

SMERSR00197**C

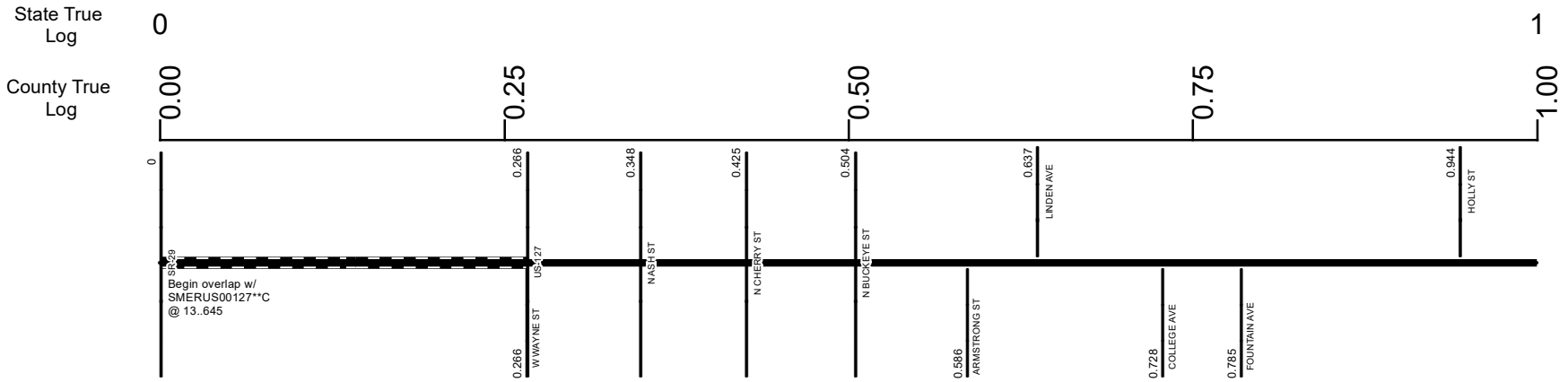

Surface Type & Width (Left / Right)	G 36'
	0.266 - 1.59
Base Type (Left / Right)	I
	0.266 - 9.242
Shoulder Type & Width (Left / Right)	1 (0'0')
	0.266 - 1.59
Through Lanes	2
	0.266 - 9.242
Street Name	WAYNE ST
	0.266 - 1.59

<ul style="list-style-type: none"> Non-divided Highway Divided Highway Secondary Segment Corporation 	<ul style="list-style-type: none"> Bridge (on route) Underpass Overpass 	<ul style="list-style-type: none"> Railroad (at grade) Railroad (underpass) Railroad (overpass) 	<ul style="list-style-type: none"> Intersection
--	---	---	---

Created on: 7/2/2025

transportation.ohio.gov

Prepared by
The Ohio Department of Transportation
Office of Technical Services
Roadway Information

SMERSR00197**C

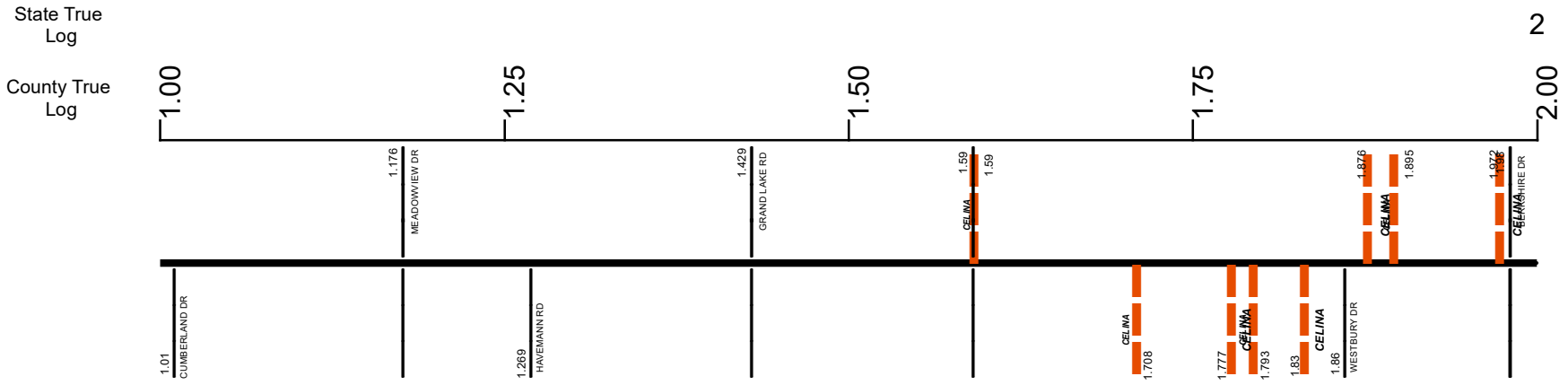

Surface Type & Width (Left / Right)	
G 36'	G 20'
0.266 - 1.59	1.59 - 6.255
Base Type (Left / Right)	
I	
0.266 - 9.242	
Shoulder Type & Width (Left / Right)	
1 (0'/0')	2 (5'/5')
0.266 - 1.59	1.59 - 6.255
Through Lanes	
2	
0.266 - 9.242	
Street Name	
WAYNE ST	SR 197
0.266 - 1.59	1.59 - 9.242

<ul style="list-style-type: none"> Non-divided Highway Divided Highway Secondary Segment Corporation 	<ul style="list-style-type: none"> Bridge (on route) Underpass Overpass 	<ul style="list-style-type: none"> Railroad (at grade) Railroad (underpass) Railroad (overpass) 	<ul style="list-style-type: none"> Intersection
---	---	---	---

Created on: 7/2/2025

transportation.ohio.gov

Prepared by
The Ohio Department of Transportation
Office of Technical Services
Roadway Information

SMERSR00197**C

State True Log

3

County True Log

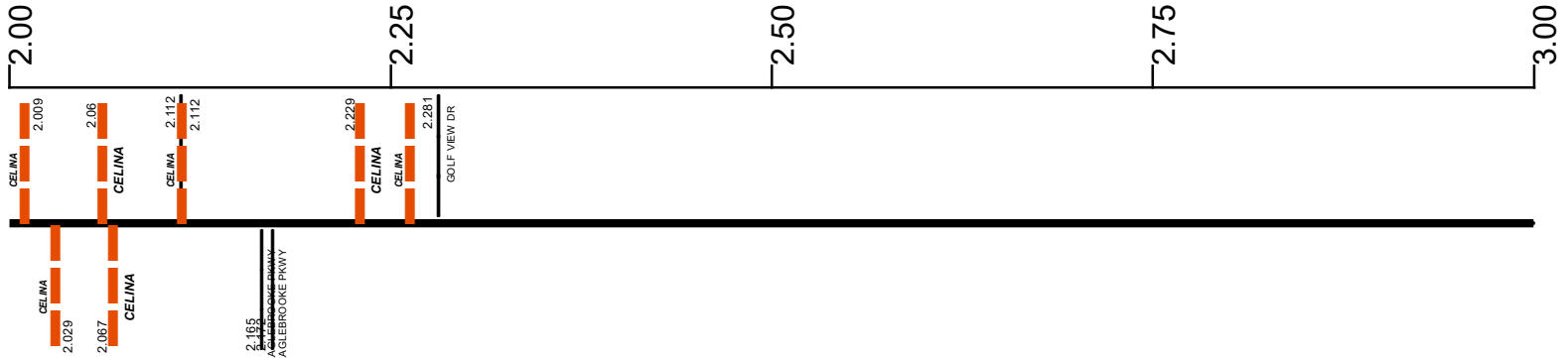

Surface Type & Width (Left / Right)

G 20'
1.59 - 6.255

Base Type (Left / Right)

I
0.266 - 9.242

Shoulder Type & Width (Left / Right)

2 (5/5)
1.59 - 6.255

Through Lanes

2
0.266 - 9.242

Street Name

SR 197
1.59 - 9.242

- Non-divided Highway
 Bridge (on route)
 Railroad (at grade)
 Intersection
- Divided Highway
 Underpass
 Railroad (underpass)
- Secondary Segment
 Overpass
 Railroad (overpass)
- Corporation**

Created on: 7/2/2025

transportation.ohio.gov

Prepared by
The Ohio Department of Transportation
Office of Technical Services
Roadway Information

SMERSR00197**C

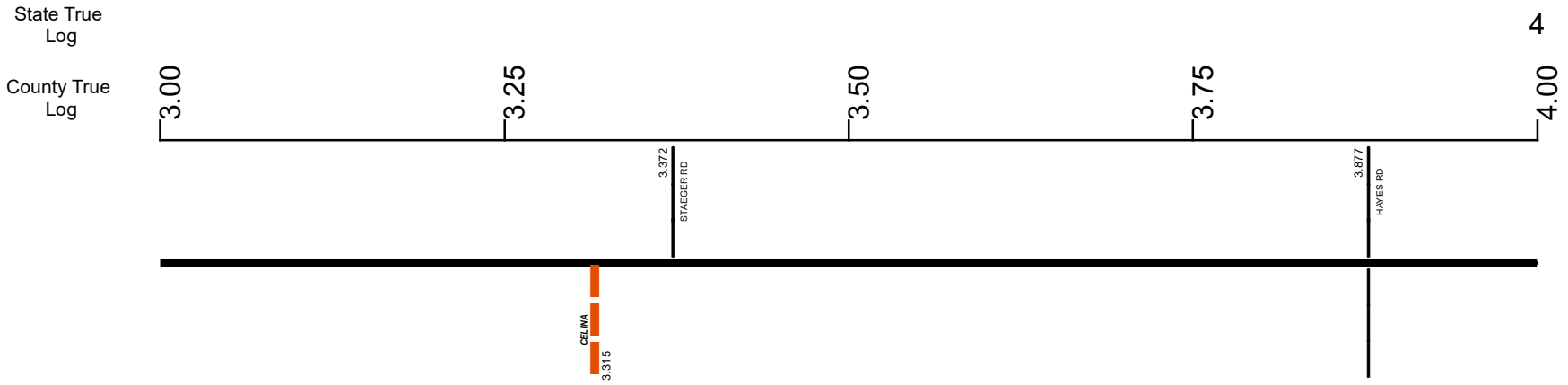

Surface Type & Width (Left / Right)	G 20' 1.59 - 6.255
Base Type (Left / Right)	I 0.266 - 9.242
Shoulder Type & Width (Left / Right)	2 (5/5) 1.59 - 6.255
Resurface Year	2020 3.37 - 6.33
Through Lanes	2 0.266 - 9.242
Street Name	SR 197 1.59 - 9.242

Non-divided Highway	Bridge (on route)	Railroad (at grade)	Intersection
Divided Highway	Underpass	Railroad (underpass)	
Secondary Segment	Overpass	Railroad (overpass)	
Corporation			

Created on: 7/2/2025

transportation.ohio.gov

Prepared by
The Ohio Department of Transportation
Office of Technical Services
Roadway Information

SMERSR00197**C

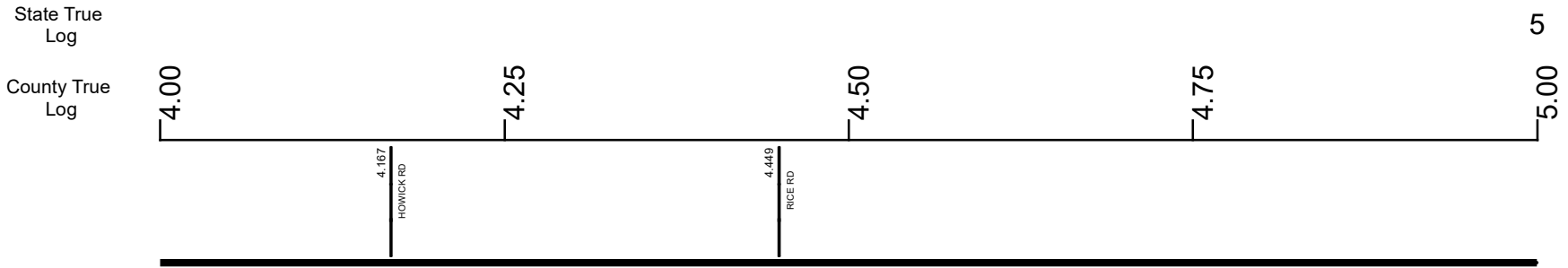

Surface Type & Width (Left / Right)	G 20'
	1.59 - 6.255
Base Type (Left / Right)	I
	0.266 - 9.242
Shoulder Type & Width (Left / Right)	2 (5/5)
	1.59 - 6.255
Resurface Year	2020
	3.37 - 6.33
Through Lanes	2
	0.266 - 9.242
Street Name	SR 197
	1.59 - 9.242

- Non-divided Highway
- Divided Highway
- Secondary Segment
- Corporation
- Bridge (on route)
- Underpass
- Overpass
- Railroad (at grade)
- Railroad (underpass)
- Railroad (overpass)
- Intersection

Created on: 7/2/2025

transportation.ohio.gov

Prepared by
The Ohio Department of Transportation
Office of Technical Services
Roadway Information

SMERSR00197**C

State True Log

County True Log

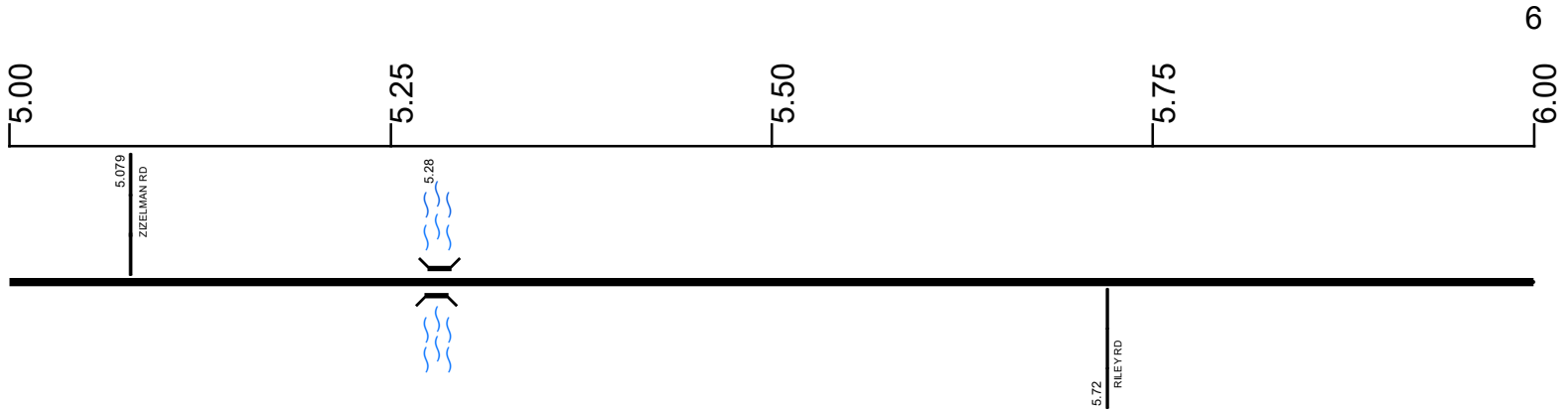

Surface Type & Width (Left / Right)	G 20' 1.59 - 6.255
Base Type (Left / Right)	I 0.266 - 9.242
Shoulder Type & Width (Left / Right)	2 (5/5) 1.59 - 6.255
Resurface Year	2020
Through Lanes	3.37 - 6.33
Street Name	SR 197 1.59 - 9.242

Non-divided Highway	Bridge (on route)	Railroad (at grade)	Intersection
Divided Highway	Underpass	Railroad (underpass)	
Secondary Segment	Overpass	Railroad (overpass)	
Corporation			

Created on: 7/2/2025



transportation.ohio.gov
Prepared by
The Ohio Department of Transportation
Office of Technical Services
Roadway Information

SMERSR00197**C

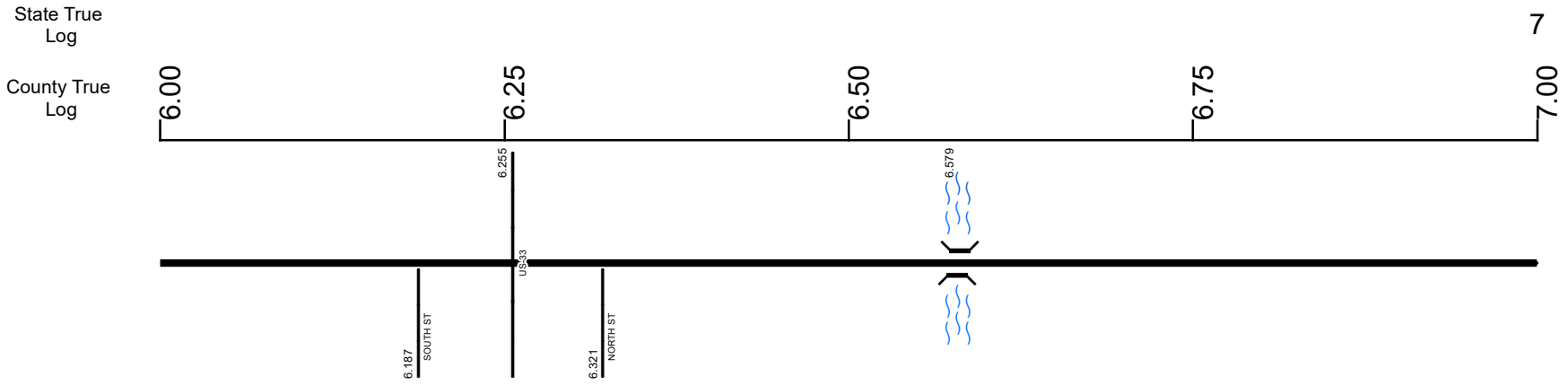

Surface Type & Width (Left / Right)

G 20'	G (9/10')	G 20'	G (9/10')	G 20'
1.59 - 6.255	6.255 - 6.502	6.502 - 6.652	6.652 - 6.954	6.954 - 7.567

Base Type (Left / Right)

I
0.266 - 9.242

Shoulder Type & Width (Left / Right)

2 (5/5')	2 (2/2')	2 (8/8')	2 (6/6')	2 (8/8')
1.59 - 6.255	6.255 - 6.502	6.502 - 6.652	6.652 - 6.954	6.954 - 7.567

Resurface Year

2020
3.37 - 6.33

Through Lanes

2
0.266 - 9.242

Street Name

SR 197
1.59 - 9.242

- Non-divided Highway
- Divided Highway
- Secondary Segment
- Corporation
- Bridge (on route)
- Underpass
- Overpass
- Railroad (at grade)
- Railroad (underpass)
- Railroad (overpass)
- Intersection

Created on: 7/2/2025

transportation.ohio.gov

Prepared by
The Ohio Department of Transportation
Office of Technical Services
Roadway Information

SMERSR00197**C

State True Log

County True Log

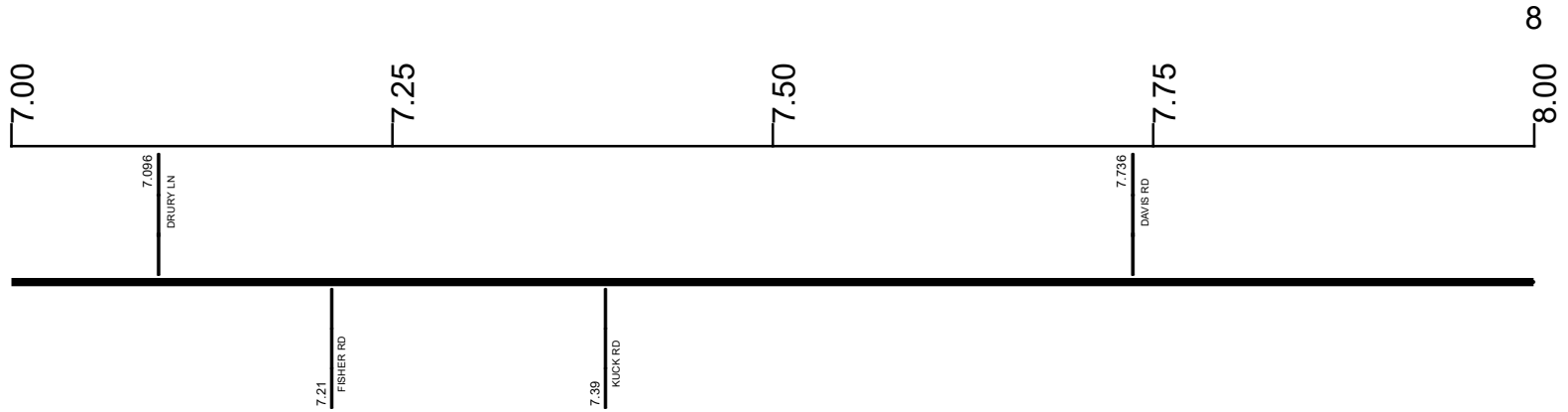

Surface Type & Width (Left / Right)

G 20' 6.954 - 7.567	G 18' 7.567 - 9.242
------------------------	------------------------

Base Type (Left / Right)

I 0.266 - 9.242	
--------------------	--

Shoulder Type & Width (Left / Right)

2 (8/8') 6.954 - 7.567	2 (2/2') 7.567 - 9.242
---------------------------	---------------------------

Through Lanes

2 0.266 - 9.242

Street Name

SR 197 1.59 - 9.242

- Non-divided Highway
- Divided Highway
- Secondary Segment
- Corporation
- Bridge (on route)
- Underpass
- Overpass
- Railroad (at grade)
- Railroad (underpass)
- Railroad (overpass)
- Intersection

Created on: 7/2/2025

transportation.ohio.gov
Prepared by
The Ohio Department of Transportation
Office of Technical Services
Roadway Information

SMERSR00197**C

State True Log

County True Log

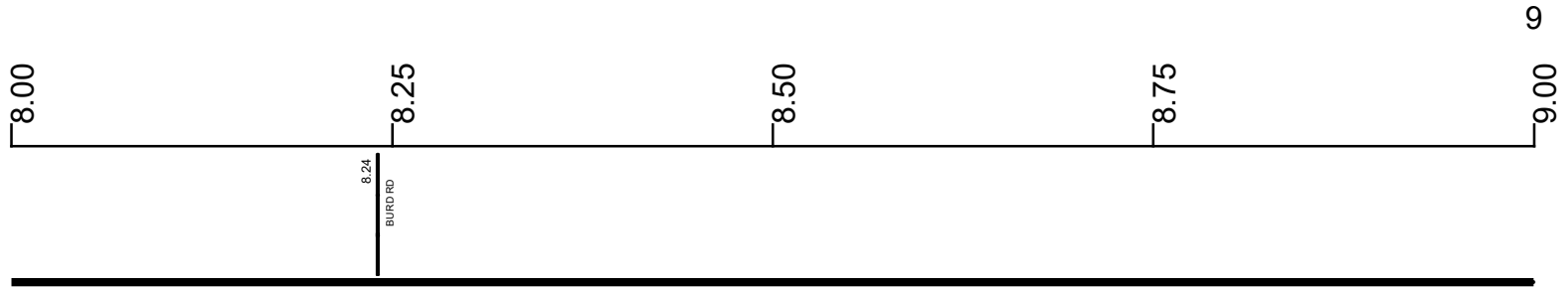

Surface Type & Width (Left / Right)

G 18'
7.567 - 9.242

Base Type (Left / Right)

I
0.266 - 9.242

Shoulder Type & Width (Left / Right)

2 (2'/2)
7.567 - 9.242

Through Lanes

2
0.266 - 9.242

Street Name

SR 197
1.59 - 9.242

- Non-divided Highway
 Bridge (on route)
 Railroad (at grade)
 Intersection
- Divided Highway
 Underpass
 Railroad (underpass)
- Secondary Segment
 Overpass
 Railroad (overpass)
- Corporation**

Created on: 7/2/2025



transportation.ohio.gov

Prepared by
The Ohio Department of Transportation
Office of Technical Services
Roadway Information

SMERSR00197**C

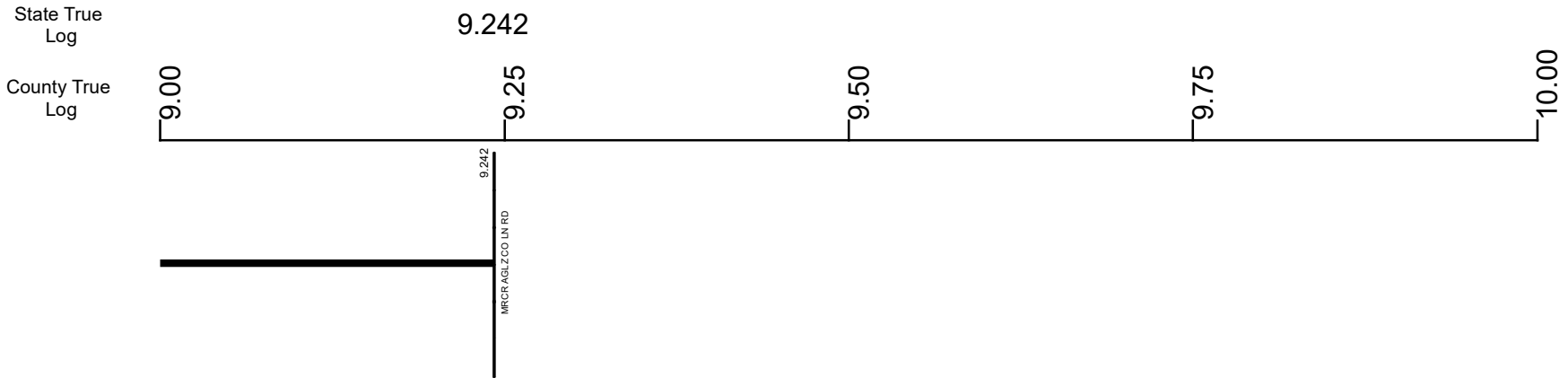

Surface Type & Width (Left / Right)	G 18'	7.567 - 9.242
Base Type (Left / Right)	I	0.266 - 9.242
Shoulder Type & Width (Left / Right)	2 (2'1/2')	7.567 - 9.242
Through Lanes	2	0.266 - 9.242
Street Name	SR 197	1.59 - 9.242

Non-divided Highway	Bridge (on route)	Railroad (at grade)	Intersection
Divided Highway	Underpass	Railroad (underpass)	
Secondary Segment	Overpass	Railroad (overpass)	
Corporation			

Created on: 7/2/2025



transportation.ohio.gov

Prepared by
The Ohio Department of Transportation
Office of Technical Services
Roadway Information

Historical Project List for SMERSR00197**C

Begin Measure	End Measure	Project ID Number	Construction Completion Date	Treatment Category	Treatment Type
0.266	1.593	25025	9-2015	Minor Rehabilitation	50-AC Overlay w/o Rpr
1.593	6.259	77520	7-2010	Minor Rehabilitation	50-AC Overlay w/o Rpr
3.368	6.329	105358	11-2020	Preventive Maintenance	25-Chip Seal
6.309	9.242	88686	8-2012	Minor Rehabilitation	60-AC Overlay w/Rpr

Roadway Codes

Access Control Journalized

- F - Full Access Control
- L - Limited Access Control
- N - No Access Control

Access Control Operational

- 1 - Full Access Control
- 2 - Partial Access Control
- 3 - No Access Control

Base Type

- F - Crack and Seat
- H - Rubblize and Roll
- I - Aggregate Base 304 or Traffic Compacted
- K - Water Bound Macadam
- L - Bituminous Concrete Mix or Penetration Macadam
- N - Plain Concrete
- P - Reinforced Concrete
- R - Brick (Flexible)
- T - Brick (Rigid)

Direction of Travel

- B - Both (Two-way)
- F - One-way Cardinal
- T - One-way Non-cardinal

Facility Type

- 1 - One-way Roadway
- 2 - Two-way Roadway
- 4 - Ramp
- 5 - Non-mainline
- 6 - Non-inventory Direction
- 7 - Planned / Unbuilt

Historical Federal Aid Indicator

- N - Not a FAP Route
- Y - FAP Route

Functional Classification

- 01 - Interstate
- 02 - Principal Arterial (Freeways)
- 03 - Principal Arterial (Other)
- 04 - Minor Arterial
- 05 - Major Collector
- 06 - Minor Collector
- 07 - Local

Leave / Reenter Indicator

- Y - Route leaves/reenters at this point
- N - Route does not leave/reenter at this point

Median Type

- 1 - None
- 2 - Unprotected
- 3 - Curbed
- 4 - Positive Barrier (Unspecified)
- 5 - Positive Barrier (Flexible)
- 6 - Positive Barrier (Semi-rigid)
- 7 - Positive Barrier (Rigid)

NHS

- N - National Highway System
- H - Congressional Corridor
- 2 - Major Airport
- 3 - Major Port Facility
- 4 - Major Amtrak Station
- 5 - Major Rail / Truck Terminal
- 6 - Major Intercity Bus Terminal
- 7 - Major Public Transit / Multi-modal Passenger Terminal
- 8 - Major Pipeline Terminal
- 9 - Major Ferry Terminal

Priority System

- G - General
- P - Priority System
- U - Urban

Scenic Byway Code

- A - All American Road
- N - National Scenic Byway
- S - State Scenic Byway

Shoulder Type

- 1 - None
- 2 - Surfaced shoulder exists (bituminous concrete {AC})
- 3 - Surfaced shoulder exists (Portland Cement Concrete {PCC})
- 4 - Stabilized shoulder exists (gravel or other granular material)
- 5 - Combination shoulder exists (two or more surface types)
- 6 - Earth shoulder exists
- 7 - Barrier curb exists; no shoulder in front of curb

Surface Type

- A - Combination
- B - Brick
- C - Continuous Reinforced Concrete
- D - Reinforced Concrete
- E - Plain Concrete
- G - Bituminous Concrete
- I - Chipseal on Granular
- K - Open Graded Bituminous
- L - Chipseal or Micro
- M - Gravel
- U - Unimproved
- X - Right of Way Only