

# SMERSR00707\*\*C

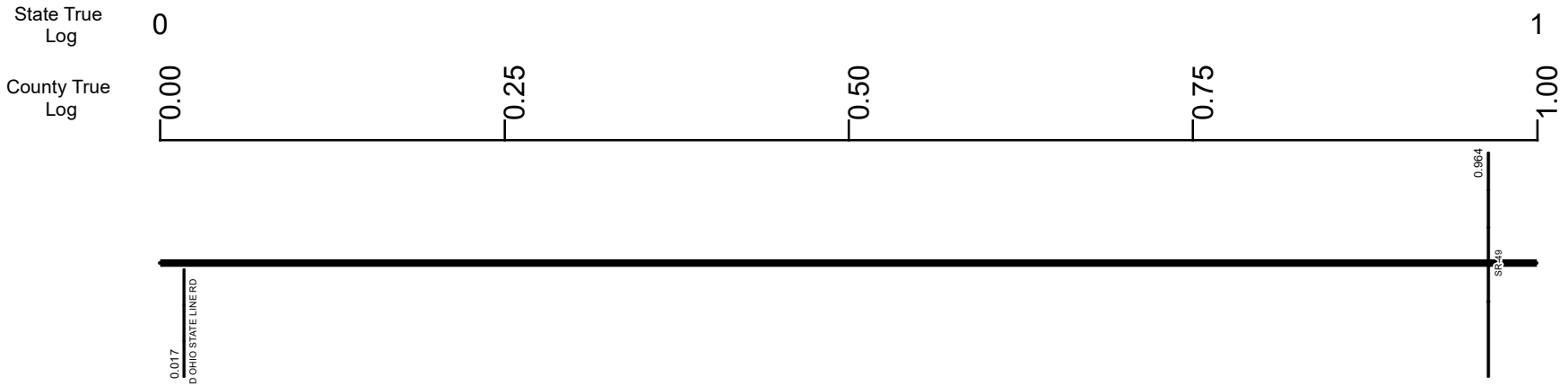

Surface Type & Width (Left / Right)	
	G 20' 0 - 11.286
Base Type (Left / Right)	
	I 0 - 11.286
Shoulder Type & Width (Left / Right)	
2 (8/8') 0 - 0.383	2 (6/6') 0.383 - 8.206
Through Lanes	
	2 0 - 11.286
Street Name	
	SR 707 0 - 11.286

- |  |   |   |   |
|--|---|---|---|
| <ul style="list-style-type: none"> <li> Non-divided Highway</li> <li> Divided Highway</li> <li> Secondary Segment</li> <li> Corporation</li> </ul> | <ul style="list-style-type: none"> <li> Bridge (on route)</li> <li> Underpass</li> <li> Overpass</li> </ul> | <ul style="list-style-type: none"> <li> Railroad (at grade)</li> <li> Railroad (underpass)</li> <li> Railroad (overpass)</li> </ul> | <ul style="list-style-type: none"> <li> Intersection</li> </ul> |
|--|---|---|---|

Created on: 7/2/2025

transportation.ohio.gov

Prepared by  
The Ohio Department of Transportation  
Office of Technical Services  
Roadway Information

# SMERSR00707\*\*C

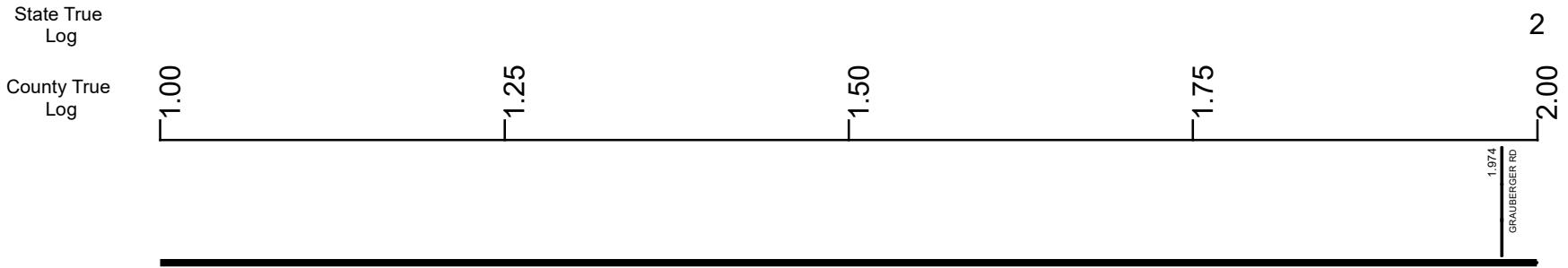

Surface Type & Width (Left / Right)	G 20'
	0 - 11.286
Base Type (Left / Right)	I
	0 - 11.286
Shoulder Type & Width (Left / Right)	2 (6/6)
	0.383 - 8.206
Through Lanes	2
	0 - 11.286
Street Name	SR 707
	0 - 11.286

Non-divided Highway	Bridge (on route)	Railroad (at grade)	Intersection
Divided Highway	Underpass	Railroad (underpass)	
Secondary Segment	Overpass	Railroad (overpass)	
Corporation			

Created on: 7/2/2025



transportation.ohio.gov

Prepared by  
The Ohio Department of Transportation  
Office of Technical Services  
Roadway Information

# SMERSR00707\*\*C

State True Log

County True Log

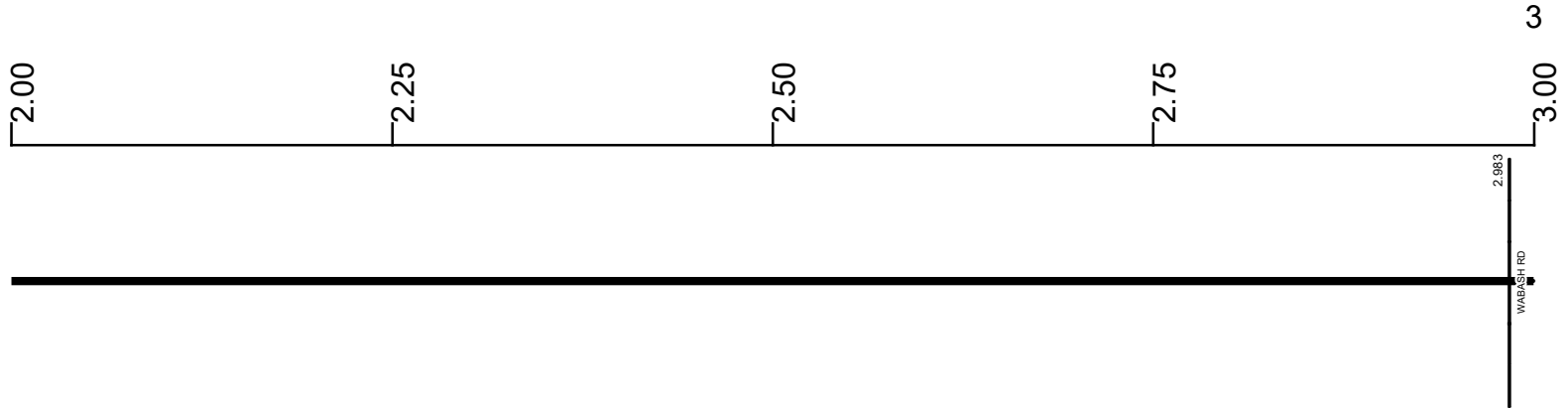

Surface Type & Width (Left / Right)

G 20'  
0 - 11.286

Base Type (Left / Right)

I  
0 - 11.286

Shoulder Type & Width (Left / Right)

2 (6/6)  
0.383 - 8.206

Through Lanes

2  
0 - 11.286

Street Name

SR 707  
0 - 11.286

- |                     |                   |                      |              |
|---------------------|-------------------|----------------------|--------------|
| Non-divided Highway | Bridge (on route) | Railroad (at grade)  | Intersection |
| Divided Highway     | Underpass         | Railroad (underpass) |              |
| Secondary Segment   | Overpass          | Railroad (overpass)  |              |
| Corporation         |                   |                      |              |

Created on: 7/2/2025



transportation.ohio.gov  
Prepared by  
The Ohio Department of Transportation  
Office of Technical Services  
Roadway Information

# SMERSR00707\*\*C

State True Log

4

County True Log

3.00

3.25

3.50

3.75

4.00



Surface Type & Width (Left / Right)

	G 20'
	0 - 11.286

Base Type (Left / Right)

	I
	0 - 11.286

Shoulder Type & Width (Left / Right)

	2 (6/6)
	0.383 - 8.206

Through Lanes

	2
	0 - 11.286

Street Name

	SR 707
	0 - 11.286

- |                     |                   |                      |              |
|---------------------|-------------------|----------------------|--------------|
| Non-divided Highway | Bridge (on route) | Railroad (at grade)  | Intersection |
| Divided Highway     | Underpass         | Railroad (underpass) |              |
| Secondary Segment   | Overpass          | Railroad (overpass)  |              |
| Corporation         |                   |                      |              |

Created on: 7/2/2025

transportation.ohio.gov

Prepared by  
The Ohio Department of Transportation  
Office of Technical Services  
Roadway Information

# SMERSR00707\*\*C

State True Log

County True Log

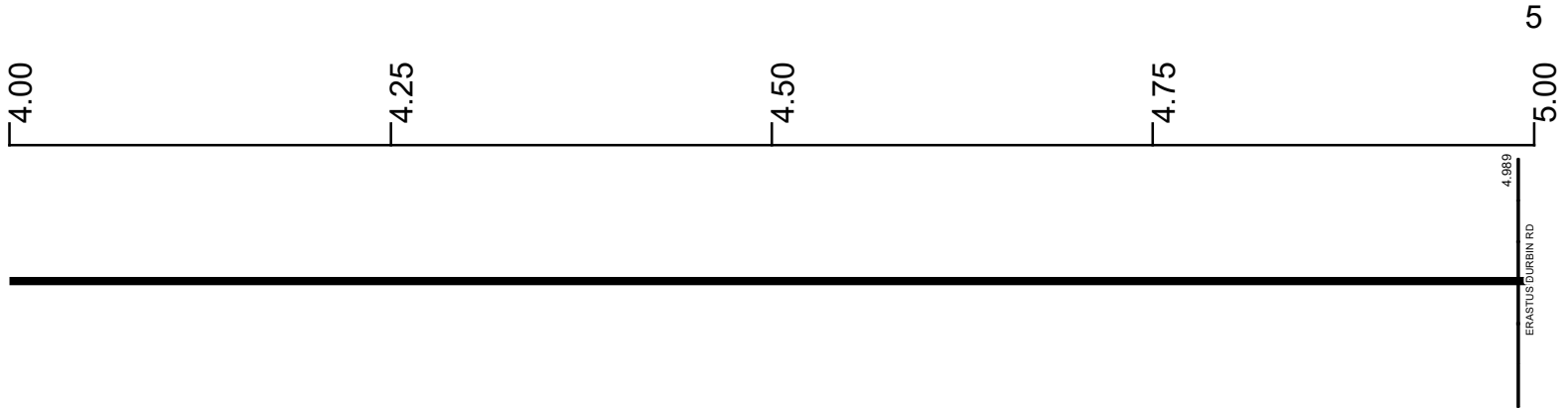

Surface Type & Width (Left / Right)	G 20' 0 - 11.286
Base Type (Left / Right)	I 0 - 11.286
Shoulder Type & Width (Left / Right)	2 (6/6) 0.383 - 8.206
Through Lanes	2 0 - 11.286
Street Name	SR 707 0 - 11.286

- |                     |                   |                      |              |
|---------------------|-------------------|----------------------|--------------|
| Non-divided Highway | Bridge (on route) | Railroad (at grade)  | Intersection |
| Divided Highway     | Underpass         | Railroad (underpass) |              |
| Secondary Segment   | Overpass          | Railroad (overpass)  |              |
| <b>Corporation</b>  |                   |                      |              |

Created on: 7/2/2025

transportation.ohio.gov

Prepared by  
The Ohio Department of Transportation  
Office of Technical Services  
Roadway Information

# SMERSR00707\*\*C

State True Log

County True Log

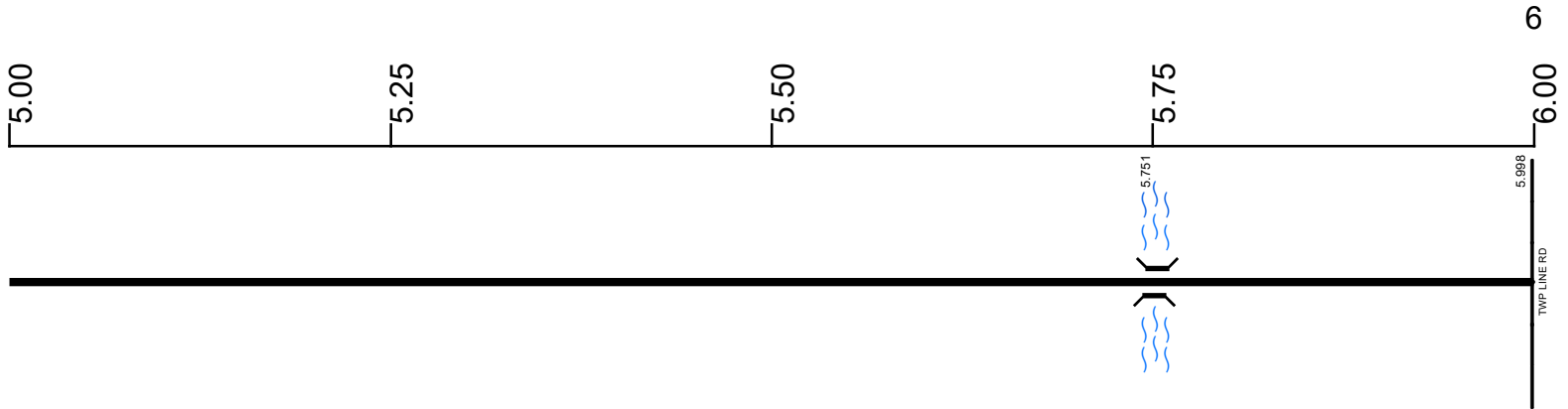

Surface Type & Width (Left / Right)

G 20'  
0 - 11.286

Base Type (Left / Right)

I  
0 - 11.286

Shoulder Type & Width (Left / Right)

2 (6/6)  
0.383 - 8.206

Through Lanes

2  
0 - 11.286

Street Name

SR 707  
0 - 11.286

- |                     |                   |                      |              |
|---------------------|-------------------|----------------------|--------------|
| Non-divided Highway | Bridge (on route) | Railroad (at grade)  | Intersection |
| Divided Highway     | Underpass         | Railroad (underpass) |              |
| Secondary Segment   | Overpass          | Railroad (overpass)  |              |
| Corporation         |                   |                      |              |

Created on: 7/2/2025

Prepared by  
The Ohio Department of Transportation  
Office of Technical Services  
Roadway Information

# SMERSR00707\*\*C

State True Log

7

County True Log



Surface Type & Width (Left / Right)

G 20'  
0 - 11.286

Base Type (Left / Right)

I  
0 - 11.286

Shoulder Type & Width (Left / Right)

2 (6/6)  
0.383 - 8.206

Through Lanes

2  
0 - 11.286

Street Name

SR 707  
0 - 11.286

- |                     |                   |                      |              |
|---------------------|-------------------|----------------------|--------------|
| Non-divided Highway | Bridge (on route) | Railroad (at grade)  | Intersection |
| Divided Highway     | Underpass         | Railroad (underpass) |              |
| Secondary Segment   | Overpass          | Railroad (overpass)  |              |
| <b>Corporation</b>  |                   |                      |              |

Created on: 7/2/2025



transportation.ohio.gov  
 Prepared by  
 The Ohio Department of Transportation  
 Office of Technical Services  
 Roadway Information

# SMERSR00707\*\*C

State True Log

County True Log

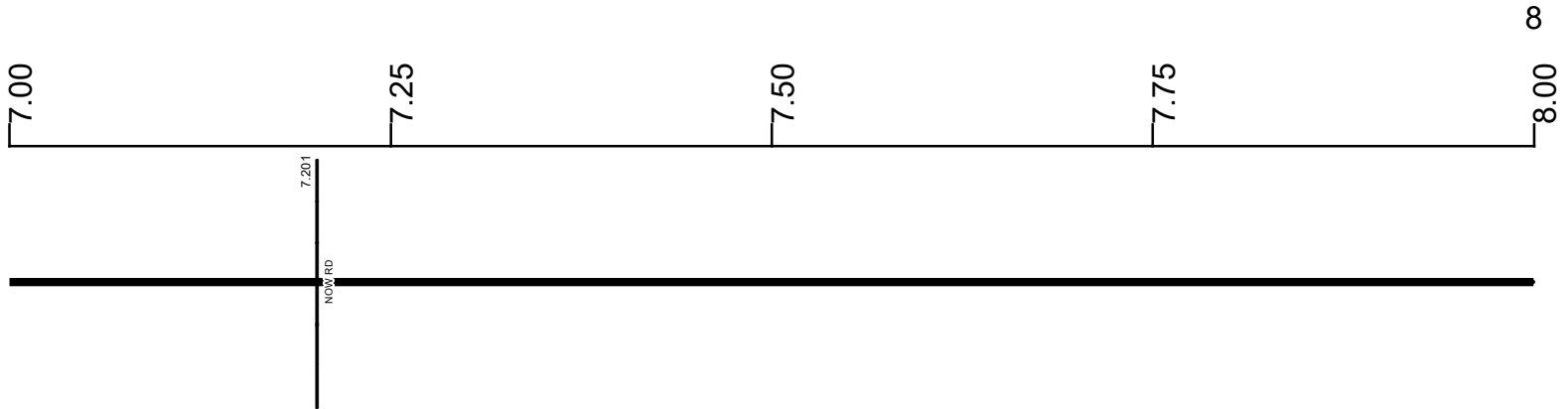

Surface Type & Width (Left / Right)

G 20'  
0 - 11.286

Base Type (Left / Right)

I  
0 - 11.286

Shoulder Type & Width (Left / Right)

2 (6/6)  
0.383 - 8.206

Through Lanes

2  
0 - 11.286

Street Name

SR 707  
0 - 11.286

- Non-divided Highway
  Bridge (on route)
  Railroad (at grade)
  Intersection
- Divided Highway
  Underpass
  Railroad (underpass)
- Secondary Segment
  Overpass
  Railroad (overpass)
- Corporation**

Created on: 7/2/2025



transportation.ohio.gov

Prepared by  
The Ohio Department of Transportation  
Office of Technical Services  
Roadway Information

# SMERSR00707\*\*C

State True Log

County True Log

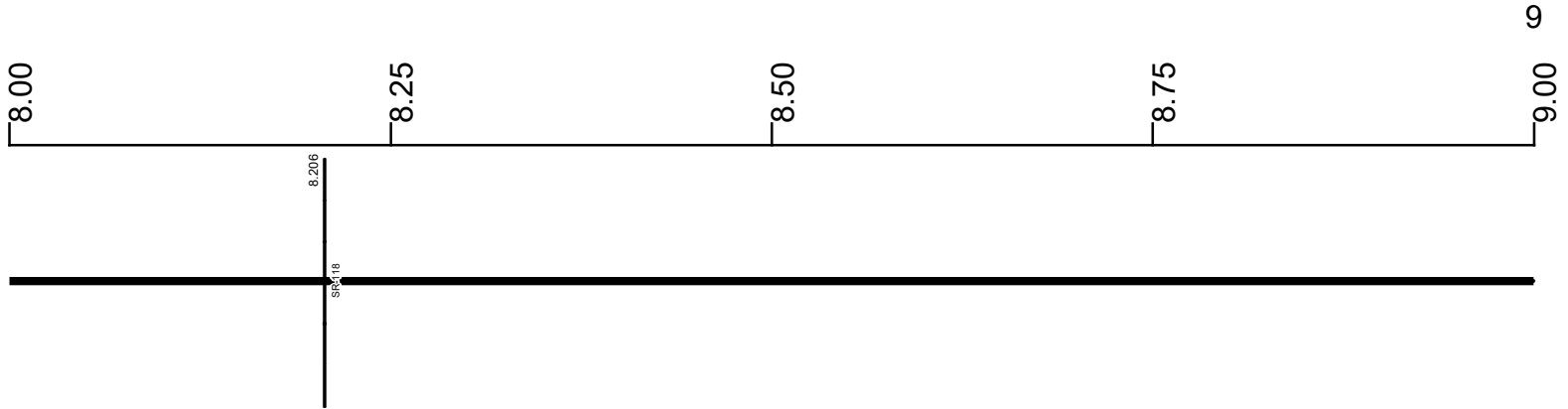

Surface Type & Width (Left / Right)

	G 20'
0 - 11.286	

Base Type (Left / Right)

	I
0 - 11.286	

Shoulder Type & Width (Left / Right)

2 (6/6')	2 (5/5')
0.383 - 8.206	8.206 - 11.286

Through Lanes

2
0 - 11.286

Street Name

	SR 707
0 - 11.286	

- |  |   |   |   |
|--|---|---|---|
| <ul style="list-style-type: none"> <li> Non-divided Highway</li> <li> Divided Highway</li> <li> Secondary Segment</li> <li> Corporation</li> </ul> | <ul style="list-style-type: none"> <li> Bridge (on route)</li> <li> Underpass</li> <li> Overpass</li> </ul> | <ul style="list-style-type: none"> <li> Railroad (at grade)</li> <li> Railroad (underpass)</li> <li> Railroad (overpass)</li> </ul> | <ul style="list-style-type: none"> <li> Intersection</li> </ul> |
|--|---|---|---|

Created on: 7/2/2025

transportation.ohio.gov

Prepared by  
The Ohio Department of Transportation  
Office of Technical Services  
Roadway Information

# SMERSR00707\*\*C

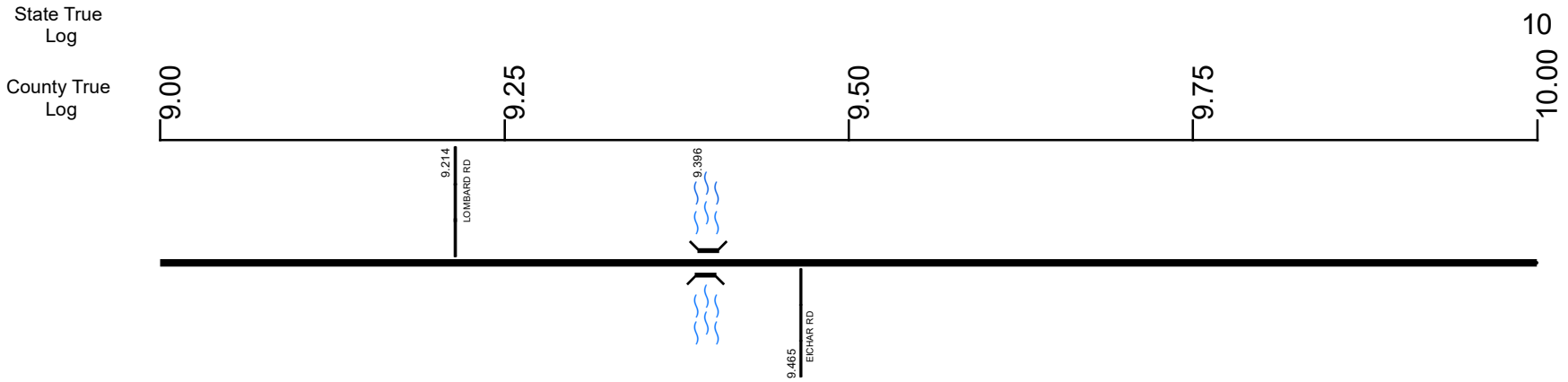

Surface Type & Width (Left / Right)	G 20'
	0 - 11.286
Base Type (Left / Right)	I
	0 - 11.286
Shoulder Type & Width (Left / Right)	2 (5/5')
	8.206 - 11.286
Through Lanes	2
	0 - 11.286
Street Name	SR 707
	0 - 11.286

Non-divided Highway	Bridge (on route)	Railroad (at grade)	Intersection
Divided Highway	Underpass	Railroad (underpass)	
Secondary Segment	Overpass	Railroad (overpass)	
Corporation			

Created on: 7/2/2025



transportation.ohio.gov

Prepared by  
The Ohio Department of Transportation  
Office of Technical Services  
Roadway Information

# SMERSR00707\*\*C

State True Log

County True Log

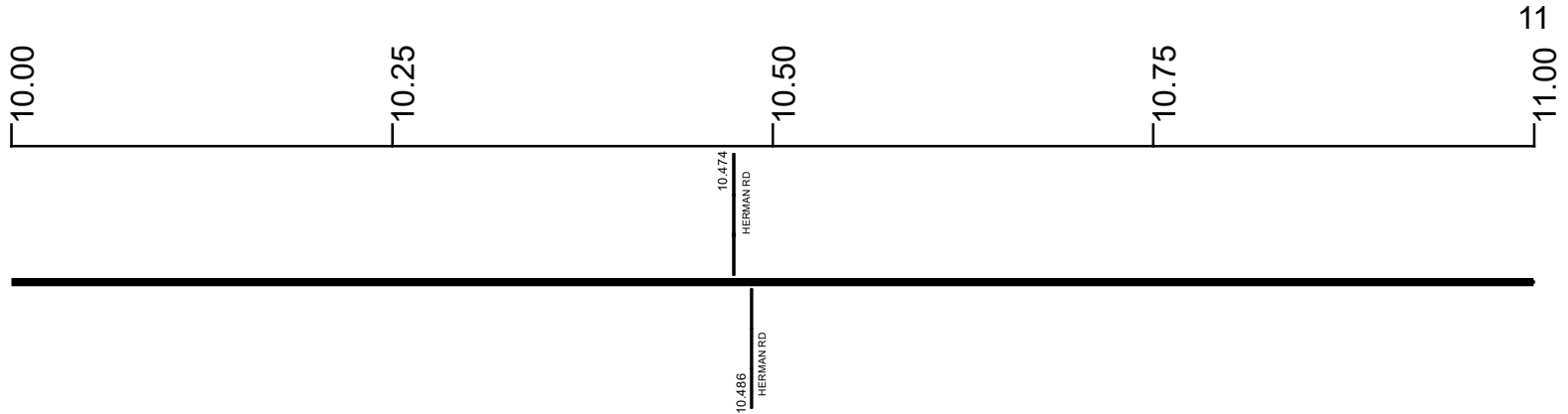

Surface Type & Width (Left / Right)

G 20'  
0 - 11.286

Base Type (Left / Right)

I  
0 - 11.286

Shoulder Type & Width (Left / Right)

2 (5/5)  
8.206 - 11.286

Through Lanes

2  
0 - 11.286

Street Name

SR 707  
0 - 11.286

- |                     |                   |                      |              |
|---------------------|-------------------|----------------------|--------------|
| Non-divided Highway | Bridge (on route) | Railroad (at grade)  | Intersection |
| Divided Highway     | Underpass         | Railroad (underpass) |              |
| Secondary Segment   | Overpass          | Railroad (overpass)  |              |
| Corporation         |                   |                      |              |

Created on: 7/2/2025



transportation.ohio.gov  
 Prepared by  
 The Ohio Department of Transportation  
 Office of Technical Services  
 Roadway Information

# SMERSR00707\*\*C

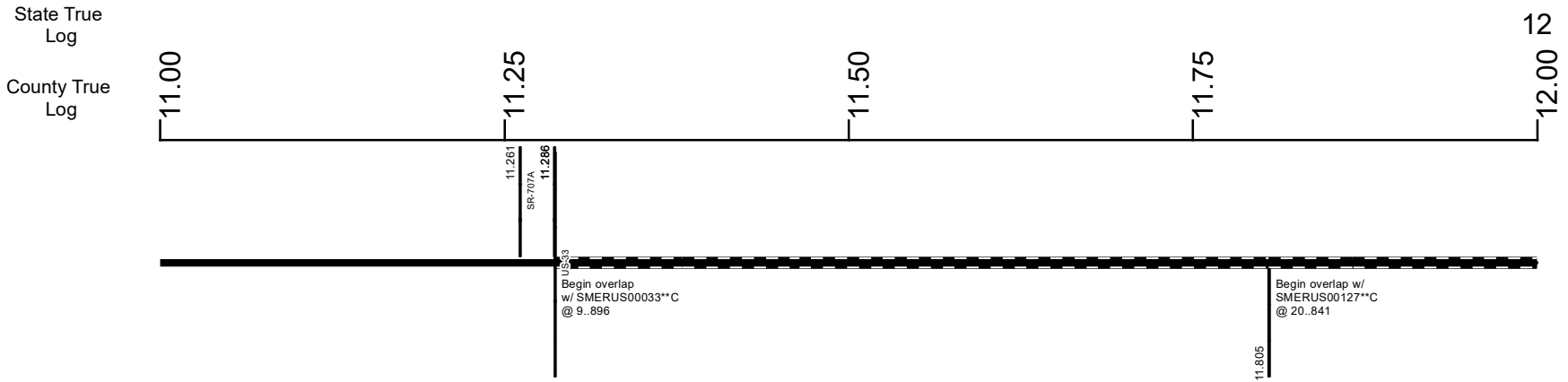

Surface Type & Width (Left / Right)	
G 20'	0 - 11.286
Base Type (Left / Right)	
I	0 - 11.286
Shoulder Type & Width (Left / Right)	
2 (5/5')	8.206 - 11.286
Through Lanes	
2	0 - 11.286
Street Name	
SR 707	0 - 11.286

Non-divided Highway	Bridge (on route)	Railroad (at grade)	Intersection
Divided Highway	Underpass	Railroad (underpass)	
Secondary Segment	Overpass	Railroad (overpass)	
Corporation			

Created on: 7/2/2025



transportation.ohio.gov  
 Prepared by  
 The Ohio Department of Transportation  
 Office of Technical Services  
 Roadway Information

# SMERSR00707\*\*C

State True  
Log

13

County True  
Log

12.00

12.25

12.50

12.75

13.00



- |                     |                   |                      |              |
|---------------------|-------------------|----------------------|--------------|
| Non-divided Highway | Bridge (on route) | Railroad (at grade)  | Intersection |
| Divided Highway     | Underpass         | Railroad (underpass) |              |
| Secondary Segment   | Overpass          | Railroad (overpass)  |              |
| <b>Corporation</b>  |                   |                      |              |

Created on: 7/2/2025

transportation.ohio.gov  
Prepared by  
The Ohio Department of Transportation  
Office of Technical Services  
Roadway Information

# SMERSR00707\*\*C

State True Log  
County True Log

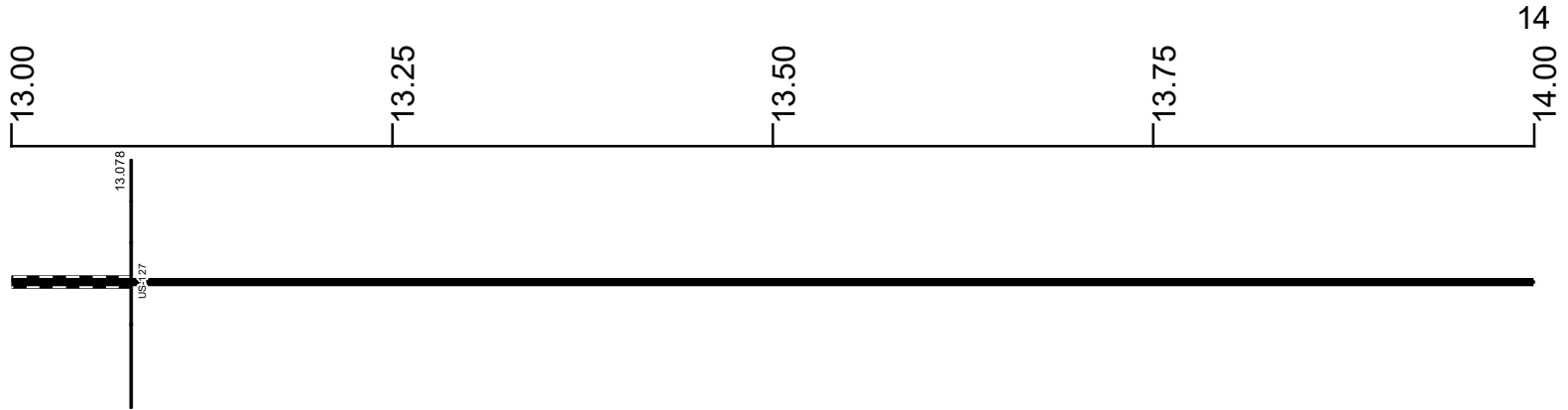

Surface Type & Width (Left / Right)	G (18'/6')
	13.078 - 16.293
Base Type (Left / Right)	N / I
	13.078 - 16.342
Shoulder Type & Width (Left / Right)	2 (2'/2')
	13.078 - 16.114
Through Lanes	2
	13.078 - 16.418
Street Name	SR 707
	13.078 - 16.114

- Non-divided Highway
- Divided Highway
- Secondary Segment
- Corporation
- Bridge (on route)
- Underpass
- Overpass
- Railroad (at grade)
- Railroad (underpass)
- Railroad (overpass)
- Intersection

Created on: 7/2/2025



transportation.ohio.gov  
 Prepared by  
 The Ohio Department of Transportation  
 Office of Technical Services  
 Roadway Information

# SMERSR00707\*\*C

State True Log  
County True Log

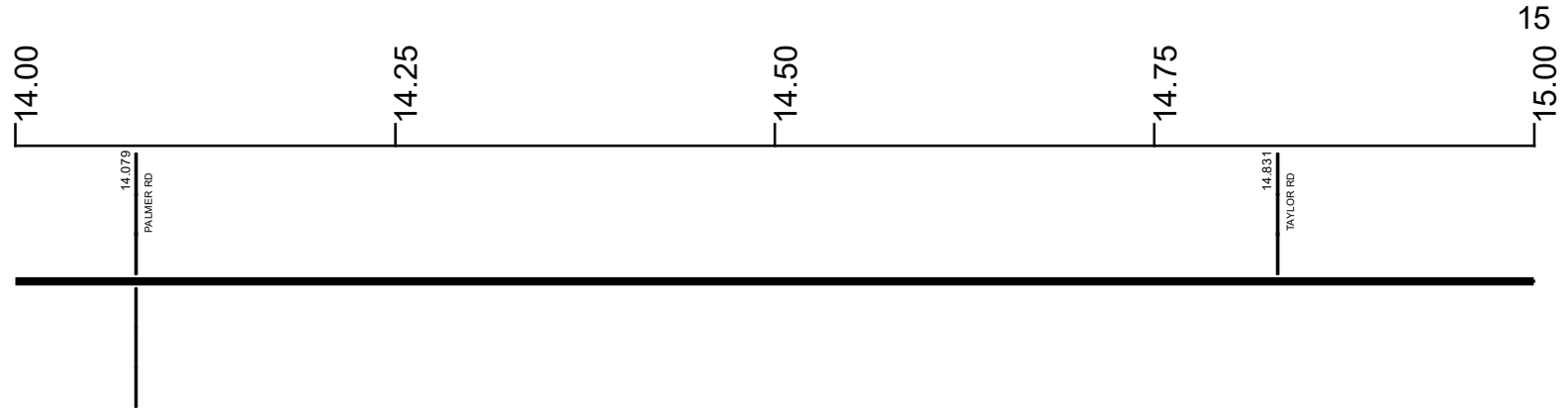

Surface Type & Width (Left / Right)

G (18/6')  
13.078 - 16.293

Base Type (Left / Right)

N / I  
13.078 - 16.342

Shoulder Type & Width (Left / Right)

2 (2/2')  
13.078 - 16.114

Through Lanes

2  
13.078 - 16.418

Street Name

SR 707  
13.078 - 16.114

- |                     |                   |                      |              |
|---------------------|-------------------|----------------------|--------------|
| Non-divided Highway | Bridge (on route) | Railroad (at grade)  | Intersection |
| Divided Highway     | Underpass         | Railroad (underpass) |              |
| Secondary Segment   | Overpass          | Railroad (overpass)  |              |
| Corporation         |                   |                      |              |

Created on: 7/2/2025



transportation.ohio.gov  
 Prepared by  
 The Ohio Department of Transportation  
 Office of Technical Services  
 Roadway Information

# SMERSR00707\*\*C

State True  
Log

16

County True  
Log

15.00

15.25

15.50

15.75

16.00



Surface Type & Width (Left / Right)

G (18/6')  
13.078 - 16.293

Base Type (Left / Right)

N / I  
13.078 - 16.342

Shoulder Type & Width (Left / Right)

2 (2/2')  
13.078 - 16.114

Through Lanes

2  
13.078 - 16.418

Street Name

SR 707  
13.078 - 16.114

- |                     |                   |                      |              |
|---------------------|-------------------|----------------------|--------------|
| Non-divided Highway | Bridge (on route) | Railroad (at grade)  | Intersection |
| Divided Highway     | Underpass         | Railroad (underpass) |              |
| Secondary Segment   | Overpass          | Railroad (overpass)  |              |
| Corporation         |                   |                      |              |

Created on: 7/2/2025



transportation.ohio.gov  
 Prepared by  
 The Ohio Department of Transportation  
 Office of Technical Services  
 Roadway Information

# SMERSR00707\*\*C

State True Log  
County True Log

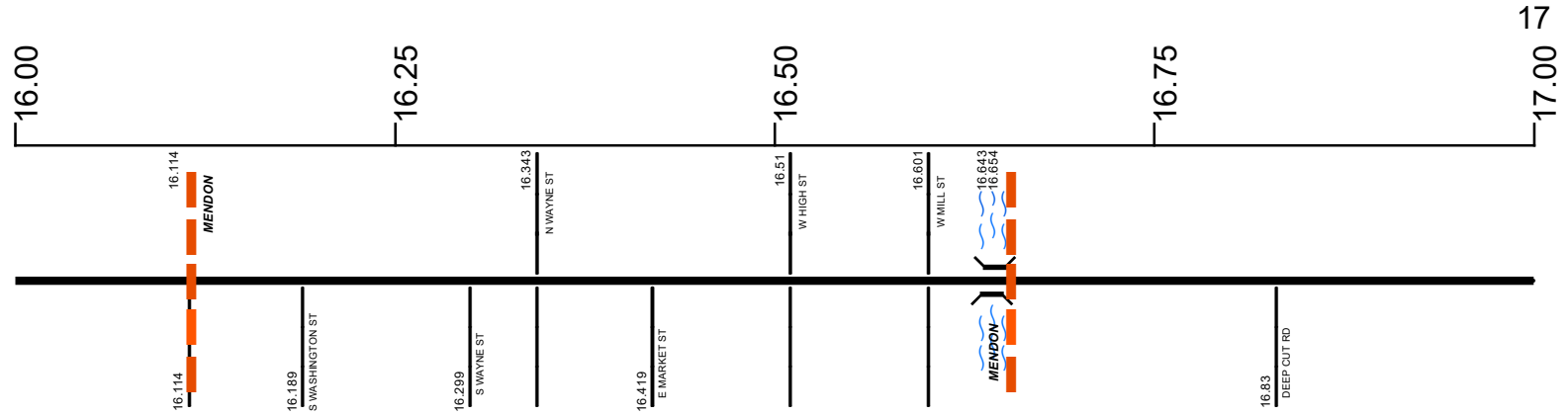

**Surface Type & Width (Left / Right)**

G (18'6")	G (18'8")	G 30'	G (27'28")	G (22'23")	G 36'	G 20'
13.078 - 16.293		16.342 - 16.418	16.418 - 16.514	16.514 - 16.654	16.654 - 16.739	16.739 - 17.232

**Base Type (Left / Right)**

N / I	N	T	I
13.078 - 16.342	16.342 - 16.418	16.418 - 16.654	16.654 - 19.431

**Shoulder Type & Width (Left / Right)**

2 (2'2")	2 (3'3")	2 (10'10")	1 (0'0")	2 (8'8")
13.078 - 16.114	16.114 - 16.293	16.293 - 16.342	16.342 - 16.739	16.739 - 17.232

**Through Lanes**

2	4	2
13.078 - 16.418	16.418 - 16.654	16.654 - 19.431

**Street Name**

SR 707	WAYNE ST	MARKET ST	MAIN ST	SR 707
13.078 - 16.114	16.114 - 16.342	16.342 - 16.514	16.514 - 16.654	16.654 - 19.431

- Non-divided Highway
- Divided Highway
- Secondary Segment
- Corporation
- Bridge (on route)
- Underpass
- Overpass
- Railroad (at grade)
- Railroad (underpass)
- Railroad (overpass)
- Intersection

Created on: 7/2/2025

transportation.ohio.gov

Prepared by  
The Ohio Department of Transportation  
Office of Technical Services  
Roadway Information

# SMERSR00707\*\*C

State True  
Log

County True  
Log

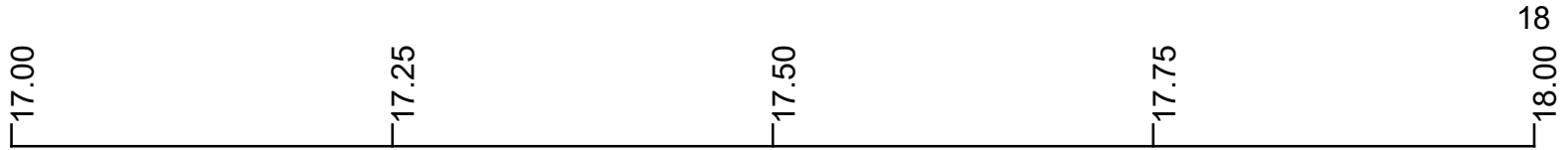

**Surface Type & Width (Left / Right)**

G 20' 16.739 - 17.232	K 20' 17.232 - 19.431
--------------------------	--------------------------

**Base Type (Left / Right)**

I 16.654 - 19.431	
----------------------	--

**Shoulder Type & Width (Left / Right)**

2 (8/8') 16.739 - 17.232	2 (3/3') 17.232 - 19.431
-----------------------------	-----------------------------

**Through Lanes**

2 16.654 - 19.431	
----------------------	--

**Street Name**

SR 707 16.654 - 19.431	
---------------------------	--

- |                     |                   |                      |              |
|---------------------|-------------------|----------------------|--------------|
| Non-divided Highway | Bridge (on route) | Railroad (at grade)  | Intersection |
| Divided Highway     | Underpass         | Railroad (underpass) |              |
| Secondary Segment   | Overpass          | Railroad (overpass)  |              |
| <b>Corporation</b>  |                   |                      |              |

Created on: 7/2/2025

transportation.ohio.gov

Prepared by  
The Ohio Department of Transportation  
Office of Technical Services  
Roadway Information

# SMERSR00707\*\*C

State True Log

County True Log

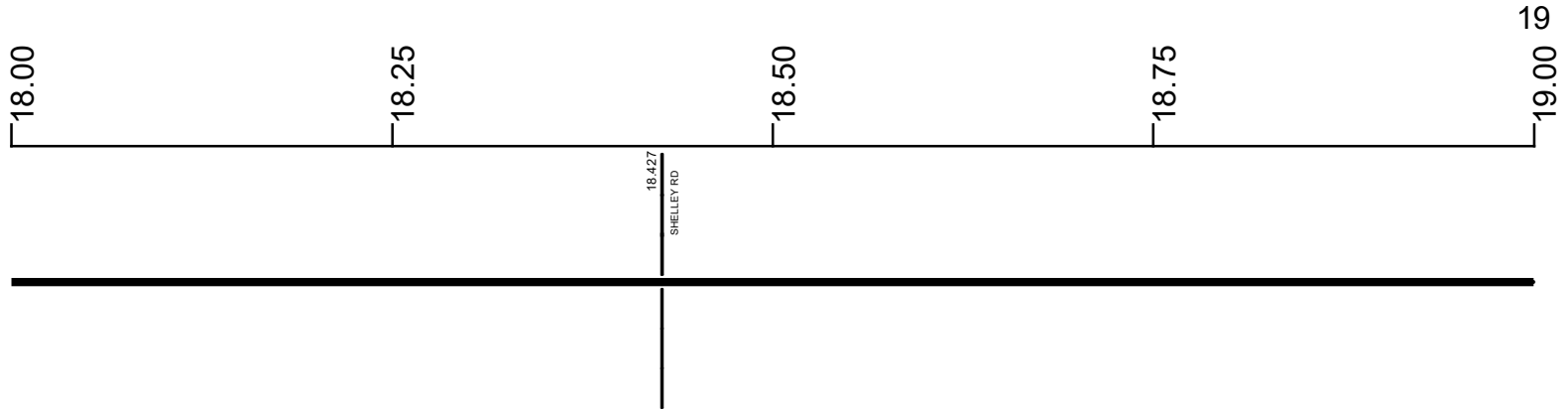

Surface Type & Width (Left / Right)

K 20'  
17.232 - 19.431

Base Type (Left / Right)

I  
16.654 - 19.431

Shoulder Type & Width (Left / Right)

2 (3/3)  
17.232 - 19.431

Through Lanes

2  
16.654 - 19.431

Street Name

SR 707  
16.654 - 19.431

- |                     |                   |                      |              |
|---------------------|-------------------|----------------------|--------------|
| Non-divided Highway | Bridge (on route) | Railroad (at grade)  | Intersection |
| Divided Highway     | Underpass         | Railroad (underpass) |              |
| Secondary Segment   | Overpass          | Railroad (overpass)  |              |
| Corporation         |                   |                      |              |

Created on: 7/2/2025



transportation.ohio.gov  
 Prepared by  
 The Ohio Department of Transportation  
 Office of Technical Services  
 Roadway Information

# SMERSR00707\*\*C

19.431

State True Log

County True Log

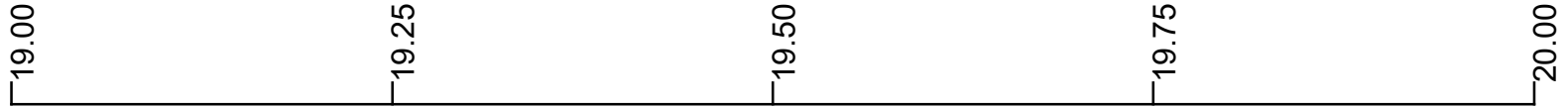

19.431  
SR-117 HICKERNELL RD

Surface Type & Width (Left / Right)

K 20'  
17.232 - 19.431

Base Type (Left / Right)

I  
16.654 - 19.431

Shoulder Type & Width (Left / Right)

2 (3'/3')  
17.232 - 19.431

Through Lanes

2  
16.654 - 19.431

Street Name

SR 707  
16.654 - 19.431

- Non-divided Highway
- Divided Highway
- Secondary Segment
- Corporation
- Bridge (on route)
- Underpass
- Overpass
- Railroad (at grade)
- Railroad (underpass)
- Railroad (overpass)
- Intersection

Created on: 7/2/2025



transportation.ohio.gov

Prepared by

The Ohio Department of Transportation  
Office of Technical Services  
Roadway Information

## Historical Project List for SMERSR00707\*\*C

Begin Measure	End Measure	Project ID Number	Construction Completion Date	Treatment Category	Treatment Type
0.000	11.286	92650	8-2017	Minor Rehabilitation	38-Fine Poly AC Overlay
0.020	11.286	25032	10-2006	Minor Rehabilitation	50-AC Overlay w/o Rpr
13.078	19.431	80888	7-2010	Minor Rehabilitation	60-AC Overlay w/Rpr
16.119	16.660	88686	8-2012	Minor Rehabilitation	60-AC Overlay w/Rpr
16.650	19.431	105280	10-2019	Preventive Maintenance	25-Chip Seal
16.650	19.431	25142	5-2008	Minor Rehabilitation	50-AC Overlay w/o Rpr

# Roadway Codes

## Access Control Journalized

- F - Full Access Control
- L - Limited Access Control
- N - No Access Control

## Access Control Operational

- 1 - Full Access Control
- 2 - Partial Access Control
- 3 - No Access Control

## Base Type

- F - Crack and Seat
- H - Rubblize and Roll
- I - Aggregate Base 304 or Traffic Compacted
- K - Water Bound Macadam
- L - Bituminous Concrete Mix or Penetration Macadam
- N - Plain Concrete
- P - Reinforced Concrete
- R - Brick (Flexible)
- T - Brick (Rigid)

## Direction of Travel

- B - Both (Two-way)
- F - One-way Cardinal
- T - One-way Non-cardinal

## Facility Type

- 1 - One-way Roadway
- 2 - Two-way Roadway
- 4 - Ramp
- 5 - Non-mainline
- 6 - Non-inventory Direction
- 7 - Planned / Unbuilt

## Historical Federal Aid Indicator

- N - Not a FAP Route
- Y - FAP Route

## Functional Classification

- 01 - Interstate
- 02 - Principal Arterial (Freeways)
- 03 - Principal Arterial (Other)
- 04 - Minor Arterial
- 05 - Major Collector
- 06 - Minor Collector
- 07 - Local

## Leave / Reenter Indicator

- Y - Route leaves/reenters at this point
- N - Route does not leave/reenter at this point

## Median Type

- 1 - None
- 2 - Unprotected
- 3 - Curbed
- 4 - Positive Barrier (Unspecified)
- 5 - Positive Barrier (Flexible)
- 6 - Positive Barrier (Semi-rigid)
- 7 - Positive Barrier (Rigid)

## NHS

- N - National Highway System
- H - Congressional Corridor
- 2 - Major Airport
- 3 - Major Port Facility
- 4 - Major Amtrak Station
- 5 - Major Rail / Truck Terminal
- 6 - Major Intercity Bus Terminal
- 7 - Major Public Transit / Multi-modal Passenger Terminal
- 8 - Major Pipeline Terminal
- 9 - Major Ferry Terminal

## Priority System

- G - General
- P - Priority System
- U - Urban

## Scenic Byway Code

- A - All American Road
- N - National Scenic Byway
- S - State Scenic Byway

## Shoulder Type

- 1 - None
- 2 - Surfaced shoulder exists (bituminous concrete {AC})
- 3 - Surfaced shoulder exists (Portland Cement Concrete {PCC})
- 4 - Stabilized shoulder exists (gravel or other granular material)
- 5 - Combination shoulder exists (two or more surface types)
- 6 - Earth shoulder exists
- 7 - Barrier curb exists; no shoulder in front of curb

## Surface Type

- A - Combination
- B - Brick
- C - Continuous Reinforced Concrete
- D - Reinforced Concrete
- E - Plain Concrete
- G - Bituminous Concrete
- I - Chipseal on Granular
- K - Open Graded Bituminous
- L - Chipseal or Micro
- M - Gravel
- U - Unimproved
- X - Right of Way Only