

# SMIASR00721\*\*C

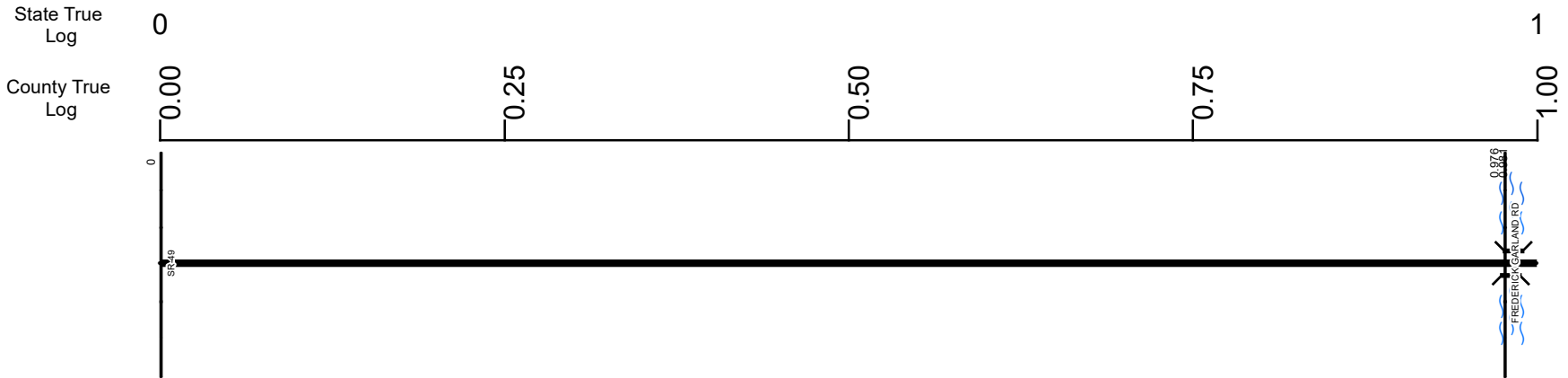

Surface Type & Width (Left / Right)	G 20' 0 - 2.826
Base Type (Left / Right)	I 0 - 5.777
Shoulder Type & Width (Left / Right)	5 (2/2) 0 - 2.727
Resurface Year	2020 0 - 2.82
Through Lanes	2 0 - 5.777
Street Name	SR 721 0 - 2.727

- Non-divided Highway
- Divided Highway
- Secondary Segment
- Corporation
- Bridge (on route)
- Underpass
- Overpass
- Railroad (at grade)
- Railroad (underpass)
- Railroad (overpass)
- Intersection

Created on: 7/3/2025



transportation.ohio.gov  
 Prepared by  
 The Ohio Department of Transportation  
 Office of Technical Services  
 Roadway Information

# SMIASR00721\*\*C

State True Log

County True Log

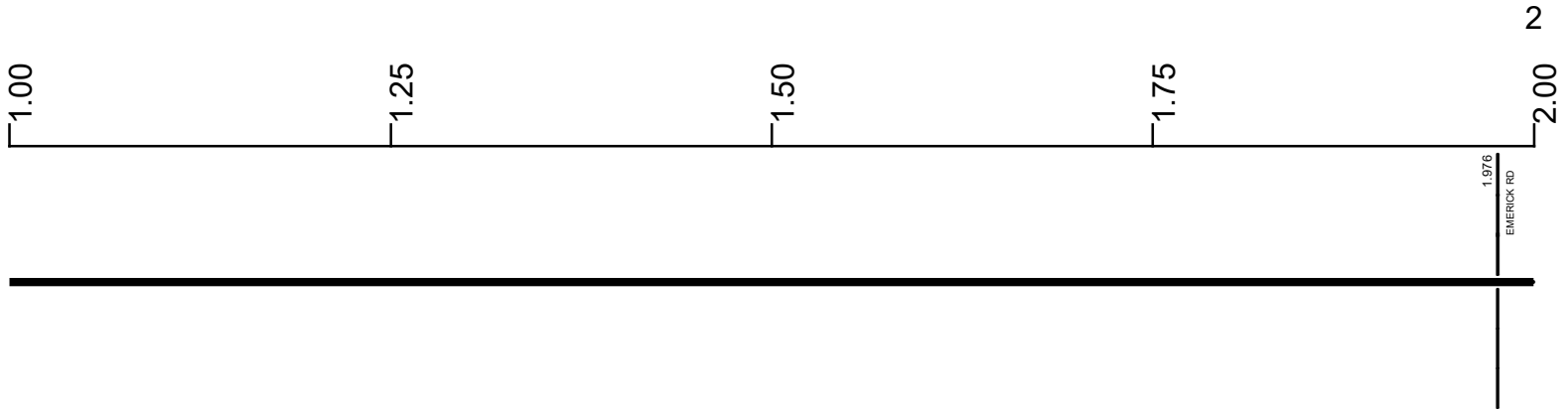

Surface Type & Width (Left / Right)

G 20'  
0 - 2.826

Base Type (Left / Right)

I  
0 - 5.777

Shoulder Type & Width (Left / Right)

5 (2/2)  
0 - 2.727

Resurface Year

2020  
0 - 2.82

Through Lanes

2  
0 - 5.777

Street Name

SR 721  
0 - 2.727

- Non-divided Highway
  Bridge (on route)
  Railroad (at grade)
  Intersection
- Divided Highway
  Underpass
  Railroad (underpass)
- Secondary Segment
  Overpass
  Railroad (overpass)
- Corporation**

Created on: 7/3/2025



transportation.ohio.gov

Prepared by  
The Ohio Department of Transportation  
Office of Technical Services  
Roadway Information

# SMIASR00721\*\*C

State True Log

County True Log

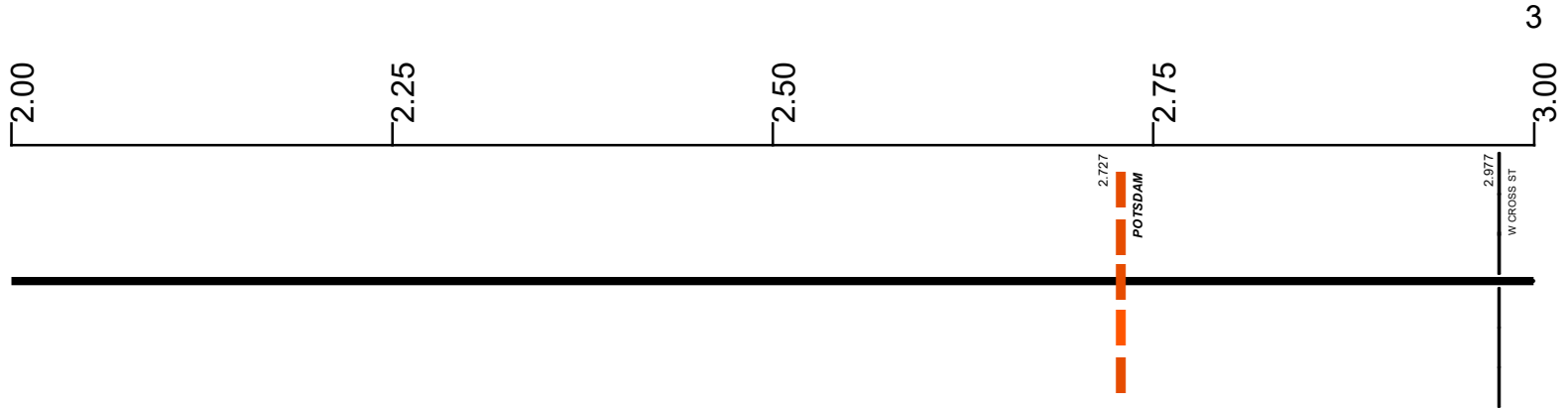

**Surface Type & Width (Left / Right)**

G 20' 0 - 2.826	G 42'	G (19'/20') 2.826 - 2.977    2.977 - 3.075
--------------------	-------	---

**Base Type (Left / Right)**

I 0 - 5.777
----------------

**Shoulder Type & Width (Left / Right)**

5 (2 1/2') 0 - 2.727	2 (4 1/4') 2.727 - 2.826	1 (0'/0') 2.826 - 3.075
-------------------------	-----------------------------	----------------------------

**Resurface Year**

2020 0 - 2.82
------------------

**Through Lanes**

2 0 - 5.777
----------------

**Street Name**

SR 721 0 - 2.727	MAIN ST 2.727 - 3.224
---------------------	--------------------------

- Non-divided Highway
- Divided Highway
- Secondary Segment
- Corporation
- Bridge (on route)
- Underpass
- Overpass
- Railroad (at grade)
- Railroad (underpass)
- Railroad (overpass)
- Intersection

Created on: 7/3/2025

transportation.ohio.gov

Prepared by  
The Ohio Department of Transportation  
Office of Technical Services  
Roadway Information

# SMIASR00721\*\*C

State True Log

County True Log

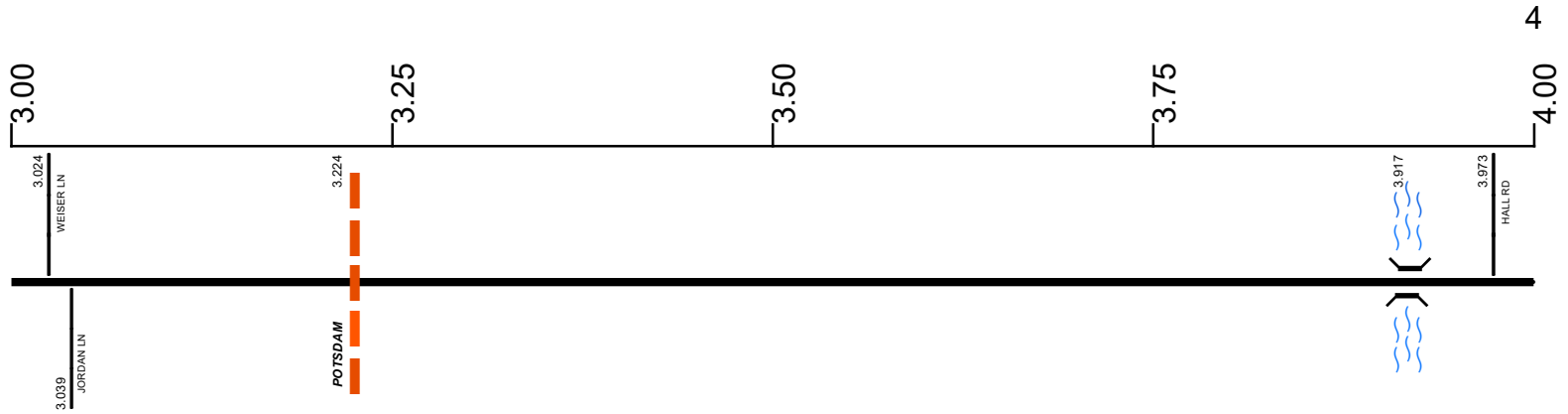

**Surface Type & Width (Left / Right)**

G (19'/20')	G 20'	G (9'/10')	G 20'
2.977 - 3.075	3.075 - 3.224	3.224 - 3.674	3.674 - 4.101

**Base Type (Left / Right)**

I
0 - 5.777

**Shoulder Type & Width (Left / Right)**

1 (0'/0')	2 (2'/2')	5 (1'/1')	5 (2'/2')
2.826 - 3.075	3.075 - 3.224	3.224 - 3.674	3.674 - 4.101

**Resurface Year**

2020
3.22 - 5.52

**Through Lanes**

2
0 - 5.777

**Street Name**

MAIN ST	SR 721
2.727 - 3.224	3.224 - 5.515

- Non-divided Highway
- Divided Highway
- Secondary Segment
- Corporation
- Bridge (on route)
- Underpass
- Overpass
- Railroad (at grade)
- Railroad (underpass)
- Railroad (overpass)
- Intersection

Created on: 7/3/2025

transportation.ohio.gov

Prepared by  
The Ohio Department of Transportation  
Office of Technical Services  
Roadway Information

# SMIASR00721\*\*C

State True Log

County True Log

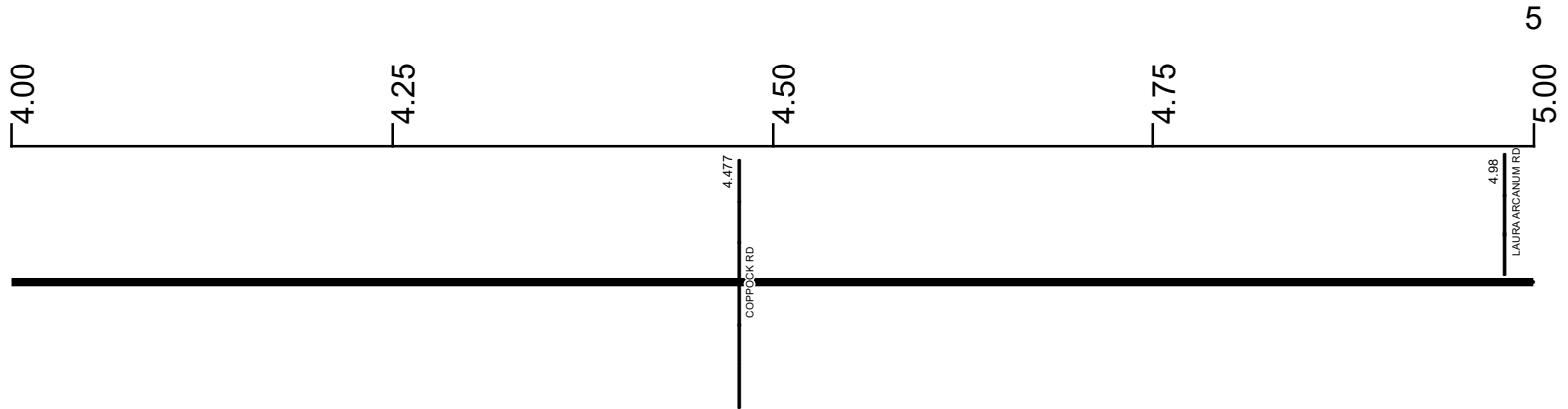

**Surface Type & Width (Left / Right)**

G 20'	G (9'/10')	G 22'
3.674 - 4.101	4.101 - 4.576	4.576 - 5.515

**Base Type (Left / Right)**

I
0 - 5.777

**Shoulder Type & Width (Left / Right)**

5 (2'/2')	5 (1'/1')	5 (2'/2')
3.674 - 4.101	4.101 - 4.576	4.576 - 5.515

**Resurface Year**

2020
3.22 - 5.52

**Through Lanes**

2
0 - 5.777

**Street Name**

SR 721
3.224 - 5.515

- |  |   |   |   |
|--|---|---|---|
| <ul style="list-style-type: none"> <li> Non-divided Highway</li> <li> Divided Highway</li> <li> Secondary Segment</li> <li> Corporation</li> </ul> | <ul style="list-style-type: none"> <li> Bridge (on route)</li> <li> Underpass</li> <li> Overpass</li> </ul> | <ul style="list-style-type: none"> <li> Railroad (at grade)</li> <li> Railroad (underpass)</li> <li> Railroad (overpass)</li> </ul> | <ul style="list-style-type: none"> <li> Intersection</li> </ul> |
|--|---|---|---|

Created on: 7/3/2025

transportation.ohio.gov

Prepared by  
The Ohio Department of Transportation  
Office of Technical Services  
Roadway Information

# SMIASR00721\*\*C

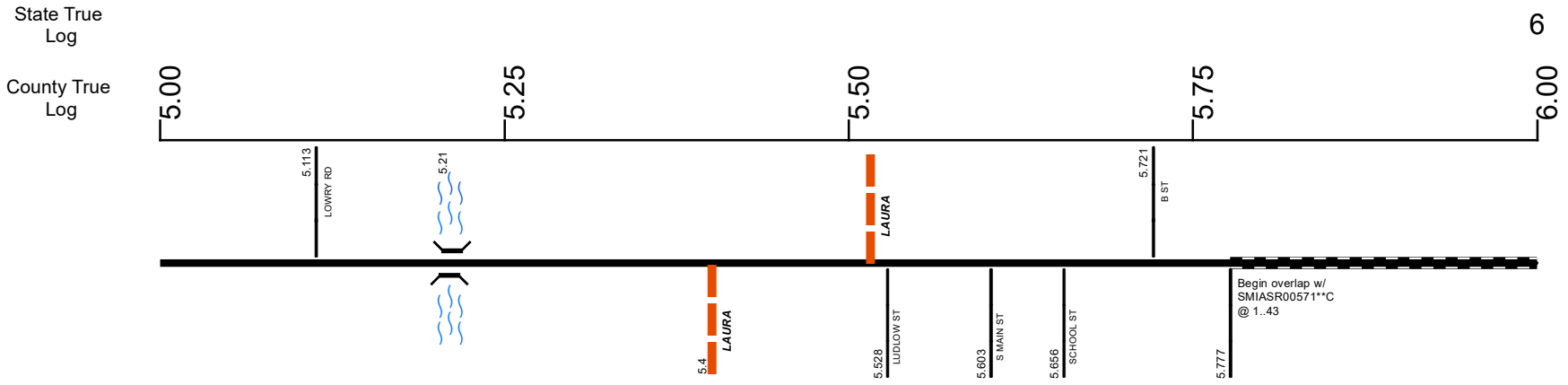

**Surface Type & Width (Left / Right)**

G 22'	G 30'	G 36'
4.576 - 5.515	5.515 - 5.601	5.601 - 5.777

**Base Type (Left / Right)**

I
0 - 5.777

**Shoulder Type & Width (Left / Right)**

5 (2'1/2')	5 (1'1/1')	1 (0'0')
4.576 - 5.515	5.515 - 5.601	5.601 - 5.777

**Resurface Year**

2020
3.22 - 5.52

**Through Lanes**

2
0 - 5.777

**Street Name**

SR 721	PIKE ST	MAIN ST
3.224 - 5.515	5.515 - 5.601	5.601 - 5.777

- Non-divided Highway
- Divided Highway
- Secondary Segment
- Corporation
- Bridge (on route)
- Underpass
- Overpass
- Railroad (at grade)
- Railroad (underpass)
- Railroad (overpass)
- Intersection

Created on: 7/3/2025

transportation.ohio.gov

Prepared by  
The Ohio Department of Transportation  
Office of Technical Services  
Roadway Information

# SMIASR00721\*\*C

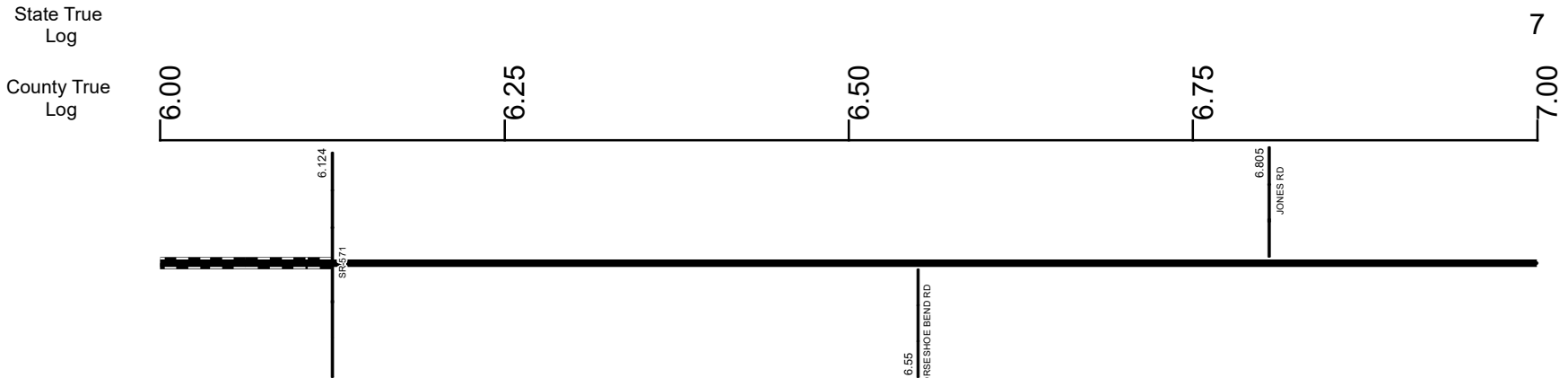

Surface Type & Width (Left / Right)	G (9'/10')
	6.124 - 9.79
Base Type (Left / Right)	I
	6.124 - 11.096
Shoulder Type & Width (Left / Right)	5 (2'/2')
	6.124 - 11.096
Through Lanes	2
	6.124 - 11.853
Street Name	SR 721
	6.124 - 11.853

- |                     |                   |                      |              |
|---------------------|-------------------|----------------------|--------------|
| Non-divided Highway | Bridge (on route) | Railroad (at grade)  | Intersection |
| Divided Highway     | Underpass         | Railroad (underpass) |              |
| Secondary Segment   | Overpass          | Railroad (overpass)  |              |
| Corporation         |                   |                      |              |

Created on: 7/3/2025

transportation.ohio.gov

Prepared by  
The Ohio Department of Transportation  
Office of Technical Services  
Roadway Information

# SMIASR00721\*\*C

State True Log

County True Log

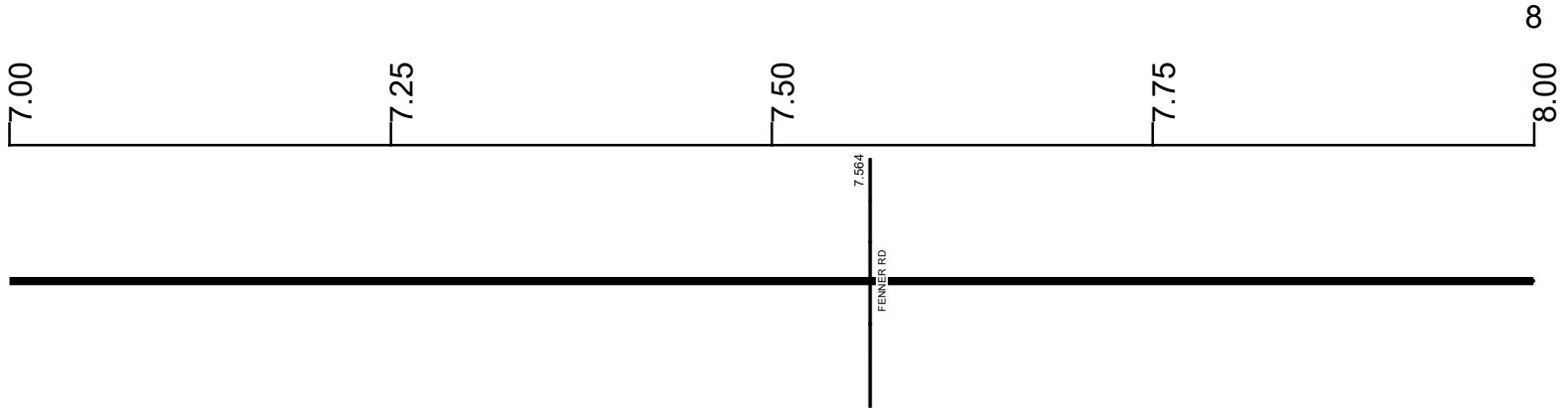

Surface Type & Width (Left / Right)

G (9'/10')  
6.124 - 9.79

Base Type (Left / Right)

I  
6.124 - 11.096

Shoulder Type & Width (Left / Right)

5 (2'/2')  
6.124 - 11.096

Through Lanes

2  
6.124 - 11.853

Street Name

SR 721  
6.124 - 11.853

- |                     |                   |                      |              |
|---------------------|-------------------|----------------------|--------------|
| Non-divided Highway | Bridge (on route) | Railroad (at grade)  | Intersection |
| Divided Highway     | Underpass         | Railroad (underpass) |              |
| Secondary Segment   | Overpass          | Railroad (overpass)  |              |
| Corporation         |                   |                      |              |

Created on: 7/3/2025



transportation.ohio.gov  
 Prepared by  
 The Ohio Department of Transportation  
 Office of Technical Services  
 Roadway Information

# SMIASR00721\*\*C

State True Log

County True Log

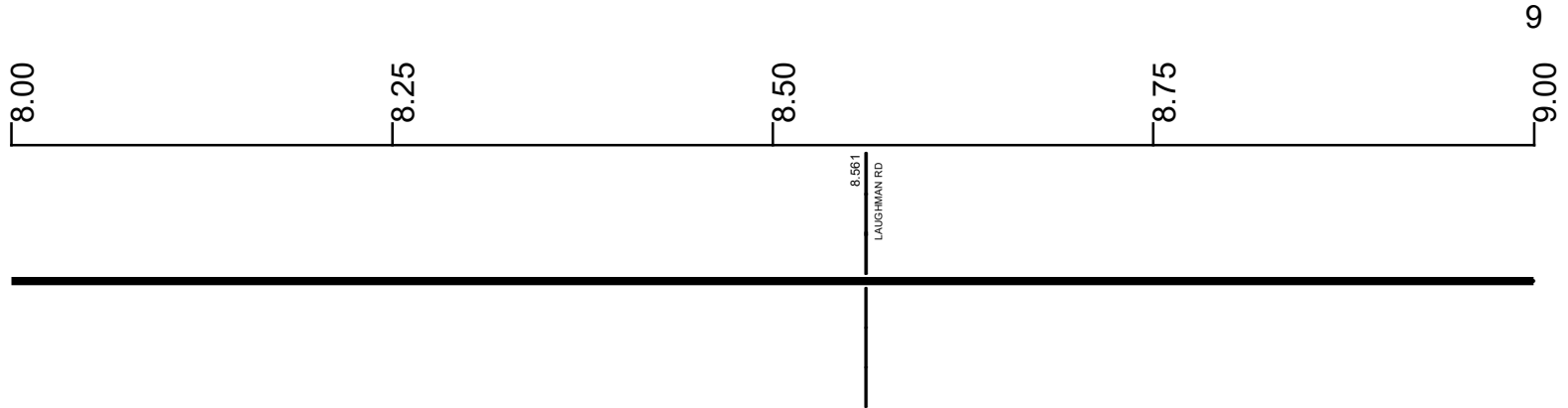

Surface Type & Width (Left / Right)

G (9'/10')  
6.124 - 9.79

Base Type (Left / Right)

I  
6.124 - 11.096

Shoulder Type & Width (Left / Right)

5 (2'/2')  
6.124 - 11.096

Through Lanes

2  
6.124 - 11.853

Street Name

SR 721  
6.124 - 11.853

- |                     |                   |                      |              |
|---------------------|-------------------|----------------------|--------------|
| Non-divided Highway | Bridge (on route) | Railroad (at grade)  | Intersection |
| Divided Highway     | Underpass         | Railroad (underpass) |              |
| Secondary Segment   | Overpass          | Railroad (overpass)  |              |
| <b>Corporation</b>  |                   |                      |              |

Created on: 7/3/2025



transportation.ohio.gov  
 Prepared by  
 The Ohio Department of Transportation  
 Office of Technical Services  
 Roadway Information

# SMIASR00721\*\*C

State True Log

County True Log

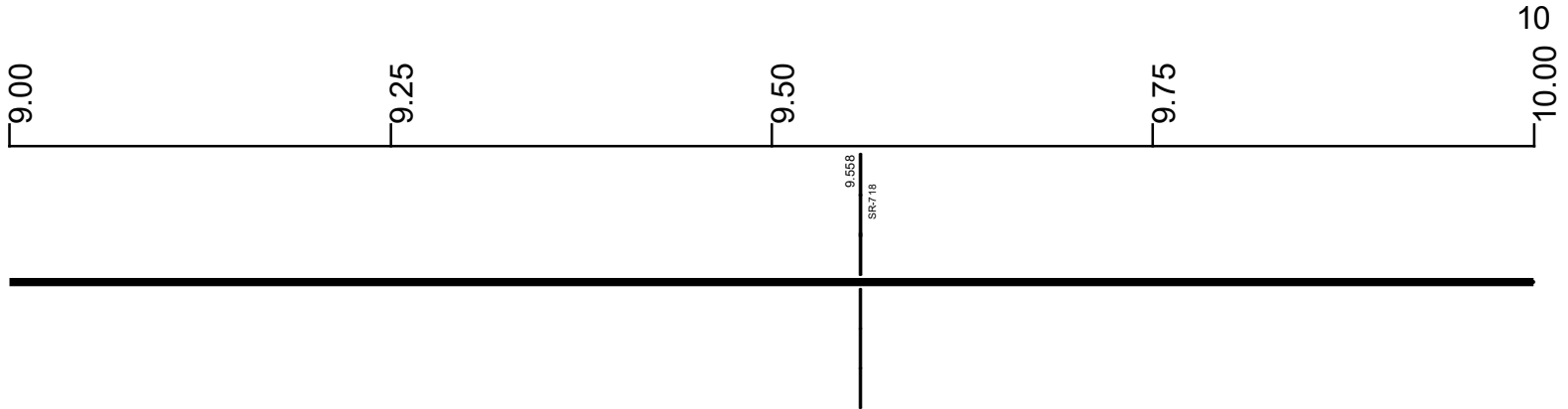

Surface Type & Width (Left / Right)

G (9'/10')	G 20'
6.124 - 9.79	9.79 - 11.096

Base Type (Left / Right)

I	
6.124 - 11.096	

Shoulder Type & Width (Left / Right)

5 (2'/2')	
6.124 - 11.096	

Through Lanes

2	
6.124 - 11.853	

Street Name

SR 721	
6.124 - 11.853	

- |  |   |   |   |
|--|---|---|---|
| <ul style="list-style-type: none"> <li> Non-divided Highway</li> <li> Divided Highway</li> <li> Secondary Segment</li> <li> Corporation</li> </ul> | <ul style="list-style-type: none"> <li> Bridge (on route)</li> <li> Underpass</li> <li> Overpass</li> </ul> | <ul style="list-style-type: none"> <li> Railroad (at grade)</li> <li> Railroad (underpass)</li> <li> Railroad (overpass)</li> </ul> | <ul style="list-style-type: none"> <li> Intersection</li> </ul> |
|--|---|---|---|

Created on: 7/3/2025

transportation.ohio.gov

Prepared by  
The Ohio Department of Transportation  
Office of Technical Services  
Roadway Information

# SMIASR00721\*\*C

State True Log  
County True Log

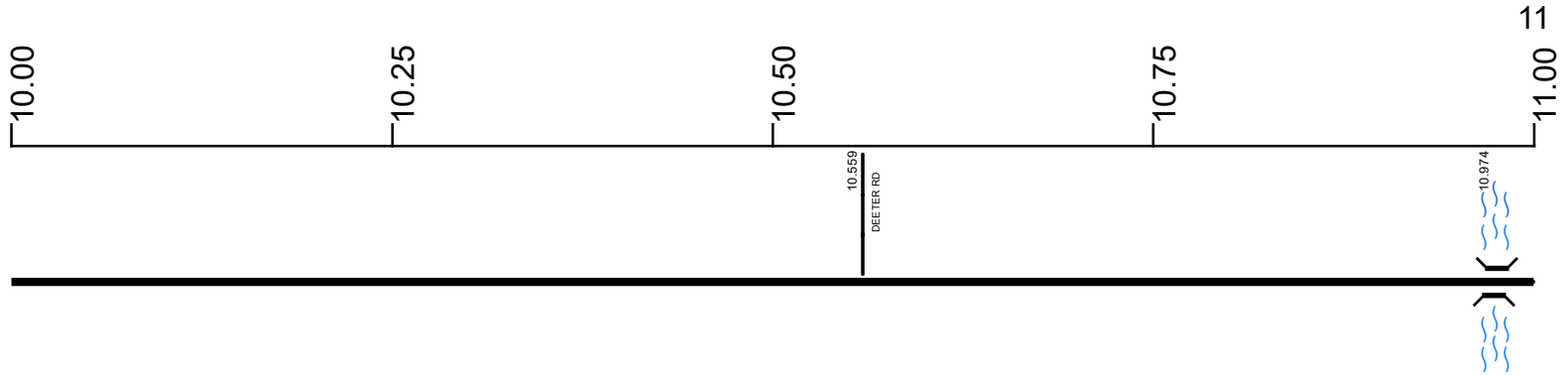

Surface Type & Width (Left / Right)

G 20'  
9.79 - 11.096

Base Type (Left / Right)

I  
6.124 - 11.096

Shoulder Type & Width (Left / Right)

5 (2/2)  
6.124 - 11.096

Through Lanes

2  
6.124 - 11.853

Street Name

SR 721  
6.124 - 11.853

- Non-divided Highway
  Bridge (on route)
  Railroad (at grade)
  Intersection
- Divided Highway
  Underpass
  Railroad (underpass)
- Secondary Segment
  Overpass
  Railroad (overpass)
- Corporation**

Created on: 7/3/2025



transportation.ohio.gov

Prepared by  
The Ohio Department of Transportation  
Office of Technical Services  
Roadway Information

# SMIASR00721\*\*C

State True  
Log

11.853

County True  
Log

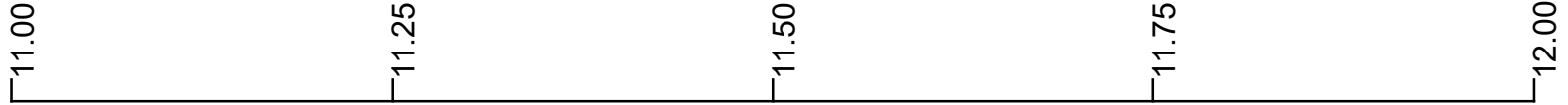

**Surface Type & Width (Left / Right)**

G 20'	G (20'/4')	G 20'
9.79 - 11.096	11.096 - 11.435	11.435 - 11.853

**Base Type (Left / Right)**

I	I / L	I
6.124 - 11.096	11.096 - 11.435	11.435 - 11.853

**Shoulder Type & Width (Left / Right)**

5 (2'/2')	5 (1'/1')	5 (2'/2')
6.124 - 11.096	11.096 - 11.435	11.435 - 11.853

**Through Lanes**

	2	
	6.124 - 11.853	

**Street Name**

	SR 721	
	6.124 - 11.853	

- Non-divided Highway
  Bridge (on route)
  Railroad (at grade)
  Intersection
- Divided Highway
  Underpass
  Railroad (underpass)
- Secondary Segment
  Overpass
  Railroad (overpass)
- Corporation**

Created on: 7/3/2025

transportation.ohio.gov

Prepared by  
The Ohio Department of Transportation  
Office of Technical Services  
Roadway Information

## Historical Project List for SMIASR00721\*\*C

Begin Measure	End Measure	Project ID Number	Construction Completion Date	Treatment Category	Treatment Type
0.000	2.819	105358	11-2020	Preventive Maintenance	25-Chip Seal
0.000	2.739	83896	8-2010	Minor Rehabilitation	60-AC Overlay w/Rpr
2.739	3.078	84935	11-2009	Major Rehabilitation	100-New Flexible Pvmt
3.208	5.507	83896	8-2010	Minor Rehabilitation	60-AC Overlay w/Rpr
3.218	5.517	105358	11-2020	Preventive Maintenance	25-Chip Seal
5.507	5.777	25112	5-2010	Major Rehabilitation	100-New Flexible Pvmt
6.124	11.853	25000	6-2006	Minor Rehabilitation	60-AC Overlay w/Rpr

# Roadway Codes

## Access Control Journalized

- F - Full Access Control
- L - Limited Access Control
- N - No Access Control

## Access Control Operational

- 1 - Full Access Control
- 2 - Partial Access Control
- 3 - No Access Control

## Base Type

- F - Crack and Seat
- H - Rubblize and Roll
- I - Aggregate Base 304 or Traffic Compacted
- K - Water Bound Macadam
- L - Bituminous Concrete Mix or Penetration Macadam
- N - Plain Concrete
- P - Reinforced Concrete
- R - Brick (Flexible)
- T - Brick (Rigid)

## Direction of Travel

- B - Both (Two-way)
- F - One-way Cardinal
- T - One-way Non-cardinal

## Facility Type

- 1 - One-way Roadway
- 2 - Two-way Roadway
- 4 - Ramp
- 5 - Non-mainline
- 6 - Non-inventory Direction
- 7 - Planned / Unbuilt

## Historical Federal Aid Indicator

- N - Not a FAP Route
- Y - FAP Route

## Functional Classification

- 01 - Interstate
- 02 - Principal Arterial (Freeways)
- 03 - Principal Arterial (Other)
- 04 - Minor Arterial
- 05 - Major Collector
- 06 - Minor Collector
- 07 - Local

## Leave / Reenter Indicator

- Y - Route leaves/reenters at this point
- N - Route does not leave/reenter at this point

## Median Type

- 1 - None
- 2 - Unprotected
- 3 - Curbed
- 4 - Positive Barrier (Unspecified)
- 5 - Positive Barrier (Flexible)
- 6 - Positive Barrier (Semi-rigid)
- 7 - Positive Barrier (Rigid)

## NHS

- N - National Highway System
- H - Congressional Corridor
- 2 - Major Airport
- 3 - Major Port Facility
- 4 - Major Amtrak Station
- 5 - Major Rail / Truck Terminal
- 6 - Major Intercity Bus Terminal
- 7 - Major Public Transit / Multi-modal Passenger Terminal
- 8 - Major Pipeline Terminal
- 9 - Major Ferry Terminal

## Priority System

- G - General
- P - Priority System
- U - Urban

## Scenic Byway Code

- A - All American Road
- N - National Scenic Byway
- S - State Scenic Byway

## Shoulder Type

- 1 - None
- 2 - Surfaced shoulder exists (bituminous concrete {AC})
- 3 - Surfaced shoulder exists (Portland Cement Concrete {PCC})
- 4 - Stabilized shoulder exists (gravel or other granular material)
- 5 - Combination shoulder exists (two or more surface types)
- 6 - Earth shoulder exists
- 7 - Barrier curb exists; no shoulder in front of curb

## Surface Type

- A - Combination
- B - Brick
- C - Continuous Reinforced Concrete
- D - Reinforced Concrete
- E - Plain Concrete
- G - Bituminous Concrete
- I - Chipseal on Granular
- K - Open Graded Bituminous
- L - Chipseal or Micro
- M - Gravel
- U - Unimproved
- X - Right of Way Only