

# SMOESR00145\*\*C

State True Log 15.576

16.576

County True Log

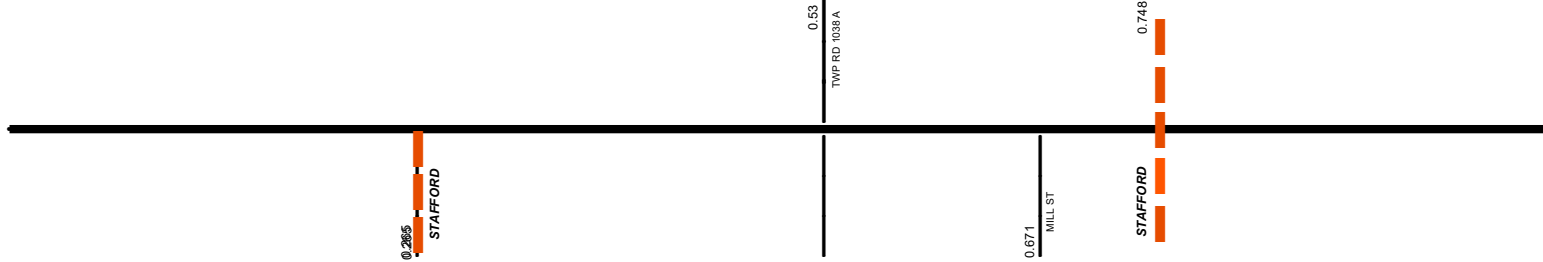

**Surface Type & Width (Left / Right)**

G 20'	G (9/10')
0 - 0.778	0.778 - 4.82

**Base Type (Left / Right)**

I	L	I
0 - 0.265	0.265 - 0.778	0.778 - 7.355

**Shoulder Type & Width (Left / Right)**

2 (2/2')	2 (3/3')	2 (2/2')
0 - 0.265	0.265 - 0.739	0.739 - 8.296

**Through Lanes**

2
0 - 21.396

**Street Name**

SR 145
0 - 20.411

- Non-divided Highway
- Divided Highway
- Secondary Segment
- Corporation
- Bridge (on route)
- Underpass
- Overpass
- Railroad (at grade)
- Railroad (underpass)
- Railroad (overpass)
- Intersection

Created on: 7/3/2025

transportation.ohio.gov

Prepared by  
The Ohio Department of Transportation  
Office of Technical Services  
Roadway Information

# SMOESR00145\*\*C

State True Log

17.576

County True Log

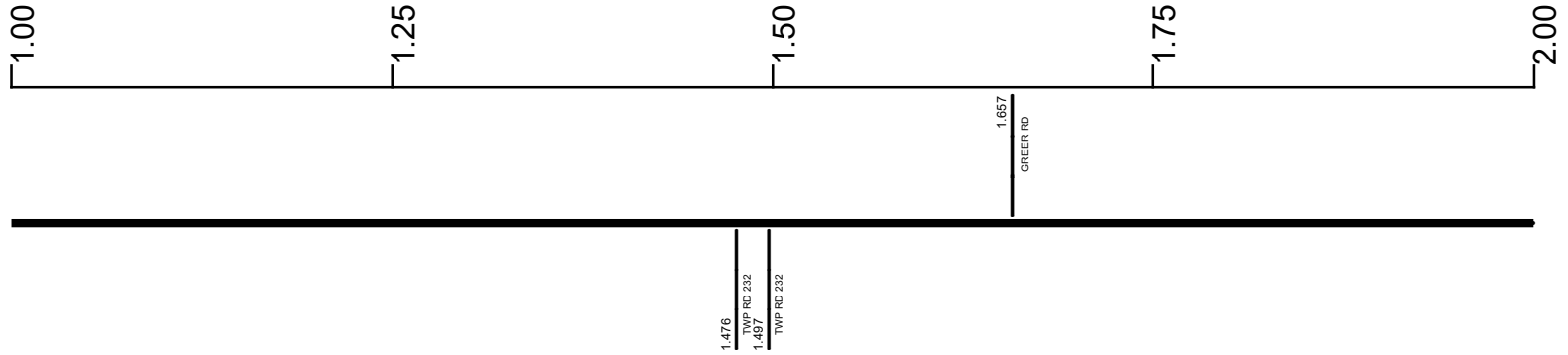

Surface Type & Width (Left / Right)

G (9'/10')  
0.778 - 4.82

Base Type (Left / Right)

I  
0.778 - 7.355

Shoulder Type & Width (Left / Right)

2 (2'/2')  
0.739 - 8.296

Through Lanes

2  
0 - 21.396

Street Name

SR 145  
0 - 20.411

- |                     |                   |                      |              |
|---------------------|-------------------|----------------------|--------------|
| Non-divided Highway | Bridge (on route) | Railroad (at grade)  | Intersection |
| Divided Highway     | Underpass         | Railroad (underpass) |              |
| Secondary Segment   | Overpass          | Railroad (overpass)  |              |
| Corporation         |                   |                      |              |

Created on: 7/3/2025

transportation.ohio.gov

Prepared by  
The Ohio Department of Transportation  
Office of Technical Services  
Roadway Information

# SMOESR00145\*\*C

State True Log

18.576

County True Log

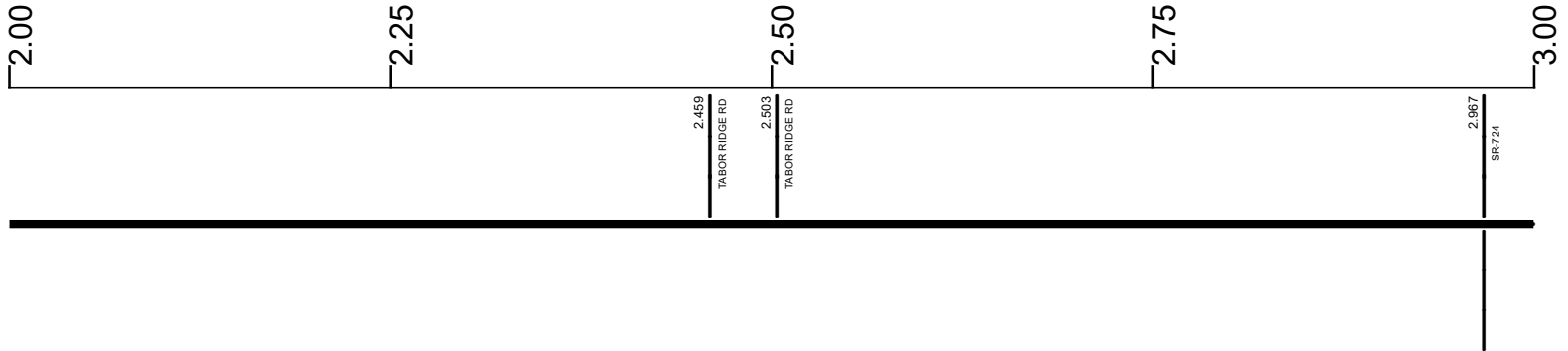

Surface Type & Width (Left / Right)

G (9'/10')  
0.778 - 4.82

Base Type (Left / Right)

I  
0.778 - 7.355

Shoulder Type & Width (Left / Right)

2 (2'/2')  
0.739 - 8.296

Through Lanes

2  
0 - 21.396

Street Name

SR 145  
0 - 20.411

- |                     |                   |                      |              |
|---------------------|-------------------|----------------------|--------------|
| Non-divided Highway | Bridge (on route) | Railroad (at grade)  | Intersection |
| Divided Highway     | Underpass         | Railroad (underpass) |              |
| Secondary Segment   | Overpass          | Railroad (overpass)  |              |
| <b>Corporation</b>  |                   |                      |              |

Created on: 7/3/2025

transportation.ohio.gov

Prepared by  
The Ohio Department of Transportation  
Office of Technical Services  
Roadway Information

# SMOESR00145\*\*C

State True Log

19.576

County True Log

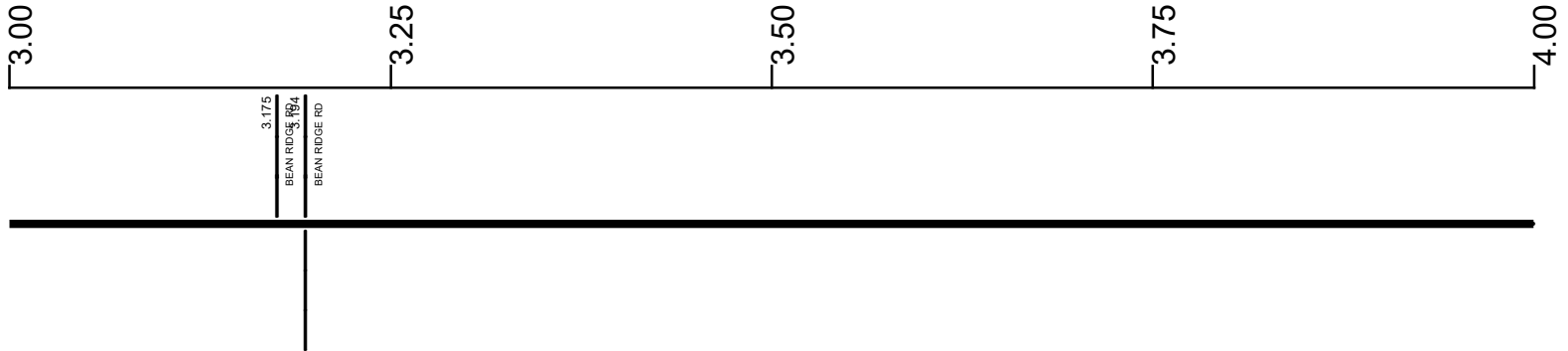

Surface Type & Width (Left / Right)

G (9'/10')  
0.778 - 4.82

Base Type (Left / Right)

I  
0.778 - 7.355

Shoulder Type & Width (Left / Right)

2 (2'/2')  
0.739 - 8.296

Through Lanes

2  
0 - 21.396

Street Name

SR 145  
0 - 20.411

- Non-divided Highway
  Bridge (on route)
  Railroad (at grade)
  Intersection
- Divided Highway
  Underpass
  Railroad (underpass)
- Secondary Segment
  Overpass
  Railroad (overpass)
- Corporation**

Created on: 7/3/2025

transportation.ohio.gov

Prepared by  
The Ohio Department of Transportation  
Office of Technical Services  
Roadway Information

# SMOESR00145\*\*C

State True Log

20.576

County True Log

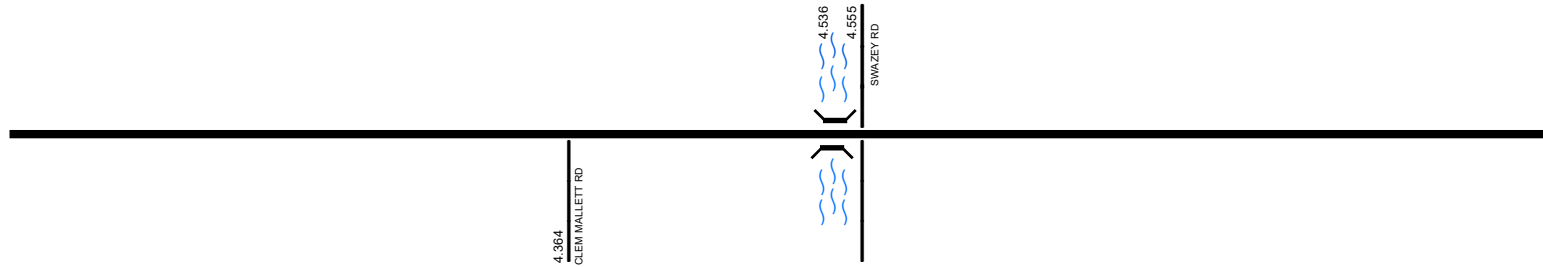

Surface Type & Width (Left / Right)	G (9/10') 0.778 - 4.82	G 20' 4.82 - 7.355
Base Type (Left / Right)	I 0.778 - 7.355	
Shoulder Type & Width (Left / Right)	2 (2/2) 0.739 - 8.296	
Through Lanes	2 0 - 21.396	
Street Name	SR 145 0 - 20.411	

<ul style="list-style-type: none"> <li> Non-divided Highway</li> <li> Divided Highway</li> <li> Secondary Segment</li> <li> <b>Corporation</b></li> </ul>	<ul style="list-style-type: none"> <li> Bridge (on route)</li> <li> Underpass</li> <li> Overpass</li> </ul>	<ul style="list-style-type: none"> <li> Railroad (at grade)</li> <li> Railroad (underpass)</li> <li> Railroad (overpass)</li> </ul>	<ul style="list-style-type: none"> <li> Intersection</li> </ul>
---	---	---	---

Created on: 7/3/2025

transportation.ohio.gov

Prepared by  
The Ohio Department of Transportation  
Office of Technical Services  
Roadway Information

# SMOESR00145\*\*C

State True Log

21.576

County True Log



Surface Type & Width (Left / Right)

G 20'  
4.82 - 7.355

Base Type (Left / Right)

I  
0.778 - 7.355

Shoulder Type & Width (Left / Right)

2 (2/2)  
0.739 - 8.296

Through Lanes

2  
0 - 21.396

Street Name

SR 145  
0 - 20.411

- |                     |                   |                      |              |
|---------------------|-------------------|----------------------|--------------|
| Non-divided Highway | Bridge (on route) | Railroad (at grade)  | Intersection |
| Divided Highway     | Underpass         | Railroad (underpass) |              |
| Secondary Segment   | Overpass          | Railroad (overpass)  |              |
| <b>Corporation</b>  |                   |                      |              |

Created on: 7/3/2025

transportation.ohio.gov

Prepared by  
The Ohio Department of Transportation  
Office of Technical Services  
Roadway Information

# SMOESR00145\*\*C

State True Log

22.576

County True Log

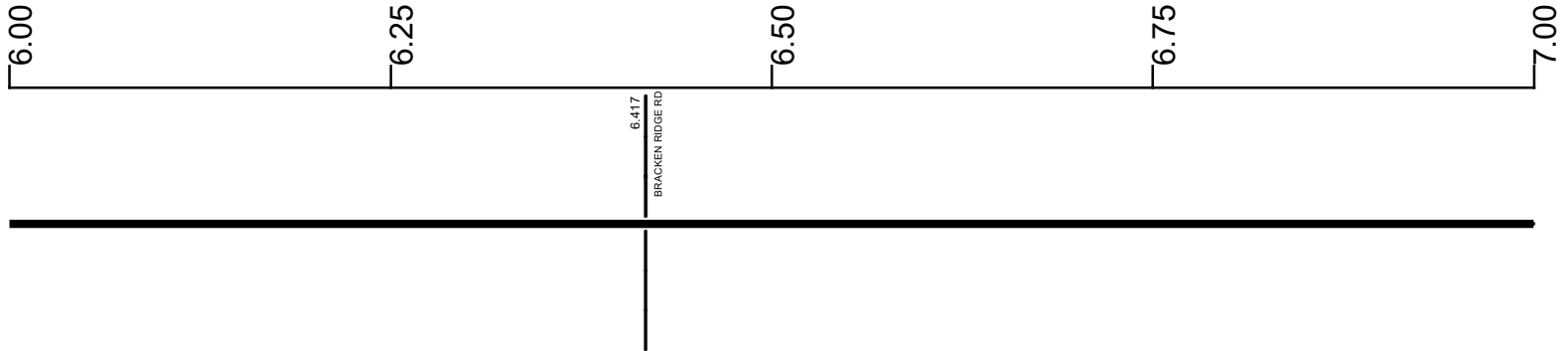

Surface Type & Width (Left / Right)

G 20'  
4.82 - 7.355

Base Type (Left / Right)

I  
0.778 - 7.355

Shoulder Type & Width (Left / Right)

2 (2/2)  
0.739 - 8.296

Through Lanes

2  
0 - 21.396

Street Name

SR 145  
0 - 20.411

- |                     |                   |                      |              |
|---------------------|-------------------|----------------------|--------------|
| Non-divided Highway | Bridge (on route) | Railroad (at grade)  | Intersection |
| Divided Highway     | Underpass         | Railroad (underpass) |              |
| Secondary Segment   | Overpass          | Railroad (overpass)  |              |
| Corporation         |                   |                      |              |

Created on: 7/3/2025

transportation.ohio.gov

Prepared by  
The Ohio Department of Transportation  
Office of Technical Services  
Roadway Information

# SMOESR00145\*\*C

State True Log

23.576

County True Log



**Surface Type & Width (Left / Right)**

G 20' 4.82 - 7.355	G (15/6') 7.355 - 8.296
-----------------------	----------------------------

**Base Type (Left / Right)**

I 0.778 - 7.355	R / I 7.355 - 8.296
--------------------	------------------------

**Shoulder Type & Width (Left / Right)**

2 (2/2') 0.739 - 8.296	
---------------------------	--

**Through Lanes**

2 0 - 21.396	
-----------------	--

**Street Name**

SR 145 0 - 20.411	
----------------------	--

- |                     |                   |                      |              |
|---------------------|-------------------|----------------------|--------------|
| Non-divided Highway | Bridge (on route) | Railroad (at grade)  | Intersection |
| Divided Highway     | Underpass         | Railroad (underpass) |              |
| Secondary Segment   | Overpass          | Railroad (overpass)  |              |
| Corporation         |                   |                      |              |

Created on: 7/3/2025

transportation.ohio.gov

Prepared by  
The Ohio Department of Transportation  
Office of Technical Services  
Roadway Information

# SMOESR00145\*\*C

State True Log

24.576

County True Log

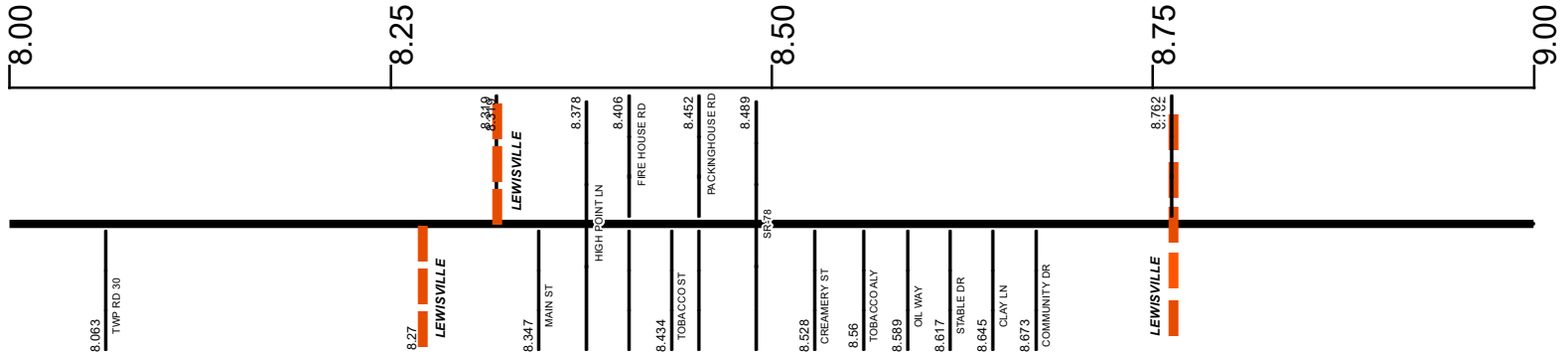

**Surface Type & Width (Left / Right)**

G (15'6")	G 24'	G 20'	G 18'
7.355 - 8.296	8.296 - 8.489	8.489 - 8.762	8.762 - 15.346

**Base Type (Left / Right)**

R / I	R	I
7.355 - 8.296	8.296 - 8.489	8.489 - 15.17

**Shoulder Type & Width (Left / Right)**

2 (2'2")	2 (6'6")	2 (2'2")	4 (0'0")
0.739 - 8.296	8.296 - 8.489	8.489 - 8.762	8.762 - 15.17

**Through Lanes**

2
0 - 21.396

**Street Name**

SR 145
0 - 20.411

- Non-divided Highway
- Divided Highway
- Secondary Segment
- Corporation
- Bridge (on route)
- Underpass
- Overpass
- Railroad (at grade)
- Railroad (underpass)
- Railroad (overpass)
- Intersection

Created on: 7/3/2025

transportation.ohio.gov

Prepared by  
The Ohio Department of Transportation  
Office of Technical Services  
Roadway Information

# SMOESR00145\*\*C

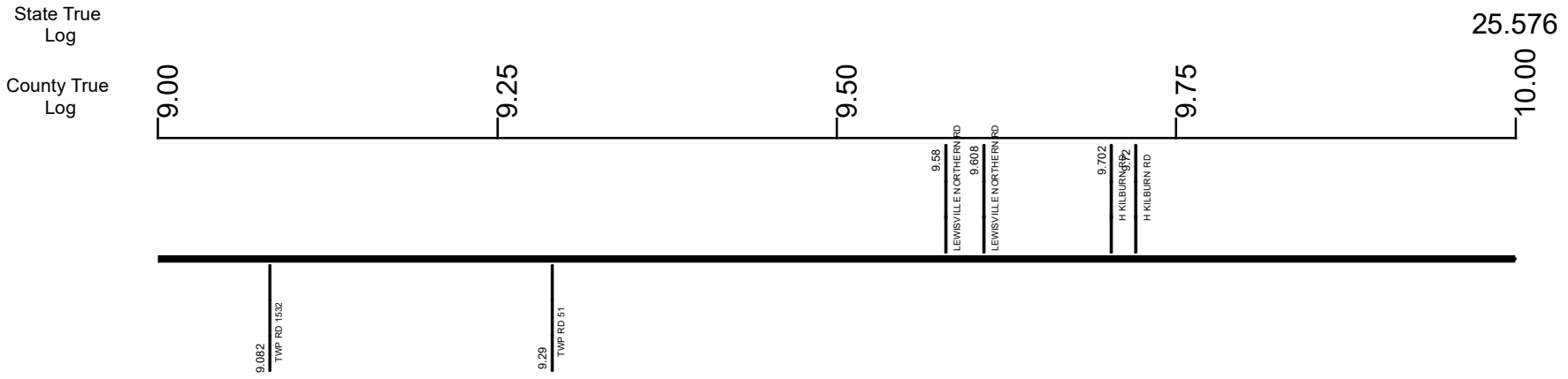

Surface Type & Width (Left / Right)	G 18' 8.762 - 15.346
Base Type (Left / Right)	I 8.489 - 15.17
Shoulder Type & Width (Left / Right)	4 (0'/0') 8.762 - 15.17
Through Lanes	2 0 - 21.396
Street Name	SR 145 0 - 20.411

Non-divided Highway	Bridge (on route)	Railroad (at grade)	Intersection
Divided Highway	Underpass	Railroad (underpass)	
Secondary Segment	Overpass	Railroad (overpass)	
Corporation			

Created on: 7/3/2025



transportation.ohio.gov

Prepared by  
The Ohio Department of Transportation  
Office of Technical Services  
Roadway Information

# SMOESR00145\*\*C

State True Log

26.576

County True Log

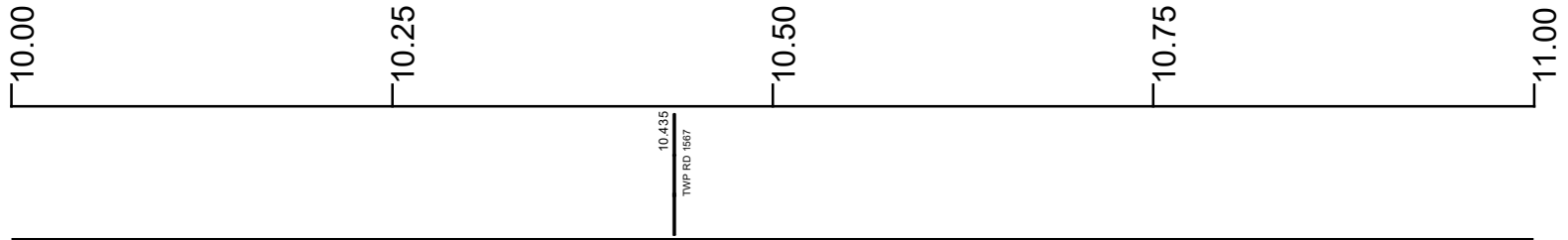

Surface Type & Width (Left / Right)

G 18'  
8.762 - 15.346

Base Type (Left / Right)

I  
8.489 - 15.17

Shoulder Type & Width (Left / Right)

4 (0/0)  
8.762 - 15.17

Through Lanes

2  
0 - 21.396

Street Name

SR 145  
0 - 20.411

- |                     |                   |                      |              |
|---------------------|-------------------|----------------------|--------------|
| Non-divided Highway | Bridge (on route) | Railroad (at grade)  | Intersection |
| Divided Highway     | Underpass         | Railroad (underpass) |              |
| Secondary Segment   | Overpass          | Railroad (overpass)  |              |
| Corporation         |                   |                      |              |

Created on: 7/3/2025

# SMOESR00145\*\*C

State True Log

27.576

County True Log

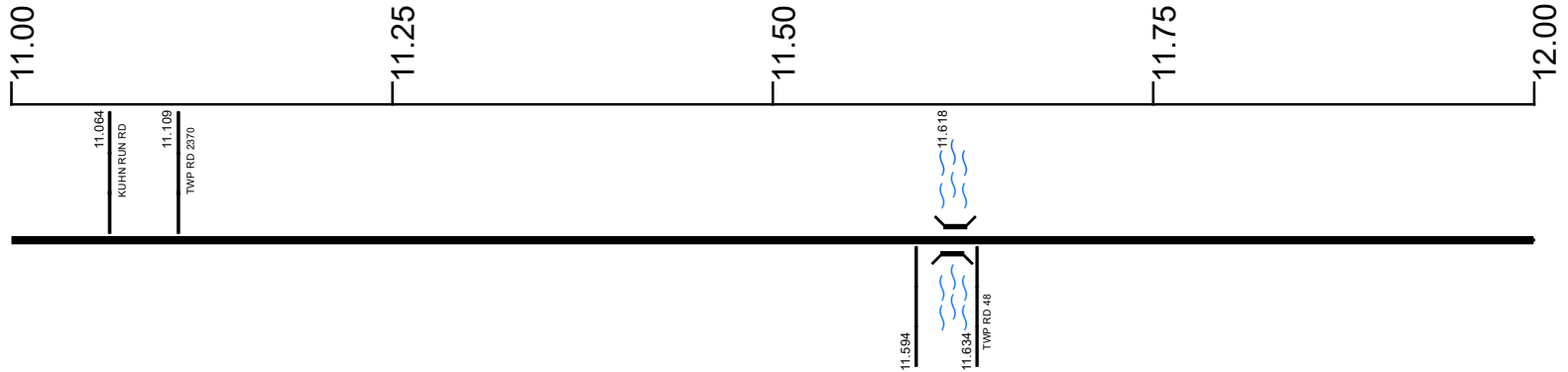

Surface Type & Width (Left / Right)

G 18'  
8.762 - 15.346

Base Type (Left / Right)

I  
8.489 - 15.17

Shoulder Type & Width (Left / Right)

4 (0/0)  
8.762 - 15.17

Through Lanes

2  
0 - 21.396

Street Name

SR 145  
0 - 20.411

- |                     |                   |                      |              |
|---------------------|-------------------|----------------------|--------------|
| Non-divided Highway | Bridge (on route) | Railroad (at grade)  | Intersection |
| Divided Highway     | Underpass         | Railroad (underpass) |              |
| Secondary Segment   | Overpass          | Railroad (overpass)  |              |
| Corporation         |                   |                      |              |

Created on: 7/3/2025

transportation.ohio.gov

Prepared by  
The Ohio Department of Transportation  
Office of Technical Services  
Roadway Information

# SMOESR00145\*\*C

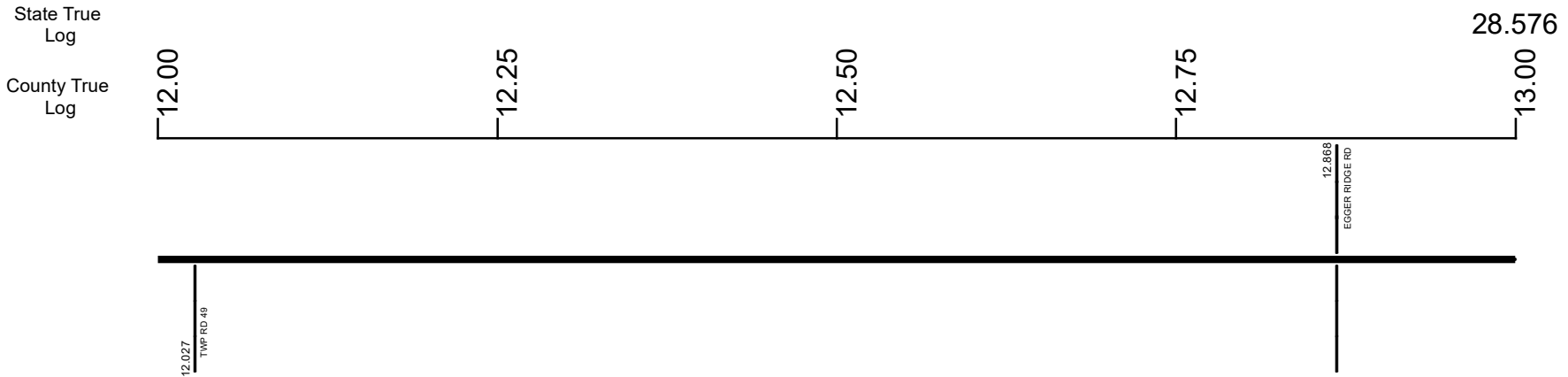

Surface Type & Width (Left / Right)	G 18' 8.762 - 15.346
Base Type (Left / Right)	I 8.489 - 15.17
Shoulder Type & Width (Left / Right)	4 (0'/0') 8.762 - 15.17
Through Lanes	2 0 - 21.396
Street Name	SR 145 0 - 20.411

- Non-divided Highway
- Divided Highway
- Secondary Segment
- Corporation
- Bridge (on route)
- Underpass
- Overpass
- Railroad (at grade)
- Railroad (underpass)
- Railroad (overpass)
- Intersection

Created on: 7/3/2025

transportation.ohio.gov  
Prepared by  
The Ohio Department of Transportation  
Office of Technical Services  
Roadway Information

# SMOESR00145\*\*C

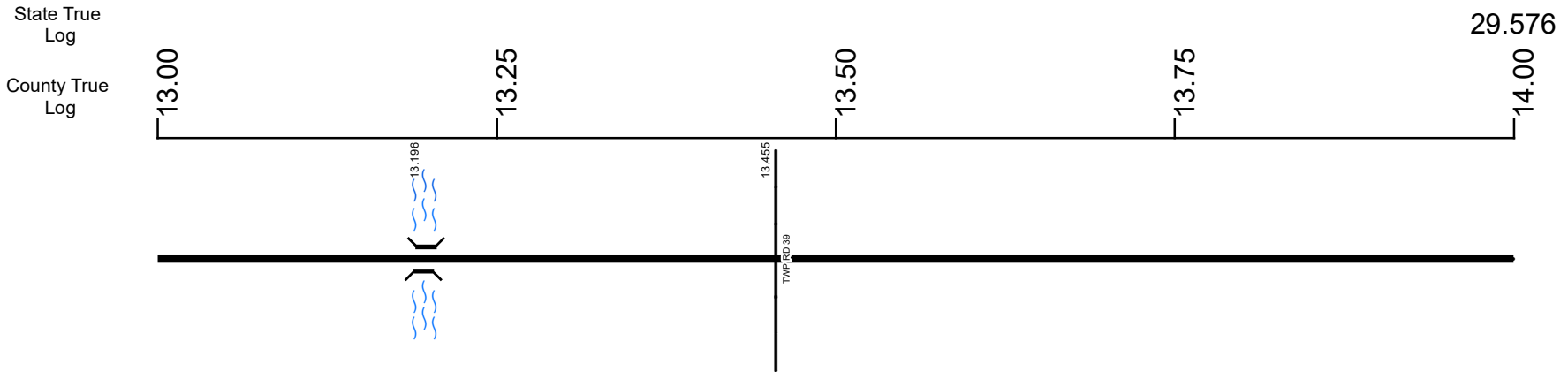

Surface Type & Width (Left / Right)	G 18'
	8.762 - 15.346
Base Type (Left / Right)	I
	8.489 - 15.17
Shoulder Type & Width (Left / Right)	4 (0'/0')
	8.762 - 15.17
Through Lanes	2
	0 - 21.396
Street Name	SR 145
	0 - 20.411

Non-divided Highway	Bridge (on route)	Railroad (at grade)	Intersection
Divided Highway	Underpass	Railroad (underpass)	
Secondary Segment	Overpass	Railroad (overpass)	
Corporation			

Created on: 7/3/2025



transportation.ohio.gov  
 Prepared by  
 The Ohio Department of Transportation  
 Office of Technical Services  
 Roadway Information

# SMOESR00145\*\*C

State True  
Log

30.576

County True  
Log

14.00

14.25

14.50

14.75

15.00

14.443  
TWP RD 2052

14.473  
TWP RD 2052

14.829  
KEYLOR HILL RD

Surface Type & Width (Left / Right)

G 18'  
8.762 - 15.346

Base Type (Left / Right)

I  
8.489 - 15.17

Shoulder Type & Width (Left / Right)

4 (0/0)  
8.762 - 15.17

Through Lanes

2  
0 - 21.396

Street Name

SR 145  
0 - 20.411

- |                     |                   |                      |              |
|---------------------|-------------------|----------------------|--------------|
| Non-divided Highway | Bridge (on route) | Railroad (at grade)  | Intersection |
| Divided Highway     | Underpass         | Railroad (underpass) |              |
| Secondary Segment   | Overpass          | Railroad (overpass)  |              |
| Corporation         |                   |                      |              |

Created on: 7/3/2025

# SMOESR00145\*\*C

State True Log  
County True Log

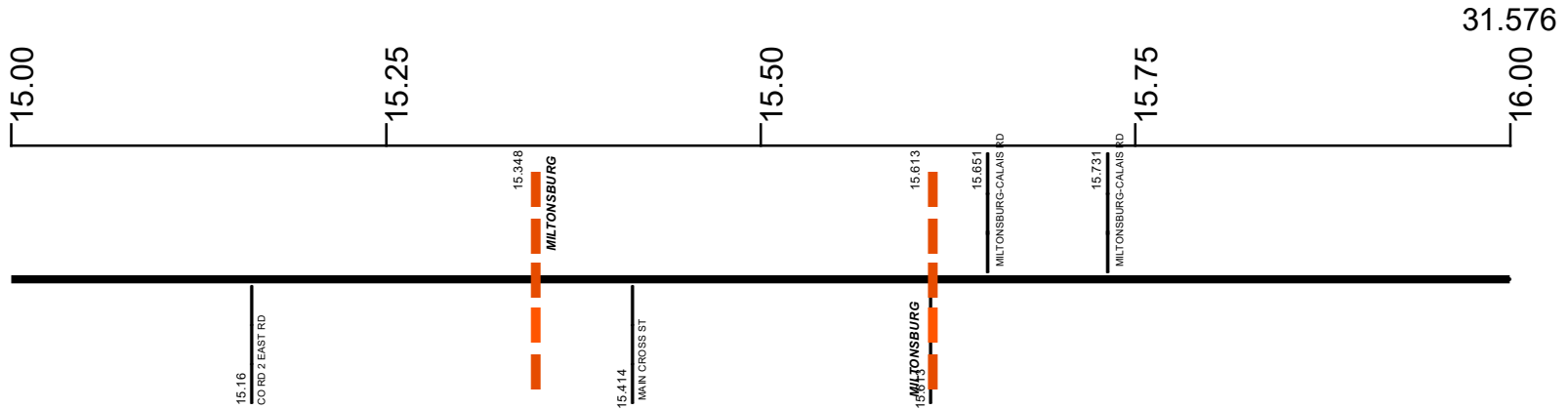

**Surface Type & Width (Left / Right)**

G 18' 8.762 - 15.346	G 20' 15.346 - 20.407
-------------------------	--------------------------

**Base Type (Left / Right)**

I 8.489 - 15.17	K 15.17 - 15.613	I 15.613 - 21.396
--------------------	---------------------	----------------------

**Shoulder Type & Width (Left / Right)**

4 (0'/0') 8.762 - 15.17	5 (1'/1') 15.17 - 15.613	4 (0'/0') 15.613 - 17.856
----------------------------	-----------------------------	------------------------------

**Through Lanes**

2 0 - 21.396
-----------------

**Street Name**

SR 145 0 - 20.411
----------------------

- Non-divided Highway
- Divided Highway
- Secondary Segment
- Corporation
- Bridge (on route)
- Underpass
- Overpass
- Railroad (at grade)
- Railroad (underpass)
- Railroad (overpass)
- Intersection

Created on: 7/3/2025

transportation.ohio.gov  
Prepared by  
The Ohio Department of Transportation  
Office of Technical Services  
Roadway Information

# SMOESR00145\*\*C

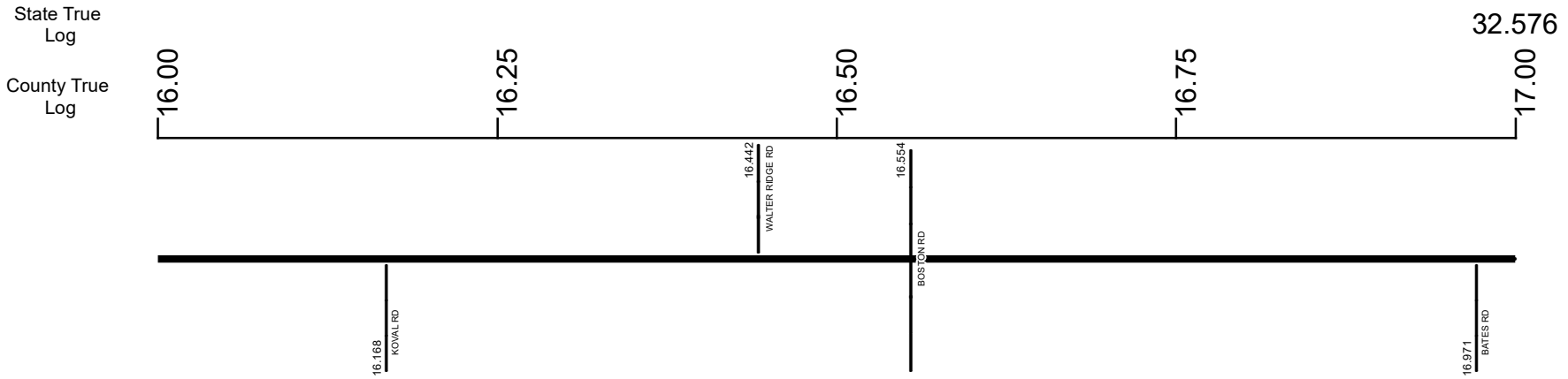

Surface Type & Width (Left / Right)	G 20'
	15.346 - 20.407
Base Type (Left / Right)	I
	15.613 - 21.396
Shoulder Type & Width (Left / Right)	4 (0'/0')
	15.613 - 17.856
Through Lanes	2
	0 - 21.396
Street Name	SR 145
	0 - 20.411

	Non-divided Highway		Bridge (on route)		Railroad (at grade)		Intersection
	Divided Highway		Underpass		Railroad (underpass)		
	Secondary Segment		Overpass		Railroad (overpass)		
	<b>Corporation</b>						

Created on: 7/3/2025

transportation.ohio.gov

Prepared by  
The Ohio Department of Transportation  
Office of Technical Services  
Roadway Information

# SMOESR00145\*\*C

State True Log  
County True Log

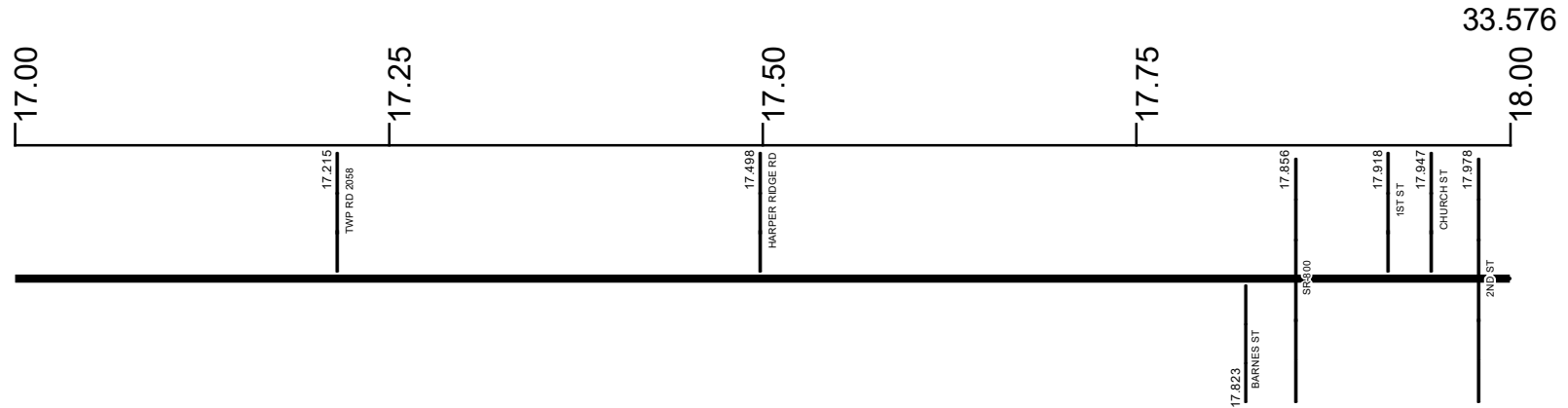

**Surface Type & Width (Left / Right)**

	G 20'
	15.346 - 20.407

**Base Type (Left / Right)**

	I
	15.613 - 21.396

**Shoulder Type & Width (Left / Right)**

4 (0'/0')	2 (2'/2')
15.613 - 17.856	17.856 - 20.407

**Through Lanes**

2
0 - 21.396

**Street Name**

	SR 145
	0 - 20.411

- Non-divided Highway
- Divided Highway
- Secondary Segment
- Corporation
- Bridge (on route)
- Underpass
- Overpass
- Railroad (at grade)
- Railroad (underpass)
- Railroad (overpass)
- Intersection

Created on: 7/3/2025

transportation.ohio.gov

Prepared by  
The Ohio Department of Transportation  
Office of Technical Services  
Roadway Information

# SMOESR00145\*\*C

State True Log

34.576

County True Log

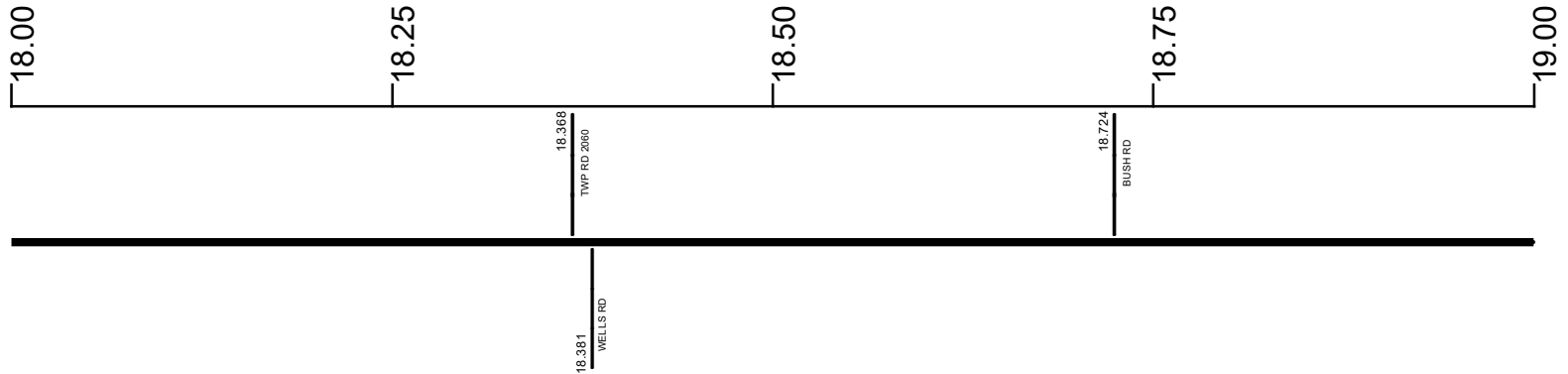

Surface Type & Width (Left / Right)

G 20'  
15.346 - 20.407

Base Type (Left / Right)

I  
15.613 - 21.396

Shoulder Type & Width (Left / Right)

2 (2/2)  
17.856 - 20.407

Through Lanes

2  
0 - 21.396

Street Name

SR 145  
0 - 20.411

- Non-divided Highway
  Bridge (on route)
  Railroad (at grade)
  Intersection
- Divided Highway
  Underpass
  Railroad (underpass)
- Secondary Segment
  Overpass
  Railroad (overpass)
- Corporation**

Created on: 7/3/2025



transportation.ohio.gov

Prepared by  
The Ohio Department of Transportation  
Office of Technical Services  
Roadway Information

# SMOESR00145\*\*C

State True Log

35.576

County True Log

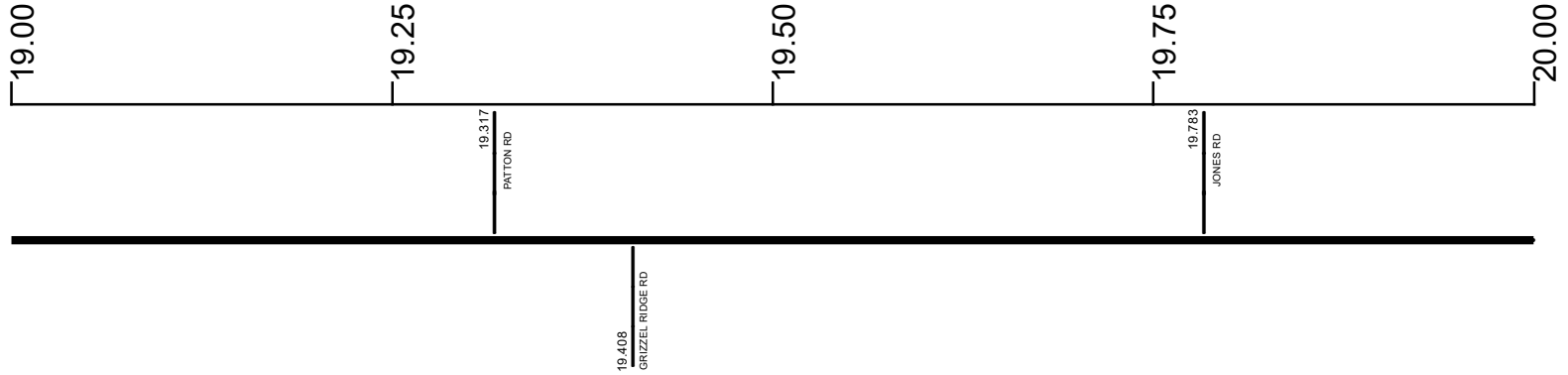

Surface Type & Width (Left / Right)	G 20'
	15.346 - 20.407
Base Type (Left / Right)	I
	15.613 - 21.396
Shoulder Type & Width (Left / Right)	2 (2/2')
	17.856 - 20.407
Through Lanes	2
	0 - 21.396
Street Name	SR 145
	0 - 20.411

<ul style="list-style-type: none"> <li> Non-divided Highway</li> <li> Divided Highway</li> <li> Secondary Segment</li> <li> Corporation</li> </ul>	<ul style="list-style-type: none"> <li> Bridge (on route)</li> <li> Underpass</li> <li> Overpass</li> </ul>	<ul style="list-style-type: none"> <li> Railroad (at grade)</li> <li> Railroad (underpass)</li> <li> Railroad (overpass)</li> </ul>	<ul style="list-style-type: none"> <li> Intersection</li> </ul>
--	---	---	---

Created on: 7/3/2025

transportation.ohio.gov

Prepared by  
The Ohio Department of Transportation  
Office of Technical Services  
Roadway Information

# SMOESR00145\*\*C

State True Log

36.576

County True Log

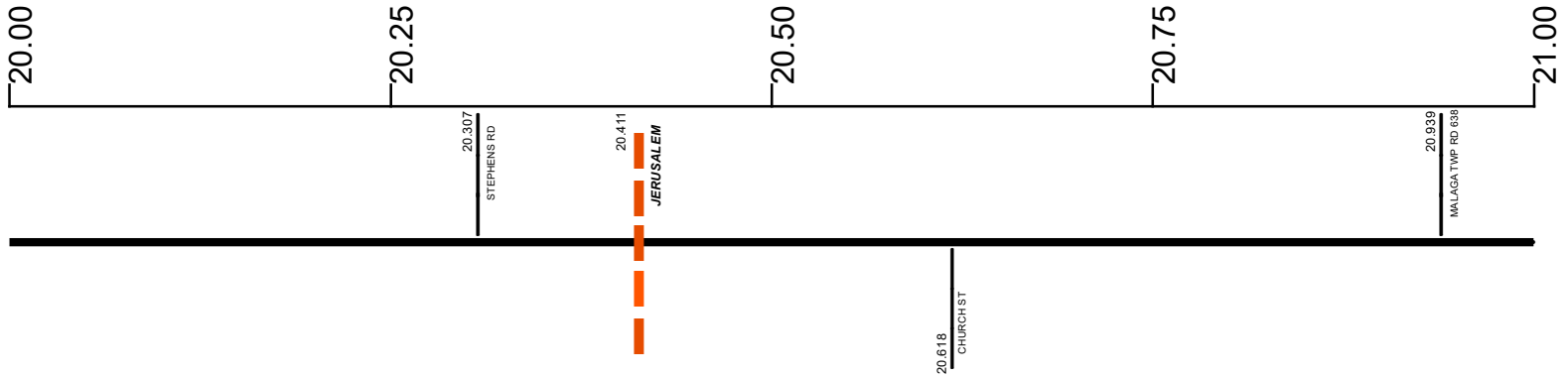

**Surface Type & Width (Left / Right)**

G 20' 15.346 - 20.407	G 18' 20.407 - 21.396
--------------------------	--------------------------

**Base Type (Left / Right)**

I 15.613 - 21.396	
----------------------	--

**Shoulder Type & Width (Left / Right)**

2 (2'2") 17.856 - 20.407	2 (3'3") 20.407 - 21.396
-----------------------------	-----------------------------

**Through Lanes**

2 0 - 21.396	
-----------------	--

**Street Name**

SR 145 0 - 20.411	MAIN ST 20.411 - 21.396
----------------------	----------------------------

- |  |   |   |   |
|--|---|---|---|
| <ul style="list-style-type: none"> <li> Non-divided Highway</li> <li> Divided Highway</li> <li> Secondary Segment</li> <li> Corporation</li> </ul> | <ul style="list-style-type: none"> <li> Bridge (on route)</li> <li> Underpass</li> <li> Overpass</li> </ul> | <ul style="list-style-type: none"> <li> Railroad (at grade)</li> <li> Railroad (underpass)</li> <li> Railroad (overpass)</li> </ul> | <ul style="list-style-type: none"> <li> Intersection</li> </ul> |
|--|---|---|---|

Created on: 7/3/2025

transportation.ohio.gov

Prepared by  
The Ohio Department of Transportation  
Office of Technical Services  
Roadway Information

# SMOESR00145\*\*C

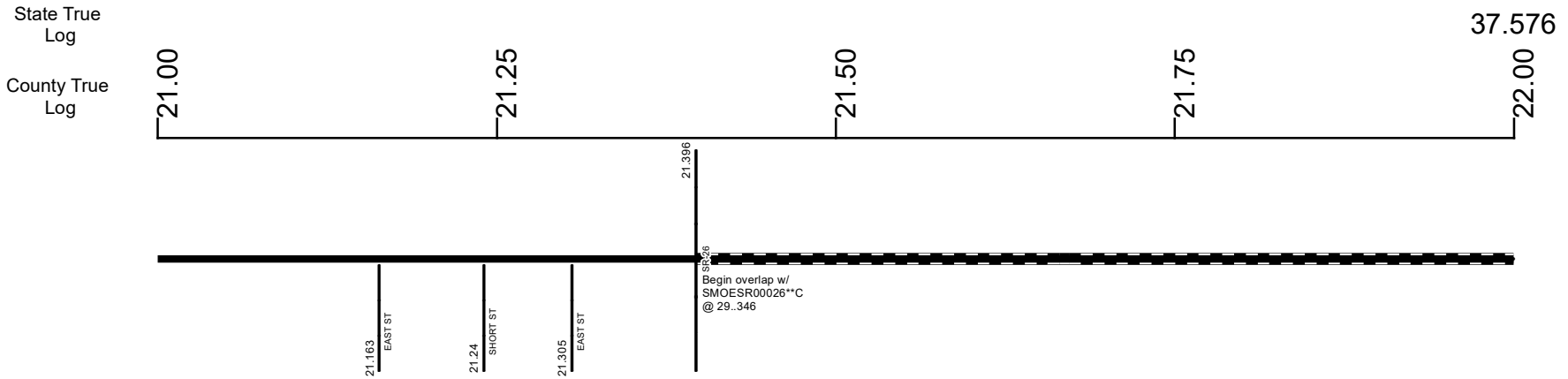

Surface Type & Width (Left / Right)	G 18'	20.407 - 21.396
Base Type (Left / Right)	I	15.613 - 21.396
Shoulder Type & Width (Left / Right)	2 (3/3')	20.407 - 21.396
Through Lanes	2	0 - 21.396
Street Name	MAIN ST	20.411 - 21.396

Non-divided Highway	Bridge (on route)	Railroad (at grade)	Intersection
Divided Highway	Underpass	Railroad (underpass)	
Secondary Segment	Overpass	Railroad (overpass)	
Corporation			

Created on: 7/3/2025



transportation.ohio.gov

Prepared by  
 The Ohio Department of Transportation  
 Office of Technical Services  
 Roadway Information

# SMOESR00145\*\*C

State True Log  
County True Log

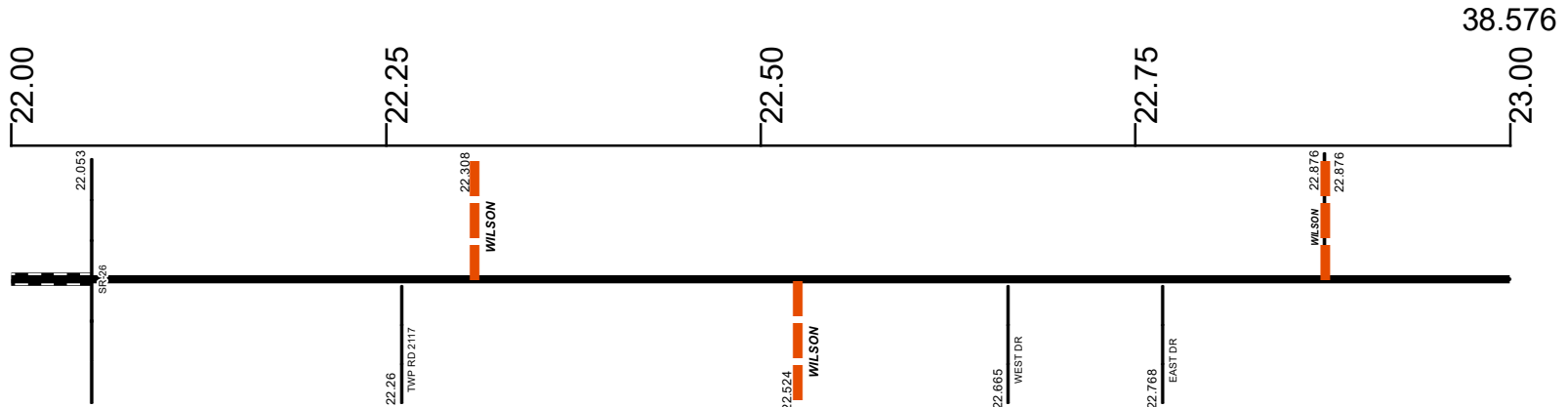

Surface Type & Width (Left / Right)

G 18'  
22.053 - 23.135

Base Type (Left / Right)

I  
22.053 - 23.135

Shoulder Type & Width (Left / Right)

2 (2'/2')  
22.053 - 23.135

Through Lanes

2  
22.053 - 25.789

Street Name

SR 145  
22.053 - 24.515

- |                     |                   |                      |              |
|---------------------|-------------------|----------------------|--------------|
| Non-divided Highway | Bridge (on route) | Railroad (at grade)  | Intersection |
| Divided Highway     | Underpass         | Railroad (underpass) |              |
| Secondary Segment   | Overpass          | Railroad (overpass)  |              |
| Corporation         |                   |                      |              |

Created on: 7/3/2025



transportation.ohio.gov  
Prepared by  
The Ohio Department of Transportation  
Office of Technical Services  
Roadway Information

# SMOESR00145\*\*C

State True Log

39.576

County True Log



23.006  
TWP RD 903 A

23.262  
SUNSHINE AVE

23.329  
PEARL ST

**Surface Type & Width (Left / Right)**

G 18' 22.053 - 23.135	G (15'/5') 23.135 - 24.451
--------------------------	-------------------------------

**Base Type (Left / Right)**

I 22.053 - 23.135	R / L 23.135 - 24.451
----------------------	--------------------------

**Shoulder Type & Width (Left / Right)**

2 (2'/2') 22.053 - 23.135	2 (3'/3') 23.135 - 24.708
------------------------------	------------------------------

**Through Lanes**

2 22.053 - 25.789
----------------------

**Street Name**

SR 145 22.053 - 24.515
---------------------------

- Non-divided Highway
- Divided Highway
- Secondary Segment
- Corporation
- Bridge (on route)
- Underpass
- Overpass
- Railroad (at grade)
- Railroad (underpass)
- Railroad (overpass)
- Intersection

Created on: 7/3/2025

transportation.ohio.gov

Prepared by  
The Ohio Department of Transportation  
Office of Technical Services  
Roadway Information

# SMOESR00145\*\*C

State True Log  
County True Log

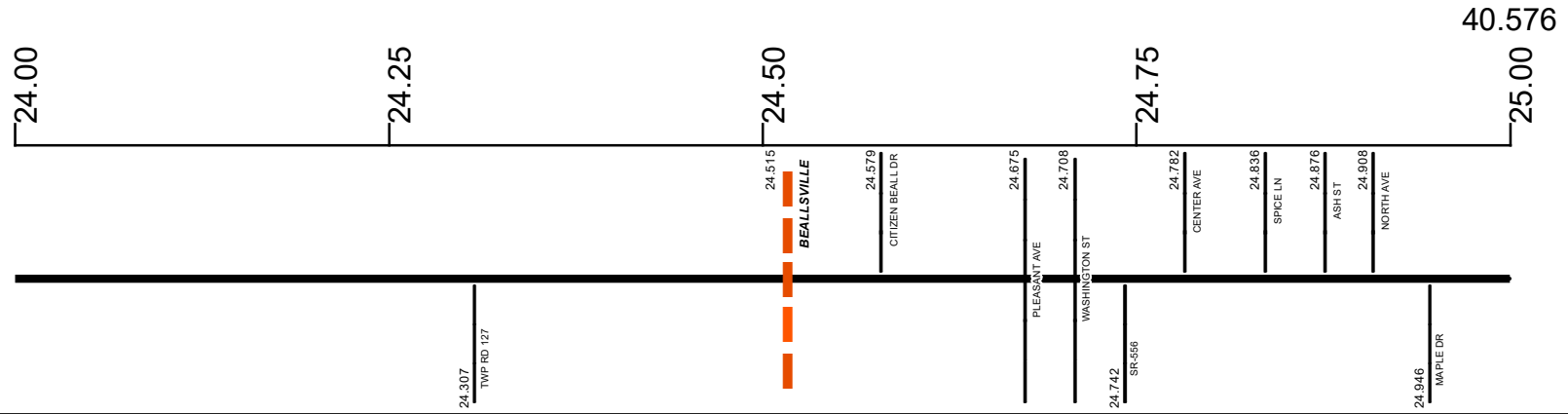

**Surface Type & Width (Left / Right)**

G (15'/5')	G 20'	G 48'	G 20'
23.135 - 24.451	24.451 - 24.708	24.708 - 24.742	24.742 - 25.219

**Base Type (Left / Right)**

R / L	K
23.135 - 24.451	24.451 - 25.219

**Shoulder Type & Width (Left / Right)**

2 (3'/3')	1 (0'/0')	2 (3'/3')
23.135 - 24.708	24.708 - 24.742	24.742 - 25.219

**Through Lanes**

2
22.053 - 25.789

**Street Name**

SR 145	OHIO AVE	MAIN ST	BELMONT AVE
22.053 - 24.515	24.515 - 24.742	24.742 - 24.908	24.908 - 25.277

- Non-divided Highway
- Divided Highway
- Secondary Segment
- Corporation
- Bridge (on route)
- Underpass
- Overpass
- Railroad (at grade)
- Railroad (underpass)
- Railroad (overpass)
- Intersection

Created on: 7/3/2025

transportation.ohio.gov

Prepared by  
The Ohio Department of Transportation  
Office of Technical Services  
Roadway Information

# SMOESR00145\*\*C

State True Log  
County True Log

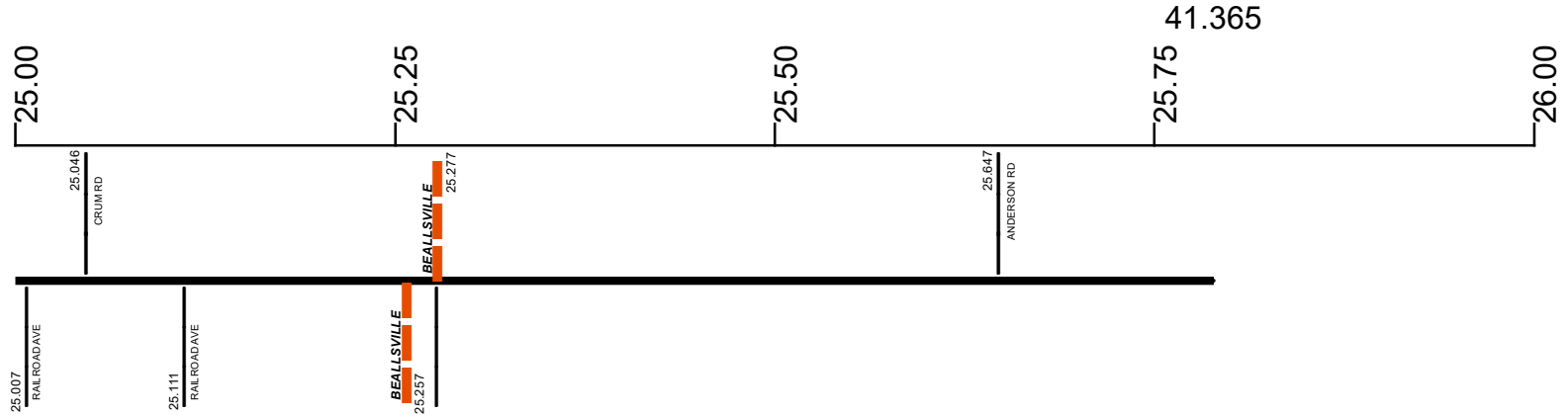

**Surface Type & Width (Left / Right)**

G 20'	G 18'
24.742 - 25.219	25.219 - 25.789

**Base Type (Left / Right)**

K	I
24.451 - 25.219	25.219 - 25.789

**Shoulder Type & Width (Left / Right)**

2 (3'/3')	2 (2'/2')
24.742 - 25.219	25.219 - 25.789

**Through Lanes**

2
22.053 - 25.789

**Street Name**

BELMONT AVE	SR 145
24.908 - 25.277	25.277 - 25.789

- |                     |                   |                      |              |
|---------------------|-------------------|----------------------|--------------|
| Non-divided Highway | Bridge (on route) | Railroad (at grade)  | Intersection |
| Divided Highway     | Underpass         | Railroad (underpass) |              |
| Secondary Segment   | Overpass          | Railroad (overpass)  |              |
| Corporation         |                   |                      |              |

Created on: 7/3/2025

transportation.ohio.gov

Prepared by  
The Ohio Department of Transportation  
Office of Technical Services  
Roadway Information

## Historical Project List for SMOESR00145\*\*C

Begin Measure	End Measure	Project ID Number	Construction Completion Date	Treatment Category	Treatment Type
0.000	8.489	91756	8-2020	Preventive Maintenance	25-Chip Seal
0.000	8.489	83817	10-2012	Minor Rehabilitation	50-AC Overlay w/o Rpr
8.489	17.856	84351	5-2017	Minor Rehabilitation	60-AC Overlay w/Rpr
8.762	17.856	84522	10-2023	Preventive Maintenance	25-Chip Seal
15.346	21.396	24826	8-2006	Minor Rehabilitation	50-AC Overlay w/o Rpr
17.856	21.396	84539	12-2019	Minor Rehabilitation	60-AC Overlay w/Rpr
22.053	25.789	84539	12-2019	Minor Rehabilitation	60-AC Overlay w/Rpr
22.053	25.789	24852	7-2007	Minor Rehabilitation	50-AC Overlay w/o Rpr

# Roadway Codes

## Access Control Journalized

- F - Full Access Control
- L - Limited Access Control
- N - No Access Control

## Access Control Operational

- 1 - Full Access Control
- 2 - Partial Access Control
- 3 - No Access Control

## Base Type

- F - Crack and Seat
- H - Rubblize and Roll
- I - Aggregate Base 304 or Traffic Compacted
- K - Water Bound Macadam
- L - Bituminous Concrete Mix or Penetration Macadam
- N - Plain Concrete
- P - Reinforced Concrete
- R - Brick (Flexible)
- T - Brick (Rigid)

## Direction of Travel

- B - Both (Two-way)
- F - One-way Cardinal
- T - One-way Non-cardinal

## Facility Type

- 1 - One-way Roadway
- 2 - Two-way Roadway
- 4 - Ramp
- 5 - Non-mainline
- 6 - Non-inventory Direction
- 7 - Planned / Unbuilt

## Historical Federal Aid Indicator

- N - Not a FAP Route
- Y - FAP Route

## Functional Classification

- 01 - Interstate
- 02 - Principal Arterial (Freeways)
- 03 - Principal Arterial (Other)
- 04 - Minor Arterial
- 05 - Major Collector
- 06 - Minor Collector
- 07 - Local

## Leave / Reenter Indicator

- Y - Route leaves/reenters at this point
- N - Route does not leave/reenter at this point

## Median Type

- 1 - None
- 2 - Unprotected
- 3 - Curbed
- 4 - Positive Barrier (Unspecified)
- 5 - Positive Barrier (Flexible)
- 6 - Positive Barrier (Semi-rigid)
- 7 - Positive Barrier (Rigid)

## NHS

- N - National Highway System
- H - Congressional Corridor
- 2 - Major Airport
- 3 - Major Port Facility
- 4 - Major Amtrak Station
- 5 - Major Rail / Truck Terminal
- 6 - Major Intercity Bus Terminal
- 7 - Major Public Transit / Multi-modal Passenger Terminal
- 8 - Major Pipeline Terminal
- 9 - Major Ferry Terminal

## Priority System

- G - General
- P - Priority System
- U - Urban

## Scenic Byway Code

- A - All American Road
- N - National Scenic Byway
- S - State Scenic Byway

## Shoulder Type

- 1 - None
- 2 - Surfaced shoulder exists (bituminous concrete {AC})
- 3 - Surfaced shoulder exists (Portland Cement Concrete {PCC})
- 4 - Stabilized shoulder exists (gravel or other granular material)
- 5 - Combination shoulder exists (two or more surface types)
- 6 - Earth shoulder exists
- 7 - Barrier curb exists; no shoulder in front of curb

## Surface Type

- A - Combination
- B - Brick
- C - Continuous Reinforced Concrete
- D - Reinforced Concrete
- E - Plain Concrete
- G - Bituminous Concrete
- I - Chipseal on Granular
- K - Open Graded Bituminous
- L - Chipseal or Micro
- M - Gravel
- U - Unimproved
- X - Right of Way Only