

SMOESR00536**C

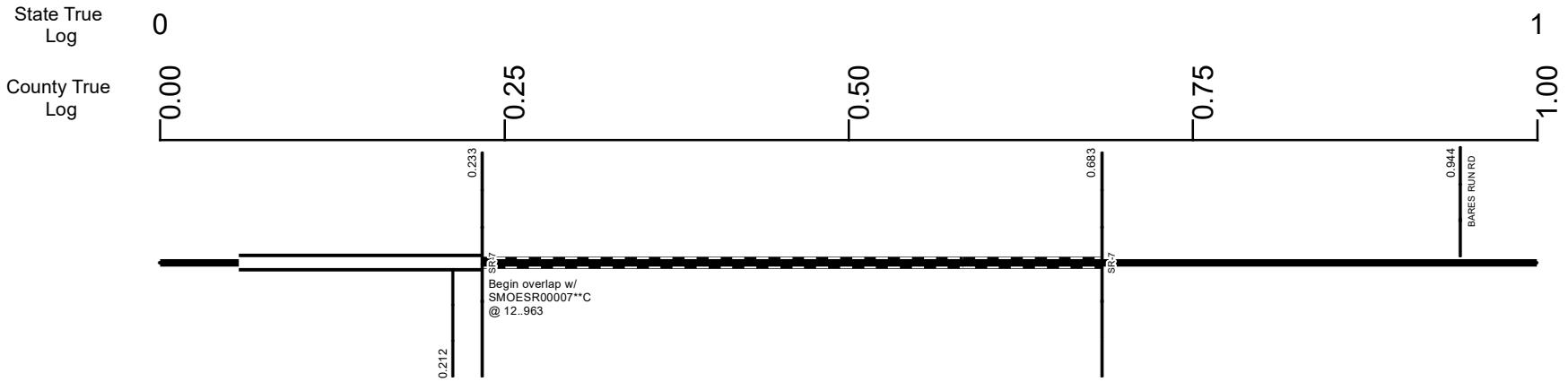

Surface Type & Width (Left / Right)	
G 24'	G 32'
0 - 0.087	0.087 - 0.233
Base Type (Left / Right)	
P	
0 - 0.233	
Shoulder Type & Width (Left / Right)	
1 (2 1/2')	1 (4 1/4')
2 (4 1/4')	
0 - 0.057	0.057 - 0.087
0.087 - 0.233	
Median Type and Width	
2 (9999')	
0.057 - 0.233	
Through Lanes	
2	
0 - 0.233	
SR 536	
0 - 0.233	

Surface Type & Width (Left / Right)	
G 18'	
0.683 - 5.743	
Base Type (Left / Right)	
I	
0.683 - 12.603	
Shoulder Type & Width (Left / Right)	
5 (2 1/2')	
0.683 - 2.473	
Through Lanes	
2	
0.683 - 12.603	
Street Name	
SR 536	
0.683 - 12.603	

Non-divided Highway	Bridge (on route)	Railroad (at grade)	Intersection
Divided Highway	Underpass	Railroad (underpass)	
Secondary Segment	Overpass	Railroad (overpass)	
Corporation			

Created on: 7/3/2025



transportation.ohio.gov
 Prepared by
 The Ohio Department of Transportation
 Office of Technical Services
 Roadway Information

SMOESR00536**C

State True Log

County True Log

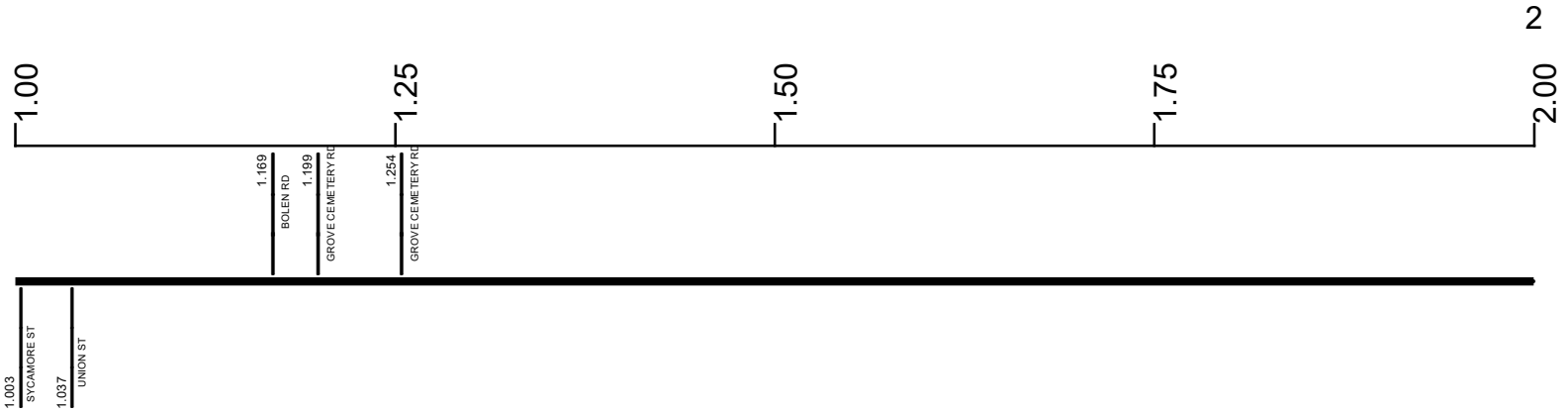

Surface Type & Width (Left / Right)

G 18'
0.683 - 5.743

Base Type (Left / Right)

I
0.683 - 12.603

Shoulder Type & Width (Left / Right)

5 (2/2)
0.683 - 2.473

Through Lanes

2
0.683 - 12.603

Street Name

SR 536
0.683 - 12.603

- Non-divided Highway
 Bridge (on route)
 Railroad (at grade)
 Intersection
- Divided Highway
 Underpass
 Railroad (underpass)
- Secondary Segment
 Overpass
 Railroad (overpass)
- Corporation**

Created on: 7/3/2025



transportation.ohio.gov

Prepared by
The Ohio Department of Transportation
Office of Technical Services
Roadway Information

SMOESR00536**C

State True Log

County True Log

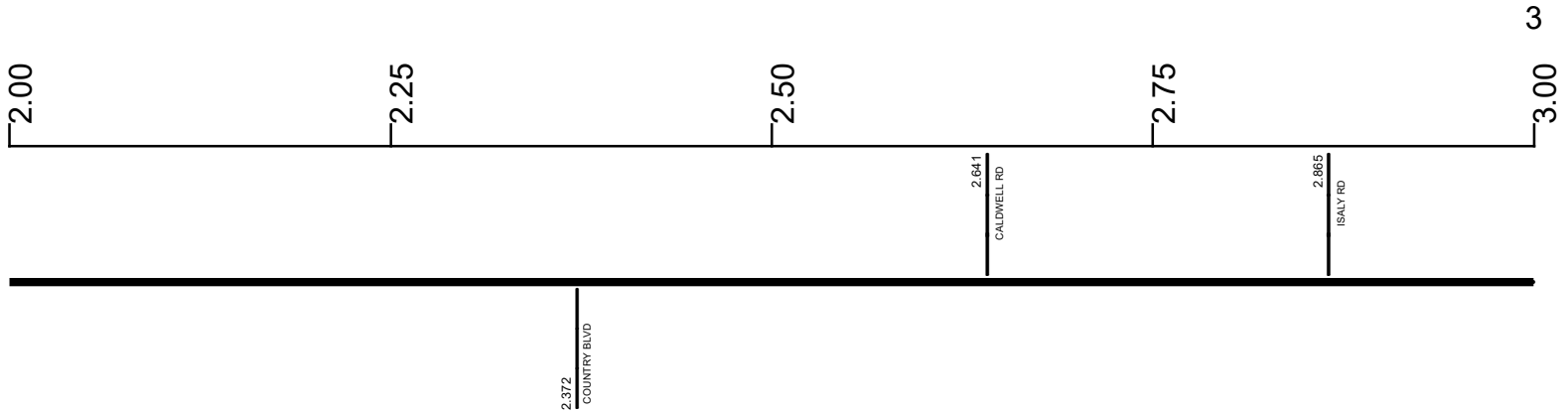

Surface Type & Width (Left / Right)

	G 18'
0.683 - 5.743	

Base Type (Left / Right)

	I
0.683 - 12.603	

Shoulder Type & Width (Left / Right)

5 (2'1/2')	2 (2'1/2')
0.683 - 2.473	2.473 - 12.603

Through Lanes

	2
0.683 - 12.603	

Street Name

	SR 536
0.683 - 12.603	

- | | | | |
|--|---|---|---|
| <ul style="list-style-type: none"> Non-divided Highway Divided Highway Secondary Segment Corporation | <ul style="list-style-type: none"> Bridge (on route) Underpass Overpass | <ul style="list-style-type: none"> Railroad (at grade) Railroad (underpass) Railroad (overpass) | <ul style="list-style-type: none"> Intersection |
|--|---|---|---|

Created on: 7/3/2025

transportation.ohio.gov

Prepared by
The Ohio Department of Transportation
Office of Technical Services
Roadway Information

SMOESR00536**C

State True Log

County True Log

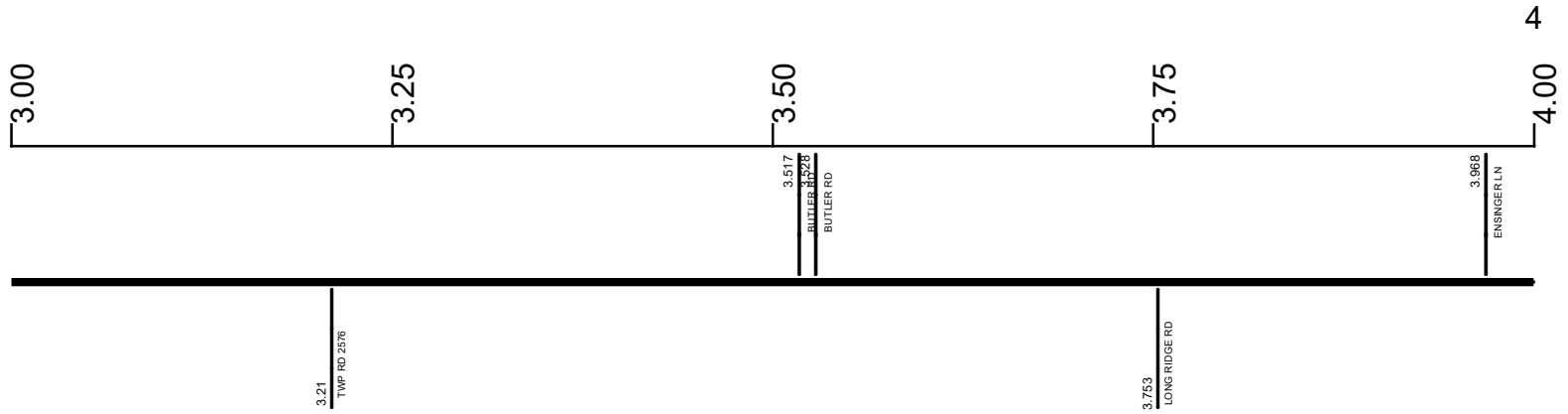

Surface Type & Width (Left / Right)

G 18'
0.683 - 5.743

Base Type (Left / Right)

I
0.683 - 12.603

Shoulder Type & Width (Left / Right)

2 (2/2)
2.473 - 12.603

Through Lanes

2
0.683 - 12.603

Street Name

SR 536
0.683 - 12.603

- Non-divided Highway
- Divided Highway
- Secondary Segment
- Corporation
- Bridge (on route)
- Underpass
- Overpass
- Railroad (at grade)
- Railroad (underpass)
- Railroad (overpass)
- Intersection

Created on: 7/3/2025

transportation.ohio.gov
Prepared by
The Ohio Department of Transportation
Office of Technical Services
Roadway Information

SMOESR00536**C

State True Log

County True Log

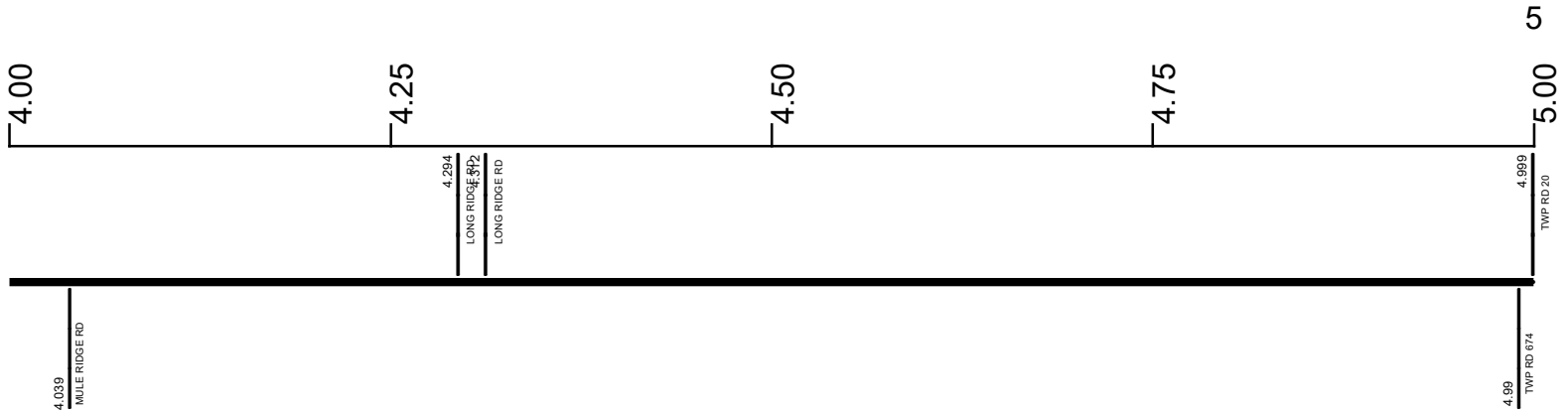

Surface Type & Width (Left / Right)	G 18'
	0.683 - 5.743
Base Type (Left / Right)	I
	0.683 - 12.603
Shoulder Type & Width (Left / Right)	2 (2'/2')
	2.473 - 12.603
Through Lanes	2
	0.683 - 12.603
Street Name	SR 536
	0.683 - 12.603

- | | | | |
|---------------------|-------------------|----------------------|--------------|
| Non-divided Highway | Bridge (on route) | Railroad (at grade) | Intersection |
| Divided Highway | Underpass | Railroad (underpass) | |
| Secondary Segment | Overpass | Railroad (overpass) | |
| Corporation | | | |

Created on: 7/3/2025

transportation.ohio.gov

Prepared by
The Ohio Department of Transportation
Office of Technical Services
Roadway Information

SMOESR00536**C

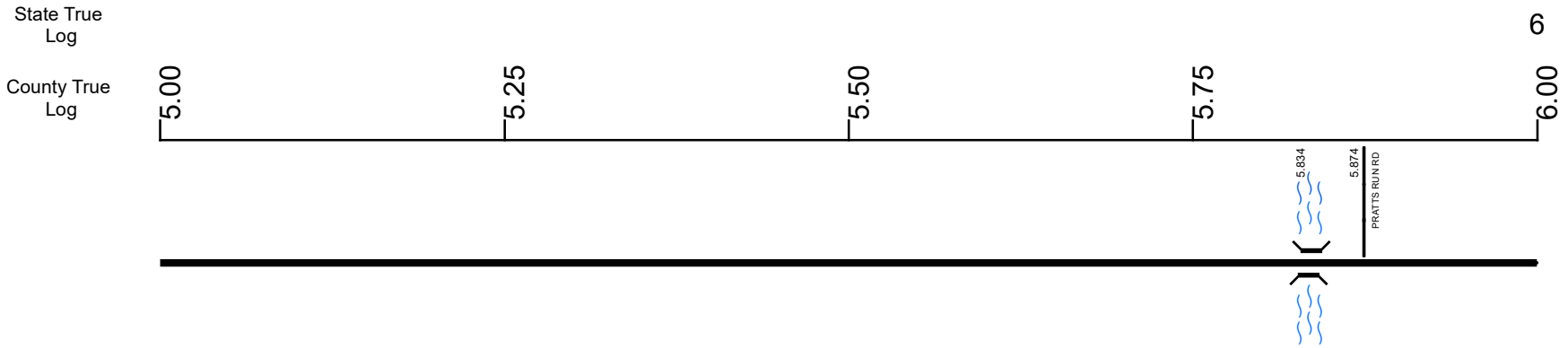

Surface Type & Width (Left / Right)	
G 18'	G 20' G 18'
0.683 - 5.743	5.743 - 5.923 5.923 - 12.603
Base Type (Left / Right)	
I	
0.683 - 12.603	
Shoulder Type & Width (Left / Right)	
2 (2'/2')	
2.473 - 12.603	
Through Lanes	
2	
0.683 - 12.603	
Street Name	
SR 536	
0.683 - 12.603	

- Non-divided Highway
- Divided Highway
- Secondary Segment
- Corporation
- Bridge (on route)
- Underpass
- Overpass
- Railroad (at grade)
- Railroad (underpass)
- Railroad (overpass)
- Intersection

Created on: 7/3/2025

transportation.ohio.gov

Prepared by
The Ohio Department of Transportation
Office of Technical Services
Roadway Information

SMOESR00536**C

State True Log

7

County True Log

6.00

6.25

6.50

6.75

7.00

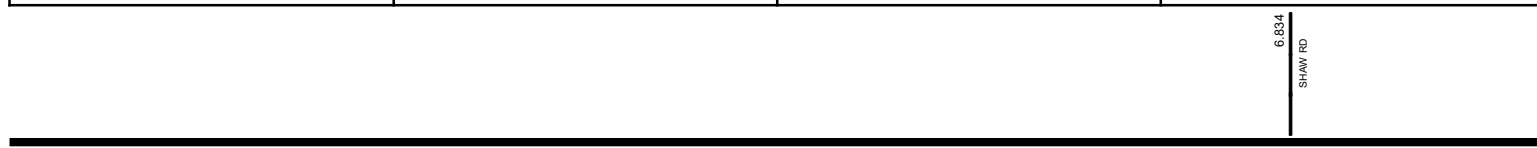

Surface Type & Width (Left / Right)

G 18'
5.923 - 12.603

Base Type (Left / Right)

I
0.683 - 12.603

Shoulder Type & Width (Left / Right)

2 (2'/2')
2.473 - 12.603

Through Lanes

2
0.683 - 12.603

Street Name

SR 536
0.683 - 12.603

- | | | | |
|---------------------|-------------------|----------------------|--------------|
| Non-divided Highway | Bridge (on route) | Railroad (at grade) | Intersection |
| Divided Highway | Underpass | Railroad (underpass) | |
| Secondary Segment | Overpass | Railroad (overpass) | |
| Corporation | | | |

Created on: 7/3/2025



transportation.ohio.gov
 Prepared by
 The Ohio Department of Transportation
 Office of Technical Services
 Roadway Information

SMOESR00536**C

State True Log

8

County True Log

7.00

7.25

7.50

7.75

8.00



Surface Type & Width (Left / Right)

G 18'
5.923 - 12.603

Base Type (Left / Right)

I
0.683 - 12.603

Shoulder Type & Width (Left / Right)

2 (2'/2)
2.473 - 12.603

Through Lanes

2
0.683 - 12.603

Street Name

SR 536
0.683 - 12.603

- | | | | |
|---------------------|-------------------|----------------------|--------------|
| Non-divided Highway | Bridge (on route) | Railroad (at grade) | Intersection |
| Divided Highway | Underpass | Railroad (underpass) | |
| Secondary Segment | Overpass | Railroad (overpass) | |
| Corporation | | | |

Created on: 7/3/2025



transportation.ohio.gov
Prepared by
The Ohio Department of Transportation
Office of Technical Services
Roadway Information

SMOESR00536**C

State True Log

County True Log

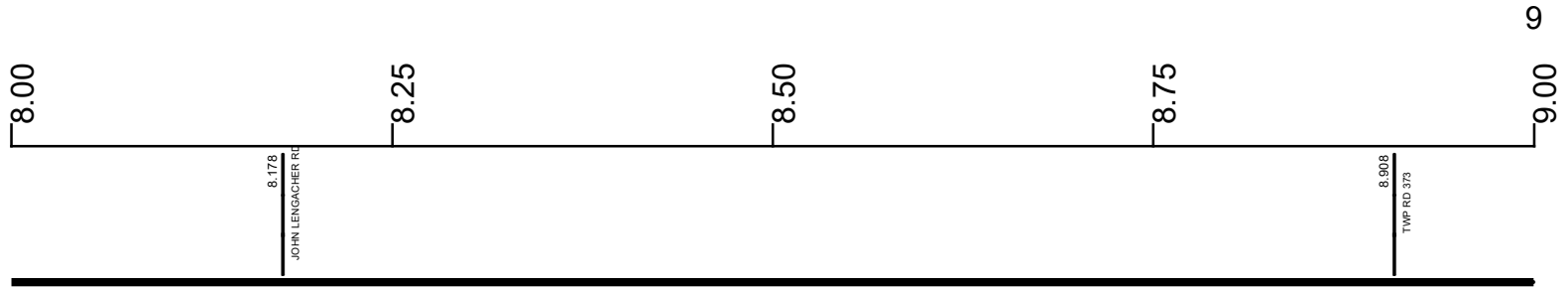

Surface Type & Width (Left / Right)

G 18'
5.923 - 12.603

Base Type (Left / Right)

I
0.683 - 12.603

Shoulder Type & Width (Left / Right)

2 (2'/2')
2.473 - 12.603

Through Lanes

2
0.683 - 12.603

Street Name

SR 536
0.683 - 12.603

- | | | | |
|---------------------|-------------------|----------------------|--------------|
| Non-divided Highway | Bridge (on route) | Railroad (at grade) | Intersection |
| Divided Highway | Underpass | Railroad (underpass) | |
| Secondary Segment | Overpass | Railroad (overpass) | |
| Corporation | | | |

Created on: 7/3/2025

SMOESR00536**C

State True Log

County True Log

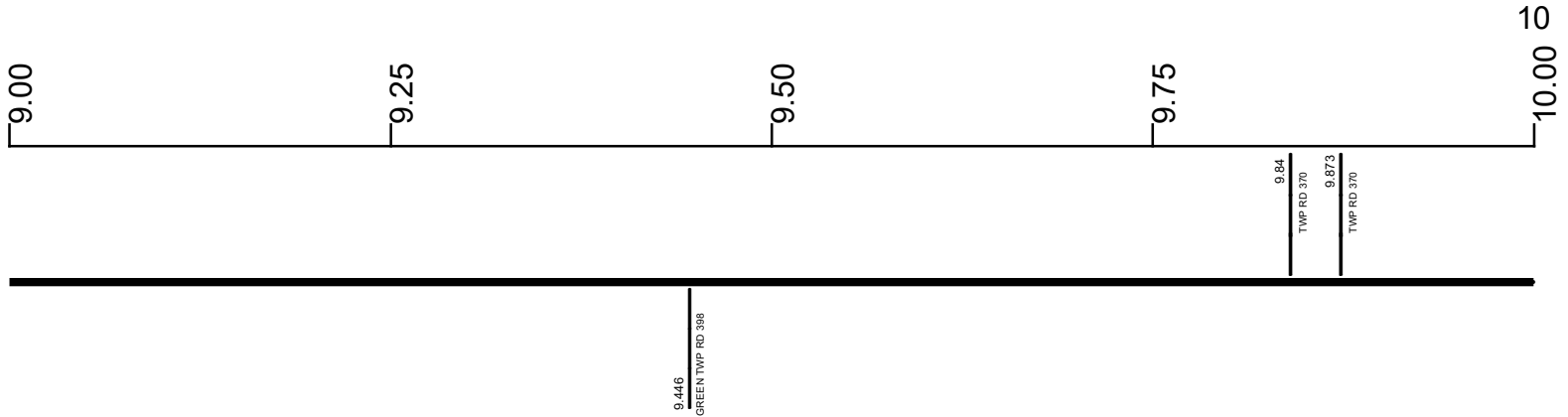

Surface Type & Width (Left / Right)

G 18'
5.923 - 12.603

Base Type (Left / Right)

I
0.683 - 12.603

Shoulder Type & Width (Left / Right)

2 (2'/2)
2.473 - 12.603

Through Lanes

2
0.683 - 12.603

Street Name

SR 536
0.683 - 12.603

- Non-divided Highway
 Bridge (on route)
 Railroad (at grade)
 Intersection
- Divided Highway
 Underpass
 Railroad (underpass)
- Secondary Segment
 Overpass
 Railroad (overpass)
- Corporation**

Created on: 7/3/2025



transportation.ohio.gov

Prepared by
The Ohio Department of Transportation
Office of Technical Services
Roadway Information

SMOESR00536**C

State True Log
County True Log

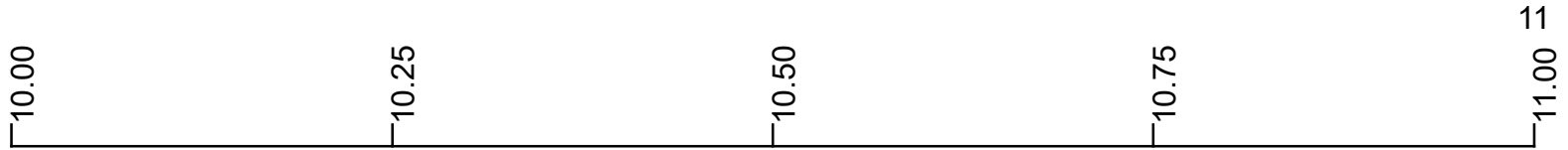

Surface Type & Width (Left / Right)

	G 18'
	5.923 - 12.603

Base Type (Left / Right)

	I
	0.683 - 12.603

Shoulder Type & Width (Left / Right)

	2 (2'/2')
	2.473 - 12.603

Through Lanes

	2
	0.683 - 12.603

Street Name

	SR 536
	0.683 - 12.603

- | | | | |
|---------------------|-------------------|----------------------|--------------|
| Non-divided Highway | Bridge (on route) | Railroad (at grade) | Intersection |
| Divided Highway | Underpass | Railroad (underpass) | |
| Secondary Segment | Overpass | Railroad (overpass) | |
| Corporation | | | |

Created on: 7/3/2025

transportation.ohio.gov

Prepared by
The Ohio Department of Transportation
Office of Technical Services
Roadway Information

SMOESR00536**C

State True Log
County True Log

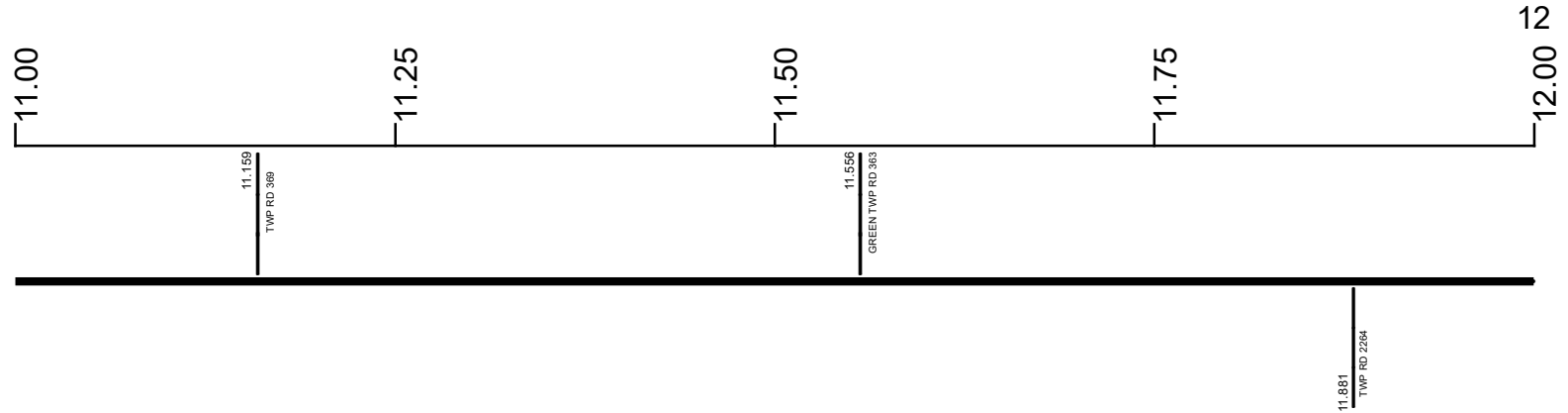

Surface Type & Width (Left / Right)	G 18'
	5.923 - 12.603
Base Type (Left / Right)	I
	0.683 - 12.603
Shoulder Type & Width (Left / Right)	2 (2'/2')
	2.473 - 12.603
Through Lanes	2
	0.683 - 12.603
Street Name	SR 536
	0.683 - 12.603

Non-divided Highway	Bridge (on route)	Railroad (at grade)	Intersection
Divided Highway	Underpass	Railroad (underpass)	
Secondary Segment	Overpass	Railroad (overpass)	
Corporation			

Created on: 7/3/2025

transportation.ohio.gov

Prepared by
The Ohio Department of Transportation
Office of Technical Services
Roadway Information

SMOESR00536**C

12.603

State True Log

County True Log

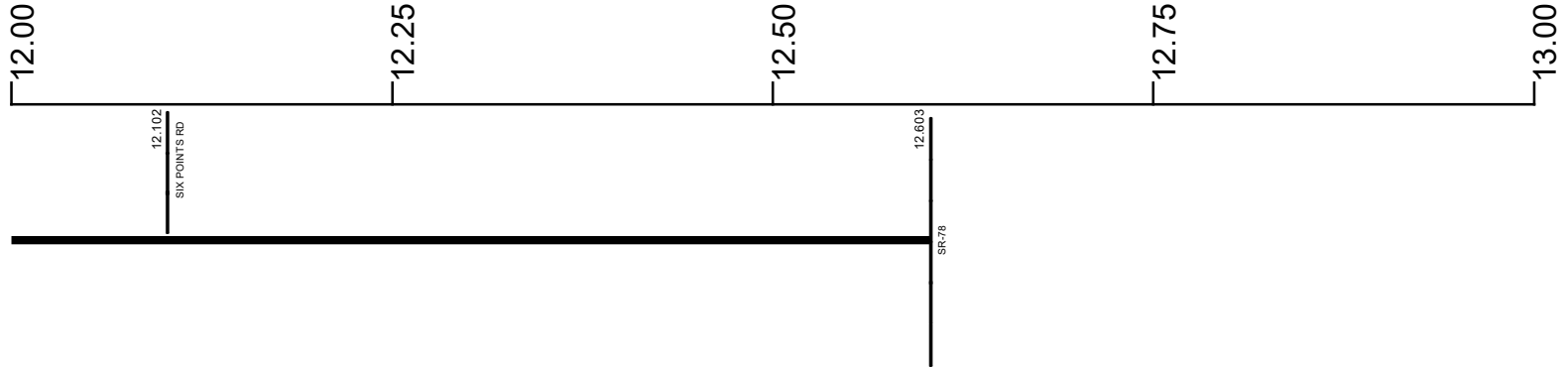

Surface Type & Width (Left / Right)

G 18'
5.923 - 12.603

Base Type (Left / Right)

I
0.683 - 12.603

Shoulder Type & Width (Left / Right)

2 (2'/2')
2.473 - 12.603

Through Lanes

2
0.683 - 12.603

Street Name

SR 536
0.683 - 12.603

- | | | | |
|--|---|---|---|
| <ul style="list-style-type: none"> Non-divided Highway Divided Highway Secondary Segment Corporation | <ul style="list-style-type: none"> Bridge (on route) Underpass Overpass | <ul style="list-style-type: none"> Railroad (at grade) Railroad (underpass) Railroad (overpass) | <ul style="list-style-type: none"> Intersection |
|--|---|---|---|

Created on: 7/3/2025

transportation.ohio.gov

Prepared by
The Ohio Department of Transportation
Office of Technical Services
Roadway Information

Historical Project List for SMOESR00536**C

Begin Measure	End Measure	Project ID Number	Construction Completion Date	Treatment Category	Treatment Type
0.000	0.240	82840	8-2014	Minor Rehabilitation	50-AC Overlay w/o Rpr
0.690	12.630	91779	12-2016	Minor Rehabilitation	60-AC Overlay w/Rpr
0.690	12.630	76139	6-2006	Minor Rehabilitation	50-AC Overlay w/o Rpr

Roadway Codes

Access Control Journalized

- F - Full Access Control
- L - Limited Access Control
- N - No Access Control

Access Control Operational

- 1 - Full Access Control
- 2 - Partial Access Control
- 3 - No Access Control

Base Type

- F - Crack and Seat
- H - Rubblize and Roll
- I - Aggregate Base 304 or Traffic Compacted
- K - Water Bound Macadam
- L - Bituminous Concrete Mix or Penetration Macadam
- N - Plain Concrete
- P - Reinforced Concrete
- R - Brick (Flexible)
- T - Brick (Rigid)

Direction of Travel

- B - Both (Two-way)
- F - One-way Cardinal
- T - One-way Non-cardinal

Facility Type

- 1 - One-way Roadway
- 2 - Two-way Roadway
- 4 - Ramp
- 5 - Non-mainline
- 6 - Non-inventory Direction
- 7 - Planned / Unbuilt

Historical Federal Aid Indicator

- N - Not a FAP Route
- Y - FAP Route

Functional Classification

- 01 - Interstate
- 02 - Principal Arterial (Freeways)
- 03 - Principal Arterial (Other)
- 04 - Minor Arterial
- 05 - Major Collector
- 06 - Minor Collector
- 07 - Local

Leave / Reenter Indicator

- Y - Route leaves/reenters at this point
- N - Route does not leave/reenter at this point

Median Type

- 1 - None
- 2 - Unprotected
- 3 - Curbed
- 4 - Positive Barrier (Unspecified)
- 5 - Positive Barrier (Flexible)
- 6 - Positive Barrier (Semi-rigid)
- 7 - Positive Barrier (Rigid)

NHS

- N - National Highway System
- H - Congressional Corridor
- 2 - Major Airport
- 3 - Major Port Facility
- 4 - Major Amtrak Station
- 5 - Major Rail / Truck Terminal
- 6 - Major Intercity Bus Terminal
- 7 - Major Public Transit / Multi-modal Passenger Terminal
- 8 - Major Pipeline Terminal
- 9 - Major Ferry Terminal

Priority System

- G - General
- P - Priority System
- U - Urban

Scenic Byway Code

- A - All American Road
- N - National Scenic Byway
- S - State Scenic Byway

Shoulder Type

- 1 - None
- 2 - Surfaced shoulder exists (bituminous concrete {AC})
- 3 - Surfaced shoulder exists (Portland Cement Concrete {PCC})
- 4 - Stabilized shoulder exists (gravel or other granular material)
- 5 - Combination shoulder exists (two or more surface types)
- 6 - Earth shoulder exists
- 7 - Barrier curb exists; no shoulder in front of curb

Surface Type

- A - Combination
- B - Brick
- C - Continuous Reinforced Concrete
- D - Reinforced Concrete
- E - Plain Concrete
- G - Bituminous Concrete
- I - Chipseal on Granular
- K - Open Graded Bituminous
- L - Chipseal or Micro
- M - Gravel
- U - Unimproved
- X - Right of Way Only