

# SMRGSR00266\*\*C

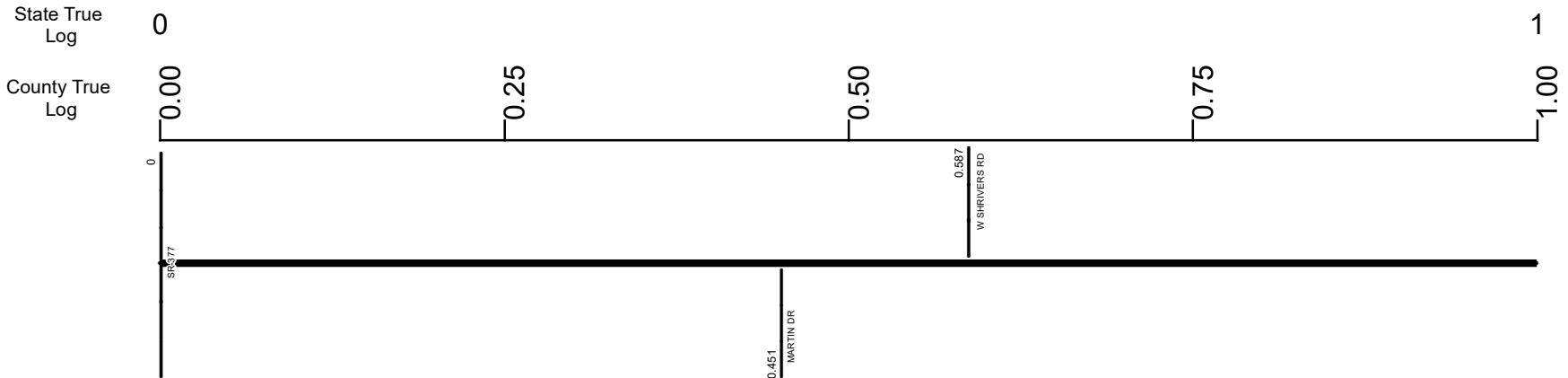

Surface Type & Width (Left / Right)	G (12'/8')
	0 - 2.353
Base Type (Left / Right)	L / I
	0 - 2.353
Shoulder Type & Width (Left / Right)	2 (8'/8')
	0 - 2.353
Through Lanes	2
	0 - 14.037
Street Name	SR 266
	0 - 3.58

Non-divided Highway	Bridge (on route)	Railroad (at grade)	Intersection
Divided Highway	Underpass	Railroad (underpass)	
Secondary Segment	Overpass	Railroad (overpass)	
Corporation			

Created on: 7/3/2025



transportation.ohio.gov

Prepared by  
The Ohio Department of Transportation  
Office of Technical Services  
Roadway Information

# SMRGSR00266\*\*C

State True Log

County True Log

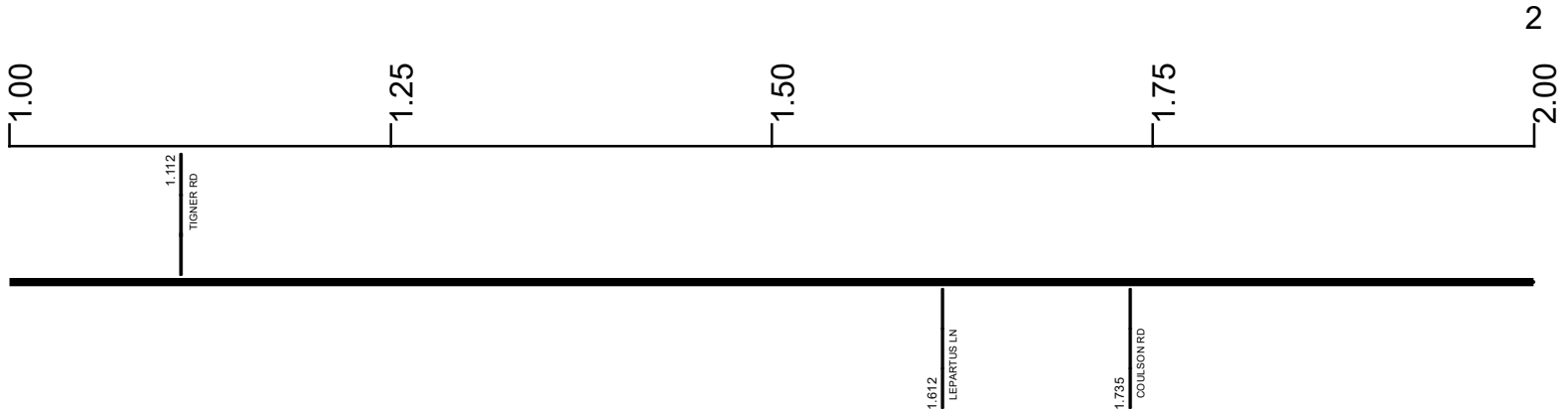

Surface Type & Width (Left / Right)	G (12'/8') 0 - 2.353
Base Type (Left / Right)	L / I 0 - 2.353
Shoulder Type & Width (Left / Right)	2 (8'/8') 0 - 2.353
Through Lanes	2 0 - 14.037
Street Name	SR 266 0 - 3.58

<ul style="list-style-type: none"> <li> Non-divided Highway</li> <li> Divided Highway</li> <li> Secondary Segment</li> <li> Corporation</li> </ul>	<ul style="list-style-type: none"> <li> Bridge (on route)</li> <li> Underpass</li> <li> Overpass</li> </ul>	<ul style="list-style-type: none"> <li> Railroad (at grade)</li> <li> Railroad (underpass)</li> <li> Railroad (overpass)</li> </ul>	<ul style="list-style-type: none"> <li> Intersection</li> </ul>
--	---	---	---

Created on: 7/3/2025

transportation.ohio.gov

Prepared by  
The Ohio Department of Transportation  
Office of Technical Services  
Roadway Information

# SMRGSR00266\*\*C

State True Log

County True Log

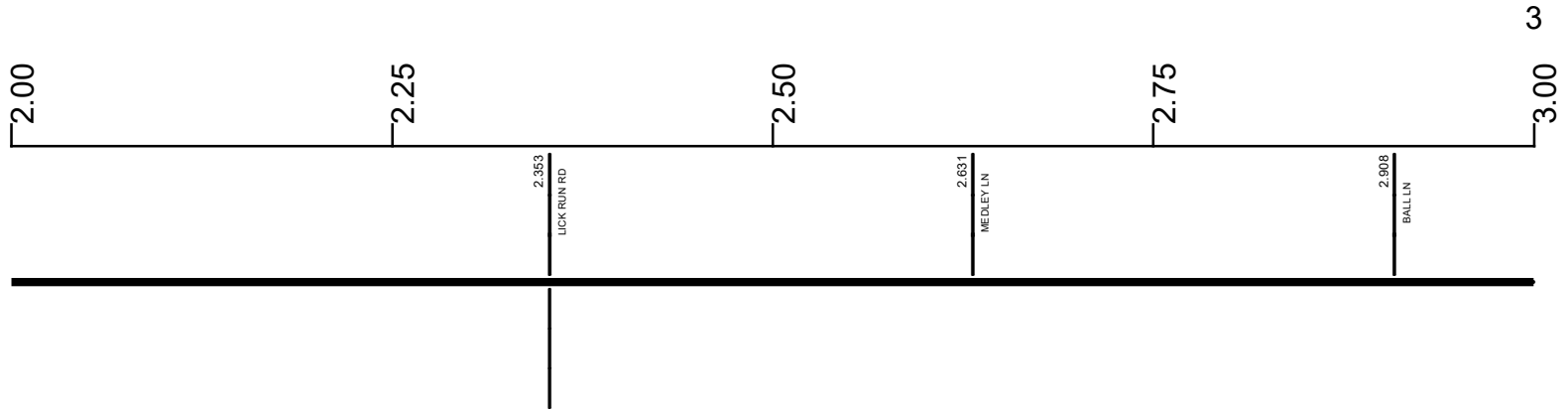

**Surface Type & Width (Left / Right)**

G (12'8") 0 - 2.353	G (14'6") 2.353 - 3.58
------------------------	---------------------------

**Base Type (Left / Right)**

L / I 0 - 2.353	R / I 2.353 - 3.58
--------------------	-----------------------

**Shoulder Type & Width (Left / Right)**

2 (8'8") 0 - 2.353	2 (5'5") 2.353 - 3.58
-----------------------	--------------------------

**Through Lanes**

2 0 - 14.037
-----------------

**Street Name**

SR 266 0 - 3.58
--------------------

- Non-divided Highway
- Divided Highway
- Secondary Segment
- Corporation
- Bridge (on route)
- Underpass
- Overpass
- Railroad (at grade)
- Railroad (underpass)
- Railroad (overpass)
- Intersection

Created on: 7/3/2025

transportation.ohio.gov

Prepared by  
The Ohio Department of Transportation  
Office of Technical Services  
Roadway Information

# SMRGSR00266\*\*C

State True Log

County True Log

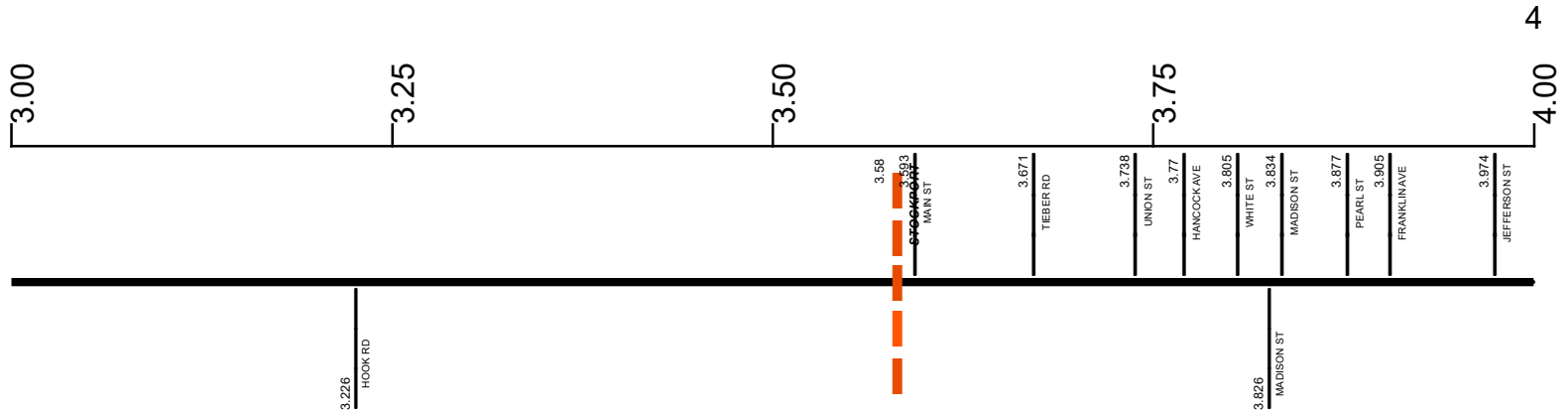

**Surface Type & Width (Left / Right)**

G (14'/6") 2.353 - 3.58	G (11'/12") 3.58 - 4.07
----------------------------	----------------------------

**Base Type (Left / Right)**

R / I 2.353 - 3.58	I 3.58 - 4.07
-----------------------	------------------

**Shoulder Type & Width (Left / Right)**

2 (5'/5") 2.353 - 3.58	2 (4'/4") 3.58 - 4.07
---------------------------	--------------------------

**Through Lanes**

2 0 - 14.037	
-----------------	--

**Street Name**

SR 266 0 - 3.58	BROADWAY ST 3.58 - 4.15
--------------------	----------------------------

- Non-divided Highway
- Divided Highway
- Secondary Segment
- Corporation**
- Bridge (on route)
- Underpass
- Overpass
- Railroad (at grade)
- Railroad (underpass)
- Railroad (overpass)
- Intersection

Created on: 7/3/2025

transportation.ohio.gov

Prepared by  
The Ohio Department of Transportation  
Office of Technical Services  
Roadway Information

# SMRGSR00266\*\*C

State True Log

5

County True Log

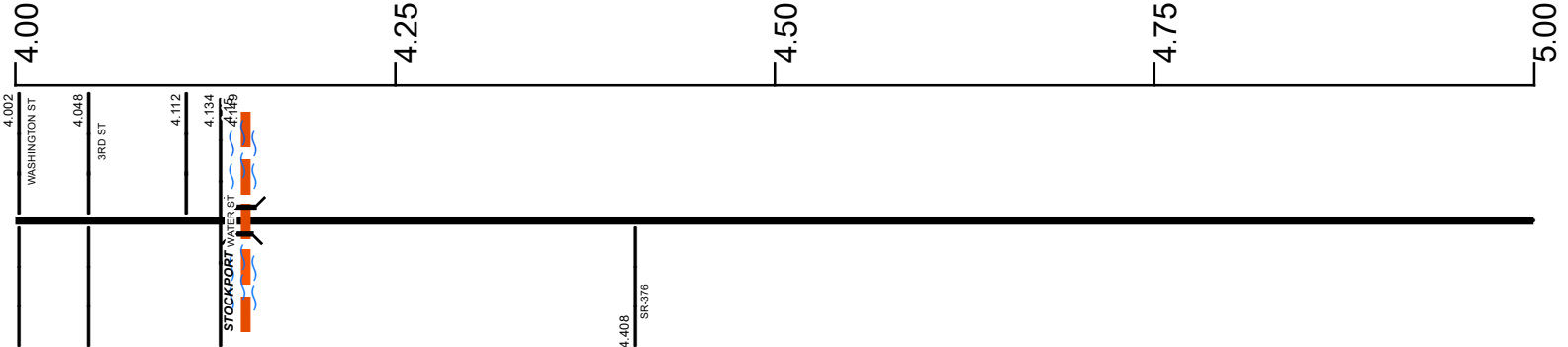

**Surface Type & Width (Left / Right)**

G (11'/12')	G 30'	D 30'	G 24'	G 18'
3.58 - 4.07	4.07 - 4.15	4.15 - 4.289	4.289 - 4.424	4.424 - 7.437

**Base Type (Left / Right)**

I	L
3.58 - 4.07	4.07 - 4.15

**Base Type (Left / Right)**

L	I
4.289 - 4.424	4.424 - 7.437

**Shoulder Type & Width (Left / Right)**

2 (4'/4')	1 (0'/0')	2 (4'/4')
3.58 - 4.07	4.07 - 4.289	4.289 - 7.437

**Through Lanes**

2
0 - 14.037

**Street Name**

BROADWAY ST	SR 266
3.58 - 4.15	4.15 - 14.037

- Non-divided Highway
- Divided Highway
- Secondary Segment
- Corporation
- Bridge (on route)
- Underpass
- Overpass
- Railroad (at grade)
- Railroad (underpass)
- Railroad (overpass)
- Intersection

Created on: 7/3/2025

transportation.ohio.gov

Prepared by  
The Ohio Department of Transportation  
Office of Technical Services  
Roadway Information

# SMRGSR00266\*\*C

State True Log

6

County True Log

5.00

5.25

5.50

5.75

6.00



5.998  
BIG BOTTOM LN

Surface Type & Width (Left / Right)

	G 18'
	4.424 - 7.437

Base Type (Left / Right)

	I
	4.424 - 7.437

Shoulder Type & Width (Left / Right)

	2 (4/4')
	4.289 - 7.437

Through Lanes

	2
	0 - 14.037

Street Name

	SR 266
	4.15 - 14.037

- |                     |                   |                      |              |
|---------------------|-------------------|----------------------|--------------|
| Non-divided Highway | Bridge (on route) | Railroad (at grade)  | Intersection |
| Divided Highway     | Underpass         | Railroad (underpass) |              |
| Secondary Segment   | Overpass          | Railroad (overpass)  |              |
| Corporation         |                   |                      |              |

Created on: 7/3/2025

transportation.ohio.gov

Prepared by  
The Ohio Department of Transportation  
Office of Technical Services  
Roadway Information



# SMRGSR00266\*\*C

State True Log

8

County True Log



**Surface Type & Width (Left / Right)**

G 18'	G 20'	G 22'
4.424 - 7.437	7.437 - 7.67	7.67 - 9.078

**Base Type (Left / Right)**

I	K	L
4.424 - 7.437	7.437 - 7.67	7.67 - 9.078

**Shoulder Type & Width (Left / Right)**

2 (4/4')	2 (8/8')	5 (7/7')
4.289 - 7.437	7.437 - 7.67	7.67 - 9.078

**Through Lanes**

2
0 - 14.037

**Street Name**

SR 266
4.15 - 14.037

- Non-divided Highway
- Divided Highway
- Secondary Segment
- Corporation
- Bridge (on route)
- Underpass
- Overpass
- Railroad (at grade)
- Railroad (underpass)
- Railroad (overpass)
- Intersection

Created on: 7/3/2025

transportation.ohio.gov

Prepared by  
The Ohio Department of Transportation  
Office of Technical Services  
Roadway Information

# SMRGSR00266\*\*C

State True  
Log

9

County True  
Log

8.00

8.25

8.50

8.75

9.00



Surface Type & Width (Left / Right)

G 22'  
7.67 - 9.078

Base Type (Left / Right)

L  
7.67 - 9.078

Shoulder Type & Width (Left / Right)

5 (7/7')  
7.67 - 9.078

Through Lanes

2  
0 - 14.037

Street Name

SR 266  
4.15 - 14.037

- |                     |                   |                      |              |
|---------------------|-------------------|----------------------|--------------|
| Non-divided Highway | Bridge (on route) | Railroad (at grade)  | Intersection |
| Divided Highway     | Underpass         | Railroad (underpass) |              |
| Secondary Segment   | Overpass          | Railroad (overpass)  |              |
| Corporation         |                   |                      |              |

Created on: 7/3/2025



transportation.ohio.gov  
 Prepared by  
 The Ohio Department of Transportation  
 Office of Technical Services  
 Roadway Information

# SMRGSR00266\*\*C

State True Log

10

County True Log

9.00

9.25

9.50

9.75

10.00



**Surface Type & Width (Left / Right)**

G 22'	G 20'
7.67 - 9.078	9.078 - 13.966

**Base Type (Left / Right)**

L	I
7.67 - 9.078	9.078 - 13.966

**Shoulder Type & Width (Left / Right)**

5 (7'7')	2 (2'1/2')
7.67 - 9.078	9.078 - 13.966

**Through Lanes**

2	0 - 14.037
---	------------

**Street Name**

SR 266	4.15 - 14.037
--------	---------------

- Non-divided Highway
- Divided Highway
- Secondary Segment
- Corporation
- Bridge (on route)
- Underpass
- Overpass
- Railroad (at grade)
- Railroad (underpass)
- Railroad (overpass)
- Intersection

Created on: 7/3/2025

transportation.ohio.gov

Prepared by  
The Ohio Department of Transportation  
Office of Technical Services  
Roadway Information

# SMRGSR00266\*\*C

State True Log

11

County True Log

10.00

10.25

10.50

10.75

11.00



Surface Type & Width (Left / Right)

G 20'  
9.078 - 13.966

Base Type (Left / Right)

I  
9.078 - 13.966

Shoulder Type & Width (Left / Right)

2 (2'/2')  
9.078 - 13.966

Through Lanes

2  
0 - 14.037

Street Name

SR 266  
4.15 - 14.037

- |                     |                   |                      |              |
|---------------------|-------------------|----------------------|--------------|
| Non-divided Highway | Bridge (on route) | Railroad (at grade)  | Intersection |
| Divided Highway     | Underpass         | Railroad (underpass) |              |
| Secondary Segment   | Overpass          | Railroad (overpass)  |              |
| Corporation         |                   |                      |              |

Created on: 7/3/2025



transportation.ohio.gov

Prepared by  
The Ohio Department of Transportation  
Office of Technical Services  
Roadway Information

# SMRGSR00266\*\*C

State True Log

County True Log

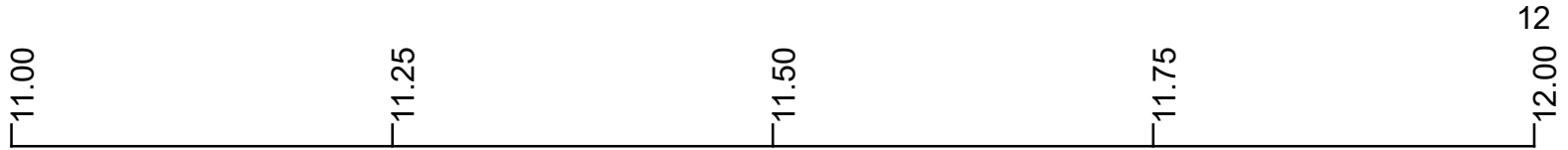

Surface Type & Width (Left / Right)

G 20'  
9.078 - 13.966

Base Type (Left / Right)

I  
9.078 - 13.966

Shoulder Type & Width (Left / Right)

2 (2'/2')  
9.078 - 13.966

Through Lanes

2  
0 - 14.037

Street Name

SR 266  
4.15 - 14.037

- Non-divided Highway
  Bridge (on route)
  Railroad (at grade)
  Intersection
- Divided Highway
  Underpass
  Railroad (underpass)
- Secondary Segment
  Overpass
  Railroad (overpass)
- Corporation**

Created on: 7/3/2025



transportation.ohio.gov

Prepared by  
The Ohio Department of Transportation  
Office of Technical Services  
Roadway Information

# SMRGSR00266\*\*C

State True Log

13

County True Log

12.00

12.25

12.50

12.75

13.00

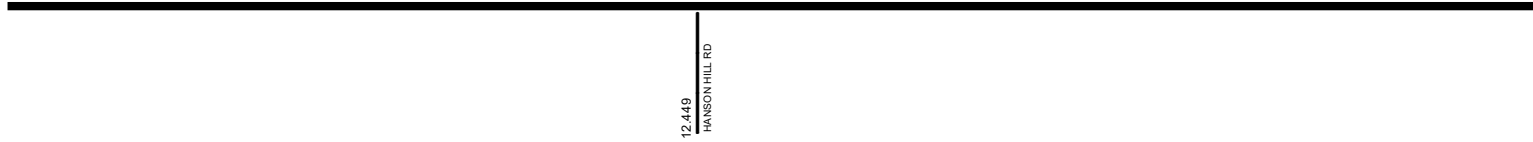

Surface Type & Width (Left / Right)

G 20'  
9.078 - 13.966

Base Type (Left / Right)

I  
9.078 - 13.966

Shoulder Type & Width (Left / Right)

2 (2/2)  
9.078 - 13.966

Through Lanes

2  
0 - 14.037

Street Name

SR 266  
4.15 - 14.037

- |                     |                   |                      |              |
|---------------------|-------------------|----------------------|--------------|
| Non-divided Highway | Bridge (on route) | Railroad (at grade)  | Intersection |
| Divided Highway     | Underpass         | Railroad (underpass) |              |
| Secondary Segment   | Overpass          | Railroad (overpass)  |              |
| <b>Corporation</b>  |                   |                      |              |

Created on: 7/3/2025

transportation.ohio.gov

Prepared by  
The Ohio Department of Transportation  
Office of Technical Services  
Roadway Information

# SMRGSR00266\*\*C

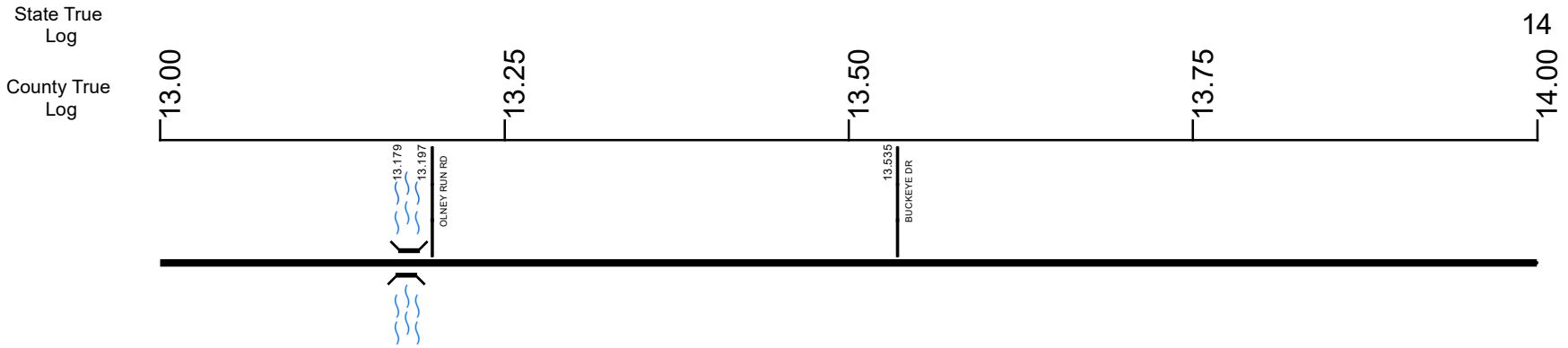

Surface Type & Width (Left / Right)	G 20'	G 22'
	9.078 - 13.966	13.966 - 14.037
Base Type (Left / Right)	I	L
	9.078 - 13.966	13.966 - 14.037
Shoulder Type & Width (Left / Right)	2 (2'/2')	5 (4'/4')
	9.078 - 13.966	13.966 - 14.037
Through Lanes	2	
	0 - 14.037	
Street Name	SR 266	
	4.15 - 14.037	

- Non-divided Highway
- Divided Highway
- Secondary Segment
- Corporation
- Bridge (on route)
- Underpass
- Overpass
- Railroad (at grade)
- Railroad (underpass)
- Railroad (overpass)
- Intersection

Created on: 7/3/2025



transportation.ohio.gov

Prepared by  
The Ohio Department of Transportation  
Office of Technical Services  
Roadway Information

SMRGSR00266\*\*C

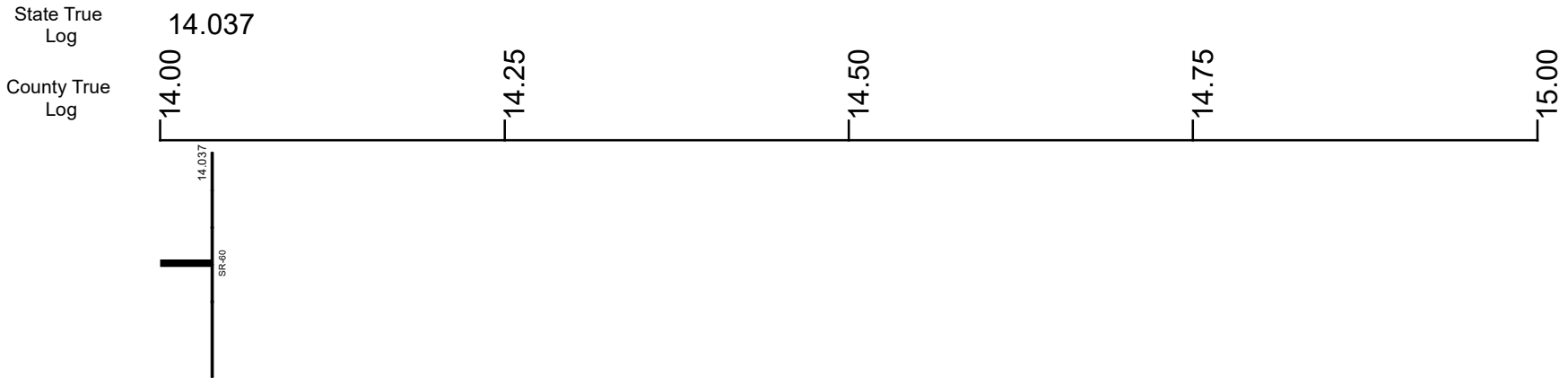

- Surface Type & Width (Left / Right)
  - G 22'
- 13.966 - 14.037
- Base Type (Left / Right)
  - L
- 13.966 - 14.037
- Shoulder Type & Width (Left / Right)
  - 5 (4/4)
- 13.966 - 14.037
- Through Lanes
  - 2
- 0 - 14.037
- Street Name
  - SR 266
- 4.15 - 14.037

Non-divided Highway	Bridge (on route)	Railroad (at grade)	Intersection
Divided Highway	Underpass	Railroad (underpass)	
Secondary Segment	Overpass	Railroad (overpass)	
Corporation			

Created on: 7/3/2025



transportation.ohio.gov

Prepared by  
The Ohio Department of Transportation  
Office of Technical Services  
Roadway Information

## Historical Project List for SMRGSR00266\*\*C

Begin Measure	End Measure	Project ID Number	Construction Completion Date	Treatment Category	Treatment Type
0.000	7.618	96644	3-2019	Minor Rehabilitation	60-AC Overlay w/Rpr
0.000	4.448	24823	6-2006	Minor Rehabilitation	50-AC Overlay w/o Rpr
9.147	14.037	96644	3-2019	Minor Rehabilitation	60-AC Overlay w/Rpr

# Roadway Codes

## Access Control Journalized

- F - Full Access Control
- L - Limited Access Control
- N - No Access Control

## Access Control Operational

- 1 - Full Access Control
- 2 - Partial Access Control
- 3 - No Access Control

## Base Type

- F - Crack and Seat
- H - Rubblize and Roll
- I - Aggregate Base 304 or Traffic Compacted
- K - Water Bound Macadam
- L - Bituminous Concrete Mix or Penetration Macadam
- N - Plain Concrete
- P - Reinforced Concrete
- R - Brick (Flexible)
- T - Brick (Rigid)

## Direction of Travel

- B - Both (Two-way)
- F - One-way Cardinal
- T - One-way Non-cardinal

## Facility Type

- 1 - One-way Roadway
- 2 - Two-way Roadway
- 4 - Ramp
- 5 - Non-mainline
- 6 - Non-inventory Direction
- 7 - Planned / Unbuilt

## Historical Federal Aid Indicator

- N - Not a FAP Route
- Y - FAP Route

## Functional Classification

- 01 - Interstate
- 02 - Principal Arterial (Freeways)
- 03 - Principal Arterial (Other)
- 04 - Minor Arterial
- 05 - Major Collector
- 06 - Minor Collector
- 07 - Local

## Leave / Reenter Indicator

- Y - Route leaves/reenters at this point
- N - Route does not leave/reenter at this point

## Median Type

- 1 - None
- 2 - Unprotected
- 3 - Curbed
- 4 - Positive Barrier (Unspecified)
- 5 - Positive Barrier (Flexible)
- 6 - Positive Barrier (Semi-rigid)
- 7 - Positive Barrier (Rigid)

## NHS

- N - National Highway System
- H - Congressional Corridor
- 2 - Major Airport
- 3 - Major Port Facility
- 4 - Major Amtrak Station
- 5 - Major Rail / Truck Terminal
- 6 - Major Intercity Bus Terminal
- 7 - Major Public Transit / Multi-modal Passenger Terminal
- 8 - Major Pipeline Terminal
- 9 - Major Ferry Terminal

## Priority System

- G - General
- P - Priority System
- U - Urban

## Scenic Byway Code

- A - All American Road
- N - National Scenic Byway
- S - State Scenic Byway

## Shoulder Type

- 1 - None
- 2 - Surfaced shoulder exists (bituminous concrete {AC})
- 3 - Surfaced shoulder exists (Portland Cement Concrete {PCC})
- 4 - Stabilized shoulder exists (gravel or other granular material)
- 5 - Combination shoulder exists (two or more surface types)
- 6 - Earth shoulder exists
- 7 - Barrier curb exists; no shoulder in front of curb

## Surface Type

- A - Combination
- B - Brick
- C - Continuous Reinforced Concrete
- D - Reinforced Concrete
- E - Plain Concrete
- G - Bituminous Concrete
- I - Chipseal on Granular
- K - Open Graded Bituminous
- L - Chipseal or Micro
- M - Gravel
- U - Unimproved
- X - Right of Way Only