

# SMRGSR00377\*\*C

State True Log 1.516

2.516

County True Log



Surface Type & Width (Left / Right)

G (16'4')  
0 - 2.844

Base Type (Left / Right)

K / I  
0 - 2.844

Shoulder Type & Width (Left / Right)

5 (2'2')  
0 - 3.108

Resurface Year

2023  
0 - 16.863

Through Lanes

2  
0 - 16.863

Street Name

SR 377  
0 - 3.108

- |                     |                   |                      |              |
|---------------------|-------------------|----------------------|--------------|
| Non-divided Highway | Bridge (on route) | Railroad (at grade)  | Intersection |
| Divided Highway     | Underpass         | Railroad (underpass) |              |
| Secondary Segment   | Overpass          | Railroad (overpass)  |              |
| Corporation         |                   |                      |              |

Created on: 7/3/2025

transportation.ohio.gov

Prepared by  
The Ohio Department of Transportation  
Office of Technical Services  
Roadway Information

# SMRGSR00377\*\*C

State True Log

3.516

County True Log

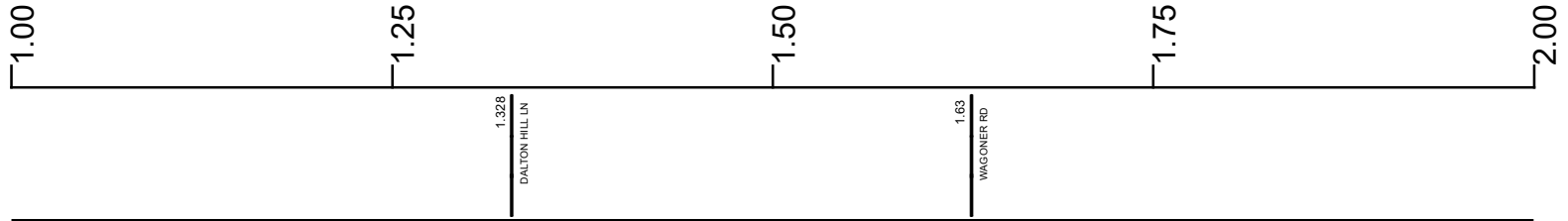

Surface Type & Width (Left / Right)

G (16'4')  
0 - 2.844

Base Type (Left / Right)

K / I  
0 - 2.844

Shoulder Type & Width (Left / Right)

5 (2'2')  
0 - 3.108

Resurface Year

2023  
0 - 16.863

Through Lanes

2  
0 - 16.863

Street Name

SR 377  
0 - 3.108

- |  |   |   |   |
|--|---|---|---|
| <ul style="list-style-type: none"> <li> Non-divided Highway</li> <li> Divided Highway</li> <li> Secondary Segment</li> <li> Corporation</li> </ul> | <ul style="list-style-type: none"> <li> Bridge (on route)</li> <li> Underpass</li> <li> Overpass</li> </ul> | <ul style="list-style-type: none"> <li> Railroad (at grade)</li> <li> Railroad (underpass)</li> <li> Railroad (overpass)</li> </ul> | <ul style="list-style-type: none"> <li> Intersection</li> </ul> |
|--|---|---|---|

Created on: 7/3/2025

transportation.ohio.gov

Prepared by  
The Ohio Department of Transportation  
Office of Technical Services  
Roadway Information

# SMRGSR00377\*\*C

State True Log

4.516

County True Log

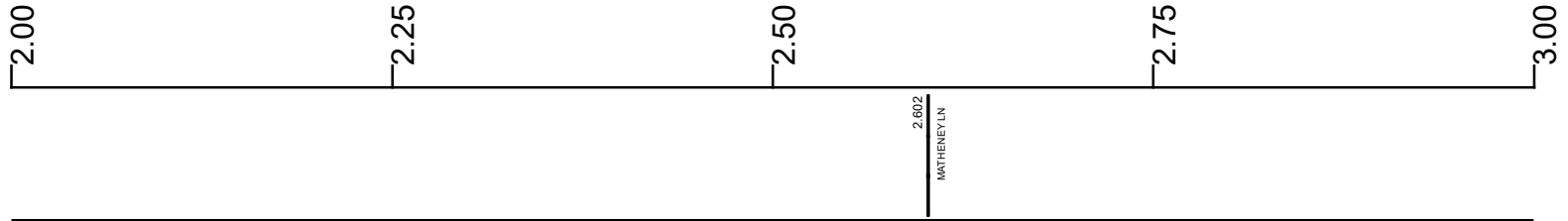

**Surface Type & Width (Left / Right)**

G (16/4) 0 - 2.844	G 20' 2.844 - 3.108
-----------------------	------------------------

**Base Type (Left / Right)**

K / I 0 - 2.844	N 2.844 - 3.108
--------------------	--------------------

**Shoulder Type & Width (Left / Right)**

5 (2/2) 0 - 3.108	
----------------------	--

**Resurface Year**

2023 0 - 16.863	
--------------------	--

**Through Lanes**

2 0 - 16.863	
-----------------	--

**Street Name**

SR 377 0 - 3.108	
---------------------	--

- Non-divided Highway
- Divided Highway
- Secondary Segment
- Corporation
- Bridge (on route)
- Underpass
- Overpass
- Railroad (at grade)
- Railroad (underpass)
- Railroad (overpass)
- Intersection

Created on: 7/3/2025

transportation.ohio.gov

Prepared by  
The Ohio Department of Transportation  
Office of Technical Services  
Roadway Information

# SMRGSR00377\*\*C

State True Log

5.516

County True Log

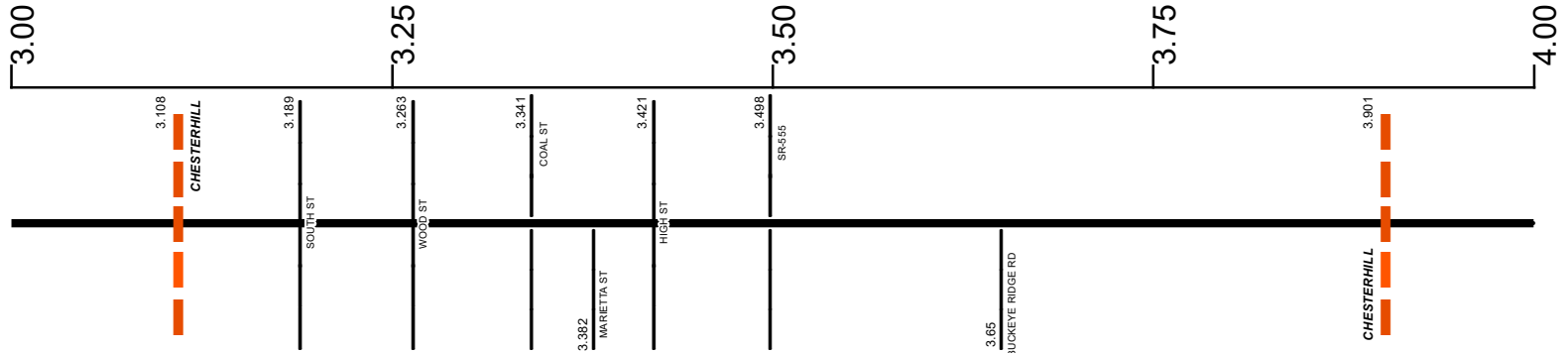

**Surface Type & Width (Left / Right)**

G 20'	G 34'	G 20'	G 18'
2.844 - 3.108	3.108 - 3.665	3.665 - 3.901	3.901 - 4.423

**Base Type (Left / Right)**

N	K / I	K
2.844 - 3.108	3.108 - 3.901	3.901 - 4.423

**Shoulder Type & Width (Left / Right)**

5 (2'/2')	1 (0'/0')	3 (4'/4')	5 (2'/2')
0 - 3.108	3.108 - 3.665	3.665 - 3.901	3.901 - 10.187

**Resurface Year**

	2023
	0 - 16.863

**Through Lanes**

	2
	0 - 16.863

**Street Name**

SR 377	MARION ST	SR 377
0 - 3.108	3.108 - 3.901	3.901 - 16.863

<p> Non-divided Highway</p> <p> Divided Highway</p> <p> Secondary Segment</p> <p> Corporation</p>	<p> Bridge (on route)</p> <p> Underpass</p> <p> Overpass</p>	<p> Railroad (at grade)</p> <p> Railroad (underpass)</p> <p> Railroad (overpass)</p>	<p> Intersection</p>
---	--	--	----------------------

Created on: 7/3/2025

transportation.ohio.gov

Prepared by

The Ohio Department of Transportation

Office of Technical Services

Roadway Information

# SMRGSR00377\*\*C

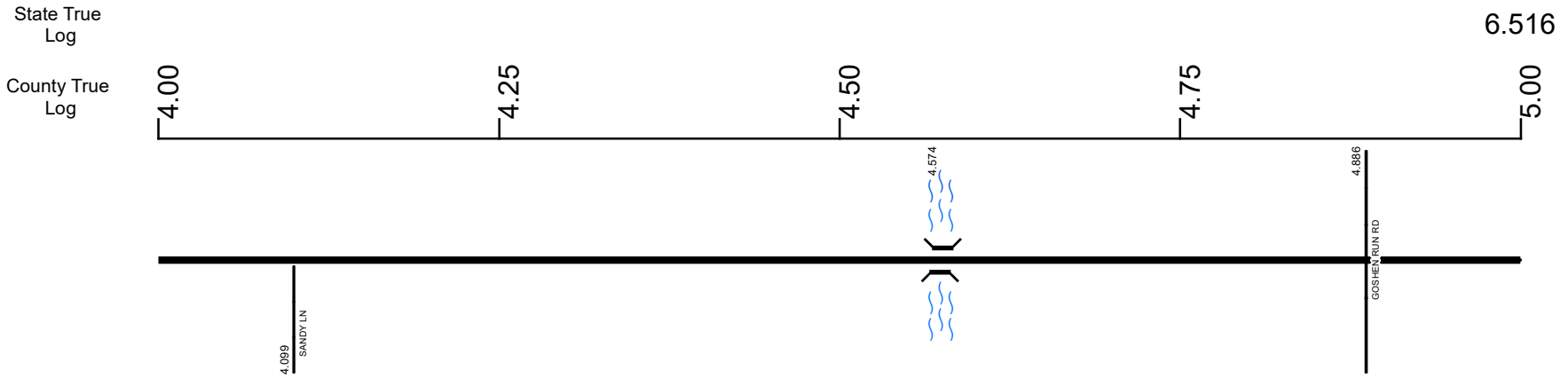

Surface Type & Width (Left / Right)		
G 18'	G 20'	G 18'
3.901 - 4.423	4.423 - 4.771	4.771 - 10.187
Base Type (Left / Right)		
K	L	K
3.901 - 4.423	4.423 - 4.771	4.771 - 10.187
Shoulder Type & Width (Left / Right)		
5 (2/2')		
3.901 - 10.187		
Resurface Year		
2023		
Through Lanes		
0 - 16.863		
Street Name		
SR 377		
3.901 - 16.863		

<ul style="list-style-type: none"> <li> Non-divided Highway</li> <li> Divided Highway</li> <li> Secondary Segment</li> <li> Corporation</li> </ul>	<ul style="list-style-type: none"> <li> Bridge (on route)</li> <li> Underpass</li> <li> Overpass</li> </ul>	<ul style="list-style-type: none"> <li> Railroad (at grade)</li> <li> Railroad (underpass)</li> <li> Railroad (overpass)</li> </ul>	<ul style="list-style-type: none"> <li> Intersection</li> </ul>
--	---	---	---

Created on: 7/3/2025

transportation.ohio.gov

Prepared by  
 The Ohio Department of Transportation  
 Office of Technical Services  
 Roadway Information

# SMRGSR00377\*\*C

State True Log

7.516

County True Log

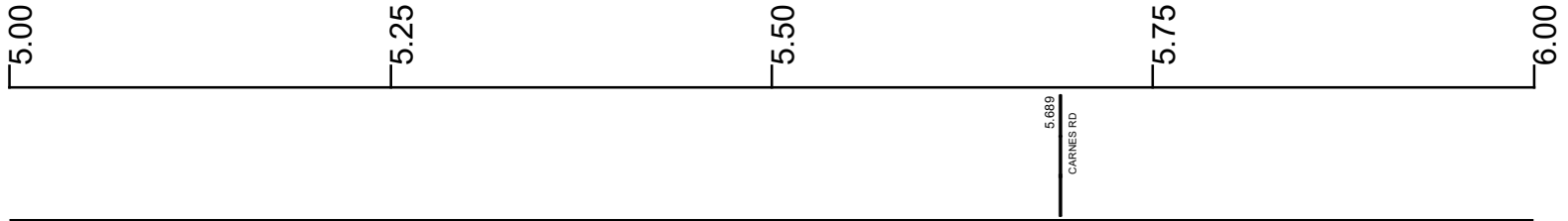

Surface Type & Width (Left / Right)

G 18'  
4.771 - 10.187

Base Type (Left / Right)

K  
4.771 - 10.187

Shoulder Type & Width (Left / Right)

5 (2/2)  
3.901 - 10.187

Resurface Year

2023

Through Lanes

0 - 16.863  
2

Street Name

SR 377  
3.901 - 16.863

- Non-divided Highway
  Bridge (on route)
  Railroad (at grade)
  Intersection
- Divided Highway
  Underpass
  Railroad (underpass)
- Secondary Segment
  Overpass
  Railroad (overpass)
- Corporation**

Created on: 7/3/2025



transportation.ohio.gov

Prepared by  
The Ohio Department of Transportation  
Office of Technical Services  
Roadway Information

# SMRGSR00377\*\*C

State True Log

8.516

County True Log

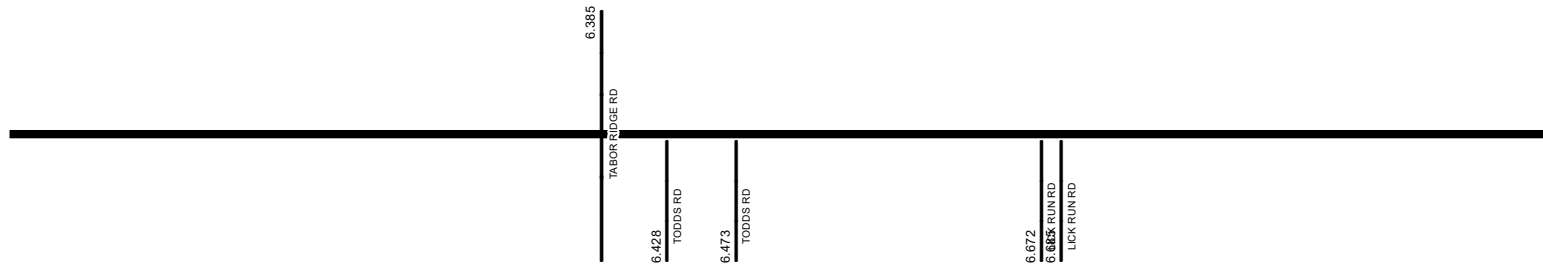

Surface Type & Width (Left / Right)

G 18'  
4.771 - 10.187

Base Type (Left / Right)

K  
4.771 - 10.187

Shoulder Type & Width (Left / Right)

5 (2/2)  
3.901 - 10.187

Resurface Year

2023

Through Lanes

0 - 16.863  
2

Street Name

SR 377  
3.901 - 16.863

<p> Non-divided Highway</p> <p> Divided Highway</p> <p> Secondary Segment</p> <p> Corporation</p>	<p> Bridge (on route)</p> <p> Underpass</p> <p> Overpass</p>	<p> Railroad (at grade)</p> <p> Railroad (underpass)</p> <p> Railroad (overpass)</p>	<p> Intersection</p>
---	--	--	----------------------

Created on: 7/3/2025

transportation.ohio.gov

Prepared by  
The Ohio Department of Transportation  
Office of Technical Services  
Roadway Information

# SMRGSR00377\*\*C

State True Log

9.516

County True Log

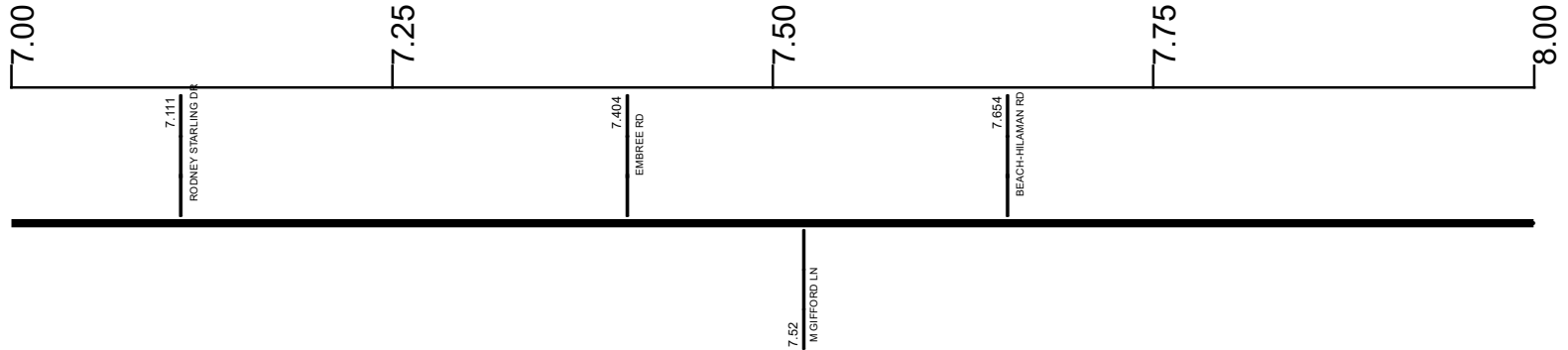

Surface Type & Width (Left / Right)

G 18'  
4.771 - 10.187

Base Type (Left / Right)

K  
4.771 - 10.187

Shoulder Type & Width (Left / Right)

5 (2/2)  
3.901 - 10.187

Resurface Year

2023

Through Lanes

2  
0 - 16.863

Street Name

SR 377  
3.901 - 16.863

- |                     |                   |                      |              |
|---------------------|-------------------|----------------------|--------------|
| Non-divided Highway | Bridge (on route) | Railroad (at grade)  | Intersection |
| Divided Highway     | Underpass         | Railroad (underpass) |              |
| Secondary Segment   | Overpass          | Railroad (overpass)  |              |
| Corporation         |                   |                      |              |

Created on: 7/3/2025

transportation.ohio.gov

Prepared by  
The Ohio Department of Transportation  
Office of Technical Services  
Roadway Information

# SMRGSR00377\*\*C

State True Log

10.516

County True Log

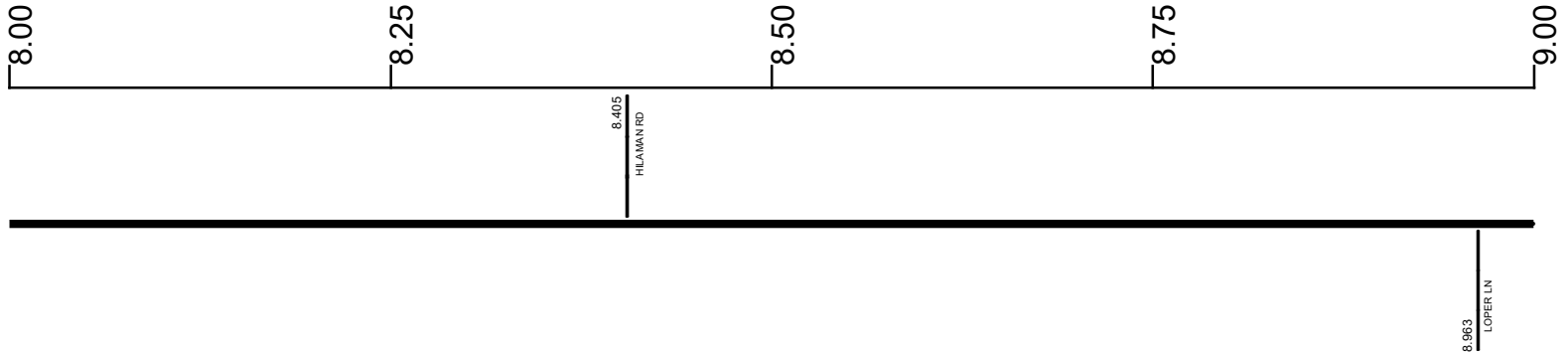

Surface Type & Width (Left / Right)

G 18'  
4.771 - 10.187

Base Type (Left / Right)

K  
4.771 - 10.187

Shoulder Type & Width (Left / Right)

5 (2/2)  
3.901 - 10.187

Resurface Year

2023

Through Lanes

2  
0 - 16.863

Street Name

SR 377  
3.901 - 16.863

- |                     |                   |                      |              |
|---------------------|-------------------|----------------------|--------------|
| Non-divided Highway | Bridge (on route) | Railroad (at grade)  | Intersection |
| Divided Highway     | Underpass         | Railroad (underpass) |              |
| Secondary Segment   | Overpass          | Railroad (overpass)  |              |
| Corporation         |                   |                      |              |

Created on: 7/3/2025



transportation.ohio.gov  
 Prepared by  
 The Ohio Department of Transportation  
 Office of Technical Services  
 Roadway Information

# SMRGSR00377\*\*C

State True Log

11.516

County True Log



9.115  
DOWNING RD  
9.136  
DOWNING RD

9.434  
POWELL LN

9.812  
SR-266

**Surface Type & Width (Left / Right)**

G 18'  
4.771 - 10.187

**Base Type (Left / Right)**

K  
4.771 - 10.187

**Shoulder Type & Width (Left / Right)**

5 (2/2)  
3.901 - 10.187

**Resurface Year**

2023

**Through Lanes**

2  
0 - 16.863

**Street Name**

SR 377  
3.901 - 16.863

- Non-divided Highway
- Divided Highway
- Secondary Segment
- Corporation
- Bridge (on route)
- Underpass
- Overpass
- Railroad (at grade)
- Railroad (underpass)
- Railroad (overpass)
- Intersection

Created on: 7/3/2025

transportation.ohio.gov

Prepared by  
The Ohio Department of Transportation  
Office of Technical Services  
Roadway Information

# SMRGSR00377\*\*C

State True Log  
County True Log

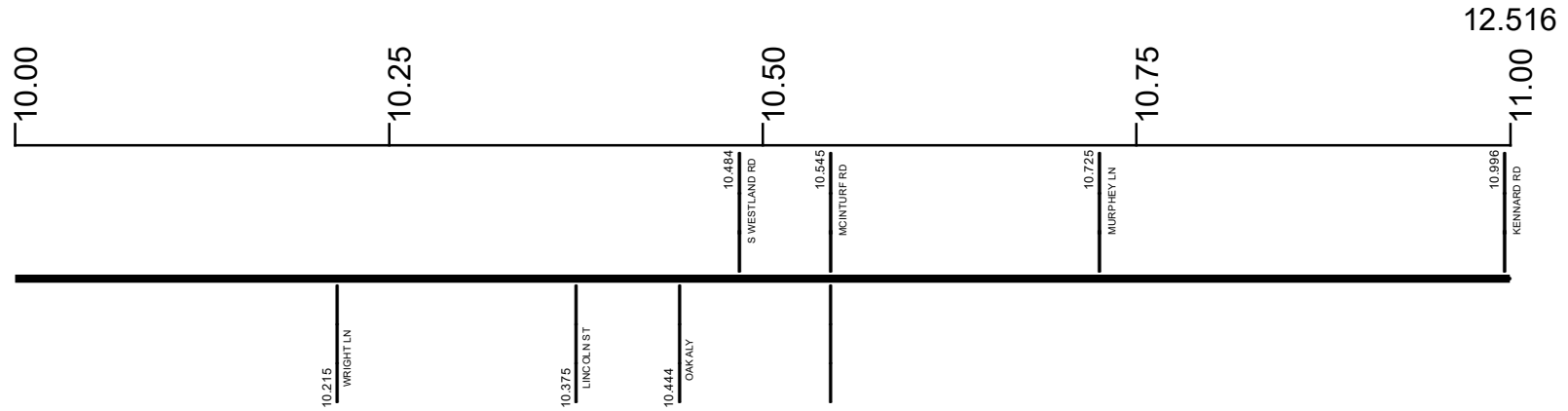

**Surface Type & Width (Left / Right)**

G 18'	G 36'	G 18'
4.771 - 10.187	10.187 - 10.955	10.955 - 16.863

**Base Type (Left / Right)**

K	N	K
4.771 - 10.187	10.187 - 10.955	10.955 - 12.454

**Shoulder Type & Width (Left / Right)**

5 (2'2')	1 (0'0')	2 (3'3')
3.901 - 10.187	10.187 - 10.955	10.955 - 12.454

**Resurface Year**

	2023	
	0 - 16.863	

**Through Lanes**

	2	
	0 - 16.863	

**Street Name**

	SR 377	
	3.901 - 16.863	

- Non-divided Highway
- Divided Highway
- Secondary Segment
- Corporation
- Bridge (on route)
- Underpass
- Overpass
- Railroad (at grade)
- Railroad (underpass)
- Railroad (overpass)
- Intersection

Created on: 7/3/2025

transportation.ohio.gov

Prepared by  
The Ohio Department of Transportation  
Office of Technical Services  
Roadway Information

# SMRGSR00377\*\*C

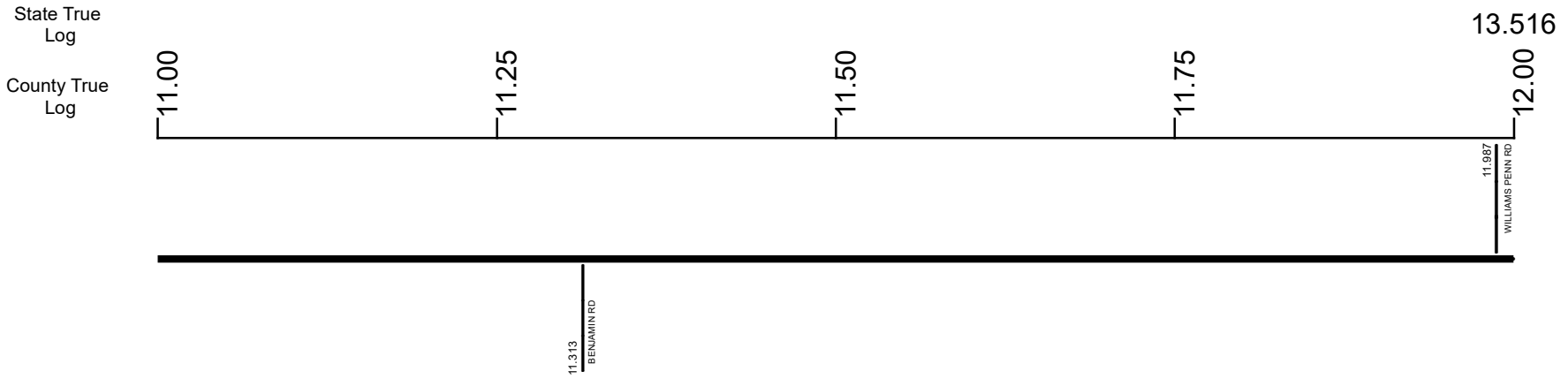

Surface Type & Width (Left / Right)	G 18'
	10.955 - 16.863
Base Type (Left / Right)	K
	10.955 - 12.454
Shoulder Type & Width (Left / Right)	2 (3/3)
	10.955 - 12.454
Resurface Year	2023
Through Lanes	0 - 16.863
	2
	0 - 16.863
Street Name	SR 377
	3.901 - 16.863

Non-divided Highway	Bridge (on route)	Railroad (at grade)	Intersection
Divided Highway	Underpass	Railroad (underpass)	
Secondary Segment	Overpass	Railroad (overpass)	
Corporation			

Created on: 7/3/2025



transportation.ohio.gov

Prepared by  
The Ohio Department of Transportation  
Office of Technical Services  
Roadway Information

# SMRGSR00377\*\*C

State True Log

14.516

County True Log

12.00

12.25

12.50

12.75

13.00



12.872  
GENE ROBERTS LN

**Surface Type & Width (Left / Right)**

G 18'	
10.955 - 16.863	

**Base Type (Left / Right)**

K	I
10.955 - 12.454	12.454 - 16.863

**Shoulder Type & Width (Left / Right)**

2 (3/3')	5 (2/2')
10.955 - 12.454	12.454 - 14.588

**Resurface Year**

2023
------

**Through Lanes**

0 - 16.863
2
0 - 16.863

**Street Name**

SR 377
3.901 - 16.863

- |                     |                   |                      |              |
|---------------------|-------------------|----------------------|--------------|
| Non-divided Highway | Bridge (on route) | Railroad (at grade)  | Intersection |
| Divided Highway     | Underpass         | Railroad (underpass) |              |
| Secondary Segment   | Overpass          | Railroad (overpass)  |              |
| Corporation         |                   |                      |              |

Created on: 7/3/2025

transportation.ohio.gov

Prepared by  
The Ohio Department of Transportation  
Office of Technical Services  
Roadway Information

# SMRGSR00377\*\*C

State True Log

15.516

County True Log

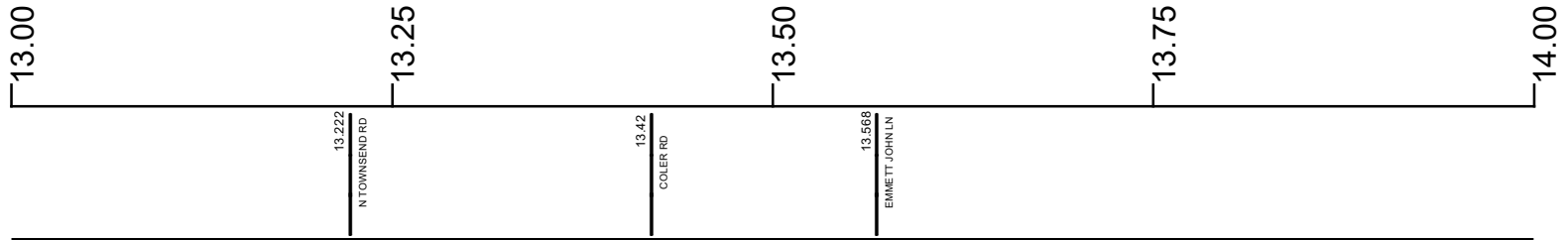

Surface Type & Width (Left / Right)

G 18'  
10.955 - 16.863

Base Type (Left / Right)

I  
12.454 - 16.863

Shoulder Type & Width (Left / Right)

5 (2/2)  
12.454 - 14.588

Resurface Year

2023

Through Lanes

2  
0 - 16.863

Street Name

SR 377  
3.901 - 16.863

- Non-divided Highway
  Bridge (on route)
  Railroad (at grade)
  Intersection
- Divided Highway
  Underpass
  Railroad (underpass)
- Secondary Segment
  Overpass
  Railroad (overpass)
- Corporation**

Created on: 7/3/2025

transportation.ohio.gov

Prepared by  
The Ohio Department of Transportation  
Office of Technical Services  
Roadway Information

# SMRGSR00377\*\*C

State True Log

16.516

County True Log

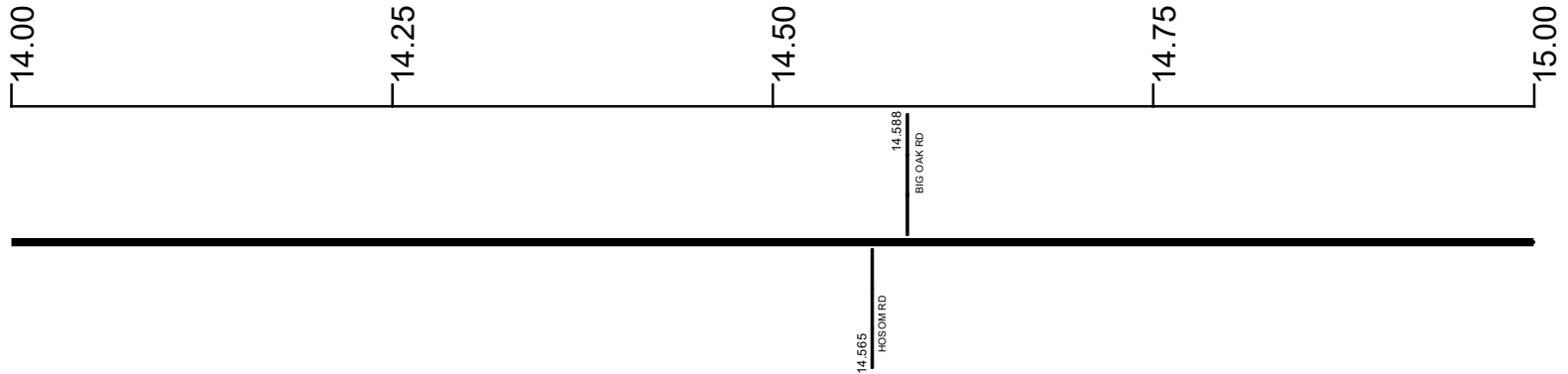

Surface Type & Width (Left / Right)

G 18'	
10.955 - 16.863	

Base Type (Left / Right)

I	
12.454 - 16.863	

Shoulder Type & Width (Left / Right)

5 (2'/2')	2 (3'/3')
12.454 - 14.588	14.588 - 16.863

Resurface Year

2023	
0 - 16.863	

Through Lanes

2	
0 - 16.863	

Street Name

SR 377	
3.901 - 16.863	

- |                     |                   |                      |              |
|---------------------|-------------------|----------------------|--------------|
| Non-divided Highway | Bridge (on route) | Railroad (at grade)  | Intersection |
| Divided Highway     | Underpass         | Railroad (underpass) |              |
| Secondary Segment   | Overpass          | Railroad (overpass)  |              |
| Corporation         |                   |                      |              |

Created on: 7/3/2025

transportation.ohio.gov

Prepared by  
The Ohio Department of Transportation  
Office of Technical Services  
Roadway Information

# SMRGSR00377\*\*C

State True Log

17.516

County True Log

15.00

15.25

15.50

15.75

16.00



Surface Type & Width (Left / Right)

G 18'  
10.955 - 16.863

Base Type (Left / Right)

I  
12.454 - 16.863

Shoulder Type & Width (Left / Right)

2 (3/3)  
14.588 - 16.863

Resurface Year

2023

Through Lanes

0 - 16.863  
2  
0 - 16.863

Street Name

SR 377  
3.901 - 16.863

- Non-divided Highway
  Bridge (on route)
  Railroad (at grade)
  Intersection
- Divided Highway
  Underpass
  Railroad (underpass)
- Secondary Segment
  Overpass
  Railroad (overpass)
- Corporation**

Created on: 7/3/2025

transportation.ohio.gov

Prepared by  
The Ohio Department of Transportation  
Office of Technical Services  
Roadway Information

# SMRGSR00377\*\*C

State True Log

18.379

County True Log

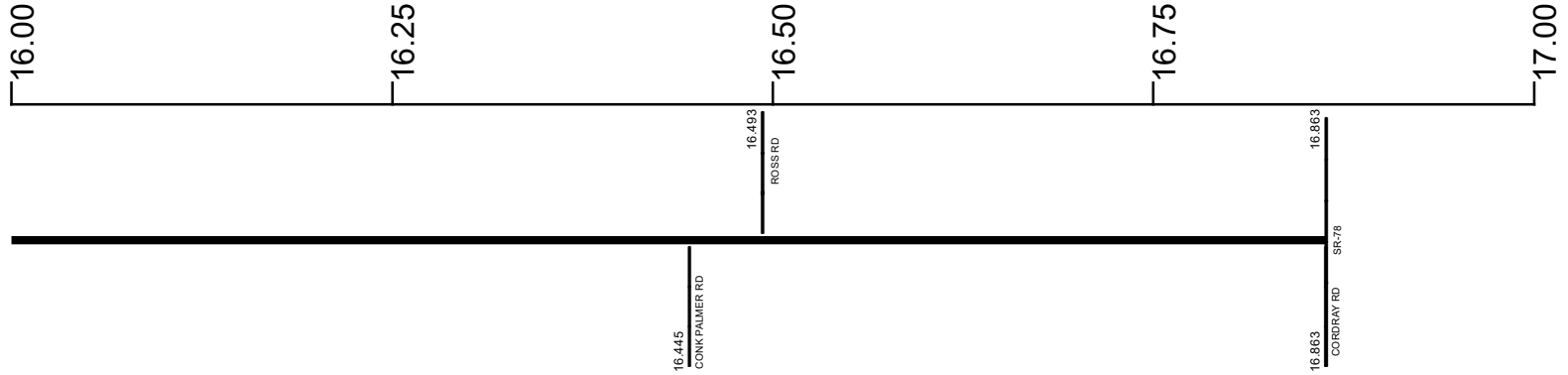

Surface Type & Width (Left / Right)	G 18' 10.955 - 16.863
Base Type (Left / Right)	I 12.454 - 16.863
Shoulder Type & Width (Left / Right)	2 (3'/3') 14.588 - 16.863
Resurface Year	2023
Through Lanes	0 - 16.863
Street Name	SR 377 3.901 - 16.863

- Non-divided Highway
- Divided Highway
- Secondary Segment
- Corporation
- Bridge (on route)
- Underpass
- Overpass
- Railroad (at grade)
- Railroad (underpass)
- Railroad (overpass)
- Intersection

Created on: 7/3/2025

transportation.ohio.gov

Prepared by  
The Ohio Department of Transportation  
Office of Technical Services  
Roadway Information

## Historical Project List for SMRGSR00377\*\*C

Begin Measure	End Measure	Project ID Number	Construction Completion Date	Treatment Category	Treatment Type
0.000	16.863	96665	12-2023	Minor Rehabilitation	60-AC Overlay w/Rpr
0.000	10.178	84575	8-2014	Minor Rehabilitation	50-AC Overlay w/o Rpr
0.000	3.101	24751	10-2003	Minor Rehabilitation	50-AC Overlay w/o Rpr
3.898	10.188	24751	10-2003	Minor Rehabilitation	50-AC Overlay w/o Rpr
10.178	16.863	87009	5-2013	Minor Rehabilitation	50-AC Overlay w/o Rpr

# Roadway Codes

## Access Control Journalized

- F - Full Access Control
- L - Limited Access Control
- N - No Access Control

## Access Control Operational

- 1 - Full Access Control
- 2 - Partial Access Control
- 3 - No Access Control

## Base Type

- F - Crack and Seat
- H - Rubblize and Roll
- I - Aggregate Base 304 or Traffic Compacted
- K - Water Bound Macadam
- L - Bituminous Concrete Mix or Penetration Macadam
- N - Plain Concrete
- P - Reinforced Concrete
- R - Brick (Flexible)
- T - Brick (Rigid)

## Direction of Travel

- B - Both (Two-way)
- F - One-way Cardinal
- T - One-way Non-cardinal

## Facility Type

- 1 - One-way Roadway
- 2 - Two-way Roadway
- 4 - Ramp
- 5 - Non-mainline
- 6 - Non-inventory Direction
- 7 - Planned / Unbuilt

## Historical Federal Aid Indicator

- N - Not a FAP Route
- Y - FAP Route

## Functional Classification

- 01 - Interstate
- 02 - Principal Arterial (Freeways)
- 03 - Principal Arterial (Other)
- 04 - Minor Arterial
- 05 - Major Collector
- 06 - Minor Collector
- 07 - Local

## Leave / Reenter Indicator

- Y - Route leaves/reenters at this point
- N - Route does not leave/reenter at this point

## Median Type

- 1 - None
- 2 - Unprotected
- 3 - Curbed
- 4 - Positive Barrier (Unspecified)
- 5 - Positive Barrier (Flexible)
- 6 - Positive Barrier (Semi-rigid)
- 7 - Positive Barrier (Rigid)

## NHS

- N - National Highway System
- H - Congressional Corridor
- 2 - Major Airport
- 3 - Major Port Facility
- 4 - Major Amtrak Station
- 5 - Major Rail / Truck Terminal
- 6 - Major Intercity Bus Terminal
- 7 - Major Public Transit / Multi-modal Passenger Terminal
- 8 - Major Pipeline Terminal
- 9 - Major Ferry Terminal

## Priority System

- G - General
- P - Priority System
- U - Urban

## Scenic Byway Code

- A - All American Road
- N - National Scenic Byway
- S - State Scenic Byway

## Shoulder Type

- 1 - None
- 2 - Surfaced shoulder exists (bituminous concrete {AC})
- 3 - Surfaced shoulder exists (Portland Cement Concrete {PCC})
- 4 - Stabilized shoulder exists (gravel or other granular material)
- 5 - Combination shoulder exists (two or more surface types)
- 6 - Earth shoulder exists
- 7 - Barrier curb exists; no shoulder in front of curb

## Surface Type

- A - Combination
- B - Brick
- C - Continuous Reinforced Concrete
- D - Reinforced Concrete
- E - Plain Concrete
- G - Bituminous Concrete
- I - Chipseal on Granular
- K - Open Graded Bituminous
- L - Chipseal or Micro
- M - Gravel
- U - Unimproved
- X - Right of Way Only