

SMRGSR00555**C

State True Log 19.412

20.412

County True Log

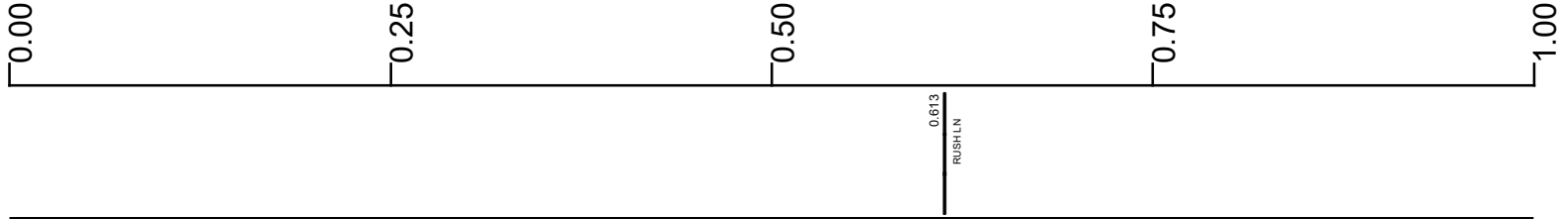

Surface Type & Width (Left / Right)

G 18'
0 - 3.274

Base Type (Left / Right)

I
0 - 3.274

Shoulder Type & Width (Left / Right)

2 (2'/2)
0 - 3.274

Through Lanes

2
0 - 3.274

Street Name

SR 555
0 - 2.907

- | | | | |
|---------------------|-------------------|----------------------|--------------|
| Non-divided Highway | Bridge (on route) | Railroad (at grade) | Intersection |
| Divided Highway | Underpass | Railroad (underpass) | |
| Secondary Segment | Overpass | Railroad (overpass) | |
| Corporation | | | |

Created on: 7/3/2025



transportation.ohio.gov
 Prepared by
 The Ohio Department of Transportation
 Office of Technical Services
 Roadway Information

SMRGSR00555**C

State True Log

21.412

County True Log

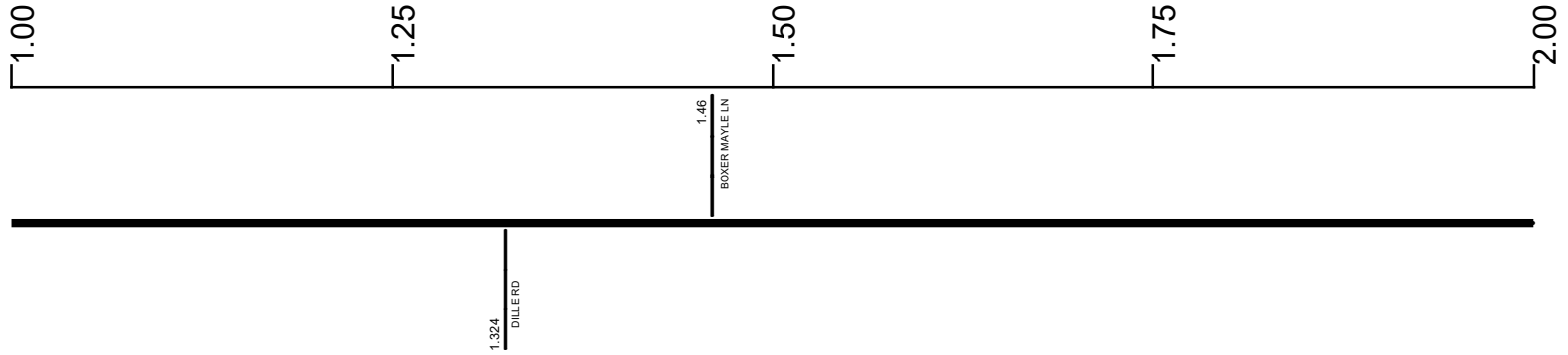

Surface Type & Width (Left / Right)

G 18'
0 - 3.274

Base Type (Left / Right)

I
0 - 3.274

Shoulder Type & Width (Left / Right)

2 (2 1/2)
0 - 3.274

Through Lanes

2
0 - 3.274

Street Name

SR 555
0 - 2.907

- | | | | |
|---------------------|-------------------|----------------------|--------------|
| Non-divided Highway | Bridge (on route) | Railroad (at grade) | Intersection |
| Divided Highway | Underpass | Railroad (underpass) | |
| Secondary Segment | Overpass | Railroad (overpass) | |
| Corporation | | | |

Created on: 7/3/2025

transportation.ohio.gov

Prepared by
The Ohio Department of Transportation
Office of Technical Services
Roadway Information

SMRGSR00555**C

State True Log

22.412

County True Log

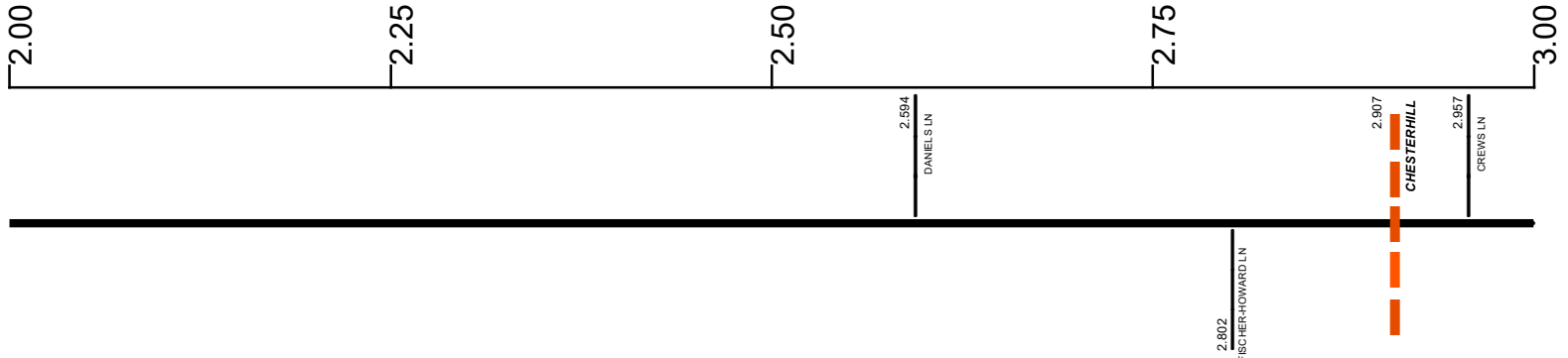

Surface Type & Width (Left / Right)

G 18'
0 - 3.274

Base Type (Left / Right)

I
0 - 3.274

Shoulder Type & Width (Left / Right)

2 (2 1/2)
0 - 3.274

Through Lanes

2
0 - 3.274

Street Name

SR 555 0 - 2.907	CHESTERHILL BARLETT RD 2.907 - 3.274
---------------------	---

- | | | | |
|---------------------|-------------------|----------------------|--------------|
| Non-divided Highway | Bridge (on route) | Railroad (at grade) | Intersection |
| Divided Highway | Underpass | Railroad (underpass) | |
| Secondary Segment | Overpass | Railroad (overpass) | |
| Corporation | | | |

Created on: 7/3/2025

transportation.ohio.gov

Prepared by
The Ohio Department of Transportation
Office of Technical Services
Roadway Information

SMRGSR00555**C

State True Log

24.412

County True Log

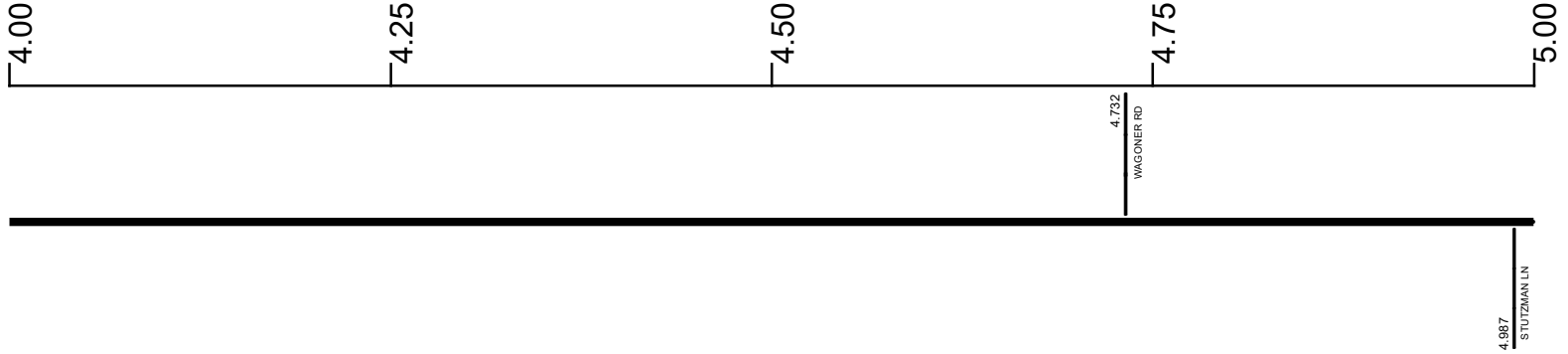

Surface Type & Width (Left / Right)

G 18'
3.676 - 15.219

Base Type (Left / Right)

I
3.431 - 15.219

Shoulder Type & Width (Left / Right)

2 (2'/2)
3.676 - 15.219

Through Lanes

2
3.431 - 15.219

Street Name

SR 555
3.849 - 15.219

- | | | | |
|---------------------|-------------------|----------------------|--------------|
| Non-divided Highway | Bridge (on route) | Railroad (at grade) | Intersection |
| Divided Highway | Underpass | Railroad (underpass) | |
| Secondary Segment | Overpass | Railroad (overpass) | |
| Corporation | | | |

Created on: 7/3/2025

transportation.ohio.gov

Prepared by
The Ohio Department of Transportation
Office of Technical Services
Roadway Information

SMRGSR00555**C

State True Log

25.412

County True Log

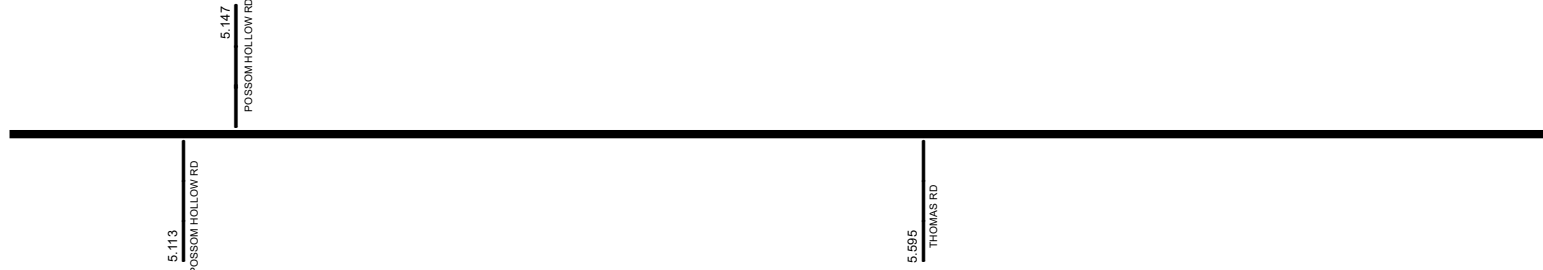

Surface Type & Width (Left / Right)

G 18'
3.676 - 15.219

Base Type (Left / Right)

I
3.431 - 15.219

Shoulder Type & Width (Left / Right)

2 (2'/2')
3.676 - 15.219

Through Lanes

2
3.431 - 15.219

Street Name

SR 555
3.849 - 15.219

- Non-divided Highway
 Bridge (on route)
 Railroad (at grade)
 Intersection
- Divided Highway
 Underpass
 Railroad (underpass)
- Secondary Segment
 Overpass
 Railroad (overpass)
- Corporation**

Created on: 7/3/2025



transportation.ohio.gov

Prepared by
The Ohio Department of Transportation
Office of Technical Services
Roadway Information

SMRGSR00555**C

State True Log

26.412

County True Log

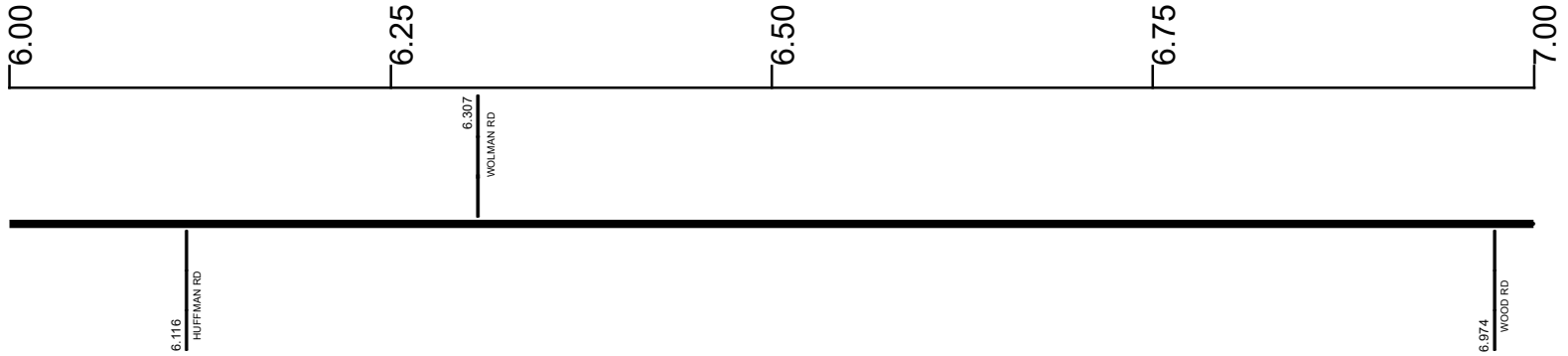

Surface Type & Width (Left / Right)

	G 18'
	3.676 - 15.219

Base Type (Left / Right)

	I
	3.431 - 15.219

Shoulder Type & Width (Left / Right)

	2 (2'/2')
	3.676 - 15.219

Through Lanes

	2
	3.431 - 15.219

Street Name

	SR 555
	3.849 - 15.219

- | | | | |
|--|---|---|---|
| <ul style="list-style-type: none"> Non-divided Highway Divided Highway Secondary Segment Corporation | <ul style="list-style-type: none"> Bridge (on route) Underpass Overpass | <ul style="list-style-type: none"> Railroad (at grade) Railroad (underpass) Railroad (overpass) | <ul style="list-style-type: none"> Intersection |
|--|---|---|---|

Created on: 7/3/2025

transportation.ohio.gov

Prepared by
The Ohio Department of Transportation
Office of Technical Services
Roadway Information

SMRGSR00555**C

State True Log

27.412

County True Log

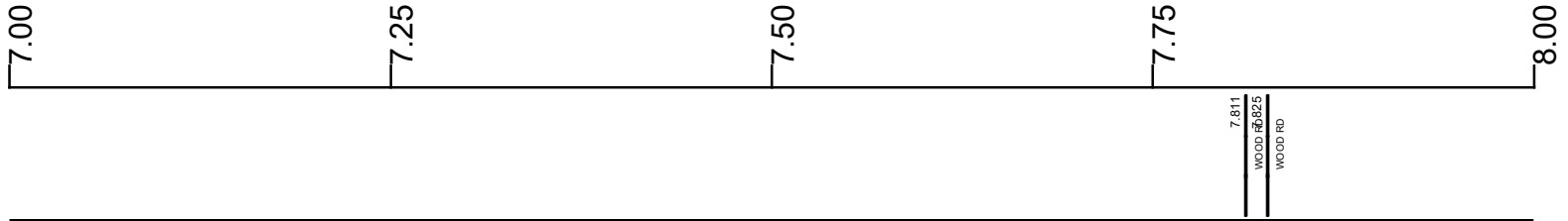

Surface Type & Width (Left / Right)

G 18'
3.676 - 15.219

Base Type (Left / Right)

I
3.431 - 15.219

Shoulder Type & Width (Left / Right)

2 (2'/2')
3.676 - 15.219

Through Lanes

2
3.431 - 15.219

Street Name

SR 555
3.849 - 15.219

- | | | | |
|---------------------|-------------------|----------------------|--------------|
| Non-divided Highway | Bridge (on route) | Railroad (at grade) | Intersection |
| Divided Highway | Underpass | Railroad (underpass) | |
| Secondary Segment | Overpass | Railroad (overpass) | |
| Corporation | | | |

Created on: 7/3/2025

transportation.ohio.gov

Prepared by
The Ohio Department of Transportation
Office of Technical Services
Roadway Information

SMRGSR00555**C

State True Log

28.412

County True Log

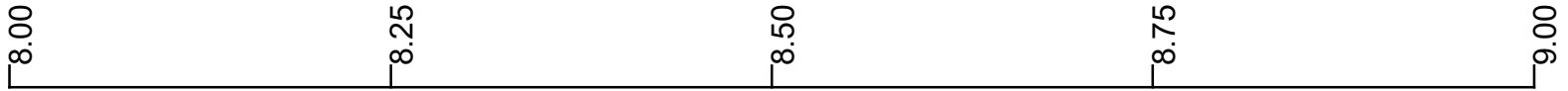

Surface Type & Width (Left / Right)

G 18'
3.676 - 15.219

Base Type (Left / Right)

I
3.431 - 15.219

Shoulder Type & Width (Left / Right)

2 (2'/2')
3.676 - 15.219

Through Lanes

2
3.431 - 15.219

Street Name

SR 555
3.849 - 15.219

- | | | | |
|---------------------|-------------------|----------------------|--------------|
| Non-divided Highway | Bridge (on route) | Railroad (at grade) | Intersection |
| Divided Highway | Underpass | Railroad (underpass) | |
| Secondary Segment | Overpass | Railroad (overpass) | |
| Corporation | | | |

Created on: 7/3/2025



transportation.ohio.gov

Prepared by
The Ohio Department of Transportation
Office of Technical Services
Roadway Information

SMRGSR00555**C

State True Log

29.412

County True Log

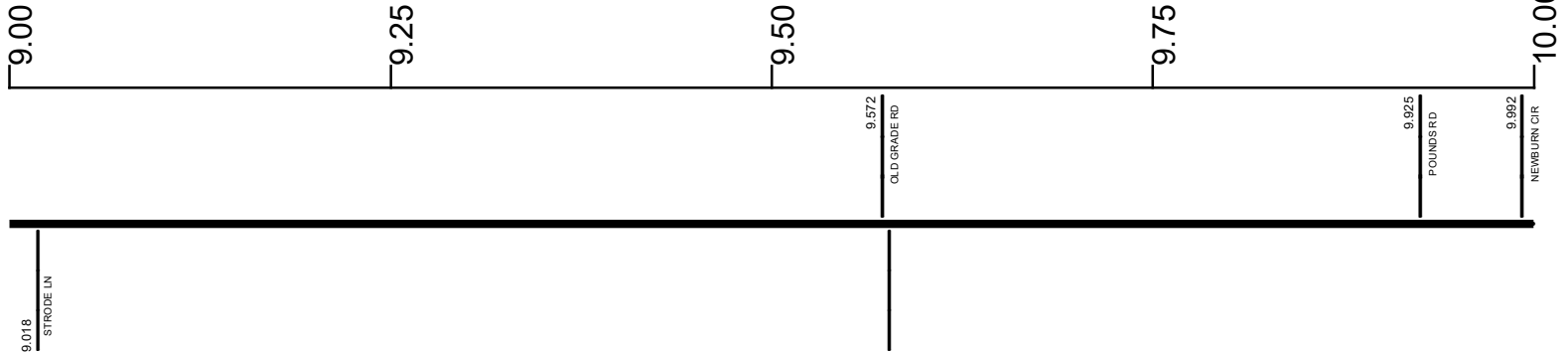

Surface Type & Width (Left / Right)

G 18'
3.676 - 15.219

Base Type (Left / Right)

I
3.431 - 15.219

Shoulder Type & Width (Left / Right)

2 (2'/2')
3.676 - 15.219

Through Lanes

2
3.431 - 15.219

Street Name

SR 555
3.849 - 15.219

- | | | | |
|---------------------|-------------------|----------------------|--------------|
| Non-divided Highway | Bridge (on route) | Railroad (at grade) | Intersection |
| Divided Highway | Underpass | Railroad (underpass) | |
| Secondary Segment | Overpass | Railroad (overpass) | |
| Corporation | | | |

Created on: 7/3/2025

transportation.ohio.gov

Prepared by
The Ohio Department of Transportation
Office of Technical Services
Roadway Information

SMRGSR00555**C

State True Log

30.412

County True Log

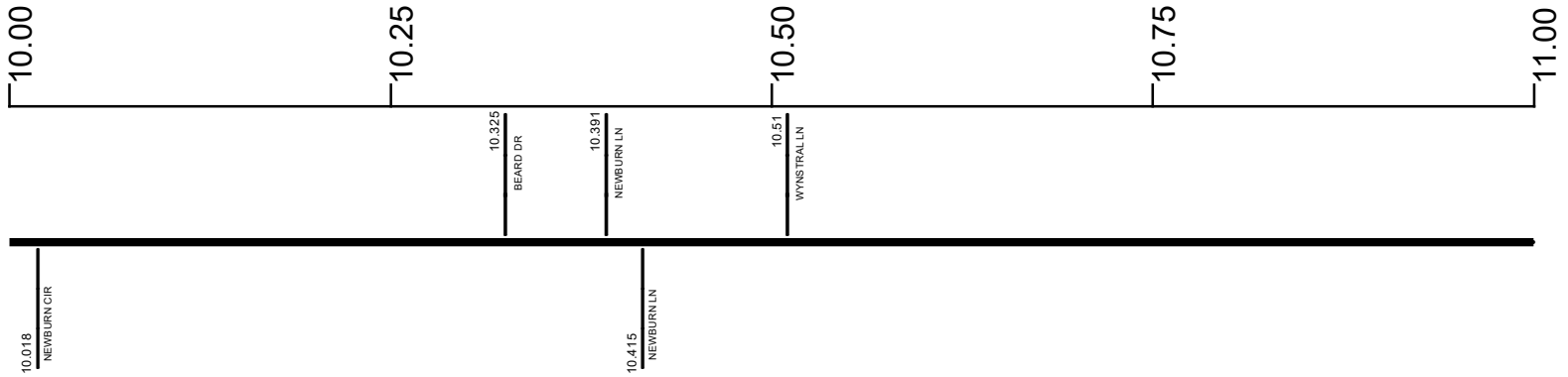

Surface Type & Width (Left / Right)

G 18'
3.676 - 15.219

Base Type (Left / Right)

I
3.431 - 15.219

Shoulder Type & Width (Left / Right)

2 (2/2)
3.676 - 15.219

Through Lanes

2
3.431 - 15.219

Street Name

SR 555
3.849 - 15.219

- | | | | |
|---------------------|-------------------|----------------------|--------------|
| Non-divided Highway | Bridge (on route) | Railroad (at grade) | Intersection |
| Divided Highway | Underpass | Railroad (underpass) | |
| Secondary Segment | Overpass | Railroad (overpass) | |
| Corporation | | | |

Created on: 7/3/2025

transportation.ohio.gov

Prepared by
The Ohio Department of Transportation
Office of Technical Services
Roadway Information

SMRGSR00555**C

State True Log

31.412

County True Log

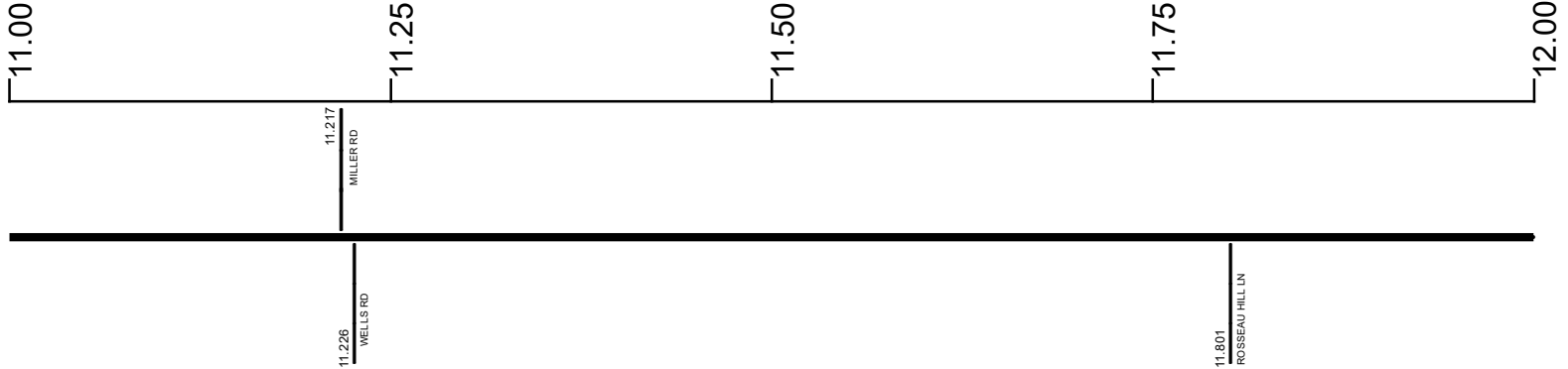

Surface Type & Width (Left / Right)

G 18'
3.676 - 15.219

Base Type (Left / Right)

I
3.431 - 15.219

Shoulder Type & Width (Left / Right)

2 (2'/2)
3.676 - 15.219

Through Lanes

2
3.431 - 15.219

Street Name

SR 555
3.849 - 15.219

- | | | | |
|---------------------|-------------------|----------------------|--------------|
| Non-divided Highway | Bridge (on route) | Railroad (at grade) | Intersection |
| Divided Highway | Underpass | Railroad (underpass) | |
| Secondary Segment | Overpass | Railroad (overpass) | |
| Corporation | | | |

Created on: 7/3/2025

transportation.ohio.gov

Prepared by
The Ohio Department of Transportation
Office of Technical Services
Roadway Information

SMRGSR00555**C

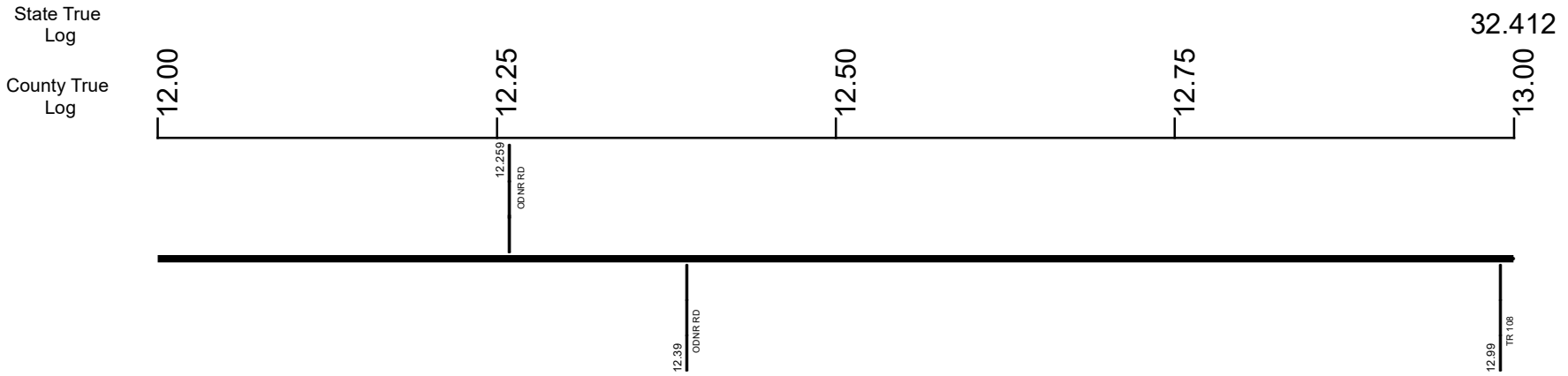

Surface Type & Width (Left / Right)	G 18'
	3.676 - 15.219
Base Type (Left / Right)	I
	3.431 - 15.219
Shoulder Type & Width (Left / Right)	2 (2'/2')
	3.676 - 15.219
Through Lanes	2
	3.431 - 15.219
Street Name	SR 555
	3.849 - 15.219

- Non-divided Highway
- Divided Highway
- Secondary Segment
- Corporation
- Bridge (on route)
- Underpass
- Overpass
- Railroad (at grade)
- Railroad (underpass)
- Railroad (overpass)
- Intersection

Created on: 7/3/2025



transportation.ohio.gov
 Prepared by
 The Ohio Department of Transportation
 Office of Technical Services
 Roadway Information

SMRGSR00555**C

State True Log

33.412

County True Log

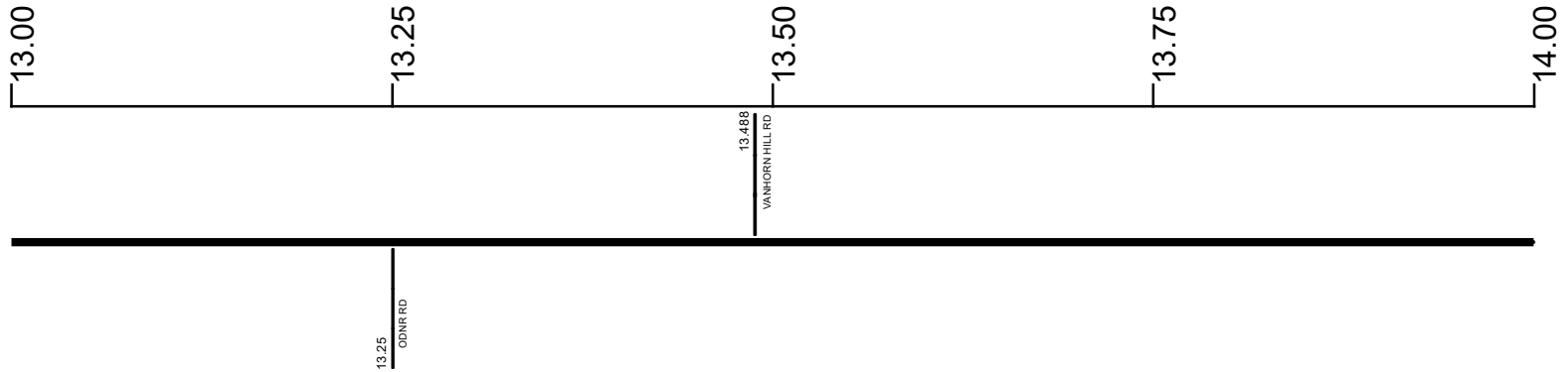

Surface Type & Width (Left / Right)

	G 18'
	3.676 - 15.219

Base Type (Left / Right)

	I
	3.431 - 15.219

Shoulder Type & Width (Left / Right)

	2 (2'/2')
	3.676 - 15.219

Through Lanes

	2
	3.431 - 15.219

Street Name

	SR 555
	3.849 - 15.219

- | | | | |
|---------------------|-------------------|----------------------|--------------|
| Non-divided Highway | Bridge (on route) | Railroad (at grade) | Intersection |
| Divided Highway | Underpass | Railroad (underpass) | |
| Secondary Segment | Overpass | Railroad (overpass) | |
| Corporation | | | |

Created on: 7/3/2025

transportation.ohio.gov

Prepared by
The Ohio Department of Transportation
Office of Technical Services
Roadway Information

SMRGSR00555**C

State True Log

34.412

County True Log

14.00

14.25

14.50

14.75

15.00

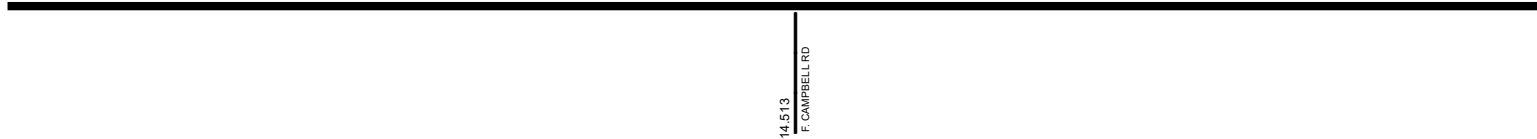

Surface Type & Width (Left / Right)

G 18'
3.676 - 15.219

Base Type (Left / Right)

I
3.431 - 15.219

Shoulder Type & Width (Left / Right)

2 (2'/2')
3.676 - 15.219

Through Lanes

2
3.431 - 15.219

Street Name

SR 555
3.849 - 15.219

- | | | | |
|---------------------|-------------------|----------------------|--------------|
| Non-divided Highway | Bridge (on route) | Railroad (at grade) | Intersection |
| Divided Highway | Underpass | Railroad (underpass) | |
| Secondary Segment | Overpass | Railroad (overpass) | |
| Corporation | | | |

Created on: 7/3/2025



transportation.ohio.gov
 Prepared by
 The Ohio Department of Transportation
 Office of Technical Services
 Roadway Information

SMRGR00555**C

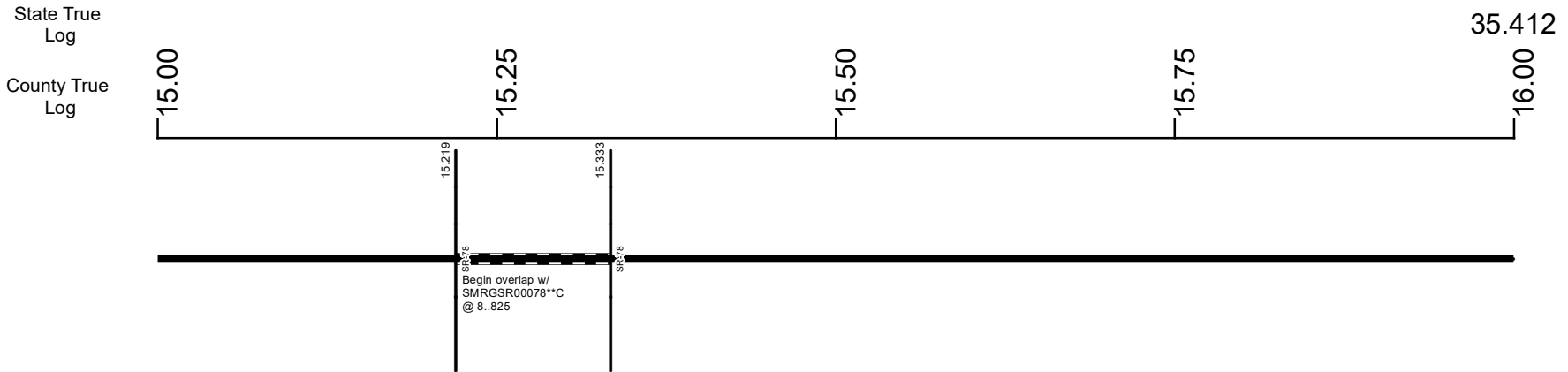

Surface Type & Width (Left / Right)

G 18'
3.676 - 15.219

Base Type (Left / Right)

I
3.431 - 15.219

Shoulder Type & Width (Left / Right)

2 (2'/2')
3.676 - 15.219

Through Lanes

2
3.431 - 15.219

SR 555
3.849 - 15.219

Surface Type & Width (Left / Right)

G 18'
15.333 - 16.872

Base Type (Left / Right)

I
15.333 - 22.949

Shoulder Type & Width (Left / Right)

2 (2'/2')
15.333 - 22.114

Resurface Year

2022
15.333 - 22.949

Through Lanes

2
15.333 - 22.949

Street Name

SR 555
15.333 - 22.949

- Non-divided Highway
- Divided Highway
- Secondary Segment
- Corporation
- Bridge (on route)
- Underpass
- Overpass
- Railroad (at grade)
- Railroad (underpass)
- Railroad (overpass)
- Intersection

Created on: 7/3/2025

transportation.ohio.gov
Prepared by
The Ohio Department of Transportation
Office of Technical Services
Roadway Information

SMRGSR00555**C

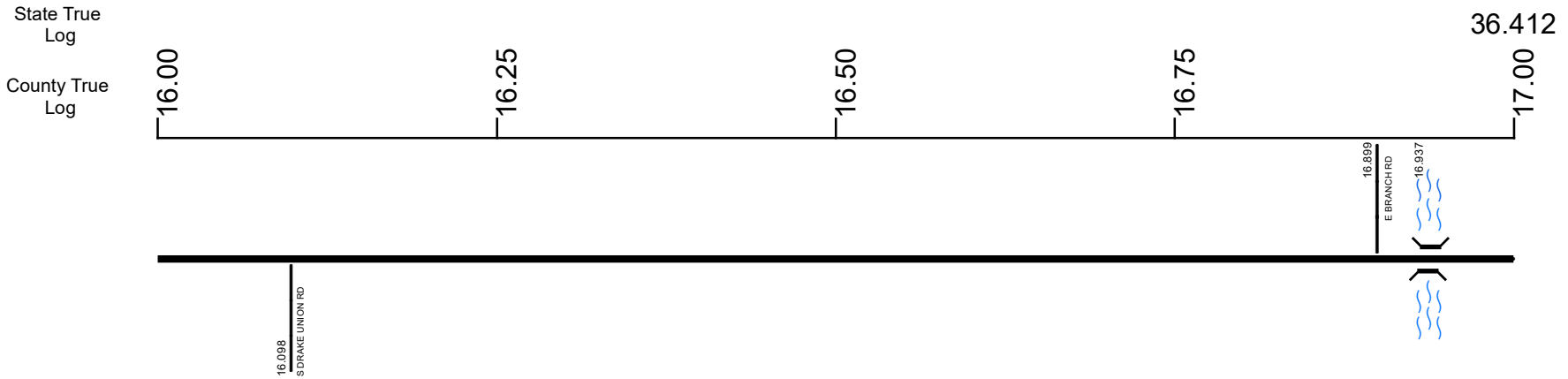

Surface Type & Width (Left / Right)	G 18' 15.333 - 16.872	G 20' 16.872 - 17.079
Base Type (Left / Right)	I 15.333 - 22.949	
Shoulder Type & Width (Left / Right)	2 (2/2) 15.333 - 22.114	
Resurface Year	2022 15.333 - 22.949	
Through Lanes	2 15.333 - 22.949	
Street Name	SR 555 15.333 - 22.949	

Non-divided Highway	Bridge (on route)	Railroad (at grade)	Intersection
Divided Highway	Underpass	Railroad (underpass)	
Secondary Segment	Overpass	Railroad (overpass)	
Corporation			

Created on: 7/3/2025



transportation.ohio.gov

Prepared by
The Ohio Department of Transportation
Office of Technical Services
Roadway Information

SMRGSR00555**C

State True Log

37.412

County True Log

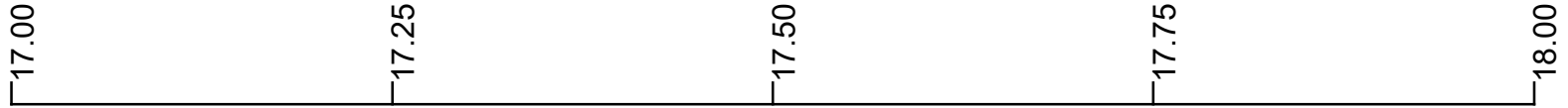

Surface Type & Width (Left / Right)

G 20' 16.872 - 17.079	G 18' 17.079 - 22.949
--------------------------	--------------------------

Base Type (Left / Right)

	I 15.333 - 22.949
--	----------------------

Shoulder Type & Width (Left / Right)

	2 (2/2) 15.333 - 22.114
--	----------------------------

Resurface Year

	2022
--	------

Through Lanes

	2 15.333 - 22.949
--	----------------------

Street Name

	SR 555 15.333 - 22.949
--	---------------------------

- Non-divided Highway
 Bridge (on route)
 Railroad (at grade)
 Intersection
- Divided Highway
 Underpass
 Railroad (underpass)
- Secondary Segment
 Overpass
 Railroad (overpass)
- Corporation**

Created on: 7/3/2025

transportation.ohio.gov

Prepared by
The Ohio Department of Transportation
Office of Technical Services
Roadway Information

SMRGSR00555**C

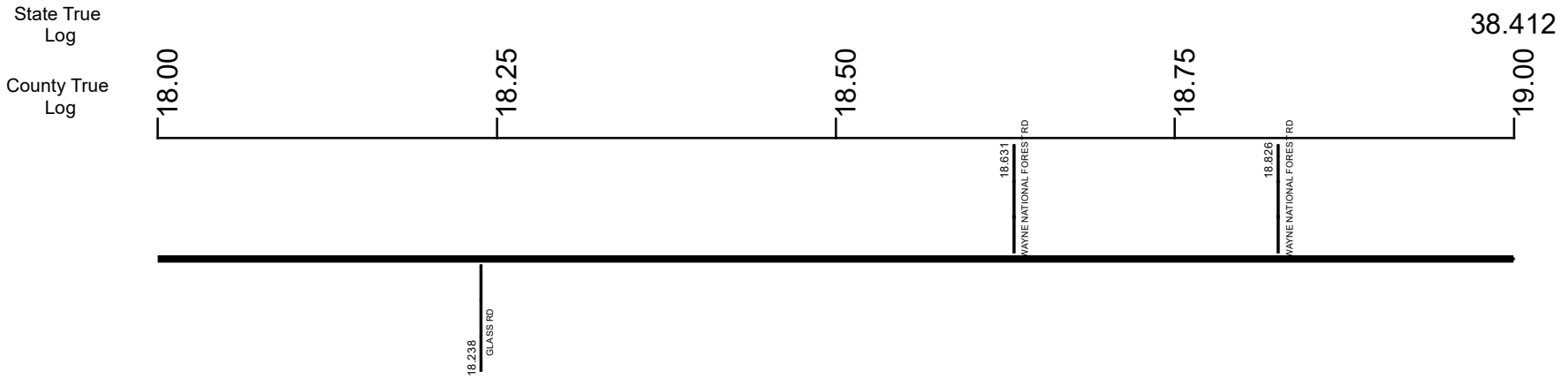

Surface Type & Width (Left / Right)	G 18'
	17.079 - 22.949
Base Type (Left / Right)	I
	15.333 - 22.949
Shoulder Type & Width (Left / Right)	2 (2'/2')
	15.333 - 22.114
Resurface Year	2022
	15.333 - 22.949
Through Lanes	2
	15.333 - 22.949
Street Name	SR 555
	15.333 - 22.949

Non-divided Highway	Bridge (on route)	Railroad (at grade)	Intersection
Divided Highway	Underpass	Railroad (underpass)	
Secondary Segment	Overpass	Railroad (overpass)	
Corporation			

Created on: 7/3/2025

transportation.ohio.gov

Prepared by
The Ohio Department of Transportation
Office of Technical Services
Roadway Information

SMRGSR00555**C

State True Log

39.412

County True Log

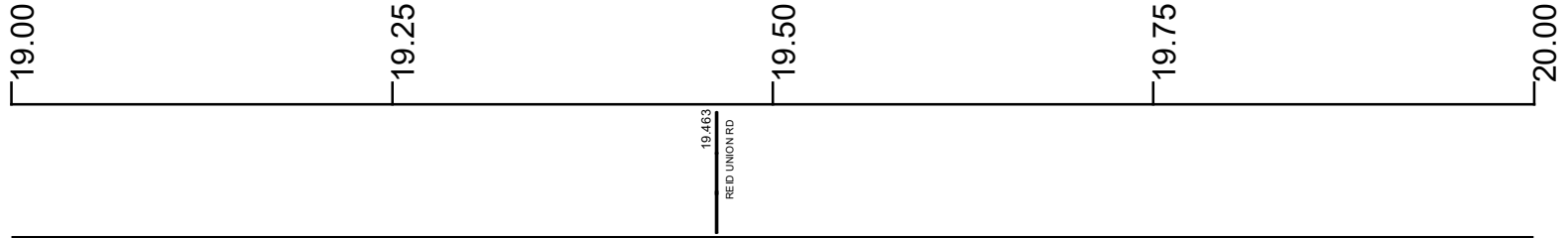

Surface Type & Width (Left / Right)

G 18'
17.079 - 22.949

Base Type (Left / Right)

I
15.333 - 22.949

Shoulder Type & Width (Left / Right)

2 (2/2)
15.333 - 22.114

Resurface Year

2022
15.333 - 22.949

Through Lanes

2
15.333 - 22.949

Street Name

SR 555
15.333 - 22.949

- | | | | |
|---------------------|-------------------|----------------------|--------------|
| Non-divided Highway | Bridge (on route) | Railroad (at grade) | Intersection |
| Divided Highway | Underpass | Railroad (underpass) | |
| Secondary Segment | Overpass | Railroad (overpass) | |
| Corporation | | | |

Created on: 7/3/2025

transportation.ohio.gov

Prepared by
The Ohio Department of Transportation
Office of Technical Services
Roadway Information

SMRGSR00555**C

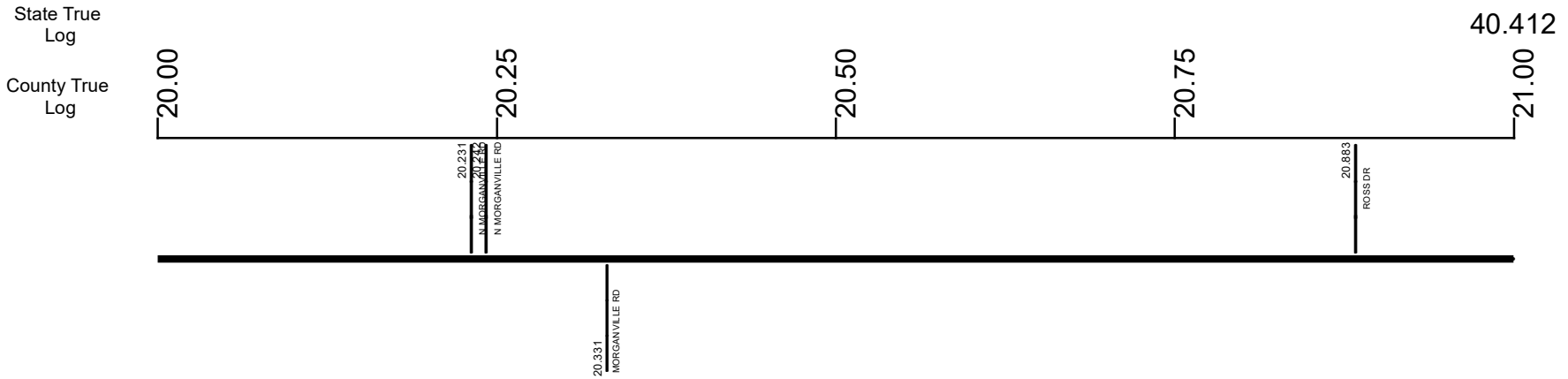

Surface Type & Width (Left / Right)	G 18'
	17.079 - 22.949
Base Type (Left / Right)	I
	15.333 - 22.949
Shoulder Type & Width (Left / Right)	2 (2'/2')
	15.333 - 22.114
Resurface Year	2022
	15.333 - 22.949
Through Lanes	2
	15.333 - 22.949
Street Name	SR 555
	15.333 - 22.949

Non-divided Highway	Bridge (on route)	Railroad (at grade)	Intersection
Divided Highway	Underpass	Railroad (underpass)	
Secondary Segment	Overpass	Railroad (overpass)	
Corporation			

Created on: 7/3/2025



transportation.ohio.gov

Prepared by
The Ohio Department of Transportation
Office of Technical Services
Roadway Information

SMRGSR00555**C

State True Log 41.412

County True Log

21.00
21.25
21.50
21.75
22.00



Surface Type & Width (Left / Right)	G 18'
	17.079 - 22.949
Base Type (Left / Right)	I
	15.333 - 22.949
Shoulder Type & Width (Left / Right)	2 (2'/2')
	15.333 - 22.114
Resurface Year	2022
	15.333 - 22.949
Through Lanes	2
	15.333 - 22.949
Street Name	SR 555
	15.333 - 22.949

Non-divided Highway	Bridge (on route)	Railroad (at grade)	Intersection
Divided Highway	Underpass	Railroad (underpass)	
Secondary Segment	Overpass	Railroad (overpass)	
Corporation			

Created on: 7/3/2025

transportation.ohio.gov

Prepared by

The Ohio Department of Transportation

Office of Technical Services

Roadway Information

SMRGSR00555**C

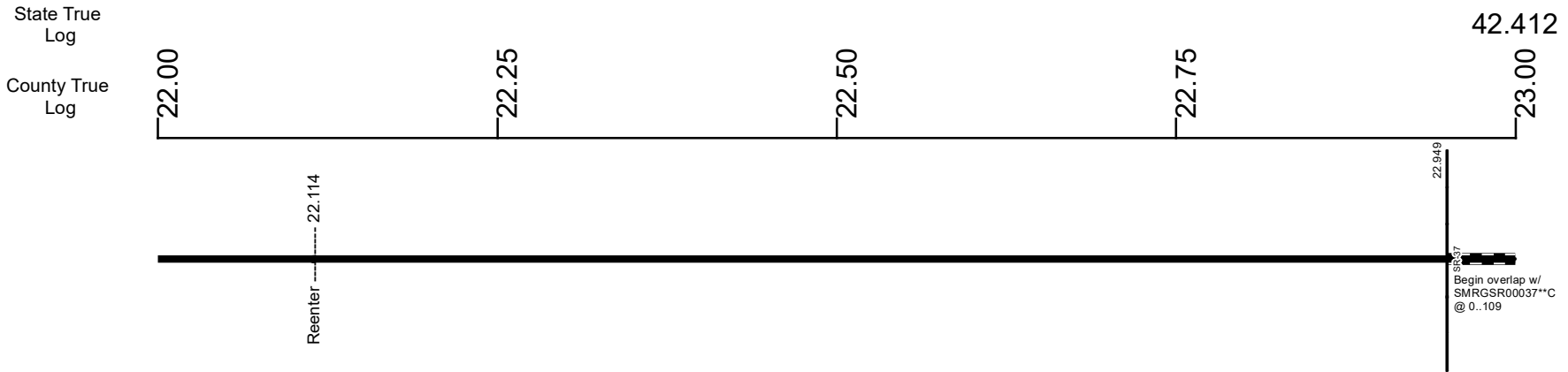

Surface Type & Width (Left / Right)

G 18'
17.079 - 22.949

Base Type (Left / Right)

I
15.333 - 22.949

Shoulder Type & Width (Left / Right)

2 (2'2") 15.333 - 22.114	2 (1'1") 22.114 - 22.949
-----------------------------	-----------------------------

Resurface Year

2022
15.333 - 22.949

Through Lanes

2
15.333 - 22.949

Street Name

SR 555
15.333 - 22.949

- | | | | |
|---------------------|-------------------|----------------------|--------------|
| Non-divided Highway | Bridge (on route) | Railroad (at grade) | Intersection |
| Divided Highway | Underpass | Railroad (underpass) | |
| Secondary Segment | Overpass | Railroad (overpass) | |
| Corporation | | | |

Created on: 7/3/2025

transportation.ohio.gov
 Prepared by
 The Ohio Department of Transportation
 Office of Technical Services
 Roadway Information

SMRGSR00555**C

State True Log
County True Log

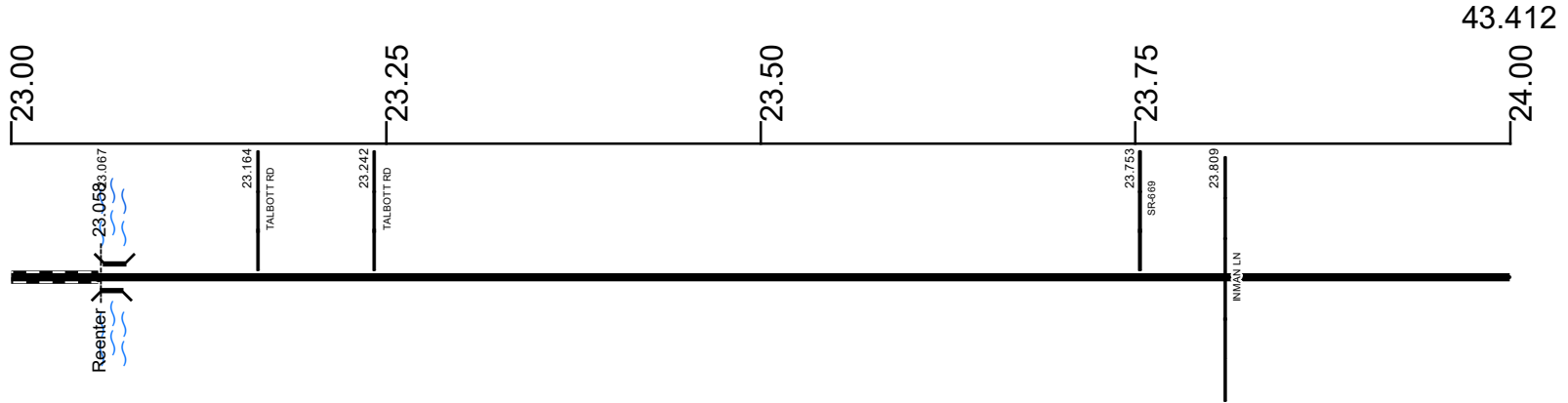

Surface Type & Width (Left / Right)	G 18'	G (9'/10')
	23.058 - 23.753	23.753 - 24.712
Base Type (Left / Right)	I	
	23.058 - 27.159	
Shoulder Type & Width (Left / Right)	5 (1'/1')	
	23.058 - 24.712	
Through Lanes	2	
	23.058 - 27.159	
Street Name	SR 555	
	23.058 - 27.159	

- Non-divided Highway
- Divided Highway
- Secondary Segment
- Corporation
- Bridge (on route)
- Underpass
- Overpass
- Railroad (at grade)
- Railroad (underpass)
- Railroad (overpass)
- Intersection

Created on: 7/3/2025



transportation.ohio.gov
 Prepared by
 The Ohio Department of Transportation
 Office of Technical Services
 Roadway Information

SMRGSR00555**C

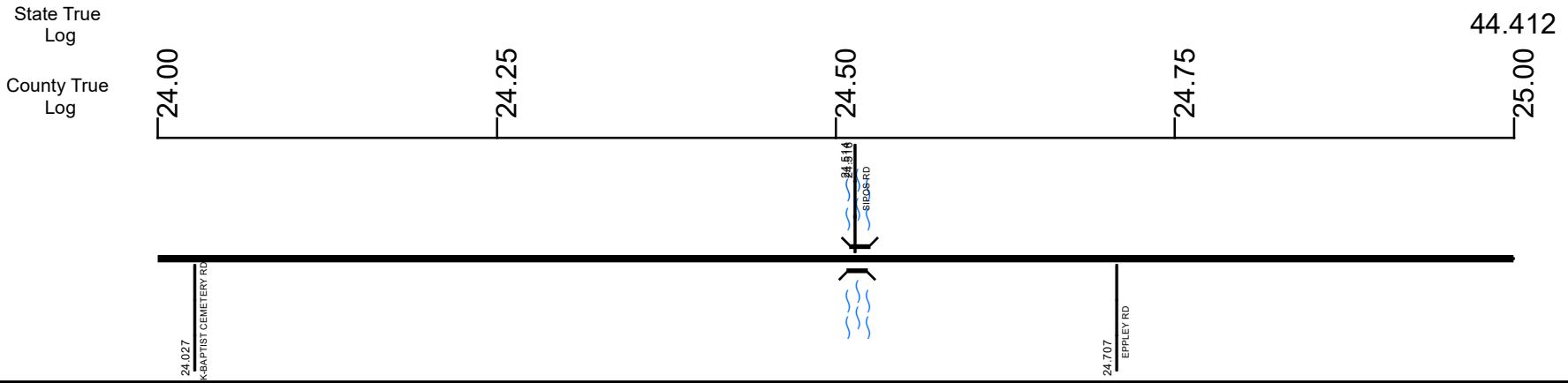

Surface Type & Width (Left / Right)	G (9'/10') 23.753 - 24.712	G 18' 24.712 - 27.159
Base Type (Left / Right)	I 23.058 - 27.159	
Shoulder Type & Width (Left / Right)	5 (1'/1') 23.058 - 24.712	5 (2'/2') 24.712 - 27.159
Through Lanes	2 23.058 - 27.159	
Street Name	SR 555 23.058 - 27.159	

<ul style="list-style-type: none"> Non-divided Highway Divided Highway Secondary Segment Corporation 	<ul style="list-style-type: none"> Bridge (on route) Underpass Overpass 	<ul style="list-style-type: none"> Railroad (at grade) Railroad (underpass) Railroad (overpass) 	<ul style="list-style-type: none"> Intersection
--	---	---	---

Created on: 7/3/2025

transportation.ohio.gov

Prepared by
The Ohio Department of Transportation
Office of Technical Services
Roadway Information

SMRGSR00555**C

State True Log

45.412

County True Log

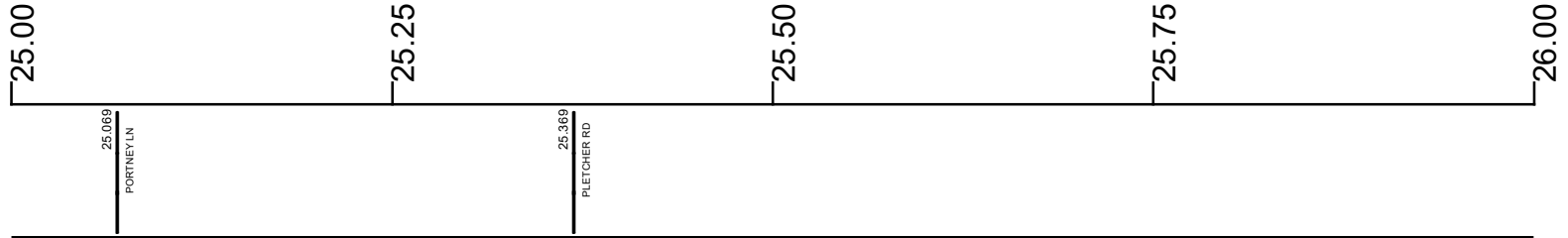

Surface Type & Width (Left / Right)

G 18'
24.712 - 27.159

Base Type (Left / Right)

I
23.058 - 27.159

Shoulder Type & Width (Left / Right)

5 (2/2)
24.712 - 27.159

Through Lanes

2
23.058 - 27.159

Street Name

SR 555
23.058 - 27.159

- | | | | |
|---------------------|-------------------|----------------------|--------------|
| Non-divided Highway | Bridge (on route) | Railroad (at grade) | Intersection |
| Divided Highway | Underpass | Railroad (underpass) | |
| Secondary Segment | Overpass | Railroad (overpass) | |
| Corporation | | | |

Created on: 7/3/2025



transportation.ohio.gov

Prepared by
The Ohio Department of Transportation
Office of Technical Services
Roadway Information

SMRGSR00555**C

State True Log

46.412

County True Log

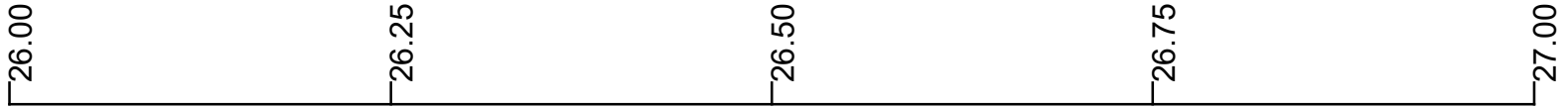

Surface Type & Width (Left / Right)

G 18'
24.712 - 27.159

Base Type (Left / Right)

I
23.058 - 27.159

Shoulder Type & Width (Left / Right)

5 (2/2)
24.712 - 27.159

Through Lanes

2
23.058 - 27.159

Street Name

SR 555
23.058 - 27.159

- | | | | |
|---------------------|-------------------|----------------------|--------------|
| Non-divided Highway | Bridge (on route) | Railroad (at grade) | Intersection |
| Divided Highway | Underpass | Railroad (underpass) | |
| Secondary Segment | Overpass | Railroad (overpass) | |
| Corporation | | | |

Created on: 7/3/2025



transportation.ohio.gov
 Prepared by
 The Ohio Department of Transportation
 Office of Technical Services
 Roadway Information

SMRGSR00555**C

State True Log

50.908

County True Log

27.00

27.25

27.50

27.75

28.00



Surface Type & Width (Left / Right)

G 18'
24.712 - 27.159

Base Type (Left / Right)

I
23.058 - 27.159

Shoulder Type & Width (Left / Right)

5 (2'1/2')
24.712 - 27.159

Through Lanes

2
23.058 - 27.159

Street Name

SR 555
23.058 - 27.159

- Non-divided Highway
- Divided Highway
- Secondary Segment
- Corporation
- Bridge (on route)
- Underpass
- Overpass
- Railroad (at grade)
- Railroad (underpass)
- Railroad (overpass)
- Intersection

Created on: 7/3/2025

transportation.ohio.gov

Prepared by
The Ohio Department of Transportation
Office of Technical Services
Roadway Information

Historical Project List for SMRGSR00555**C

Begin Measure	End Measure	Project ID Number	Construction Completion Date	Treatment Category	Treatment Type
0.000	3.274	91760	12-2016	Minor Rehabilitation	38-Fine Poly AC Overlay
0.000	3.274	76155	7-2008	Minor Rehabilitation	50-AC Overlay w/o Rpr
3.431	3.850	96665	12-2023	Minor Rehabilitation	60-AC Overlay w/Rpr
3.431	13.268	24892	12-2012	Preventive Maintenance	25-Chip Seal
3.851	15.219	102397	9-2020	Minor Rehabilitation	60-AC Overlay w/Rpr
13.328	15.219	79970	6-2007	Minor Rehabilitation	50-AC Overlay w/o Rpr
15.333	22.114	87116	10-2022	Minor Rehabilitation	60-AC Overlay w/Rpr
15.333	22.114	79970	6-2007	Minor Rehabilitation	50-AC Overlay w/o Rpr
22.114	22.949	87116	10-2022	Minor Rehabilitation	60-AC Overlay w/Rpr
22.114	22.949	79970	6-2007	Minor Rehabilitation	50-AC Overlay w/o Rpr
23.058	23.743	92963	11-2015	Minor Rehabilitation	60-AC Overlay w/Rpr
23.763	26.747	83818	6-2012	Minor Rehabilitation	50-AC Overlay w/o Rpr
26.727	27.159	92963	11-2015	Minor Rehabilitation	60-AC Overlay w/Rpr

Roadway Codes

Access Control Journalized

- F - Full Access Control
- L - Limited Access Control
- N - No Access Control

Access Control Operational

- 1 - Full Access Control
- 2 - Partial Access Control
- 3 - No Access Control

Base Type

- F - Crack and Seat
- H - Rubblize and Roll
- I - Aggregate Base 304 or Traffic Compacted
- K - Water Bound Macadam
- L - Bituminous Concrete Mix or Penetration Macadam
- N - Plain Concrete
- P - Reinforced Concrete
- R - Brick (Flexible)
- T - Brick (Rigid)

Direction of Travel

- B - Both (Two-way)
- F - One-way Cardinal
- T - One-way Non-cardinal

Facility Type

- 1 - One-way Roadway
- 2 - Two-way Roadway
- 4 - Ramp
- 5 - Non-mainline
- 6 - Non-inventory Direction
- 7 - Planned / Unbuilt

Historical Federal Aid Indicator

- N - Not a FAP Route
- Y - FAP Route

Functional Classification

- 01 - Interstate
- 02 - Principal Arterial (Freeways)
- 03 - Principal Arterial (Other)
- 04 - Minor Arterial
- 05 - Major Collector
- 06 - Minor Collector
- 07 - Local

Leave / Reenter Indicator

- Y - Route leaves/reenters at this point
- N - Route does not leave/reenter at this point

Median Type

- 1 - None
- 2 - Unprotected
- 3 - Curbed
- 4 - Positive Barrier (Unspecified)
- 5 - Positive Barrier (Flexible)
- 6 - Positive Barrier (Semi-rigid)
- 7 - Positive Barrier (Rigid)

NHS

- N - National Highway System
- H - Congressional Corridor
- 2 - Major Airport
- 3 - Major Port Facility
- 4 - Major Amtrak Station
- 5 - Major Rail / Truck Terminal
- 6 - Major Intercity Bus Terminal
- 7 - Major Public Transit / Multi-modal Passenger Terminal
- 8 - Major Pipeline Terminal
- 9 - Major Ferry Terminal

Priority System

- G - General
- P - Priority System
- U - Urban

Scenic Byway Code

- A - All American Road
- N - National Scenic Byway
- S - State Scenic Byway

Shoulder Type

- 1 - None
- 2 - Surfaced shoulder exists (bituminous concrete {AC})
- 3 - Surfaced shoulder exists (Portland Cement Concrete {PCC})
- 4 - Stabilized shoulder exists (gravel or other granular material)
- 5 - Combination shoulder exists (two or more surface types)
- 6 - Earth shoulder exists
- 7 - Barrier curb exists; no shoulder in front of curb

Surface Type

- A - Combination
- B - Brick
- C - Continuous Reinforced Concrete
- D - Reinforced Concrete
- E - Plain Concrete
- G - Bituminous Concrete
- I - Chipseal on Granular
- K - Open Graded Bituminous
- L - Chipseal or Micro
- M - Gravel
- U - Unimproved
- X - Right of Way Only