

SMUSSR00146**C

State True Log 2.451

3.451

County True Log

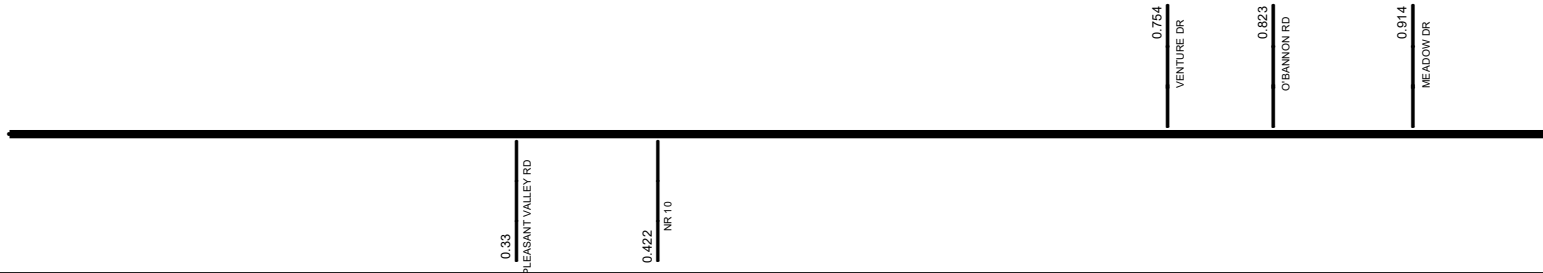

Surface Type & Width (Left / Right)	G 24' 0 - 3.636
Base Type (Left / Right)	L 0 - 3.636
Shoulder Type & Width (Left / Right)	2 (5/5) 0 - 1.976
Through Lanes	2 0 - 13.319
Street Name	NEWARK RD 0 - 13.035

Non-divided Highway	Bridge (on route)	Railroad (at grade)	Intersection
Divided Highway	Underpass	Railroad (underpass)	
Secondary Segment	Overpass	Railroad (overpass)	
Corporation			

Created on: 7/3/2025

transportation.ohio.gov

Prepared by
The Ohio Department of Transportation
Office of Technical Services
Roadway Information

SMUSSR00146**C

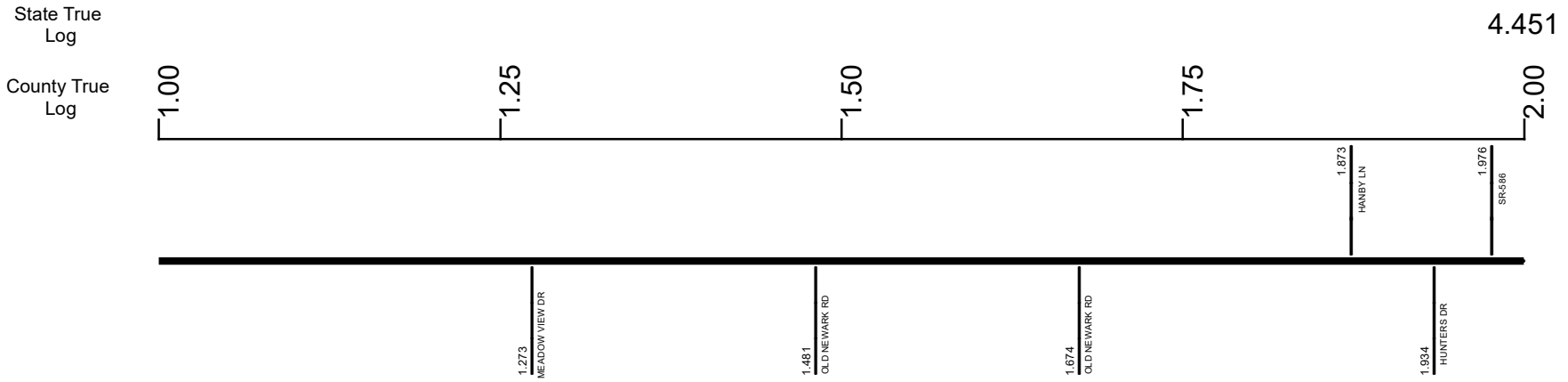

Surface Type & Width (Left / Right)	G 24'
	0 - 3.636
Base Type (Left / Right)	L
	0 - 3.636
Shoulder Type & Width (Left / Right)	2 (5/5)
	0 - 1.976
	2 (9/9)
	1.976 - 3.636
Through Lanes	2
	0 - 13.319
Street Name	NEWARK RD
	0 - 13.035

- Non-divided Highway
- Divided Highway
- Secondary Segment
- Corporation
- Bridge (on route)
- Underpass
- Overpass
- Railroad (at grade)
- Railroad (underpass)
- Railroad (overpass)
- Intersection

Created on: 7/3/2025

transportation.ohio.gov

Prepared by

The Ohio Department of Transportation

Office of Technical Services

Roadway Information

SMUSSR00146**C

State True Log

5.451

County True Log

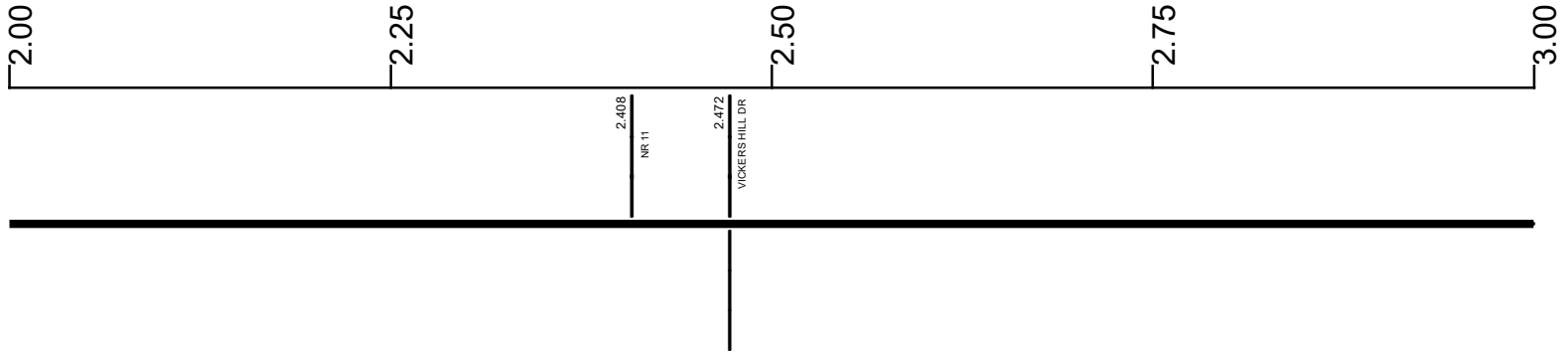

Surface Type & Width (Left / Right)

G 24'
0 - 3.636

Base Type (Left / Right)

L
0 - 3.636

Shoulder Type & Width (Left / Right)

2 (9/9)
1.976 - 3.636

Through Lanes

2
0 - 13.319

Street Name

NEWARK RD
0 - 13.035

- | | | | |
|---------------------|-------------------|----------------------|--------------|
| Non-divided Highway | Bridge (on route) | Railroad (at grade) | Intersection |
| Divided Highway | Underpass | Railroad (underpass) | |
| Secondary Segment | Overpass | Railroad (overpass) | |
| Corporation | | | |

Created on: 7/3/2025

transportation.ohio.gov

Prepared by
The Ohio Department of Transportation
Office of Technical Services
Roadway Information

SMUSSR00146**C

State True Log

6.451

County True Log

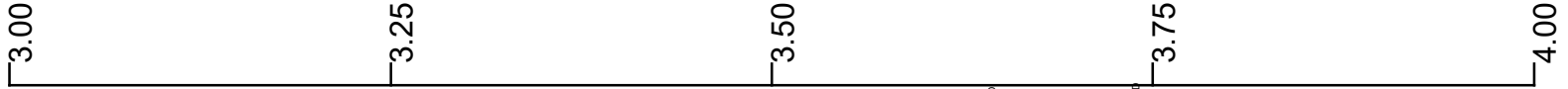

Surface Type & Width (Left / Right)

G 24'	G (20'/4')
0 - 3.636	3.636 - 6.042

Base Type (Left / Right)

L	I / L
0 - 3.636	3.636 - 6.042

Shoulder Type & Width (Left / Right)

2 (9'/9')	2 (5'/5')
1.976 - 3.636	3.636 - 12.696

Through Lanes

2	
0 - 13.319	

Street Name

NEWARK RD	
0 - 13.035	

- | | | | |
|--|---|---|---|
| <ul style="list-style-type: none"> Non-divided Highway Divided Highway Secondary Segment Corporation | <ul style="list-style-type: none"> Bridge (on route) Underpass Overpass | <ul style="list-style-type: none"> Railroad (at grade) Railroad (underpass) Railroad (overpass) | <ul style="list-style-type: none"> Intersection |
|--|---|---|---|

Created on: 7/3/2025

transportation.ohio.gov

Prepared by
The Ohio Department of Transportation
Office of Technical Services
Roadway Information

SMUSSR00146**C

State True Log

7.451

County True Log



Surface Type & Width (Left / Right)

G (20'4')
3.636 - 6.042

Base Type (Left / Right)

I / L
3.636 - 6.042

Shoulder Type & Width (Left / Right)

2 (5'5')
3.636 - 12.696

Through Lanes

2
0 - 13.319

Street Name

NEWARK RD
0 - 13.035

- | | | | |
|---------------------|-------------------|----------------------|--------------|
| Non-divided Highway | Bridge (on route) | Railroad (at grade) | Intersection |
| Divided Highway | Underpass | Railroad (underpass) | |
| Secondary Segment | Overpass | Railroad (overpass) | |
| Corporation | | | |

Created on: 7/3/2025



transportation.ohio.gov
 Prepared by
 The Ohio Department of Transportation
 Office of Technical Services
 Roadway Information

SMUSSR00146**C

State True Log

8.451

County True Log

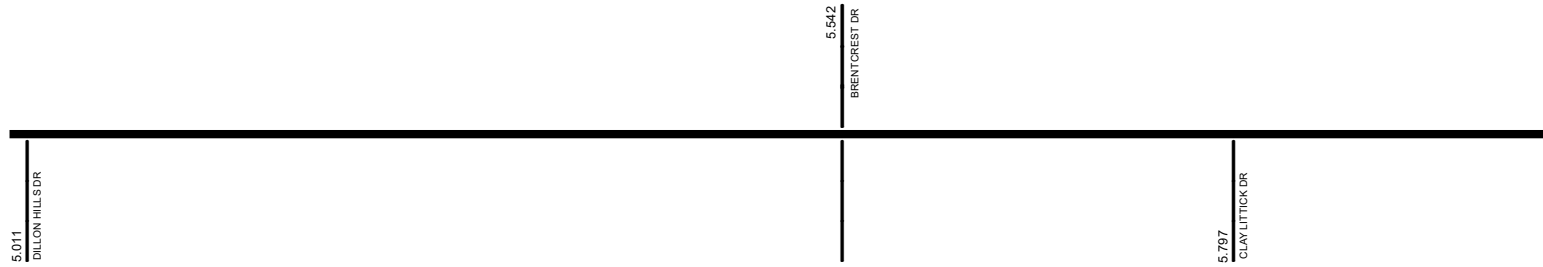

Surface Type & Width (Left / Right)

G (20'4')
3.636 - 6.042

Base Type (Left / Right)

I / L
3.636 - 6.042

Shoulder Type & Width (Left / Right)

2 (5'5')
3.636 - 12.696

Through Lanes

2
0 - 13.319

Street Name

NEWARK RD
0 - 13.035

- | | | | |
|---------------------|-------------------|----------------------|--------------|
| Non-divided Highway | Bridge (on route) | Railroad (at grade) | Intersection |
| Divided Highway | Underpass | Railroad (underpass) | |
| Secondary Segment | Overpass | Railroad (overpass) | |
| Corporation | | | |

Created on: 7/3/2025

transportation.ohio.gov

Prepared by
The Ohio Department of Transportation
Office of Technical Services
Roadway Information

SMUSSR00146**C

State True Log

9.451

County True Log

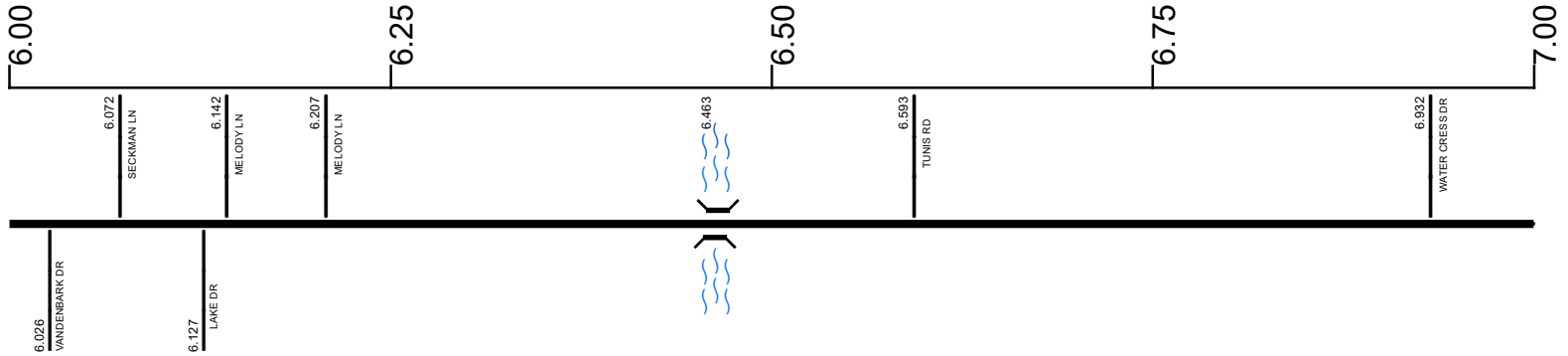

Surface Type & Width (Left / Right)

G (20'4')	G 24'
3.636 - 6.042	6.042 - 11.556

Base Type (Left / Right)

I / L	L
3.636 - 6.042	6.042 - 8.063

Shoulder Type & Width (Left / Right)

	2 (5/5)
	3.636 - 12.696

Through Lanes

	2
	0 - 13.319

Street Name

	NEWARK RD
	0 - 13.035

- Non-divided Highway
- Divided Highway
- Secondary Segment
- Corporation
- Bridge (on route)
- Underpass
- Overpass
- Railroad (at grade)
- Railroad (underpass)
- Railroad (overpass)
- Intersection

Created on: 7/3/2025

transportation.ohio.gov

Prepared by
The Ohio Department of Transportation
Office of Technical Services
Roadway Information

SMUSSR00146**C

State True Log

10.451

County True Log

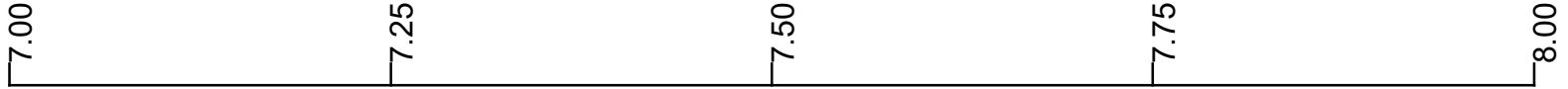

Surface Type & Width (Left / Right)

G 24'
6.042 - 11.556

Base Type (Left / Right)

L
6.042 - 8.063

Shoulder Type & Width (Left / Right)

2 (5/5)
3.636 - 12.696

Through Lanes

2
0 - 13.319

Street Name

NEWARK RD
0 - 13.035

- | | | | |
|---------------------|-------------------|----------------------|--------------|
| Non-divided Highway | Bridge (on route) | Railroad (at grade) | Intersection |
| Divided Highway | Underpass | Railroad (underpass) | |
| Secondary Segment | Overpass | Railroad (overpass) | |
| Corporation | | | |

Created on: 7/3/2025

transportation.ohio.gov

Prepared by
The Ohio Department of Transportation
Office of Technical Services
Roadway Information

SMUSSR00146**C

State True Log

11.451

County True Log

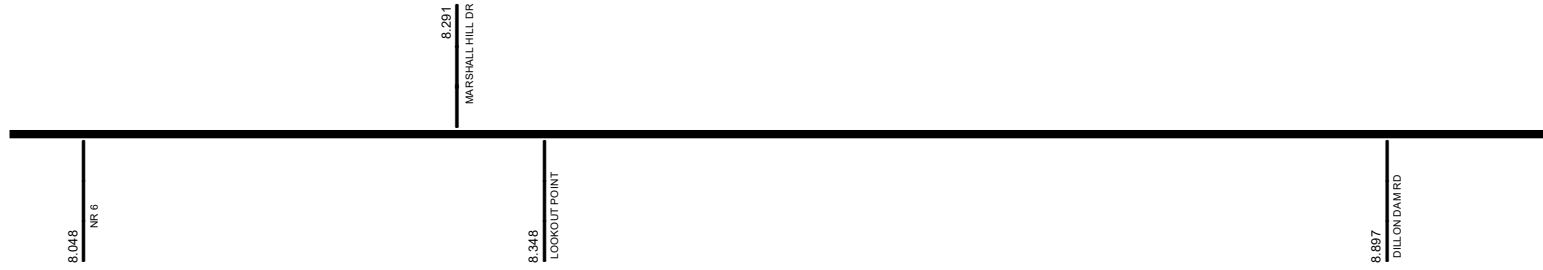
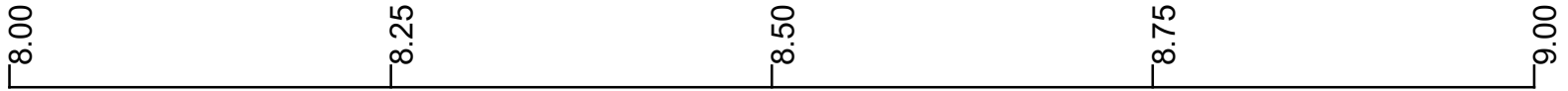

Surface Type & Width (Left / Right)

	G 24'
	6.042 - 11.556

Base Type (Left / Right)

L	I
6.042 - 8.063	8.063 - 10.044

Shoulder Type & Width (Left / Right)

	2 (5/5)
	3.636 - 12.696

Through Lanes

	2
	0 - 13.319

Street Name

	NEWARK RD
	0 - 13.035

- | | | | |
|---------------------|-------------------|----------------------|--------------|
| Non-divided Highway | Bridge (on route) | Railroad (at grade) | Intersection |
| Divided Highway | Underpass | Railroad (underpass) | |
| Secondary Segment | Overpass | Railroad (overpass) | |
| Corporation | | | |

Created on: 7/3/2025

transportation.ohio.gov

Prepared by
The Ohio Department of Transportation
Office of Technical Services
Roadway Information

SMUSSR00146**C

State True Log

12.451

County True Log

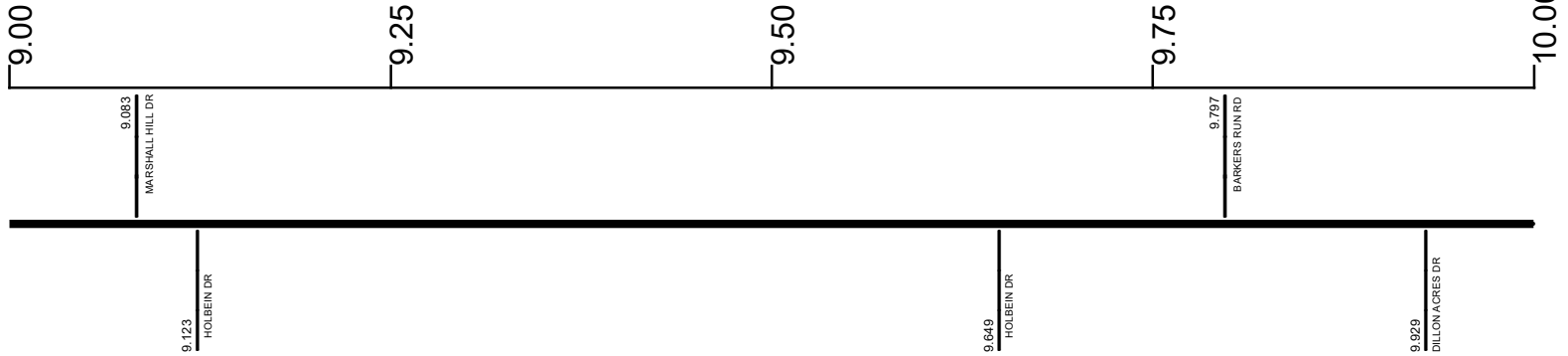

Surface Type & Width (Left / Right)

G 24'
6.042 - 11.556

Base Type (Left / Right)

I
8.063 - 10.044

Shoulder Type & Width (Left / Right)

2 (5/5)
3.636 - 12.696

Through Lanes

2
0 - 13.319

Street Name

NEWARK RD
0 - 13.035

- | | | | |
|---------------------|-------------------|----------------------|--------------|
| Non-divided Highway | Bridge (on route) | Railroad (at grade) | Intersection |
| Divided Highway | Underpass | Railroad (underpass) | |
| Secondary Segment | Overpass | Railroad (overpass) | |
| Corporation | | | |

Created on: 7/3/2025

transportation.ohio.gov

Prepared by
The Ohio Department of Transportation
Office of Technical Services
Roadway Information

SMUSSR00146**C

State True Log

13.451

County True Log

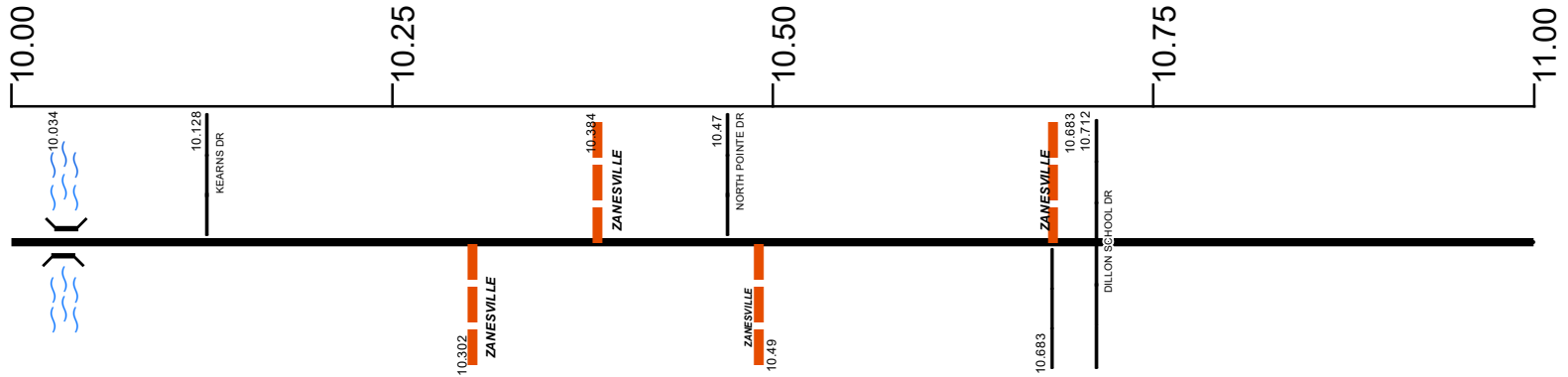

Surface Type & Width (Left / Right)

	G 24'
	6.042 - 11.556

Base Type (Left / Right)

I	L
8.063 - 10.044	10.044 - 11.556

Shoulder Type & Width (Left / Right)

	2 (5/5)
	3.636 - 12.696

Through Lanes

	2
	0 - 13.319

Street Name

	NEWARK RD
	0 - 13.035

- Non-divided Highway
- Divided Highway
- Secondary Segment
- Corporation
- Bridge (on route)
- Underpass
- Overpass
- Railroad (at grade)
- Railroad (underpass)
- Railroad (overpass)
- Intersection

Created on: 7/3/2025

transportation.ohio.gov

Prepared by
The Ohio Department of Transportation
Office of Technical Services
Roadway Information

SMUSSR00146**C

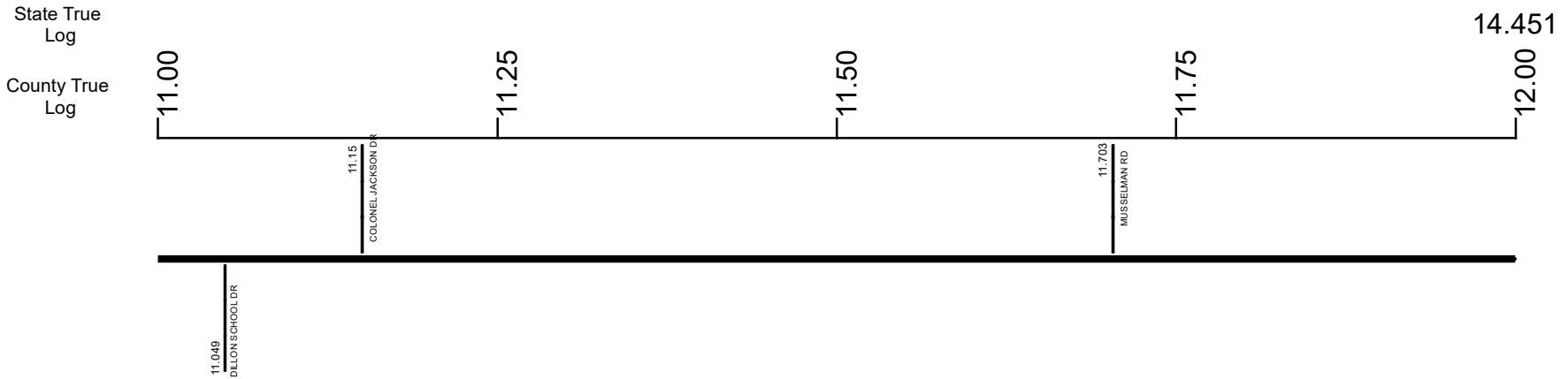

Surface Type & Width (Left / Right)	
G 24'	G (18'/6')
6.042 - 11.556	11.556 - 12.696
Base Type (Left / Right)	
L	N / L
10.044 - 11.556	11.556 - 12.696
Shoulder Type & Width (Left / Right)	
2 (5/5)	
3.636 - 12.696	
Through Lanes	
2	
0 - 13.319	
Street Name	
NEWARK RD	
0 - 13.035	

- | | | | |
|--|---|---|---|
| <ul style="list-style-type: none"> Non-divided Highway Divided Highway Secondary Segment Corporation | <ul style="list-style-type: none"> Bridge (on route) Underpass Overpass | <ul style="list-style-type: none"> Railroad (at grade) Railroad (underpass) Railroad (overpass) | <ul style="list-style-type: none"> Intersection |
|--|---|---|---|

Created on: 7/3/2025

transportation.ohio.gov

Prepared by
The Ohio Department of Transportation
Office of Technical Services
Roadway Information

SMUSSR00146**C

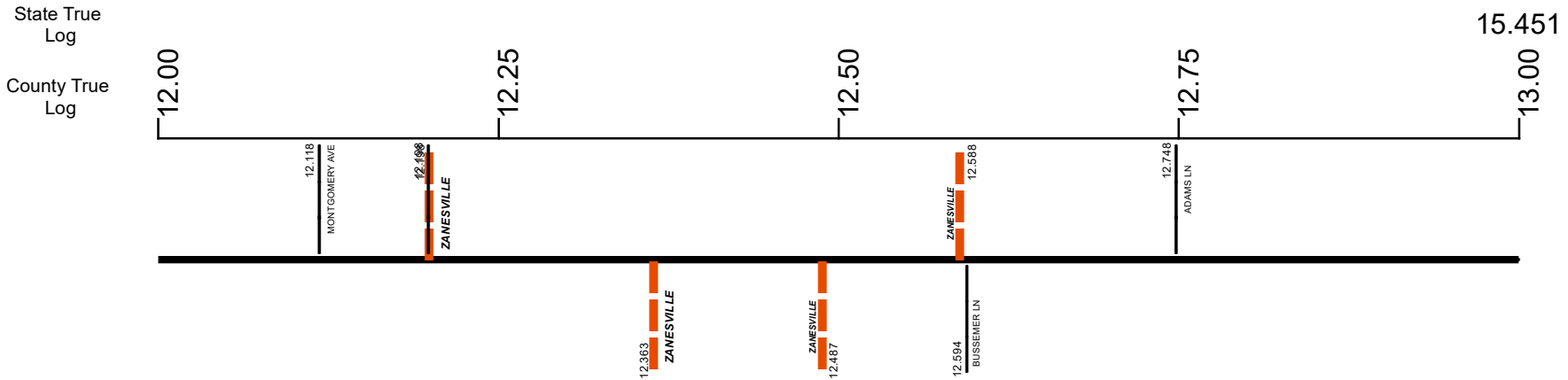

Surface Type & Width (Left / Right)			
G (18'/6')	G (14'/15')	G (18'/6')	
11.556 - 12.696	12.696 - 12.797	12.797 - 13.128	
Base Type (Left / Right)			
N / L	L	N / L	
11.556 - 12.696	12.696 - 12.797	12.797 - 13.128	
Shoulder Type & Width (Left / Right)			
2 (5'/5')	1 (0'/0')	2 (5'/5')	
3.636 - 12.696	12.696 - 12.797	12.797 - 13.128	
Through Lanes			
2			
0 - 13.319			
Street Name			
NEWARK RD			
0 - 13.035			

Non-divided Highway	Bridge (on route)	Railroad (at grade)	Intersection
Divided Highway	Underpass	Railroad (underpass)	
Secondary Segment	Overpass	Railroad (overpass)	
Corporation			

Created on: 7/3/2025



transportation.ohio.gov

Prepared by
The Ohio Department of Transportation
Office of Technical Services
Roadway Information

SMUSSR00146**C

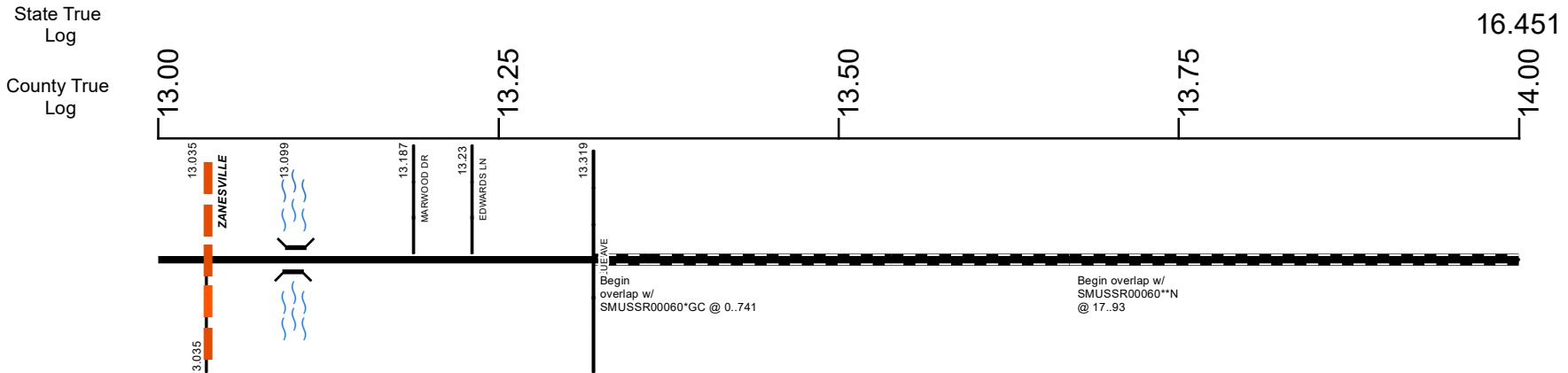

Surface Type & Width (Left / Right)

G (18'/6')	G 30'	G 36'
12.797 - 13.128	13.128 - 13.256	13.256 - 13.319

Base Type (Left / Right)

N / L	N	L
12.797 - 13.128	13.128 - 13.256	13.256 - 13.319

Shoulder Type & Width (Left / Right)

2 (5'/5')	1 (0'/0')
12.797 - 13.128	13.128 - 13.319

Through Lanes

2
0 - 13.319

Street Name

NEWARK RD	ADAIR AVE
0 - 13.035	13.035 - 13.319

- Non-divided Highway
- Divided Highway
- Secondary Segment
- Corporation
- Bridge (on route)
- Underpass
- Overpass
- Railroad (at grade)
- Railroad (underpass)
- Railroad (overpass)
- Intersection

Created on: 7/3/2025



transportation.ohio.gov

Prepared by
The Ohio Department of Transportation
Office of Technical Services
Roadway Information

SMUSSR00146**C

State True
Log

17.451

County True
Log

14.00

14.25

14.50

14.75

15.00



Begin overlap @ 16.764
Begin overlap w/ SMUSSR000eSMUSUS00022**C @ 12.251
Begin overlap w/ /USUS00022**C @ 12.185

- | | | | | | | |
|---------------------|--|-------------------|--|----------------------|--|--------------|
| Non-divided Highway | | Bridge (on route) | | Railroad (at grade) | | Intersection |
| Divided Highway | | Underpass | | Railroad (underpass) | | |
| Secondary Segment | | Overpass | | Railroad (overpass) | | |
| Corporation | | | | | | |

Created on: 7/3/2025

transportation.ohio.gov

Prepared by
The Ohio Department of Transportation
Office of Technical Services
Roadway Information

SMUSSR00146**C

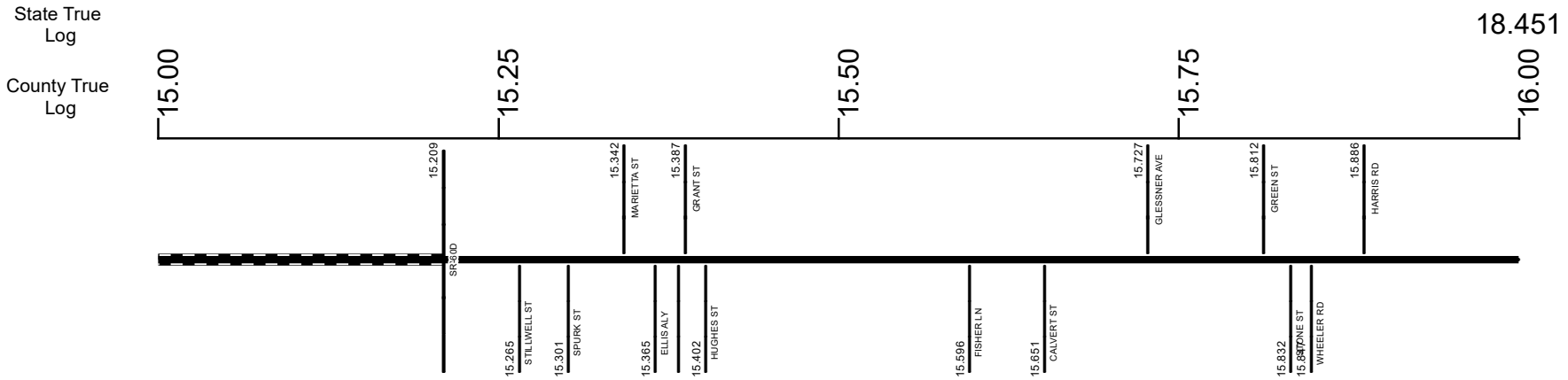

Surface Type & Width (Left / Right)		
G 30'		
15.209 - 15.847	G 26'	
15.847 - 16.205		
Base Type (Left / Right)		
R	N	T
15.209 - 15.342	15.342 - 15.847	15.847 - 16.046
Shoulder Type & Width (Left / Right)		
1 (0'/0')		
15.209 - 16.205		
Through Lanes		
2		
15.209 - 33.766		
Street Name		
MARIETTA ST	SHARON AVE	
15.209 - 15.342	15.342 - 16.208	

<ul style="list-style-type: none"> Non-divided Highway Divided Highway Secondary Segment Corporation 	<ul style="list-style-type: none"> Bridge (on route) Underpass Overpass 	<ul style="list-style-type: none"> Railroad (at grade) Railroad (underpass) Railroad (overpass) 	<ul style="list-style-type: none"> Intersection
--	---	---	---

Created on: 7/3/2025

transportation.ohio.gov

Prepared by
The Ohio Department of Transportation
Office of Technical Services
Roadway Information

SMUSSR00146**C

State True Log

19.451

County True Log

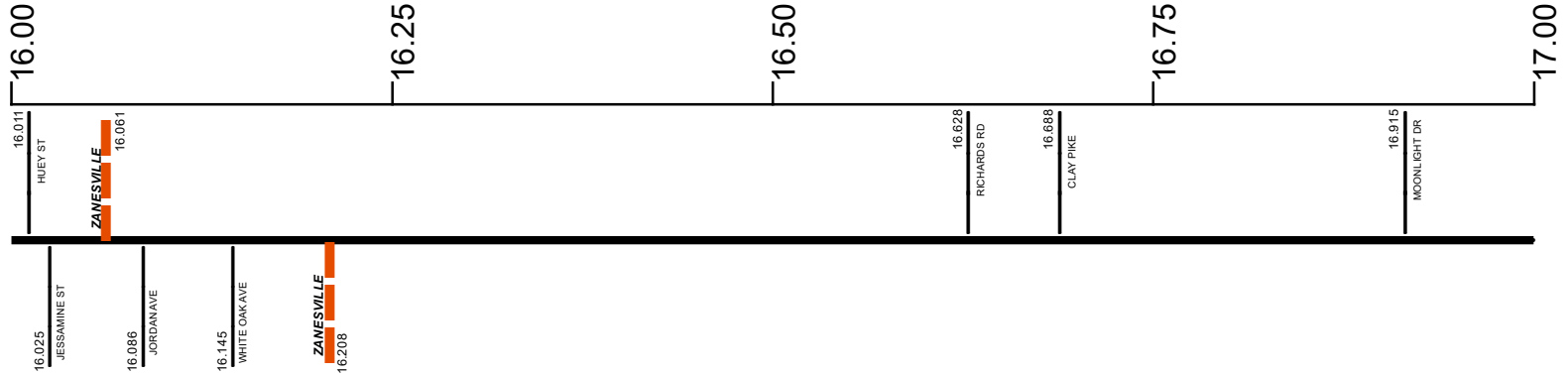

Surface Type & Width (Left / Right)

G 26'	G (16'4')	G 24'	G (16'4')
15.847 - 16.205	16.205 - 16.524	16.524 - 16.815	16.815 - 18.816

Base Type (Left / Right)

T	R	T / L	L	T / L
15.847 - 16.046	16.046 - 16.205	16.205 - 16.524	16.524 - 16.815	16.815 - 17.376

Shoulder Type & Width (Left / Right)

1 (0'0')	2 (4'4')	5 (3'3')
15.209 - 16.205	16.205 - 16.815	16.815 - 17.376

Through Lanes

2
15.209 - 33.766

Street Name

SHARON AVE	CHANDLERSVILLE RD
15.342 - 16.208	16.208 - 33.766

- Non-divided Highway
- Divided Highway
- Secondary Segment
- Corporation
- Bridge (on route)
- Underpass
- Overpass
- Railroad (at grade)
- Railroad (underpass)
- Railroad (overpass)
- Intersection

Created on: 7/3/2025

transportation.ohio.gov

Prepared by
The Ohio Department of Transportation
Office of Technical Services
Roadway Information

SMUSSR00146**C

State True Log

20.451

County True Log

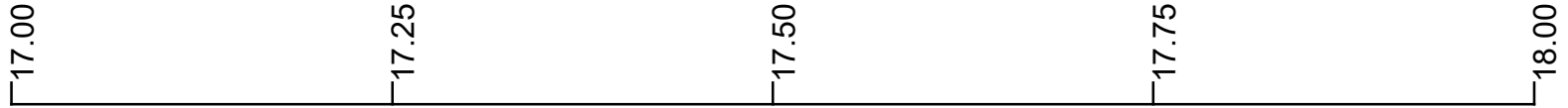

Surface Type & Width (Left / Right)

G (16'4')
16.815 - 18.816

Base Type (Left / Right)

T / L	R / L
16.815 - 17.376	17.376 - 18.816

Shoulder Type & Width (Left / Right)

5 (3'3')	2 (4'4')
16.815 - 17.376	17.376 - 25.677

Through Lanes

2
15.209 - 33.766

Street Name

CHANDLERSVILLE RD
16.208 - 33.766

- Non-divided Highway
 Bridge (on route)
 Railroad (at grade)
 Intersection
- Divided Highway
 Underpass
 Railroad (underpass)
- Secondary Segment
 Overpass
 Railroad (overpass)
- Corporation**

Created on: 7/3/2025

transportation.ohio.gov

Prepared by
The Ohio Department of Transportation
Office of Technical Services
Roadway Information

SMUSSR00146**C

State True Log

21.451

County True Log

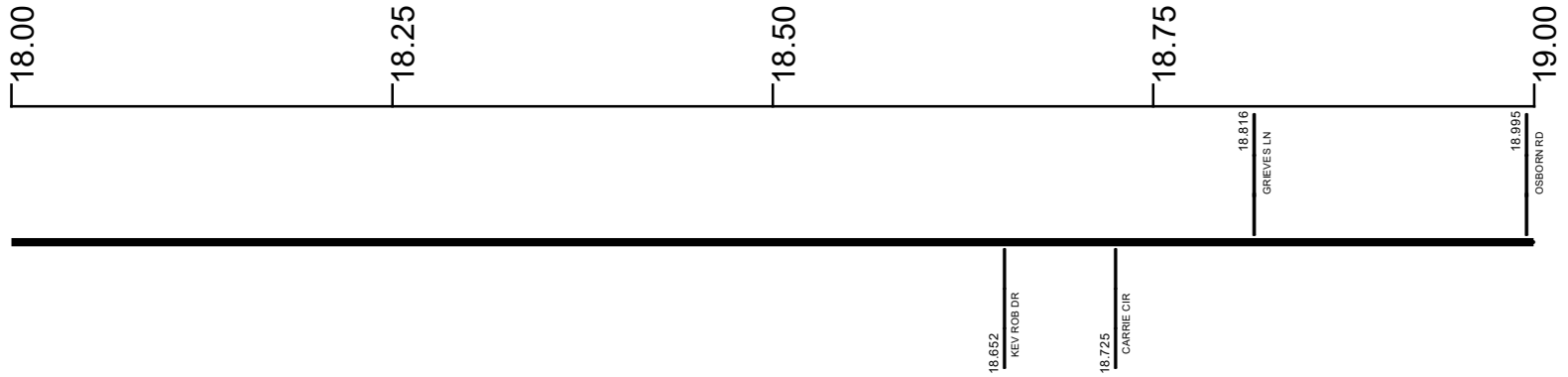

Surface Type & Width (Left / Right)

G (16'4')	G (18'2')
16.815 - 18.816	18.816 - 25.677

Base Type (Left / Right)

R / L	N / L
17.376 - 18.816	18.816 - 25.677

Shoulder Type & Width (Left / Right)

2 (4'4')	
17.376 - 25.677	

Through Lanes

2	
15.209 - 33.766	

Street Name

CHANDLERSVILLE RD	
16.208 - 33.766	

- | | | | |
|---------------------|-------------------|----------------------|--------------|
| Non-divided Highway | Bridge (on route) | Railroad (at grade) | Intersection |
| Divided Highway | Underpass | Railroad (underpass) | |
| Secondary Segment | Overpass | Railroad (overpass) | |
| Corporation | | | |

Created on: 7/3/2025

transportation.ohio.gov

Prepared by
The Ohio Department of Transportation
Office of Technical Services
Roadway Information

SMUSSR00146**C

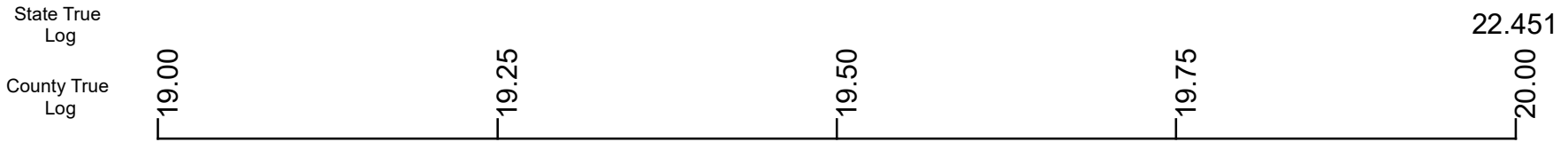

19.945
CANDLESTICK DR

Surface Type & Width (Left / Right)	G (18/2')
	18.816 - 25.677
Base Type (Left / Right)	N / L
	18.816 - 25.677
Shoulder Type & Width (Left / Right)	2 (4/4')
	17.376 - 25.677
Through Lanes	2
	15.209 - 33.766
Street Name	CHANDLERSVILLE RD
	16.208 - 33.766

- | | | | |
|---------------------|-------------------|----------------------|--------------|
| Non-divided Highway | Bridge (on route) | Railroad (at grade) | Intersection |
| Divided Highway | Underpass | Railroad (underpass) | |
| Secondary Segment | Overpass | Railroad (overpass) | |
| Corporation | | | |

Created on: 7/3/2025

transportation.ohio.gov

Prepared by
The Ohio Department of Transportation
Office of Technical Services
Roadway Information

SMUSSR00146**C

State True Log
County True Log

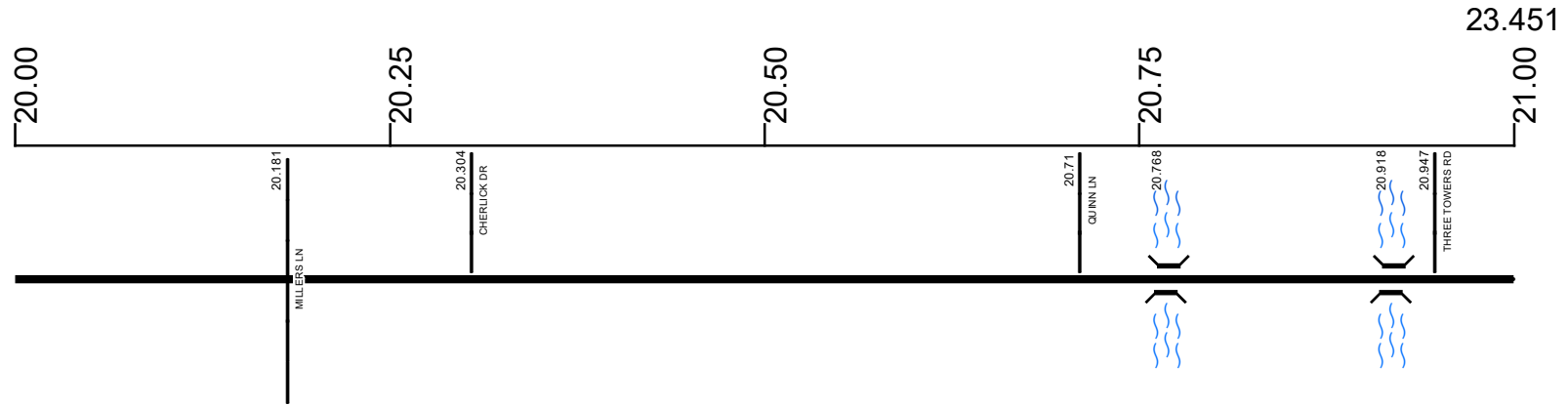

Surface Type & Width (Left / Right)

G (18/2')
18.816 - 25.677

Base Type (Left / Right)

N / L
18.816 - 25.677

Shoulder Type & Width (Left / Right)

2 (4/4')
17.376 - 25.677

Through Lanes

2
15.209 - 33.766

Street Name

CHANDLERSVILLE RD
16.208 - 33.766

- | | | | |
|---------------------|-------------------|----------------------|--------------|
| Non-divided Highway | Bridge (on route) | Railroad (at grade) | Intersection |
| Divided Highway | Underpass | Railroad (underpass) | |
| Secondary Segment | Overpass | Railroad (overpass) | |
| Corporation | | | |

Created on: 7/3/2025



transportation.ohio.gov
Prepared by
The Ohio Department of Transportation
Office of Technical Services
Roadway Information

SMUSSR00146**C

State True Log

24.451

County True Log



Surface Type & Width (Left / Right)	G (18/2') 18.816 - 25.677
Base Type (Left / Right)	N / L 18.816 - 25.677
Shoulder Type & Width (Left / Right)	2 (4/4') 17.376 - 25.677
Through Lanes	2 15.209 - 33.766
Street Name	CHANDLERSVILLE RD 16.208 - 33.766

- | | | | |
|--|---|---|---|
| <ul style="list-style-type: none"> Non-divided Highway Divided Highway Secondary Segment Corporation | <ul style="list-style-type: none"> Bridge (on route) Underpass Overpass | <ul style="list-style-type: none"> Railroad (at grade) Railroad (underpass) Railroad (overpass) | <ul style="list-style-type: none"> Intersection |
|--|---|---|---|

Created on: 7/3/2025

transportation.ohio.gov

Prepared by
The Ohio Department of Transportation
Office of Technical Services
Roadway Information

SMUSSR00146**C

State True Log

25.451

County True Log

22.00

22.25

22.50

22.75

23.00



Surface Type & Width (Left / Right)

G (18/2')
18.816 - 25.677

Base Type (Left / Right)

N / L
18.816 - 25.677

Shoulder Type & Width (Left / Right)

2 (4/4')
17.376 - 25.677

Through Lanes

2
15.209 - 33.766

Street Name

CHANDLERSVILLE RD
16.208 - 33.766

- | | | | |
|---------------------|-------------------|----------------------|--------------|
| Non-divided Highway | Bridge (on route) | Railroad (at grade) | Intersection |
| Divided Highway | Underpass | Railroad (underpass) | |
| Secondary Segment | Overpass | Railroad (overpass) | |
| Corporation | | | |

Created on: 7/3/2025

SMUSSR00146**C

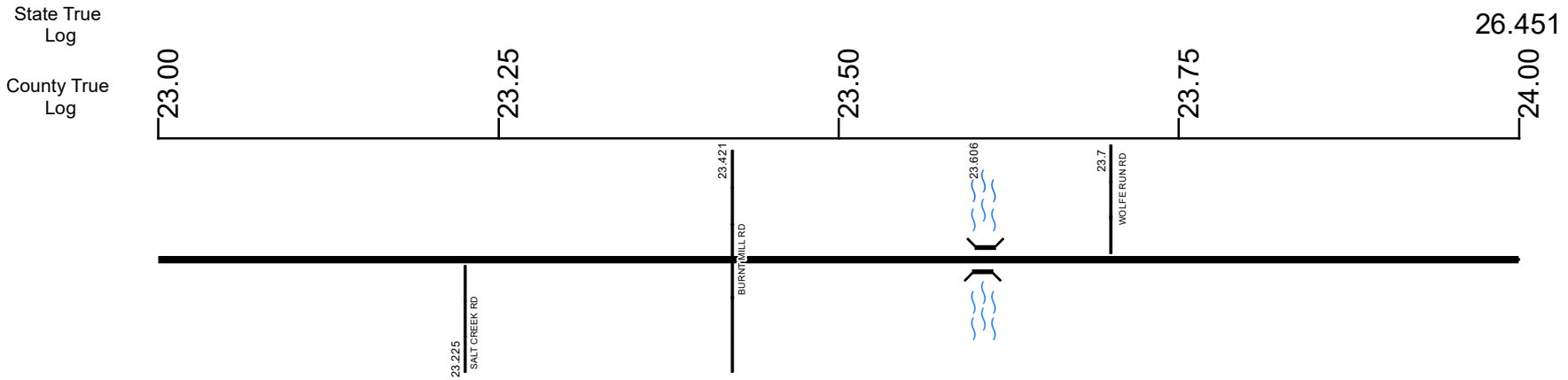

Surface Type & Width (Left / Right)	G (18'2')
	18.816 - 25.677
Base Type (Left / Right)	N / L
	18.816 - 25.677
Shoulder Type & Width (Left / Right)	2 (4'4')
	17.376 - 25.677
Through Lanes	2
	15.209 - 33.766
Street Name	CHANDLERSVILLE RD
	16.208 - 33.766

- Non-divided Highway
- Divided Highway
- Secondary Segment
- Corporation
- Bridge (on route)
- Underpass
- Overpass
- Railroad (at grade)
- Railroad (underpass)
- Railroad (overpass)
- Intersection

Created on: 7/3/2025



transportation.ohio.gov
 Prepared by
 The Ohio Department of Transportation
 Office of Technical Services
 Roadway Information

SMUSSR00146**C

State True Log
County True Log

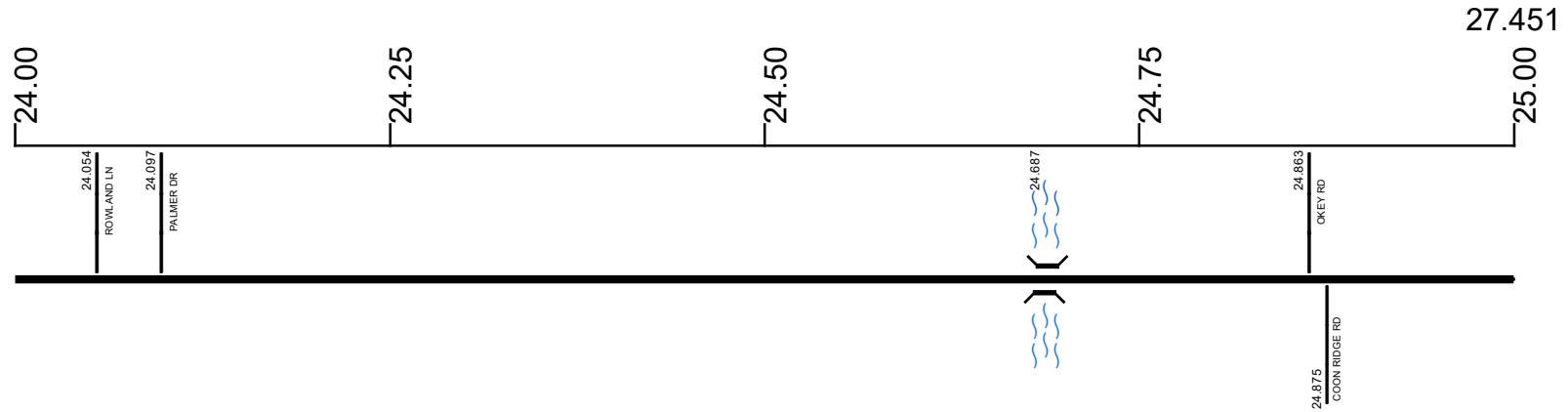

Surface Type & Width (Left / Right)	G (18'2')
	18.816 - 25.677
Base Type (Left / Right)	N / L
	18.816 - 25.677
Shoulder Type & Width (Left / Right)	2 (4'4')
	17.376 - 25.677
Through Lanes	2
	15.209 - 33.766
Street Name	CHANDLERSVILLE RD
	16.208 - 33.766

Non-divided Highway	Bridge (on route)	Railroad (at grade)	Intersection
Divided Highway	Underpass	Railroad (underpass)	
Secondary Segment	Overpass	Railroad (overpass)	
Corporation			

Created on: 7/3/2025

transportation.ohio.gov

Prepared by
The Ohio Department of Transportation
Office of Technical Services
Roadway Information

SMUSSR00146**C

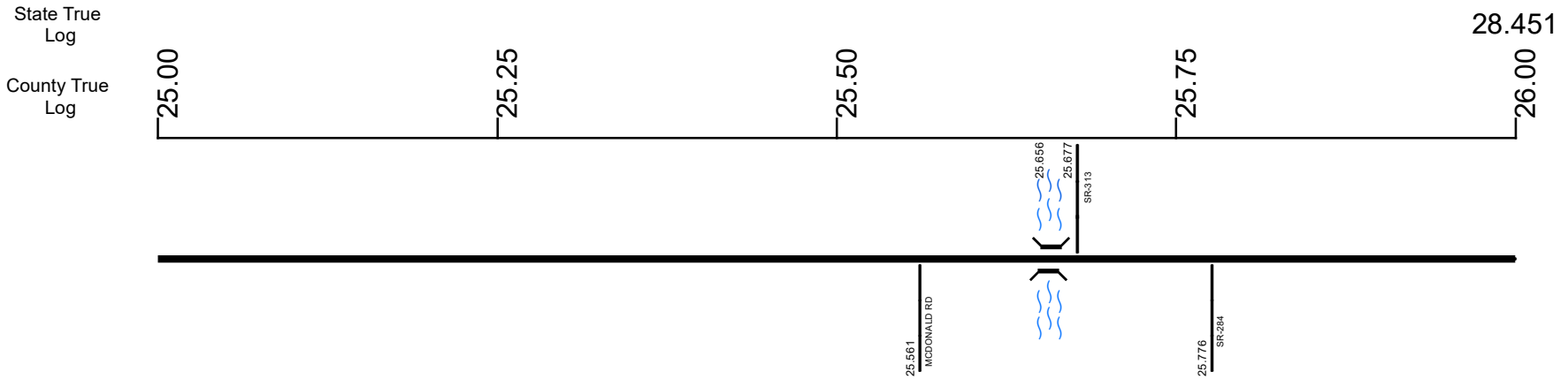

Surface Type & Width (Left / Right)		
G (18'/2')	G 28'	G 20'
18.816 - 25.677	25.677 - 25.826	25.826 - 33.766
Base Type (Left / Right)		
N / L	T	
18.816 - 25.677	25.677 - 33.766	
Shoulder Type & Width (Left / Right)		
2 (4'/4')	1 (0'/0')	2 (4'/4')
17.376 - 25.677	25.677 - 25.826	25.826 - 33.766
Through Lanes		
2		
15.209 - 33.766		
Street Name		
CHANDLERSVILLE RD		
16.208 - 33.766		

Non-divided Highway	Bridge (on route)	Railroad (at grade)	Intersection
Divided Highway	Underpass	Railroad (underpass)	
Secondary Segment	Overpass	Railroad (overpass)	
Corporation			

Created on: 7/3/2025



transportation.ohio.gov
 Prepared by
 The Ohio Department of Transportation
 Office of Technical Services
 Roadway Information

SMUSSR00146**C

State True Log

29.451

County True Log

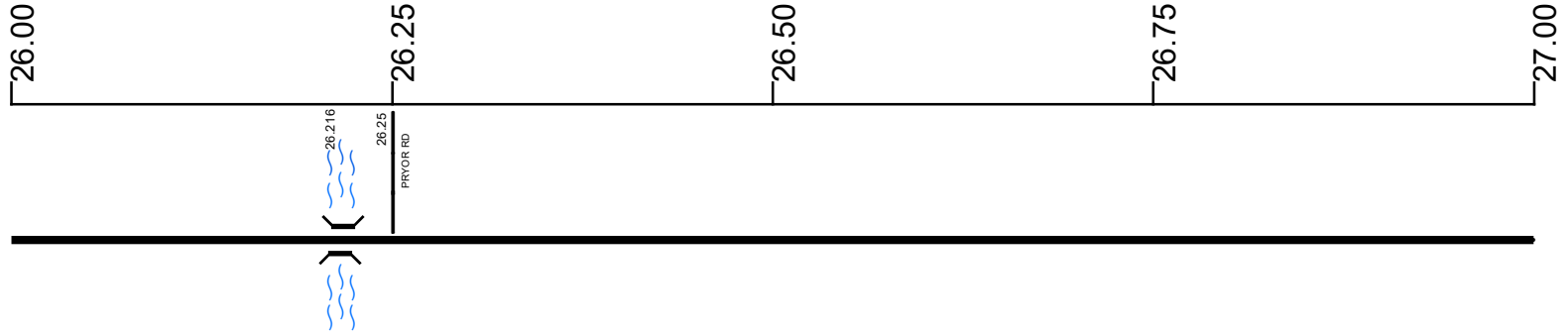

Surface Type & Width (Left / Right)

G 20'
25.826 - 33.766

Base Type (Left / Right)

T
25.677 - 33.766

Shoulder Type & Width (Left / Right)

2 (4/4')
25.826 - 33.766

Through Lanes

2
15.209 - 33.766

Street Name

CHANDLERSVILLE RD
16.208 - 33.766

- | | | | |
|---------------------|-------------------|----------------------|--------------|
| Non-divided Highway | Bridge (on route) | Railroad (at grade) | Intersection |
| Divided Highway | Underpass | Railroad (underpass) | |
| Secondary Segment | Overpass | Railroad (overpass) | |
| Corporation | | | |

Created on: 7/3/2025



transportation.ohio.gov

Prepared by

The Ohio Department of Transportation
Office of Technical Services
Roadway Information

SMUSSR00146**C

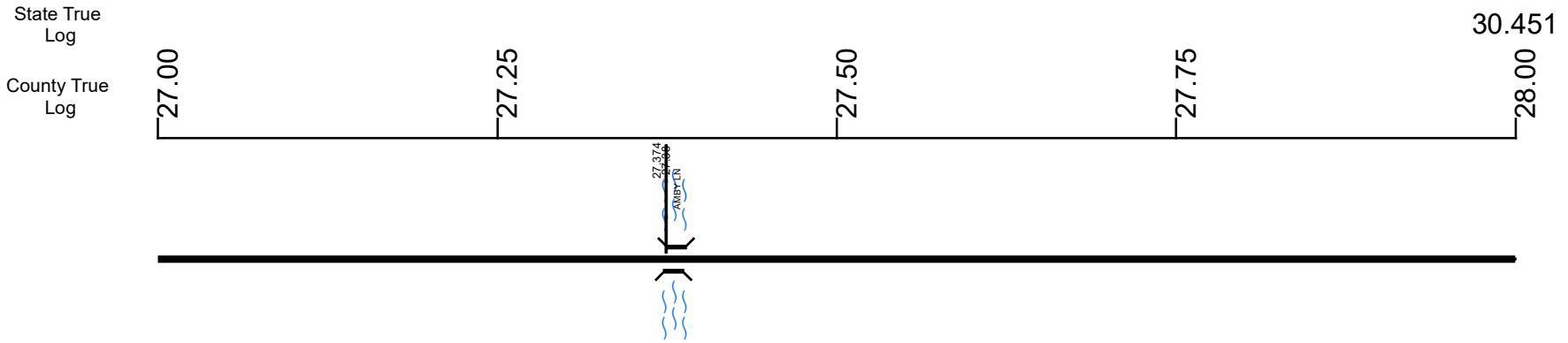

Surface Type & Width (Left / Right)	G 20'
	25.826 - 33.766
Base Type (Left / Right)	T
	25.677 - 33.766
Shoulder Type & Width (Left / Right)	2 (4/4')
	25.826 - 33.766
Through Lanes	2
	15.209 - 33.766
Street Name	CHANDLERSVILLE RD
	16.208 - 33.766

- | | | | |
|--|---|---|---|
| <ul style="list-style-type: none"> Non-divided Highway Divided Highway Secondary Segment Corporation | <ul style="list-style-type: none"> Bridge (on route) Underpass Overpass | <ul style="list-style-type: none"> Railroad (at grade) Railroad (underpass) Railroad (overpass) | <ul style="list-style-type: none"> Intersection |
|--|---|---|---|

Created on: 7/3/2025

transportation.ohio.gov

Prepared by
The Ohio Department of Transportation
Office of Technical Services
Roadway Information

SMUSSR00146**C

State True Log
County True Log

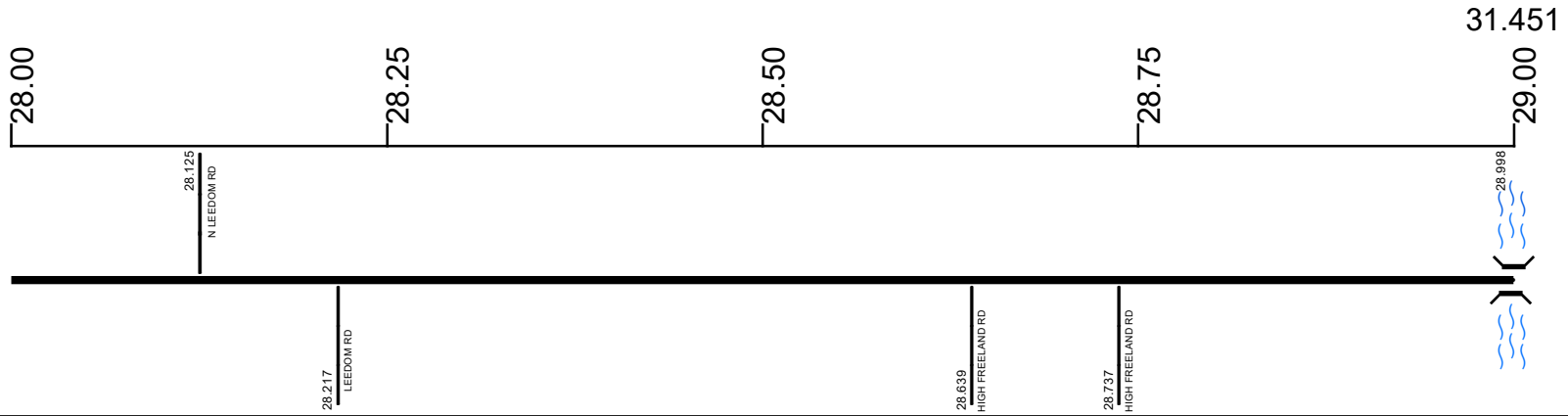

Surface Type & Width (Left / Right)	G 20'
	25.826 - 33.766
Base Type (Left / Right)	T
	25.677 - 33.766
Shoulder Type & Width (Left / Right)	2 (4/4')
	25.826 - 33.766
Through Lanes	2
	15.209 - 33.766
Street Name	CHANDLERSVILLE RD
	16.208 - 33.766

- | | | | |
|---------------------|-------------------|----------------------|--------------|
| Non-divided Highway | Bridge (on route) | Railroad (at grade) | Intersection |
| Divided Highway | Underpass | Railroad (underpass) | |
| Secondary Segment | Overpass | Railroad (overpass) | |
| Corporation | | | |

Created on: 7/3/2025

transportation.ohio.gov

Prepared by
The Ohio Department of Transportation
Office of Technical Services
Roadway Information

SMUSSR00146**C

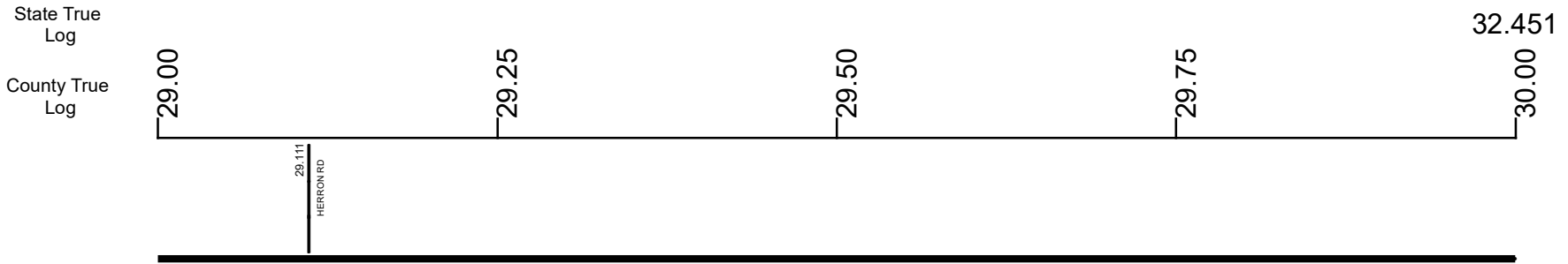

Surface Type & Width (Left / Right)

G 20'
25.826 - 33.766

Base Type (Left / Right)

T
25.677 - 33.766

Shoulder Type & Width (Left / Right)

2 (4/4')
25.826 - 33.766

Through Lanes

2
15.209 - 33.766

Street Name

CHANDLERSVILLE RD
16.208 - 33.766

- Non-divided Highway
- Divided Highway
- Secondary Segment
- Corporation
- Bridge (on route)
- Underpass
- Overpass
- Railroad (at grade)
- Railroad (underpass)
- Railroad (overpass)
- Intersection

Created on: 7/3/2025

transportation.ohio.gov
Prepared by
The Ohio Department of Transportation
Office of Technical Services
Roadway Information

SMUSSR00146**C

State True Log

33.451

County True Log

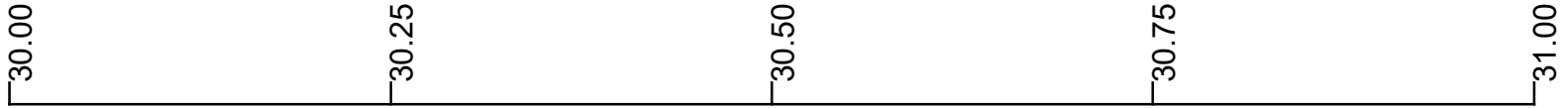

Surface Type & Width (Left / Right)

G 20'
25.826 - 33.766

Base Type (Left / Right)

T
25.677 - 33.766

Shoulder Type & Width (Left / Right)

2 (4/4')
25.826 - 33.766

Through Lanes

2
15.209 - 33.766

Street Name

CHANDLERSVILLE RD
16.208 - 33.766

- | | | | |
|---------------------|-------------------|----------------------|--------------|
| Non-divided Highway | Bridge (on route) | Railroad (at grade) | Intersection |
| Divided Highway | Underpass | Railroad (underpass) | |
| Secondary Segment | Overpass | Railroad (overpass) | |
| Corporation | | | |

Created on: 7/3/2025



transportation.ohio.gov

Prepared by

The Ohio Department of Transportation
Office of Technical Services
Roadway Information

SMUSSR00146**C

State True Log

34.451

County True Log

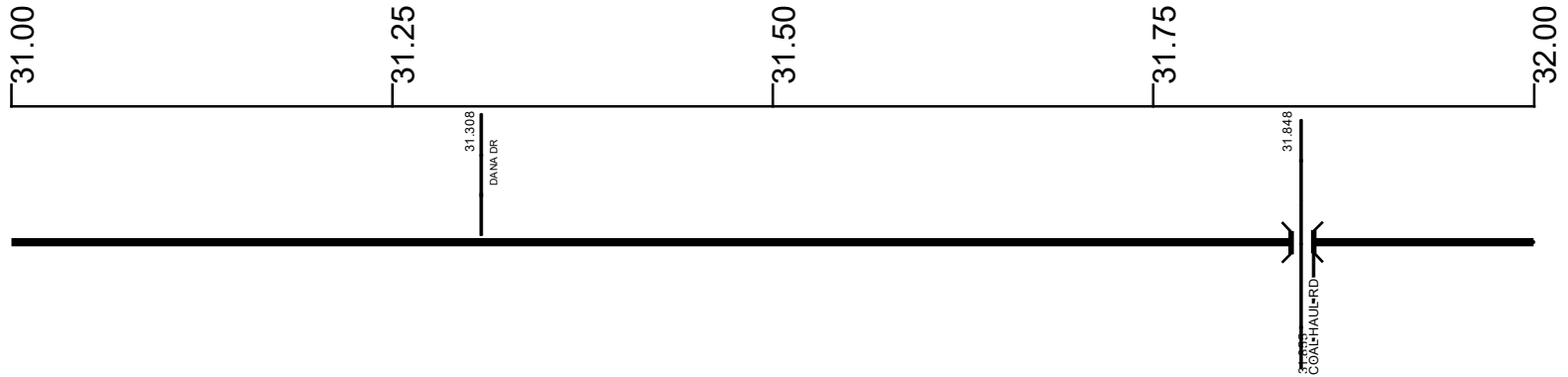

Surface Type & Width (Left / Right)

	G 20'
	25.826 - 33.766

Base Type (Left / Right)

	T
	25.677 - 33.766

Shoulder Type & Width (Left / Right)

	2 (4/4')
	25.826 - 33.766

Through Lanes

	2
	15.209 - 33.766

Street Name

	CHANDLERSVILLE RD
	16.208 - 33.766

- | | | | |
|--|---|---|---|
| <ul style="list-style-type: none"> Non-divided Highway Divided Highway Secondary Segment Corporation | <ul style="list-style-type: none"> Bridge (on route) Underpass Overpass | <ul style="list-style-type: none"> Railroad (at grade) Railroad (underpass) Railroad (overpass) | <ul style="list-style-type: none"> Intersection |
|--|---|---|---|

Created on: 7/3/2025

transportation.ohio.gov

Prepared by
The Ohio Department of Transportation
Office of Technical Services
Roadway Information

SMUSSR00146**C

State True Log

35.451

County True Log

32.00

32.25

32.50

32.75

33.00



Surface Type & Width (Left / Right)

G 20'
25.826 - 33.766

Base Type (Left / Right)

T
25.677 - 33.766

Shoulder Type & Width (Left / Right)

2 (4/4')
25.826 - 33.766

Through Lanes

2
15.209 - 33.766

Street Name

CHANDLERSVILLE RD
16.208 - 33.766

- | | | | |
|---------------------|-------------------|----------------------|--------------|
| Non-divided Highway | Bridge (on route) | Railroad (at grade) | Intersection |
| Divided Highway | Underpass | Railroad (underpass) | |
| Secondary Segment | Overpass | Railroad (overpass) | |
| Corporation | | | |

Created on: 7/3/2025

transportation.ohio.gov

Prepared by
The Ohio Department of Transportation
Office of Technical Services
Roadway Information

SMUSSR00146**C

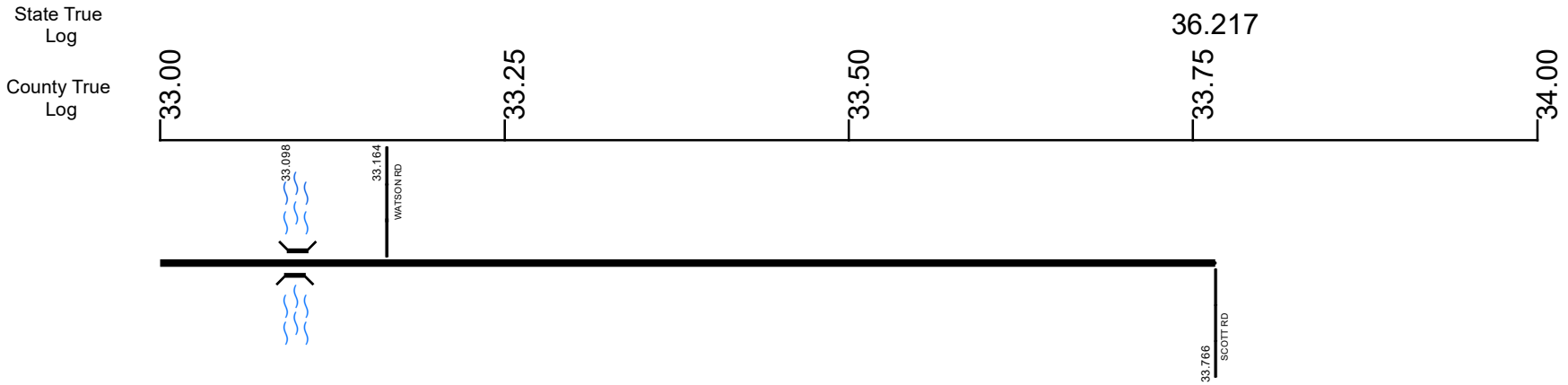

Surface Type & Width (Left / Right)	G 20'
	25.826 - 33.766
Base Type (Left / Right)	T
	25.677 - 33.766
Shoulder Type & Width (Left / Right)	2 (4'4')
	25.826 - 33.766
Through Lanes	2
	15.209 - 33.766
Street Name	CHANDLERSVILLE RD
	16.208 - 33.766

Non-divided Highway	Bridge (on route)	Railroad (at grade)	Intersection
Divided Highway	Underpass	Railroad (underpass)	
Secondary Segment	Overpass	Railroad (overpass)	
Corporation			

Created on: 7/3/2025



transportation.ohio.gov

Prepared by
The Ohio Department of Transportation
Office of Technical Services
Roadway Information

Historical Project List for SMU SSR00146**C

Begin Measure	End Measure	Project ID Number	Construction Completion Date	Treatment Category	Treatment Type
0.000	2.210	93002	10-2018	Minor Rehabilitation	60-AC Overlay w/Rpr
0.000	3.030	22637	10-2004	Minor Rehabilitation	60-AC Overlay w/Rpr
2.210	9.930	95963	12-2019	Minor Rehabilitation	60-AC Overlay w/Rpr
2.210	10.040	76460	8-2011	Minor Rehabilitation	60-AC Overlay w/Rpr
9.930	10.040	95963	12-2019	Minor Rehabilitation	60-AC Overlay w/Rpr
10.040	10.310	95963	12-2019	Minor Rehabilitation	60-AC Overlay w/Rpr
10.040	10.390	76460	8-2011	Minor Rehabilitation	60-AC Overlay w/Rpr
10.310	10.390	95963	12-2019	Minor Rehabilitation	60-AC Overlay w/Rpr
10.390	10.490	95963	12-2019	Minor Rehabilitation	60-AC Overlay w/Rpr
10.390	10.490	76460	8-2011	Minor Rehabilitation	60-AC Overlay w/Rpr
10.490	12.202	95963	12-2019	Minor Rehabilitation	60-AC Overlay w/Rpr
10.490	12.232	76460	8-2011	Minor Rehabilitation	60-AC Overlay w/Rpr
12.202	13.013	92974	11-2017	Minor Rehabilitation	60-AC Overlay w/Rpr
12.322	12.762	77098	5-2009	Minor Rehabilitation	60-AC Overlay w/Rpr
12.853	13.013	76460	8-2011	Minor Rehabilitation	60-AC Overlay w/Rpr
13.013	13.313	92974	11-2017	Minor Rehabilitation	60-AC Overlay w/Rpr
13.013	13.093	76460	8-2011	Minor Rehabilitation	60-AC Overlay w/Rpr
15.213	16.062	92974	11-2017	Minor Rehabilitation	60-AC Overlay w/Rpr
16.062	16.221	92974	11-2017	Minor Rehabilitation	60-AC Overlay w/Rpr
16.221	17.559	95510	8-2018	Minor Rehabilitation	38-Fine Poly AC Overlay
16.221	16.940	87604	10-2010	Minor Rehabilitation	38-Fine Poly AC Overlay
16.940	25.648	87604	10-2010	Minor Rehabilitation	38-Fine Poly AC Overlay
17.559	25.778	95510	8-2018	Minor Rehabilitation	38-Fine Poly AC Overlay
25.648	33.763	85016	8-2011	Minor Rehabilitation	60-AC Overlay w/Rpr

Roadway Codes

Access Control Journalized

- F - Full Access Control
- L - Limited Access Control
- N - No Access Control

Access Control Operational

- 1 - Full Access Control
- 2 - Partial Access Control
- 3 - No Access Control

Base Type

- F - Crack and Seat
- H - Rubblize and Roll
- I - Aggregate Base 304 or Traffic Compacted
- K - Water Bound Macadam
- L - Bituminous Concrete Mix or Penetration Macadam
- N - Plain Concrete
- P - Reinforced Concrete
- R - Brick (Flexible)
- T - Brick (Rigid)

Direction of Travel

- B - Both (Two-way)
- F - One-way Cardinal
- T - One-way Non-cardinal

Facility Type

- 1 - One-way Roadway
- 2 - Two-way Roadway
- 4 - Ramp
- 5 - Non-mainline
- 6 - Non-inventory Direction
- 7 - Planned / Unbuilt

Historical Federal Aid Indicator

- N - Not a FAP Route
- Y - FAP Route

Functional Classification

- 01 - Interstate
- 02 - Principal Arterial (Freeways)
- 03 - Principal Arterial (Other)
- 04 - Minor Arterial
- 05 - Major Collector
- 06 - Minor Collector
- 07 - Local

Leave / Reenter Indicator

- Y - Route leaves/reenters at this point
- N - Route does not leave/reenter at this point

Median Type

- 1 - None
- 2 - Unprotected
- 3 - Curbed
- 4 - Positive Barrier (Unspecified)
- 5 - Positive Barrier (Flexible)
- 6 - Positive Barrier (Semi-rigid)
- 7 - Positive Barrier (Rigid)

NHS

- N - National Highway System
- H - Congressional Corridor
- 2 - Major Airport
- 3 - Major Port Facility
- 4 - Major Amtrak Station
- 5 - Major Rail / Truck Terminal
- 6 - Major Intercity Bus Terminal
- 7 - Major Public Transit / Multi-modal Passenger Terminal
- 8 - Major Pipeline Terminal
- 9 - Major Ferry Terminal

Priority System

- G - General
- P - Priority System
- U - Urban

Scenic Byway Code

- A - All American Road
- N - National Scenic Byway
- S - State Scenic Byway

Shoulder Type

- 1 - None
- 2 - Surfaced shoulder exists (bituminous concrete {AC})
- 3 - Surfaced shoulder exists (Portland Cement Concrete {PCC})
- 4 - Stabilized shoulder exists (gravel or other granular material)
- 5 - Combination shoulder exists (two or more surface types)
- 6 - Earth shoulder exists
- 7 - Barrier curb exists; no shoulder in front of curb

Surface Type

- A - Combination
- B - Brick
- C - Continuous Reinforced Concrete
- D - Reinforced Concrete
- E - Plain Concrete
- G - Bituminous Concrete
- I - Chipseal on Granular
- K - Open Graded Bituminous
- L - Chipseal or Micro
- M - Gravel
- U - Unimproved
- X - Right of Way Only