

SNOBSR00146**C

State True Log 46.775

47.775

County True Log

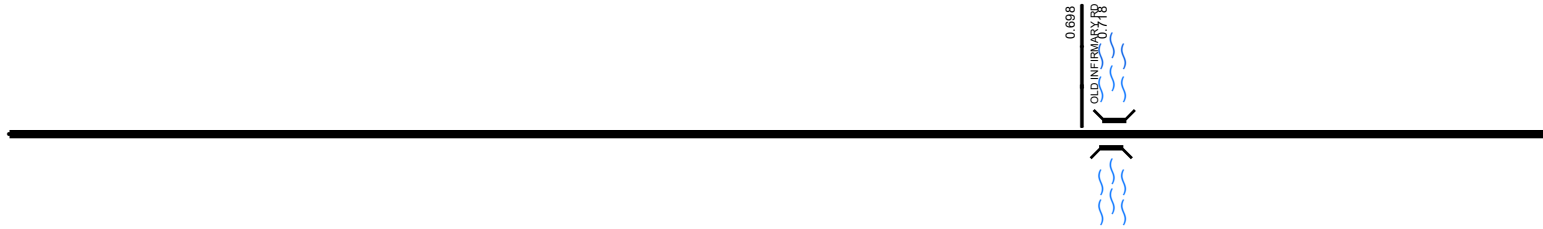

Surface Type & Width (Left / Right)

G 20'	G 18'
0 - 0.84	0.84 - 7.897

Base Type (Left / Right)

I	
0 - 8.277	

Shoulder Type & Width (Left / Right)

2 (3/3)	
0 - 8.277	

Through Lanes

2	
0 - 18.443	

Street Name

ZEP RD	
0 - 8.176	

- | | | | |
|--|---|---|---|
| <ul style="list-style-type: none"> Non-divided Highway Divided Highway Secondary Segment Corporation | <ul style="list-style-type: none"> Bridge (on route) Underpass Overpass | <ul style="list-style-type: none"> Railroad (at grade) Railroad (underpass) Railroad (overpass) | <ul style="list-style-type: none"> Intersection |
|--|---|---|---|

Created on: 7/3/2025

transportation.ohio.gov

Prepared by
The Ohio Department of Transportation
Office of Technical Services
Roadway Information

SNOBSR00146**C

State True Log

48.775

County True Log

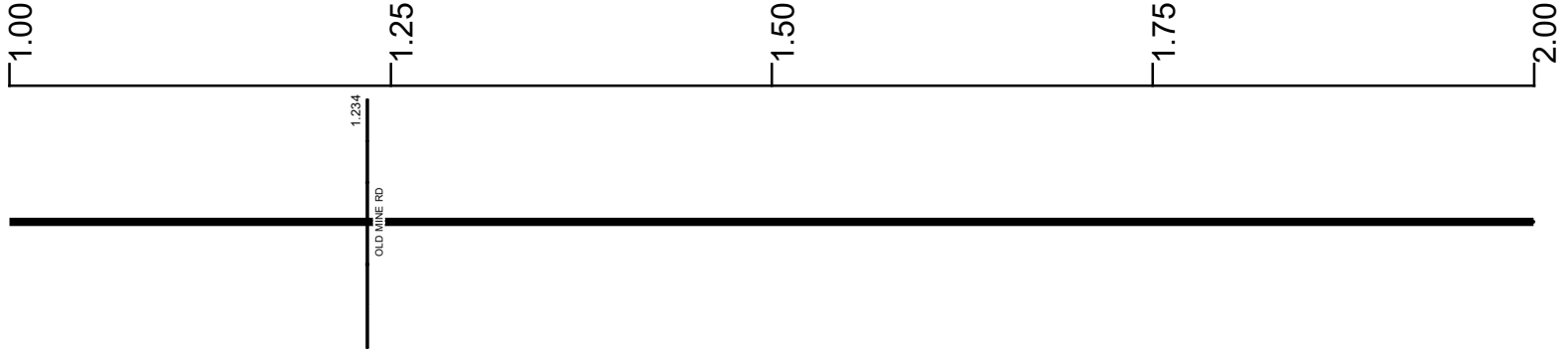

Surface Type & Width (Left / Right)

G 18'
0.84 - 7.897

Base Type (Left / Right)

I
0 - 8.277

Shoulder Type & Width (Left / Right)

2 (3/3)
0 - 8.277

Through Lanes

2
0 - 18.443

Street Name

ZEP RD
0 - 8.176

- Non-divided Highway
 Bridge (on route)
 Railroad (at grade)
 Intersection
- Divided Highway
 Underpass
 Railroad (underpass)
- Secondary Segment
 Overpass
 Railroad (overpass)
- Corporation**

Created on: 7/3/2025

transportation.ohio.gov

Prepared by
The Ohio Department of Transportation
Office of Technical Services
Roadway Information

SNOBSR00146**C

State True Log

49.775

County True Log

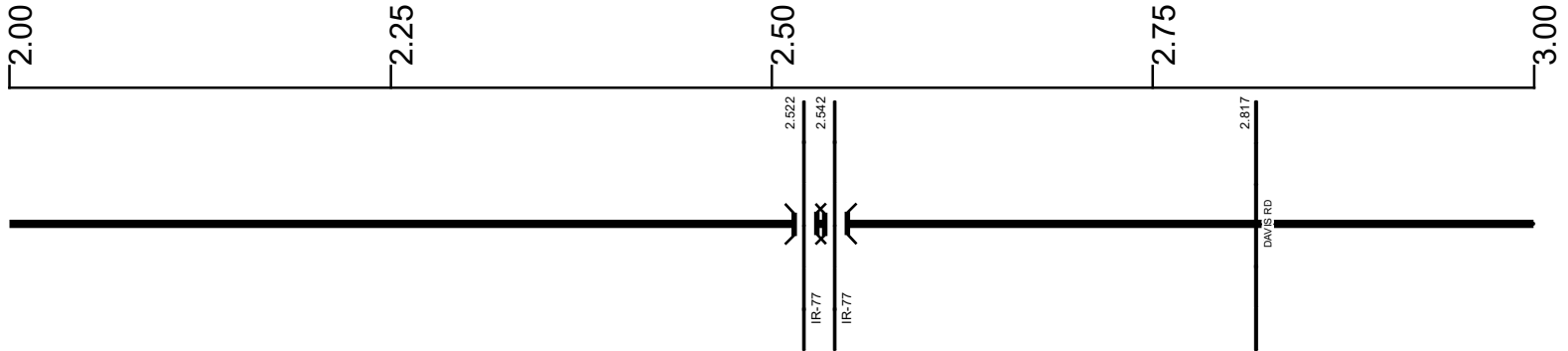

Surface Type & Width (Left / Right)

G 18'
0.84 - 7.897

Base Type (Left / Right)

I
0 - 8.277

Shoulder Type & Width (Left / Right)

2 (3/3)
0 - 8.277

Through Lanes

2
0 - 18.443

Street Name

ZEP RD
0 - 8.176

- | | | | |
|---------------------|-------------------|----------------------|--------------|
| Non-divided Highway | Bridge (on route) | Railroad (at grade) | Intersection |
| Divided Highway | Underpass | Railroad (underpass) | |
| Secondary Segment | Overpass | Railroad (overpass) | |
| Corporation | | | |

Created on: 7/3/2025



transportation.ohio.gov
Prepared by
The Ohio Department of Transportation
Office of Technical Services
Roadway Information

SNOBSR00146**C

State True Log

50.775

County True Log

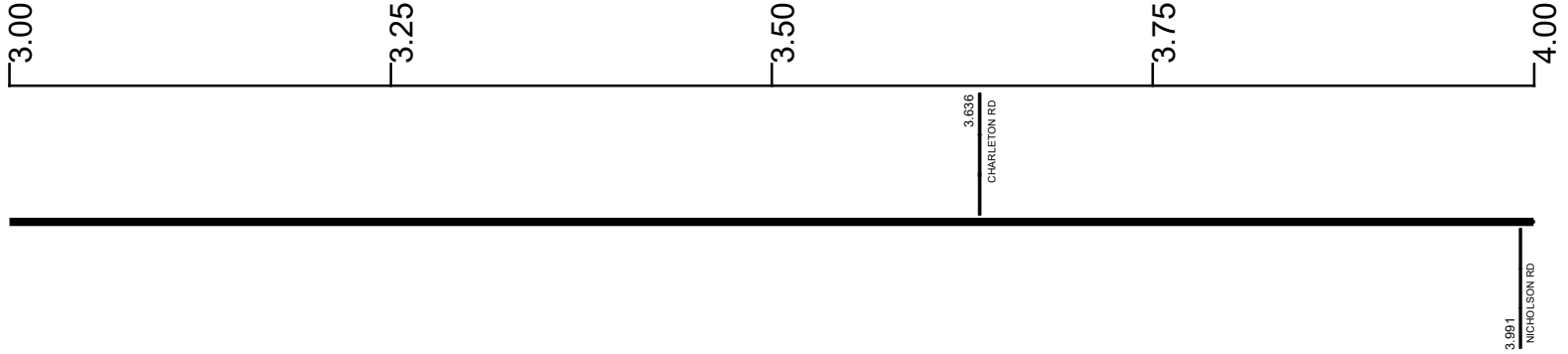

Surface Type & Width (Left / Right)

G 18'
0.84 - 7.897

Base Type (Left / Right)

I
0 - 8.277

Shoulder Type & Width (Left / Right)

2 (3/3)
0 - 8.277

Through Lanes

2
0 - 18.443

Street Name

ZEP RD
0 - 8.176

- | | | | |
|---------------------|-------------------|----------------------|--------------|
| Non-divided Highway | Bridge (on route) | Railroad (at grade) | Intersection |
| Divided Highway | Underpass | Railroad (underpass) | |
| Secondary Segment | Overpass | Railroad (overpass) | |
| Corporation | | | |

Created on: 7/3/2025

transportation.ohio.gov

Prepared by
The Ohio Department of Transportation
Office of Technical Services
Roadway Information

SNOBSR00146**C

State True Log

51.775

County True Log

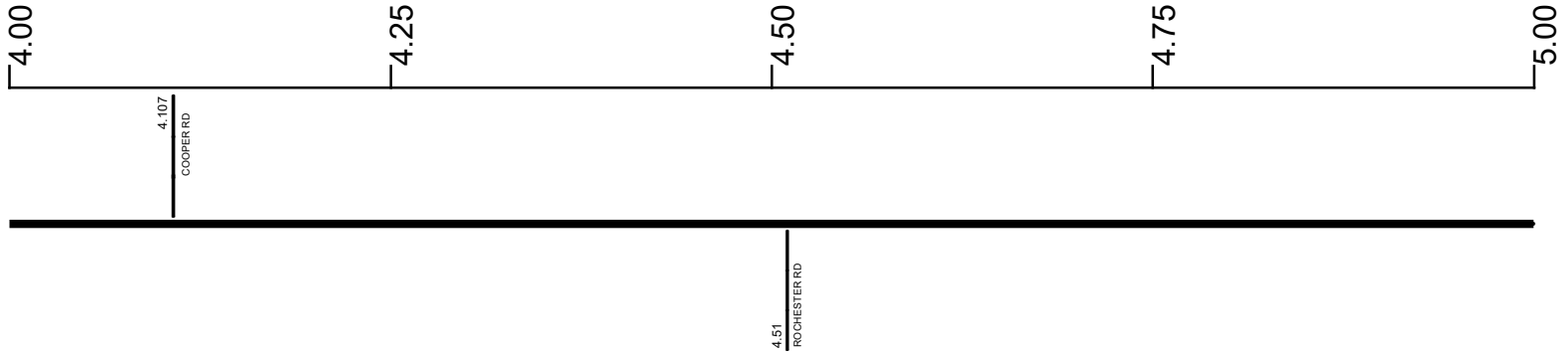

Surface Type & Width (Left / Right)

G 18'
0.84 - 7.897

Base Type (Left / Right)

I
0 - 8.277

Shoulder Type & Width (Left / Right)

2 (3/3)
0 - 8.277

Through Lanes

2
0 - 18.443

Street Name

ZEP RD
0 - 8.176

- | | | | |
|---------------------|-------------------|----------------------|--------------|
| Non-divided Highway | Bridge (on route) | Railroad (at grade) | Intersection |
| Divided Highway | Underpass | Railroad (underpass) | |
| Secondary Segment | Overpass | Railroad (overpass) | |
| Corporation | | | |

Created on: 7/3/2025

transportation.ohio.gov

Prepared by
The Ohio Department of Transportation
Office of Technical Services
Roadway Information

SNOBSR00146**C

State True Log

52.775

County True Log

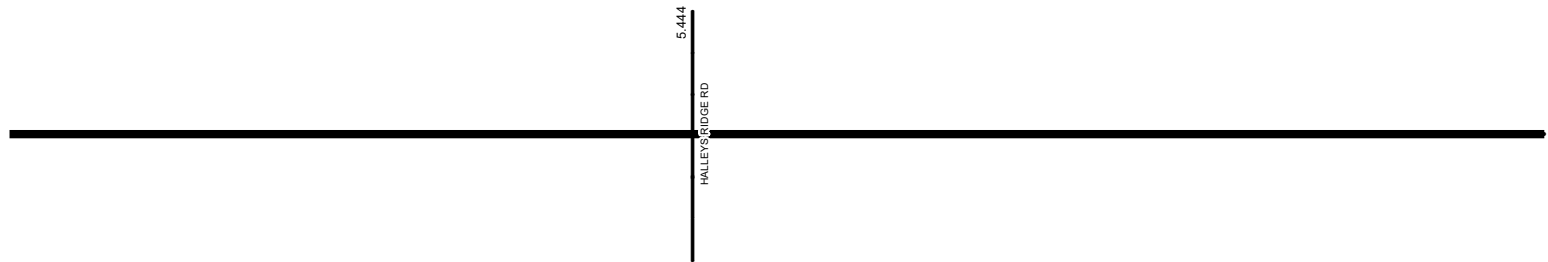

Surface Type & Width (Left / Right)

G 18'
0.84 - 7.897

Base Type (Left / Right)

I
0 - 8.277

Shoulder Type & Width (Left / Right)

2 (3/3)
0 - 8.277

Through Lanes

2
0 - 18.443

Street Name

ZEP RD
0 - 8.176

- | | | | |
|---------------------|-------------------|----------------------|--------------|
| Non-divided Highway | Bridge (on route) | Railroad (at grade) | Intersection |
| Divided Highway | Underpass | Railroad (underpass) | |
| Secondary Segment | Overpass | Railroad (overpass) | |
| Corporation | | | |

Created on: 7/3/2025

transportation.ohio.gov

Prepared by
The Ohio Department of Transportation
Office of Technical Services
Roadway Information

SNOBSR00146**C

State True Log

53.775

County True Log

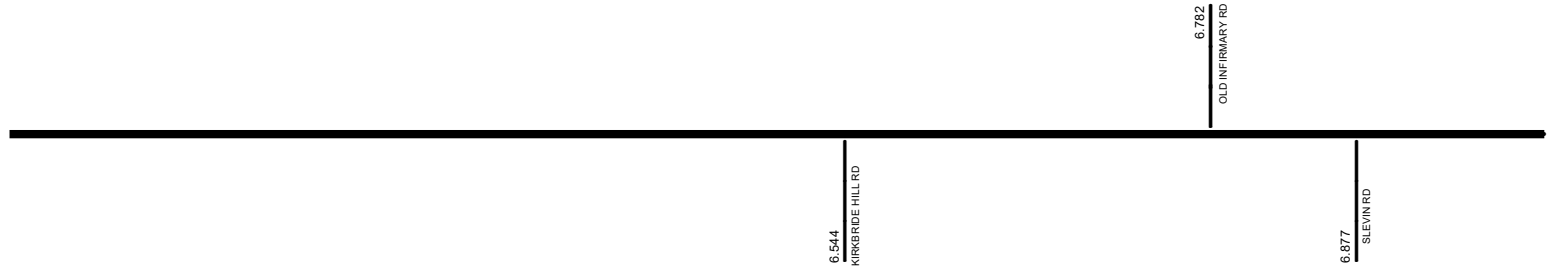

Surface Type & Width (Left / Right)

G 18'
0.84 - 7.897

Base Type (Left / Right)

I
0 - 8.277

Shoulder Type & Width (Left / Right)

2 (3/3)
0 - 8.277

Through Lanes

2
0 - 18.443

Street Name

ZEP RD
0 - 8.176

- | | | | |
|---------------------|-------------------|----------------------|--------------|
| Non-divided Highway | Bridge (on route) | Railroad (at grade) | Intersection |
| Divided Highway | Underpass | Railroad (underpass) | |
| Secondary Segment | Overpass | Railroad (overpass) | |
| Corporation | | | |

Created on: 7/3/2025

transportation.ohio.gov

Prepared by
The Ohio Department of Transportation
Office of Technical Services
Roadway Information

SNOBSR00146**C

State True Log

54.775

County True Log

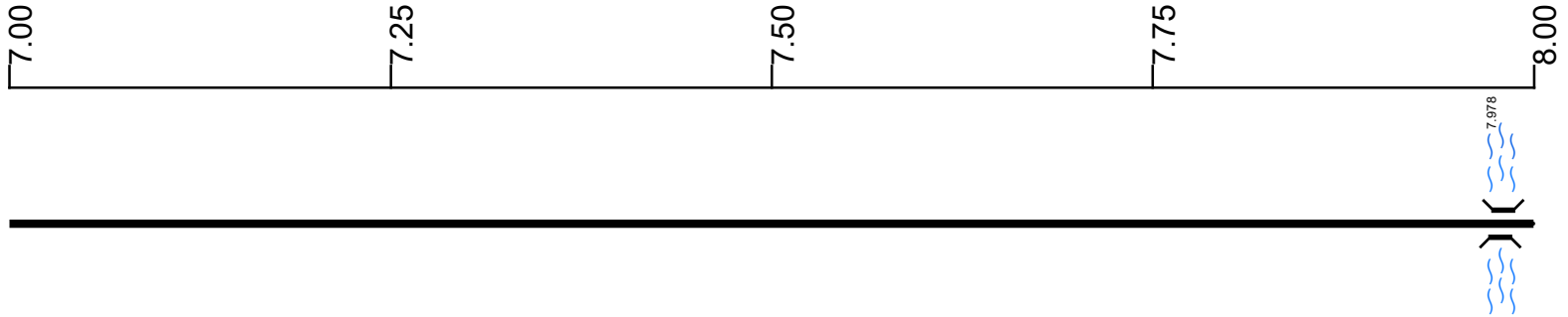

Surface Type & Width (Left / Right)

G 18'	G 20'
0.84 - 7.897	7.897 - 8.277

Base Type (Left / Right)

I	
0 - 8.277	

Shoulder Type & Width (Left / Right)

2 (3/3)	
0 - 8.277	

Resurface Year

2022

7.957 - 7.997

Through Lanes

2	
0 - 18.443	

Street Name

ZEP RD	
0 - 8.176	

- | | | | |
|--|---|---|---|
| <ul style="list-style-type: none"> Non-divided Highway Divided Highway Secondary Segment Corporation | <ul style="list-style-type: none"> Bridge (on route) Underpass Overpass | <ul style="list-style-type: none"> Railroad (at grade) Railroad (underpass) Railroad (overpass) | <ul style="list-style-type: none"> Intersection |
|--|---|---|---|

Created on: 7/3/2025

transportation.ohio.gov

Prepared by

The Ohio Department of Transportation

Office of Technical Services

Roadway Information

SNOBSR00146**C

State True Log

55.775

County True Log

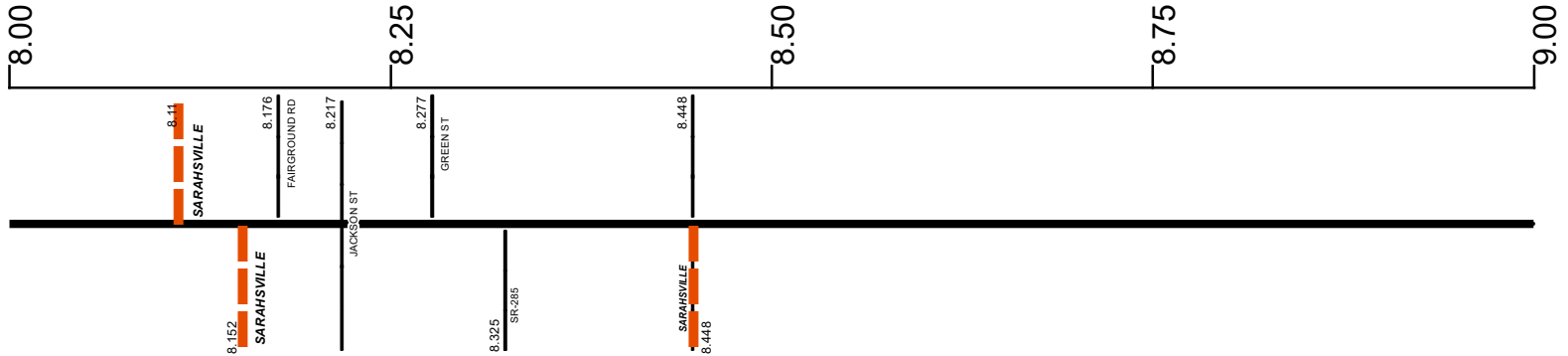

Surface Type & Width (Left / Right)

G 20'	G 24'	G 20'
7.897 - 8.277	8.277 - 8.798	8.798 - 9.249

Base Type (Left / Right)

I	L	I
0 - 8.277	8.277 - 8.798	8.798 - 9.249

Shoulder Type & Width (Left / Right)

2 (3'/3')	2 (8'/8')	2 (2'/2')
0 - 8.277	8.277 - 8.798	8.798 - 9.249

Through Lanes

	2	
	0 - 18.443	

Street Name

ZEP RD	GREEN ST MARIETTA RD	SR 146	SENECA LAKE RD
0 - 8.176	8.176 - 8.277 8.277 - 8.325	8.325 - 8.448	8.448 - 9.349

- Non-divided Highway
 Bridge (on route)
 Railroad (at grade)
 Intersection
- Divided Highway
 Underpass
 Railroad (underpass)
- Secondary Segment
 Overpass
 Railroad (overpass)
- Corporation**

Created on: 7/3/2025

transportation.ohio.gov

Prepared by
The Ohio Department of Transportation
Office of Technical Services
Roadway Information

SNOBSR00146**C

State True Log

56.775

County True Log

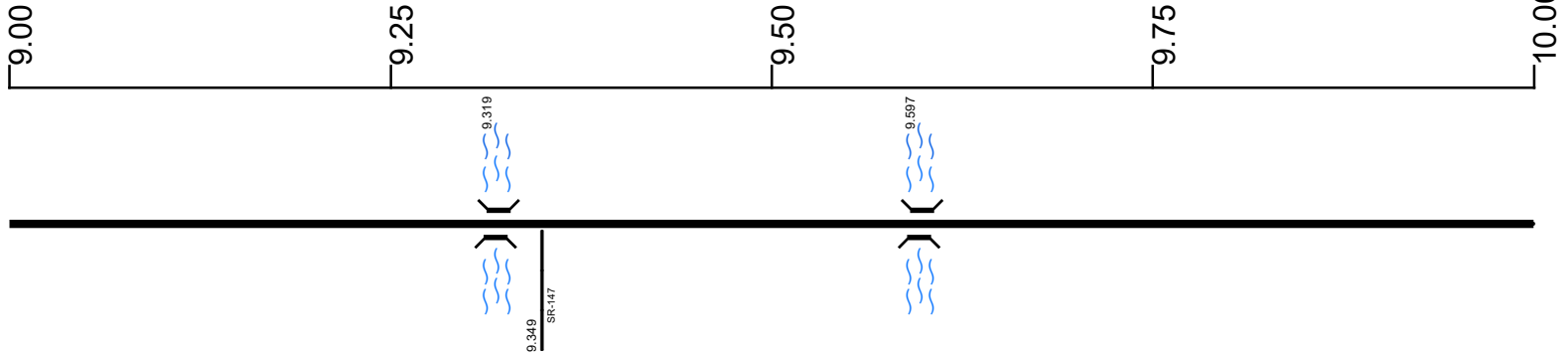

Surface Type & Width (Left / Right)

G 20'	G (20'4')	G 20'
8.798 - 9.249	9.249 - 9.359	9.359 - 13.504

Base Type (Left / Right)

I	I / L	I
8.798 - 9.249	9.249 - 9.359	9.359 - 17.863

Shoulder Type & Width (Left / Right)

2 (2'2')	2 (4'4')	2 (2'2')
8.798 - 9.249	9.249 - 9.359	9.359 - 13.504

Through Lanes

2
0 - 18.443

Street Name

SENECA LAKE RD	ZEP RD
8.448 - 9.349	9.349 - 17.864

- Non-divided Highway
- Divided Highway
- Secondary Segment
- Corporation
- Bridge (on route)
- Underpass
- Overpass
- Railroad (at grade)
- Railroad (underpass)
- Railroad (overpass)
- Intersection

Created on: 7/3/2025

transportation.ohio.gov

Prepared by
The Ohio Department of Transportation
Office of Technical Services
Roadway Information

SNOBSR00146**C

State True Log

57.775

County True Log



Surface Type & Width (Left / Right)

G 20'	
9.359 - 13.504	

Base Type (Left / Right)

I	
9.359 - 17.863	

Shoulder Type & Width (Left / Right)

2 (2'/2')	
9.359 - 13.504	

Through Lanes

2	
0 - 18.443	

Street Name

ZEP RD	
9.349 - 17.864	

<p> Non-divided Highway</p> <p> Divided Highway</p> <p> Secondary Segment</p> <p> Corporation</p>	<p> Bridge (on route)</p> <p> Underpass</p> <p> Overpass</p>	<p> Railroad (at grade)</p> <p> Railroad (underpass)</p> <p> Railroad (overpass)</p>	<p> Intersection</p>
--	--	--	----------------------

Created on: 7/3/2025

transportation.ohio.gov

Prepared by

The Ohio Department of Transportation

Office of Technical Services

Roadway Information

SNOBSR00146**C

State True Log

58.775

County True Log

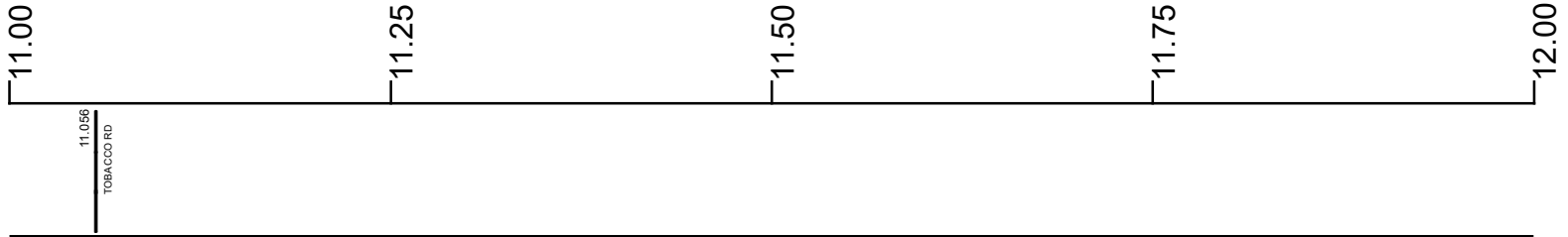

Surface Type & Width (Left / Right)

G 20'
9.359 - 13.504

Base Type (Left / Right)

I
9.359 - 17.863

Shoulder Type & Width (Left / Right)

2 (2'/2')
9.359 - 13.504

Through Lanes

2
0 - 18.443

Street Name

ZEP RD
9.349 - 17.864

- | | | | |
|---------------------|-------------------|----------------------|--------------|
| Non-divided Highway | Bridge (on route) | Railroad (at grade) | Intersection |
| Divided Highway | Underpass | Railroad (underpass) | |
| Secondary Segment | Overpass | Railroad (overpass) | |
| Corporation | | | |

Created on: 7/3/2025

transportation.ohio.gov

Prepared by
The Ohio Department of Transportation
Office of Technical Services
Roadway Information

SNOBSR00146**C

State True Log

59.775

County True Log

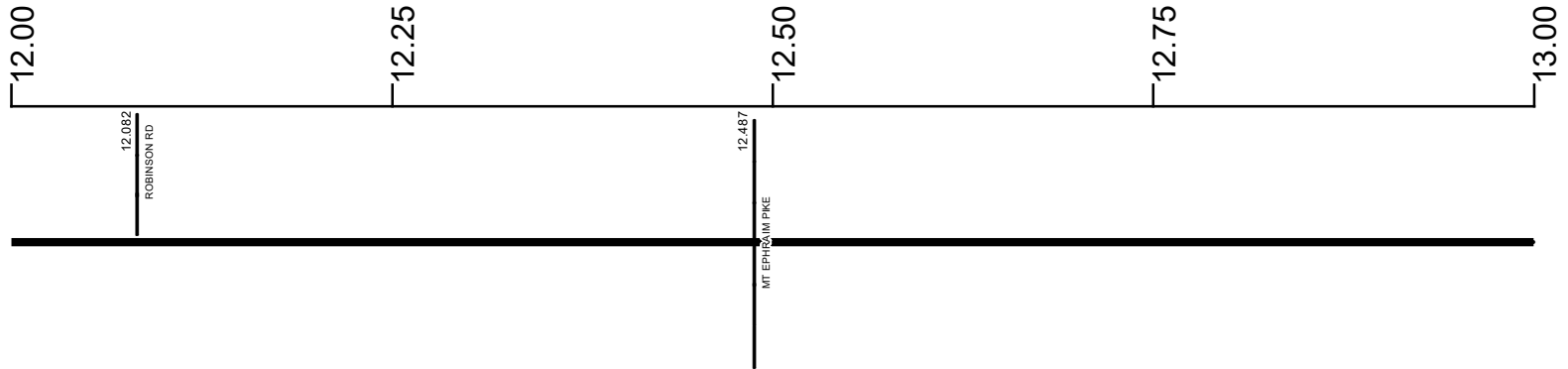

Surface Type & Width (Left / Right)

G 20'
9.359 - 13.504

Base Type (Left / Right)

I
9.359 - 17.863

Shoulder Type & Width (Left / Right)

2 (2 1/2')
9.359 - 13.504

Through Lanes

2
0 - 18.443

Street Name

ZEP RD
9.349 - 17.864

- | | | | |
|---------------------|-------------------|----------------------|--------------|
| Non-divided Highway | Bridge (on route) | Railroad (at grade) | Intersection |
| Divided Highway | Underpass | Railroad (underpass) | |
| Secondary Segment | Overpass | Railroad (overpass) | |
| Corporation | | | |

Created on: 7/3/2025

transportation.ohio.gov

Prepared by
The Ohio Department of Transportation
Office of Technical Services
Roadway Information

SNOBSR00146**C

State True Log

60.775

County True Log

13.008
ROBERTA CLEARY LN

13.25

13.50

13.75

14.00

13.008
ROBERTA CLEARY LN

13.971
GOULD WARD RD

Surface Type & Width (Left / Right)

G 20' 9.359 - 13.504	G 18' 13.504 - 17.863
-------------------------	--------------------------

Base Type (Left / Right)

I 9.359 - 17.863	
---------------------	--

Shoulder Type & Width (Left / Right)

2 (2'/2') 9.359 - 13.504	2 (3'/3') 13.504 - 17.863
-----------------------------	------------------------------

Through Lanes

2 0 - 18.443

Street Name

ZEP RD 9.349 - 17.864

- | | | | |
|---------------------|-------------------|----------------------|--------------|
| Non-divided Highway | Bridge (on route) | Railroad (at grade) | Intersection |
| Divided Highway | Underpass | Railroad (underpass) | |
| Secondary Segment | Overpass | Railroad (overpass) | |
| Corporation | | | |

Created on: 7/3/2025

transportation.ohio.gov

Prepared by
The Ohio Department of Transportation
Office of Technical Services
Roadway Information

SNOBSR00146**C

State True Log

61.775

County True Log

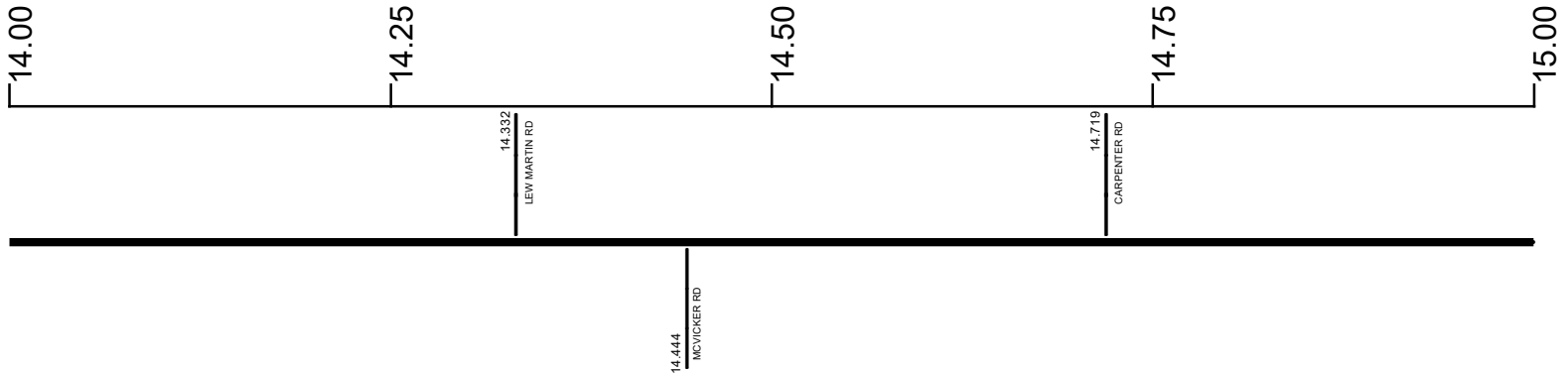

Surface Type & Width (Left / Right)

G 18'
13.504 - 17.863

Base Type (Left / Right)

I
9.359 - 17.863

Shoulder Type & Width (Left / Right)

2 (3/3)
13.504 - 17.863

Through Lanes

2
0 - 18.443

Street Name

ZEP RD
9.349 - 17.864

- | | | | |
|---------------------|-------------------|----------------------|--------------|
| Non-divided Highway | Bridge (on route) | Railroad (at grade) | Intersection |
| Divided Highway | Underpass | Railroad (underpass) | |
| Secondary Segment | Overpass | Railroad (overpass) | |
| Corporation | | | |

Created on: 7/3/2025

transportation.ohio.gov

Prepared by
The Ohio Department of Transportation
Office of Technical Services
Roadway Information

SNOBSR00146**C

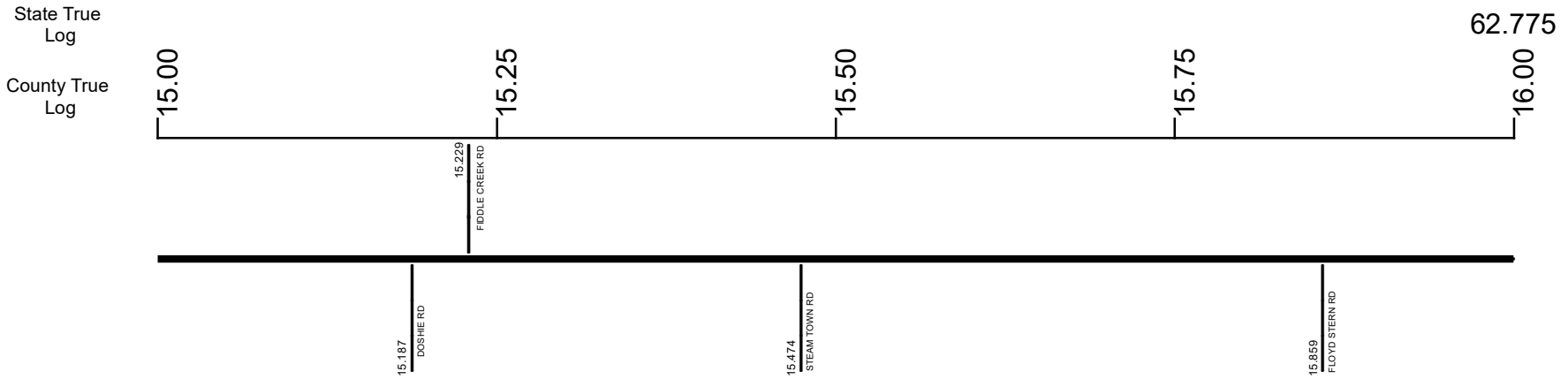

Surface Type & Width (Left / Right)	G 18'
	13.504 - 17.863
Base Type (Left / Right)	I
	9.359 - 17.863
Shoulder Type & Width (Left / Right)	2 (3/3')
	13.504 - 17.863
Through Lanes	2
	0 - 18.443
Street Name	ZEP RD
	9.349 - 17.864

- Non-divided Highway
- Divided Highway
- Secondary Segment
- Corporation
- Bridge (on route)
- Underpass
- Overpass
- Railroad (at grade)
- Railroad (underpass)
- Railroad (overpass)
- Intersection

Created on: 7/3/2025



transportation.ohio.gov
 Prepared by
 The Ohio Department of Transportation
 Office of Technical Services
 Roadway Information

SNOBSR00146**C

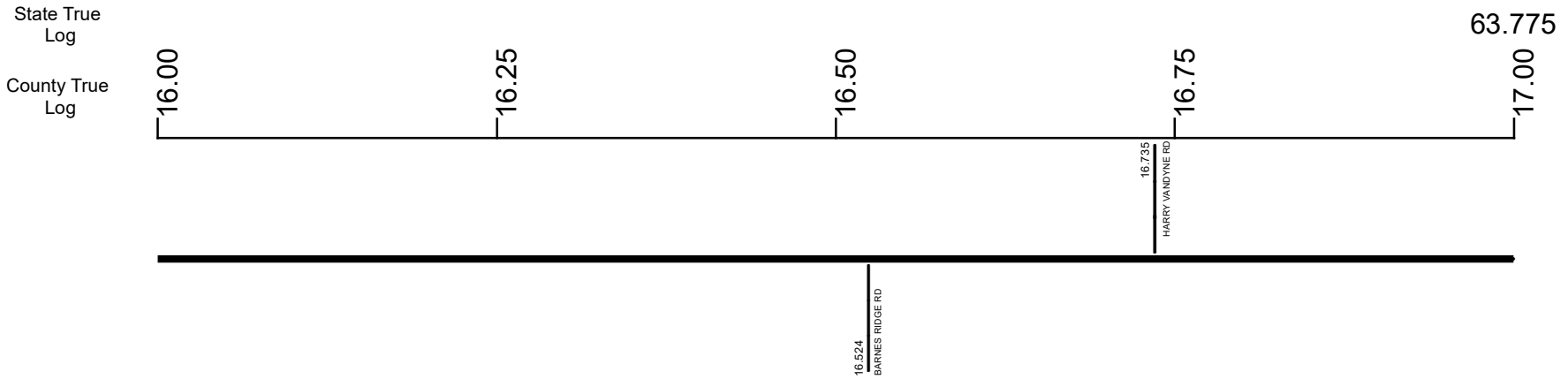

Surface Type & Width (Left / Right)	G 18'	13.504 - 17.863
Base Type (Left / Right)	I	9.359 - 17.863
Shoulder Type & Width (Left / Right)	2 (3/3')	13.504 - 17.863
Through Lanes	2	0 - 18.443
Street Name	ZEP RD	9.349 - 17.864

Non-divided Highway	Bridge (on route)	Railroad (at grade)	Intersection
Divided Highway	Underpass	Railroad (underpass)	
Secondary Segment	Overpass	Railroad (overpass)	
Corporation			

Created on: 7/3/2025



transportation.ohio.gov
 Prepared by
 The Ohio Department of Transportation
 Office of Technical Services
 Roadway Information

SNOBSR00146**C

State True Log
County True Log

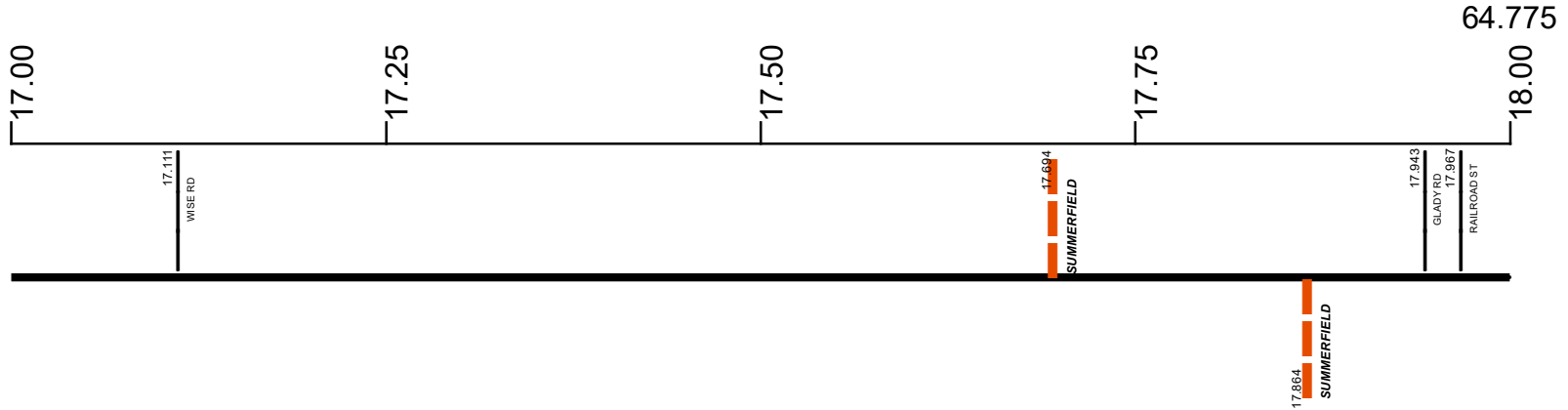

Surface Type & Width (Left / Right)

G 18'	G (16'4')	G (16'8')
13.504 - 17.863	17.863 - 17.955	

Base Type (Left / Right)

I	I/L	N/L
9.359 - 17.863	17.863 - 17.955	17.955 - 18.151

Shoulder Type & Width (Left / Right)

2 (3'3')	2 (2'2')	2 (4'4')
13.504 - 17.863	17.863 - 17.955	17.955 - 18.151

Through Lanes

2	
0 - 18.443	

Street Name

ZEP RD	CROSS ST
9.349 - 17.864	17.864 - 18.151

- Non-divided Highway
- Divided Highway
- Secondary Segment
- Corporation
- Bridge (on route)
- Underpass
- Overpass
- Railroad (at grade)
- Railroad (underpass)
- Railroad (overpass)
- Intersection

Created on: 7/3/2025

transportation.ohio.gov

Prepared by
The Ohio Department of Transportation
Office of Technical Services
Roadway Information

SNOBSR00146**C

65.218

State True
Log

County True
Log

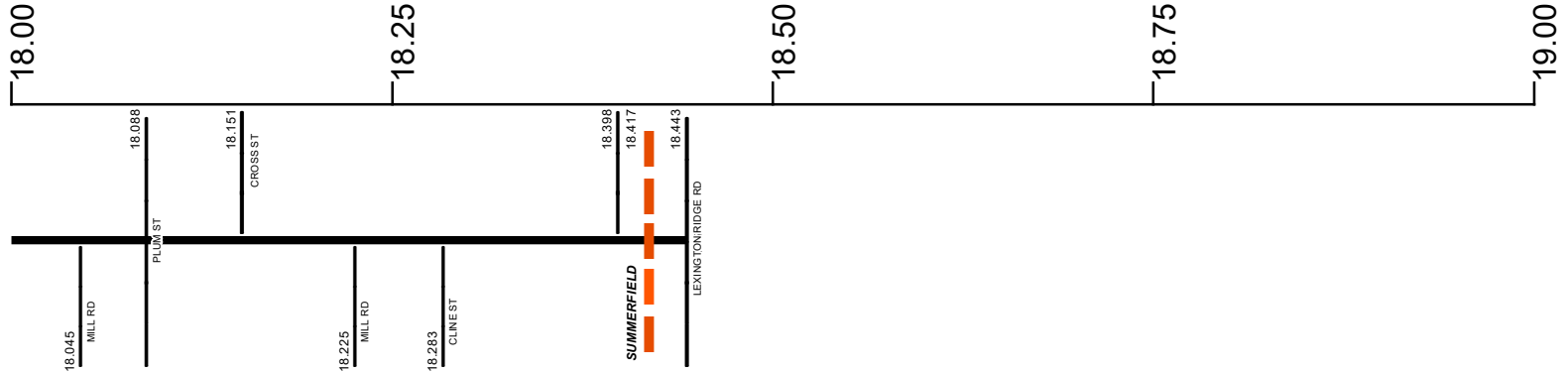

Surface Type & Width (Left / Right)

G (16'8')	G (16'4')	G 24'
17.955 - 18.151	18.151 - 18.226	18.226 - 18.443

Base Type (Left / Right)

N / L	I / L	L
17.955 - 18.151	18.151 - 18.226	18.226 - 18.443

Shoulder Type & Width (Left / Right)

2 (4'4')	2 (2'2')	2 (8'8')
17.955 - 18.151	18.151 - 18.226	18.226 - 18.443

Through Lanes

2
0 - 18.443

Street Name

CROSS ST	MAIN ST
17.864 - 18.151	18.151 - 18.443

- | | | | |
|--|---|---|---|
| <ul style="list-style-type: none"> Non-divided Highway Divided Highway Secondary Segment Corporation | <ul style="list-style-type: none"> Bridge (on route) Underpass Overpass | <ul style="list-style-type: none"> Railroad (at grade) Railroad (underpass) Railroad (overpass) | <ul style="list-style-type: none"> Intersection |
|--|---|---|---|

Created on: 7/3/2025



Prepared by
The Ohio Department of Transportation
Office of Technical Services
Roadway Information

Historical Project List for SNOBSR00146**C

Begin Measure	End Measure	Project ID Number	Construction Completion Date	Treatment Category	Treatment Type
0.000	8.150	87114	8-2019	Preventive Maintenance	25-Chip Seal
0.000	8.150	82842	8-2012	Minor Rehabilitation	50-AC Overlay w/o Rpr
8.150	9.400	82889	7-2016	Minor Rehabilitation	60-AC Overlay w/Rpr
8.150	9.400	24737	6-2005	Minor Rehabilitation	50-AC Overlay w/o Rpr
9.400	18.500	104082	12-2017	Minor Rehabilitation	60-AC Overlay w/Rpr
9.400	18.500	24822	9-2006	Minor Rehabilitation	50-AC Overlay w/o Rpr

Roadway Codes

Access Control Journalized

- F - Full Access Control
- L - Limited Access Control
- N - No Access Control

Access Control Operational

- 1 - Full Access Control
- 2 - Partial Access Control
- 3 - No Access Control

Base Type

- F - Crack and Seat
- H - Rubblize and Roll
- I - Aggregate Base 304 or Traffic Compacted
- K - Water Bound Macadam
- L - Bituminous Concrete Mix or Penetration Macadam
- N - Plain Concrete
- P - Reinforced Concrete
- R - Brick (Flexible)
- T - Brick (Rigid)

Direction of Travel

- B - Both (Two-way)
- F - One-way Cardinal
- T - One-way Non-cardinal

Facility Type

- 1 - One-way Roadway
- 2 - Two-way Roadway
- 4 - Ramp
- 5 - Non-mainline
- 6 - Non-inventory Direction
- 7 - Planned / Unbuilt

Historical Federal Aid Indicator

- N - Not a FAP Route
- Y - FAP Route

Functional Classification

- 01 - Interstate
- 02 - Principal Arterial (Freeways)
- 03 - Principal Arterial (Other)
- 04 - Minor Arterial
- 05 - Major Collector
- 06 - Minor Collector
- 07 - Local

Leave / Reenter Indicator

- Y - Route leaves/reenters at this point
- N - Route does not leave/reenter at this point

Median Type

- 1 - None
- 2 - Unprotected
- 3 - Curbed
- 4 - Positive Barrier (Unspecified)
- 5 - Positive Barrier (Flexible)
- 6 - Positive Barrier (Semi-rigid)
- 7 - Positive Barrier (Rigid)

NHS

- N - National Highway System
- H - Congressional Corridor
- 2 - Major Airport
- 3 - Major Port Facility
- 4 - Major Amtrak Station
- 5 - Major Rail / Truck Terminal
- 6 - Major Intercity Bus Terminal
- 7 - Major Public Transit / Multi-modal Passenger Terminal
- 8 - Major Pipeline Terminal
- 9 - Major Ferry Terminal

Priority System

- G - General
- P - Priority System
- U - Urban

Scenic Byway Code

- A - All American Road
- N - National Scenic Byway
- S - State Scenic Byway

Shoulder Type

- 1 - None
- 2 - Surfaced shoulder exists (bituminous concrete {AC})
- 3 - Surfaced shoulder exists (Portland Cement Concrete {PCC})
- 4 - Stabilized shoulder exists (gravel or other granular material)
- 5 - Combination shoulder exists (two or more surface types)
- 6 - Earth shoulder exists
- 7 - Barrier curb exists; no shoulder in front of curb

Surface Type

- A - Combination
- B - Brick
- C - Continuous Reinforced Concrete
- D - Reinforced Concrete
- E - Plain Concrete
- G - Bituminous Concrete
- I - Chipseal on Granular
- K - Open Graded Bituminous
- L - Chipseal or Micro
- M - Gravel
- U - Unimproved
- X - Right of Way Only