

# SNOBSR00821\*\*C

State True Log 20.771

21.771

County True Log

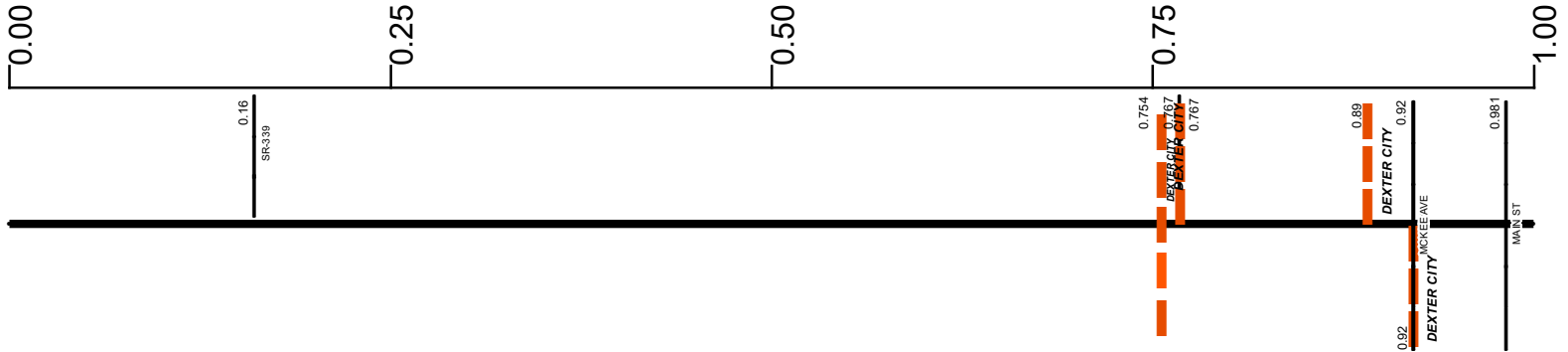

**Surface Type & Width (Left / Right)**

G 20'	G (13'/14')	G (11'/12')
0 - 0.757	0.757 - 0.808	0.808 - 1.289

**Base Type (Left / Right)**

N	T
0 - 0.808	0.808 - 1.289

**Shoulder Type & Width (Left / Right)**

5 (1'/1')	2 (0'/0')	1 (2'/2')
0 - 0.757	0.757 - 0.808	0.808 - 1.289

**Through Lanes**

2	
0 - 21.324	

**Street Name**

MARIETTA RD	JEFFERSON ST
0 - 0.754	0.754 - 1.31

- Non-divided Highway
- Divided Highway
- Secondary Segment
- Corporation
- Bridge (on route)
- Underpass
- Overpass
- Railroad (at grade)
- Railroad (underpass)
- Railroad (overpass)
- Intersection

Created on: 7/3/2025

transportation.ohio.gov

Prepared by  
The Ohio Department of Transportation  
Office of Technical Services  
Roadway Information

# SNOBSR00821\*\*C

State True Log

22.771

County True Log

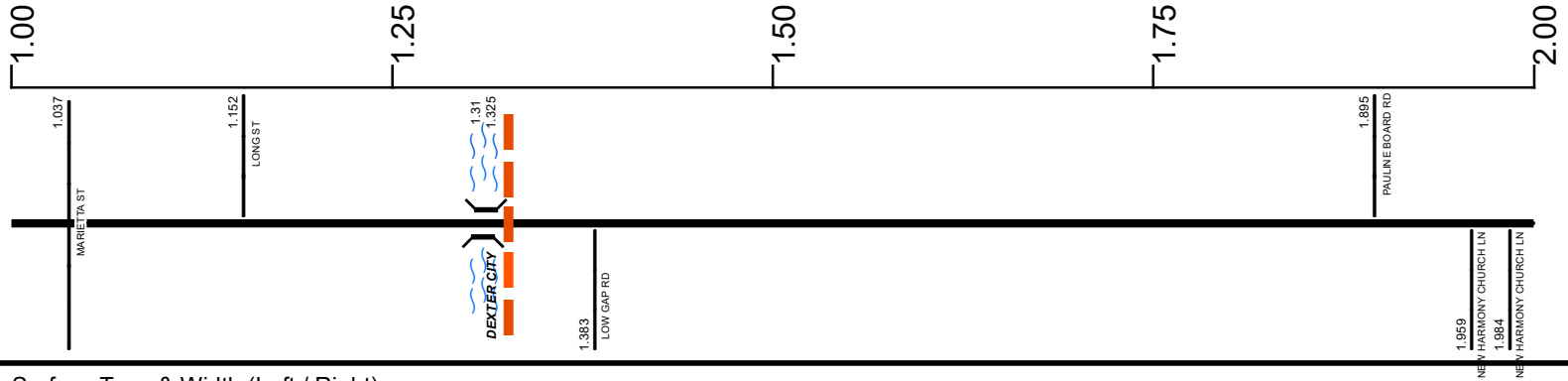

**Surface Type & Width (Left / Right)**

G (11'12')	G 22'	G (10'11')
0.808 - 1.289	1.289 - 1.352	1.352 - 2.157

**Base Type (Left / Right)**

T	L	T
0.808 - 1.289	1.289 - 1.352	1.352 - 2.157

**Shoulder Type & Width (Left / Right)**

1 (2'2')	2 (6'6')	5 (1'1')
0.808 - 1.289	1.289 - 1.352	1.352 - 2.157

**Through Lanes**

2
0 - 21.324

**Street Name**

JEFFERSON ST	MARIETTA RD
0.754 - 1.31	1.31 - 8.112

- Non-divided Highway
- Divided Highway
- Secondary Segment
- Corporation
- Bridge (on route)
- Underpass
- Overpass
- Railroad (at grade)
- Railroad (underpass)
- Railroad (overpass)
- Intersection

Created on: 7/3/2025

transportation.ohio.gov

Prepared by  
The Ohio Department of Transportation  
Office of Technical Services  
Roadway Information

# SNOBSR00821\*\*C

State True Log

23.771

County True Log

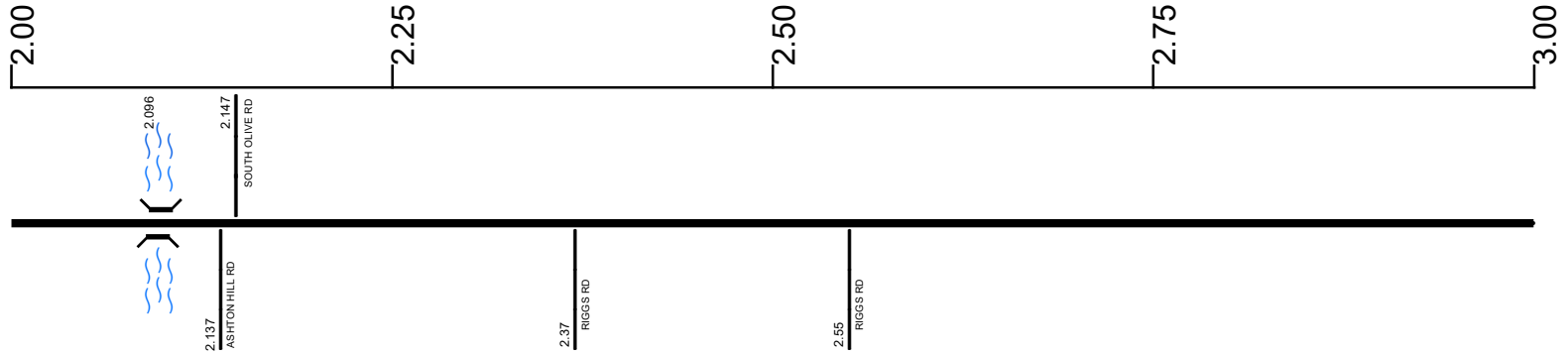

**Surface Type & Width (Left / Right)**

G (10'/11')	G 24'
1.352 - 2.157	2.157 - 7.597

**Base Type (Left / Right)**

T	P
1.352 - 2.157	2.157 - 7.309

**Shoulder Type & Width (Left / Right)**

5 (1'/1')	5 (4'/4')
1.352 - 2.157	2.157 - 7.597

**Through Lanes**

	2
	0 - 21.324

**Street Name**

	MARIETTA RD
	1.31 - 8.112

- Non-divided Highway
- Divided Highway
- Secondary Segment
- Corporation**
- Bridge (on route)
- Underpass
- Overpass
- Railroad (at grade)
- Railroad (underpass)
- Railroad (overpass)
- Intersection

Created on: 7/3/2025

transportation.ohio.gov

Prepared by  
The Ohio Department of Transportation  
Office of Technical Services  
Roadway Information

# SNOBSR00821\*\*C

State True Log

24.771

County True Log

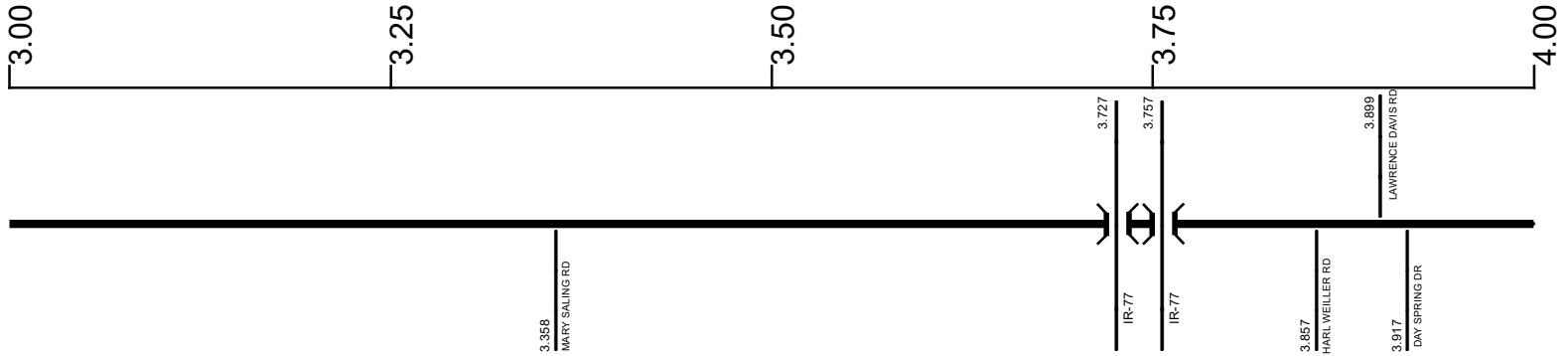

Surface Type & Width (Left / Right)

G 24'  
2.157 - 7.597

Base Type (Left / Right)

P  
2.157 - 7.309

Shoulder Type & Width (Left / Right)

5 (4/4')  
2.157 - 7.597

Through Lanes

2  
0 - 21.324

Street Name

MARIETTA RD  
1.31 - 8.112

- |                     |                   |                      |              |
|---------------------|-------------------|----------------------|--------------|
| Non-divided Highway | Bridge (on route) | Railroad (at grade)  | Intersection |
| Divided Highway     | Underpass         | Railroad (underpass) |              |
| Secondary Segment   | Overpass          | Railroad (overpass)  |              |
| Corporation         |                   |                      |              |

Created on: 7/3/2025



transportation.ohio.gov

Prepared by  
The Ohio Department of Transportation  
Office of Technical Services  
Roadway Information

# SNOBSR00821\*\*C

State True Log

25.771

County True Log

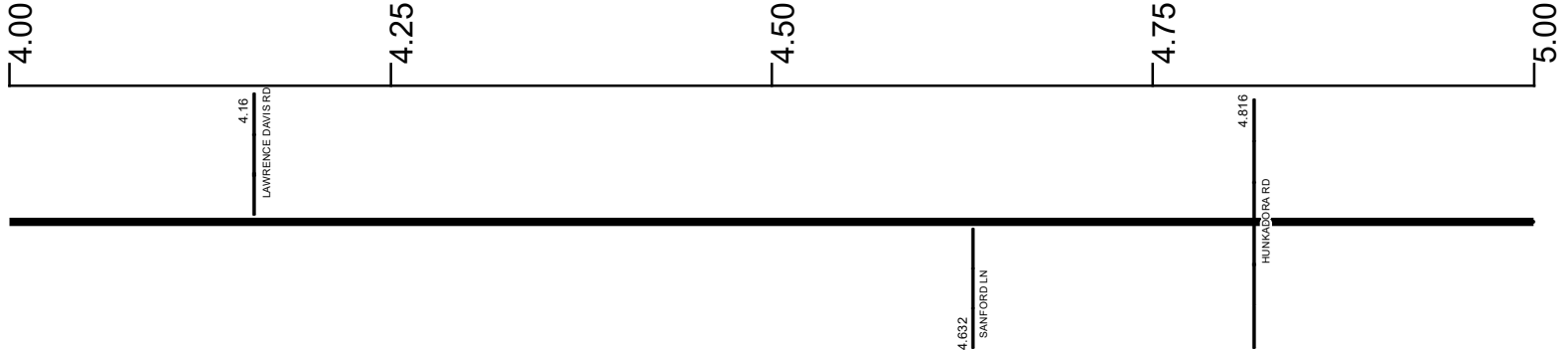

Surface Type & Width (Left / Right)

G 24'  
2.157 - 7.597

Base Type (Left / Right)

P  
2.157 - 7.309

Shoulder Type & Width (Left / Right)

5 (4/4')  
2.157 - 7.597

Through Lanes

2  
0 - 21.324

Street Name

MARIETTA RD  
1.31 - 8.112

- |                     |                   |                      |              |
|---------------------|-------------------|----------------------|--------------|
| Non-divided Highway | Bridge (on route) | Railroad (at grade)  | Intersection |
| Divided Highway     | Underpass         | Railroad (underpass) |              |
| Secondary Segment   | Overpass          | Railroad (overpass)  |              |
| Corporation         |                   |                      |              |

Created on: 7/3/2025

transportation.ohio.gov

Prepared by  
The Ohio Department of Transportation  
Office of Technical Services  
Roadway Information

# SNOBSR00821\*\*C

State True Log

26.771

County True Log



Surface Type & Width (Left / Right)

	G 24'
	2.157 - 7.597

Base Type (Left / Right)

	P
	2.157 - 7.309

Shoulder Type & Width (Left / Right)

	5 (4/4')
	2.157 - 7.597

Through Lanes

	2
	0 - 21.324

Street Name

	MARIETTA RD
	1.31 - 8.112

- |                     |                   |                      |              |
|---------------------|-------------------|----------------------|--------------|
| Non-divided Highway | Bridge (on route) | Railroad (at grade)  | Intersection |
| Divided Highway     | Underpass         | Railroad (underpass) |              |
| Secondary Segment   | Overpass          | Railroad (overpass)  |              |
| Corporation         |                   |                      |              |

Created on: 7/3/2025

transportation.ohio.gov

Prepared by  
The Ohio Department of Transportation  
Office of Technical Services  
Roadway Information

# SNOBSR00821\*\*C

State True Log

27.771

County True Log



Surface Type & Width (Left / Right)	G 24' 2.157 - 7.597
Base Type (Left / Right)	P 2.157 - 7.309
Shoulder Type & Width (Left / Right)	5 (4/4') 2.157 - 7.597
Through Lanes	2 0 - 21.324
Street Name	MARIETTA RD 1.31 - 8.112

Non-divided Highway	Bridge (on route)	Railroad (at grade)	Intersection
Divided Highway	Underpass	Railroad (underpass)	
Secondary Segment	Overpass	Railroad (overpass)	
Corporation			

Created on: 7/3/2025

transportation.ohio.gov

Prepared by  
The Ohio Department of Transportation  
Office of Technical Services  
Roadway Information

# SNOBSR00821\*\*C

State True Log

28.771

County True Log

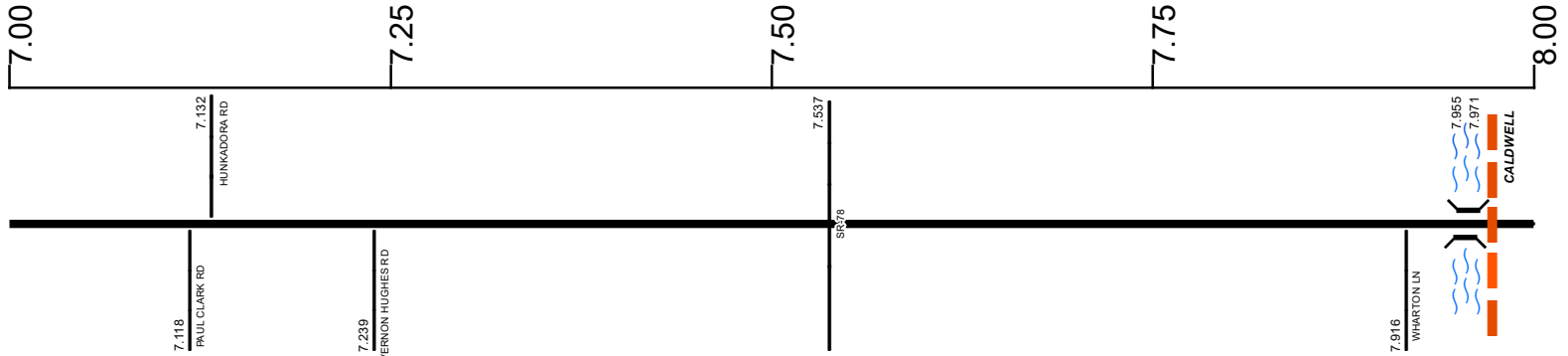

**Surface Type & Width (Left / Right)**

G 24'	G 20'	G 24'
2.157 - 7.597	7.597 - 7.806	7.806 - 8.014

**Base Type (Left / Right)**

P	L	N	L
2.157 - 7.309	7.309 - 7.597	7.597 - 7.806	7.806 - 8.014

**Shoulder Type & Width (Left / Right)**

5 (4'4")	5 (1'1")	5 (4'6")	1 (5'7")	5 (2'2")
2.157 - 7.597	7.597 - 7.806	7.806 - 7.916	7.916 - 7.975	

**Resurface Year**

2024
------

**Through Lanes**

2
0 - 21.324

**Street Name**

MARIETTA RD
1.31 - 8.112

- Non-divided Highway
- Divided Highway
- Secondary Segment
- Corporation
- Bridge (on route)
- Underpass
- Overpass
- Railroad (at grade)
- Railroad (underpass)
- Railroad (overpass)
- Intersection

Created on: 7/3/2025



transportation.ohio.gov  
Prepared by  
The Ohio Department of Transportation  
Office of Technical Services  
Roadway Information

# SNOBSR00821\*\*C

State True Log

29.771

County True Log

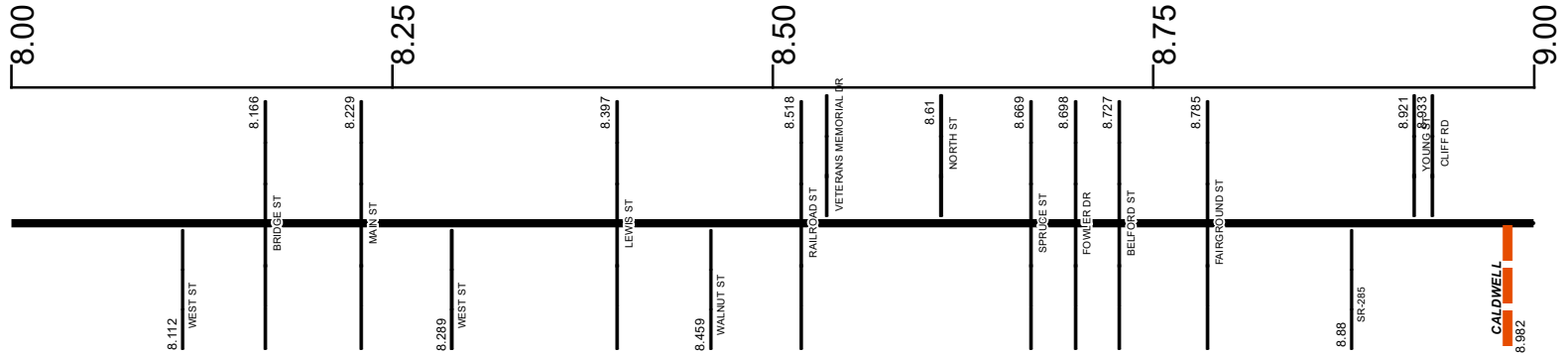

**Surface Type & Width (Left / Right)**

G 24'	G 22'	G 46'	G 32'	G 24'	G (10'/11')	G 20'
8.014 - 8.187	8.187 - 8.279	8.279 - 8.6	8.6 - 8.869	8.869 - 8.985		

**Base Type (Left / Right)**

L	N	R	N
7.806 - 8.014	8.014 - 8.6	8.6 - 8.985	8.985 - 11.872

**Shoulder Type & Width (Left / Right)**

5 (2'2')	2 (1'1')	1 (0'0')	5 (2'1')	5 (2'2')
7.975 - 8.014	8.014 - 8.187	8.187 - 8.869	8.869 - 8.985	8.985 - 9.17

**Resurface Year**

2024	7.309 - 13.314
------	----------------

**Through Lanes**

2	0 - 21.324
---	------------

**Street Name**

MARIETTA RD	WEST ST	NORTH ST	MILLER ST	PLANING MILL ST
1.31 - 8.112	8.112 - 8.289	8.289 - 8.61	8.61 - 8.88	8.88 - 8.982 8.982 - 11.814

- Non-divided Highway
- Divided Highway
- Secondary Segment
- Corporation
- Bridge (on route)
- Underpass
- Overpass
- Railroad (at grade)
- Railroad (underpass)
- Railroad (overpass)
- Intersection

Created on: 7/3/2025

transportation.ohio.gov

Prepared by  
The Ohio Department of Transportation  
Office of Technical Services  
Roadway Information

# SNOBSR00821\*\*C

State True Log

30.771

County True Log

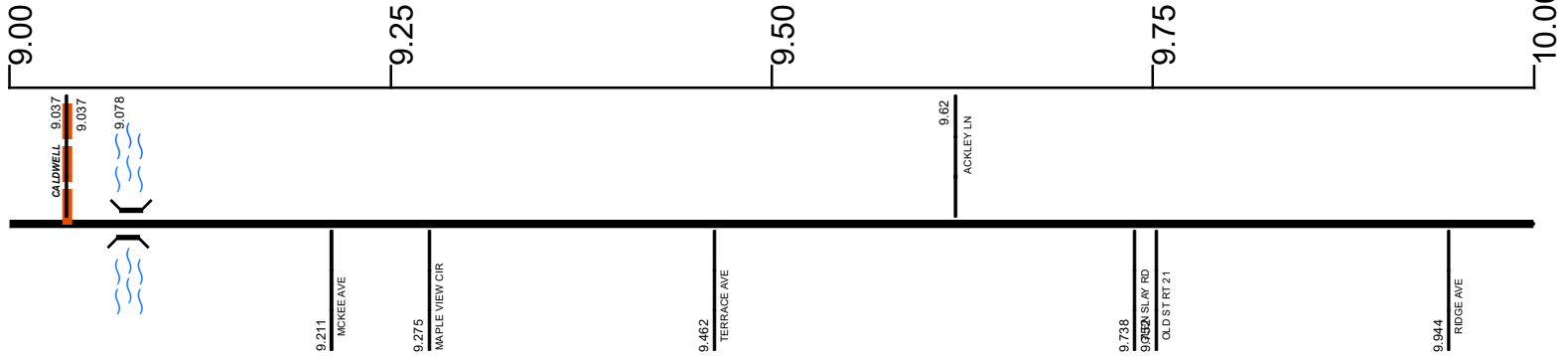

Surface Type & Width (Left / Right)	G 20'
	8.985 - 11.872
Base Type (Left / Right)	N
	8.985 - 11.872
Shoulder Type & Width (Left / Right)	
5 (2'/2')	5 (1'/1')
8.985 - 9.17	9.17 - 11.872
Resurface Year	2024
	7.309 - 13.314
Through Lanes	2
	0 - 21.324
Street Name	MARIETTA RD
	8.982 - 11.814

<ul style="list-style-type: none"> <li> Non-divided Highway</li> <li> Divided Highway</li> <li> Secondary Segment</li> <li> Corporation</li> </ul>	<ul style="list-style-type: none"> <li> Bridge (on route)</li> <li> Underpass</li> <li> Overpass</li> </ul>	<ul style="list-style-type: none"> <li> Railroad (at grade)</li> <li> Railroad (underpass)</li> <li> Railroad (overpass)</li> </ul>	<ul style="list-style-type: none"> <li> Intersection</li> </ul>
--	---	---	---

Created on: 7/3/2025

transportation.ohio.gov

Prepared by  
The Ohio Department of Transportation  
Office of Technical Services  
Roadway Information

# SNOBSR00821\*\*C

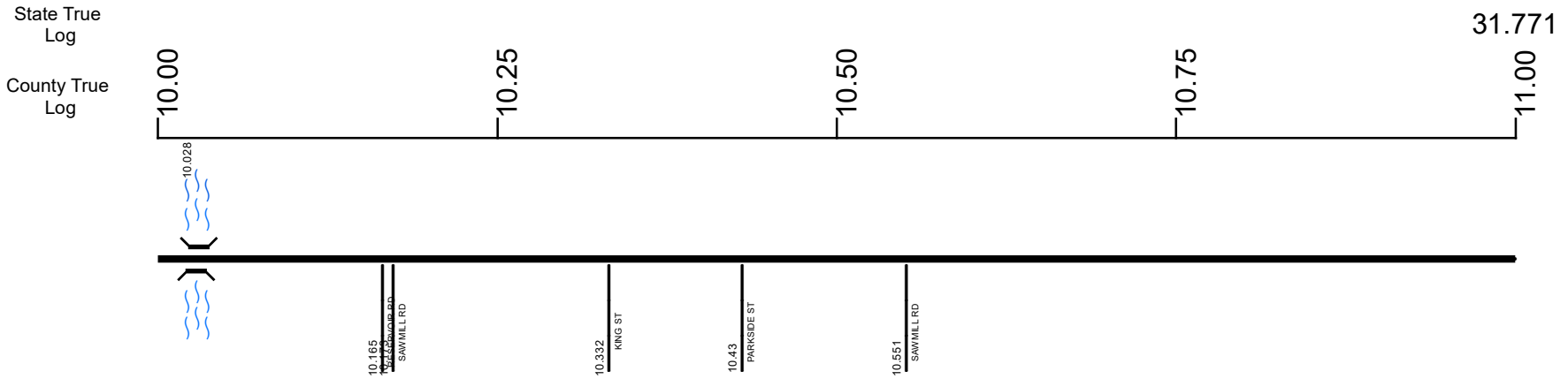

Surface Type & Width (Left / Right)	G 20'
	8.985 - 11.872
Base Type (Left / Right)	N
	8.985 - 11.872
Shoulder Type & Width (Left / Right)	5 (1/1')
	9.17 - 11.872
Resurface Year	2024
	7.309 - 13.314
Through Lanes	2
	0 - 21.324
Street Name	MARIETTA RD
	8.982 - 11.814

- |                     |                   |                      |              |
|---------------------|-------------------|----------------------|--------------|
| Non-divided Highway | Bridge (on route) | Railroad (at grade)  | Intersection |
| Divided Highway     | Underpass         | Railroad (underpass) |              |
| Secondary Segment   | Overpass          | Railroad (overpass)  |              |
| Corporation         |                   |                      |              |

Created on: 7/3/2025

transportation.ohio.gov

Prepared by  
The Ohio Department of Transportation  
Office of Technical Services  
Roadway Information

# SNOBSR00821\*\*C

State True Log  
County True Log

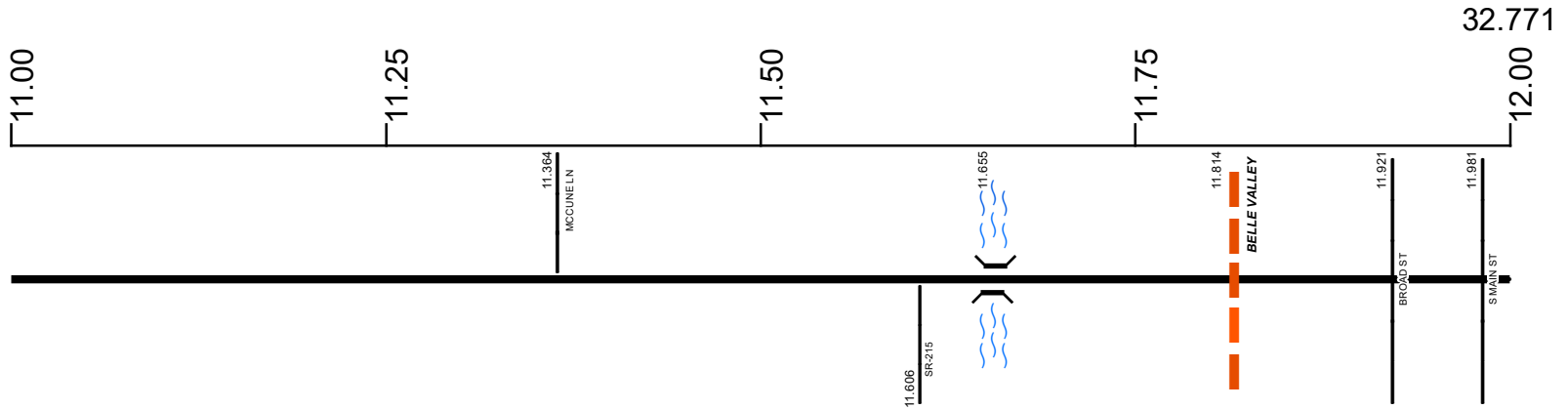

**Surface Type & Width (Left / Right)**

G 20'	G 26'	G 24'
8.985 - 11.872	11.872 - 11.992	

**Base Type (Left / Right)**

N	L
8.985 - 11.872	11.872 - 12.313

**Shoulder Type & Width (Left / Right)**

5 (1'1')	1 (0'0')	2 (0'5')
9.17 - 11.872	11.872 - 11.992	11.992 - 12.127

**Resurface Year**

2024	
7.309 - 13.314	

**Through Lanes**

2	
0 - 21.324	

**Street Name**

MARIETTA RD	LIBERTY ST	MAIN ST
8.982 - 11.814	11.814 - 11.981	11.981 - 12.754

- Non-divided Highway
- Divided Highway
- Secondary Segment
- Corporation
- Bridge (on route)
- Underpass
- Overpass
- Railroad (at grade)
- Railroad (underpass)
- Railroad (overpass)
- Intersection

Created on: 7/3/2025

transportation.ohio.gov

Prepared by  
The Ohio Department of Transportation  
Office of Technical Services  
Roadway Information

# SNOBSR00821\*\*C

State True Log

33.771

County True Log

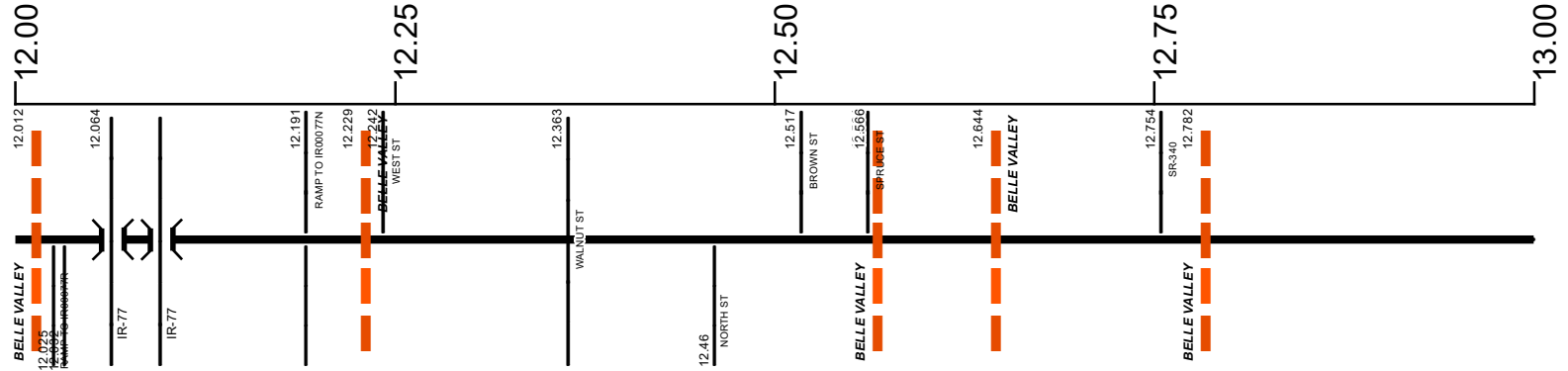

**Surface Type & Width (Left / Right)**

G 24'	G 22'	G 24'	G (12'/13')	G 24'	G (20'/4')	G 20'
11.992 - 12.127	12.127 - 12.201	12.242 - 12.313	12.313 - 12.571	12.571 - 12.783	12.783 - 13.088	

**Base Type (Left / Right)**

L	R	N / L	N
11.872 - 12.313	12.313 - 12.571	12.571 - 12.783	12.783 - 13.088

**Shoulder Type & Width (Left / Right)**

2 (0'/5')	2 (5'/5')	2 (5'/0')	1 (0'/0')	1 (4'/4')	2 (0'/0')
11.992 - 12.127	12.127 - 12.201	12.201 - 12.242	12.242 - 12.571	12.571 - 12.783	12.783 - 13.088

**Resurface Year**

2024
7.309 - 13.314

**Through Lanes**

2
0 - 21.324

**Street Name**

MAIN ST	MARIETTA RD
11.981 - 12.754	12.754 - 21.324

- Non-divided Highway
- Divided Highway
- Secondary Segment
- Corporation
- Bridge (on route)
- Underpass
- Overpass
- Railroad (at grade)
- Railroad (underpass)
- Railroad (overpass)
- Intersection

Created on: 7/3/2025

transportation.ohio.gov

Prepared by  
The Ohio Department of Transportation  
Office of Technical Services  
Roadway Information

INTERCHANGE  
IR 77 & SR 821  
NOBLE COUNTY  
INTERCHANGE ID NUMBER = 073400

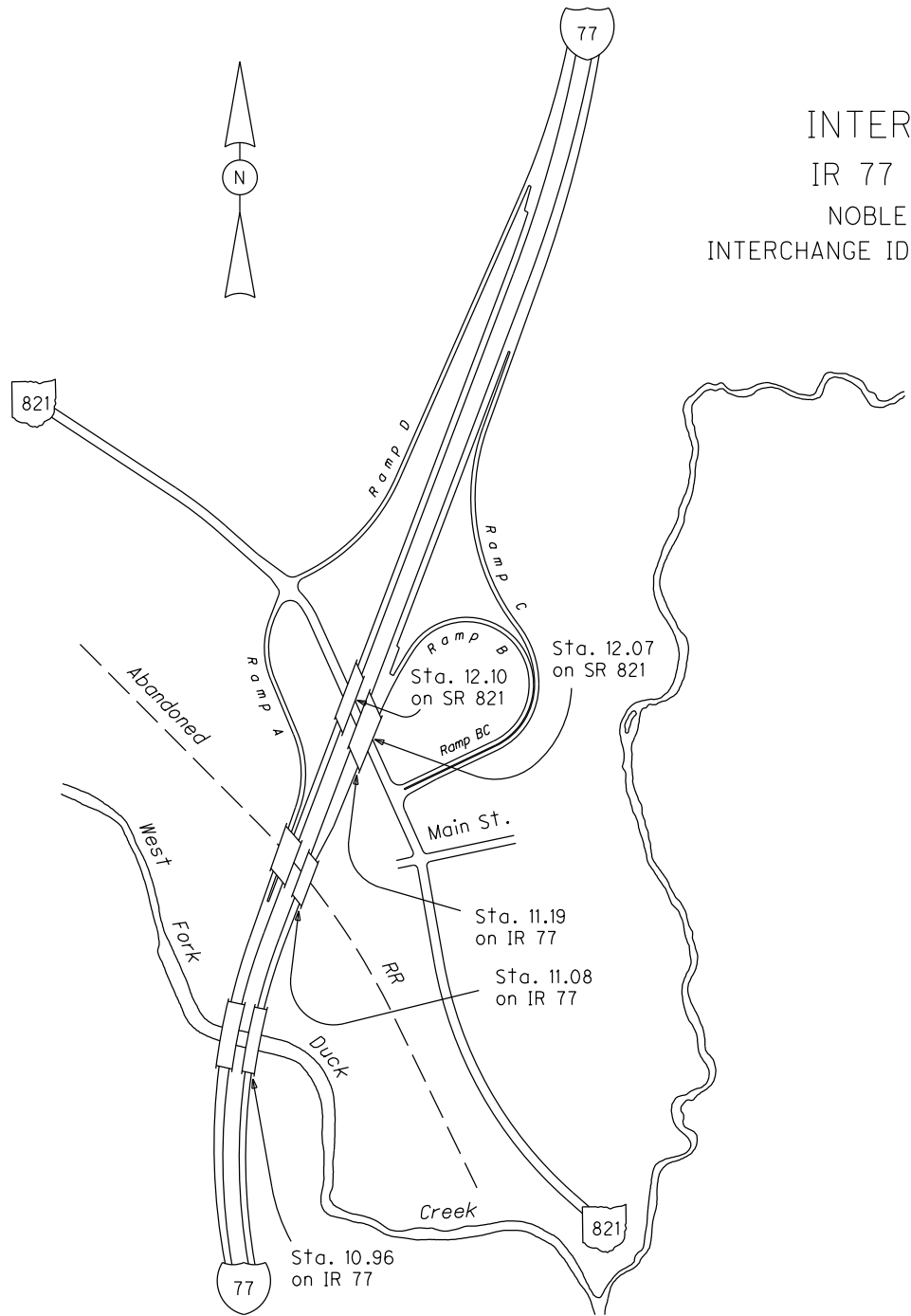

# SNOBSR00821\*\*C

State True Log

34.771

County True Log

13.00

13.25

13.50

13.75

14.00



**Surface Type & Width (Left / Right)**

G 20'	G (11'/12')	G 20'
12.783 - 13.088	13.088 - 13.314	13.314 - 16.533

**Base Type (Left / Right)**

N	K	T
12.783 - 13.088	13.088 - 13.314	13.314 - 16.533

**Shoulder Type & Width (Left / Right)**

2 (0'/0')	5 (1'/1')	
12.783 - 13.088	13.088 - 19.597	

**Resurface Year**

2024	2022	
7.309 - 13.314	13.314 - 21.324	

**Through Lanes**

	2	
	0 - 21.324	

**Street Name**

	MARIETTA RD	
	12.754 - 21.324	

- Non-divided Highway
- Divided Highway
- Secondary Segment
- Corporation
- Bridge (on route)
- Underpass
- Overpass
- Railroad (at grade)
- Railroad (underpass)
- Railroad (overpass)
- Intersection

Created on: 7/3/2025

transportation.ohio.gov

Prepared by  
The Ohio Department of Transportation  
Office of Technical Services  
Roadway Information

# SNOBSR00821\*\*C

State True Log

35.771

County True Log

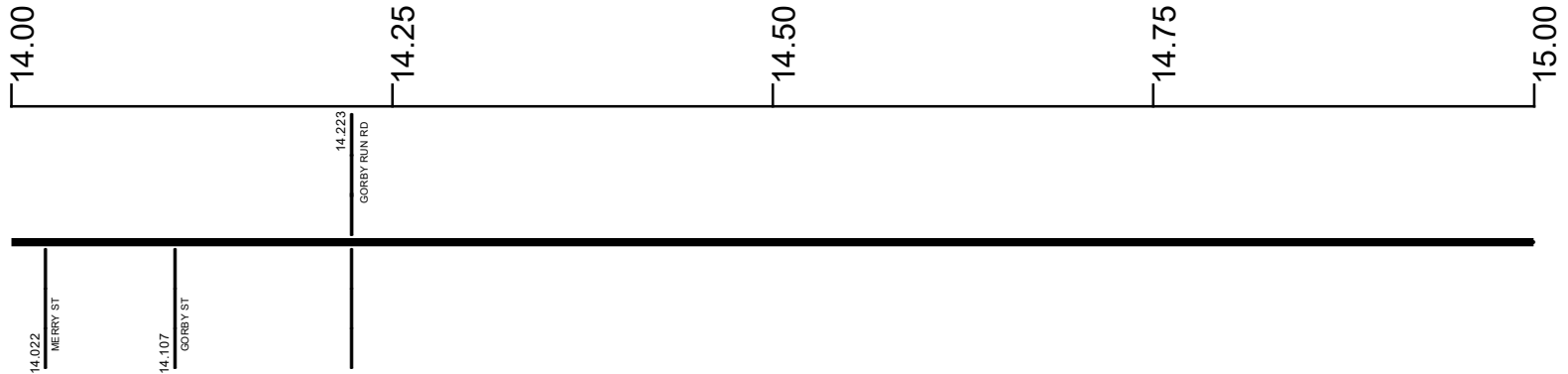

Surface Type & Width (Left / Right)

G 20'  
13.314 - 16.533

Base Type (Left / Right)

T  
13.314 - 16.533

Shoulder Type & Width (Left / Right)

5 (1/1')  
13.088 - 19.597

Resurface Year

2022

Through Lanes

2  
0 - 21.324

Street Name

MARIETTA RD  
12.754 - 21.324

- |                     |                   |                      |              |
|---------------------|-------------------|----------------------|--------------|
| Non-divided Highway | Bridge (on route) | Railroad (at grade)  | Intersection |
| Divided Highway     | Underpass         | Railroad (underpass) |              |
| Secondary Segment   | Overpass          | Railroad (overpass)  |              |
| Corporation         |                   |                      |              |

Created on: 7/3/2025

transportation.ohio.gov

Prepared by  
The Ohio Department of Transportation  
Office of Technical Services  
Roadway Information

# SNOBSR00821\*\*C

State True Log

36.771

County True Log

15.00

15.25

15.50

15.75

16.00

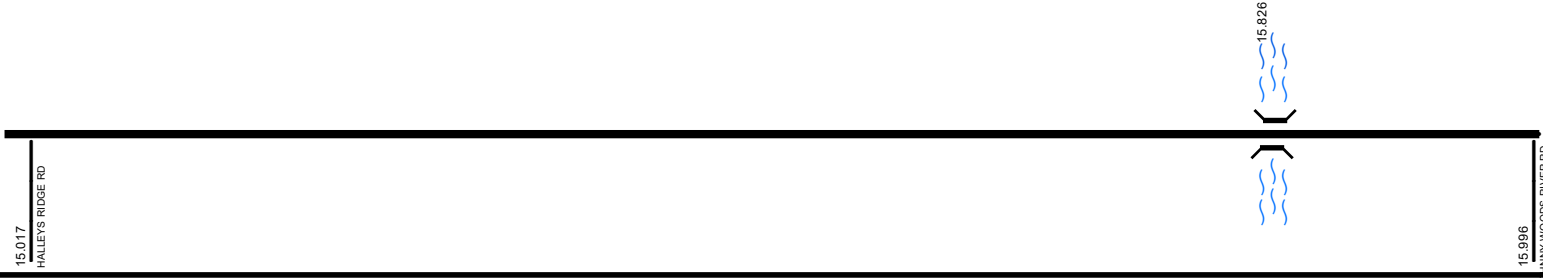

Surface Type & Width (Left / Right)

G 20'  
13.314 - 16.533

Base Type (Left / Right)

T  
13.314 - 16.533

Shoulder Type & Width (Left / Right)

5 (1/1')  
13.088 - 19.597

Resurface Year

2022

Through Lanes

2  
0 - 21.324

Street Name

MARIETTA RD  
12.754 - 21.324

- |                     |                   |                      |              |
|---------------------|-------------------|----------------------|--------------|
| Non-divided Highway | Bridge (on route) | Railroad (at grade)  | Intersection |
| Divided Highway     | Underpass         | Railroad (underpass) |              |
| Secondary Segment   | Overpass          | Railroad (overpass)  |              |
| Corporation         |                   |                      |              |

Created on: 7/3/2025

transportation.ohio.gov

Prepared by  
The Ohio Department of Transportation  
Office of Technical Services  
Roadway Information

# SNOBSR00821\*\*C

State True Log

37.771

County True Log

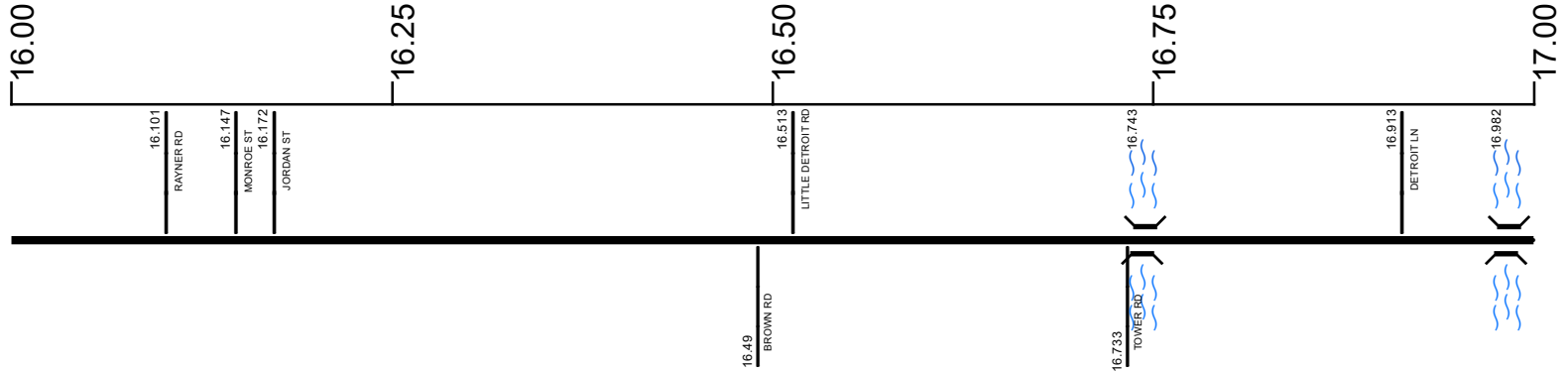

**Surface Type & Width (Left / Right)**

G 20' 13.314 - 16.533	G (10'/11') 16.533 - 21.324
--------------------------	--------------------------------

**Base Type (Left / Right)**

T 13.314 - 16.533	R 16.533 - 21.324
----------------------	----------------------

**Shoulder Type & Width (Left / Right)**

5 (1'/1') 13.088 - 19.597	
------------------------------	--

**Resurface Year**

2022 13.314 - 21.324	
-------------------------	--

**Through Lanes**

2 0 - 21.324	
-----------------	--

**Street Name**

MARIETTA RD 12.754 - 21.324	
--------------------------------	--

- Non-divided Highway
- Divided Highway
- Secondary Segment
- Corporation
- Bridge (on route)
- Underpass
- Overpass
- Railroad (at grade)
- Railroad (underpass)
- Railroad (overpass)
- Intersection

Created on: 7/3/2025

transportation.ohio.gov

Prepared by  
The Ohio Department of Transportation  
Office of Technical Services  
Roadway Information

# SNOBSR00821\*\*C

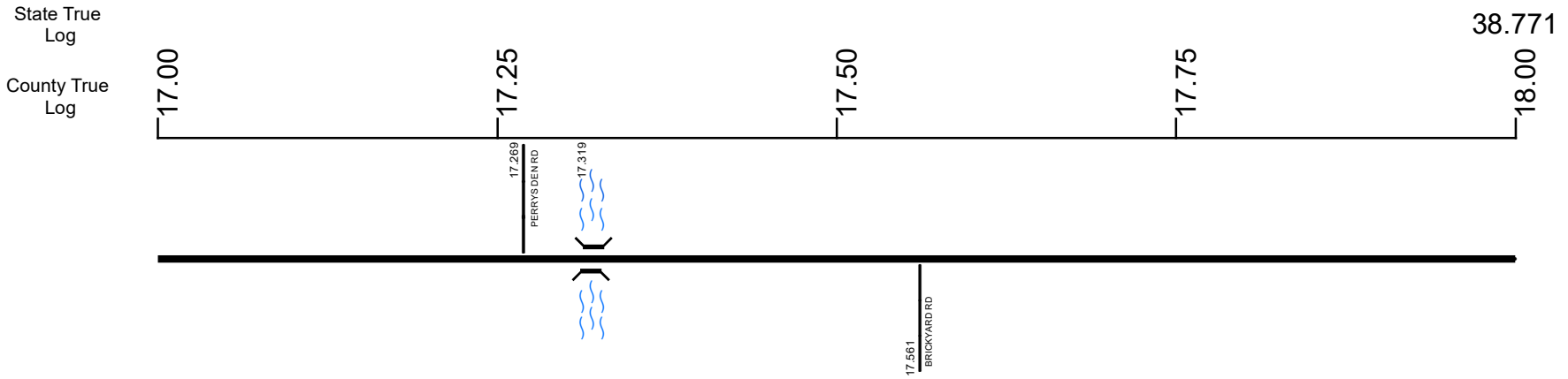

Surface Type & Width (Left / Right)	G (10'/11')
	16.533 - 21.324
Base Type (Left / Right)	R
	16.533 - 21.324
Shoulder Type & Width (Left / Right)	5 (1'/1')
	13.088 - 19.597
Resurface Year	2022
	13.314 - 21.324
Through Lanes	2
	0 - 21.324
Street Name	MARIETTA RD
	12.754 - 21.324

- Non-divided Highway
- Divided Highway
- Secondary Segment
- Corporation
- Bridge (on route)
- Underpass
- Overpass
- Railroad (at grade)
- Railroad (underpass)
- Railroad (overpass)
- Intersection

Created on: 7/3/2025

transportation.ohio.gov

Prepared by  
The Ohio Department of Transportation  
Office of Technical Services  
Roadway Information

# SNOBSR00821\*\*C

State True Log

39.771

County True Log

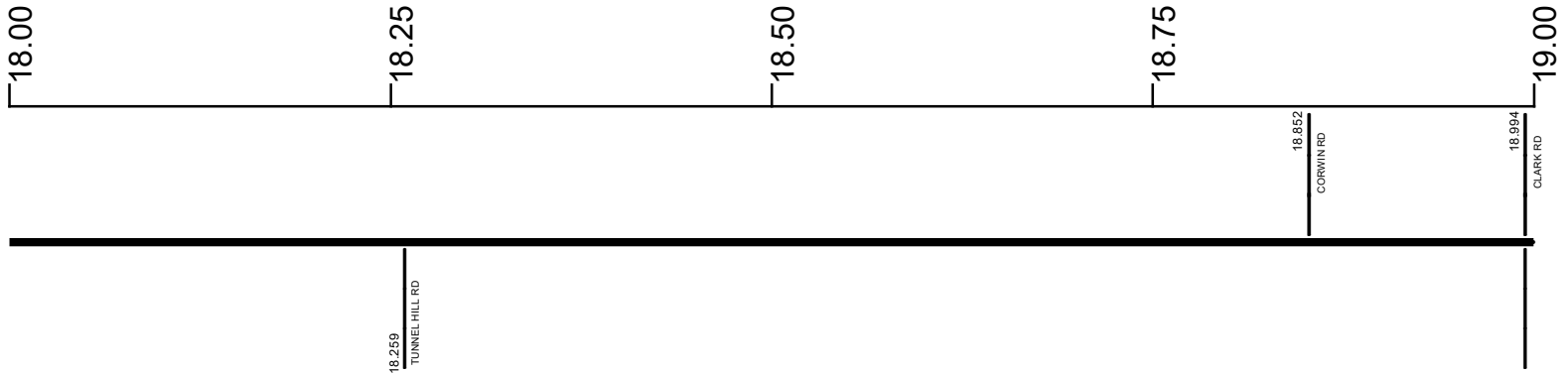

Surface Type & Width (Left / Right)

G (10/11')  
16.533 - 21.324

Base Type (Left / Right)

R  
16.533 - 21.324

Shoulder Type & Width (Left / Right)

5 (1/1')  
13.088 - 19.597

Resurface Year

2022

Through Lanes

2  
0 - 21.324

Street Name

MARIETTA RD  
12.754 - 21.324

- |                     |                   |                      |              |
|---------------------|-------------------|----------------------|--------------|
| Non-divided Highway | Bridge (on route) | Railroad (at grade)  | Intersection |
| Divided Highway     | Underpass         | Railroad (underpass) |              |
| Secondary Segment   | Overpass          | Railroad (overpass)  |              |
| Corporation         |                   |                      |              |

Created on: 7/3/2025



transportation.ohio.gov

Prepared by  
The Ohio Department of Transportation  
Office of Technical Services  
Roadway Information

# SNOBSR00821\*\*C

State True Log

40.771

County True Log

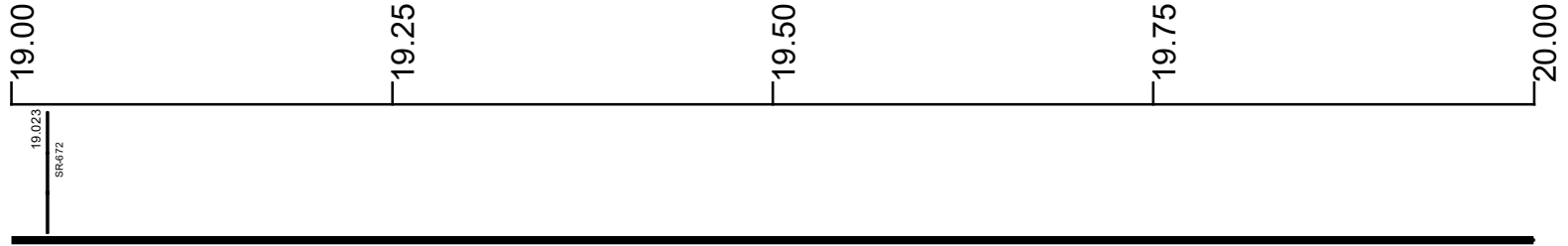

**Surface Type & Width (Left / Right)**

G (10'/11')  
16.533 - 21.324

**Base Type (Left / Right)**

R  
16.533 - 21.324

**Shoulder Type & Width (Left / Right)**

5 (1'/1') 13.088 - 19.597	2 (4'/8') 19.597 - 19.657	5 (1'/1') 19.657 - 21.324
------------------------------	------------------------------	------------------------------

**Resurface Year**

2022

**Through Lanes**

2  
0 - 21.324

**Street Name**

MARIETTA RD  
12.754 - 21.324

- |                     |                   |                      |              |
|---------------------|-------------------|----------------------|--------------|
| Non-divided Highway | Bridge (on route) | Railroad (at grade)  | Intersection |
| Divided Highway     | Underpass         | Railroad (underpass) |              |
| Secondary Segment   | Overpass          | Railroad (overpass)  |              |
| Corporation         |                   |                      |              |

Created on: 7/3/2025

transportation.ohio.gov

Prepared by  
The Ohio Department of Transportation  
Office of Technical Services  
Roadway Information

# SNOBSR00821\*\*C

State True Log

41.771

County True Log

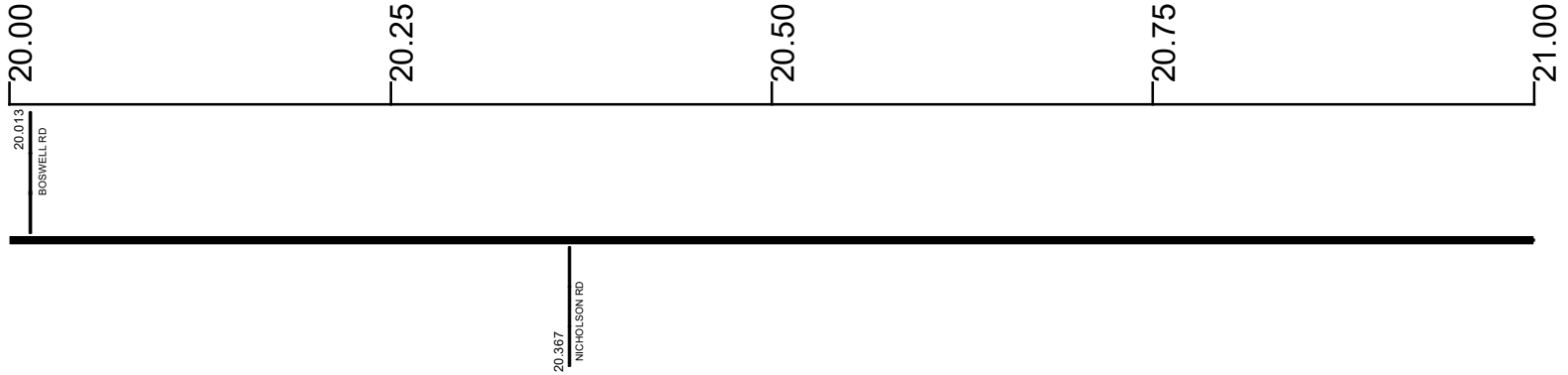

Surface Type & Width (Left / Right)

G (10'/11')  
16.533 - 21.324

Base Type (Left / Right)

R  
16.533 - 21.324

Shoulder Type & Width (Left / Right)

5 (1'/1')  
19.657 - 21.324

Resurface Year

2022

Through Lanes

13.314 - 21.324

2

Street Name

0 - 21.324  
MARIETTA RD  
12.754 - 21.324

- |                     |                   |                      |              |
|---------------------|-------------------|----------------------|--------------|
| Non-divided Highway | Bridge (on route) | Railroad (at grade)  | Intersection |
| Divided Highway     | Underpass         | Railroad (underpass) |              |
| Secondary Segment   | Overpass          | Railroad (overpass)  |              |
| Corporation         |                   |                      |              |

Created on: 7/3/2025



transportation.ohio.gov  
 Prepared by  
 The Ohio Department of Transportation  
 Office of Technical Services  
 Roadway Information

# SNOBSR00821\*\*C

State True  
Log

42.095

County True  
Log

21.00

21.25

21.50

21.75

22.00



**Surface Type & Width (Left / Right)**

G (10'/11')

16.533 - 21.324

**Base Type (Left / Right)**

R

16.533 - 21.324

**Shoulder Type & Width (Left / Right)**

5 (1'/1')

19.657 - 21.324

**Resurface Year**

2022

13.314 - 21.324

**Through Lanes**

2

0 - 21.324

**Street Name**

MARIETTA RD

12.754 - 21.324

- |  |  |  |                      |
|--|--|--|----------------------|
| <p> Non-divided Highway</p> <p> Divided Highway</p> <p> Secondary Segment</p> <p> <b>Corporation</b></p> | <p> Bridge (on route)</p> <p> Underpass</p> <p> Overpass</p> | <p> Railroad (at grade)</p> <p> Railroad (underpass)</p> <p> Railroad (overpass)</p> | <p> Intersection</p> |
|--|--|--|----------------------|

Created on: 7/3/2025

transportation.ohio.gov

Prepared by  
The Ohio Department of Transportation  
Office of Technical Services  
Roadway Information

## Historical Project List for SNOBSR00821\*\*C

Begin Measure	End Measure	Project ID Number	Construction Completion Date	Treatment Category	Treatment Type
0.000	7.467	102370	7-2018	Minor Rehabilitation	60-AC Overlay w/Rpr
0.000	7.448	24825	11-2006	Minor Rehabilitation	50-AC Overlay w/o Rpr
7.418	7.657	82689	12-2011	Major Rehabilitation	100-New Flexible Pvmt
7.597	11.872	76151	10-2012	Minor Rehabilitation	50-AC Overlay w/o Rpr
11.872	12.313	83523	11-2010	Minor Rehabilitation	60-AC Overlay w/Rpr
12.313	12.754	76151	10-2012	Minor Rehabilitation	50-AC Overlay w/o Rpr
12.754	21.324	82842	8-2012	Minor Rehabilitation	50-AC Overlay w/o Rpr
13.216	21.324	113943	9-2022	Preventive Maintenance	25-Chip Seal

# Roadway Codes

## Access Control Journalized

- F - Full Access Control
- L - Limited Access Control
- N - No Access Control

## Access Control Operational

- 1 - Full Access Control
- 2 - Partial Access Control
- 3 - No Access Control

## Base Type

- F - Crack and Seat
- H - Rubblize and Roll
- I - Aggregate Base 304 or Traffic Compacted
- K - Water Bound Macadam
- L - Bituminous Concrete Mix or Penetration Macadam
- N - Plain Concrete
- P - Reinforced Concrete
- R - Brick (Flexible)
- T - Brick (Rigid)

## Direction of Travel

- B - Both (Two-way)
- F - One-way Cardinal
- T - One-way Non-cardinal

## Facility Type

- 1 - One-way Roadway
- 2 - Two-way Roadway
- 4 - Ramp
- 5 - Non-mainline
- 6 - Non-inventory Direction
- 7 - Planned / Unbuilt

## Historical Federal Aid Indicator

- N - Not a FAP Route
- Y - FAP Route

## Functional Classification

- 01 - Interstate
- 02 - Principal Arterial (Freeways)
- 03 - Principal Arterial (Other)
- 04 - Minor Arterial
- 05 - Major Collector
- 06 - Minor Collector
- 07 - Local

## Leave / Reenter Indicator

- Y - Route leaves/reenters at this point
- N - Route does not leave/reenter at this point

## Median Type

- 1 - None
- 2 - Unprotected
- 3 - Curbed
- 4 - Positive Barrier (Unspecified)
- 5 - Positive Barrier (Flexible)
- 6 - Positive Barrier (Semi-rigid)
- 7 - Positive Barrier (Rigid)

## NHS

- N - National Highway System
- H - Congressional Corridor
- 2 - Major Airport
- 3 - Major Port Facility
- 4 - Major Amtrak Station
- 5 - Major Rail / Truck Terminal
- 6 - Major Intercity Bus Terminal
- 7 - Major Public Transit / Multi-modal Passenger Terminal
- 8 - Major Pipeline Terminal
- 9 - Major Ferry Terminal

## Priority System

- G - General
- P - Priority System
- U - Urban

## Scenic Byway Code

- A - All American Road
- N - National Scenic Byway
- S - State Scenic Byway

## Shoulder Type

- 1 - None
- 2 - Surfaced shoulder exists (bituminous concrete {AC})
- 3 - Surfaced shoulder exists (Portland Cement Concrete {PCC})
- 4 - Stabilized shoulder exists (gravel or other granular material)
- 5 - Combination shoulder exists (two or more surface types)
- 6 - Earth shoulder exists
- 7 - Barrier curb exists; no shoulder in front of curb

## Surface Type

- A - Combination
- B - Brick
- C - Continuous Reinforced Concrete
- D - Reinforced Concrete
- E - Plain Concrete
- G - Bituminous Concrete
- I - Chipseal on Granular
- K - Open Graded Bituminous
- L - Chipseal or Micro
- M - Gravel
- U - Unimproved
- X - Right of Way Only