

# SOTTSR00051\*\*C

State True Log 2.287

3.287

County True Log

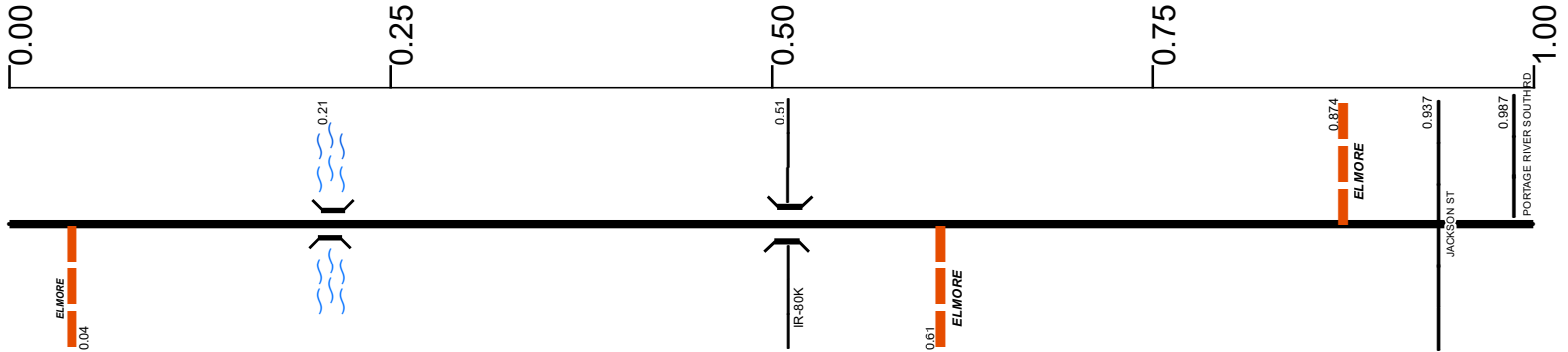

**Surface Type & Width (Left / Right)**

G 30'	G 24'	G 30'	G (6'/24')
0 - 0.51	0.51 - 0.66	0.66 - 0.97	0.97 - 1.259

**Base Type (Left / Right)**

N	N / R
0 - 0.97	0.97 - 1.259

**Shoulder Type & Width (Left / Right)**

2 (6'/6')	2 (8'/8')	2 (10'/10')	1 (0'/0')
0 - 0.51	0.51 - 0.66	0.66 - 0.97	0.97 - 1.42

**Through Lanes**

2	
0 - 5.874	

**Street Name**

SR 51	RICE ST
0 - 0.97	0.97 - 1.42

- Non-divided Highway
- Divided Highway
- Secondary Segment
- Corporation
- Bridge (on route)
- Underpass
- Overpass
- Railroad (at grade)
- Railroad (underpass)
- Railroad (overpass)
- Intersection

Created on: 7/3/2025

transportation.ohio.gov

Prepared by  
The Ohio Department of Transportation  
Office of Technical Services  
Roadway Information

# SOTTSR00051\*\*C

State True Log

4.287

County True Log

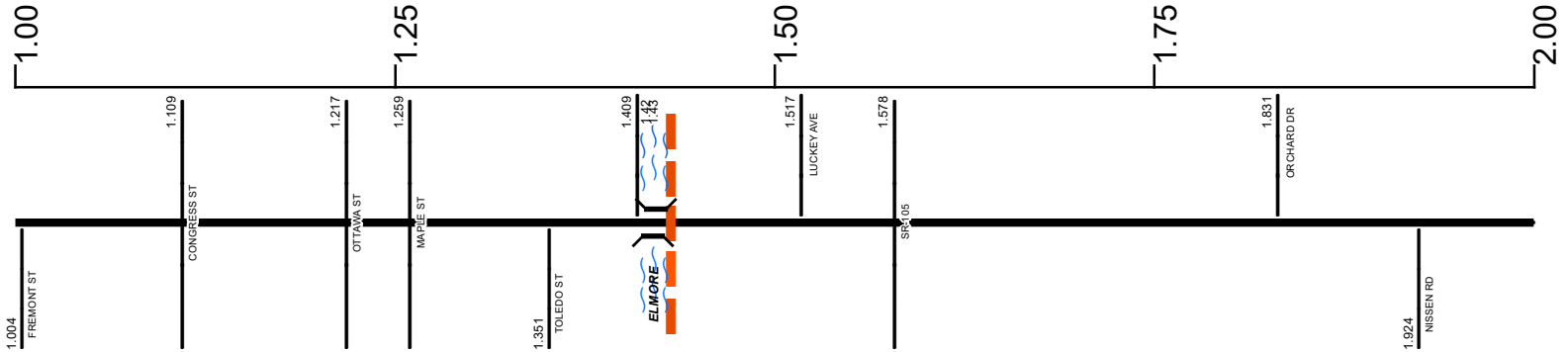

**Surface Type & Width (Left / Right)**

G (6'/24')	G (20'/30')	G (20'/8')	G 30'
0.97 - 1.259	1.259 - 1.351	1.351 - 1.42	1.42 - 4.905

**Base Type (Left / Right)**

N / R	T / N	N
0.97 - 1.259	1.259 - 1.42	1.42 - 5.874

**Shoulder Type & Width (Left / Right)**

1 (0'/0')	2 (8'/8')
0.97 - 1.42	1.42 - 4.905

**Resurface Year**

2020

**Resurface Year**

2020

1.421 - 1.479

1.578 - 4.905

**Through Lanes**

2	
0 - 5.874	

**Street Name**

RICE ST	TOLEDO ST	SR 51
0.97 - 1.42	1.42 - 1.43	1.43 - 10.385

- Non-divided Highway
- Divided Highway
- Secondary Segment
- Corporation
- Bridge (on route)
- Underpass
- Overpass
- Railroad (at grade)
- Railroad (underpass)
- Railroad (overpass)
- Intersection

Created on: 7/3/2025

transportation.ohio.gov

Prepared by  
The Ohio Department of Transportation  
Office of Technical Services  
Roadway Information

# SOTTSR00051\*\*C

State True Log

5.287

County True Log

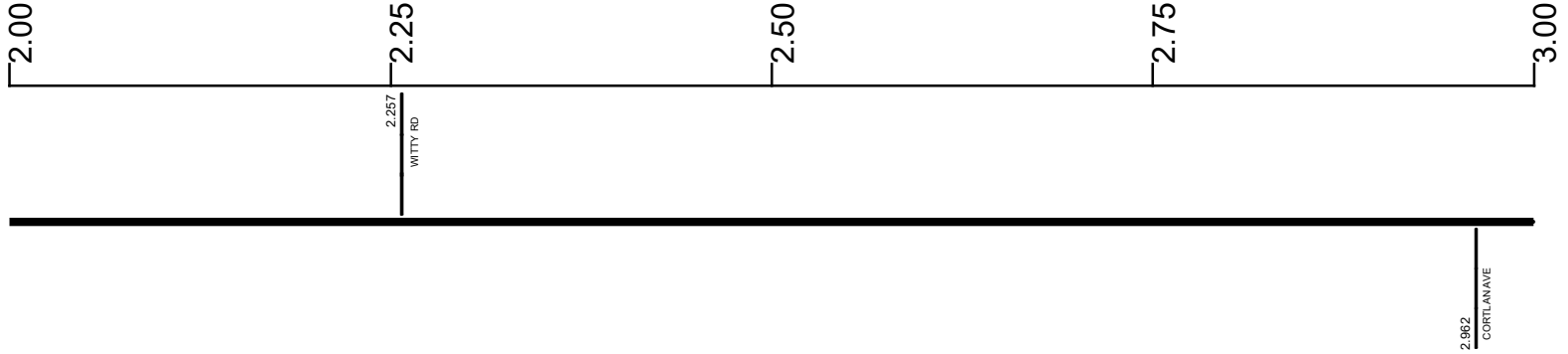

Surface Type & Width (Left / Right)

G 30'  
1.42 - 4.905

Base Type (Left / Right)

N  
1.42 - 5.874

Shoulder Type & Width (Left / Right)

2 (8/8)  
1.42 - 4.905

Resurface Year

2020  
1.578 - 4.905

Through Lanes

2  
0 - 5.874

Street Name

SR 51  
1.43 - 10.385

- |                     |                   |                      |              |
|---------------------|-------------------|----------------------|--------------|
| Non-divided Highway | Bridge (on route) | Railroad (at grade)  | Intersection |
| Divided Highway     | Underpass         | Railroad (underpass) |              |
| Secondary Segment   | Overpass          | Railroad (overpass)  |              |
| Corporation         |                   |                      |              |

Created on: 7/3/2025



transportation.ohio.gov

Prepared by  
The Ohio Department of Transportation  
Office of Technical Services  
Roadway Information

# SOTTSR00051\*\*C

State True Log

6.287

County True Log

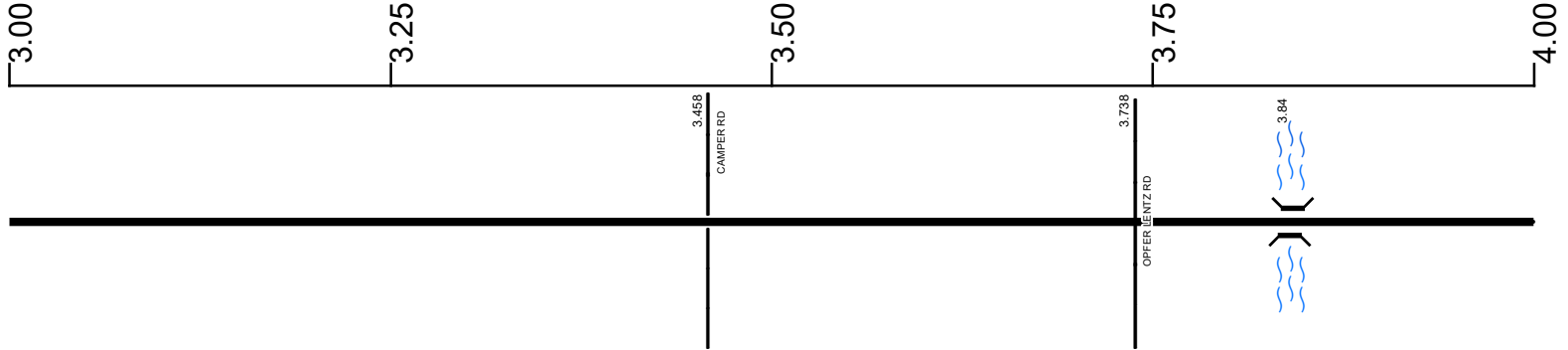

Surface Type & Width (Left / Right)	G 30'
	1.42 - 4.905
Base Type (Left / Right)	N
	1.42 - 5.874
Shoulder Type & Width (Left / Right)	2 (8/8')
	1.42 - 4.905
Resurface Year	2020
Through Lanes	2
	0 - 5.874
Street Name	SR 51
	1.43 - 10.385

- |                     |                   |                      |              |
|---------------------|-------------------|----------------------|--------------|
| Non-divided Highway | Bridge (on route) | Railroad (at grade)  | Intersection |
| Divided Highway     | Underpass         | Railroad (underpass) |              |
| Secondary Segment   | Overpass          | Railroad (overpass)  |              |
| Corporation         |                   |                      |              |

Created on: 7/3/2025

transportation.ohio.gov

Prepared by  
The Ohio Department of Transportation  
Office of Technical Services  
Roadway Information

# SOTTSR00051\*\*C

State True Log

7.287

County True Log

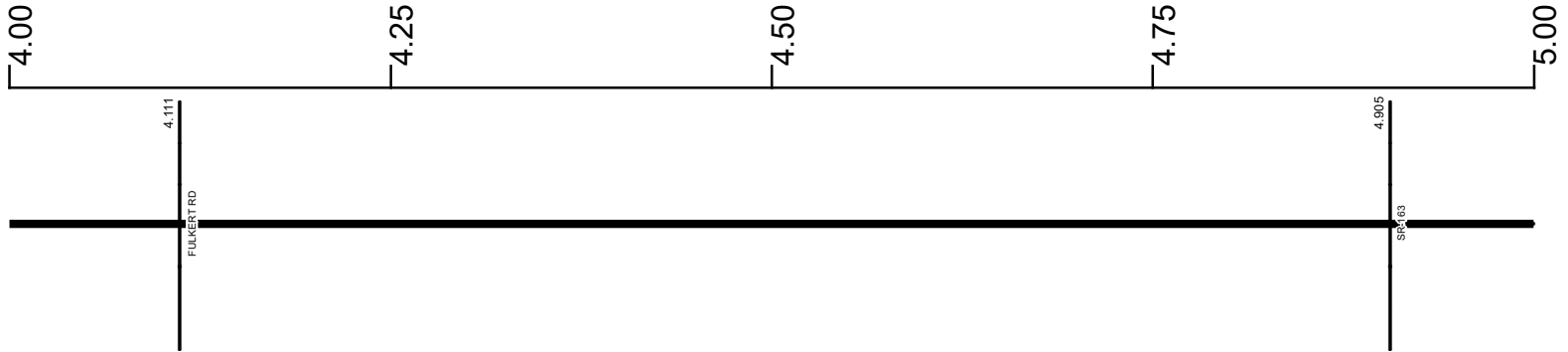

**Surface Type & Width (Left / Right)**

G 30'	G 24'
1.42 - 4.905	4.905 - 5.874

**Base Type (Left / Right)**

N	
1.42 - 5.874	

**Shoulder Type & Width (Left / Right)**

2 (8'/8')	2 (15'/15')
1.42 - 4.905	4.905 - 5.874

**Resurface Year**

2020	
1.578 - 4.905	

**Through Lanes**

2	
0 - 5.874	

**Street Name**

SR 51	
1.43 - 10.385	

- Non-divided Highway
  Bridge (on route)
  Railroad (at grade)
  Intersection
- Divided Highway
  Underpass
  Railroad (underpass)
- Secondary Segment
  Overpass
  Railroad (overpass)
- Corporation**

Created on: 7/3/2025

transportation.ohio.gov

Prepared by  
The Ohio Department of Transportation  
Office of Technical Services  
Roadway Information

# SOTTSR00051\*\*C

State True Log

8.287

County True Log

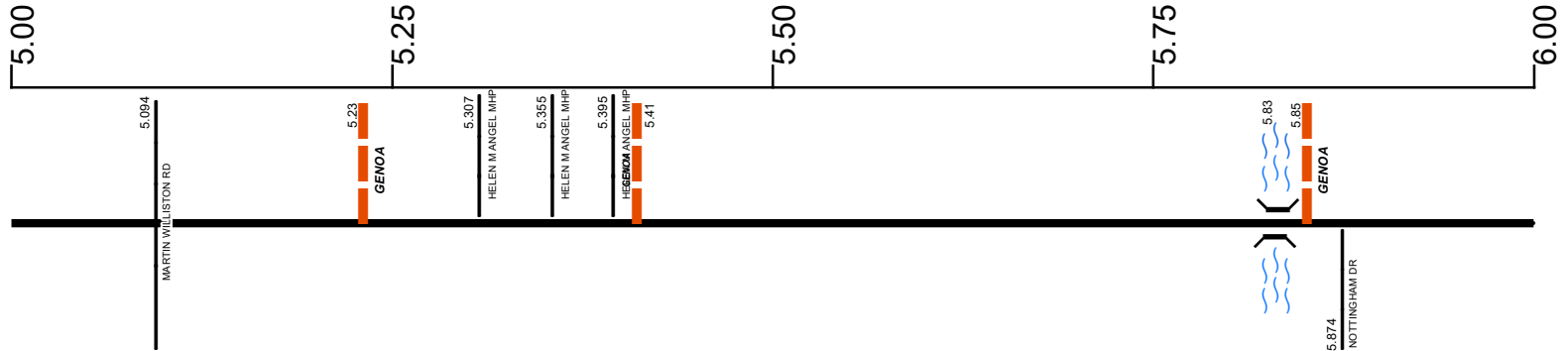

**Surface Type & Width (Left / Right)**

G 24'	G (30'/6')
4.905 - 5.874	5.874 - 7.11

**Base Type (Left / Right)**

N	N / L
1.42 - 5.874	5.874 - 7.11

**Shoulder Type & Width (Left / Right)**

2 (15'/15')	2 (10'/10')
4.905 - 5.874	5.874 - 6.459

**Through Lanes**

2	3
0 - 5.874	5.874 - 6.69

**Street Name**

SR 51	
1.43 - 10.385	

- Non-divided Highway
- Divided Highway
- Secondary Segment
- Corporation
- Bridge (on route)
- Underpass
- Overpass
- Railroad (at grade)
- Railroad (underpass)
- Railroad (overpass)
- Intersection

Created on: 7/3/2025

transportation.ohio.gov

Prepared by  
The Ohio Department of Transportation  
Office of Technical Services  
Roadway Information

# SOTTSR00051\*\*C

State True Log

9.287

County True Log



**Surface Type & Width (Left / Right)**

	G (30'/6')
	5.874 - 7.11

**Base Type (Left / Right)**

	N / L
	5.874 - 7.11

**Shoulder Type & Width (Left / Right)**

2 (10'/10')	2 (8'/8')	2 (10'/10')
5.874 - 6.459	6.459 - 6.509	6.509 - 10.385

**Through Lanes**

3	2
5.874 - 6.69	6.69 - 10.385

**Street Name**

	SR 51
	1.43 - 10.385

- Non-divided Highway
- Divided Highway
- Secondary Segment
- Corporation
- Bridge (on route)
- Underpass
- Overpass
- Railroad (at grade)
- Railroad (underpass)
- Railroad (overpass)
- Intersection

Created on: 7/3/2025

transportation.ohio.gov

Prepared by  
The Ohio Department of Transportation  
Office of Technical Services  
Roadway Information

# SOTTSR00051\*\*C

State True Log

10.287

County True Log

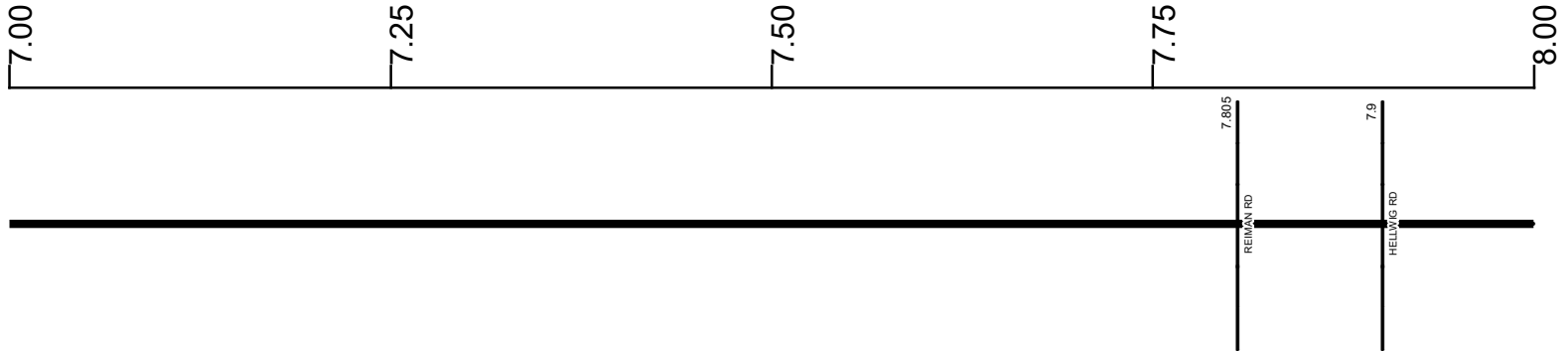

**Surface Type & Width (Left / Right)**

G (30'/6')	G 24'
5.874 - 7.11	7.11 - 10.385

**Base Type (Left / Right)**

N / L	N
5.874 - 7.11	7.11 - 10.385

**Shoulder Type & Width (Left / Right)**

	2 (10'/10')
	6.509 - 10.385

**Through Lanes**

	2
	6.69 - 10.385

**Street Name**

	SR 51
	1.43 - 10.385

- |                     |                   |                      |              |
|---------------------|-------------------|----------------------|--------------|
| Non-divided Highway | Bridge (on route) | Railroad (at grade)  | Intersection |
| Divided Highway     | Underpass         | Railroad (underpass) |              |
| Secondary Segment   | Overpass          | Railroad (overpass)  |              |
| Corporation         |                   |                      |              |

Created on: 7/3/2025

transportation.ohio.gov

Prepared by  
The Ohio Department of Transportation  
Office of Technical Services  
Roadway Information

# SOTTSR00051\*\*C

State True Log

11.287

County True Log

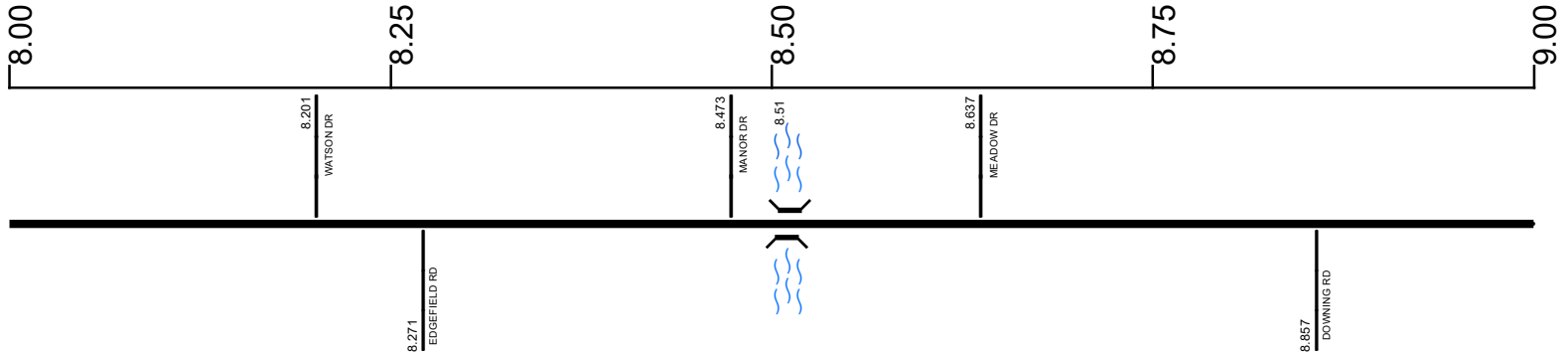

Surface Type & Width (Left / Right)

G 24'  
7.11 - 10.385

Base Type (Left / Right)

N  
7.11 - 10.385

Shoulder Type & Width (Left / Right)

2 (10'/10')  
6.509 - 10.385

Through Lanes

2  
6.69 - 10.385

Street Name

SR 51  
1.43 - 10.385

- |                     |                   |                      |              |
|---------------------|-------------------|----------------------|--------------|
| Non-divided Highway | Bridge (on route) | Railroad (at grade)  | Intersection |
| Divided Highway     | Underpass         | Railroad (underpass) |              |
| Secondary Segment   | Overpass          | Railroad (overpass)  |              |
| Corporation         |                   |                      |              |

Created on: 7/3/2025



transportation.ohio.gov

Prepared by  
The Ohio Department of Transportation  
Office of Technical Services  
Roadway Information

# SOTTSR00051\*\*C

State True Log

12.287

County True Log

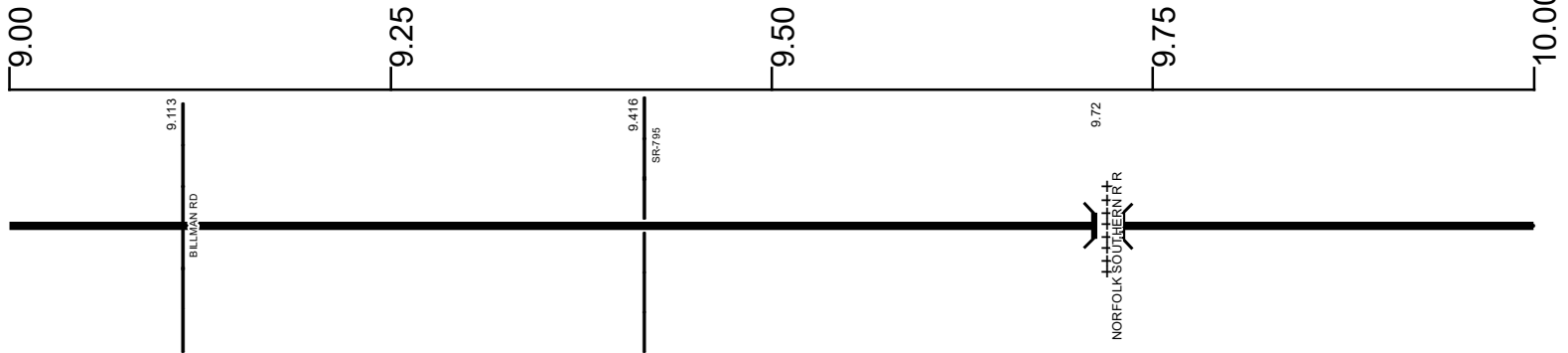

Surface Type & Width (Left / Right)

G 24'  
7.11 - 10.385

Base Type (Left / Right)

N  
7.11 - 10.385

Shoulder Type & Width (Left / Right)

2 (10'/10')  
6.509 - 10.385

Through Lanes

2  
6.69 - 10.385

Street Name

SR 51  
1.43 - 10.385

- |  |   |   |   |
|--|---|---|---|
| <ul style="list-style-type: none"> <li> Non-divided Highway</li> <li> Divided Highway</li> <li> Secondary Segment</li> <li> Corporation</li> </ul> | <ul style="list-style-type: none"> <li> Bridge (on route)</li> <li> Underpass</li> <li> Overpass</li> </ul> | <ul style="list-style-type: none"> <li> Railroad (at grade)</li> <li> Railroad (underpass)</li> <li> Railroad (overpass)</li> </ul> | <ul style="list-style-type: none"> <li> Intersection</li> </ul> |
|--|---|---|---|

Created on: 7/3/2025

transportation.ohio.gov

Prepared by  
The Ohio Department of Transportation  
Office of Technical Services  
Roadway Information

SOTTSR00051\*\*C

State True Log

12.672

County True Log



Surface Type & Width (Left / Right)	G 24'	7.11 - 10.385
Base Type (Left / Right)	N	7.11 - 10.385
Shoulder Type & Width (Left / Right)	2 (10'/10')	6.509 - 10.385
Through Lanes	2	6.69 - 10.385
Street Name	SR 51	1.43 - 10.385

Non-divided Highway	Bridge (on route)	Railroad (at grade)	Intersection
Divided Highway	Underpass	Railroad (underpass)	
Secondary Segment	Overpass	Railroad (overpass)	
Corporation			

Created on: 7/3/2025



transportation.ohio.gov  
 Prepared by  
 The Ohio Department of Transportation  
 Office of Technical Services  
 Roadway Information

## Historical Project List for SOTTSR00051\*\*C

Begin Measure	End Measure	Project ID Number	Construction Completion Date	Treatment Category	Treatment Type
0.000	1.429	88524	11-2016	Minor Rehabilitation	60-AC Overlay w/Rpr
1.579	4.878	94324	8-2020	Minor Rehabilitation	60-AC Overlay w/Rpr
4.908	10.385	100342	8-2017	Minor Rehabilitation	38-Fine Poly AC Overlay

# Roadway Codes

## Access Control Journalized

- F - Full Access Control
- L - Limited Access Control
- N - No Access Control

## Access Control Operational

- 1 - Full Access Control
- 2 - Partial Access Control
- 3 - No Access Control

## Base Type

- F - Crack and Seat
- H - Rubblize and Roll
- I - Aggregate Base 304 or Traffic Compacted
- K - Water Bound Macadam
- L - Bituminous Concrete Mix or Penetration Macadam
- N - Plain Concrete
- P - Reinforced Concrete
- R - Brick (Flexible)
- T - Brick (Rigid)

## Direction of Travel

- B - Both (Two-way)
- F - One-way Cardinal
- T - One-way Non-cardinal

## Facility Type

- 1 - One-way Roadway
- 2 - Two-way Roadway
- 4 - Ramp
- 5 - Non-mainline
- 6 - Non-inventory Direction
- 7 - Planned / Unbuilt

## Historical Federal Aid Indicator

- N - Not a FAP Route
- Y - FAP Route

## Functional Classification

- 01 - Interstate
- 02 - Principal Arterial (Freeways)
- 03 - Principal Arterial (Other)
- 04 - Minor Arterial
- 05 - Major Collector
- 06 - Minor Collector
- 07 - Local

## Leave / Reenter Indicator

- Y - Route leaves/reenters at this point
- N - Route does not leave/reenter at this point

## Median Type

- 1 - None
- 2 - Unprotected
- 3 - Curbed
- 4 - Positive Barrier (Unspecified)
- 5 - Positive Barrier (Flexible)
- 6 - Positive Barrier (Semi-rigid)
- 7 - Positive Barrier (Rigid)

## NHS

- N - National Highway System
- H - Congressional Corridor
- 2 - Major Airport
- 3 - Major Port Facility
- 4 - Major Amtrak Station
- 5 - Major Rail / Truck Terminal
- 6 - Major Intercity Bus Terminal
- 7 - Major Public Transit / Multi-modal Passenger Terminal
- 8 - Major Pipeline Terminal
- 9 - Major Ferry Terminal

## Priority System

- G - General
- P - Priority System
- U - Urban

## Scenic Byway Code

- A - All American Road
- N - National Scenic Byway
- S - State Scenic Byway

## Shoulder Type

- 1 - None
- 2 - Surfaced shoulder exists (bituminous concrete {AC})
- 3 - Surfaced shoulder exists (Portland Cement Concrete {PCC})
- 4 - Stabilized shoulder exists (gravel or other granular material)
- 5 - Combination shoulder exists (two or more surface types)
- 6 - Earth shoulder exists
- 7 - Barrier curb exists; no shoulder in front of curb

## Surface Type

- A - Combination
- B - Brick
- C - Continuous Reinforced Concrete
- D - Reinforced Concrete
- E - Plain Concrete
- G - Bituminous Concrete
- I - Chipseal on Granular
- K - Open Graded Bituminous
- L - Chipseal or Micro
- M - Gravel
- U - Unimproved
- X - Right of Way Only