

# SPUTSR00634\*\*C

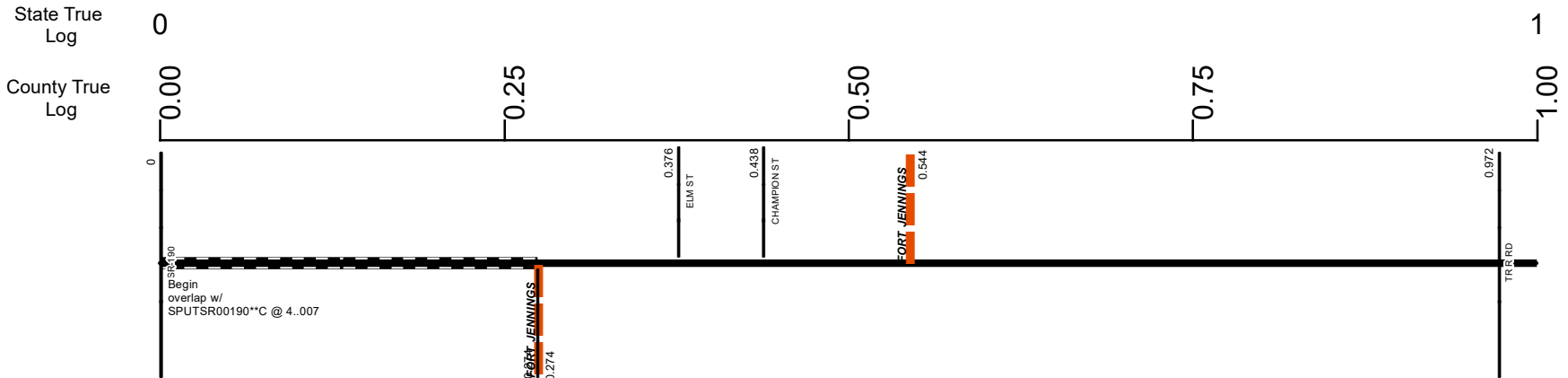

Surface Type & Width (Left / Right)	G 20'
	0.274 - 5.987
Base Type (Left / Right)	I
	0.274 - 8.174
Shoulder Type & Width (Left / Right)	5 (2'/2')
	0.274 - 5.987
Through Lanes	2
	0.274 - 8.174
Street Name	SR 634
	0.274 - 8.174

- Non-divided Highway
- Divided Highway
- Secondary Segment
- Corporation
- Bridge (on route)
- Underpass
- Overpass
- Railroad (at grade)
- Railroad (underpass)
- Railroad (overpass)
- Intersection

Created on: 7/8/2025



transportation.ohio.gov  
 Prepared by  
 The Ohio Department of Transportation  
 Office of Technical Services  
 Roadway Information

# SPUTSR00634\*\*C

State True Log

County True Log

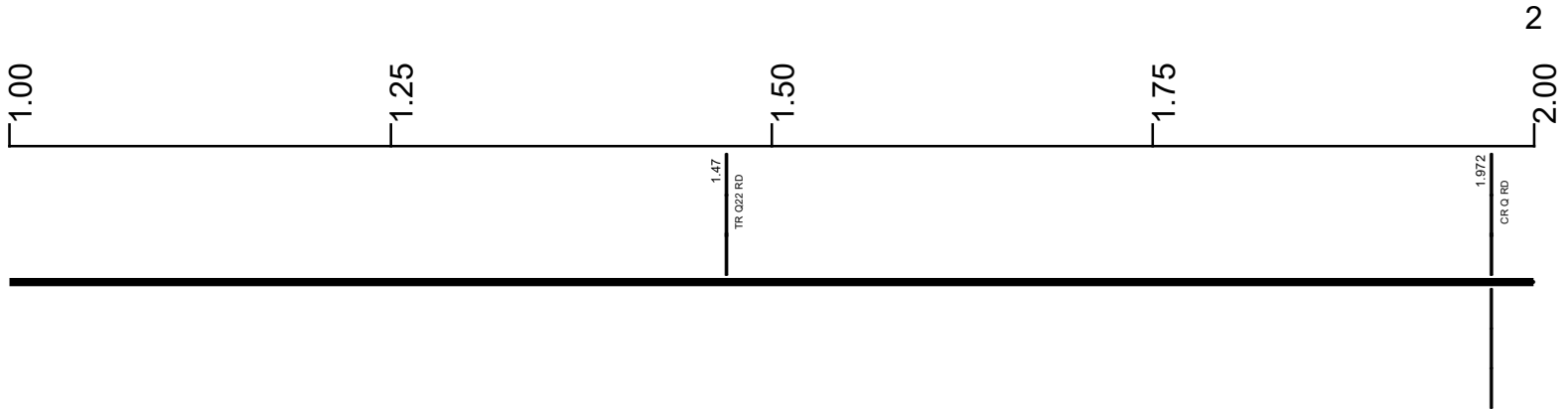

Surface Type & Width (Left / Right)	G 20'
	0.274 - 5.987
Base Type (Left / Right)	I
	0.274 - 8.174
Shoulder Type & Width (Left / Right)	5 (2/2')
	0.274 - 5.987
Through Lanes	2
	0.274 - 8.174
Street Name	SR 634
	0.274 - 8.174

<ul style="list-style-type: none"> <li> Non-divided Highway</li> <li> Divided Highway</li> <li> Secondary Segment</li> <li> Corporation</li> </ul>	<ul style="list-style-type: none"> <li> Bridge (on route)</li> <li> Underpass</li> <li> Overpass</li> </ul>	<ul style="list-style-type: none"> <li> Railroad (at grade)</li> <li> Railroad (underpass)</li> <li> Railroad (overpass)</li> </ul>	<ul style="list-style-type: none"> <li> Intersection</li> </ul>
--	---	---	---

Created on: 7/8/2025

transportation.ohio.gov

Prepared by  
The Ohio Department of Transportation  
Office of Technical Services  
Roadway Information

# SPUTSR00634\*\*C

State True Log

County True Log

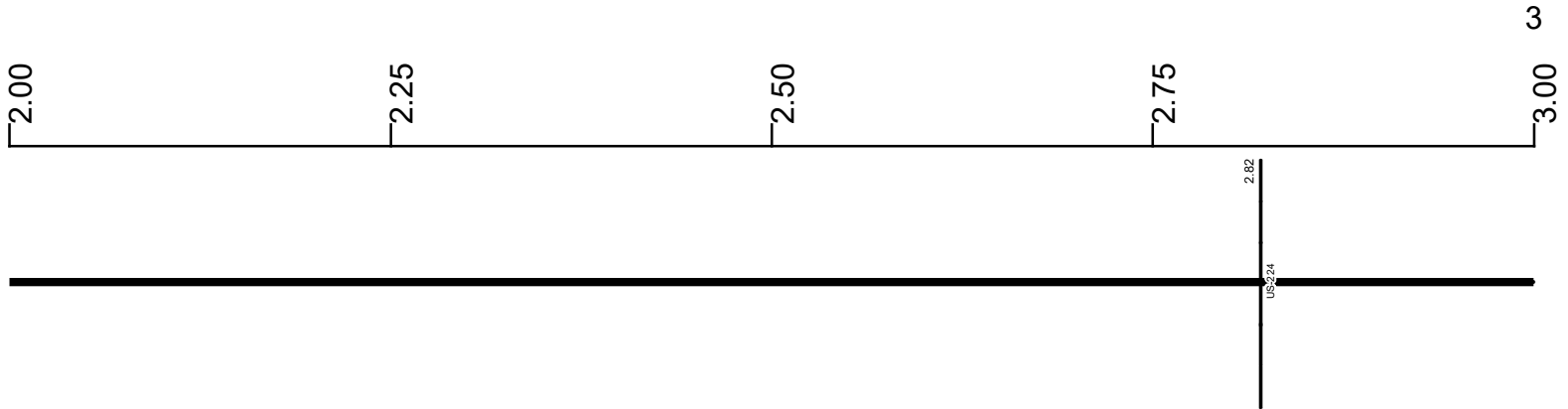

Surface Type & Width (Left / Right)	G 20'
	0.274 - 5.987
Base Type (Left / Right)	I
	0.274 - 8.174
Shoulder Type & Width (Left / Right)	5 (2'/2')
	0.274 - 5.987
Through Lanes	2
	0.274 - 8.174
Street Name	SR 634
	0.274 - 8.174

- Non-divided Highway
- Divided Highway
- Secondary Segment
- Corporation
- Bridge (on route)
- Underpass
- Overpass
- Railroad (at grade)
- Railroad (underpass)
- Railroad (overpass)
- Intersection

Created on: 7/8/2025



transportation.ohio.gov  
 Prepared by  
 The Ohio Department of Transportation  
 Office of Technical Services  
 Roadway Information

# SPUTSR00634\*\*C

State True Log

County True Log

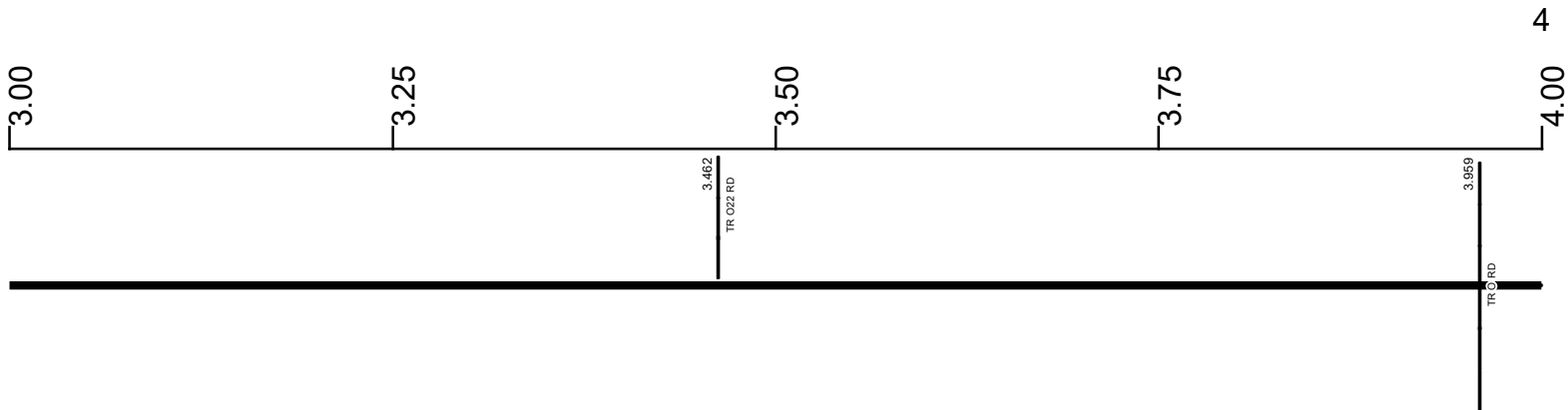

Surface Type & Width (Left / Right)

G 20'  
0.274 - 5.987

Base Type (Left / Right)

I  
0.274 - 8.174

Shoulder Type & Width (Left / Right)

5 (2/2)  
0.274 - 5.987

Through Lanes

2  
0.274 - 8.174

Street Name

SR 634  
0.274 - 8.174

- Non-divided Highway
  Bridge (on route)
  Railroad (at grade)
  Intersection
- Divided Highway
  Underpass
  Railroad (underpass)
- Secondary Segment
  Overpass
  Railroad (overpass)
- Corporation**

Created on: 7/8/2025



transportation.ohio.gov

Prepared by  
The Ohio Department of Transportation  
Office of Technical Services  
Roadway Information

# SPUTSR00634\*\*C

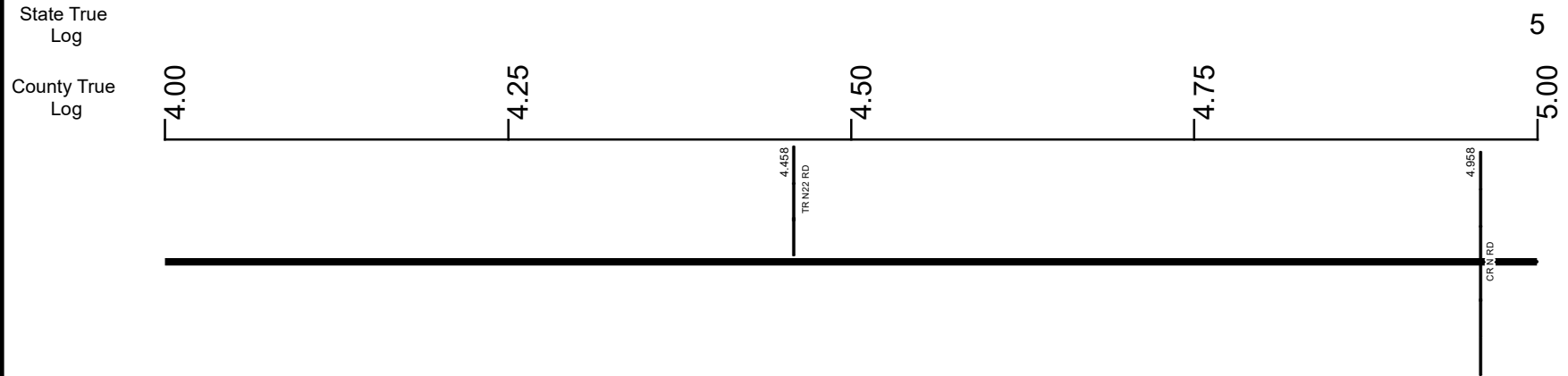

Surface Type & Width (Left / Right)	G 20'
	0.274 - 5.987
Base Type (Left / Right)	I
	0.274 - 8.174
Shoulder Type & Width (Left / Right)	5 (2/2')
	0.274 - 5.987
Through Lanes	2
	0.274 - 8.174
Street Name	SR 634
	0.274 - 8.174

<ul style="list-style-type: none"> <li> Non-divided Highway</li> <li> Divided Highway</li> <li> Secondary Segment</li> <li> Corporation</li> </ul>	<ul style="list-style-type: none"> <li> Bridge (on route)</li> <li> Underpass</li> <li> Overpass</li> </ul>	<ul style="list-style-type: none"> <li> Railroad (at grade)</li> <li> Railroad (underpass)</li> <li> Railroad (overpass)</li> </ul>	<ul style="list-style-type: none"> <li> Intersection</li> </ul>
--	---	---	---

Created on: 7/8/2025

transportation.ohio.gov

Prepared by  
The Ohio Department of Transportation  
Office of Technical Services  
Roadway Information

# SPUTSR00634\*\*C

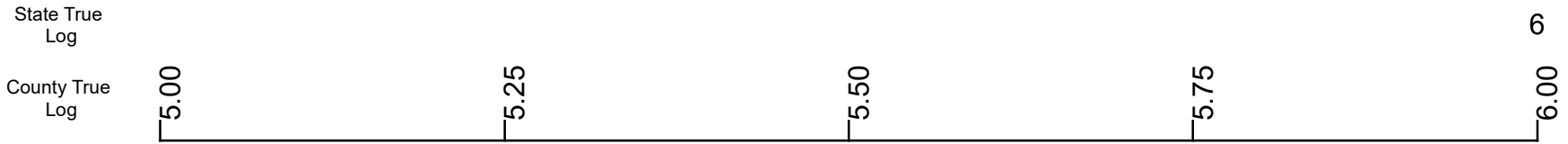

Surface Type & Width (Left / Right)	G 20'	G (9'/10')
	0.274 - 5.987	
Base Type (Left / Right)	I	
	0.274 - 8.174	
Shoulder Type & Width (Left / Right)	5 (2'/2')	5 (1 1/2')
	0.274 - 5.987	5.987 - 8.174
Through Lanes	2	
	0.274 - 8.174	
Street Name	SR 634	
	0.274 - 8.174	

Non-divided Highway	Bridge (on route)	Railroad (at grade)	Intersection
Divided Highway	Underpass	Railroad (underpass)	
Secondary Segment	Overpass	Railroad (overpass)	
Corporation			

Created on: 7/8/2025



transportation.ohio.gov  
 Prepared by  
 The Ohio Department of Transportation  
 Office of Technical Services  
 Roadway Information

# SPUTSR00634\*\*C

State True Log

7

County True Log



Surface Type & Width (Left / Right)

G (9'/10')  
5.987 - 8.174

Base Type (Left / Right)

I  
0.274 - 8.174

Shoulder Type & Width (Left / Right)

5 (1'/1')  
5.987 - 8.174

Through Lanes

2  
0.274 - 8.174

Street Name

SR 634  
0.274 - 8.174

- Non-divided Highway
  Bridge (on route)
  Railroad (at grade)
  Intersection
- Divided Highway
  Underpass
  Railroad (underpass)
- Secondary Segment
  Overpass
  Railroad (overpass)
- Corporation**

Created on: 7/8/2025



transportation.ohio.gov

Prepared by  
The Ohio Department of Transportation  
Office of Technical Services  
Roadway Information

# SPUTSR00634\*\*C

State True Log

County True Log

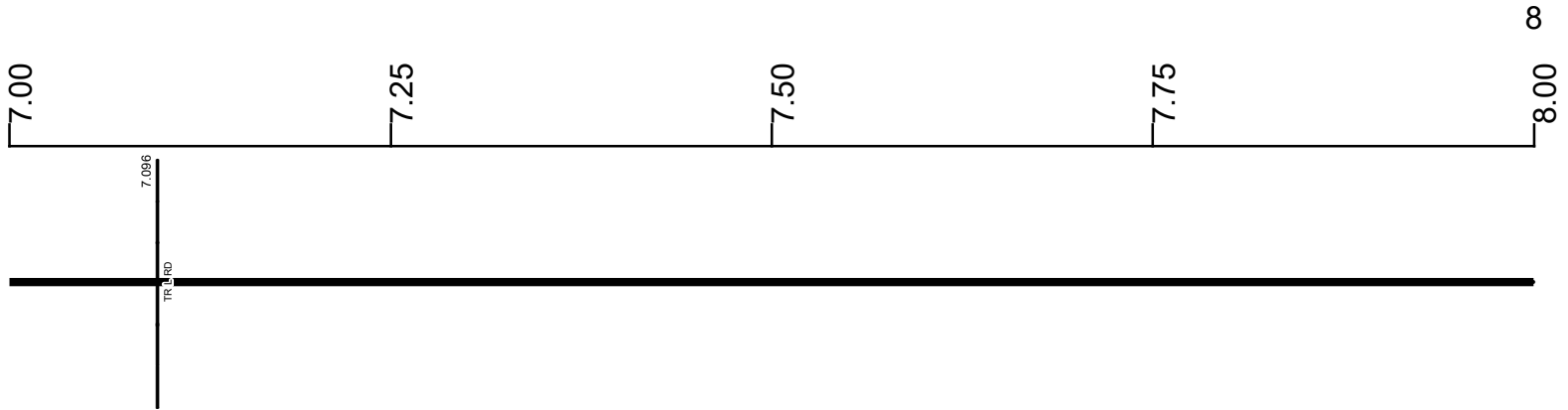

Surface Type & Width (Left / Right)

G (9'/10')  
5.987 - 8.174

Base Type (Left / Right)

I  
0.274 - 8.174

Shoulder Type & Width (Left / Right)

5 (1'/1')  
5.987 - 8.174

Through Lanes

2  
0.274 - 8.174

Street Name

SR 634  
0.274 - 8.174

- Non-divided Highway
  Bridge (on route)
  Railroad (at grade)
  Intersection
- Divided Highway
  Underpass
  Railroad (underpass)
- Secondary Segment
  Overpass
  Railroad (overpass)
- Corporation**

Created on: 7/8/2025



transportation.ohio.gov

Prepared by  
The Ohio Department of Transportation  
Office of Technical Services  
Roadway Information

# SPUTSR00634\*\*C

State True Log

County True Log

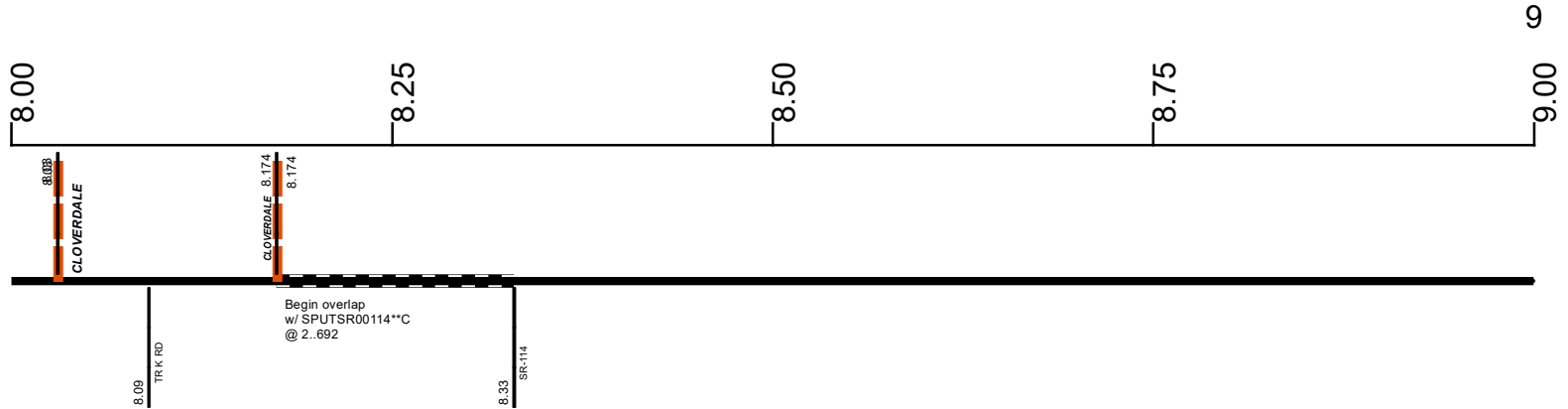

**Surface Type & Width (Left / Right)**

G (9/10')  
5.987 - 8.174

Base Type (Left / Right)  
I  
0.274 - 8.174

Shoulder Type & Width (Left / Right)  
5 (1/1')  
5.987 - 8.174

Through Lanes  
2  
0.274 - 8.174

SR 634  
0.274 - 8.174

**Surface Type & Width (Left / Right)**

G 22'  
8.33 - 10.42

Base Type (Left / Right)  
I  
8.33 - 13.435

Shoulder Type & Width (Left / Right)  
5 (1/1')  
8.33 - 10.31

Through Lanes  
2  
8.33 - 13.435

Street Name  
SR 634  
8.33 - 10.31

- Non-divided Highway
- Divided Highway
- Secondary Segment
- Corporation
- Bridge (on route)
- Underpass
- Overpass
- Railroad (at grade)
- Railroad (underpass)
- Railroad (overpass)
- Intersection

Created on: 7/8/2025



transportation.ohio.gov  
Prepared by  
The Ohio Department of Transportation  
Office of Technical Services  
Roadway Information

# SPUTSR00634\*\*C

State True Log

County True Log

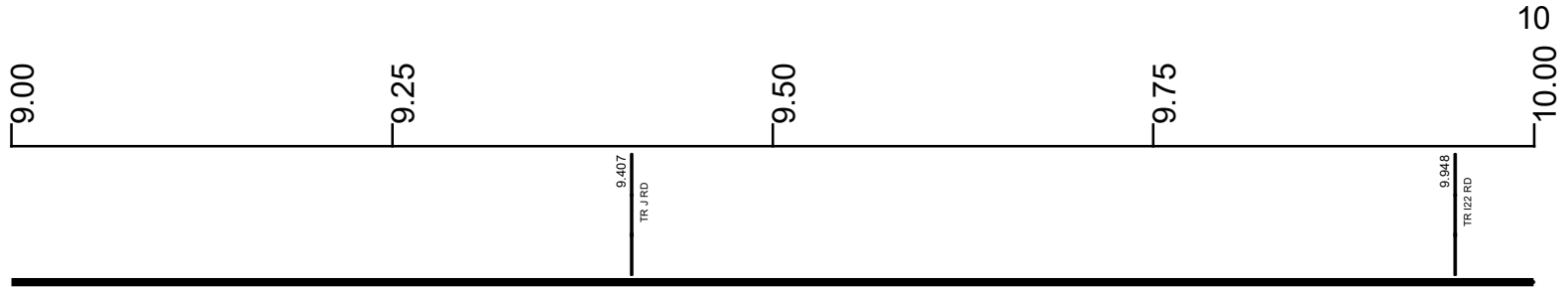

Surface Type & Width (Left / Right)

G 22'  
8.33 - 10.42

Base Type (Left / Right)

I  
8.33 - 13.435

Shoulder Type & Width (Left / Right)

5 (1/1')  
8.33 - 10.31

Through Lanes

2  
8.33 - 13.435

Street Name

SR 634  
8.33 - 10.31

- |                     |                   |                      |              |
|---------------------|-------------------|----------------------|--------------|
| Non-divided Highway | Bridge (on route) | Railroad (at grade)  | Intersection |
| Divided Highway     | Underpass         | Railroad (underpass) |              |
| Secondary Segment   | Overpass          | Railroad (overpass)  |              |
| Corporation         |                   |                      |              |

Created on: 7/8/2025



transportation.ohio.gov  
Prepared by  
The Ohio Department of Transportation  
Office of Technical Services  
Roadway Information

# SPUTSR00634\*\*C

State True Log  
County True Log

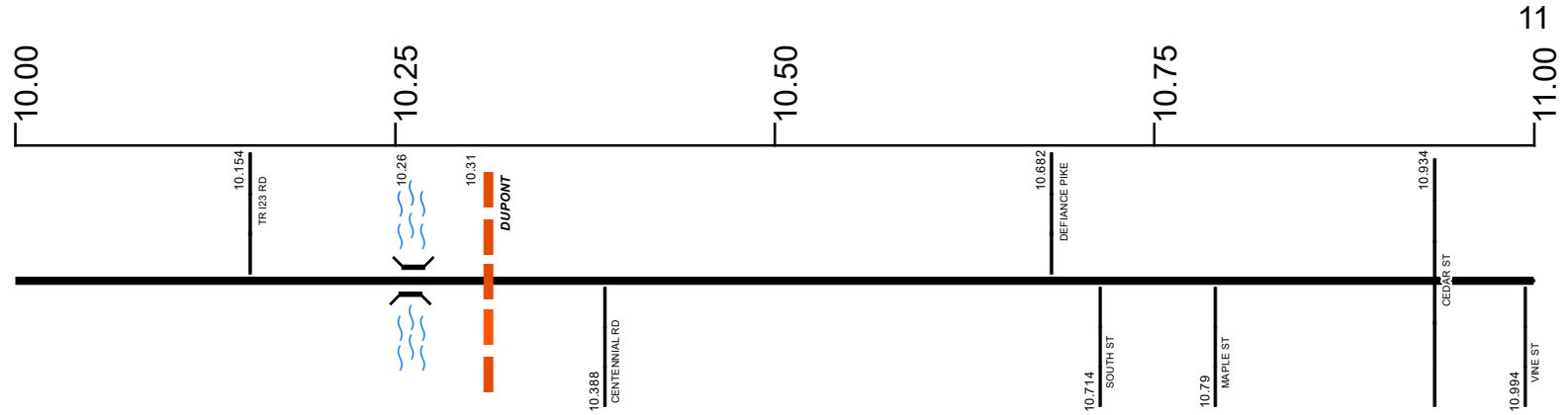

Surface Type & Width (Left / Right)	
G 22'	G 20'
8.33 - 10.42	10.42 - 13.435
Base Type (Left / Right)	
I	
8.33 - 13.435	
Shoulder Type & Width (Left / Right)	
5 (1/1')	4 (0/0')
8.33 - 10.31	10.31 - 10.42
Through Lanes	
2	
8.33 - 13.435	
Street Name	
SR 634	RIVER ST
8.33 - 10.31	10.31 - 11.438

Non-divided Highway	Bridge (on route)	Railroad (at grade)	Intersection
Divided Highway	Underpass	Railroad (underpass)	
Secondary Segment	Overpass	Railroad (overpass)	
Corporation			

Created on: 7/8/2025

transportation.ohio.gov

Prepared by  
The Ohio Department of Transportation  
Office of Technical Services  
Roadway Information

# SPUTSR00634\*\*C

State True Log  
County True Log

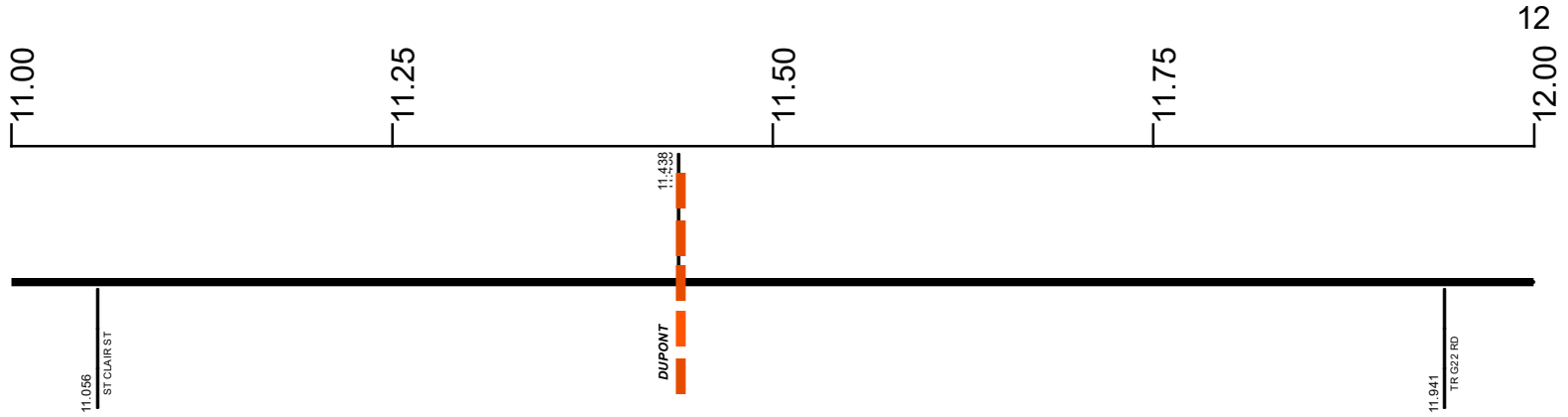

Surface Type & Width (Left / Right)	
G 20'	10.42 - 13.435
Base Type (Left / Right)	
I	8.33 - 13.435
Shoulder Type & Width (Left / Right)	
5 (1'1")	2 (0'0")
10.42 - 11.438	11.438 - 13.435
Through Lanes	
2	8.33 - 13.435
Street Name	
RIVER ST	SR 634
10.31 - 11.438	11.438 - 13.435

- |  |   |   |   |
|--|---|---|---|
| <ul style="list-style-type: none"> <li> Non-divided Highway</li> <li> Divided Highway</li> <li> Secondary Segment</li> <li> Corporation</li> </ul> | <ul style="list-style-type: none"> <li> Bridge (on route)</li> <li> Underpass</li> <li> Overpass</li> </ul> | <ul style="list-style-type: none"> <li> Railroad (at grade)</li> <li> Railroad (underpass)</li> <li> Railroad (overpass)</li> </ul> | <ul style="list-style-type: none"> <li> Intersection</li> </ul> |
|--|---|---|---|

Created on: 7/8/2025

transportation.ohio.gov

Prepared by  
The Ohio Department of Transportation  
Office of Technical Services  
Roadway Information

# SPUTSR00634\*\*C

State True Log  
County True Log

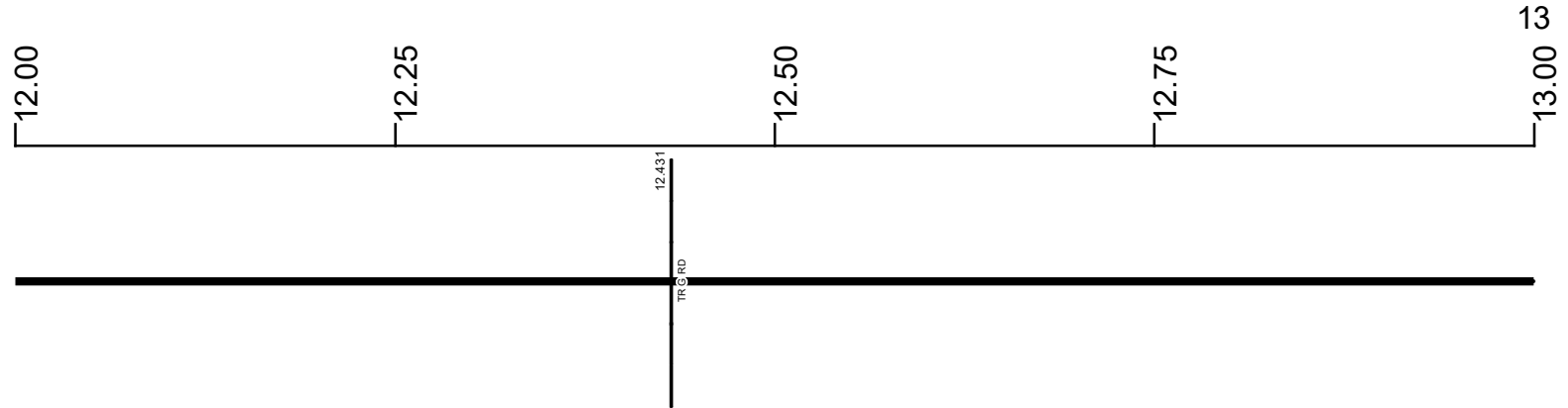

Surface Type & Width (Left / Right)	G 20' 10.42 - 13.435
Base Type (Left / Right)	I 8.33 - 13.435
Shoulder Type & Width (Left / Right)	2 (0/0) 11.438 - 13.435
Through Lanes	2 8.33 - 13.435
Street Name	SR 634 11.438 - 13.435

- Non-divided Highway
- Divided Highway
- Secondary Segment
- Corporation
- Bridge (on route)
- Underpass
- Overpass
- Railroad (at grade)
- Railroad (underpass)
- Railroad (overpass)
- Intersection

Created on: 7/8/2025



transportation.ohio.gov  
 Prepared by  
 The Ohio Department of Transportation  
 Office of Technical Services  
 Roadway Information

# SPUTSR00634\*\*C

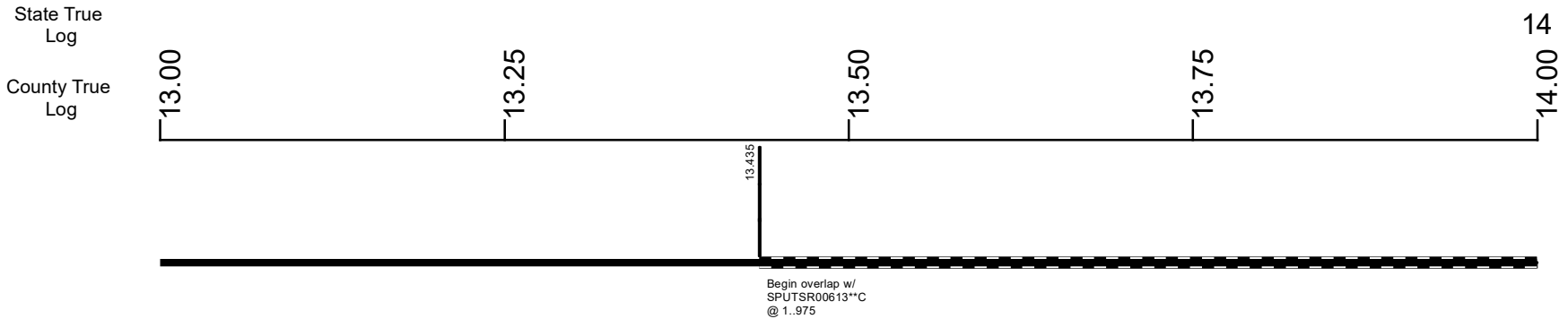

Surface Type & Width (Left / Right)	G 20'	10.42 - 13.435
Base Type (Left / Right)	I	8.33 - 13.435
Shoulder Type & Width (Left / Right)	2 (0'/0')	11.438 - 13.435
Through Lanes	2	8.33 - 13.435
Street Name	SR 634	11.438 - 13.435

- |                     |                   |                      |              |
|---------------------|-------------------|----------------------|--------------|
| Non-divided Highway | Bridge (on route) | Railroad (at grade)  | Intersection |
| Divided Highway     | Underpass         | Railroad (underpass) |              |
| Secondary Segment   | Overpass          | Railroad (overpass)  |              |
| Corporation         |                   |                      |              |

Created on: 7/8/2025



transportation.ohio.gov

Prepared by  
The Ohio Department of Transportation  
Office of Technical Services  
Roadway Information

SPUTSR00634\*\*C

State True Log

County True Log



- |                     |                   |                      |              |
|---------------------|-------------------|----------------------|--------------|
| Non-divided Highway | Bridge (on route) | Railroad (at grade)  | Intersection |
| Divided Highway     | Underpass         | Railroad (underpass) |              |
| Secondary Segment   | Overpass          | Railroad (overpass)  |              |
| Corporation         |                   |                      |              |

Created on: 7/8/2025

transportation.ohio.gov  
 Prepared by  
 The Ohio Department of Transportation  
 Office of Technical Services  
 Roadway Information

# SPUTSR00634\*\*C

State True Log  
County True Log

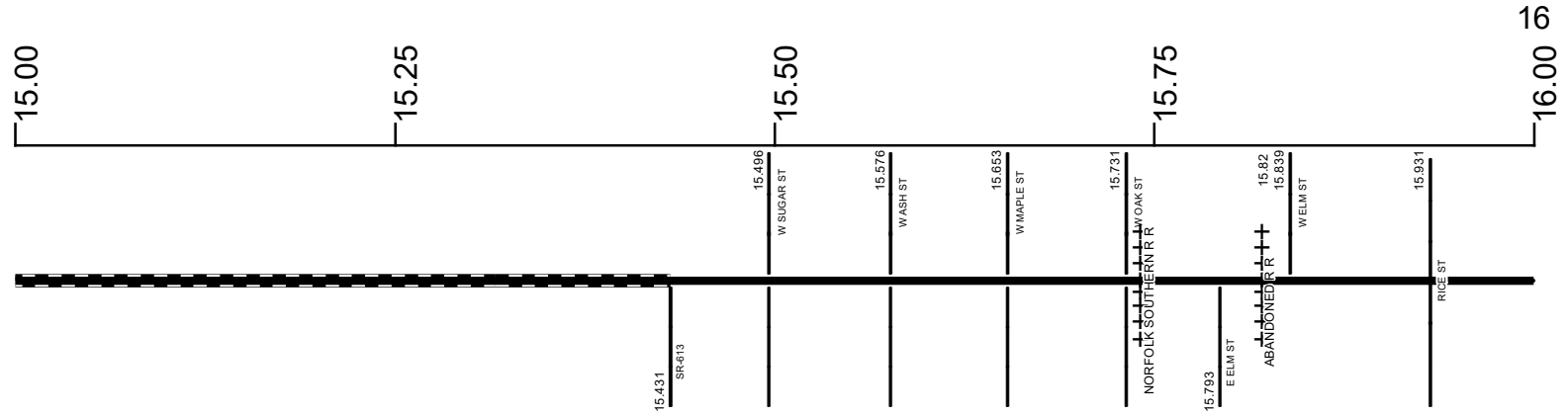

**Surface Type & Width (Left / Right)**

G (15'/16')	G 54'	G (28'/2')
15.431 - 15.576	15.576 - 15.97	15.97 - 16.148

**Base Type (Left / Right)**

T	T / I
15.431 - 15.97	15.97 - 16.148

**Shoulder Type & Width (Left / Right)**

1 (0'/0')
15.431 - 16.148

**Through Lanes**

2
15.431 - 17.954

**Street Name**

MAIN ST
15.431 - 16.183

- Non-divided Highway
- Divided Highway
- Secondary Segment
- Corporation
- Bridge (on route)
- Underpass
- Overpass
- Railroad (at grade)
- Railroad (underpass)
- Railroad (overpass)
- Intersection

Created on: 7/8/2025

transportation.ohio.gov

Prepared by  
The Ohio Department of Transportation  
Office of Technical Services  
Roadway Information

# SPUTSR00634\*\*C

State True Log  
County True Log

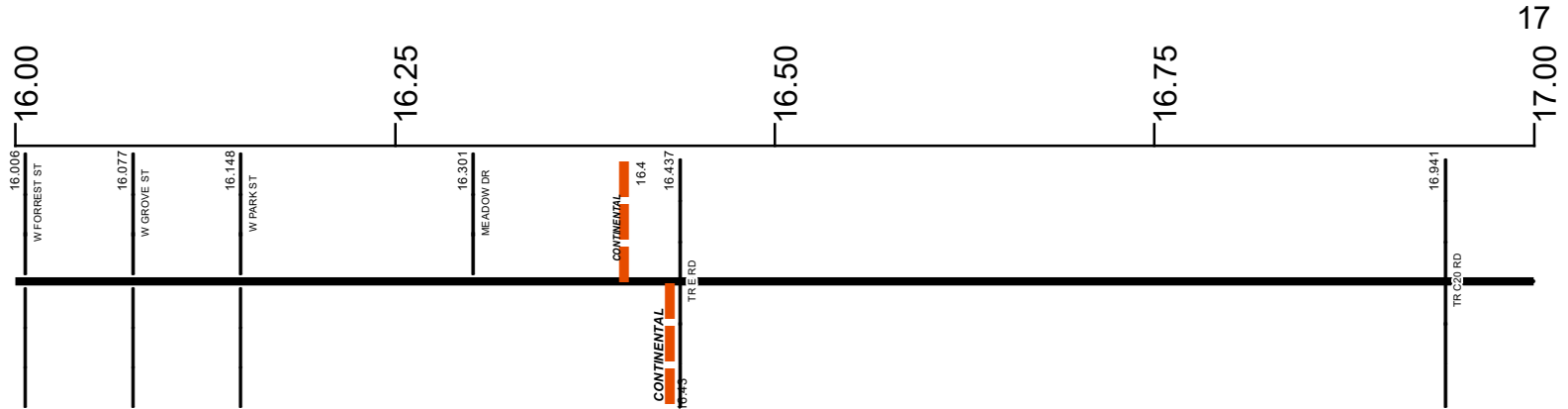

**Surface Type & Width (Left / Right)**

G (28'2")	G (20'8")	G 20'
15.97 - 16.148	16.148 - 16.183	16.183 - 17.954

**Base Type (Left / Right)**

T / I	N / I	N
15.97 - 16.148	16.148 - 16.183	16.183 - 17.954

**Shoulder Type & Width (Left / Right)**

1 (0'0")	1 (2'0")	5 (3'3")
15.431 - 16.148	16.148 - 16.183	16.183 - 17.954

**Through Lanes**

2
15.431 - 17.954

**Street Name**

MAIN ST	SR 634
15.431 - 16.183	16.183 - 17.954

- Non-divided Highway
- Divided Highway
- Secondary Segment
- Corporation
- Bridge (on route)
- Underpass
- Overpass
- Railroad (at grade)
- Railroad (underpass)
- Railroad (overpass)
- Intersection

Created on: 7/8/2025

transportation.ohio.gov

Prepared by  
The Ohio Department of Transportation  
Office of Technical Services  
Roadway Information

# SPUTSR00634\*\*C

State True Log  
County True Log

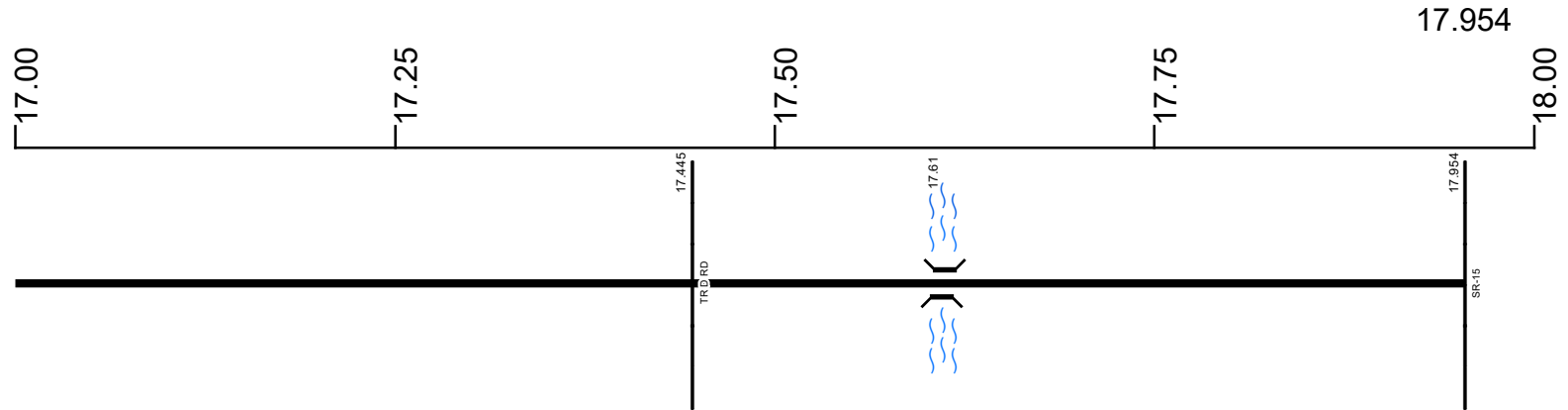

Surface Type & Width (Left / Right)	G 20'	16.183 - 17.954
Base Type (Left / Right)	N	16.183 - 17.954
Shoulder Type & Width (Left / Right)	5 (3'/3')	16.183 - 17.954
Through Lanes	2	15.431 - 17.954
Street Name	SR 634	16.183 - 17.954

Non-divided Highway	Bridge (on route)	Railroad (at grade)	Intersection
Divided Highway	Underpass	Railroad (underpass)	
Secondary Segment	Overpass	Railroad (overpass)	
Corporation			

Created on: 7/8/2025



transportation.ohio.gov  
 Prepared by  
 The Ohio Department of Transportation  
 Office of Technical Services  
 Roadway Information

## Historical Project List for SPUTSR00634\*\*C

Begin Measure	End Measure	Project ID Number	Construction Completion Date	Treatment Category	Treatment Type
0.274	8.174	87208	7-2014	Minor Rehabilitation	60-AC Overlay w/Rpr
0.480	8.174	109880	5-2023	Preventive Maintenance	25-Chip Seal
8.330	13.435	109880	5-2023	Preventive Maintenance	25-Chip Seal
8.330	13.435	87208	7-2014	Minor Rehabilitation	60-AC Overlay w/Rpr
15.431	16.432	92685	9-2018	Minor Rehabilitation	50-AC Overlay w/o Rpr
16.432	17.954	87204	11-2016	Minor Rehabilitation	50-AC Overlay w/o Rpr

# Roadway Codes

## Access Control Journalized

- F - Full Access Control
- L - Limited Access Control
- N - No Access Control

## Access Control Operational

- 1 - Full Access Control
- 2 - Partial Access Control
- 3 - No Access Control

## Base Type

- F - Crack and Seat
- H - Rubblize and Roll
- I - Aggregate Base 304 or Traffic Compacted
- K - Water Bound Macadam
- L - Bituminous Concrete Mix or Penetration Macadam
- N - Plain Concrete
- P - Reinforced Concrete
- R - Brick (Flexible)
- T - Brick (Rigid)

## Direction of Travel

- B - Both (Two-way)
- F - One-way Cardinal
- T - One-way Non-cardinal

## Facility Type

- 1 - One-way Roadway
- 2 - Two-way Roadway
- 4 - Ramp
- 5 - Non-mainline
- 6 - Non-inventory Direction
- 7 - Planned / Unbuilt

## Historical Federal Aid Indicator

- N - Not a FAP Route
- Y - FAP Route

## Functional Classification

- 01 - Interstate
- 02 - Principal Arterial (Freeways)
- 03 - Principal Arterial (Other)
- 04 - Minor Arterial
- 05 - Major Collector
- 06 - Minor Collector
- 07 - Local

## Leave / Reenter Indicator

- Y - Route leaves/reenters at this point
- N - Route does not leave/reenter at this point

## Median Type

- 1 - None
- 2 - Unprotected
- 3 - Curbed
- 4 - Positive Barrier (Unspecified)
- 5 - Positive Barrier (Flexible)
- 6 - Positive Barrier (Semi-rigid)
- 7 - Positive Barrier (Rigid)

## NHS

- N - National Highway System
- H - Congressional Corridor
- 2 - Major Airport
- 3 - Major Port Facility
- 4 - Major Amtrak Station
- 5 - Major Rail / Truck Terminal
- 6 - Major Intercity Bus Terminal
- 7 - Major Public Transit / Multi-modal Passenger Terminal
- 8 - Major Pipeline Terminal
- 9 - Major Ferry Terminal

## Priority System

- G - General
- P - Priority System
- U - Urban

## Scenic Byway Code

- A - All American Road
- N - National Scenic Byway
- S - State Scenic Byway

## Shoulder Type

- 1 - None
- 2 - Surfaced shoulder exists (bituminous concrete {AC})
- 3 - Surfaced shoulder exists (Portland Cement Concrete {PCC})
- 4 - Stabilized shoulder exists (gravel or other granular material)
- 5 - Combination shoulder exists (two or more surface types)
- 6 - Earth shoulder exists
- 7 - Barrier curb exists; no shoulder in front of curb

## Surface Type

- A - Combination
- B - Brick
- C - Continuous Reinforced Concrete
- D - Reinforced Concrete
- E - Plain Concrete
- G - Bituminous Concrete
- I - Chipseal on Granular
- K - Open Graded Bituminous
- L - Chipseal or Micro
- M - Gravel
- U - Unimproved
- X - Right of Way Only