

# SRICSR00430\*\*C

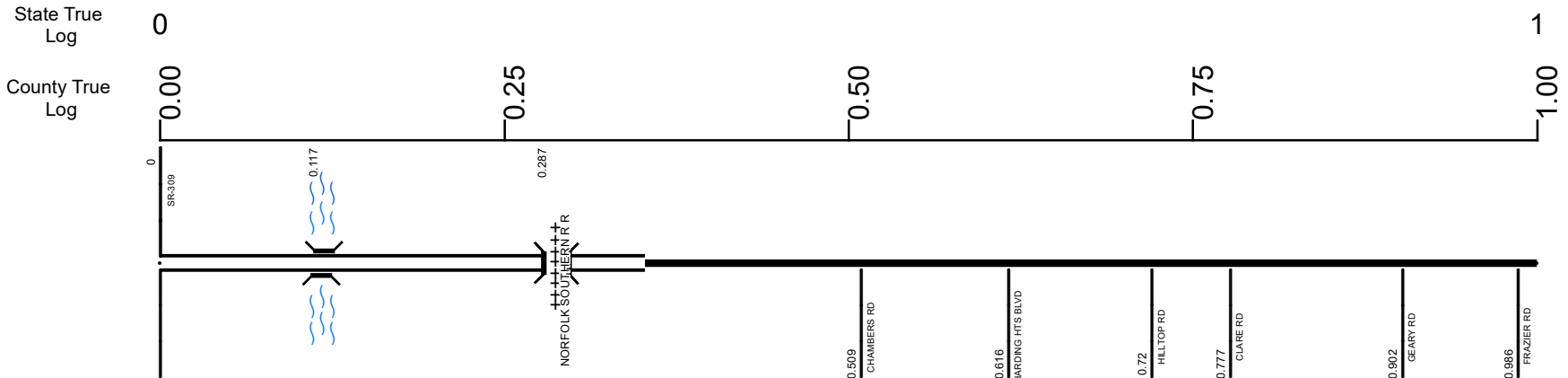

**Surface Type & Width (Left / Right)**

G 32'	G 24'
0 - 0.352	0.352 - 1.122

**Base Type (Left / Right)**

P	T
0 - 0.352	0.352 - 2.186

**Shoulder Type & Width (Left / Right)**

5 (10'/10')	5 (5'/5')
0 - 0.352	0.352 - 1.122

**Median Type and Width**

2 ( 9999' )
0 - 0.352

**Resurface Year**

2020
0.38 - 2.19

**Through Lanes**

2
0 - 1.122

**Street Name**

WPARK AVE
0 - 5.18

- Non-divided Highway
- Divided Highway
- Secondary Segment
- Corporation
- Bridge (on route)
- Underpass
- Overpass
- Railroad (at grade)
- Railroad (underpass)
- Railroad (overpass)
- Intersection

Created on: 7/8/2025

transportation.ohio.gov

Prepared by  
The Ohio Department of Transportation  
Office of Technical Services  
Roadway Information

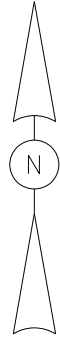

INTERCHANGE  
SR 309 & SR 430  
RICHLAND COUNTY  
INTERCHANGE ID NUMBER = 077500

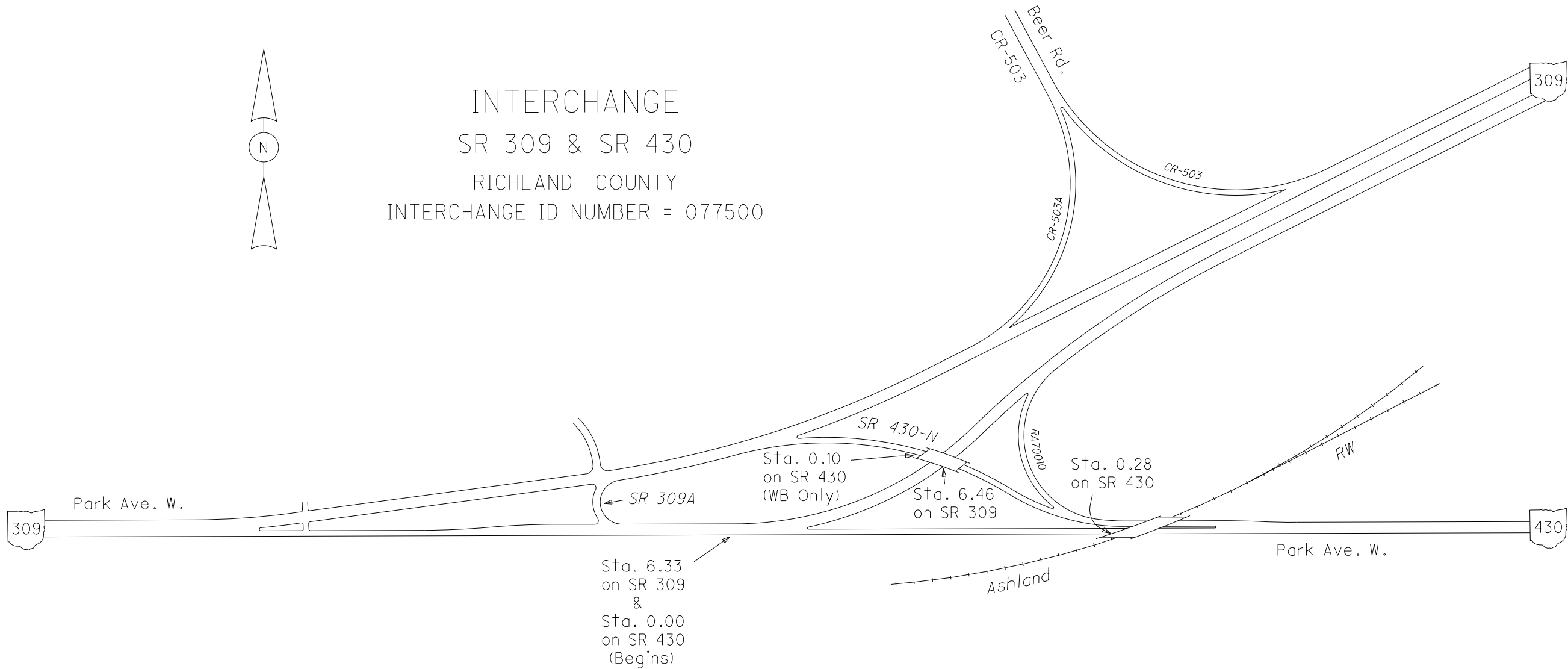

# SRICSR00430\*\*C

State True Log

County True Log

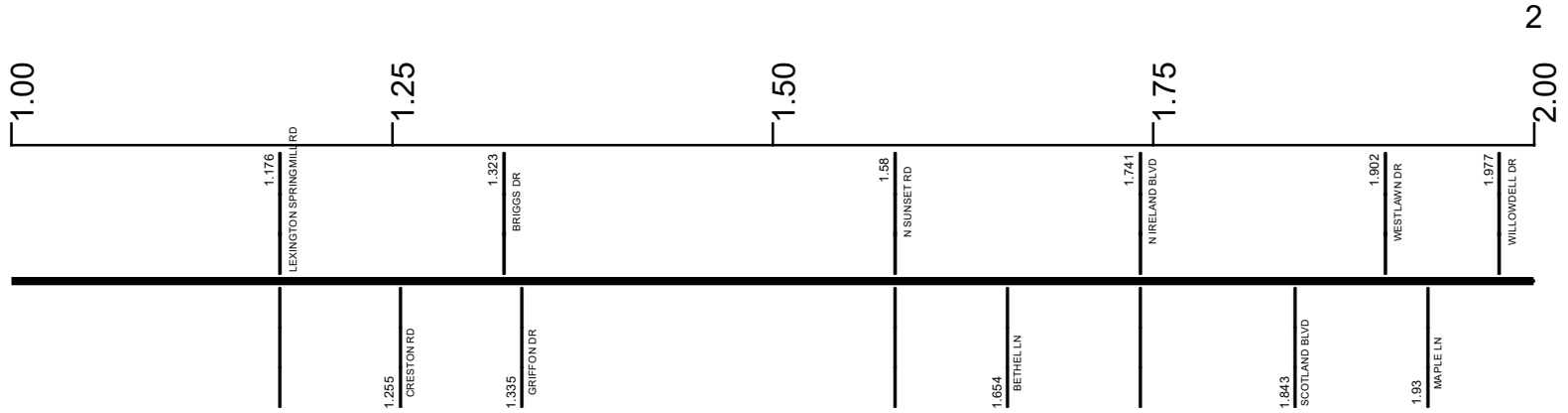

**Surface Type & Width (Left / Right)**

G 24'	G 34'
0.352 - 1.122	1.122 - 2.186

**Base Type (Left / Right)**

T	T
0.352 - 1.122	1.122 - 2.186

**Shoulder Type & Width (Left / Right)**

5 (5/5')	2 (2/2')	5 (2/2')
0.352 - 1.122	1.122 - 1.176	1.176 - 2.186

**Resurface Year**

2020	2020
0.38 - 2.19	0.38 - 2.19

**Through Lanes**

2	3	2
0 - 1.122	1.122 - 1.176	1.176 - 2.186

**Street Name**

W PARK AVE	W PARK AVE
0 - 5.18	0 - 5.18

<p> Non-divided Highway</p> <p> Divided Highway</p> <p> Secondary Segment</p> <p> Corporation</p>	<p> Bridge (on route)</p> <p> Underpass</p> <p> Overpass</p>	<p> Railroad (at grade)</p> <p> Railroad (underpass)</p> <p> Railroad (overpass)</p>	<p> Intersection</p>
---	--	--	----------------------

Created on: 7/8/2025

transportation.ohio.gov

Prepared by

The Ohio Department of Transportation

Office of Technical Services

Roadway Information

# SRICSR00430\*\*C

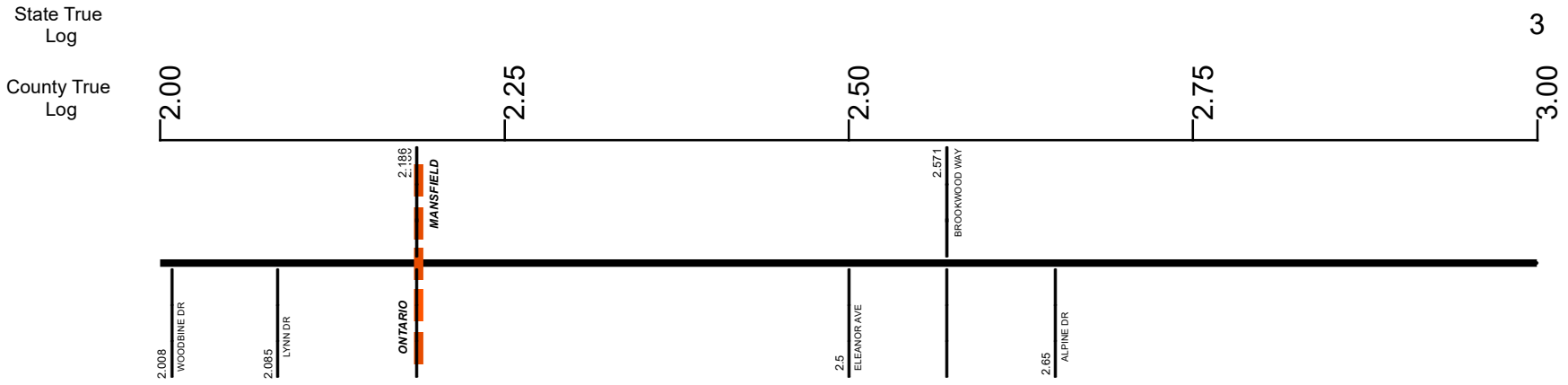

<b>Surface Type &amp; Width (Left / Right)</b>	
G 34' 1.122 - 2.186	G (40'/30') 2.186 - 3.204
<b>Base Type (Left / Right)</b>	
T 0.352 - 2.186	N / T 2.186 - 3.204
<b>Shoulder Type &amp; Width (Left / Right)</b>	
5 (2'/2') 1.176 - 2.186	1 (0'/0') 2.186 - 5.413
<b>Resurface Year</b>	
2020 0.38 - 2.19	
<b>Through Lanes</b>	
2 1.176 - 2.186	4 2.186 - 5.413
<b>Street Name</b>	
W PARK AVE 0 - 5.18	

Non-divided Highway	Bridge (on route)	Railroad (at grade)	Intersection
Divided Highway	Underpass	Railroad (underpass)	
Secondary Segment	Overpass	Railroad (overpass)	
<b>Corporation</b>			

Created on: 7/8/2025



transportation.ohio.gov

Prepared by  
The Ohio Department of Transportation  
Office of Technical Services  
Roadway Information

# SRICSR00430\*\*C

State True Log

County True Log

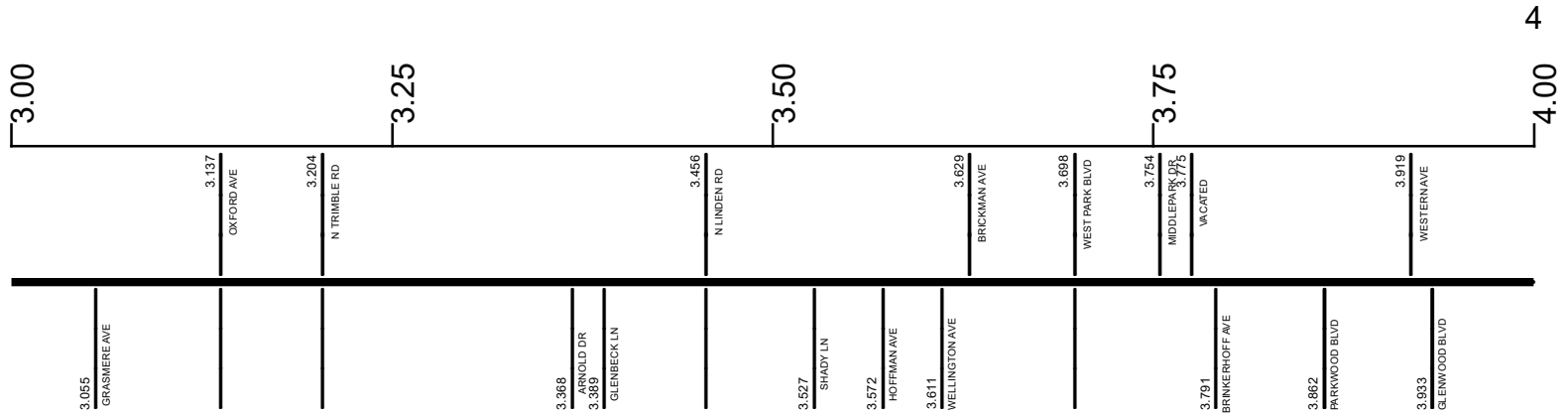

**Surface Type & Width (Left / Right)**

G (40'/30')	G (24'/16')	G 40'
2.186 - 3.204	3.204 - 3.698	3.698 - 4.703

**Base Type (Left / Right)**

N / T	R / N	T
2.186 - 3.204	3.204 - 3.698	3.698 - 4.703

**Shoulder Type & Width (Left / Right)**

1 (0'/0')
2.186 - 5.413

**Through Lanes**

4
2.186 - 5.413

**Street Name**

W PARK AVE
0 - 5.18

- Non-divided Highway
- Divided Highway
- Secondary Segment
- Corporation
- Bridge (on route)
- Underpass
- Overpass
- Railroad (at grade)
- Railroad (underpass)
- Railroad (overpass)
- Intersection

Created on: 7/8/2025

transportation.ohio.gov

Prepared by  
The Ohio Department of Transportation  
Office of Technical Services  
Roadway Information

# SRICSR00430\*\*C

State True Log

County True Log

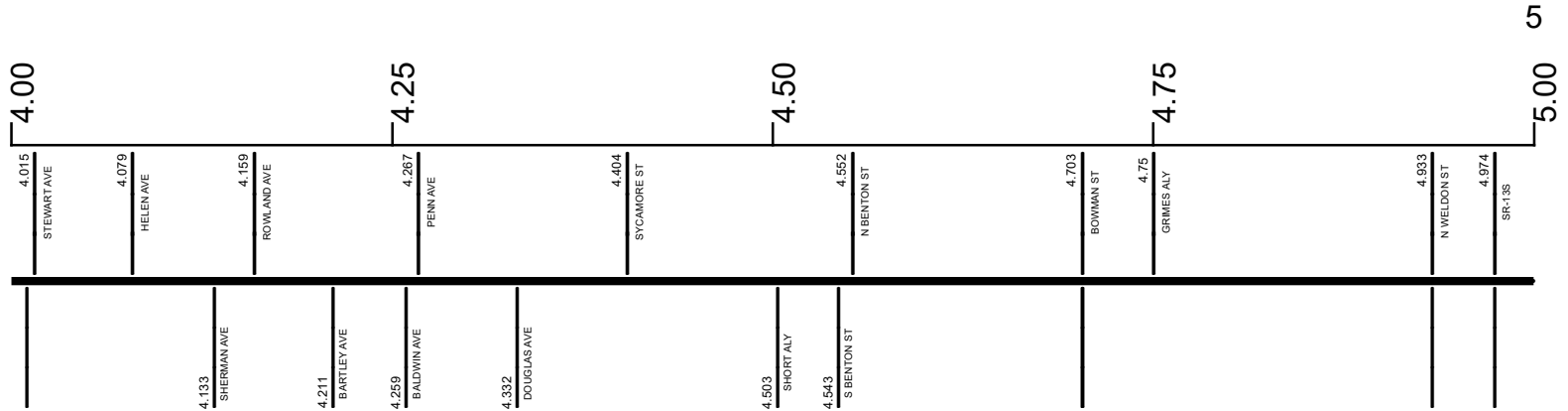

**Surface Type & Width (Left / Right)**

G 40'	G (40'/16')
3.698 - 4.703	4.703 - 5.107

**Base Type (Left / Right)**

T	T / N
3.698 - 4.703	4.703 - 5.107

**Shoulder Type & Width (Left / Right)**

	1 (0'/0')
	2.186 - 5.413

**Through Lanes**

	4
	2.186 - 5.413

**Street Name**

	W PARK AVE
	0 - 5.18

- Non-divided Highway
- Divided Highway
- Secondary Segment
- Corporation
- Bridge (on route)
- Underpass
- Overpass
- Railroad (at grade)
- Railroad (underpass)
- Railroad (overpass)
- Intersection

Created on: 7/8/2025

transportation.ohio.gov

Prepared by  
The Ohio Department of Transportation  
Office of Technical Services  
Roadway Information

# SRICSR00430\*\*C

State True Log

County True Log

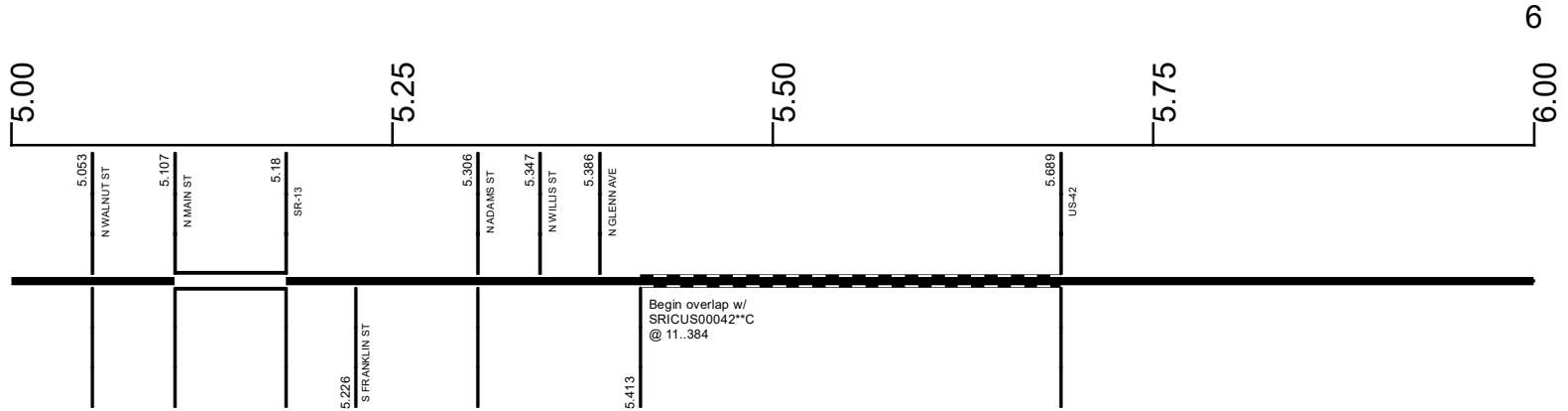

**Surface Type & Width (Left / Right)**

G (40'/16')	G 44'	G 52'
4.703 - 5.107	5.107 - 5.18	5.18 - 5.413

**Base Type (Left / Right)**

T / N	N	T
4.703 - 5.107	5.107 - 5.18	5.18 - 5.413

**Shoulder Type & Width (Left / Right)**

1 (0'/0')
2.186 - 5.413

**Median Type and Width**

3 (10')
5.107 - 5.18

**Through Lanes**

4
2.186 - 5.413

**Street Name**

W PARK AVE	E PARK AVE
0 - 5.18	5.18 - 5.413

**Surface Type & Width (Left / Right)**

G 32'
5.689 - 6.011

**Base Type (Left / Right)**

T
5.689 - 6.011

**Shoulder Type & Width (Left / Right)**

1 (0'/0')
5.689 - 6.011

**Through Lanes**

2
5.689 - 6.011

**Street Name**

E PARK AVE
5.689 - 6.011

- Non-divided Highway
- Divided Highway
- Secondary Segment
- Corporation
- Bridge (on route)
- Underpass
- Overpass
- Railroad (at grade)
- Railroad (underpass)
- Railroad (overpass)
- Intersection

Created on: 7/8/2025



transportation.ohio.gov  
 Prepared by  
 The Ohio Department of Transportation  
 Office of Technical Services  
 Roadway Information

# SRICSR00430\*\*C

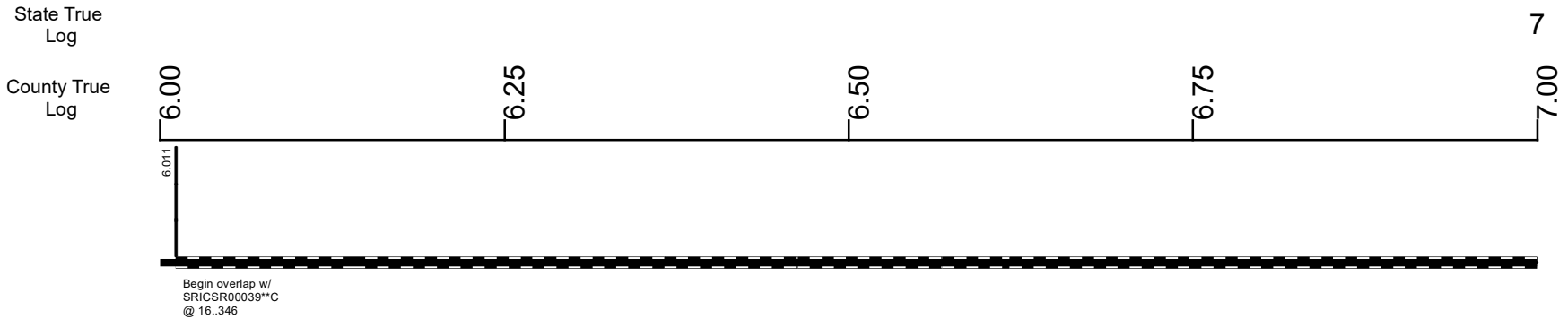

**Surface Type & Width (Left / Right)**

G 32'

**Base Type (Left / Right)**

T

5.689 - 6.011

**Shoulder Type & Width (Left / Right)**

1 (0'0')

5.689 - 6.011

**Through Lanes**

2

5.689 - 6.011

**Street Name**

E PARK AVE

5.689 - 6.011

Non-divided Highway	Bridge (on route)	Railroad (at grade)	Intersection
Divided Highway	Underpass	Railroad (underpass)	
Secondary Segment	Overpass	Railroad (overpass)	
Corporation			

Created on: 7/8/2025



transportation.ohio.gov

Prepared by  
The Ohio Department of Transportation  
Office of Technical Services  
Roadway Information

# SRICSR00430\*\*C

State True Log

County True Log

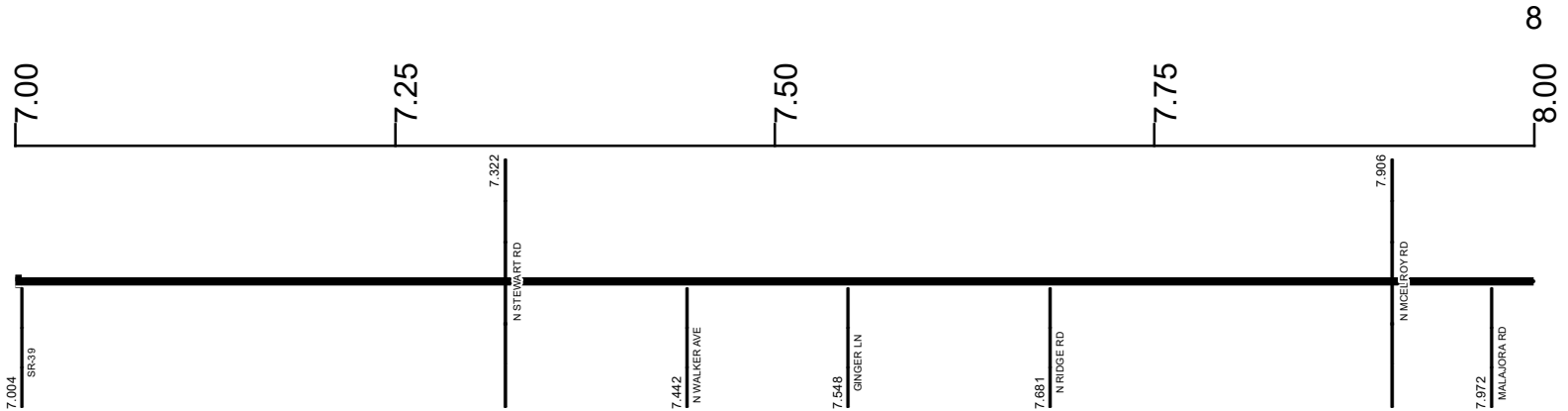

Surface Type & Width (Left / Right)

G (18'6")  
7.004 - 8.015

Base Type (Left / Right)

R / L  
7.004 - 8.015

Shoulder Type & Width (Left / Right)

5 (4'4")  
7.004 - 12.51

Through Lanes

2  
7.004 - 12.51

Street Name

SR 430  
7.004 - 12.51

- |                     |                   |                      |              |
|---------------------|-------------------|----------------------|--------------|
| Non-divided Highway | Bridge (on route) | Railroad (at grade)  | Intersection |
| Divided Highway     | Underpass         | Railroad (underpass) |              |
| Secondary Segment   | Overpass          | Railroad (overpass)  |              |
| Corporation         |                   |                      |              |

Created on: 7/8/2025



transportation.ohio.gov  
Prepared by  
The Ohio Department of Transportation  
Office of Technical Services  
Roadway Information

# SRICSR00430\*\*C

State True Log

County True Log

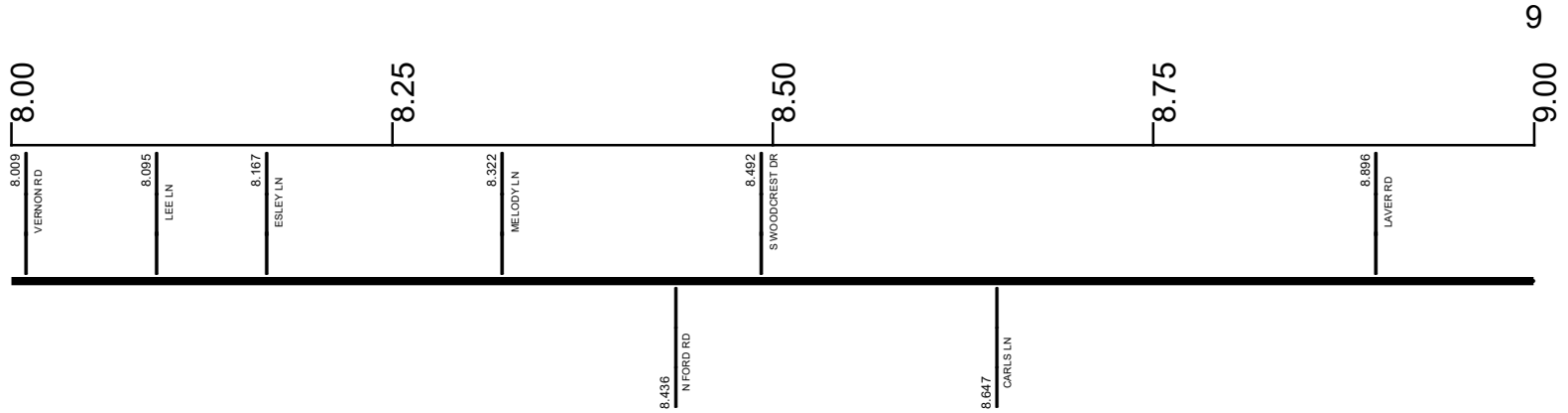

**Surface Type & Width (Left / Right)**

G (18'/6')	G (22'/2')
	8.015 - 9.923

**Base Type (Left / Right)**

R / L	R / I
7.004 - 8.015	8.015 - 9.923

**Shoulder Type & Width (Left / Right)**

	5 (4'/4')
	7.004 - 12.51

**Through Lanes**

	2
	7.004 - 12.51

**Street Name**

	SR 430
	7.004 - 12.51

- |                     |                   |                      |              |
|---------------------|-------------------|----------------------|--------------|
| Non-divided Highway | Bridge (on route) | Railroad (at grade)  | Intersection |
| Divided Highway     | Underpass         | Railroad (underpass) |              |
| Secondary Segment   | Overpass          | Railroad (overpass)  |              |
| Corporation         |                   |                      |              |

Created on: 7/8/2025

transportation.ohio.gov

Prepared by  
The Ohio Department of Transportation  
Office of Technical Services  
Roadway Information

# SRICSR00430\*\*C

State True Log

County True Log

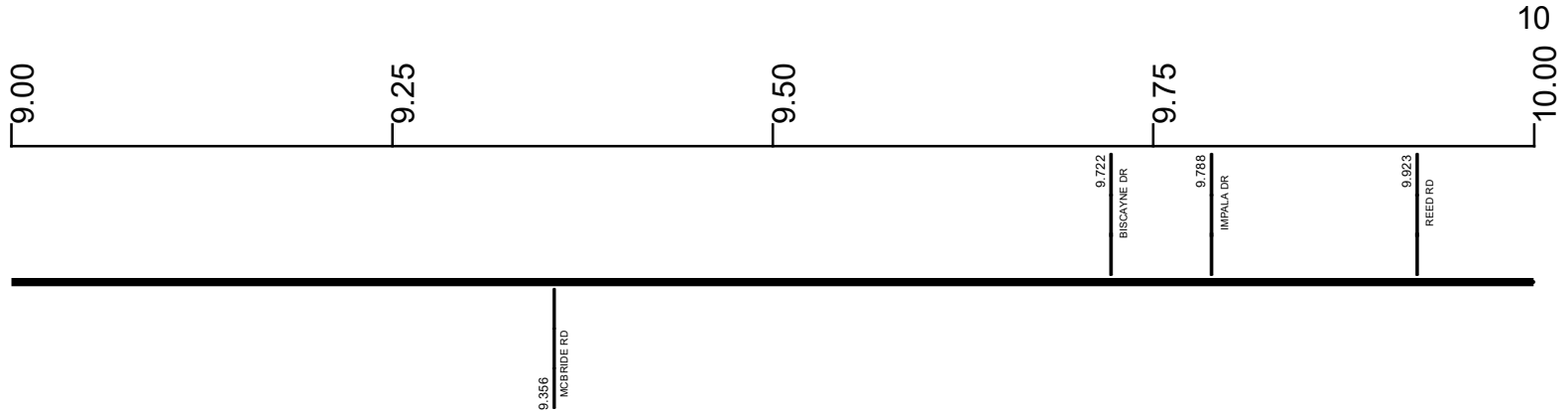

**Surface Type & Width (Left / Right)**

G (22'1/2')	G (18'6')
8.015 - 9.923	9.923 - 11.512

**Base Type (Left / Right)**

R / I	R / L
8.015 - 9.923	9.923 - 12.131

**Shoulder Type & Width (Left / Right)**

5 (4'1/4')
7.004 - 12.51

**Through Lanes**

2
7.004 - 12.51

**Street Name**

SR 430
7.004 - 12.51

- Non-divided Highway
- Divided Highway
- Secondary Segment
- Corporation
- Bridge (on route)
- Underpass
- Overpass
- Railroad (at grade)
- Railroad (underpass)
- Railroad (overpass)
- Intersection

Created on: 7/8/2025

transportation.ohio.gov

Prepared by  
The Ohio Department of Transportation  
Office of Technical Services  
Roadway Information

# SRICSR00430\*\*C

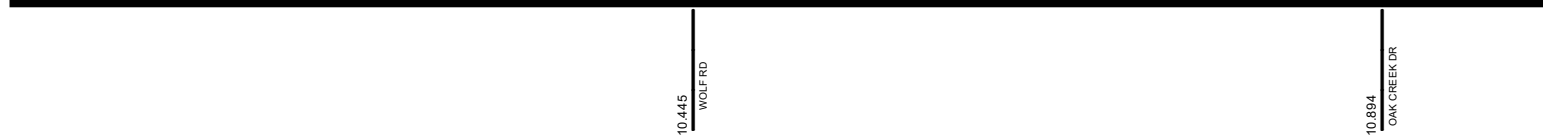
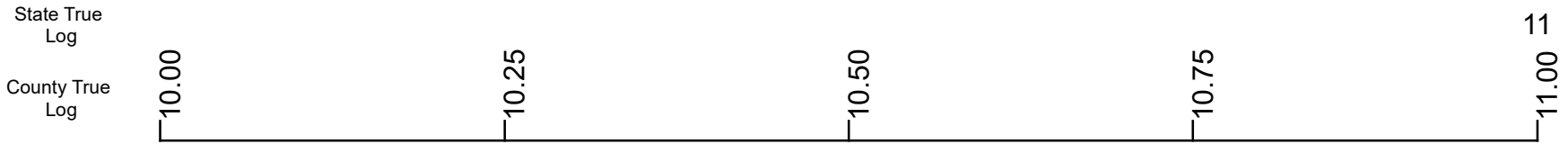

Surface Type & Width (Left / Right)	G (18/6') 9.923 - 11.512
Base Type (Left / Right)	R / L 9.923 - 12.131
Shoulder Type & Width (Left / Right)	5 (4/4') 7.004 - 12.51
Through Lanes	2 7.004 - 12.51
Street Name	SR 430 7.004 - 12.51

<ul style="list-style-type: none"> <li> Non-divided Highway</li> <li> Divided Highway</li> <li> Secondary Segment</li> <li> Corporation</li> </ul>	<ul style="list-style-type: none"> <li> Bridge (on route)</li> <li> Underpass</li> <li> Overpass</li> </ul>	<ul style="list-style-type: none"> <li> Railroad (at grade)</li> <li> Railroad (underpass)</li> <li> Railroad (overpass)</li> </ul>	<ul style="list-style-type: none"> <li> Intersection</li> </ul>
--	---	---	---

Created on: 7/8/2025

transportation.ohio.gov

Prepared by  
The Ohio Department of Transportation  
Office of Technical Services  
Roadway Information

# SRICSR00430\*\*C

State True Log  
County True Log

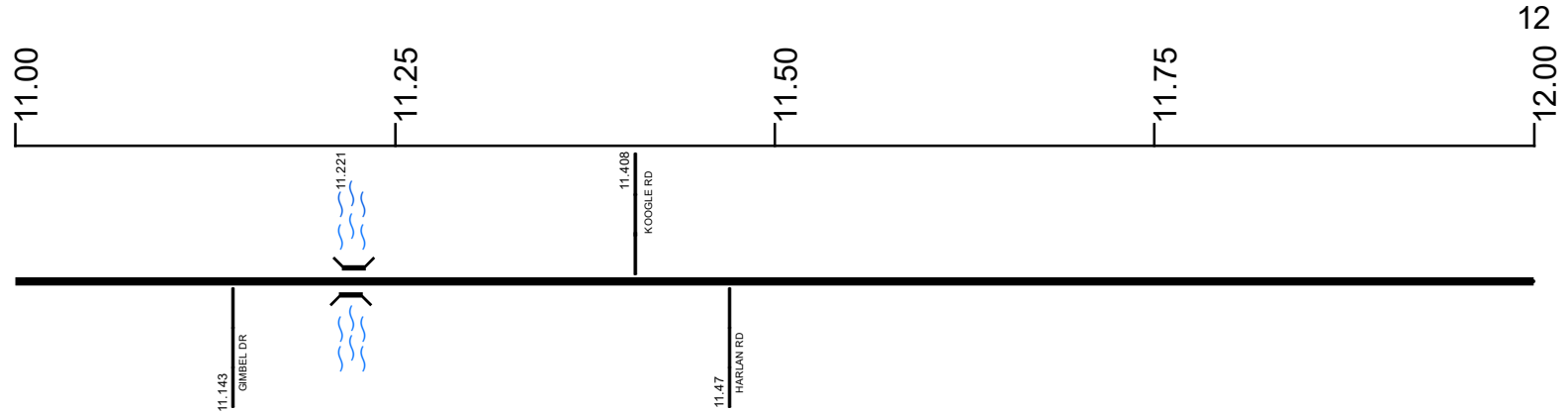

**Surface Type & Width (Left / Right)**

G (18'/6')	G (20'/4')
9.923 - 11.512	11.512 - 12.51

**Base Type (Left / Right)**

R / L	
9.923 - 12.131	

**Shoulder Type & Width (Left / Right)**

5 (4'/4')	
7.004 - 12.51	

**Through Lanes**

2	
7.004 - 12.51	

**Street Name**

SR 430	
7.004 - 12.51	

- Non-divided Highway
- Divided Highway
- Secondary Segment
- Corporation
- Bridge (on route)
- Underpass
- Overpass
- Railroad (at grade)
- Railroad (underpass)
- Railroad (overpass)
- Intersection

Created on: 7/8/2025

transportation.ohio.gov

Prepared by  
The Ohio Department of Transportation  
Office of Technical Services  
Roadway Information

# SRICSR00430\*\*C

State True  
Log

County True  
Log



**Surface Type & Width (Left / Right)**

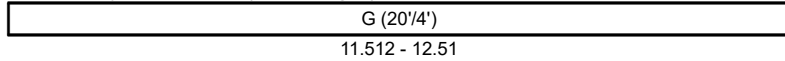

**Base Type (Left / Right)**

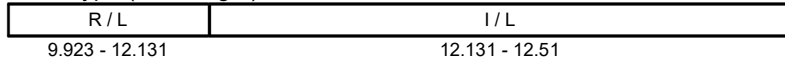

**Shoulder Type & Width (Left / Right)**

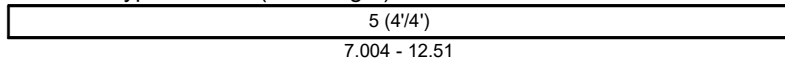

**Through Lanes**

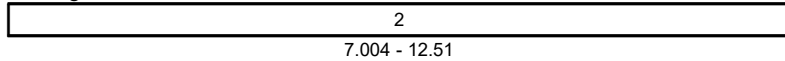

**Street Name**

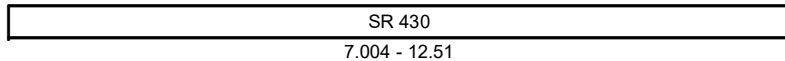

- |                     |                   |                      |              |
|---------------------|-------------------|----------------------|--------------|
| Non-divided Highway | Bridge (on route) | Railroad (at grade)  | Intersection |
| Divided Highway     | Underpass         | Railroad (underpass) |              |
| Secondary Segment   | Overpass          | Railroad (overpass)  |              |
| <b>Corporation</b>  |                   |                      |              |

Created on: 7/8/2025

## Historical Project List for SRICSR00430\*\*C

Begin Measure	End Measure	Project ID Number	Construction Completion Date	Treatment Category	Treatment Type
0.000	2.191	101442	6-2021	Minor Rehabilitation	60-AC Overlay w/Rpr
0.000	2.191	81300	11-2011	Minor Rehabilitation	50-AC Overlay w/o Rpr
2.191	5.413	88728	5-2016	Minor Rehabilitation	60-AC Overlay w/Rpr
5.689	6.011	98571	12-2018	Minor Rehabilitation	60-AC Overlay w/Rpr
10.110	12.509	115132	10-2023	Preventive Maintenance	25-Chip Seal
10.112	12.510	88809	8-2016	Minor Rehabilitation	60-AC Overlay w/Rpr
10.132	12.510	78306	9-2005	Minor Rehabilitation	38-Fine Poly AC Overlay

# Roadway Codes

## Access Control Journalized

- F - Full Access Control
- L - Limited Access Control
- N - No Access Control

## Access Control Operational

- 1 - Full Access Control
- 2 - Partial Access Control
- 3 - No Access Control

## Base Type

- F - Crack and Seat
- H - Rubblize and Roll
- I - Aggregate Base 304 or Traffic Compacted
- K - Water Bound Macadam
- L - Bituminous Concrete Mix or Penetration Macadam
- N - Plain Concrete
- P - Reinforced Concrete
- R - Brick (Flexible)
- T - Brick (Rigid)

## Direction of Travel

- B - Both (Two-way)
- F - One-way Cardinal
- T - One-way Non-cardinal

## Facility Type

- 1 - One-way Roadway
- 2 - Two-way Roadway
- 4 - Ramp
- 5 - Non-mainline
- 6 - Non-inventory Direction
- 7 - Planned / Unbuilt

## Historical Federal Aid Indicator

- N - Not a FAP Route
- Y - FAP Route

## Functional Classification

- 01 - Interstate
- 02 - Principal Arterial (Freeways)
- 03 - Principal Arterial (Other)
- 04 - Minor Arterial
- 05 - Major Collector
- 06 - Minor Collector
- 07 - Local

## Leave / Reenter Indicator

- Y - Route leaves/reenters at this point
- N - Route does not leave/reenter at this point

## Median Type

- 1 - None
- 2 - Unprotected
- 3 - Curbed
- 4 - Positive Barrier (Unspecified)
- 5 - Positive Barrier (Flexible)
- 6 - Positive Barrier (Semi-rigid)
- 7 - Positive Barrier (Rigid)

## NHS

- N - National Highway System
- H - Congressional Corridor
- 2 - Major Airport
- 3 - Major Port Facility
- 4 - Major Amtrak Station
- 5 - Major Rail / Truck Terminal
- 6 - Major Intercity Bus Terminal
- 7 - Major Public Transit / Multi-modal Passenger Terminal
- 8 - Major Pipeline Terminal
- 9 - Major Ferry Terminal

## Priority System

- G - General
- P - Priority System
- U - Urban

## Scenic Byway Code

- A - All American Road
- N - National Scenic Byway
- S - State Scenic Byway

## Shoulder Type

- 1 - None
- 2 - Surfaced shoulder exists (bituminous concrete {AC})
- 3 - Surfaced shoulder exists (Portland Cement Concrete {PCC})
- 4 - Stabilized shoulder exists (gravel or other granular material)
- 5 - Combination shoulder exists (two or more surface types)
- 6 - Earth shoulder exists
- 7 - Barrier curb exists; no shoulder in front of curb

## Surface Type

- A - Combination
- B - Brick
- C - Continuous Reinforced Concrete
- D - Reinforced Concrete
- E - Plain Concrete
- G - Bituminous Concrete
- I - Chipseal on Granular
- K - Open Graded Bituminous
- L - Chipseal or Micro
- M - Gravel
- U - Unimproved
- X - Right of Way Only