

SRICSR00546**C

State True Log 2.131

3.131

County True Log

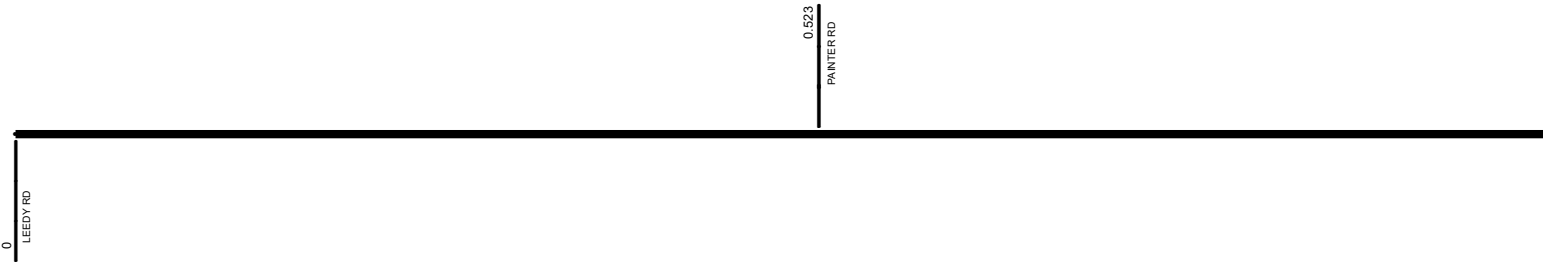

Surface Type & Width (Left / Right)

G (9'/10')
0 - 4.824

Base Type (Left / Right)

I
0 - 4.824

Shoulder Type & Width (Left / Right)

2 (3'/3')
0 - 4.824

Through Lanes

2
0 - 9.277

Street Name

SR 546
0 - 8.745

- | | | | |
|---------------------|-------------------|----------------------|--------------|
| Non-divided Highway | Bridge (on route) | Railroad (at grade) | Intersection |
| Divided Highway | Underpass | Railroad (underpass) | |
| Secondary Segment | Overpass | Railroad (overpass) | |
| Corporation | | | |

Created on: 7/8/2025

transportation.ohio.gov

Prepared by
The Ohio Department of Transportation
Office of Technical Services
Roadway Information

SRICSR00546**C

State True Log

4.131

County True Log

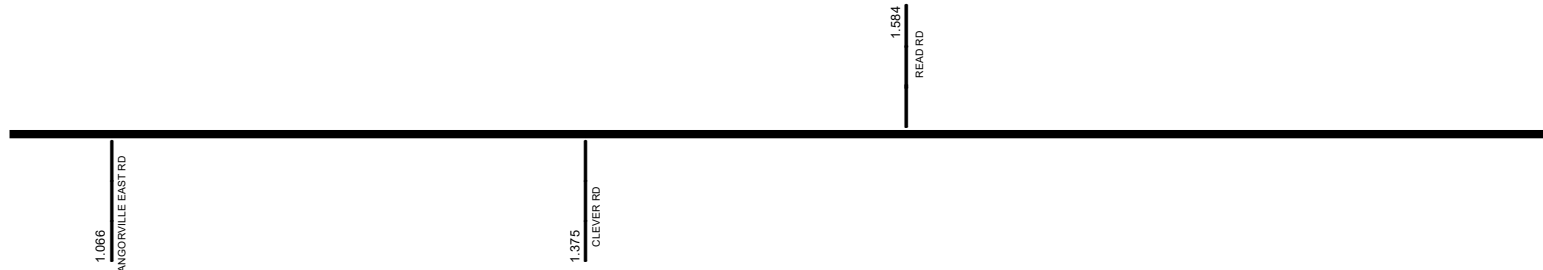

Surface Type & Width (Left / Right)

	G (9'/10')
	0 - 4.824

Base Type (Left / Right)

	I
	0 - 4.824

Shoulder Type & Width (Left / Right)

	2 (3'/3')
	0 - 4.824

Through Lanes

	2
	0 - 9.277

Street Name

	SR 546
	0 - 8.745

- | | | | |
|--|---|---|---|
| <ul style="list-style-type: none"> Non-divided Highway Divided Highway Secondary Segment Corporation | <ul style="list-style-type: none"> Bridge (on route) Underpass Overpass | <ul style="list-style-type: none"> Railroad (at grade) Railroad (underpass) Railroad (overpass) | <ul style="list-style-type: none"> Intersection |
|--|---|---|---|

Created on: 7/8/2025

transportation.ohio.gov

Prepared by
The Ohio Department of Transportation
Office of Technical Services
Roadway Information

SRICSR00546**C

State True Log

5.131

County True Log

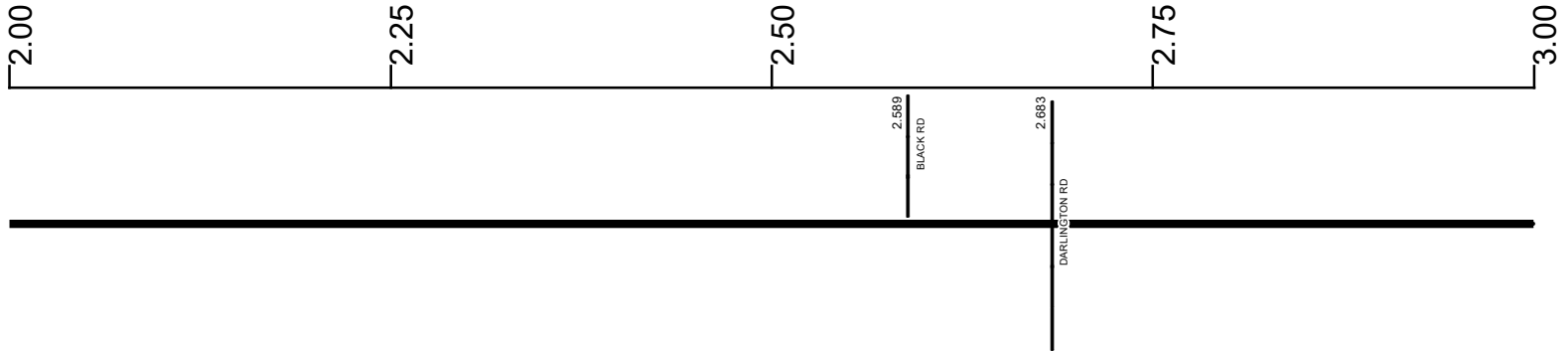

Surface Type & Width (Left / Right)

	G (9'/10')
	0 - 4.824

Base Type (Left / Right)

	I
	0 - 4.824

Shoulder Type & Width (Left / Right)

	2 (3'/3')
	0 - 4.824

Through Lanes

	2
	0 - 9.277

Street Name

	SR 546
	0 - 8.745

- | | | | |
|--|---|---|---|
| <ul style="list-style-type: none"> Non-divided Highway Divided Highway Secondary Segment Corporation | <ul style="list-style-type: none"> Bridge (on route) Underpass Overpass | <ul style="list-style-type: none"> Railroad (at grade) Railroad (underpass) Railroad (overpass) | <ul style="list-style-type: none"> Intersection |
|--|---|---|---|

Created on: 7/8/2025

transportation.ohio.gov

Prepared by
The Ohio Department of Transportation
Office of Technical Services
Roadway Information

SRICSR00546**C

State True Log

6.131

County True Log

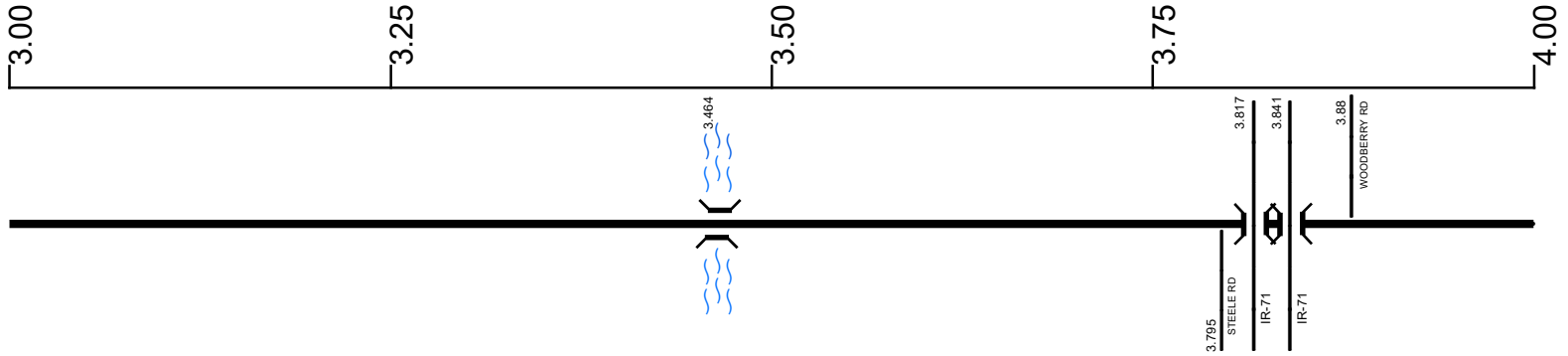

Surface Type & Width (Left / Right)	G (9'/10')	0 - 4.824
Base Type (Left / Right)	I	0 - 4.824
Shoulder Type & Width (Left / Right)	2 (3'/3')	0 - 4.824
Through Lanes	2	0 - 9.277
Street Name	SR 546	0 - 8.745

- | | | | |
|---------------------|-------------------|----------------------|--------------|
| Non-divided Highway | Bridge (on route) | Railroad (at grade) | Intersection |
| Divided Highway | Underpass | Railroad (underpass) | |
| Secondary Segment | Overpass | Railroad (overpass) | |
| Corporation | | | |

Created on: 7/8/2025

transportation.ohio.gov

Prepared by
The Ohio Department of Transportation
Office of Technical Services
Roadway Information

SRICSR00546**C

State True Log

7.131

County True Log

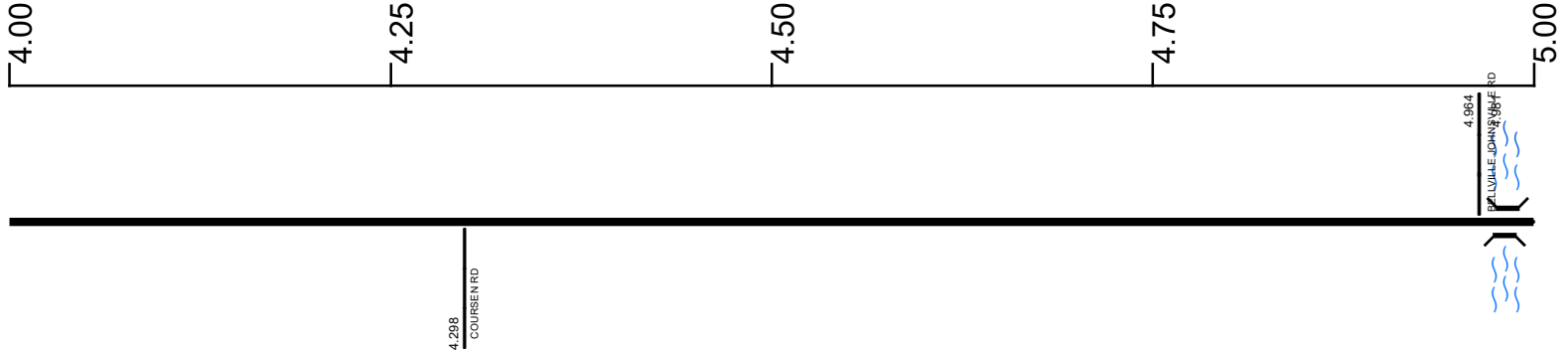

Surface Type & Width (Left / Right)

	G (9'/10')	G 20'
	0 - 4.824	4.824 - 5.15

Base Type (Left / Right)

	I	L
	0 - 4.824	4.824 - 5.15

Shoulder Type & Width (Left / Right)

	2 (3'/3')	2 (6'/6')
	0 - 4.824	4.824 - 5.15

Through Lanes

	2	
	0 - 9.277	

Street Name

	SR 546	
	0 - 8.745	

- Non-divided Highway
- Divided Highway
- Secondary Segment
- Corporation
- Bridge (on route)
- Underpass
- Overpass
- Railroad (at grade)
- Railroad (underpass)
- Railroad (overpass)
- Intersection

Created on: 7/8/2025

transportation.ohio.gov

Prepared by
The Ohio Department of Transportation
Office of Technical Services
Roadway Information

SRICSR00546**C

State True Log

8.131

County True Log

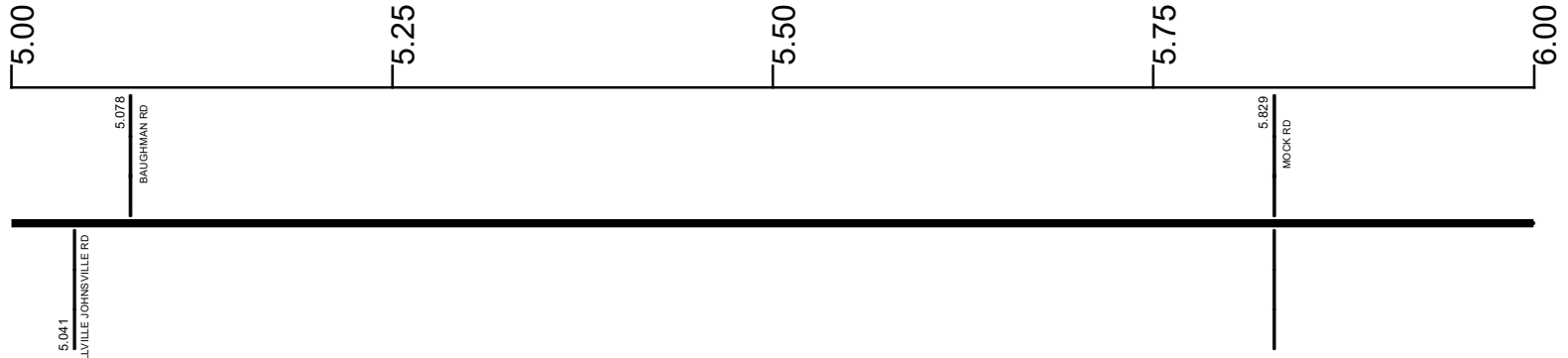

Surface Type & Width (Left / Right)

G 20' 4.824 - 5.15	G (9'/10') 5.15 - 8.745
-----------------------	----------------------------

Base Type (Left / Right)

L 4.824 - 5.15	K 5.15 - 8.777
-------------------	-------------------

Shoulder Type & Width (Left / Right)

2 (6'/6') 4.824 - 5.15	2 (3'/3') 5.15 - 8.777
---------------------------	---------------------------

Through Lanes

	2 0 - 9.277
--	----------------

Street Name

	SR 546 0 - 8.745
--	---------------------

- Non-divided Highway
- Divided Highway
- Secondary Segment
- Corporation
- Bridge (on route)
- Underpass
- Overpass
- Railroad (at grade)
- Railroad (underpass)
- Railroad (overpass)
- Intersection

Created on: 7/8/2025

transportation.ohio.gov

Prepared by
The Ohio Department of Transportation
Office of Technical Services
Roadway Information

SRICSR00546**C

State True Log

9.131

County True Log

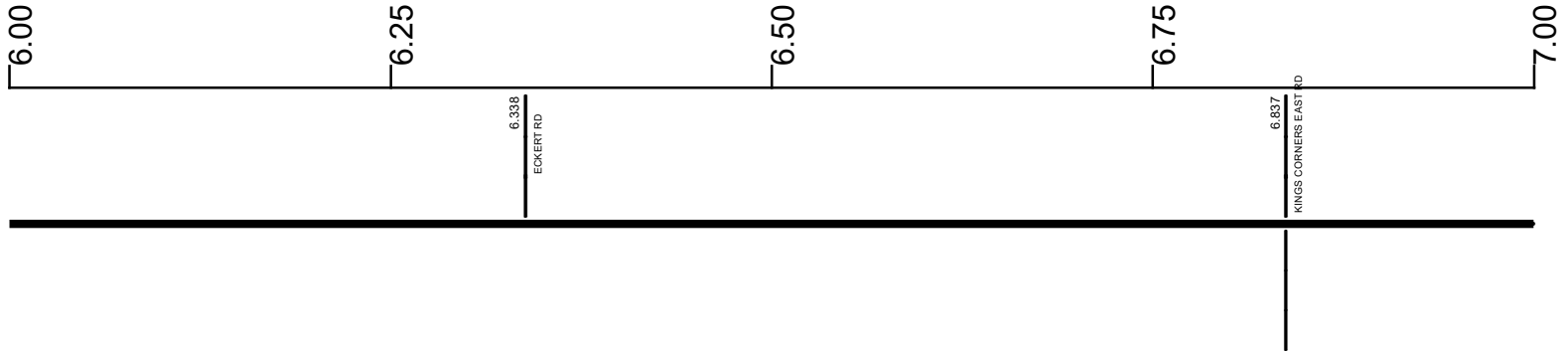

Surface Type & Width (Left / Right)

G (9'/10')
5.15 - 8.745

Base Type (Left / Right)

K
5.15 - 8.777

Shoulder Type & Width (Left / Right)

2 (3'/3')
5.15 - 8.777

Through Lanes

2
0 - 9.277

Street Name

SR 546
0 - 8.745

- | | | | |
|---------------------|-------------------|----------------------|--------------|
| Non-divided Highway | Bridge (on route) | Railroad (at grade) | Intersection |
| Divided Highway | Underpass | Railroad (underpass) | |
| Secondary Segment | Overpass | Railroad (overpass) | |
| Corporation | | | |

Created on: 7/8/2025

transportation.ohio.gov

Prepared by
The Ohio Department of Transportation
Office of Technical Services
Roadway Information

SRICSR00546**C

State True Log

10.131

County True Log

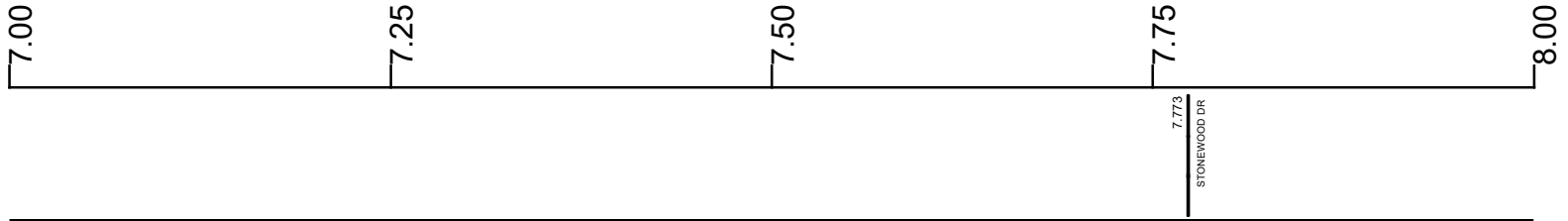

Surface Type & Width (Left / Right)

G (9'/10')
5.15 - 8.745

Base Type (Left / Right)

K
5.15 - 8.777

Shoulder Type & Width (Left / Right)

2 (3'/3')
5.15 - 8.777

Through Lanes

2
0 - 9.277

Street Name

SR 546
0 - 8.745

- | | | | |
|---------------------|-------------------|----------------------|--------------|
| Non-divided Highway | Bridge (on route) | Railroad (at grade) | Intersection |
| Divided Highway | Underpass | Railroad (underpass) | |
| Secondary Segment | Overpass | Railroad (overpass) | |
| Corporation | | | |

Created on: 7/8/2025

transportation.ohio.gov

Prepared by
The Ohio Department of Transportation
Office of Technical Services
Roadway Information

SRICSR00546**C

State True Log

11.131

County True Log

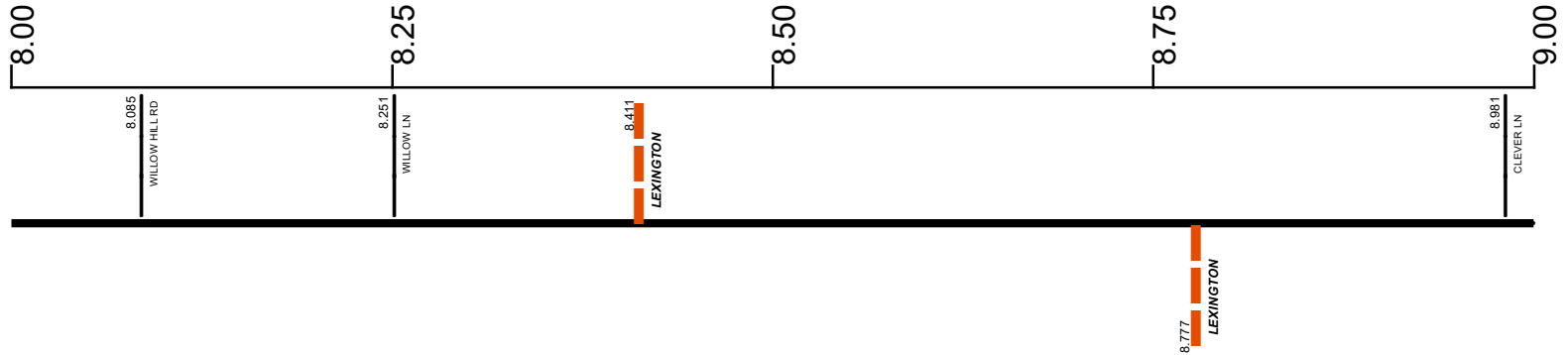

Surface Type & Width (Left / Right)

G (9'/10')	G 20'	G (17'/19')
5.15 - 8.745	8.745 - 8.777	8.777 - 9.277

Base Type (Left / Right)

K	K / I
5.15 - 8.777	8.777 - 9.277

Shoulder Type & Width (Left / Right)

2 (3'/3')	2 (1'/1')
5.15 - 8.777	8.777 - 9.277

Through Lanes

2	2
0 - 9.277	

Street Name

SR 546	FEDERICK ST
0 - 8.745	8.745 - 9.277

- Non-divided Highway
- Divided Highway
- Secondary Segment
- Corporation
- Bridge (on route)
- Underpass
- Overpass
- Railroad (at grade)
- Railroad (underpass)
- Railroad (overpass)
- Intersection

Created on: 7/8/2025

transportation.ohio.gov

Prepared by
The Ohio Department of Transportation
Office of Technical Services
Roadway Information

SRICSR00546**C

State True Log

11.408

County True Log

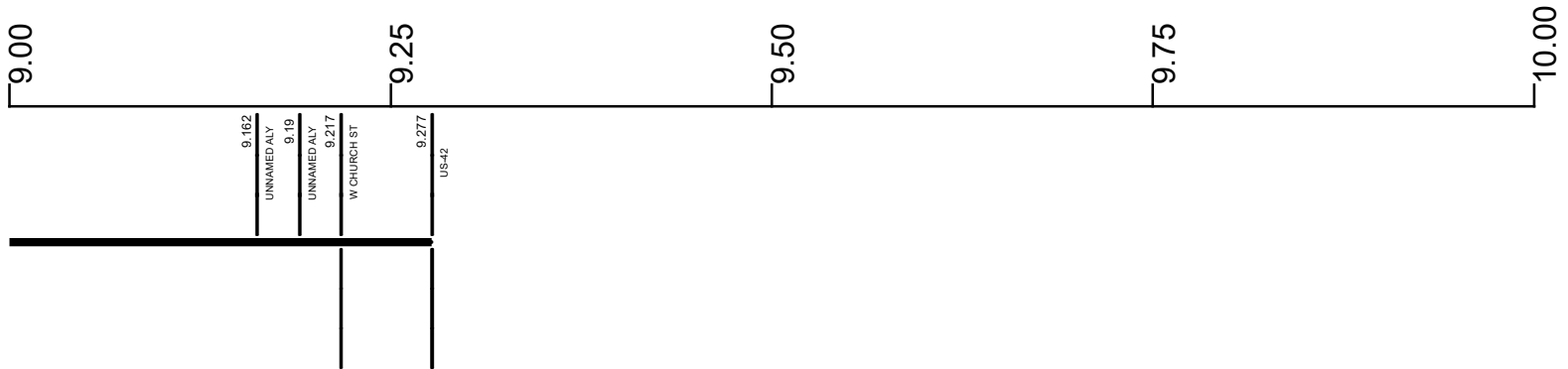

Surface Type & Width (Left / Right)	G (17'/19')	8.777 - 9.277
Base Type (Left / Right)	K / I	8.777 - 9.277
Shoulder Type & Width (Left / Right)	2 (1'/1')	8.777 - 9.277
Through Lanes	2	0 - 9.277
Street Name	FEDERICK ST	8.745 - 9.277

Non-divided Highway	Bridge (on route)	Railroad (at grade)	Intersection
Divided Highway	Underpass	Railroad (underpass)	
Secondary Segment	Overpass	Railroad (overpass)	
Corporation			

Created on: 7/8/2025



transportation.ohio.gov
 Prepared by
 The Ohio Department of Transportation
 Office of Technical Services
 Roadway Information

Historical Project List for SRICSR00546**C

Begin Measure	End Measure	Project ID Number	Construction Completion Date	Treatment Category	Treatment Type
0.000	8.678	98488	9-2017	Preventive Maintenance	25-Chip Seal
0.000	8.698	80180	5-2011	Minor Rehabilitation	60-AC Overlay w/Rpr
8.678	9.277	98488	9-2017	Minor Rehabilitation	60-AC Overlay w/Rpr
8.698	9.277	78314	9-2007	Minor Rehabilitation	38-Fine Poly AC Overlay

Roadway Codes

Access Control Journalized

- F - Full Access Control
- L - Limited Access Control
- N - No Access Control

Access Control Operational

- 1 - Full Access Control
- 2 - Partial Access Control
- 3 - No Access Control

Base Type

- F - Crack and Seat
- H - Rubblize and Roll
- I - Aggregate Base 304 or Traffic Compacted
- K - Water Bound Macadam
- L - Bituminous Concrete Mix or Penetration Macadam
- N - Plain Concrete
- P - Reinforced Concrete
- R - Brick (Flexible)
- T - Brick (Rigid)

Direction of Travel

- B - Both (Two-way)
- F - One-way Cardinal
- T - One-way Non-cardinal

Facility Type

- 1 - One-way Roadway
- 2 - Two-way Roadway
- 4 - Ramp
- 5 - Non-mainline
- 6 - Non-inventory Direction
- 7 - Planned / Unbuilt

Historical Federal Aid Indicator

- N - Not a FAP Route
- Y - FAP Route

Functional Classification

- 01 - Interstate
- 02 - Principal Arterial (Freeways)
- 03 - Principal Arterial (Other)
- 04 - Minor Arterial
- 05 - Major Collector
- 06 - Minor Collector
- 07 - Local

Leave / Reenter Indicator

- Y - Route leaves/reenters at this point
- N - Route does not leave/reenter at this point

Median Type

- 1 - None
- 2 - Unprotected
- 3 - Curbed
- 4 - Positive Barrier (Unspecified)
- 5 - Positive Barrier (Flexible)
- 6 - Positive Barrier (Semi-rigid)
- 7 - Positive Barrier (Rigid)

NHS

- N - National Highway System
- H - Congressional Corridor
- 2 - Major Airport
- 3 - Major Port Facility
- 4 - Major Amtrak Station
- 5 - Major Rail / Truck Terminal
- 6 - Major Intercity Bus Terminal
- 7 - Major Public Transit / Multi-modal Passenger Terminal
- 8 - Major Pipeline Terminal
- 9 - Major Ferry Terminal

Priority System

- G - General
- P - Priority System
- U - Urban

Scenic Byway Code

- A - All American Road
- N - National Scenic Byway
- S - State Scenic Byway

Shoulder Type

- 1 - None
- 2 - Surfaced shoulder exists (bituminous concrete {AC})
- 3 - Surfaced shoulder exists (Portland Cement Concrete {PCC})
- 4 - Stabilized shoulder exists (gravel or other granular material)
- 5 - Combination shoulder exists (two or more surface types)
- 6 - Earth shoulder exists
- 7 - Barrier curb exists; no shoulder in front of curb

Surface Type

- A - Combination
- B - Brick
- C - Continuous Reinforced Concrete
- D - Reinforced Concrete
- E - Plain Concrete
- G - Bituminous Concrete
- I - Chipseal on Granular
- K - Open Graded Bituminous
- L - Chipseal or Micro
- M - Gravel
- U - Unimproved
- X - Right of Way Only