

SSCISR00348**C

State True Log 13.553

14.553

County True Log



Surface Type & Width (Left / Right)	G 18' 0 - 5.019
Base Type (Left / Right)	I 0 - 6.243
Shoulder Type & Width (Left / Right)	2 (2/2) 0 - 6.243
Through Lanes	2 0 - 6.243
Street Name	SR 348 0 - 6.243

<ul style="list-style-type: none"> Non-divided Highway Divided Highway Secondary Segment Corporation 	<ul style="list-style-type: none"> Bridge (on route) Underpass Overpass 	<ul style="list-style-type: none"> Railroad (at grade) Railroad (underpass) Railroad (overpass) 	<ul style="list-style-type: none"> Intersection
--	---	---	---

Created on: 7/8/2025

transportation.ohio.gov

Prepared by
The Ohio Department of Transportation
Office of Technical Services
Roadway Information

SSCISR00348**C

State True Log

15.553

County True Log

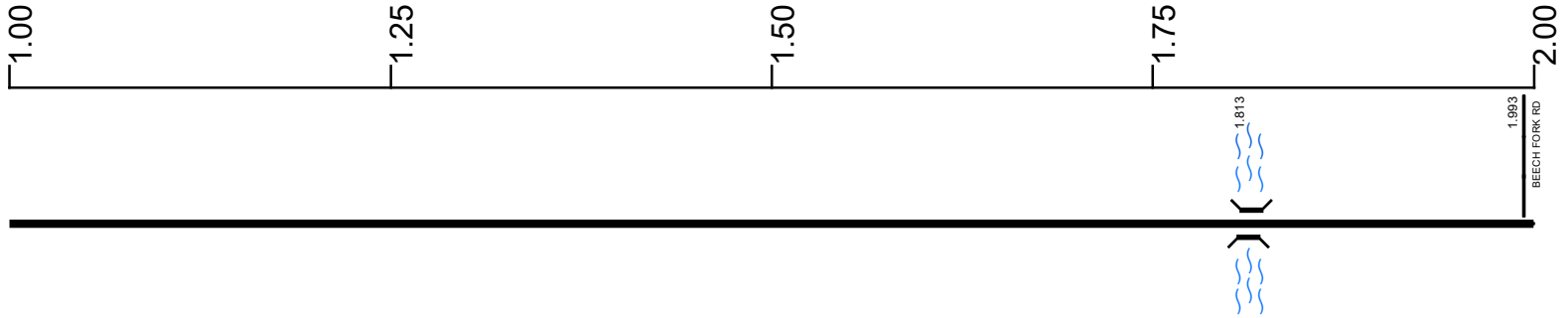

Surface Type & Width (Left / Right)

	G 18'
	0 - 5.019

Base Type (Left / Right)

	I
	0 - 6.243

Shoulder Type & Width (Left / Right)

	2 (2'/2')
	0 - 6.243

Through Lanes

	2
	0 - 6.243

Street Name

	SR 348
	0 - 6.243

- | | | | |
|---------------------|-------------------|----------------------|--------------|
| Non-divided Highway | Bridge (on route) | Railroad (at grade) | Intersection |
| Divided Highway | Underpass | Railroad (underpass) | |
| Secondary Segment | Overpass | Railroad (overpass) | |
| Corporation | | | |

Created on: 7/8/2025

transportation.ohio.gov

Prepared by
The Ohio Department of Transportation
Office of Technical Services
Roadway Information

SSCISR00348**C

State True Log

16.553

County True Log

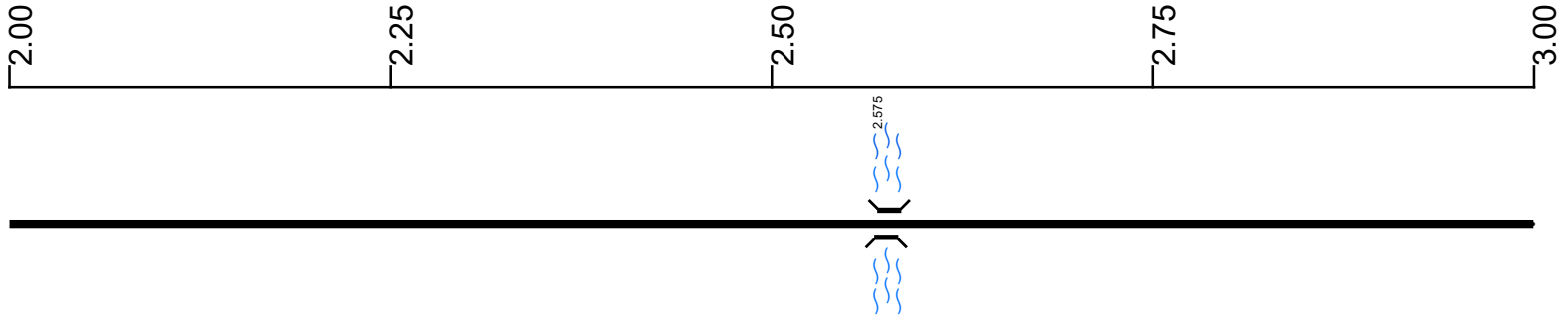

Surface Type & Width (Left / Right)

	G 18'
	0 - 5.019

Base Type (Left / Right)

	I
	0 - 6.243

Shoulder Type & Width (Left / Right)

	2 (2'/2')
	0 - 6.243

Through Lanes

	2
	0 - 6.243

Street Name

	SR 348
	0 - 6.243

- | | | | |
|--|---|---|---|
| <ul style="list-style-type: none"> Non-divided Highway Divided Highway Secondary Segment Corporation | <ul style="list-style-type: none"> Bridge (on route) Underpass Overpass | <ul style="list-style-type: none"> Railroad (at grade) Railroad (underpass) Railroad (overpass) | <ul style="list-style-type: none"> Intersection |
|--|---|---|---|

Created on: 7/8/2025

transportation.ohio.gov

Prepared by
The Ohio Department of Transportation
Office of Technical Services
Roadway Information

SSCISR00348**C

State True Log

17.553

County True Log

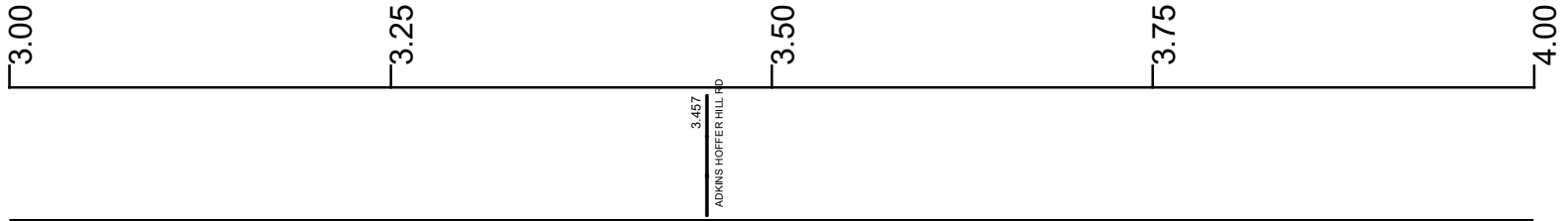

Surface Type & Width (Left / Right)

G 18'
0 - 5.019

Base Type (Left / Right)

I
0 - 6.243

Shoulder Type & Width (Left / Right)

2 (2'/2)
0 - 6.243

Through Lanes

2
0 - 6.243

Street Name

SR 348
0 - 6.243

- | | | | |
|---------------------|-------------------|----------------------|--------------|
| Non-divided Highway | Bridge (on route) | Railroad (at grade) | Intersection |
| Divided Highway | Underpass | Railroad (underpass) | |
| Secondary Segment | Overpass | Railroad (overpass) | |
| Corporation | | | |

Created on: 7/8/2025

transportation.ohio.gov

Prepared by
The Ohio Department of Transportation
Office of Technical Services
Roadway Information

SSCISR00348**C

State True Log

18.553

County True Log

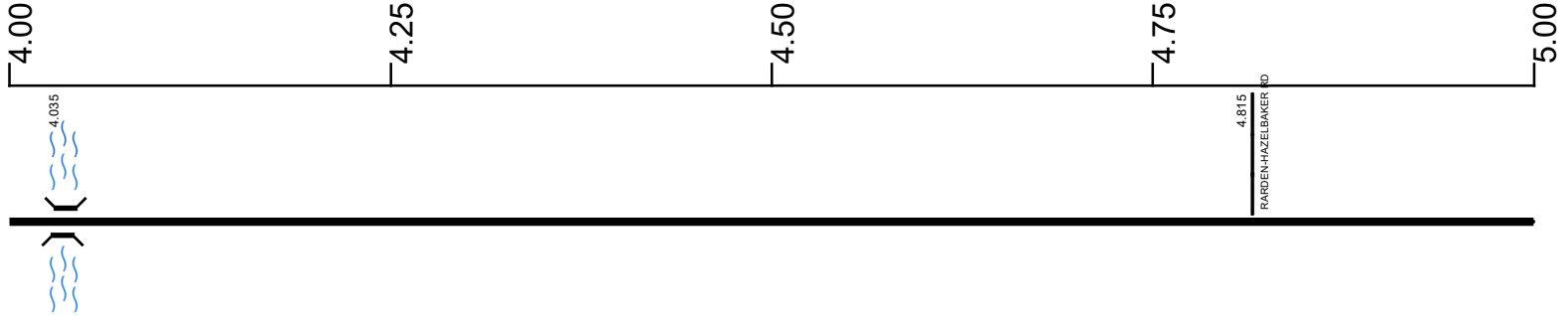

Surface Type & Width (Left / Right)

G 18'
0 - 5.019

Base Type (Left / Right)

I
0 - 6.243

Shoulder Type & Width (Left / Right)

2 (2/2)
0 - 6.243

Through Lanes

2
0 - 6.243

Street Name

SR 348
0 - 6.243

- Non-divided Highway
 Bridge (on route)
 Railroad (at grade)
 Intersection
- Divided Highway
 Underpass
 Railroad (underpass)
- Secondary Segment
 Overpass
 Railroad (overpass)
- Corporation**

Created on: 7/8/2025

transportation.ohio.gov

Prepared by
The Ohio Department of Transportation
Office of Technical Services
Roadway Information

SSCISR00348**C

State True Log

19.553

County True Log

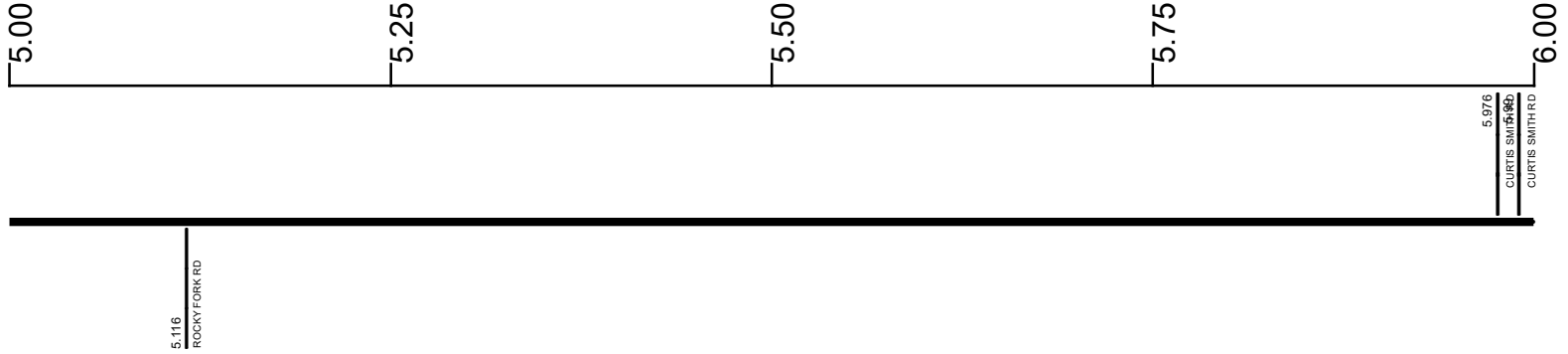

Surface Type & Width (Left / Right)

G 18'	G 20'
0 - 5.019	5.019 - 6.243

Base Type (Left / Right)

	I
	0 - 6.243

Shoulder Type & Width (Left / Right)

	2 (2'/2')
	0 - 6.243

Through Lanes

	2
	0 - 6.243

Street Name

	SR 348
	0 - 6.243

- Non-divided Highway
 Bridge (on route)
 Railroad (at grade)
 Intersection
- Divided Highway
 Underpass
 Railroad (underpass)
- Secondary Segment
 Overpass
 Railroad (overpass)
- Corporation**

Created on: 7/8/2025

transportation.ohio.gov

Prepared by
The Ohio Department of Transportation
Office of Technical Services
Roadway Information

SSCISR00348**C

State True Log

20.553

County True Log

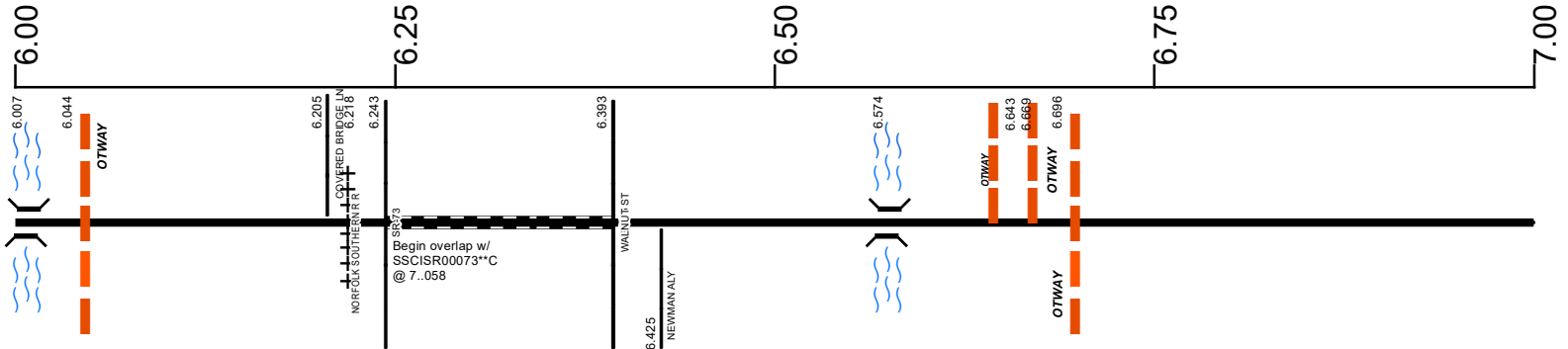

Surface Type & Width (Left / Right)	G 20'
	5.019 - 6.243
Base Type (Left / Right)	I
	0 - 6.243
Shoulder Type & Width (Left / Right)	2 (2'1/2')
	0 - 6.243
Through Lanes	2
	0 - 6.243
	SR 348
	0 - 6.243

Surface Type & Width (Left / Right)	G (10'/11')	G 22'
	6.393 - 6.714	6.714 - 12.817
Base Type (Left / Right)	I	
	6.393 - 12.817	
Shoulder Type & Width (Left / Right)	5 (1'1/3')	5 (1'1/1')
	6.393 - 6.574	6.574 - 12.817
Resurface Year	2021	2021
	6.554 - 6.59	6.714 - 12.817
Through Lanes	2	
	6.393 - 15.405	
Street Name	SR 348	
	6.393 - 18.707	

- Non-divided Highway
- Divided Highway
- Secondary Segment
- Corporation
- Bridge (on route)
- Underpass
- Overpass
- Railroad (at grade)
- Railroad (underpass)
- Railroad (overpass)
- Intersection

Created on: 7/8/2025



transportation.ohio.gov
 Prepared by
 The Ohio Department of Transportation
 Office of Technical Services
 Roadway Information

SSCISR00348**C

State True Log

21.553

County True Log



Surface Type & Width (Left / Right)

G 22'
6.714 - 12.817

Base Type (Left / Right)

I
6.393 - 12.817

Shoulder Type & Width (Left / Right)

5 (1/1')
6.574 - 12.817

Resurface Year

2021
6.714 - 12.817

Through Lanes

2
6.393 - 15.405

Street Name

SR 348
6.393 - 18.707

- | | | | |
|---------------------|-------------------|----------------------|--------------|
| Non-divided Highway | Bridge (on route) | Railroad (at grade) | Intersection |
| Divided Highway | Underpass | Railroad (underpass) | |
| Secondary Segment | Overpass | Railroad (overpass) | |
| Corporation | | | |

Created on: 7/8/2025

transportation.ohio.gov

Prepared by
The Ohio Department of Transportation
Office of Technical Services
Roadway Information

SSCISR00348**C

State True Log

22.553

County True Log

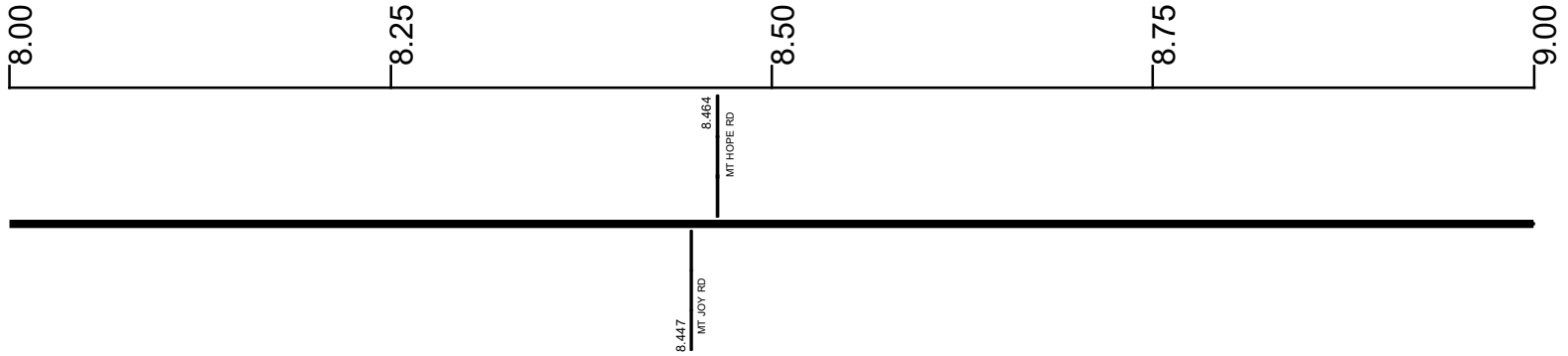

Surface Type & Width (Left / Right)

G 22'
6.714 - 12.817

Base Type (Left / Right)

I
6.393 - 12.817

Shoulder Type & Width (Left / Right)

5 (1/1')
6.574 - 12.817

Resurface Year

2021
6.714 - 12.817

Through Lanes

2
6.393 - 15.405

Street Name

SR 348
6.393 - 18.707

- | | | | |
|---------------------|-------------------|----------------------|--------------|
| Non-divided Highway | Bridge (on route) | Railroad (at grade) | Intersection |
| Divided Highway | Underpass | Railroad (underpass) | |
| Secondary Segment | Overpass | Railroad (overpass) | |
| Corporation | | | |

Created on: 7/8/2025



transportation.ohio.gov
 Prepared by
 The Ohio Department of Transportation
 Office of Technical Services
 Roadway Information

SSCISR00348**C

State True Log

23.553

County True Log

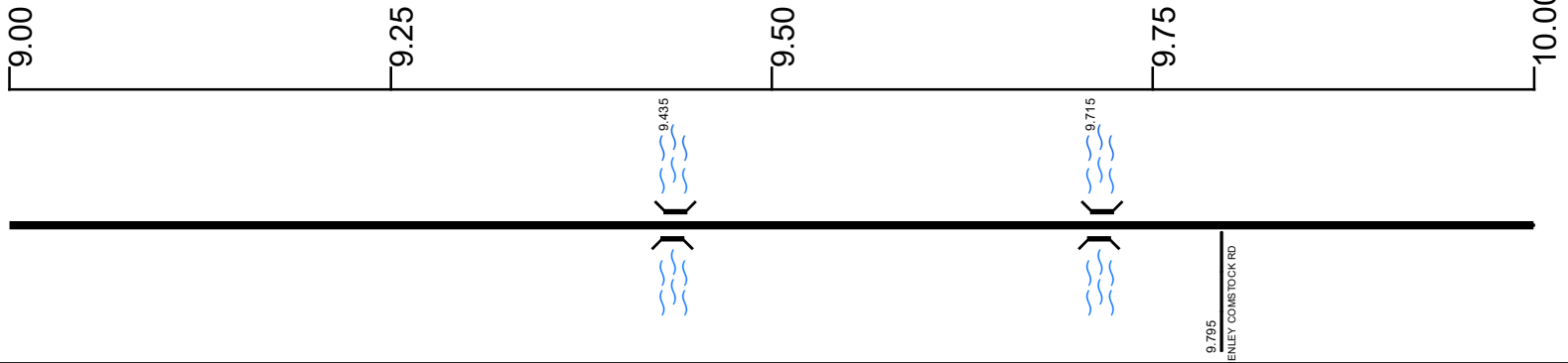

Surface Type & Width (Left / Right)	G 22' 6.714 - 12.817
Base Type (Left / Right)	I 6.393 - 12.817
Shoulder Type & Width (Left / Right)	5 (1/1') 6.574 - 12.817
Resurface Year	2021 6.714 - 12.817
Through Lanes	2 6.393 - 15.405
Street Name	SR 348 6.393 - 18.707

- | | | | |
|---------------------|-------------------|----------------------|--------------|
| Non-divided Highway | Bridge (on route) | Railroad (at grade) | Intersection |
| Divided Highway | Underpass | Railroad (underpass) | |
| Secondary Segment | Overpass | Railroad (overpass) | |
| Corporation | | | |

Created on: 7/8/2025

transportation.ohio.gov

Prepared by
The Ohio Department of Transportation
Office of Technical Services
Roadway Information

SSCISR00348**C

State True Log

24.553

County True Log

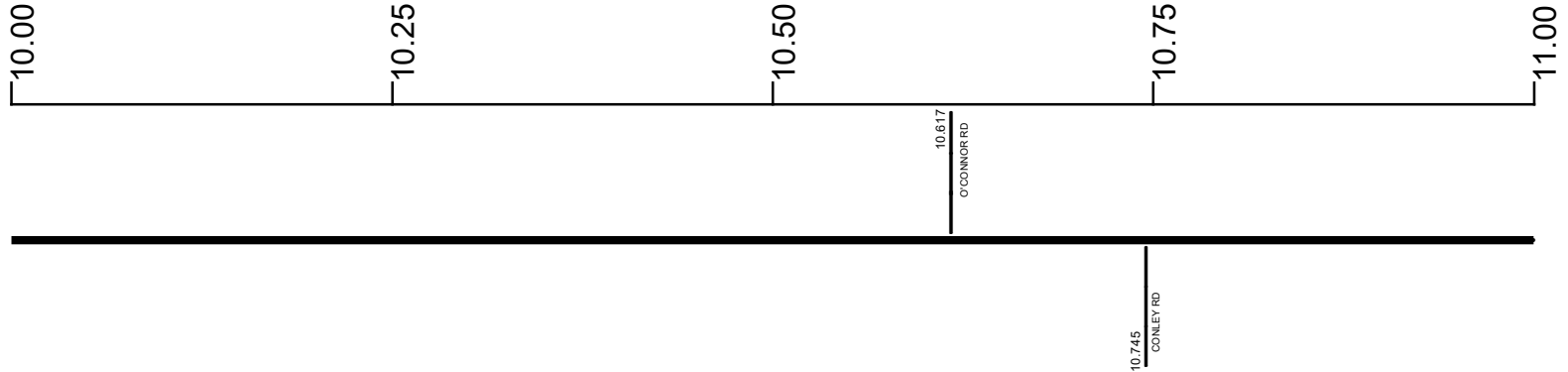

Surface Type & Width (Left / Right)

G 22'
6.714 - 12.817

Base Type (Left / Right)

I
6.393 - 12.817

Shoulder Type & Width (Left / Right)

5 (1/1')
6.574 - 12.817

Resurface Year

2021
6.714 - 12.817

Through Lanes

2
6.393 - 15.405

Street Name

SR 348
6.393 - 18.707

- | | | | |
|---------------------|-------------------|----------------------|--------------|
| Non-divided Highway | Bridge (on route) | Railroad (at grade) | Intersection |
| Divided Highway | Underpass | Railroad (underpass) | |
| Secondary Segment | Overpass | Railroad (overpass) | |
| Corporation | | | |

Created on: 7/8/2025

transportation.ohio.gov

Prepared by
The Ohio Department of Transportation
Office of Technical Services
Roadway Information

SSCISR00348**C

State True Log

25.553

County True Log

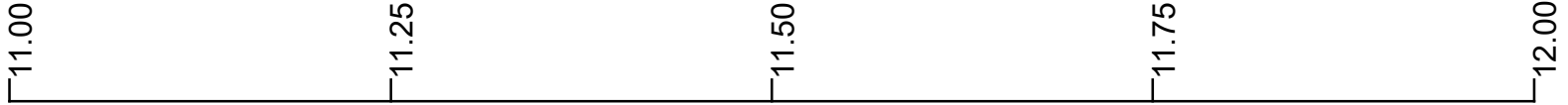

Surface Type & Width (Left / Right)	G 22' 6.714 - 12.817
Base Type (Left / Right)	I 6.393 - 12.817
Shoulder Type & Width (Left / Right)	5 (1/1') 6.574 - 12.817
Resurface Year	2021 6.714 - 12.817
Through Lanes	2 6.393 - 15.405
Street Name	SR 348 6.393 - 18.707

<ul style="list-style-type: none"> Non-divided Highway Divided Highway Secondary Segment Corporation 	<ul style="list-style-type: none"> Bridge (on route) Underpass Overpass 	<ul style="list-style-type: none"> Railroad (at grade) Railroad (underpass) Railroad (overpass) 	<ul style="list-style-type: none"> Intersection
--	---	---	---

Created on: 7/8/2025

transportation.ohio.gov

Prepared by
The Ohio Department of Transportation
Office of Technical Services
Roadway Information

SSCISR00348**C

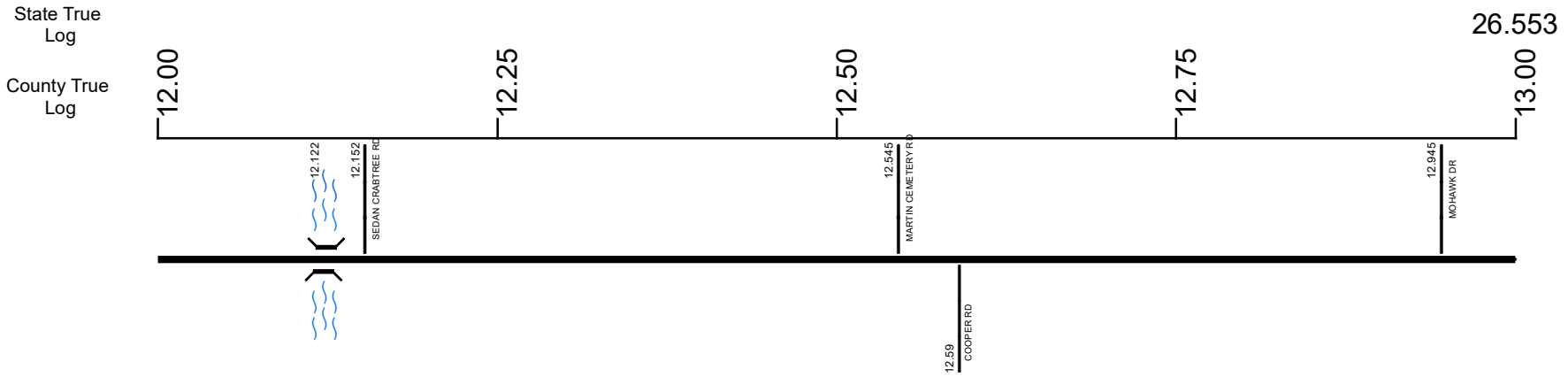

Surface Type & Width (Left / Right)	G 22' 6.714 - 12.817	G 24' 12.817 - 15.405
Base Type (Left / Right)	I 6.393 - 12.817	L 12.817 - 18.707
Shoulder Type & Width (Left / Right)	5 (1/1') 6.574 - 12.817	2 (3/3') 12.817 - 15.405
Resurface Year	2021 6.714 - 12.817	2023 12.817 - 18.707
Through Lanes	2 6.393 - 15.405	
Street Name	SR 348 6.393 - 18.707	

- Non-divided Highway
- Divided Highway
- Secondary Segment
- Corporation
- Bridge (on route)
- Underpass
- Overpass
- Railroad (at grade)
- Railroad (underpass)
- Railroad (overpass)
- Intersection

Created on: 7/8/2025



transportation.ohio.gov
 Prepared by
 The Ohio Department of Transportation
 Office of Technical Services
 Roadway Information

SSCISR00348**C

State True Log

27.553

County True Log

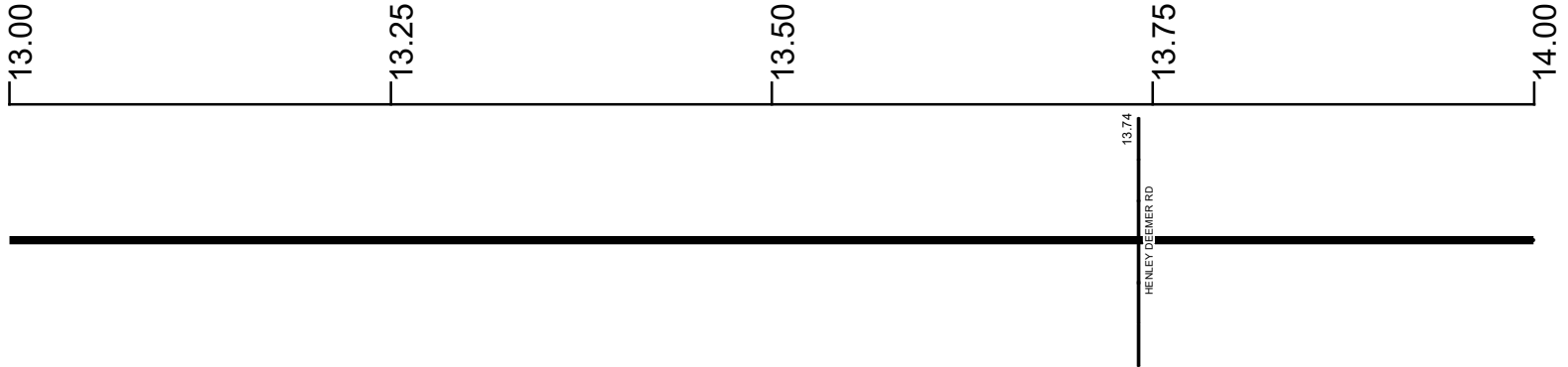

Surface Type & Width (Left / Right)

G 24'
12.817 - 15.405

Base Type (Left / Right)

L
12.817 - 18.707

Shoulder Type & Width (Left / Right)

2 (3/3)
12.817 - 15.405

Resurface Year

2023

Through Lanes

2
6.393 - 15.405

Street Name

SR 348
6.393 - 18.707

- Non-divided Highway
 Bridge (on route)
 Railroad (at grade)
 Intersection
- Divided Highway
 Underpass
 Railroad (underpass)
- Secondary Segment
 Overpass
 Railroad (overpass)
- Corporation**

Created on: 7/8/2025

transportation.ohio.gov

Prepared by
The Ohio Department of Transportation
Office of Technical Services
Roadway Information

SSCISR00348**C

State True Log

28.553

County True Log

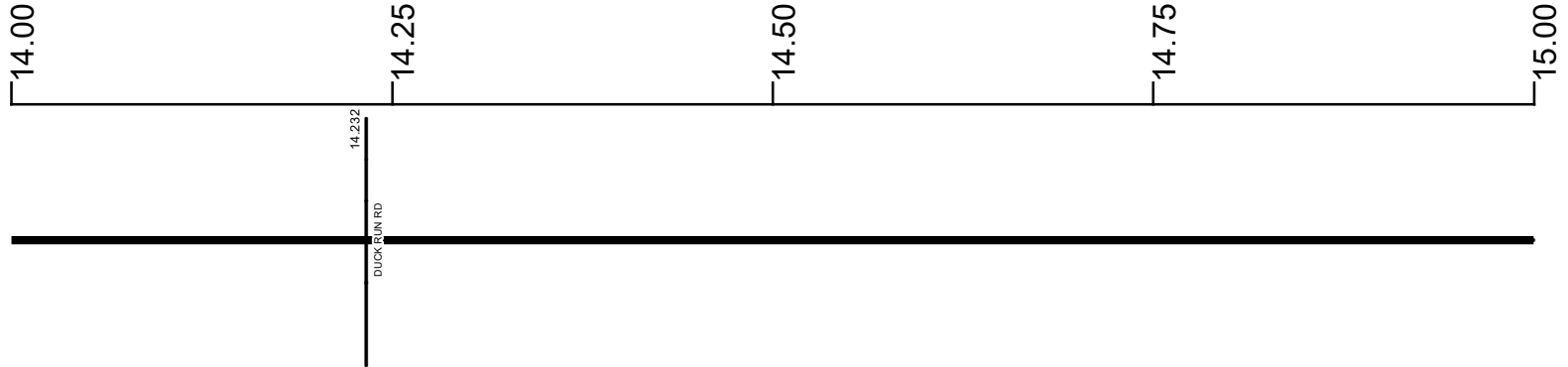

Surface Type & Width (Left / Right)

G 24'
12.817 - 15.405

Base Type (Left / Right)

L
12.817 - 18.707

Shoulder Type & Width (Left / Right)

2 (3/3)
12.817 - 15.405

Resurface Year

2023

Through Lanes

2
6.393 - 15.405

Street Name

SR 348
6.393 - 18.707

- | | | | |
|---------------------|-------------------|----------------------|--------------|
| Non-divided Highway | Bridge (on route) | Railroad (at grade) | Intersection |
| Divided Highway | Underpass | Railroad (underpass) | |
| Secondary Segment | Overpass | Railroad (overpass) | |
| Corporation | | | |

Created on: 7/8/2025

transportation.ohio.gov

Prepared by
The Ohio Department of Transportation
Office of Technical Services
Roadway Information

SSCISR00348**C

State True Log

29.553

County True Log

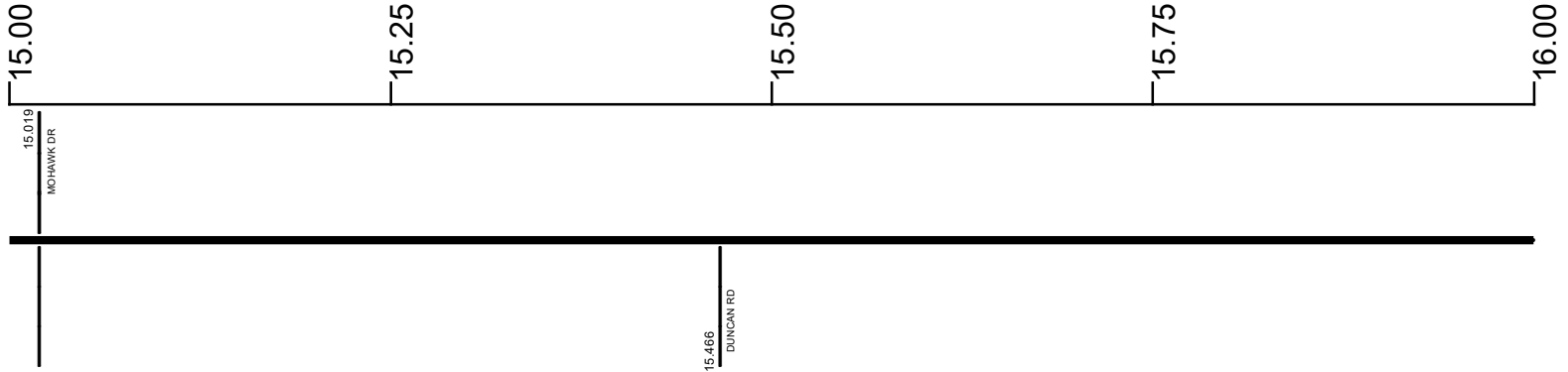

Surface Type & Width (Left / Right)	
G 24' 12.817 - 15.405	G 36' 15.405 - 16.411
Base Type (Left / Right)	
L 12.817 - 18.707	
Shoulder Type & Width (Left / Right)	
2 (3/3') 12.817 - 15.405	2 (4/4') 15.405 - 16.411
Resurface Year	
2023 12.817 - 18.707	
Through Lanes	
2 6.393 - 15.405	3 15.405 - 16.411
Street Name	
SR 348 6.393 - 18.707	

<ul style="list-style-type: none"> Non-divided Highway Divided Highway Secondary Segment Corporation 	<ul style="list-style-type: none"> Bridge (on route) Underpass Overpass 	<ul style="list-style-type: none"> Railroad (at grade) Railroad (underpass) Railroad (overpass) 	<ul style="list-style-type: none"> Intersection
--	---	---	---

Created on: 7/8/2025

transportation.ohio.gov

Prepared by
The Ohio Department of Transportation
Office of Technical Services
Roadway Information

SSCISR00348**C

State True Log

30.553

County True Log

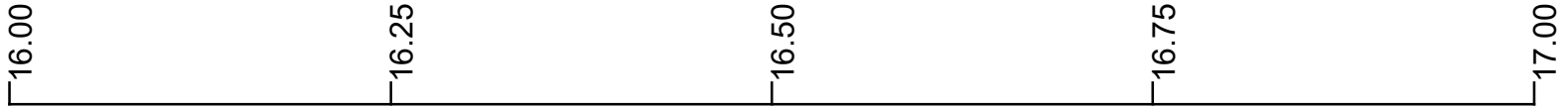

16.038
OWENSVILLE RD

Surface Type & Width (Left / Right)

G 36'	G 24'
15.405 - 16.411	16.411 - 17.292

Base Type (Left / Right)

L
12.817 - 18.707

Shoulder Type & Width (Left / Right)

2 (4'4')	2 (3'3')
15.405 - 16.411	16.411 - 18.707

Resurface Year

2023
12.817 - 18.707

Through Lanes

3	2
15.405 - 16.411	16.411 - 18.707

Street Name

SR 348
6.393 - 18.707

- | | | | |
|---------------------|-------------------|----------------------|--------------|
| Non-divided Highway | Bridge (on route) | Railroad (at grade) | Intersection |
| Divided Highway | Underpass | Railroad (underpass) | |
| Secondary Segment | Overpass | Railroad (overpass) | |
| Corporation | | | |

Created on: 7/8/2025

transportation.ohio.gov

Prepared by
The Ohio Department of Transportation
Office of Technical Services
Roadway Information

SSCISR00348**C

State True Log
County True Log

31.553

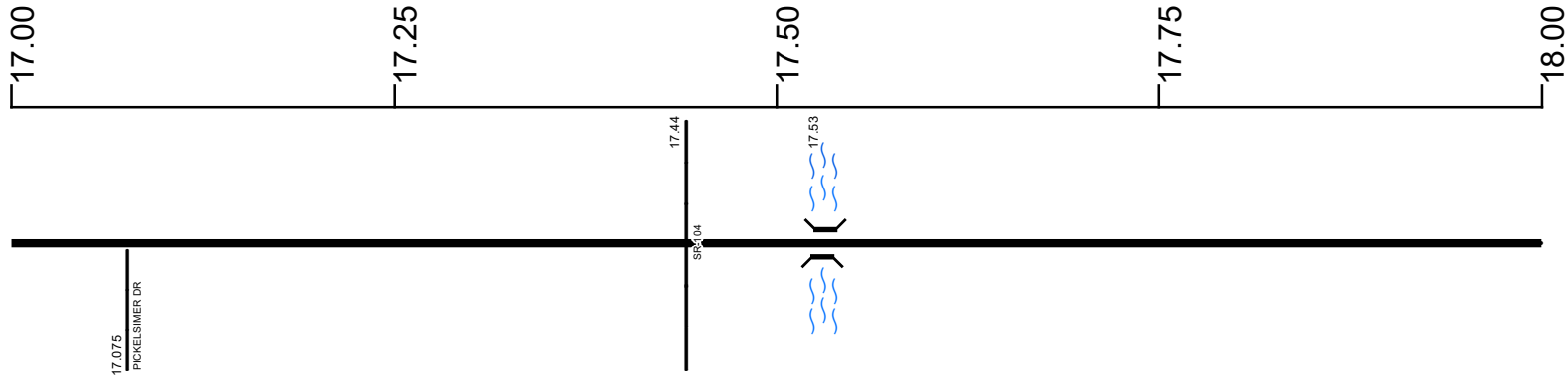

Surface Type & Width (Left / Right)

G 24'	G (12'/24')	G 24'
16.411 - 17.292	17.292 - 17.52	17.52 - 18.707

Base Type (Left / Right)

L
12.817 - 18.707

Shoulder Type & Width (Left / Right)

2 (3'/3')
16.411 - 18.707

Resurface Year

2023

Through Lanes

2
16.411 - 18.707

Street Name

SR 348
6.393 - 18.707

<ul style="list-style-type: none"> Non-divided Highway Divided Highway Secondary Segment Corporation 	<ul style="list-style-type: none"> Bridge (on route) Underpass Overpass 	<ul style="list-style-type: none"> Railroad (at grade) Railroad (underpass) Railroad (overpass) 	<ul style="list-style-type: none"> Intersection
--	---	---	---

Created on: 7/8/2025

transportation.ohio.gov

Prepared by
The Ohio Department of Transportation
Office of Technical Services
Roadway Information

SSCISR00348**C

State True Log
County True Log

32.26

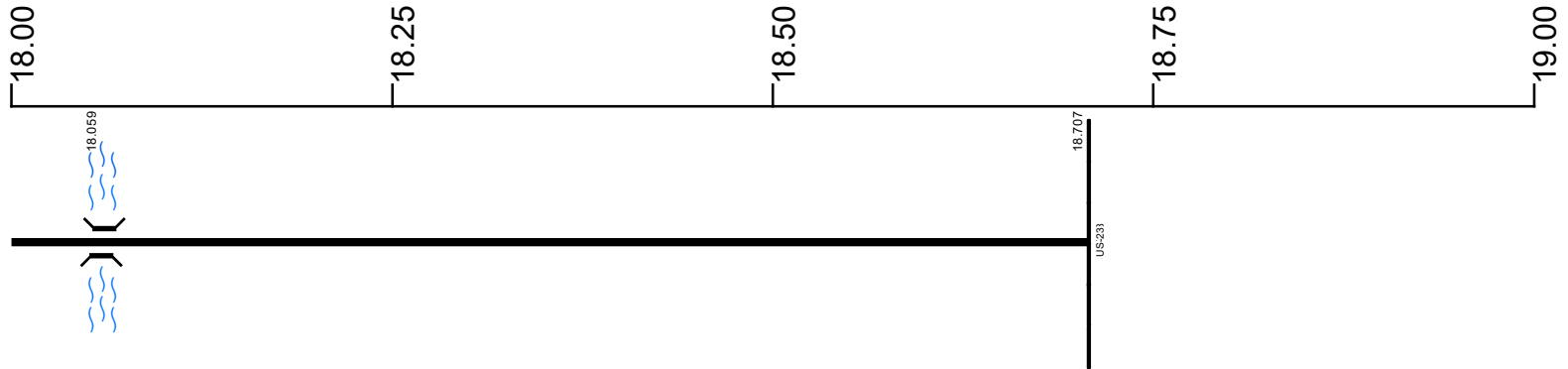

Surface Type & Width (Left / Right)	G 24'
	17.52 - 18.707
Base Type (Left / Right)	L
	12.817 - 18.707
Shoulder Type & Width (Left / Right)	2 (3/3')
	16.411 - 18.707
Resurface Year	2023
	12.817 - 18.707
Through Lanes	2
	16.411 - 18.707
Street Name	SR 348
	6.393 - 18.707

- | | | | | | | | |
|--|---------------------|--|-------------------|--|----------------------|--|--------------|
| | Non-divided Highway | | Bridge (on route) | | Railroad (at grade) | | Intersection |
| | Divided Highway | | Underpass | | Railroad (underpass) | | |
| | Secondary Segment | | Overpass | | Railroad (overpass) | | |
| | Corporation | | | | | | |

Created on: 7/8/2025

transportation.ohio.gov

Prepared by
The Ohio Department of Transportation
Office of Technical Services
Roadway Information

Historical Project List for SSCISR00348**C

Begin Measure	End Measure	Project ID Number	Construction Completion Date	Treatment Category	Treatment Type
0.000	6.243	87259	10-2016	Minor Rehabilitation	50-AC Overlay w/o Rpr
6.393	12.817	25602	10-2008	Minor Rehabilitation	60-AC Overlay w/Rpr
6.714	12.817	112919	10-2021	Preventive Maintenance	25-Chip Seal
12.817	18.707	114563	10-2023	Minor Rehabilitation	60-AC Overlay w/Rpr
12.817	18.707	95438	9-2017	Preventive Maintenance	30-Microsurfacing
12.817	18.707	25267	11-2004	Minor Rehabilitation	60-AC Overlay w/Rpr

Roadway Codes

Access Control Journalized

- F - Full Access Control
- L - Limited Access Control
- N - No Access Control

Access Control Operational

- 1 - Full Access Control
- 2 - Partial Access Control
- 3 - No Access Control

Base Type

- F - Crack and Seat
- H - Rubblize and Roll
- I - Aggregate Base 304 or Traffic Compacted
- K - Water Bound Macadam
- L - Bituminous Concrete Mix or Penetration Macadam
- N - Plain Concrete
- P - Reinforced Concrete
- R - Brick (Flexible)
- T - Brick (Rigid)

Direction of Travel

- B - Both (Two-way)
- F - One-way Cardinal
- T - One-way Non-cardinal

Facility Type

- 1 - One-way Roadway
- 2 - Two-way Roadway
- 4 - Ramp
- 5 - Non-mainline
- 6 - Non-inventory Direction
- 7 - Planned / Unbuilt

Historical Federal Aid Indicator

- N - Not a FAP Route
- Y - FAP Route

Functional Classification

- 01 - Interstate
- 02 - Principal Arterial (Freeways)
- 03 - Principal Arterial (Other)
- 04 - Minor Arterial
- 05 - Major Collector
- 06 - Minor Collector
- 07 - Local

Leave / Reenter Indicator

- Y - Route leaves/reenters at this point
- N - Route does not leave/reenter at this point

Median Type

- 1 - None
- 2 - Unprotected
- 3 - Curbed
- 4 - Positive Barrier (Unspecified)
- 5 - Positive Barrier (Flexible)
- 6 - Positive Barrier (Semi-rigid)
- 7 - Positive Barrier (Rigid)

NHS

- N - National Highway System
- H - Congressional Corridor
- 2 - Major Airport
- 3 - Major Port Facility
- 4 - Major Amtrak Station
- 5 - Major Rail / Truck Terminal
- 6 - Major Intercity Bus Terminal
- 7 - Major Public Transit / Multi-modal Passenger Terminal
- 8 - Major Pipeline Terminal
- 9 - Major Ferry Terminal

Priority System

- G - General
- P - Priority System
- U - Urban

Scenic Byway Code

- A - All American Road
- N - National Scenic Byway
- S - State Scenic Byway

Shoulder Type

- 1 - None
- 2 - Surfaced shoulder exists (bituminous concrete {AC})
- 3 - Surfaced shoulder exists (Portland Cement Concrete {PCC})
- 4 - Stabilized shoulder exists (gravel or other granular material)
- 5 - Combination shoulder exists (two or more surface types)
- 6 - Earth shoulder exists
- 7 - Barrier curb exists; no shoulder in front of curb

Surface Type

- A - Combination
- B - Brick
- C - Continuous Reinforced Concrete
- D - Reinforced Concrete
- E - Plain Concrete
- G - Bituminous Concrete
- I - Chipseal on Granular
- K - Open Graded Bituminous
- L - Chipseal or Micro
- M - Gravel
- U - Unimproved
- X - Right of Way Only