

SSUMSR00082**C

State True Log 25.544

26.544

County True Log

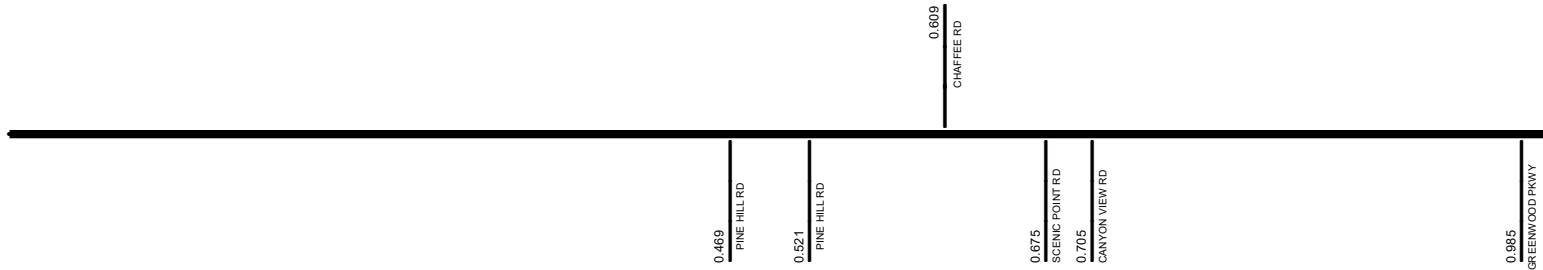

Surface Type & Width (Left / Right)

D 40' 0 - 0.143	G 24' 0.143 - 1.556
--------------------	------------------------

Base Type (Left / Right)

	P 0.143 - 1.556
--	--------------------

Shoulder Type & Width (Left / Right)

1 (0'/0') 0 - 0.143	2 (3'/3') 0.143 - 1.556
------------------------	----------------------------

Through Lanes

3 0 - 0.143	2 0.143 - 3.389
----------------	--------------------

Street Name

	W AURORA RD 0 - 2.673
--	--------------------------

- | | | | |
|---------------------|-------------------|----------------------|--------------|
| Non-divided Highway | Bridge (on route) | Railroad (at grade) | Intersection |
| Divided Highway | Underpass | Railroad (underpass) | |
| Secondary Segment | Overpass | Railroad (overpass) | |
| Corporation | | | |

Created on: 7/8/2025

transportation.ohio.gov

Prepared by
The Ohio Department of Transportation
Office of Technical Services
Roadway Information

SSUMSR00082**C

State True Log

27.544

County True Log

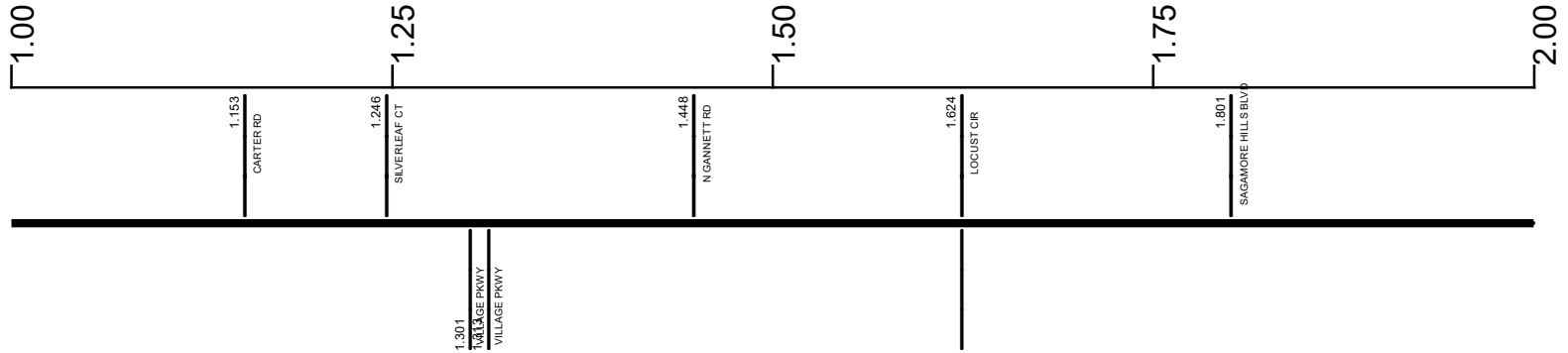

Surface Type & Width (Left / Right)

G 24'	G (18'/6')
0.143 - 1.556	1.556 - 3.389

Base Type (Left / Right)

P	P / K
0.143 - 1.556	1.556 - 3.389

Shoulder Type & Width (Left / Right)

2 (3'/3')	2 (8'/8')
0.143 - 1.556	1.556 - 3.389

Through Lanes

	2
	0.143 - 3.389

Street Name

	W AURORA RD
	0 - 2.673

- | | | | |
|---------------------|-------------------|----------------------|--------------|
| Non-divided Highway | Bridge (on route) | Railroad (at grade) | Intersection |
| Divided Highway | Underpass | Railroad (underpass) | |
| Secondary Segment | Overpass | Railroad (overpass) | |
| Corporation | | | |

Created on: 7/8/2025

transportation.ohio.gov

Prepared by
The Ohio Department of Transportation
Office of Technical Services
Roadway Information

SSUMSR00082**C

State True Log

28.544

County True Log

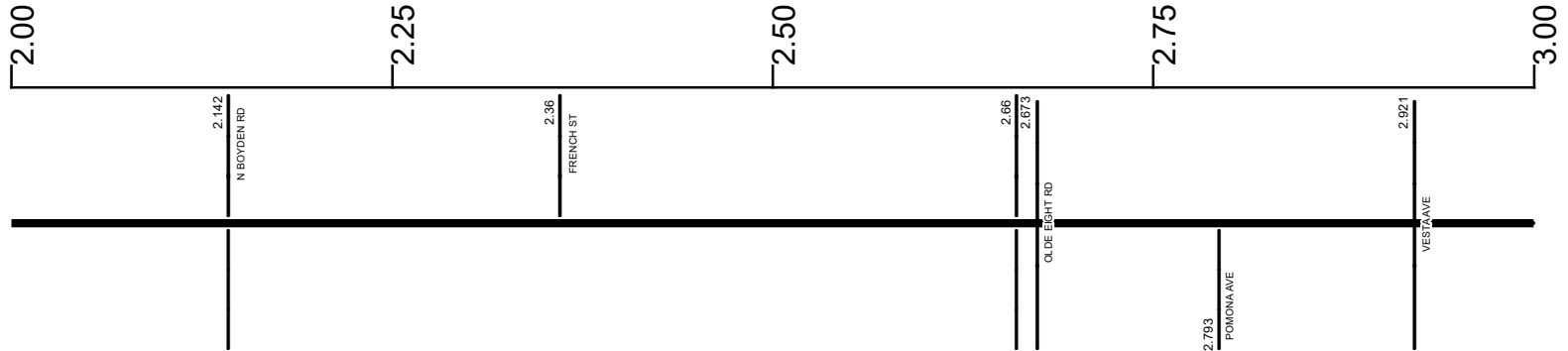

Surface Type & Width (Left / Right)

	G (18'/6')
	1.556 - 3.389

Base Type (Left / Right)

	P / K
	1.556 - 3.389

Shoulder Type & Width (Left / Right)

	2 (8'/8')
	1.556 - 3.389

Through Lanes

	2
	0.143 - 3.389

Street Name

W AURORA RD 0 - 2.673	E AURORA RD 2.673 - 8.015
--------------------------	------------------------------

- | | | | |
|--|---|---|---|
| <ul style="list-style-type: none"> Non-divided Highway Divided Highway Secondary Segment Corporation | <ul style="list-style-type: none"> Bridge (on route) Underpass Overpass | <ul style="list-style-type: none"> Railroad (at grade) Railroad (underpass) Railroad (overpass) | <ul style="list-style-type: none"> Intersection |
|--|---|---|---|

Created on: 7/8/2025

transportation.ohio.gov

Prepared by
The Ohio Department of Transportation
Office of Technical Services
Roadway Information

SSUMSR00082**C

State True Log

29.544

County True Log

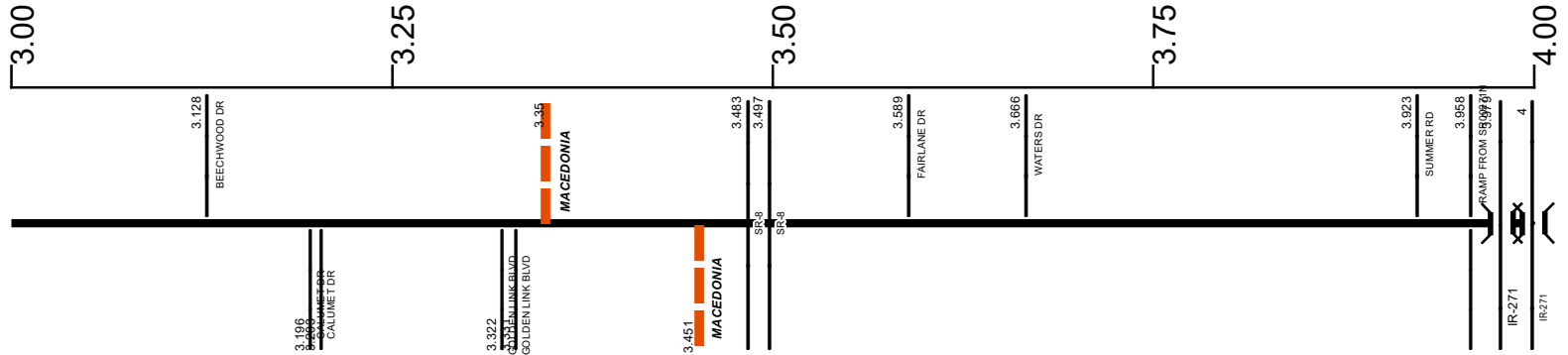

Surface Type & Width (Left / Right)

G (18'/6")	G (44'/18")	G 66'
1.556 - 3.389	3.389 - 3.923	3.923 - 4.171

Base Type (Left / Right)

P / K	N / L	L
1.556 - 3.389	3.389 - 3.923	3.923 - 4.298

Shoulder Type & Width (Left / Right)

2 (8'/8")	1 (0'/0")
1.556 - 3.389	3.389 - 5.399

Through Lanes

2	4
0.143 - 3.389	3.389 - 4.171

Street Name

E AURORA RD
2.673 - 8.015

- Non-divided Highway
- Divided Highway
- Secondary Segment
- Corporation
- Bridge (on route)
- Underpass
- Overpass
- Railroad (at grade)
- Railroad (underpass)
- Railroad (overpass)
- Intersection

Created on: 7/8/2025



transportation.ohio.gov

Prepared by
The Ohio Department of Transportation
Office of Technical Services
Roadway Information

SSUMSR00082**C

State True Log

30.544

County True Log

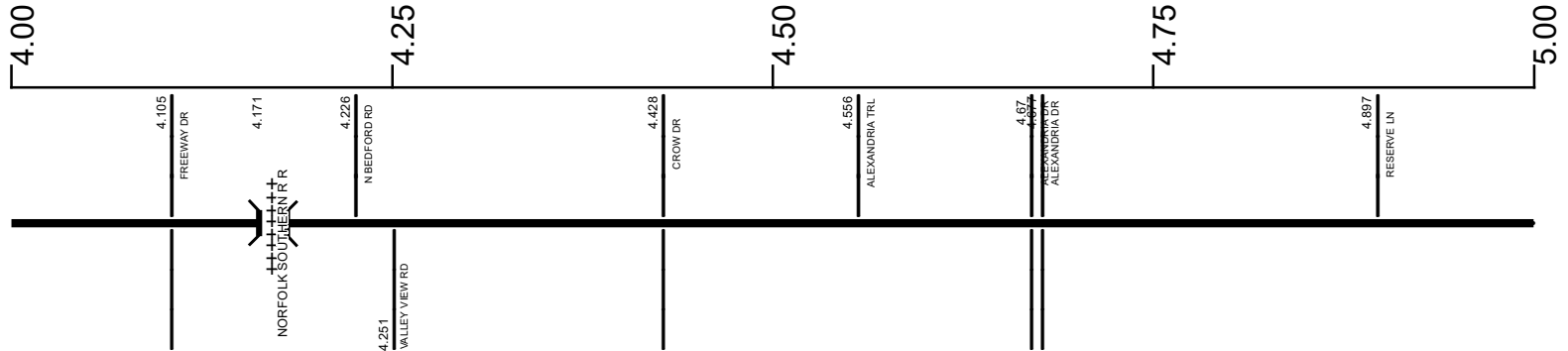

Surface Type & Width (Left / Right)

G 66'	G (30'/31')	G (18'/43')	G (30'/31')	G (18'/43')	G (18'/6')	G 40'
3.923 - 4.171	4.171 - 4.298	4.298 - 4.4	4.4 - 4.52	4.52 - 4.663	4.663 - 4.713	4.713 - 5.399

Base Type (Left / Right)

L	P / L	L	P / L	P / K	L
3.923 - 4.298	4.298 - 4.4	4.4 - 4.52	4.52 - 4.663	4.663 - 4.713	4.713 - 5.399

Shoulder Type & Width (Left / Right)

1 (0'/0')	
3.389 - 5.399	

Through Lanes

4	5	4
3.389 - 4.171	4.171 - 4.663	4.663 - 5.399

Street Name

E AURORA RD
2.673 - 8.015

- Non-divided Highway
- Divided Highway
- Secondary Segment
- Corporation
- Bridge (on route)
- Underpass
- Overpass
- Railroad (at grade)
- Railroad (underpass)
- Railroad (overpass)
- Intersection

Created on: 7/8/2025



transportation.ohio.gov
 Prepared by
 The Ohio Department of Transportation
 Office of Technical Services
 Roadway Information

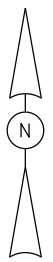

INTERCHANGE
IR 271 & SR 82
SUMMIT COUNTY
INTERCHANGE ID NUMBER = 087100

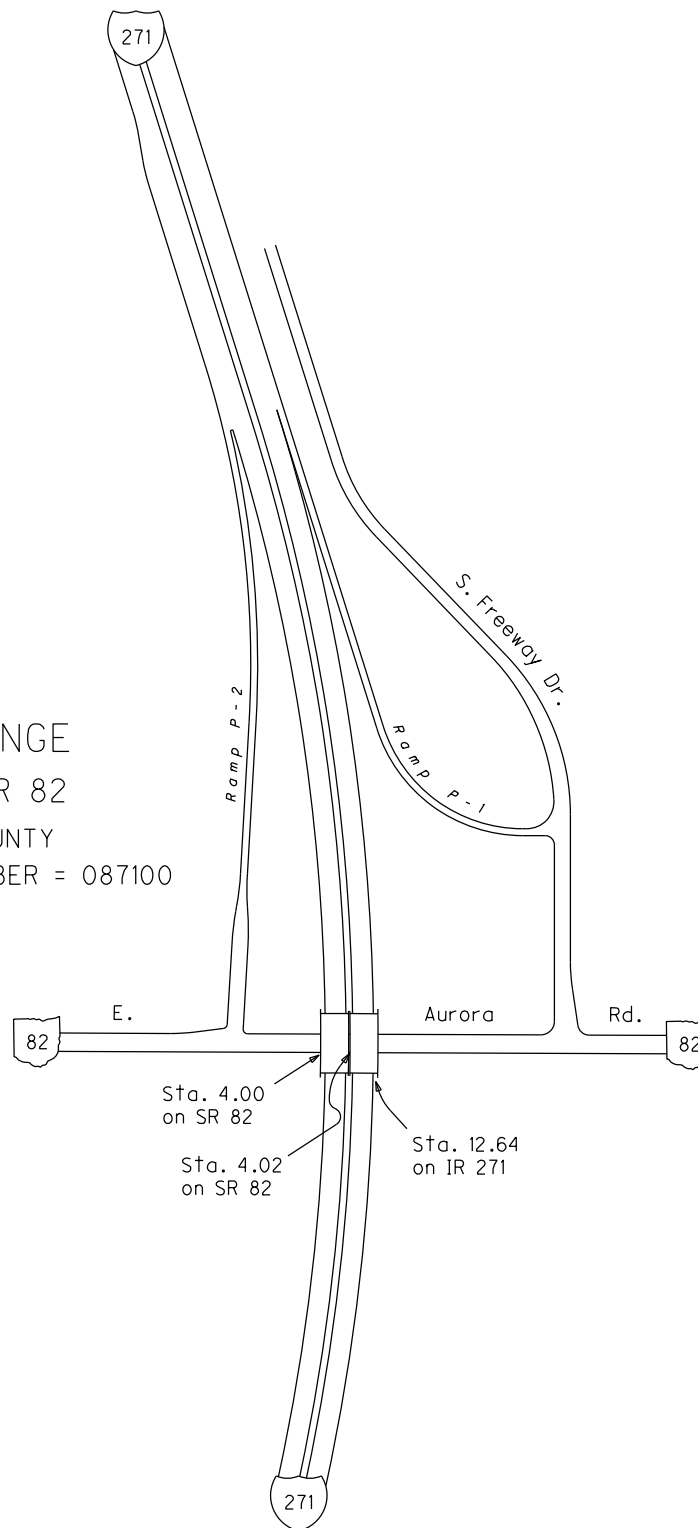

IR271 SHEET 3 OF 4
SR82 SHEET 1 OF 3

REVISED Jan 2018

SSUMSR00082**C

State True Log

31.544

County True Log

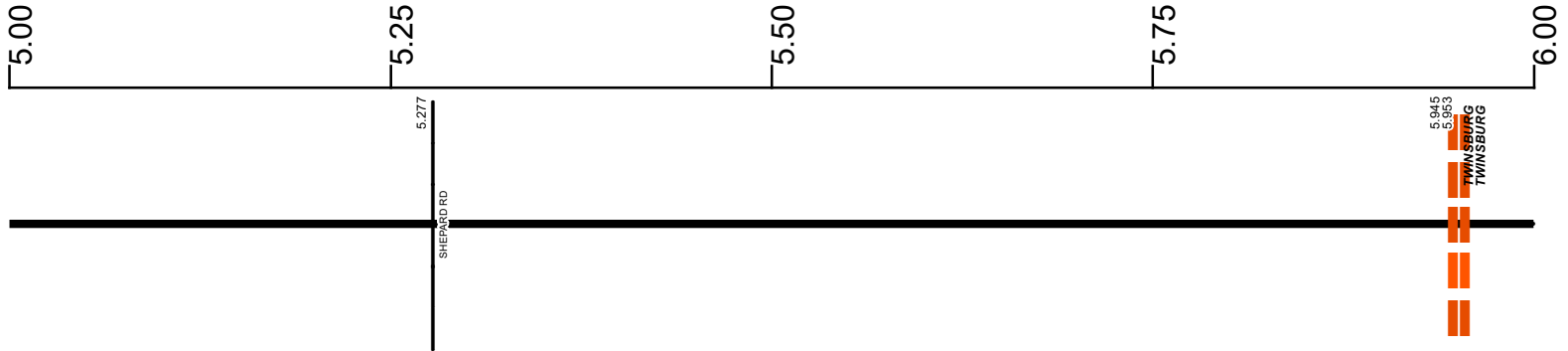

Surface Type & Width (Left / Right)

G 40'	G 36'	G (18'/6')
4.713 - 5.399	5.399 - 5.767	5.767 - 6.087

Base Type (Left / Right)

L	P / K
4.713 - 5.399	5.399 - 6.087

Shoulder Type & Width (Left / Right)

1 (0'/0')	2 (10'/10')	2 (8'/8')
3.389 - 5.399	5.399 - 5.767	5.767 - 6.087

Through Lanes

4	2
4.663 - 5.399	5.399 - 6.087

Street Name

E AURORA RD
2.673 - 8.015

- | | | | |
|---------------------|-------------------|----------------------|--------------|
| Non-divided Highway | Bridge (on route) | Railroad (at grade) | Intersection |
| Divided Highway | Underpass | Railroad (underpass) | |
| Secondary Segment | Overpass | Railroad (overpass) | |
| Corporation | | | |

Created on: 7/8/2025

transportation.ohio.gov

Prepared by
The Ohio Department of Transportation
Office of Technical Services
Roadway Information

SSUMSR00082**C

State True Log

32.544

County True Log

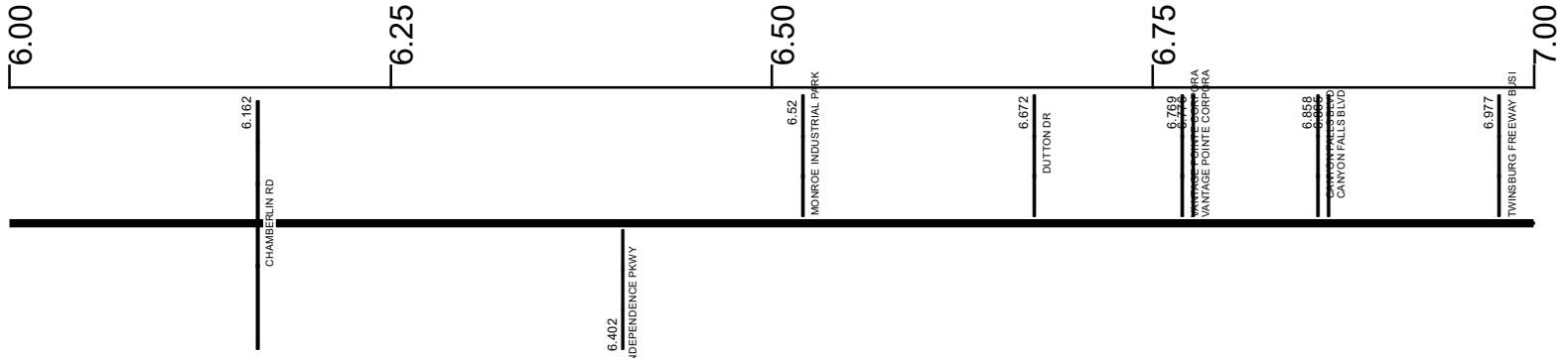

Surface Type & Width (Left / Right)

G (18'6")	G (18'34")
5.767 - 6.087	6.087 - 7.032

Base Type (Left / Right)

P / K	P / L
5.399 - 6.087	6.087 - 7.032

Shoulder Type & Width (Left / Right)

2 (8'8")	2 (6'6")
5.767 - 6.087	6.087 - 7.016

Through Lanes

2	4
5.399 - 6.087	6.087 - 7.865

Street Name

E AURORA RD
2.673 - 8.015

- Non-divided Highway
- Divided Highway
- Secondary Segment
- Corporation
- Bridge (on route)
- Underpass
- Overpass
- Railroad (at grade)
- Railroad (underpass)
- Railroad (overpass)
- Intersection

Created on: 7/8/2025



transportation.ohio.gov
 Prepared by
 The Ohio Department of Transportation
 Office of Technical Services
 Roadway Information

SSUMSR00082**C

State True Log

33.544

County True Log

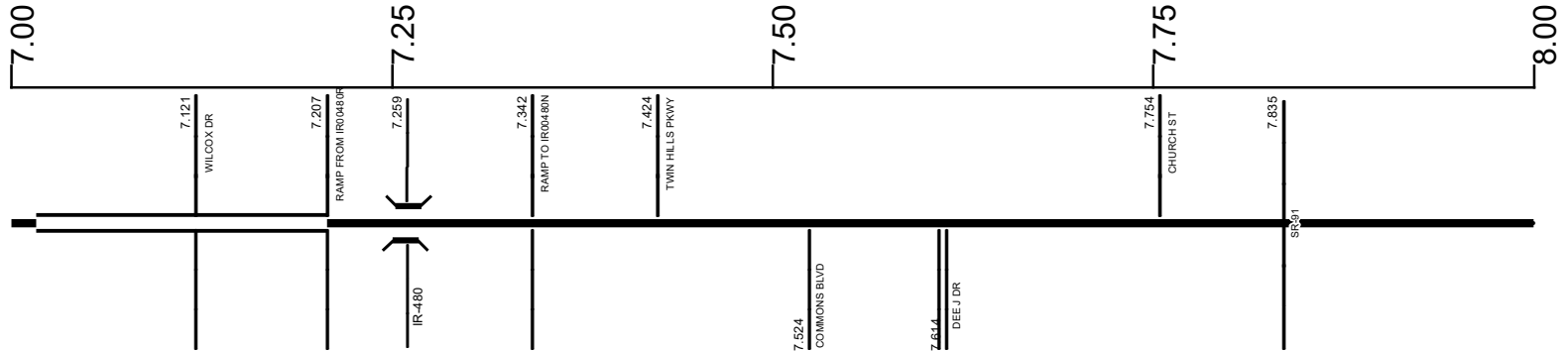

Surface Type & Width (Left / Right)

G (18'/34')	D 48'	G 48'	D 48'	G (18'/26')	G (20'/16')
6.087 - 7.032	7.032 - 7.342	7.342 - 7.444	7.444 - 7.464	7.464 - 7.865	7.865 - 8.235

Base Type (Left / Right)

P / L	P / L
6.087 - 7.032	7.464 - 8.025

Shoulder Type & Width (Left / Right)

2 (6'/6')	2 (10'/10')	2 (8'/8')	1 (0'/0')	2 (6'/6')
6.087 - 7.016	7.032 - 7.207	7.207 - 7.464	7.464 - 7.865	7.865 - 8.854

Median Type and Width

3 (4')
7.016 - 7.207

Through Lanes

4	2
6.087 - 7.865	7.865 - 10.546

Street Name

EAURORA RD	
2.673 - 8.015	

- Non-divided Highway
- Divided Highway
- Secondary Segment
- Corporation
- Bridge (on route)
- Underpass
- Overpass
- Railroad (at grade)
- Railroad (underpass)
- Railroad (overpass)
- Intersection

Created on: 7/8/2025

transportation.ohio.gov

Prepared by
The Ohio Department of Transportation
Office of Technical Services
Roadway Information

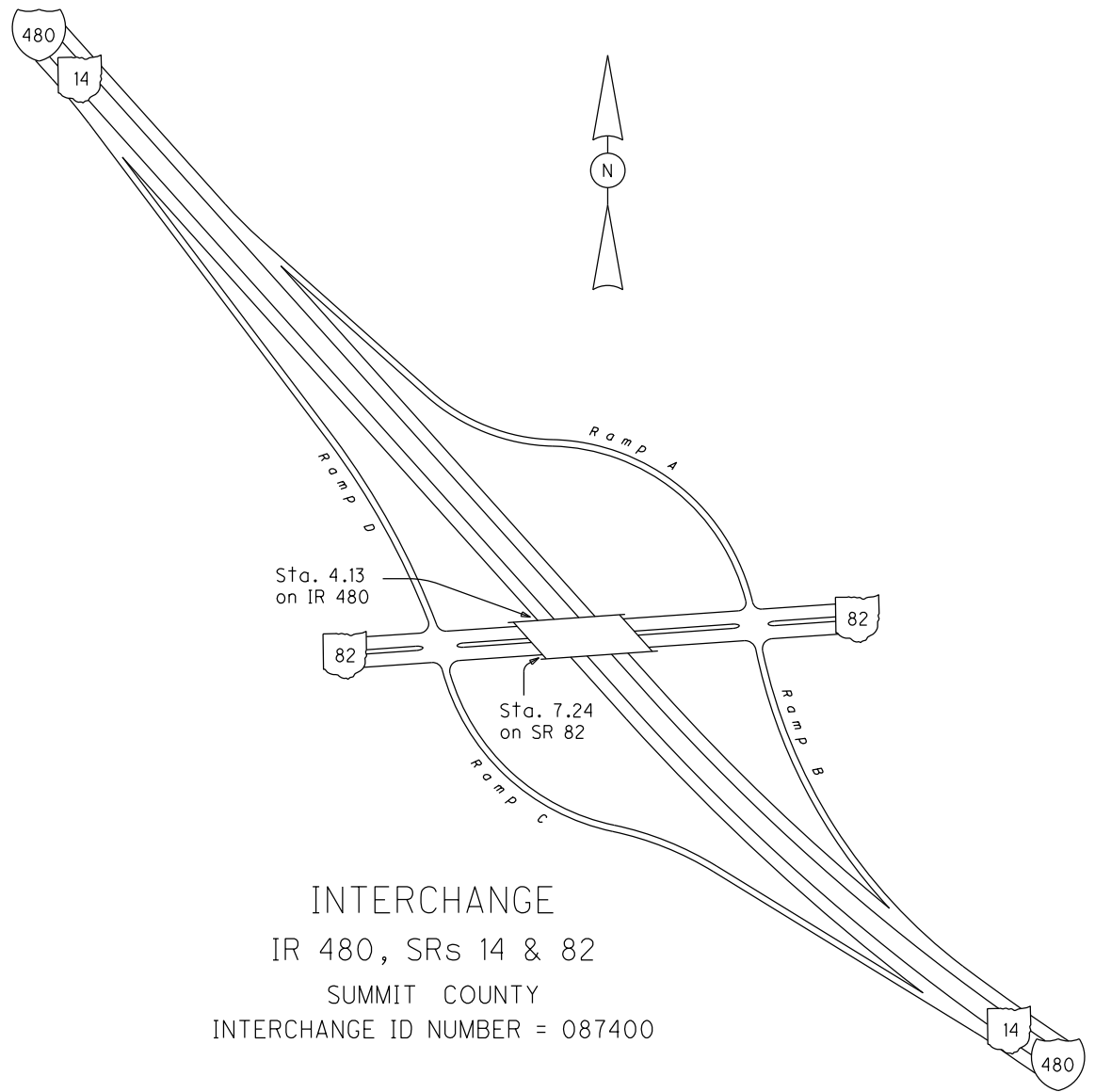

INTERCHANGE
IR 480, SRs 14 & 82
SUMMIT COUNTY
INTERCHANGE ID NUMBER = 087400

SSUMSR00082**C

State True Log

34.544

County True Log

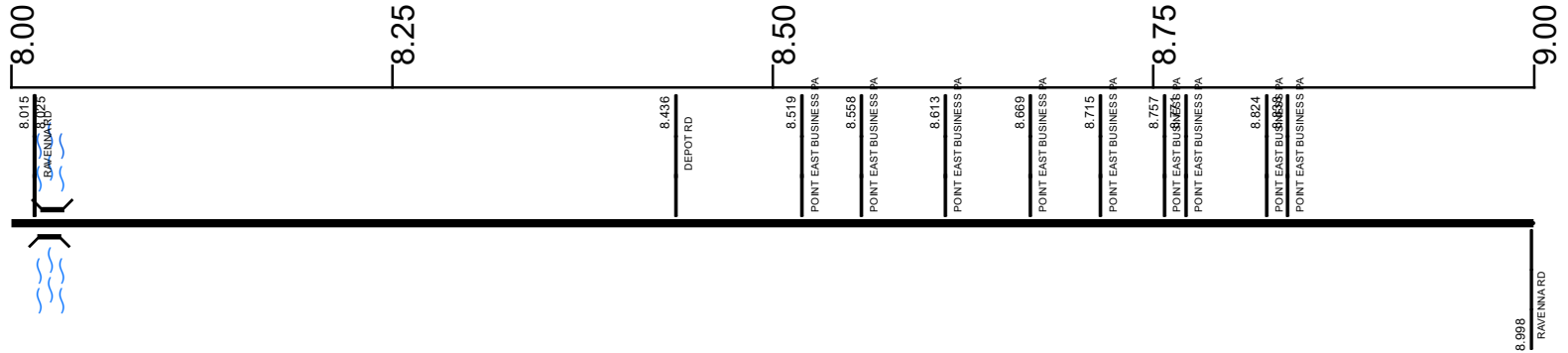

Surface Type & Width (Left / Right)

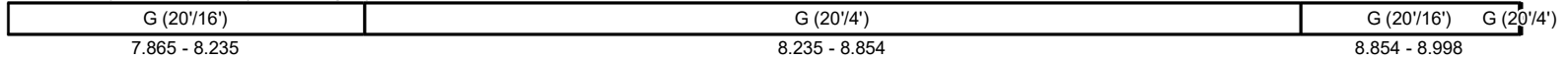

Base Type (Left / Right)

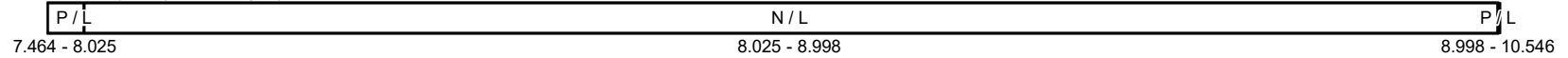

Shoulder Type & Width (Left / Right)

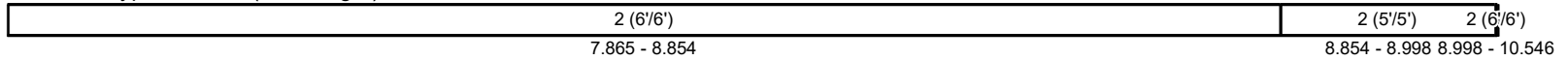

Through Lanes

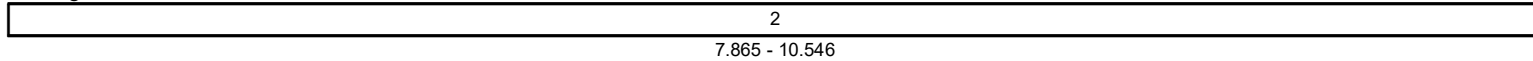

Street Name

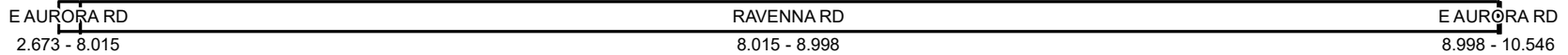

- Non-divided Highway
- Divided Highway
- Secondary Segment
- Corporation
- Bridge (on route)
- Underpass
- Overpass
- Railroad (at grade)
- Railroad (underpass)
- Railroad (overpass)
- Intersection

Created on: 7/8/2025

transportation.ohio.gov

Prepared by
The Ohio Department of Transportation
Office of Technical Services
Roadway Information

SSUMSR00082**C

State True Log

35.544

County True Log

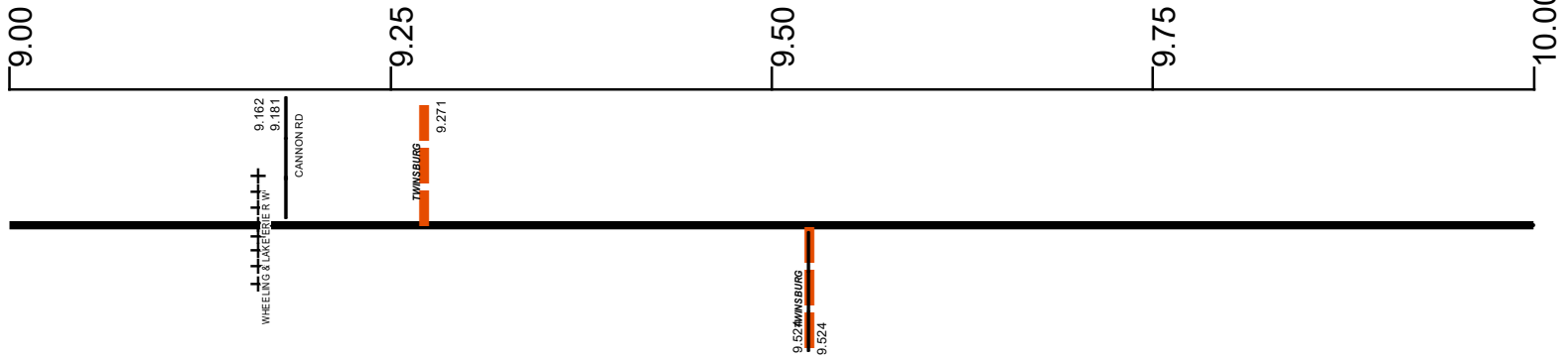

Surface Type & Width (Left / Right)

G (20'4')
8.998 - 10.546

Base Type (Left / Right)

P / L
8.998 - 10.546

Shoulder Type & Width (Left / Right)

2 (6'6')
8.998 - 10.546

Through Lanes

2
7.865 - 10.546

Street Name

EAURORA RD
8.998 - 10.546

- | | | | |
|---------------------|-------------------|----------------------|--------------|
| Non-divided Highway | Bridge (on route) | Railroad (at grade) | Intersection |
| Divided Highway | Underpass | Railroad (underpass) | |
| Secondary Segment | Overpass | Railroad (overpass) | |
| Corporation | | | |

Created on: 7/8/2025



Prepared by
The Ohio Department of Transportation
Office of Technical Services
Roadway Information

SSUMSR00082**C

State True Log

County True Log

36.09

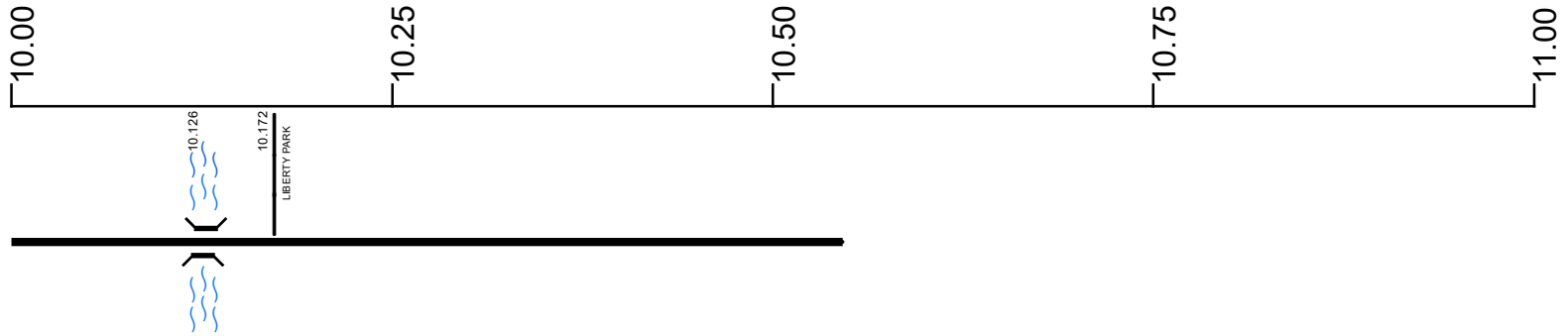

Surface Type & Width (Left / Right)

G (20'4')
8.998 - 10.546

Base Type (Left / Right)

P / L
8.998 - 10.546

Shoulder Type & Width (Left / Right)

2 (6'6')
8.998 - 10.546

Through Lanes

2
7.865 - 10.546

Street Name

E AURORA RD
8.998 - 10.546

- | | | | |
|--|---|---|---|
| <ul style="list-style-type: none"> Non-divided Highway Divided Highway Secondary Segment Corporation | <ul style="list-style-type: none"> Bridge (on route) Underpass Overpass | <ul style="list-style-type: none"> Railroad (at grade) Railroad (underpass) Railroad (overpass) | <ul style="list-style-type: none"> Intersection |
|--|---|---|---|

Created on: 7/8/2025

transportation.ohio.gov

Prepared by
The Ohio Department of Transportation
Office of Technical Services
Roadway Information

Historical Project List for SSUMSR00082**C

Begin Measure	End Measure	Project ID Number	Construction Completion Date	Treatment Category	Treatment Type
0.000	3.470	24526	12-2003	Minor Rehabilitation	60-AC Overlay w/Rpr
0.140	3.370	84563	12-2015	Minor Rehabilitation	60-AC Overlay w/Rpr
3.370	3.920	84563	12-2015	Minor Rehabilitation	60-AC Overlay w/Rpr
3.930	4.170	89458	6-2017	Minor Rehabilitation	60-AC Overlay w/Rpr
4.050	4.650	23261	7-2010	Minor Rehabilitation	60-AC Overlay w/Rpr
4.650	5.950	81656	12-2016	Minor Rehabilitation	60-AC Overlay w/Rpr
5.950	6.200	81656	12-2016	Minor Rehabilitation	60-AC Overlay w/Rpr
5.950	8.040	24526	12-2003	Minor Rehabilitation	60-AC Overlay w/Rpr
7.410	8.020	86954	9-2015	Minor Rehabilitation	60-AC Overlay w/Rpr
8.040	10.580	25544	8-2009	Minor Rehabilitation	60-AC Overlay w/Rpr

Roadway Codes

Access Control Journalized

- F - Full Access Control
- L - Limited Access Control
- N - No Access Control

Access Control Operational

- 1 - Full Access Control
- 2 - Partial Access Control
- 3 - No Access Control

Base Type

- F - Crack and Seat
- H - Rubblize and Roll
- I - Aggregate Base 304 or Traffic Compacted
- K - Water Bound Macadam
- L - Bituminous Concrete Mix or Penetration Macadam
- N - Plain Concrete
- P - Reinforced Concrete
- R - Brick (Flexible)
- T - Brick (Rigid)

Direction of Travel

- B - Both (Two-way)
- F - One-way Cardinal
- T - One-way Non-cardinal

Facility Type

- 1 - One-way Roadway
- 2 - Two-way Roadway
- 4 - Ramp
- 5 - Non-mainline
- 6 - Non-inventory Direction
- 7 - Planned / Unbuilt

Historical Federal Aid Indicator

- N - Not a FAP Route
- Y - FAP Route

Functional Classification

- 01 - Interstate
- 02 - Principal Arterial (Freeways)
- 03 - Principal Arterial (Other)
- 04 - Minor Arterial
- 05 - Major Collector
- 06 - Minor Collector
- 07 - Local

Leave / Reenter Indicator

- Y - Route leaves/reenters at this point
- N - Route does not leave/reenter at this point

Median Type

- 1 - None
- 2 - Unprotected
- 3 - Curbed
- 4 - Positive Barrier (Unspecified)
- 5 - Positive Barrier (Flexible)
- 6 - Positive Barrier (Semi-rigid)
- 7 - Positive Barrier (Rigid)

NHS

- N - National Highway System
- H - Congressional Corridor
- 2 - Major Airport
- 3 - Major Port Facility
- 4 - Major Amtrak Station
- 5 - Major Rail / Truck Terminal
- 6 - Major Intercity Bus Terminal
- 7 - Major Public Transit / Multi-modal Passenger Terminal
- 8 - Major Pipeline Terminal
- 9 - Major Ferry Terminal

Priority System

- G - General
- P - Priority System
- U - Urban

Scenic Byway Code

- A - All American Road
- N - National Scenic Byway
- S - State Scenic Byway

Shoulder Type

- 1 - None
- 2 - Surfaced shoulder exists (bituminous concrete {AC})
- 3 - Surfaced shoulder exists (Portland Cement Concrete {PCC})
- 4 - Stabilized shoulder exists (gravel or other granular material)
- 5 - Combination shoulder exists (two or more surface types)
- 6 - Earth shoulder exists
- 7 - Barrier curb exists; no shoulder in front of curb

Surface Type

- A - Combination
- B - Brick
- C - Continuous Reinforced Concrete
- D - Reinforced Concrete
- E - Plain Concrete
- G - Bituminous Concrete
- I - Chipseal on Granular
- K - Open Graded Bituminous
- L - Chipseal or Micro
- M - Gravel
- U - Unimproved
- X - Right of Way Only