

# SSUMSR00532\*\*C

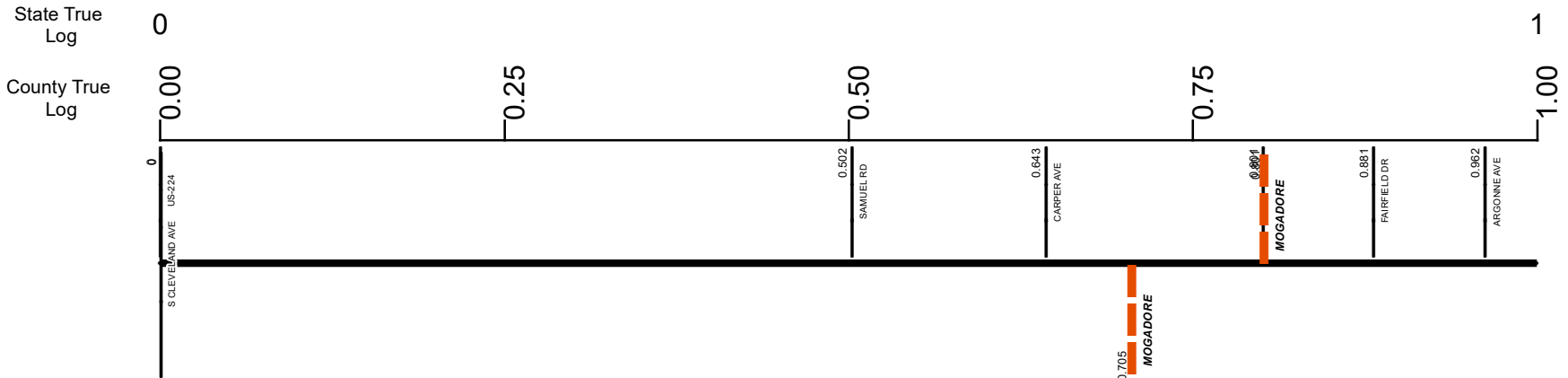

<b>Surface Type &amp; Width (Left / Right)</b>	
G (18'/6')	G (6'/24')
0 - 0.801	0.801 - 1.397
<b>Base Type (Left / Right)</b>	
K / L	N / K
0 - 0.801	0.801 - 1.397
<b>Shoulder Type &amp; Width (Left / Right)</b>	
5 (2'/2')	1 (0'/0')
0 - 0.801	0.801 - 1.586
<b>Through Lanes</b>	
2	
0 - 3.742	
<b>Street Name</b>	
S CLEVELAND AVE	
0 - 1.523	

<ul style="list-style-type: none"> <li> Non-divided Highway</li> <li> Divided Highway</li> <li> Secondary Segment</li> <li> <b>Corporation</b></li> </ul>	<ul style="list-style-type: none"> <li> Bridge (on route)</li> <li> Underpass</li> <li> Overpass</li> </ul>	<ul style="list-style-type: none"> <li> Railroad (at grade)</li> <li> Railroad (underpass)</li> <li> Railroad (overpass)</li> </ul>	<ul style="list-style-type: none"> <li> Intersection</li> </ul>
---	---	---	---

Created on: 7/8/2025

transportation.ohio.gov

Prepared by  
The Ohio Department of Transportation  
Office of Technical Services  
Roadway Information

# SSUMSR00532\*\*C

State True  
Log

County True  
Log

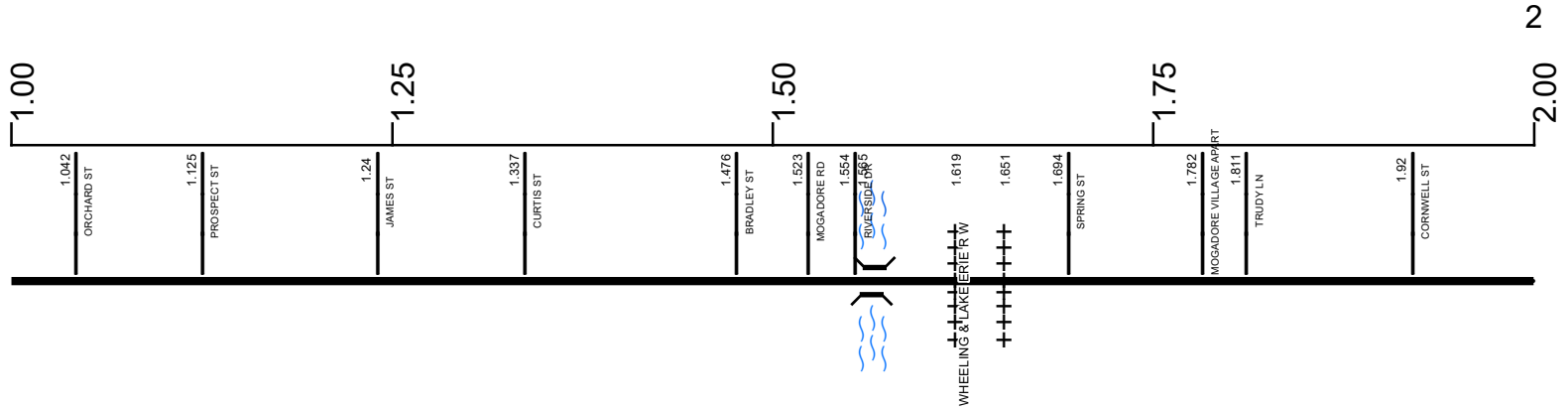

**Surface Type & Width (Left / Right)**

G (6'/24')	G (21'/22')	G (20'/4')
0.801 - 1.397	1.397 - 1.586	1.586 - 2.443

**Base Type (Left / Right)**

N / K	P	P / L	I / L
0.801 - 1.397	1.397 - 1.586	1.586 - 1.891	1.891 - 2.443

**Shoulder Type & Width (Left / Right)**

1 (0'/0')	5 (1'/1')
0.801 - 1.586	1.586 - 3.489

**Through Lanes**

2
0 - 3.742

**Street Name**

S CLEVELAND AVE	N CLEVELAND AVE
0 - 1.523	1.523 - 2.586

- Non-divided Highway
- Divided Highway
- Secondary Segment
- Corporation
- Bridge (on route)
- Underpass
- Overpass
- Railroad (at grade)
- Railroad (underpass)
- Railroad (overpass)
- Intersection

Created on: 7/8/2025

transportation.ohio.gov

Prepared by  
The Ohio Department of Transportation  
Office of Technical Services  
Roadway Information

# SSUMSR00532\*\*C

State True Log

County True Log

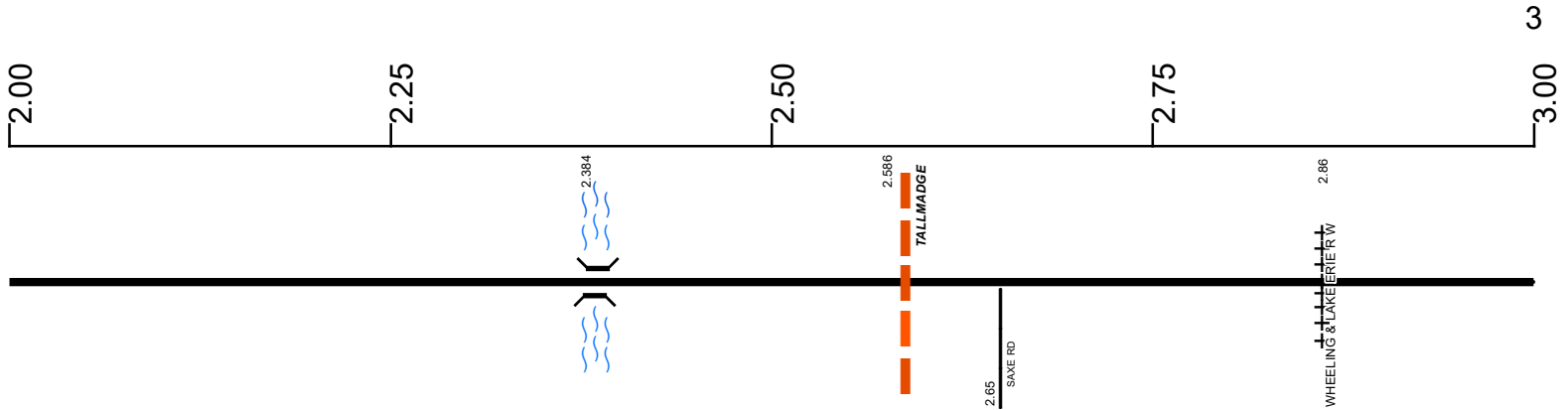

**Surface Type & Width (Left / Right)**

G (20'4")	G 24'	G (20'4")
1.586 - 2.443	2.443 - 2.95	2.95 - 3.489

**Base Type (Left / Right)**

I / L	L	I / L
1.891 - 2.443	2.443 - 2.95	2.95 - 3.489

**Shoulder Type & Width (Left / Right)**

5 (1'1")
1.586 - 3.489

**Through Lanes**

2
0 - 3.742

**Street Name**

N CLEVELAND AVE	SOUTHEAST AVE
1.523 - 2.586	2.586 - 3.489

- Non-divided Highway
- Divided Highway
- Secondary Segment
- Corporation
- Bridge (on route)
- Underpass
- Overpass
- Railroad (at grade)
- Railroad (underpass)
- Railroad (overpass)
- Intersection

Created on: 7/8/2025

transportation.ohio.gov

Prepared by  
The Ohio Department of Transportation  
Office of Technical Services  
Roadway Information

# SSUMSR00532\*\*C

State True Log

3.742

County True Log

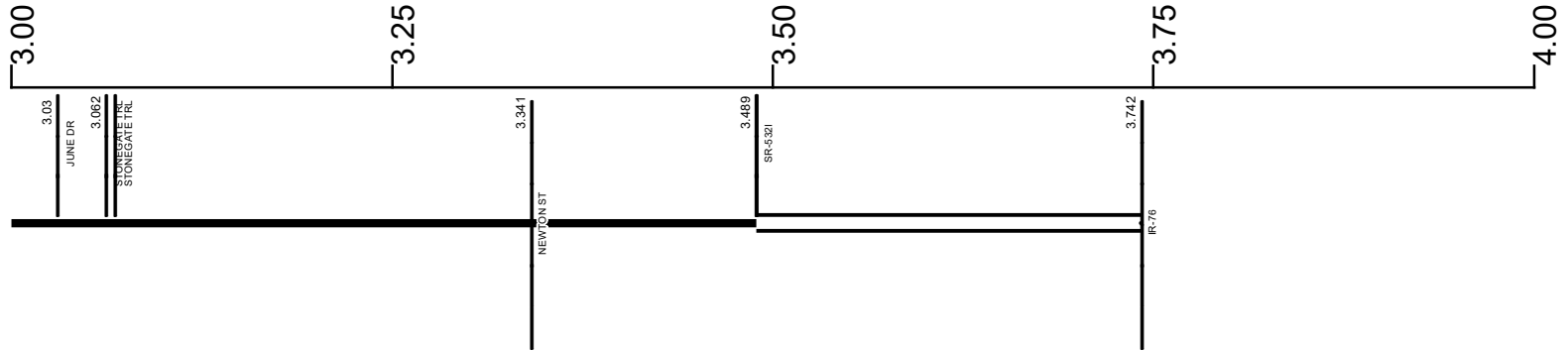

**Surface Type & Width (Left / Right)**

G (20'4')	D 32'
2.95 - 3.489	3.489 - 3.742

**Base Type (Left / Right)**

I / L
2.95 - 3.489

**Shoulder Type & Width (Left / Right)**

5 (1'1')	2 (8/8')
1.586 - 3.489	3.489 - 3.742

**Median Type and Width**

2 ( 9999' )
3.489 - 3.742

**Through Lanes**

2
0 - 3.742

**Street Name**

SOUTHEAST AVE	SOUTHEAST AVE TO I 76 E
2.586 - 3.489	3.489 - 3.742

- Non-divided Highway
- Divided Highway
- Secondary Segment
- Corporation
- Bridge (on route)
- Underpass
- Overpass
- Railroad (at grade)
- Railroad (underpass)
- Railroad (overpass)
- Intersection

Created on: 7/8/2025

transportation.ohio.gov  
 Prepared by  
 The Ohio Department of Transportation  
 Office of Technical Services  
 Roadway Information

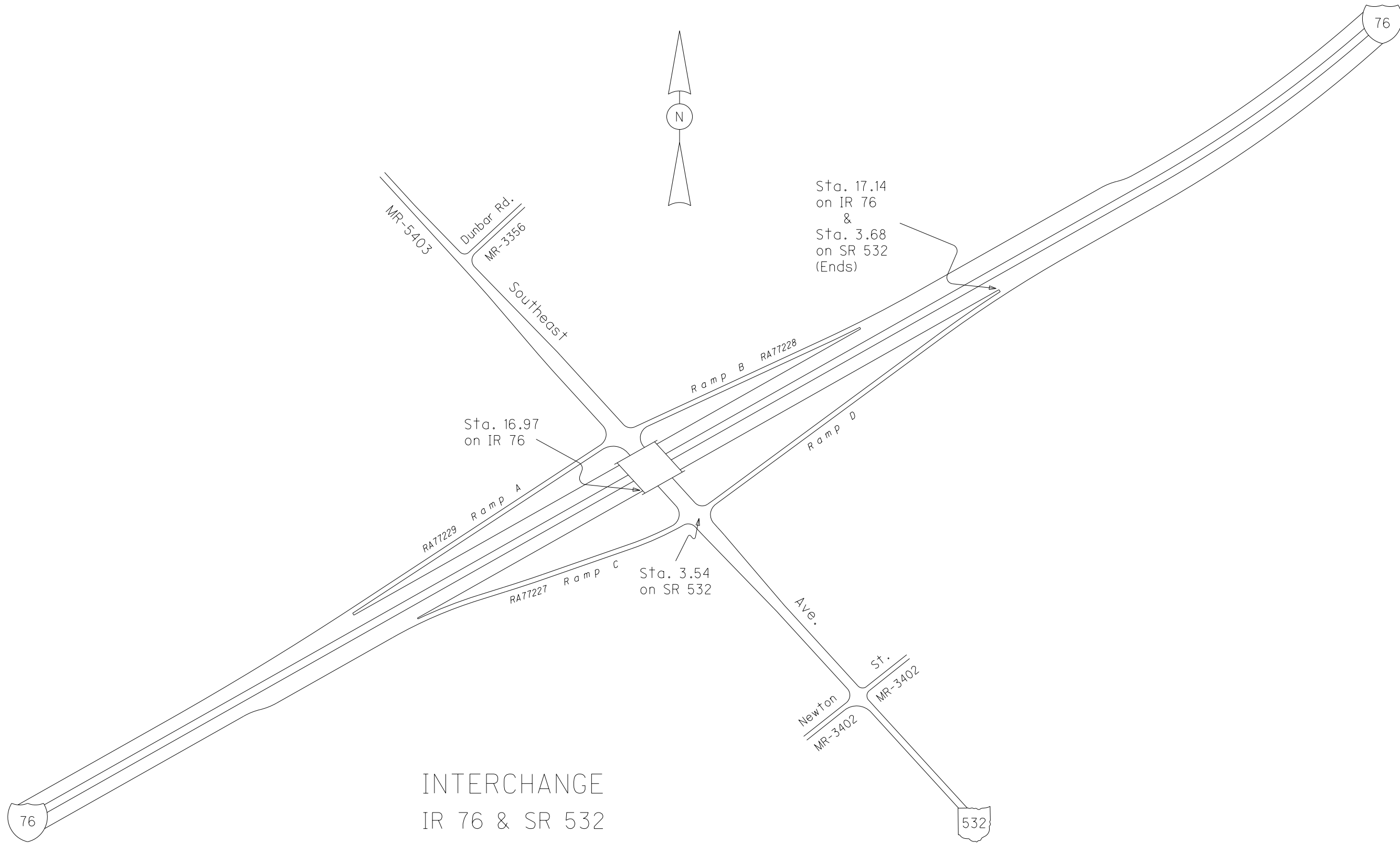

INTERCHANGE  
 IR 76 & SR 532  
 SUMMIT COUNTY  
 INTERCHANGE ID NUMBER = 085000

IR 76  
 SR 532  
 REVISED Jan 2023

## Historical Project List for SSUMSR00532\*\*C

Begin Measure	End Measure	Project ID Number	Construction Completion Date	Treatment Category	Treatment Type
0.000	1.420	94126	11-2018	Minor Rehabilitation	60-AC Overlay w/Rpr
0.000	3.590	22480	5-2006	Minor Rehabilitation	60-AC Overlay w/Rpr
1.420	1.930	94126	11-2018	Minor Rehabilitation	38-Fine Poly AC Overlay
1.930	2.380	94126	11-2018	Minor Rehabilitation	60-AC Overlay w/Rpr
2.380	2.490	94126	11-2018	Minor Rehabilitation	60-AC Overlay w/Rpr
2.490	2.630	94126	11-2018	Minor Rehabilitation	60-AC Overlay w/Rpr
2.630	3.540	94126	11-2018	Minor Rehabilitation	60-AC Overlay w/Rpr

# Roadway Codes

## Access Control Journalized

- F - Full Access Control
- L - Limited Access Control
- N - No Access Control

## Access Control Operational

- 1 - Full Access Control
- 2 - Partial Access Control
- 3 - No Access Control

## Base Type

- F - Crack and Seat
- H - Rubblize and Roll
- I - Aggregate Base 304 or Traffic Compacted
- K - Water Bound Macadam
- L - Bituminous Concrete Mix or Penetration Macadam
- N - Plain Concrete
- P - Reinforced Concrete
- R - Brick (Flexible)
- T - Brick (Rigid)

## Direction of Travel

- B - Both (Two-way)
- F - One-way Cardinal
- T - One-way Non-cardinal

## Facility Type

- 1 - One-way Roadway
- 2 - Two-way Roadway
- 4 - Ramp
- 5 - Non-mainline
- 6 - Non-inventory Direction
- 7 - Planned / Unbuilt

## Historical Federal Aid Indicator

- N - Not a FAP Route
- Y - FAP Route

## Functional Classification

- 01 - Interstate
- 02 - Principal Arterial (Freeways)
- 03 - Principal Arterial (Other)
- 04 - Minor Arterial
- 05 - Major Collector
- 06 - Minor Collector
- 07 - Local

## Leave / Reenter Indicator

- Y - Route leaves/reenters at this point
- N - Route does not leave/reenter at this point

## Median Type

- 1 - None
- 2 - Unprotected
- 3 - Curbed
- 4 - Positive Barrier (Unspecified)
- 5 - Positive Barrier (Flexible)
- 6 - Positive Barrier (Semi-rigid)
- 7 - Positive Barrier (Rigid)

## NHS

- N - National Highway System
- H - Congressional Corridor
- 2 - Major Airport
- 3 - Major Port Facility
- 4 - Major Amtrak Station
- 5 - Major Rail / Truck Terminal
- 6 - Major Intercity Bus Terminal
- 7 - Major Public Transit / Multi-modal Passenger Terminal
- 8 - Major Pipeline Terminal
- 9 - Major Ferry Terminal

## Priority System

- G - General
- P - Priority System
- U - Urban

## Scenic Byway Code

- A - All American Road
- N - National Scenic Byway
- S - State Scenic Byway

## Shoulder Type

- 1 - None
- 2 - Surfaced shoulder exists (bituminous concrete {AC})
- 3 - Surfaced shoulder exists (Portland Cement Concrete {PCC})
- 4 - Stabilized shoulder exists (gravel or other granular material)
- 5 - Combination shoulder exists (two or more surface types)
- 6 - Earth shoulder exists
- 7 - Barrier curb exists; no shoulder in front of curb

## Surface Type

- A - Combination
- B - Brick
- C - Continuous Reinforced Concrete
- D - Reinforced Concrete
- E - Plain Concrete
- G - Bituminous Concrete
- I - Chipseal on Granular
- K - Open Graded Bituminous
- L - Chipseal or Micro
- M - Gravel
- U - Unimproved
- X - Right of Way Only