

# STRUSR00045\*\*C

State True Log 43.859

44.859

County True Log

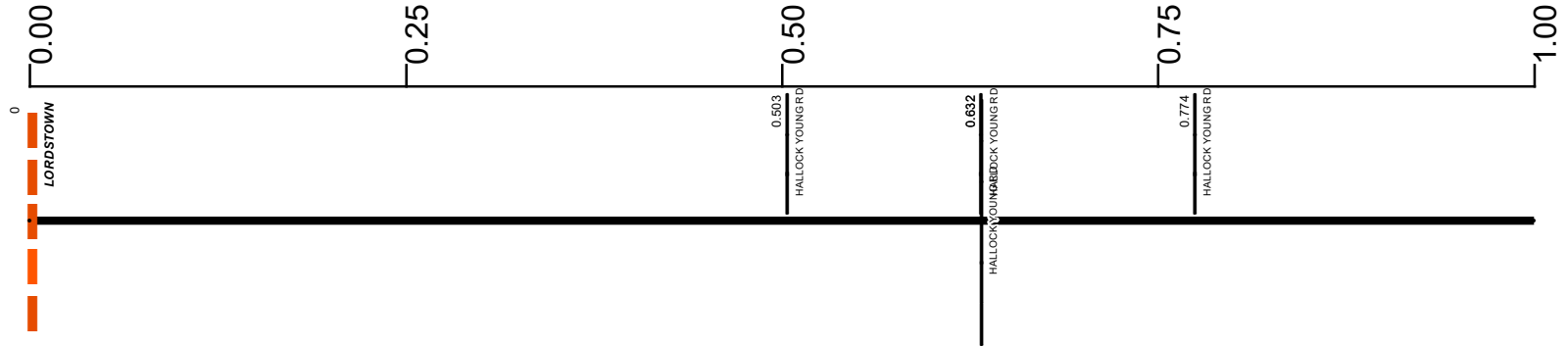

**Surface Type & Width (Left / Right)**

G (29'/21')	G 50'	G (29'/21')	G 50'	G (35'/15')
0 - 0.061	0.061 - 0.15	0.15 - 0.408	0.408 - 0.795	0.795 - 1.367

**Base Type (Left / Right)**

L / K	L	L / K	L	L / K
0 - 0.061	0.061 - 0.15	0.15 - 0.408	0.408 - 0.795	0.795 - 1.367

**Shoulder Type & Width (Left / Right)**

	2 (8'/8')	
0 - 5.767		

**Resurface Year**

	2021	
--	------	--

0 - 5.78

**Through Lanes**

	4	
--	---	--

0 - 7.351

**Street Name**

	TODAVE	
--	--------	--

0 - 4.9

- Non-divided Highway
  Bridge (on route)
  Railroad (at grade)
  Intersection
- Divided Highway
  Underpass
  Railroad (underpass)
- Secondary Segment
  Overpass
  Railroad (overpass)
- Corporation**

Created on: 7/8/2025

transportation.ohio.gov

Prepared by  
The Ohio Department of Transportation  
Office of Technical Services  
Roadway Information

# STRUSR00045\*\*C

State True Log

45.859

County True Log

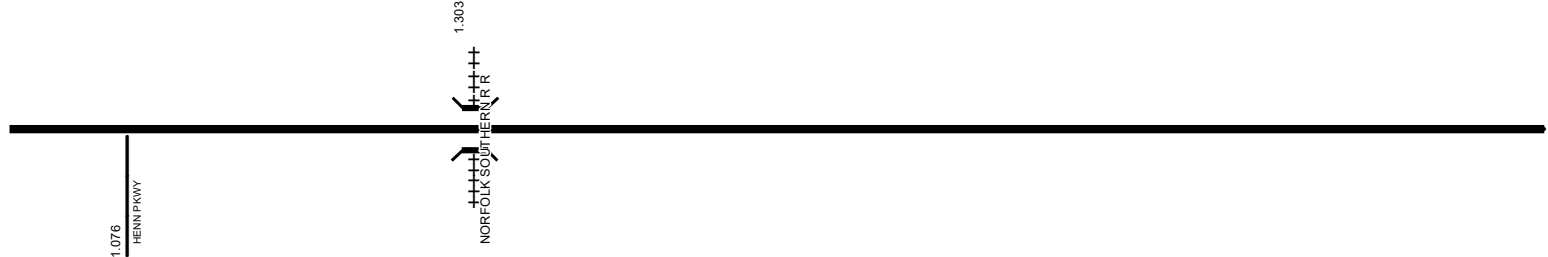

**Surface Type & Width (Left / Right)**

G (35'/15') 0.795 - 1.367	G 50' 1.367 - 1.708	G (28'/22') 1.708 - 2.799
------------------------------	------------------------	------------------------------

**Base Type (Left / Right)**

L / K 0.795 - 1.367	L 1.367 - 1.708	L / K 1.708 - 2.799
------------------------	--------------------	------------------------

**Shoulder Type & Width (Left / Right)**

2 (8/8) 0 - 5.767
----------------------

**Resurface Year**

2021 0 - 5.78
------------------

**Through Lanes**

4 0 - 7.351
----------------

**Street Name**

TOD AVE 0 - 4.9
--------------------

- Non-divided Highway
- Divided Highway
- Secondary Segment
- Corporation
- Bridge (on route)
- Underpass
- Overpass
- Railroad (at grade)
- Railroad (underpass)
- Railroad (overpass)
- Intersection

Created on: 7/8/2025

transportation.ohio.gov

Prepared by  
The Ohio Department of Transportation  
Office of Technical Services  
Roadway Information

# STRUSR00045\*\*C

State True Log

46.859

County True Log

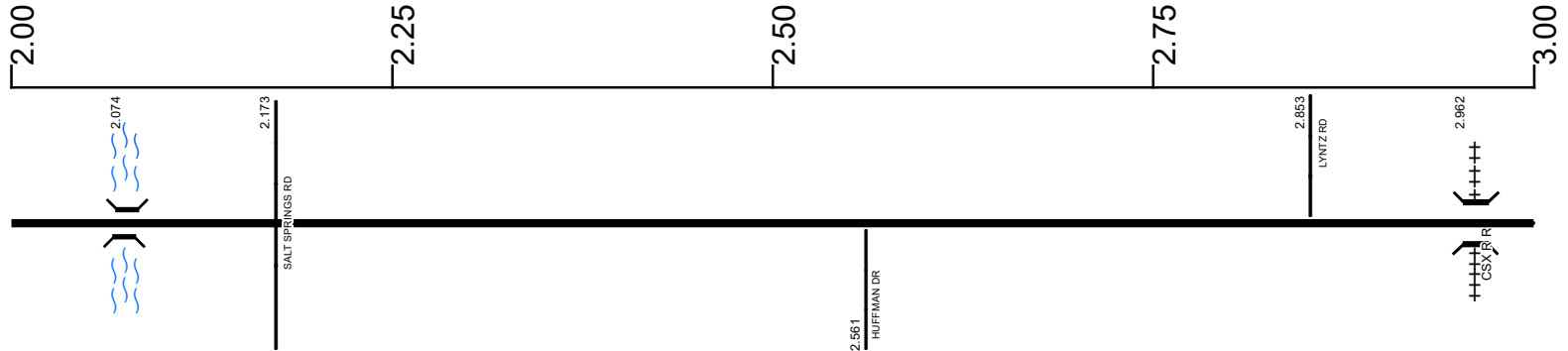

**Surface Type & Width (Left / Right)**

G (28'/22')	G 50'
1.708 - 2.799	2.799 - 3.139

**Base Type (Left / Right)**

L / K	L
1.708 - 2.799	2.799 - 3.139

**Shoulder Type & Width (Left / Right)**

2 (8'/8')	
0 - 5.767	

**Resurface Year**

2021	
------	--

**Through Lanes**

4	
---	--

**Street Name**

TODAVE	
0 - 4.9	

- Non-divided Highway
- Divided Highway
- Secondary Segment
- Corporation
- Bridge (on route)
- Underpass
- Overpass
- Railroad (at grade)
- Railroad (underpass)
- Railroad (overpass)
- Intersection

Created on: 7/8/2025

transportation.ohio.gov

Prepared by  
The Ohio Department of Transportation  
Office of Technical Services  
Roadway Information

# STRUSR00045\*\*C

State True Log

47.859

County True Log

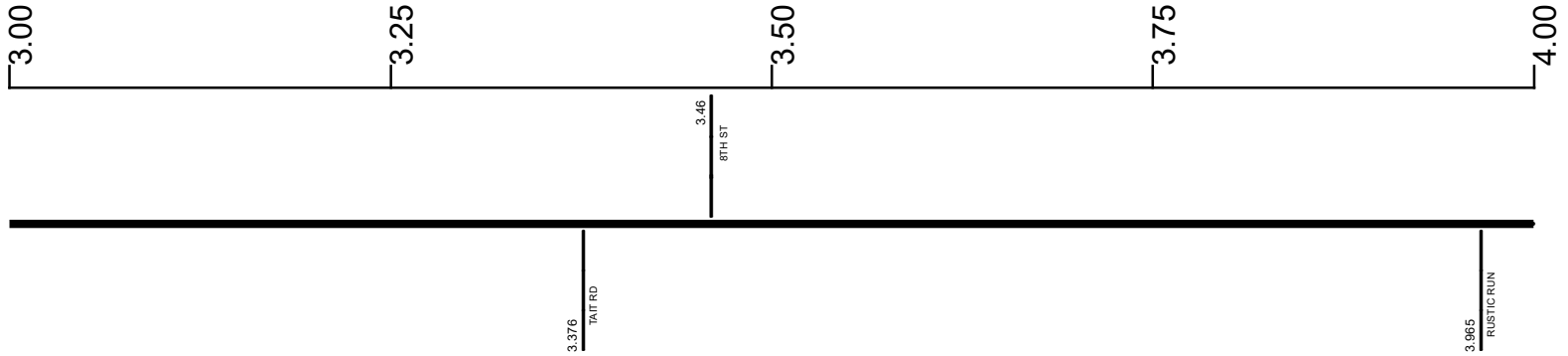

**Surface Type & Width (Left / Right)**

G 50'	G (35/15')	G (28/22')
2.799 - 3.139	3.139 - 3.799	3.799 - 4.63

**Base Type (Left / Right)**

L	L / K
2.799 - 3.139	3.139 - 4.63

**Shoulder Type & Width (Left / Right)**

	2 (8/8)
	0 - 5.767

**Resurface Year**

	2021
	0 - 5.78

**Through Lanes**

	4
	0 - 7.351

**Street Name**

	TODAVE
	0 - 4.9

- Non-divided Highway
  Bridge (on route)
  Railroad (at grade)
  Intersection
- Divided Highway
  Underpass
  Railroad (underpass)
- Secondary Segment
  Overpass
  Railroad (overpass)
- Corporation**

Created on: 7/8/2025

transportation.ohio.gov

Prepared by

The Ohio Department of Transportation

Office of Technical Services

Roadway Information

# STRUSR00045\*\*C

State True Log

48.859

County True Log

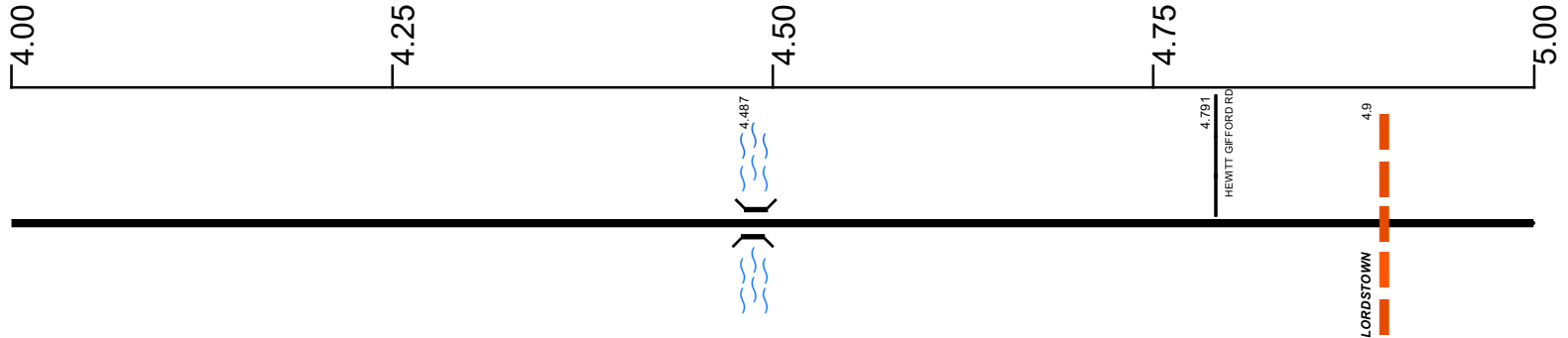

**Surface Type & Width (Left / Right)**

G (28'/22') 3.799 - 4.63	G 50' 4.63 - 5.226
-----------------------------	-----------------------

**Base Type (Left / Right)**

L / K 3.139 - 4.63	L 4.63 - 5.226
-----------------------	-------------------

**Shoulder Type & Width (Left / Right)**

2 (8'/8') 0 - 5.767
------------------------

**Resurface Year**

2021 0 - 5.78
------------------

**Through Lanes**

4 0 - 7.351
----------------

**Street Name**

TODAVE 0 - 4.9	4.9 - 7.315
-------------------	-------------

- Non-divided Highway
  Bridge (on route)
  Railroad (at grade)
  Intersection
- Divided Highway
  Underpass
  Railroad (underpass)
- Secondary Segment
  Overpass
  Railroad (overpass)
- Corporation**

Created on: 7/8/2025

transportation.ohio.gov

Prepared by  
The Ohio Department of Transportation  
Office of Technical Services  
Roadway Information

# STRUSR00045\*\*C

State True Log

49.859

County True Log

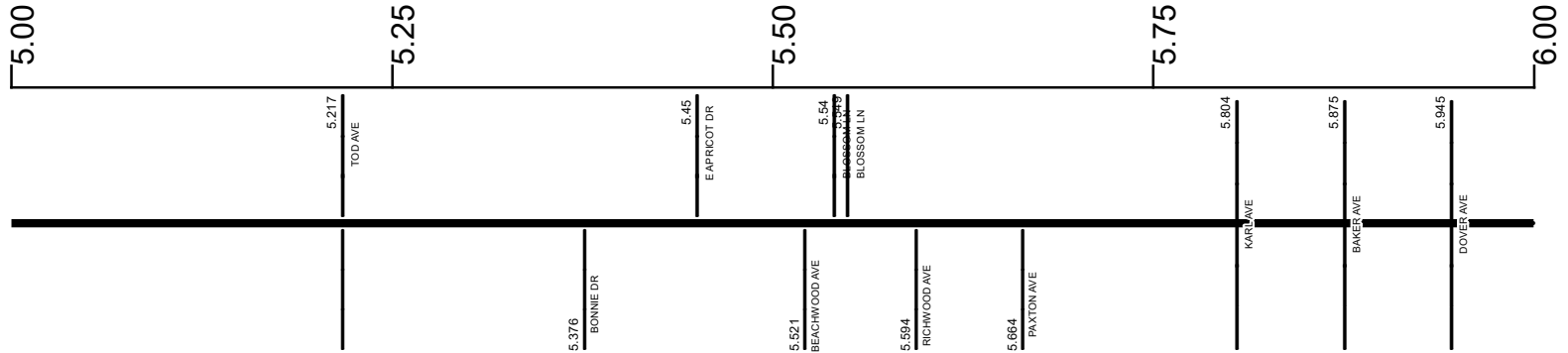

**Surface Type & Width (Left / Right)**

G 50'	G (28'/22')	G (21'/27')
4.63 - 5.226	5.226 - 5.767	5.767 - 6.318

**Base Type (Left / Right)**

L	L / K	K / L
4.63 - 5.226	5.226 - 5.767	5.767 - 6.318

**Shoulder Type & Width (Left / Right)**

2 (8'/8')	1 (0'/0')
0 - 5.767	5.767 - 9.163

**Resurface Year**

2021
0 - 5.78

**Through Lanes**

4
0 - 7.351

**Street Name**

TOD AVE
4.9 - 7.315

- Non-divided Highway
- Divided Highway
- Secondary Segment
- Corporation
- Bridge (on route)
- Underpass
- Overpass
- Railroad (at grade)
- Railroad (underpass)
- Railroad (overpass)
- Intersection

Created on: 7/8/2025

transportation.ohio.gov

Prepared by  
The Ohio Department of Transportation  
Office of Technical Services  
Roadway Information

# STRUSR00045\*\*C

State True Log

50.859

County True Log

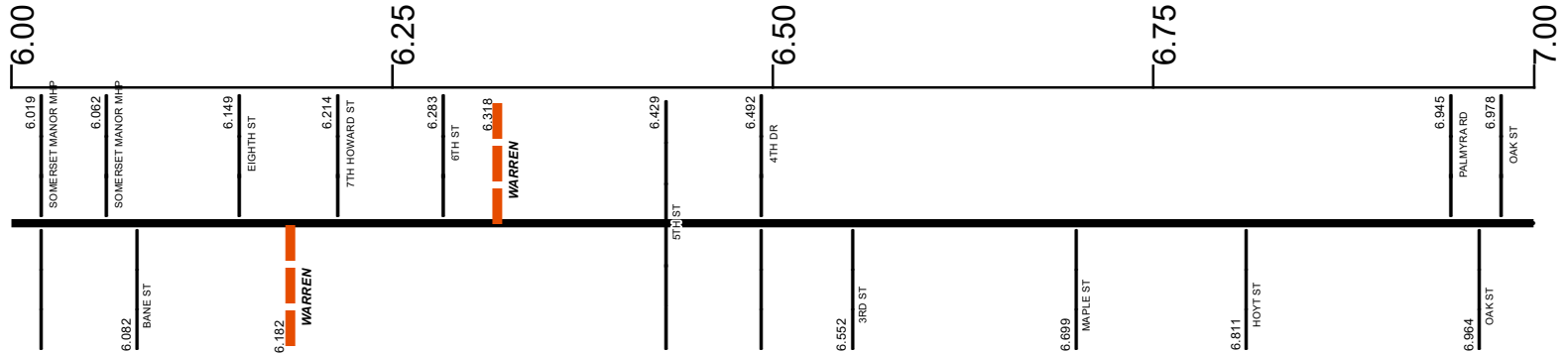

**Surface Type & Width (Left / Right)**

G (21'/27") 5.767 - 6.318	G (22'/26") 6.318 - 6.945	G (30'/18") 6.945 - 7.351
------------------------------	------------------------------	------------------------------

**Base Type (Left / Right)**

K / L 5.767 - 6.318	N / L 6.318 - 6.945	R / L 6.945 - 7.351
------------------------	------------------------	------------------------

**Shoulder Type & Width (Left / Right)**

1 (0'/0") 5.767 - 9.163
----------------------------

**Through Lanes**

4 0 - 7.351
----------------

**Street Name**

TODAVE 4.9 - 7.315
-----------------------

- Non-divided Highway
- Divided Highway
- Secondary Segment
- Corporation
- Bridge (on route)
- Underpass
- Overpass
- Railroad (at grade)
- Railroad (underpass)
- Railroad (overpass)
- Intersection

Created on: 7/8/2025

transportation.ohio.gov

Prepared by  
The Ohio Department of Transportation  
Office of Technical Services  
Roadway Information

# STRUSR00045\*\*C

State True Log

51.859

County True Log

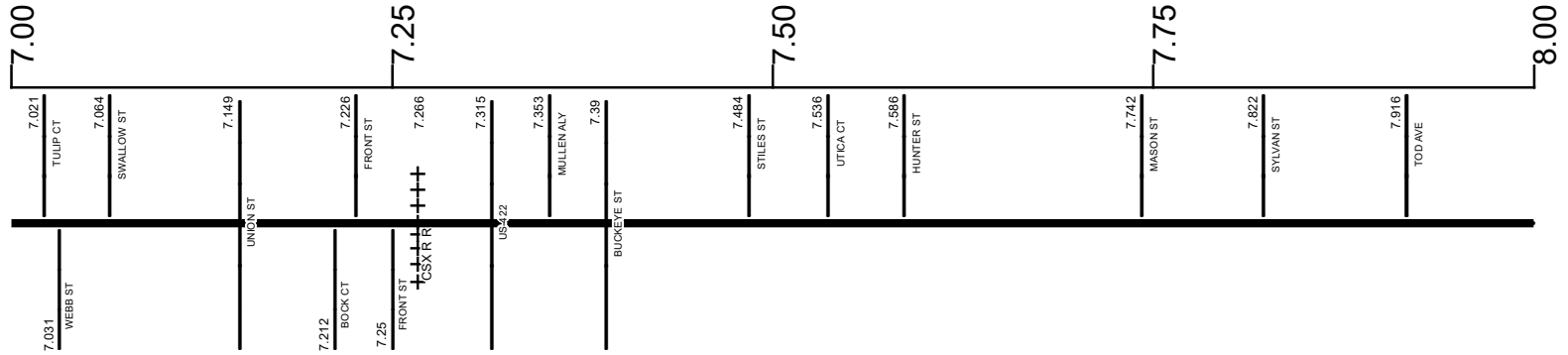

**Surface Type & Width (Left / Right)**

G (30'/18')	G 24'	G 60'
6.945 - 7.351	7.351 - 7.916	7.916 - 8.009

**Base Type (Left / Right)**

R / L	R	N / T
6.945 - 7.351	7.351 - 7.916	7.916 - 8.009

**Shoulder Type & Width (Left / Right)**

1 (0'/0')
5.767 - 9.163

**Through Lanes**

4	2	4
0 - 7.351	7.351 - 7.916	7.916 - 8.212

**Street Name**

TOD AVE	SUMMIT ST
4.9 - 7.315	7.315 - 7.916

- Non-divided Highway
- Divided Highway
- Secondary Segment
- Corporation
- Bridge (on route)
- Underpass
- Overpass
- Railroad (at grade)
- Railroad (underpass)
- Railroad (overpass)
- Intersection

Created on: 7/8/2025

transportation.ohio.gov

Prepared by  
The Ohio Department of Transportation  
Office of Technical Services  
Roadway Information

# STRUSR00045\*\*C

State True Log

52.859

County True Log

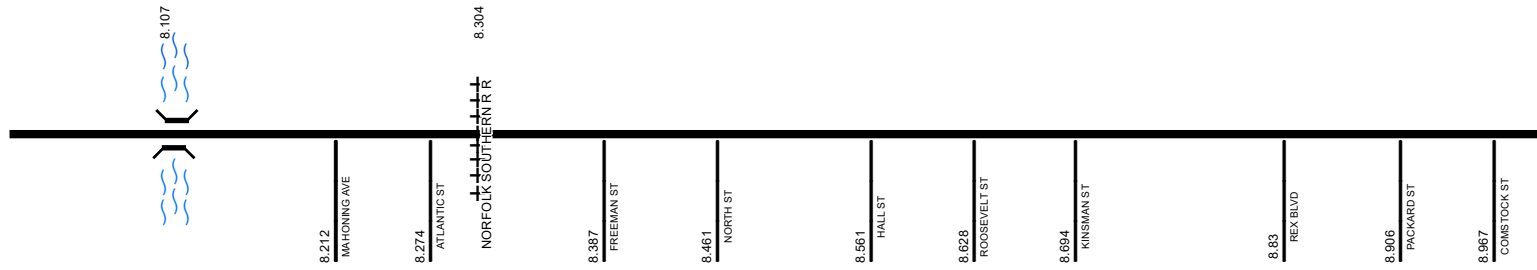
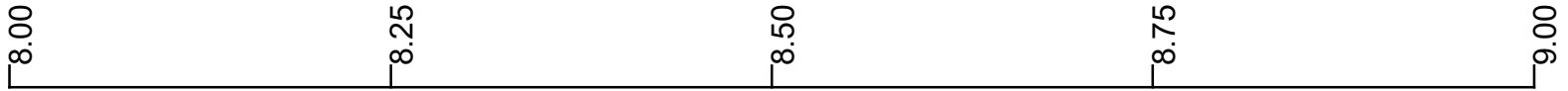

**Surface Type & Width (Left / Right)**

G 60'	G 50'	G 64'	G 30'	G (16'/17')	G 28'
8.009 - 8.077	8.077 - 8.212	8.212 - 8.296		8.296 - 8.839	8.839 - 9.038

**Base Type (Left / Right)**

N/T	N	T	
7.916 - 8.009	8.009 - 8.212	8.212 - 9.038	

**Shoulder Type & Width (Left / Right)**

	1 (0'/0')
	5.767 - 9.163

**Resurface Year**

2024

8.212 - 8.296

**Through Lanes**

4	2
7.916 - 8.212	8.212 - 10.238

**Street Name**

SUMMIT ST	MAHONING AVE
7.916 - 8.212	8.212 - 10.304

- Non-divided Highway
- Divided Highway
- Secondary Segment
- Corporation**
- Bridge (on route)
- Underpass
- Overpass
- Railroad (at grade)
- Railroad (underpass)
- Railroad (overpass)
- Intersection

Created on: 7/8/2025

transportation.ohio.gov

Prepared by  
The Ohio Department of Transportation  
Office of Technical Services  
Roadway Information

# STRUSR00045\*\*C

State True Log

53.859

County True Log

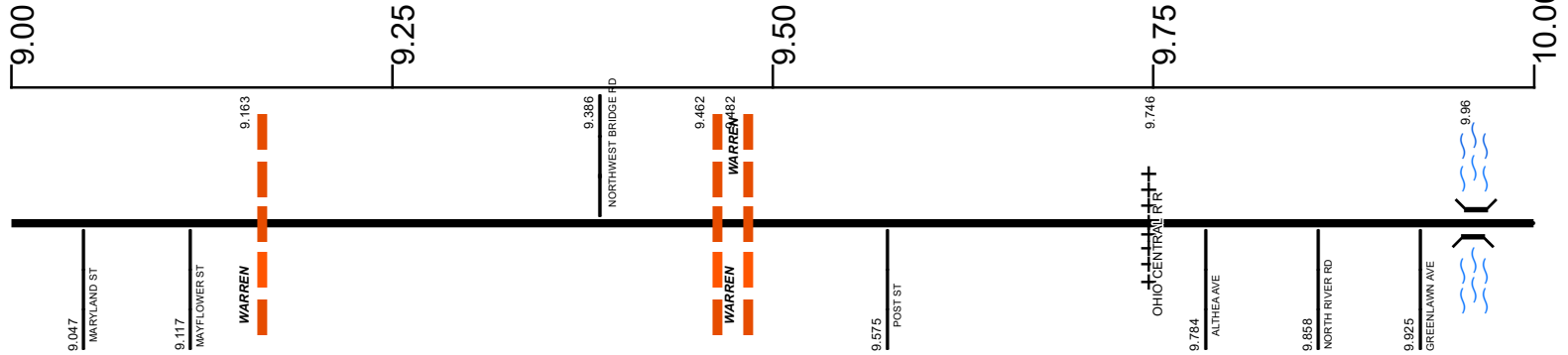

**Surface Type & Width (Left / Right)**

G 28'	G (20'/4')	G (20'/18')	G (20'/28')	G (20'/4')	G (20'/13')
8.839 - 9.038	9.038 - 9.163	9.163 - 9.386	9.386 - 9.872	9.872 - 9.912	9.912 - 10.045

**Base Type (Left / Right)**

T	R / K	R / L	R / K	R / L
8.212 - 9.038	9.038 - 9.163	9.163 - 9.872	9.872 - 9.912	9.912 - 10.045

**Shoulder Type & Width (Left / Right)**

1 (0'/0')	2 (5'/5')	1 (0'/0')
5.767 - 9.163	9.163 - 9.386	9.386 - 10.045

**Through Lanes**

	2	
	8.212 - 10.238	

**Street Name**

	MAHONING AVE	
	8.212 - 10.304	

- Non-divided Highway
- Divided Highway
- Secondary Segment
- Corporation
- Bridge (on route)
- Underpass
- Overpass
- Railroad (at grade)
- Railroad (underpass)
- Railroad (overpass)
- Intersection

Created on: 7/8/2025

transportation.ohio.gov

Prepared by  
The Ohio Department of Transportation  
Office of Technical Services  
Roadway Information

# STRUSR00045\*\*C

State True Log  
County True Log

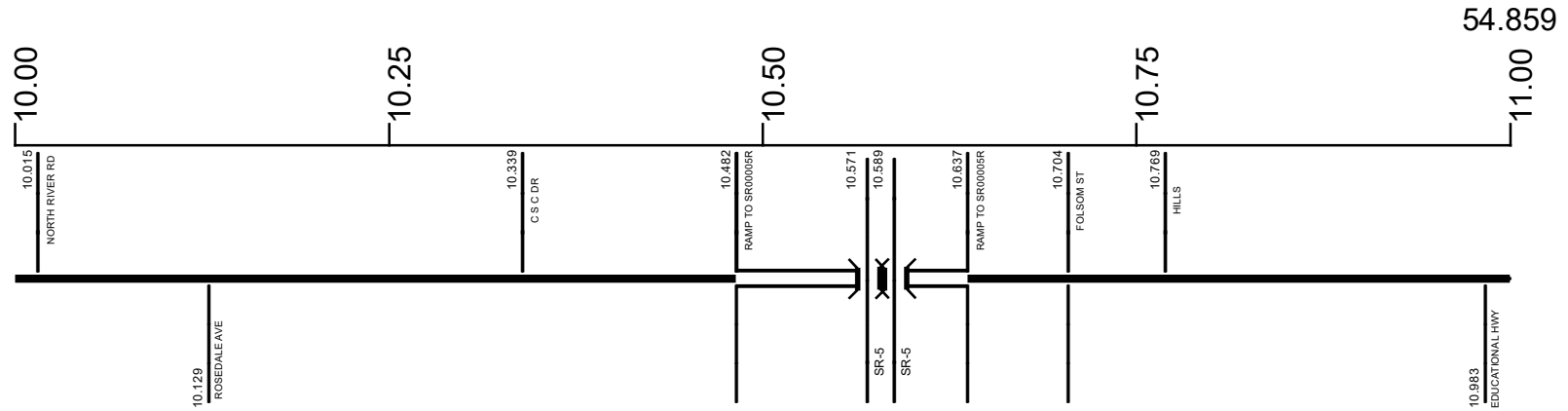

### Surface Type & Width (Left / Right)

G (20'/13')	G (20'/4')	G (16'/32')	G (32'/18')	G 54'	G (32'/40')	G (12'/48')	G (12'/60')
9.912 - 10.045	10.045 - 10.238	10.238 - 10.39	10.39 - 10.482	10.482 - 10.637	10.637 - 10.719	10.719 - 10.859	10.859 - 11

### Base Type (Left / Right)

R / L	R / K	K / L	L / R	R / L	I / L
9.912 - 10.045	10.045 - 10.39	10.39 - 10.482	10.482 - 10.637	10.637 - 10.719	10.719 - 11.307

### Shoulder Type & Width (Left / Right)

1 (0'/0')	2 (6'/6')	1 (0'/0')
9.386 - 10.045	10.045 - 10.238	10.238 - 11.307

### Median Type and Width

4 (16')	3 (16')
10.482 - 10.575	10.575 - 10.637

### Through Lanes

2	4	6	5	6
8.212 - 10.238	10.238 - 10.637	10.637 - 10.719	10.719 - 10.859	10.859 - 11

### Street Name

MAHONING AVE
8.212 - 10.304
10.304 - 15.735

- Non-divided Highway
- Divided Highway
- Secondary Segment
- Corporation
- Bridge (on route)
- Underpass
- Overpass
- Railroad (at grade)
- Railroad (underpass)
- Railroad (overpass)
- Intersection

Created on: 7/8/2025



transportation.ohio.gov  
Prepared by  
The Ohio Department of Transportation  
Office of Technical Services  
Roadway Information

INTERCHANGE  
SRs 5, 45 & 82  
TRUMBULL COUNTY  
INTERCHANGE ID NUMBER = 090500

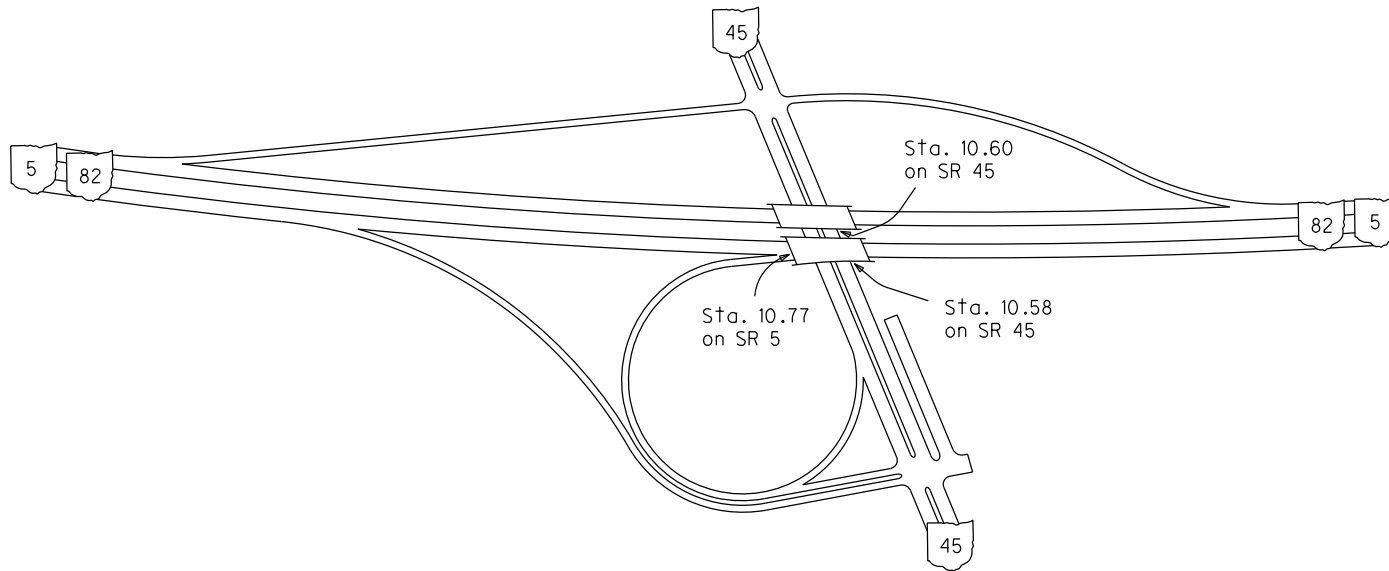

# STRUSR00045\*\*C

State True Log

55.859

County True Log

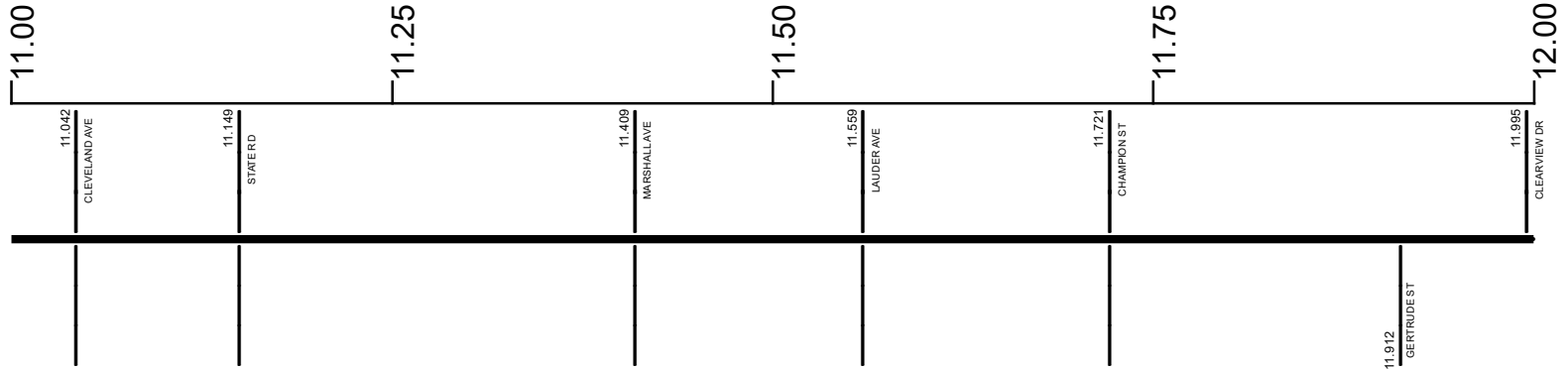

**Surface Type & Width (Left / Right)**

G (12'/48')	G (19'/5')
11 - 11.307	11.307 - 12.898

**Base Type (Left / Right)**

I / L	T / L
10.719 - 11.307	11.307 - 12.898

**Shoulder Type & Width (Left / Right)**

1 (0'/0')	2 (4'/4')
10.238 - 11.307	11.307 - 12.898

**Through Lanes**

5	2
11 - 11.307	11.307 - 26.349

**Street Name**

	MAHONING AVE
	10.304 - 15.735

- |                     |                   |                      |              |
|---------------------|-------------------|----------------------|--------------|
| Non-divided Highway | Bridge (on route) | Railroad (at grade)  | Intersection |
| Divided Highway     | Underpass         | Railroad (underpass) |              |
| Secondary Segment   | Overpass          | Railroad (overpass)  |              |
| Corporation         |                   |                      |              |

Created on: 7/8/2025

transportation.ohio.gov

Prepared by  
The Ohio Department of Transportation  
Office of Technical Services  
Roadway Information

# STRUSR00045\*\*C

State True Log

56.859

County True Log

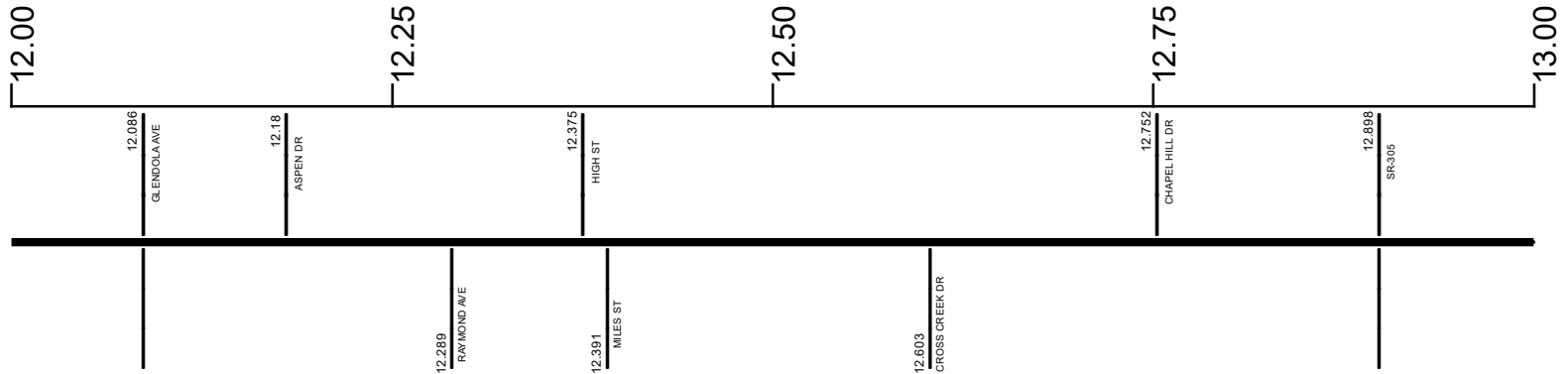

**Surface Type & Width (Left / Right)**

G (19'5')	G (16'8')
11.307 - 12.898	12.898 - 16.696

**Base Type (Left / Right)**

T / L	P / L
11.307 - 12.898	12.898 - 16.696

**Shoulder Type & Width (Left / Right)**

2 (4'4')	2 (10'10')
11.307 - 12.898	12.898 - 21.126

**Through Lanes**

2
11.307 - 26.349

**Street Name**

MAHONING AVE
10.304 - 15.735

- Non-divided Highway
  Bridge (on route)
  Railroad (at grade)
  Intersection
- Divided Highway
  Underpass
  Railroad (underpass)
- Secondary Segment
  Overpass
  Railroad (overpass)
- Corporation**

Created on: 7/8/2025

transportation.ohio.gov

Prepared by  
The Ohio Department of Transportation  
Office of Technical Services  
Roadway Information

# STRUSR00045\*\*C

State True Log

57.859

County True Log

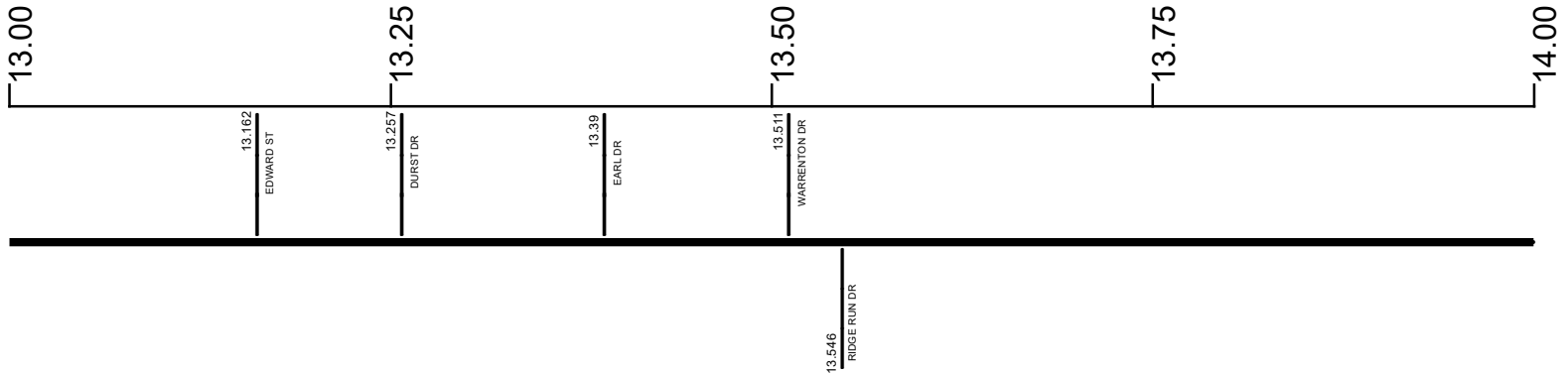

Surface Type & Width (Left / Right)

G (16'/8')  
12.898 - 16.696

Base Type (Left / Right)

P / L  
12.898 - 16.696

Shoulder Type & Width (Left / Right)

2 (10'/10')  
12.898 - 21.126

Through Lanes

2  
11.307 - 26.349

Street Name

MAHONING AVE  
10.304 - 15.735

- |                     |                   |                      |              |
|---------------------|-------------------|----------------------|--------------|
| Non-divided Highway | Bridge (on route) | Railroad (at grade)  | Intersection |
| Divided Highway     | Underpass         | Railroad (underpass) |              |
| Secondary Segment   | Overpass          | Railroad (overpass)  |              |
| Corporation         |                   |                      |              |

Created on: 7/8/2025



transportation.ohio.gov

Prepared by  
The Ohio Department of Transportation  
Office of Technical Services  
Roadway Information

# STRUSR00045\*\*C

State True Log

58.859

County True Log

14.00

14.25

14.50

14.75

15.00

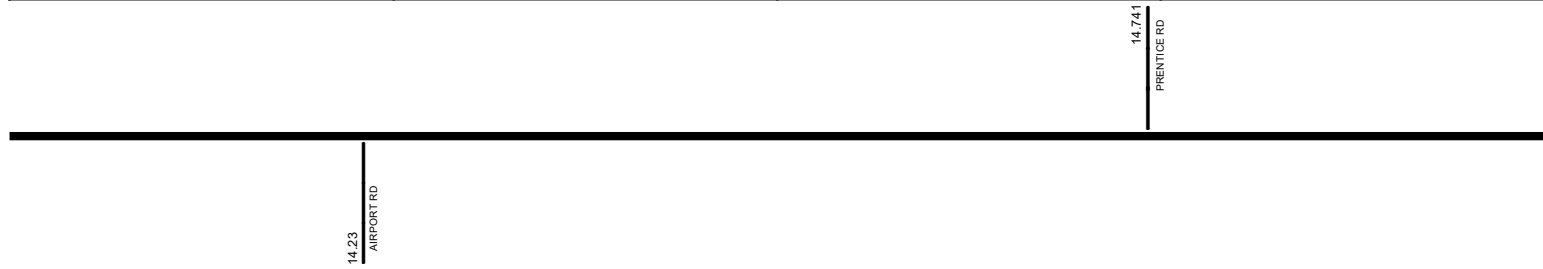

**Surface Type & Width (Left / Right)**

	G (16/8')
	12.898 - 16.696

**Base Type (Left / Right)**

	P / L
	12.898 - 16.696

**Shoulder Type & Width (Left / Right)**

	2 (10/10')
	12.898 - 21.126

**Through Lanes**

	2
	11.307 - 26.349

**Street Name**

	MAHONING AVE
	10.304 - 15.735

<p> Non-divided Highway</p> <p> Divided Highway</p> <p> Secondary Segment</p> <p> Corporation</p>	<p> Bridge (on route)</p> <p> Underpass</p> <p> Overpass</p>	<p> Railroad (at grade)</p> <p> Railroad (underpass)</p> <p> Railroad (overpass)</p>	<p> Intersection</p>
---	--	--	----------------------

Created on: 7/8/2025

transportation.ohio.gov

Prepared by

The Ohio Department of Transportation

Office of Technical Services

Roadway Information

# STRUSR00045\*\*C

State True Log

59.859

County True Log



Surface Type & Width (Left / Right)

G (16/8')  
12.898 - 16.696

Base Type (Left / Right)

P / L  
12.898 - 16.696

Shoulder Type & Width (Left / Right)

2 (10/10')  
12.898 - 21.126

Through Lanes

2  
11.307 - 26.349

Street Name

MAHONING AVE 10.304 - 15.735	SR 45 15.735 - 21.136
---------------------------------	--------------------------

- |                     |                   |                      |              |
|---------------------|-------------------|----------------------|--------------|
| Non-divided Highway | Bridge (on route) | Railroad (at grade)  | Intersection |
| Divided Highway     | Underpass         | Railroad (underpass) |              |
| Secondary Segment   | Overpass          | Railroad (overpass)  |              |
| Corporation         |                   |                      |              |

Created on: 7/8/2025

transportation.ohio.gov

Prepared by  
The Ohio Department of Transportation  
Office of Technical Services  
Roadway Information

# STRUSR00045\*\*C

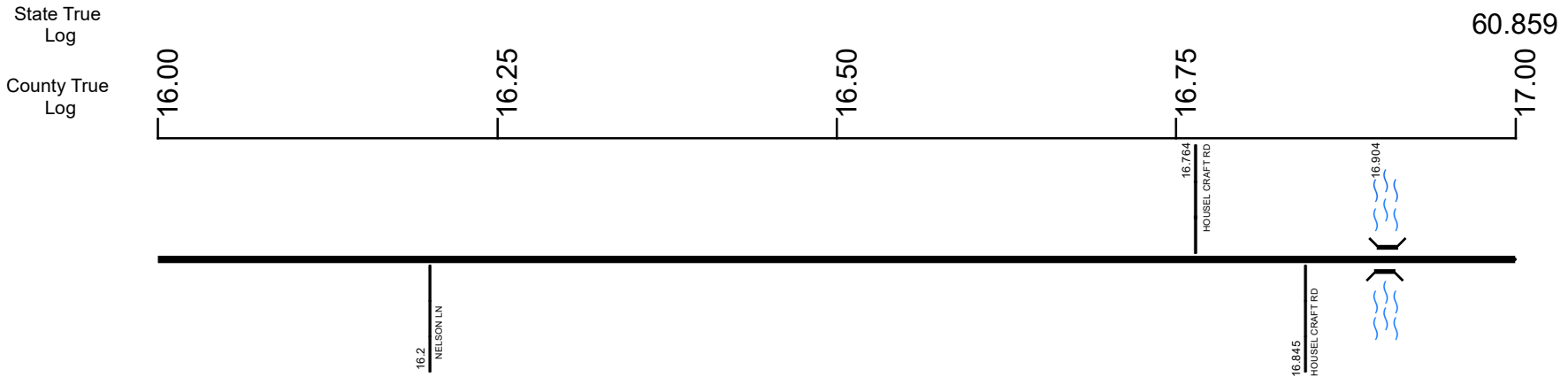

Surface Type & Width (Left / Right)	
G (16'8") 12.898 - 16.696	G 24' 16.696 - 18.304
Base Type (Left / Right)	
P / L 12.898 - 16.696	L 16.696 - 18.304
Shoulder Type & Width (Left / Right)	
2 (10'10") 12.898 - 21.126	
Through Lanes	
2 11.307 - 26.349	
Street Name	
SR 45 15.735 - 21.136	

- Non-divided Highway
- Divided Highway
- Secondary Segment
- Corporation
- Bridge (on route)
- Underpass
- Overpass
- Railroad (at grade)
- Railroad (underpass)
- Railroad (overpass)
- Intersection

Created on: 7/8/2025



transportation.ohio.gov  
Prepared by  
The Ohio Department of Transportation  
Office of Technical Services  
Roadway Information

# STRUSR00045\*\*C

State True Log

61.859

County True Log



17.389  
HYDES SHIFFER RD

17.928  
PHELPS RD

Surface Type & Width (Left / Right)

G 24'  
16.696 - 18.304

Base Type (Left / Right)

L  
16.696 - 18.304

Shoulder Type & Width (Left / Right)

2 (10'/10')  
12.898 - 21.126

Through Lanes

2  
11.307 - 26.349

Street Name

SR 45  
15.735 - 21.136

- |                     |                   |                      |              |
|---------------------|-------------------|----------------------|--------------|
| Non-divided Highway | Bridge (on route) | Railroad (at grade)  | Intersection |
| Divided Highway     | Underpass         | Railroad (underpass) |              |
| Secondary Segment   | Overpass          | Railroad (overpass)  |              |
| Corporation         |                   |                      |              |

Created on: 7/8/2025



transportation.ohio.gov

Prepared by

The Ohio Department of Transportation  
Office of Technical Services  
Roadway Information

# STRUSR00045\*\*C

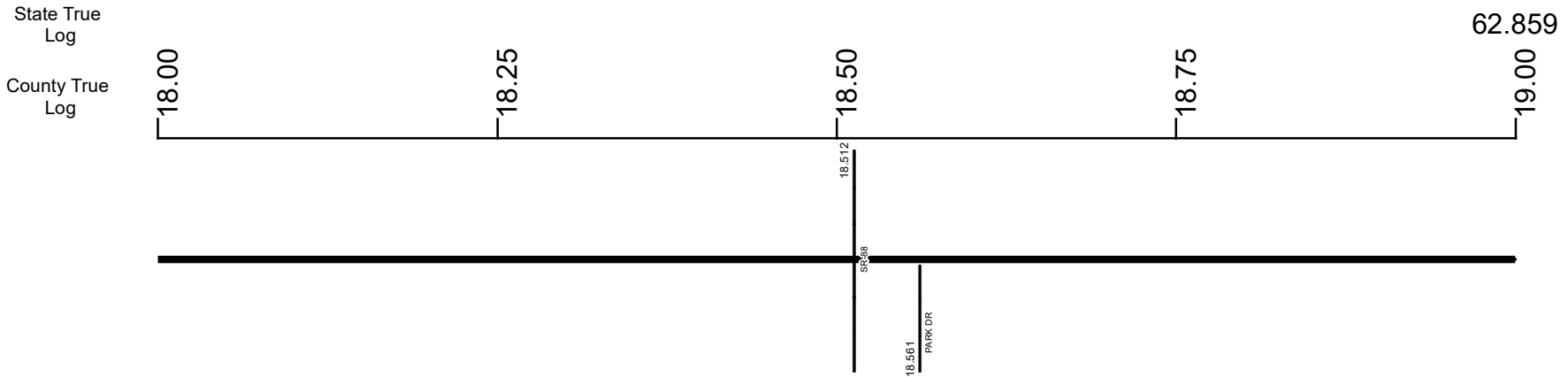

**Surface Type & Width (Left / Right)**

G 24'	G (16/8')
16.696 - 18.304	18.304 - 20.047

**Base Type (Left / Right)**

L	P / L
16.696 - 18.304	18.304 - 20.047

**Shoulder Type & Width (Left / Right)**

2 (10/10')
12.898 - 21.126

**Through Lanes**

2
11.307 - 26.349

**Street Name**

SR 45
15.735 - 21.136

- Non-divided Highway
  Bridge (on route)
  Railroad (at grade)
  Intersection
- Divided Highway
  Underpass
  Railroad (underpass)
- Secondary Segment
  Overpass
  Railroad (overpass)
- Corporation**

Created on: 7/8/2025

transportation.ohio.gov

Prepared by  
The Ohio Department of Transportation  
Office of Technical Services  
Roadway Information

# STRUSR00045\*\*C

State True Log

63.859

County True Log

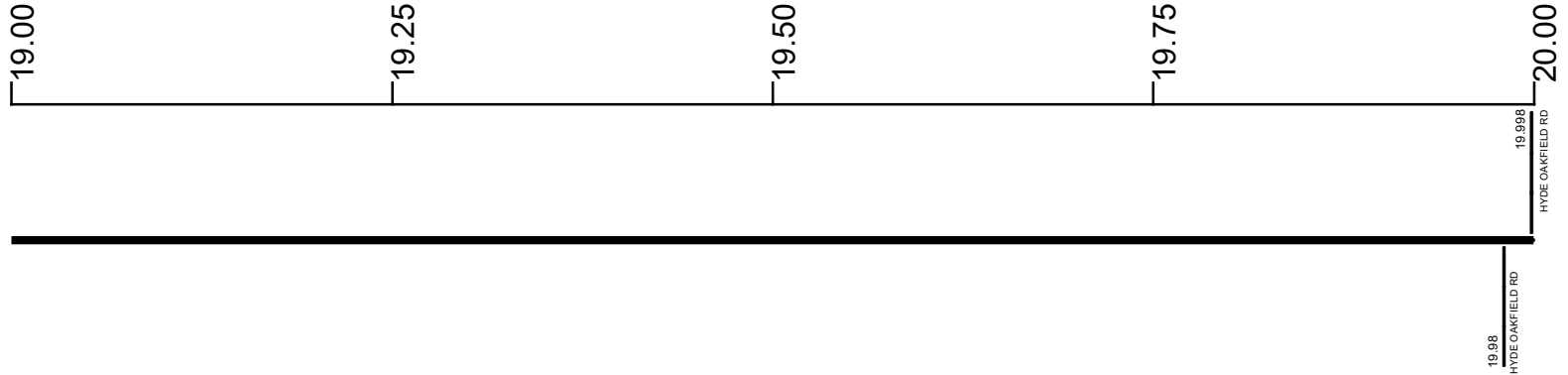

Surface Type & Width (Left / Right)

	G (16'/8')
	18.304 - 20.047

Base Type (Left / Right)

	P / L
	18.304 - 20.047

Shoulder Type & Width (Left / Right)

	2 (10'/10')
	12.898 - 21.126

Through Lanes

	2
	11.307 - 26.349

Street Name

	SR 45
	15.735 - 21.136

- |                     |                   |                      |              |
|---------------------|-------------------|----------------------|--------------|
| Non-divided Highway | Bridge (on route) | Railroad (at grade)  | Intersection |
| Divided Highway     | Underpass         | Railroad (underpass) |              |
| Secondary Segment   | Overpass          | Railroad (overpass)  |              |
| Corporation         |                   |                      |              |

Created on: 7/8/2025

transportation.ohio.gov

Prepared by  
The Ohio Department of Transportation  
Office of Technical Services  
Roadway Information

# STRUSR00045\*\*C

State True  
Log

64.859

County True  
Log

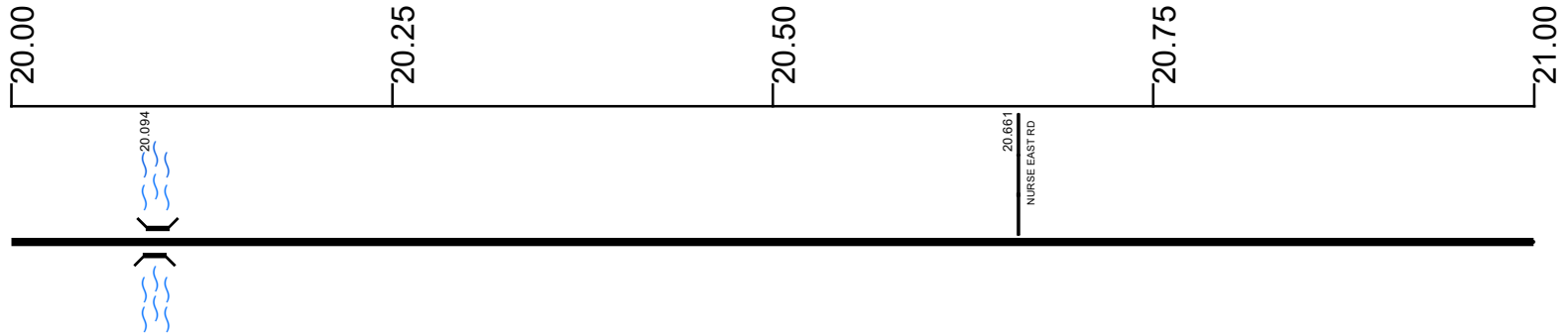

**Surface Type & Width (Left / Right)**

G (16'/8')	G 24'	G (16'/8')
18.304 - 20.047	20.047 - 20.262	20.262 - 26.349

**Base Type (Left / Right)**

P / L	L	P / L
18.304 - 20.047	20.047 - 20.262	20.262 - 21.136

**Shoulder Type & Width (Left / Right)**

	2 (10'/10')	
	12.898 - 21.126	

**Through Lanes**

	2	
	11.307 - 26.349	

**Street Name**

	SR 45	
	15.735 - 21.136	

- Non-divided Highway
  Bridge (on route)
  Railroad (at grade)
  Intersection
- Divided Highway
  Underpass
  Railroad (underpass)
- Secondary Segment
  Overpass
  Railroad (overpass)
- Corporation**

Created on: 7/8/2025

transportation.ohio.gov

Prepared by  
The Ohio Department of Transportation  
Office of Technical Services  
Roadway Information

# STRUSR00045\*\*C

State True Log  
County True Log

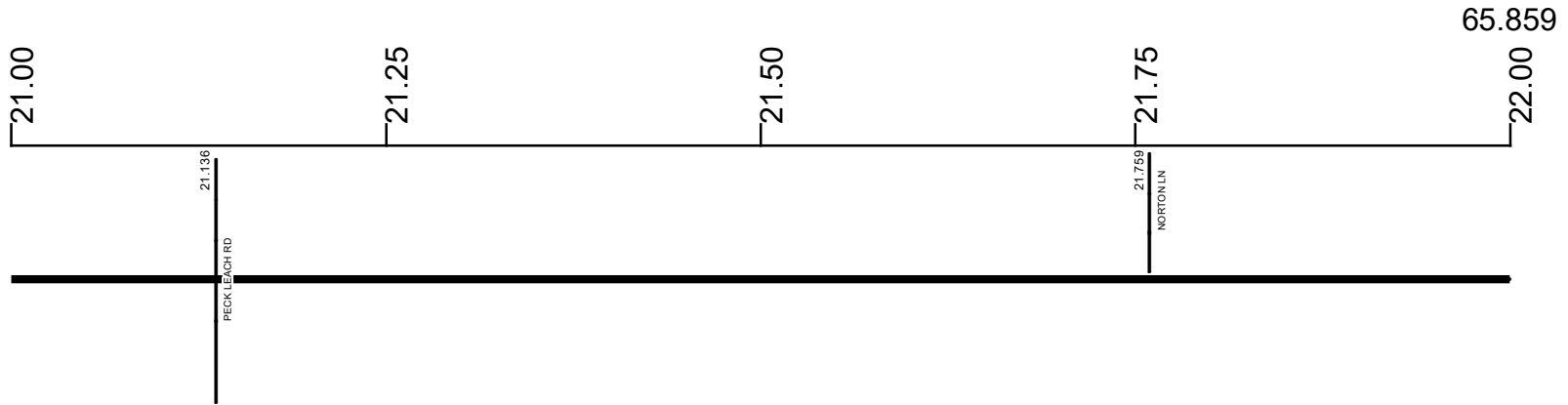

**Surface Type & Width (Left / Right)**

G (16/8')	
20.262 - 26.349	

**Base Type (Left / Right)**

P / L	K / L
20.262 - 21.136	21.136 - 26.349

**Shoulder Type & Width (Left / Right)**

2 (10/10')	4 (0/0')
12.898 - 21.126	21.126 - 26.349

**Through Lanes**

2	
	11.307 - 26.349

**Street Name**

SR 45	
15.735 - 21.136	21.136 - 24.124

- Non-divided Highway
  Bridge (on route)
  Railroad (at grade)
  Intersection
- Divided Highway
  Underpass
  Railroad (underpass)
- Secondary Segment
  Overpass
  Railroad (overpass)
- Corporation**

Created on: 7/8/2025

transportation.ohio.gov

Prepared by  
The Ohio Department of Transportation  
Office of Technical Services  
Roadway Information

# STRUSR00045\*\*C

State True Log

66.859

County True Log

22.00

22.25

22.50

22.75

23.00



Surface Type & Width (Left / Right)

G (16/8')  
20.262 - 26.349

Base Type (Left / Right)

K / L  
21.136 - 26.349

Shoulder Type & Width (Left / Right)

4 (0/0')  
21.126 - 26.349

Through Lanes

2  
11.307 - 26.349

Street Name

SR 45  
21.136 - 24.124

- |                     |                   |                      |              |
|---------------------|-------------------|----------------------|--------------|
| Non-divided Highway | Bridge (on route) | Railroad (at grade)  | Intersection |
| Divided Highway     | Underpass         | Railroad (underpass) |              |
| Secondary Segment   | Overpass          | Railroad (overpass)  |              |
| Corporation         |                   |                      |              |

Created on: 7/8/2025



transportation.ohio.gov

Prepared by  
The Ohio Department of Transportation  
Office of Technical Services  
Roadway Information

# STRUSR00045\*\*C

State True Log

67.859

County True Log

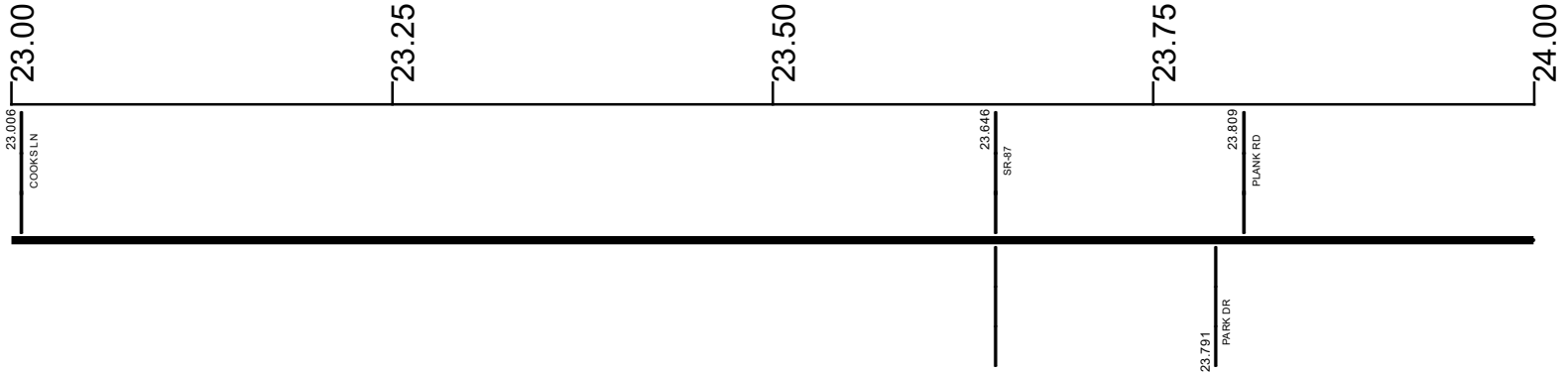

Surface Type & Width (Left / Right)

G (16'/8')  
20.262 - 26.349

Base Type (Left / Right)

K / L  
21.136 - 26.349

Shoulder Type & Width (Left / Right)

4 (0'/0')  
21.126 - 26.349

Through Lanes

2  
11.307 - 26.349

Street Name

SR 45  
21.136 - 24.124

- |                     |                   |                      |              |
|---------------------|-------------------|----------------------|--------------|
| Non-divided Highway | Bridge (on route) | Railroad (at grade)  | Intersection |
| Divided Highway     | Underpass         | Railroad (underpass) |              |
| Secondary Segment   | Overpass          | Railroad (overpass)  |              |
| Corporation         |                   |                      |              |

Created on: 7/8/2025

transportation.ohio.gov

Prepared by  
The Ohio Department of Transportation  
Office of Technical Services  
Roadway Information

# STRUSR00045\*\*C

State True Log

68.859

County True Log



Surface Type & Width (Left / Right)

	G (16/8')
	20.262 - 26.349

Base Type (Left / Right)

	K / L
	21.136 - 26.349

Shoulder Type & Width (Left / Right)

	4 (0/0')
	21.126 - 26.349

Through Lanes

	2
	11.307 - 26.349

Street Name

	SR 45	
21.136 - 24.124	24.124 - 26.349	

- |                     |                   |                      |              |
|---------------------|-------------------|----------------------|--------------|
| Non-divided Highway | Bridge (on route) | Railroad (at grade)  | Intersection |
| Divided Highway     | Underpass         | Railroad (underpass) |              |
| Secondary Segment   | Overpass          | Railroad (overpass)  |              |
| Corporation         |                   |                      |              |

Created on: 7/8/2025

transportation.ohio.gov

Prepared by  
The Ohio Department of Transportation  
Office of Technical Services  
Roadway Information

# STRUSR00045\*\*C

State True  
Log

69.859

County True  
Log

25.00

25.25

25.50

25.75

26.00

25.529  
FLAGE EAST RD

Surface Type & Width (Left / Right)

G (16'/8')  
20.262 - 26.349

Base Type (Left / Right)

K / L  
21.136 - 26.349

Shoulder Type & Width (Left / Right)

4 (0'/0')  
21.126 - 26.349

Through Lanes

2  
11.307 - 26.349

Street Name

SR 45  
24.124 - 26.349

- |                     |                   |                      |              |
|---------------------|-------------------|----------------------|--------------|
| Non-divided Highway | Bridge (on route) | Railroad (at grade)  | Intersection |
| Divided Highway     | Underpass         | Railroad (underpass) |              |
| Secondary Segment   | Overpass          | Railroad (overpass)  |              |
| Corporation         |                   |                      |              |

Created on: 7/8/2025

# STRUSR00045\*\*C

State True Log

70.208

County True Log



26.349  
MICHAMER RD

**Surface Type & Width (Left / Right)**

G (16'8")  
20.262 - 26.349

**Base Type (Left / Right)**

K / L  
21.136 - 26.349

**Shoulder Type & Width (Left / Right)**

4 (0'0")  
21.126 - 26.349

**Through Lanes**

2  
11.307 - 26.349

**Street Name**

SR 45  
24.124 - 26.349

- |                     |                   |                      |              |
|---------------------|-------------------|----------------------|--------------|
| Non-divided Highway | Bridge (on route) | Railroad (at grade)  | Intersection |
| Divided Highway     | Underpass         | Railroad (underpass) |              |
| Secondary Segment   | Overpass          | Railroad (overpass)  |              |
| Corporation         |                   |                      |              |

Created on: 7/8/2025

transportation.ohio.gov

Prepared by  
The Ohio Department of Transportation  
Office of Technical Services  
Roadway Information

## Historical Project List for STRUSR00045\*\*C

Begin Measure	End Measure	Project ID Number	Construction Completion Date	Treatment Category	Treatment Type
0.000	5.779	96560	12-2021	Preventive Maintenance	30-Microsurfacing
0.000	5.779	100297	10-2017	Preventive Maintenance	30-Microsurfacing
0.000	6.319	77864	11-2011	Minor Rehabilitation	60-AC Overlay w/Rpr
6.319	7.319	86365	7-2010	Minor Rehabilitation	60-AC Overlay w/Rpr
7.319	7.908	99581	10-2017	Minor Rehabilitation	60-AC Overlay w/Rpr
7.448	7.918	25079	7-2006	Minor Rehabilitation	60-AC Overlay w/Rpr
7.918	8.208	82917	11-2011	Minor Rehabilitation	60-AC Overlay w/Rpr
8.158	9.118	79827	1-2011	Minor Rehabilitation	60-AC Overlay w/Rpr
9.168	9.868	100817	7-2019	Preventive Maintenance	30-Microsurfacing
9.168	9.458	77864	11-2011	Minor Rehabilitation	60-AC Overlay w/Rpr
9.478	10.676	77864	11-2011	Minor Rehabilitation	60-AC Overlay w/Rpr
9.868	10.656	100817	7-2019	Preventive Maintenance	31-DbI Appl Micro
10.656	11.647	98509	8-2020	Minor Rehabilitation	60-AC Overlay w/Rpr
10.676	11.677	18487	10-2005	Minor Rehabilitation	60-AC Overlay w/Rpr
11.647	12.899	100817	7-2019	Preventive Maintenance	30-Microsurfacing
11.677	18.508	13235	10-2005	Minor Rehabilitation	60-AC Overlay w/Rpr
12.899	21.138	100310	9-2016	Minor Rehabilitation	38-Fine Poly AC Overlay
18.508	21.138	19831	6-2005	Minor Rehabilitation	60-AC Overlay w/Rpr
21.088	26.349	84571	8-2013	Minor Rehabilitation	60-AC Overlay w/Rpr
21.138	23.759	101061	9-2023	Preventive Maintenance	25-Chip Seal
21.138	23.759	100935	8-2019	Preventive Maintenance	30-Microsurfacing
21.138	26.349	22792	7-2003	Minor Rehabilitation	60-AC Overlay w/Rpr

# Roadway Codes

## Access Control Journalized

- F - Full Access Control
- L - Limited Access Control
- N - No Access Control

## Access Control Operational

- 1 - Full Access Control
- 2 - Partial Access Control
- 3 - No Access Control

## Base Type

- F - Crack and Seat
- H - Rubblize and Roll
- I - Aggregate Base 304 or Traffic Compacted
- K - Water Bound Macadam
- L - Bituminous Concrete Mix or Penetration Macadam
- N - Plain Concrete
- P - Reinforced Concrete
- R - Brick (Flexible)
- T - Brick (Rigid)

## Direction of Travel

- B - Both (Two-way)
- F - One-way Cardinal
- T - One-way Non-cardinal

## Facility Type

- 1 - One-way Roadway
- 2 - Two-way Roadway
- 4 - Ramp
- 5 - Non-mainline
- 6 - Non-inventory Direction
- 7 - Planned / Unbuilt

## Historical Federal Aid Indicator

- N - Not a FAP Route
- Y - FAP Route

## Functional Classification

- 01 - Interstate
- 02 - Principal Arterial (Freeways)
- 03 - Principal Arterial (Other)
- 04 - Minor Arterial
- 05 - Major Collector
- 06 - Minor Collector
- 07 - Local

## Leave / Reenter Indicator

- Y - Route leaves/reenters at this point
- N - Route does not leave/reenter at this point

## Median Type

- 1 - None
- 2 - Unprotected
- 3 - Curbed
- 4 - Positive Barrier (Unspecified)
- 5 - Positive Barrier (Flexible)
- 6 - Positive Barrier (Semi-rigid)
- 7 - Positive Barrier (Rigid)

## NHS

- N - National Highway System
- H - Congressional Corridor
- 2 - Major Airport
- 3 - Major Port Facility
- 4 - Major Amtrak Station
- 5 - Major Rail / Truck Terminal
- 6 - Major Intercity Bus Terminal
- 7 - Major Public Transit / Multi-modal Passenger Terminal
- 8 - Major Pipeline Terminal
- 9 - Major Ferry Terminal

## Priority System

- G - General
- P - Priority System
- U - Urban

## Scenic Byway Code

- A - All American Road
- N - National Scenic Byway
- S - State Scenic Byway

## Shoulder Type

- 1 - None
- 2 - Surfaced shoulder exists (bituminous concrete {AC})
- 3 - Surfaced shoulder exists (Portland Cement Concrete {PCC})
- 4 - Stabilized shoulder exists (gravel or other granular material)
- 5 - Combination shoulder exists (two or more surface types)
- 6 - Earth shoulder exists
- 7 - Barrier curb exists; no shoulder in front of curb

## Surface Type

- A - Combination
- B - Brick
- C - Continuous Reinforced Concrete
- D - Reinforced Concrete
- E - Plain Concrete
- G - Bituminous Concrete
- I - Chipseal on Granular
- K - Open Graded Bituminous
- L - Chipseal or Micro
- M - Gravel
- U - Unimproved
- X - Right of Way Only