

# STRUSR00087\*\*C

State True Log 37.982

38.982

County True Log

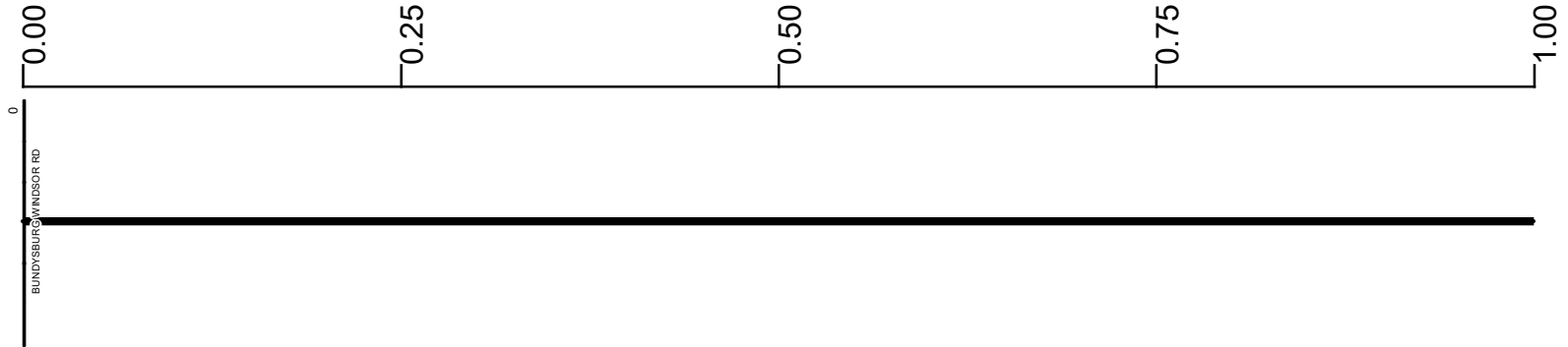

**Surface Type & Width (Left / Right)**

	G (17'5')
	0 - 2.266

**Base Type (Left / Right)**

	K / L
	0 - 7.058

**Shoulder Type & Width (Left / Right)**

	2 (8'8')
	0 - 2.062

**Through Lanes**

	2
	0 - 22.288

**Street Name**

	SR 87
	0 - 5.172

- |  |   |   |   |
|--|---|---|---|
| <ul style="list-style-type: none"> <li> Non-divided Highway</li> <li> Divided Highway</li> <li> Secondary Segment</li> <li> Corporation</li> </ul> | <ul style="list-style-type: none"> <li> Bridge (on route)</li> <li> Underpass</li> <li> Overpass</li> </ul> | <ul style="list-style-type: none"> <li> Railroad (at grade)</li> <li> Railroad (underpass)</li> <li> Railroad (overpass)</li> </ul> | <ul style="list-style-type: none"> <li> Intersection</li> </ul> |
|--|---|---|---|

Created on: 7/8/2025

transportation.ohio.gov

Prepared by  
The Ohio Department of Transportation  
Office of Technical Services  
Roadway Information

# STRUSR00087\*\*C

State True Log

39.982

County True Log

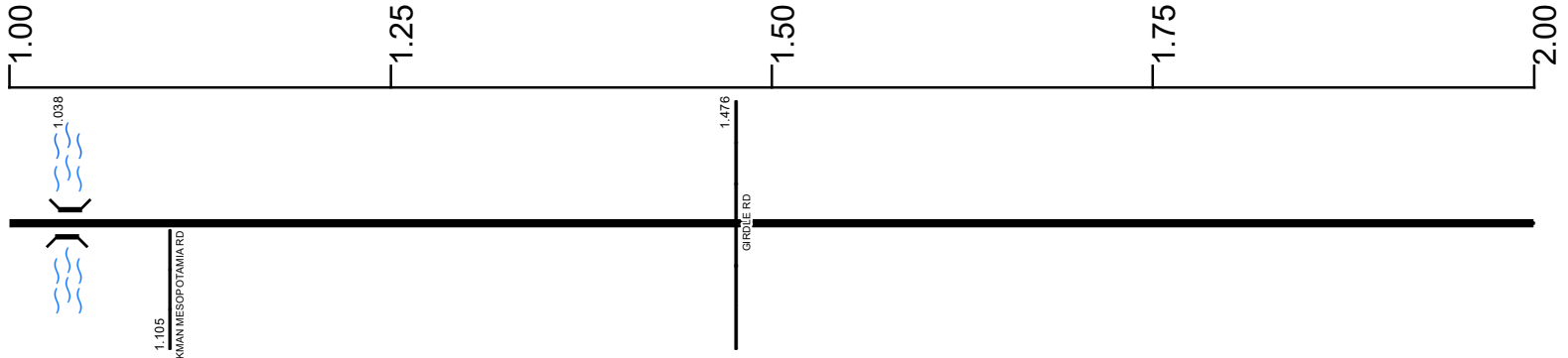

Surface Type & Width (Left / Right)

	G (17'5')
	0 - 2.266

Base Type (Left / Right)

	K / L
	0 - 7.058

Shoulder Type & Width (Left / Right)

	2 (8'8')
	0 - 2.062

Through Lanes

	2
	0 - 22.288

Street Name

	SR 87
	0 - 5.172

- |  |   |   |   |
|--|---|---|---|
| <ul style="list-style-type: none"> <li> Non-divided Highway</li> <li> Divided Highway</li> <li> Secondary Segment</li> <li> Corporation</li> </ul> | <ul style="list-style-type: none"> <li> Bridge (on route)</li> <li> Underpass</li> <li> Overpass</li> </ul> | <ul style="list-style-type: none"> <li> Railroad (at grade)</li> <li> Railroad (underpass)</li> <li> Railroad (overpass)</li> </ul> | <ul style="list-style-type: none"> <li> Intersection</li> </ul> |
|--|---|---|---|

Created on: 7/8/2025

transportation.ohio.gov

Prepared by  
The Ohio Department of Transportation  
Office of Technical Services  
Roadway Information

# STRUSR00087\*\*C

State True Log

40.982

County True Log

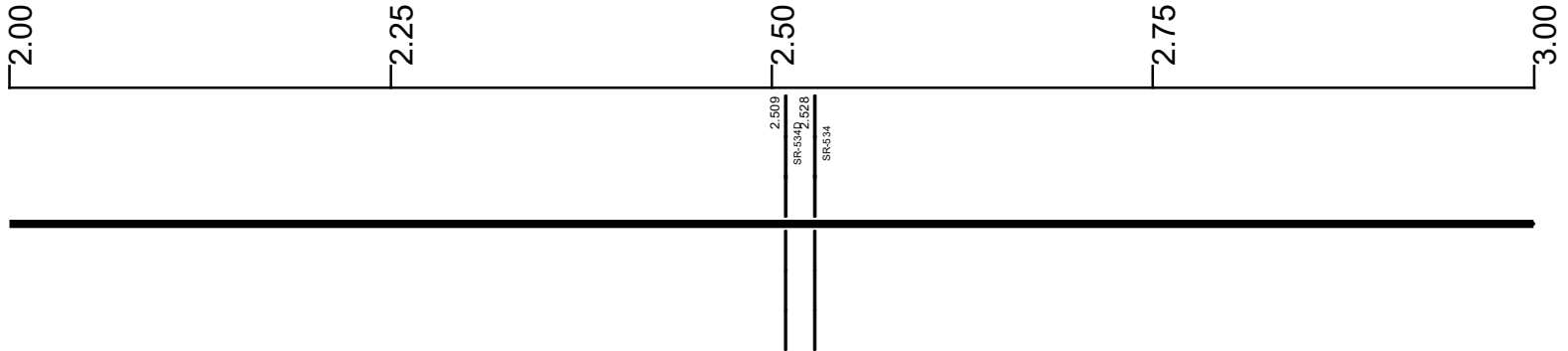

**Surface Type & Width (Left / Right)**

G (17'5") 0 - 2.266	G (17'7") 2.266 - 3.559
------------------------	----------------------------

**Base Type (Left / Right)**

K / L 0 - 7.058	
--------------------	--

**Shoulder Type & Width (Left / Right)**

2 (8'8") 0 - 2.062	2 (5'5") 2.062 - 2.266	2 (7'7") 2.266 - 7.058
-----------------------	---------------------------	---------------------------

**Resurface Year**

2022 2.26 - 7.058
----------------------

**Through Lanes**

2 0 - 22.288
-----------------

**Street Name**

SR 87 0 - 5.172
--------------------

- Non-divided Highway
- Divided Highway
- Secondary Segment
- Corporation
- Bridge (on route)
- Underpass
- Overpass
- Railroad (at grade)
- Railroad (underpass)
- Railroad (overpass)
- Intersection

Created on: 7/8/2025

transportation.ohio.gov

Prepared by  
The Ohio Department of Transportation  
Office of Technical Services  
Roadway Information

# STRUSR00087\*\*C

State True Log

41.982

County True Log

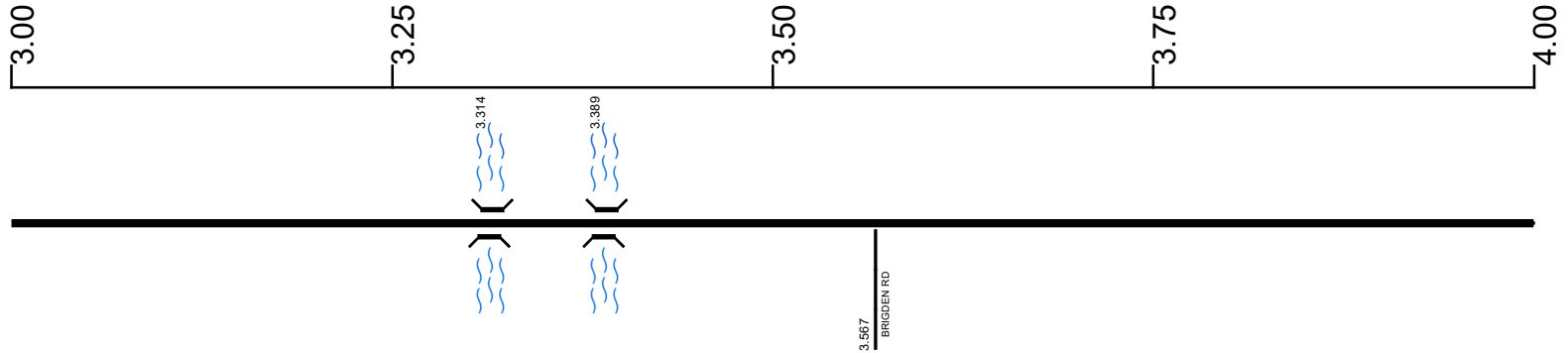

**Surface Type & Width (Left / Right)**

G (17'7") 2.266 - 3.559	G (18'6") 3.559 - 7.058
----------------------------	----------------------------

**Base Type (Left / Right)**

K / L 0 - 7.058	
--------------------	--

**Shoulder Type & Width (Left / Right)**

2 (7'7") 2.266 - 7.058	
---------------------------	--

**Resurface Year**

2022	
------	--

**Through Lanes**

2 0 - 22.288	
-----------------	--

**Street Name**

SR 87 0 - 5.172	
--------------------	--

- Non-divided Highway
- Divided Highway
- Secondary Segment
- Corporation
- Bridge (on route)
- Underpass
- Overpass
- Railroad (at grade)
- Railroad (underpass)
- Railroad (overpass)
- Intersection

Created on: 7/8/2025

transportation.ohio.gov

Prepared by  
 The Ohio Department of Transportation  
 Office of Technical Services  
 Roadway Information

# STRUSR00087\*\*C

State True Log

42.982

County True Log

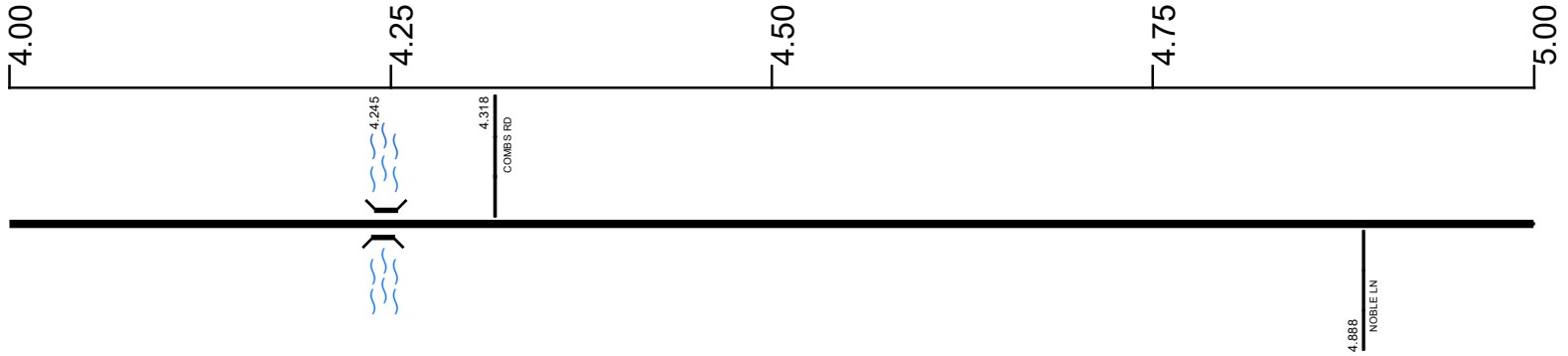

Surface Type & Width (Left / Right)

G (18/6')  
3.559 - 7.058

Base Type (Left / Right)

K / L  
0 - 7.058

Shoulder Type & Width (Left / Right)

2 (7/7')  
2.266 - 7.058

Resurface Year

2022  
2.26 - 7.058

Through Lanes

2  
0 - 22.288

Street Name

SR 87  
0 - 5.172

- |                     |                   |                      |              |
|---------------------|-------------------|----------------------|--------------|
| Non-divided Highway | Bridge (on route) | Railroad (at grade)  | Intersection |
| Divided Highway     | Underpass         | Railroad (underpass) |              |
| Secondary Segment   | Overpass          | Railroad (overpass)  |              |
| Corporation         |                   |                      |              |

Created on: 7/8/2025

transportation.ohio.gov

Prepared by  
The Ohio Department of Transportation  
Office of Technical Services  
Roadway Information

# STRUSR00087\*\*C

State True Log

43.982

County True Log

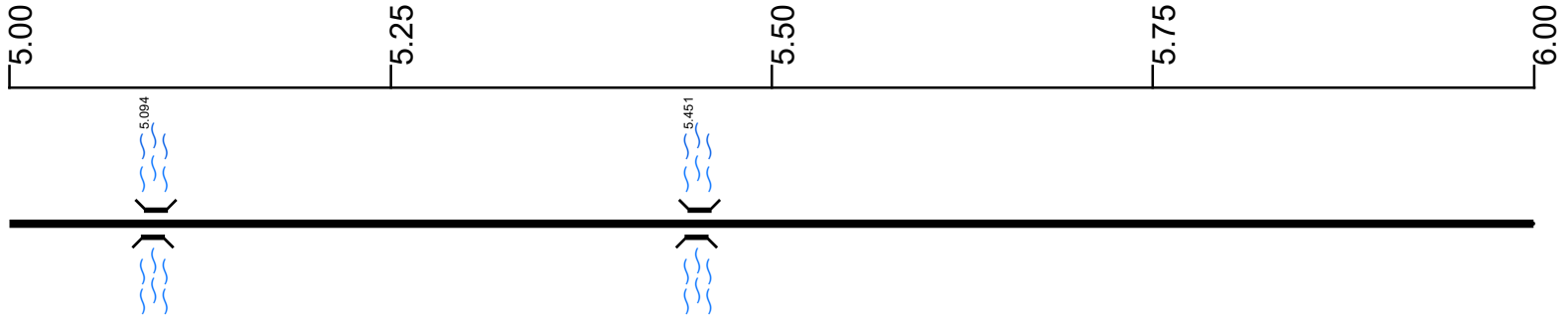

Surface Type & Width (Left / Right)

G (18/6')  
3.559 - 7.058

Base Type (Left / Right)

K / L  
0 - 7.058

Shoulder Type & Width (Left / Right)

2 (7/7')  
2.266 - 7.058

Resurface Year

2022  
2.26 - 7.058

Through Lanes

2  
0 - 22.288

Street Name

0 - 5.172	SR 87	5.172 - 7.058
-----------	-------	---------------

- |  |   |   |   |
|--|---|---|---|
| <ul style="list-style-type: none"> <li> Non-divided Highway</li> <li> Divided Highway</li> <li> Secondary Segment</li> <li> Corporation</li> </ul> | <ul style="list-style-type: none"> <li> Bridge (on route)</li> <li> Underpass</li> <li> Overpass</li> </ul> | <ul style="list-style-type: none"> <li> Railroad (at grade)</li> <li> Railroad (underpass)</li> <li> Railroad (overpass)</li> </ul> | <ul style="list-style-type: none"> <li> Intersection</li> </ul> |
|--|---|---|---|

Created on: 7/8/2025

transportation.ohio.gov

Prepared by  
The Ohio Department of Transportation  
Office of Technical Services  
Roadway Information

# STRUSR00087\*\*C

State True Log

44.982

County True Log



Surface Type & Width (Left / Right)

G (18/6')  
3.559 - 7.058

Base Type (Left / Right)

K / L  
0 - 7.058

Shoulder Type & Width (Left / Right)

2 (7/7')  
2.266 - 7.058

Resurface Year

2022  
2.26 - 7.058

Through Lanes

2  
0 - 22.288

Street Name

SR 87  
5.172 - 7.058

- |                     |                   |                      |              |
|---------------------|-------------------|----------------------|--------------|
| Non-divided Highway | Bridge (on route) | Railroad (at grade)  | Intersection |
| Divided Highway     | Underpass         | Railroad (underpass) |              |
| Secondary Segment   | Overpass          | Railroad (overpass)  |              |
| Corporation         |                   |                      |              |

Created on: 7/8/2025

transportation.ohio.gov

Prepared by  
The Ohio Department of Transportation  
Office of Technical Services  
Roadway Information

# STRUSR00087\*\*C

State True Log

45.982

County True Log

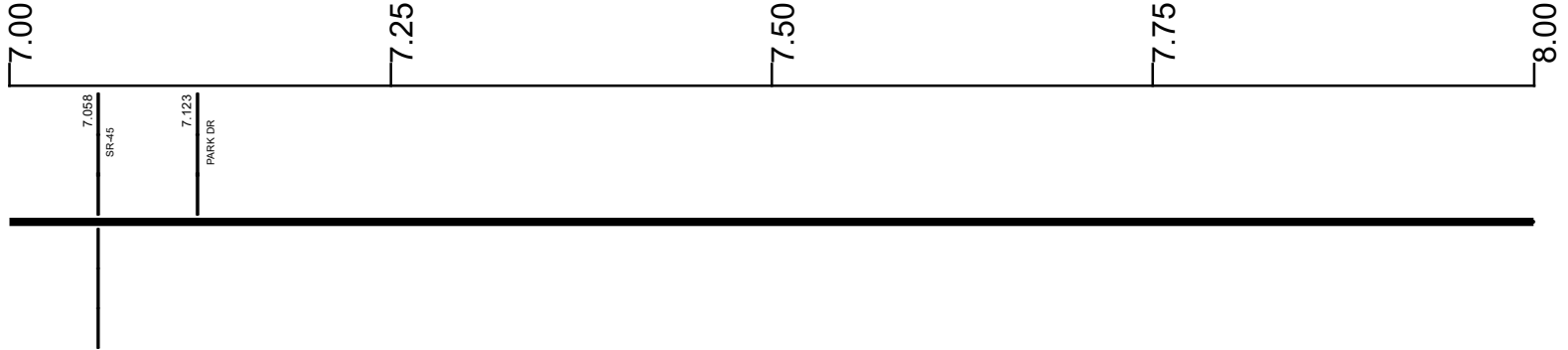

**Surface Type & Width (Left / Right)**

G (18'/6')	G (12'/10')
3.559 - 7.058	7.058 - 8.125

**Base Type (Left / Right)**

K / L	P / K
0 - 7.058	7.058 - 8.125

**Shoulder Type & Width (Left / Right)**

2 (7'/7')	2 (10'/10')
2.266 - 7.058	7.058 - 8.125

**Resurface Year**

2022

2.26 - 7.058

**Through Lanes**

2	2
0 - 22.288	

**Street Name**

SR 87	SR 87
5.172 - 7.058	7.058 - 10.056

Non-divided Highway	Bridge (on route)	Railroad (at grade)	Intersection
Divided Highway	Underpass	Railroad (underpass)	
Secondary Segment	Overpass	Railroad (overpass)	
Corporation			

Created on: 7/8/2025

transportation.ohio.gov

Prepared by  
The Ohio Department of Transportation  
Office of Technical Services  
Roadway Information

# STRUSR00087\*\*C

State True Log

46.982

County True Log

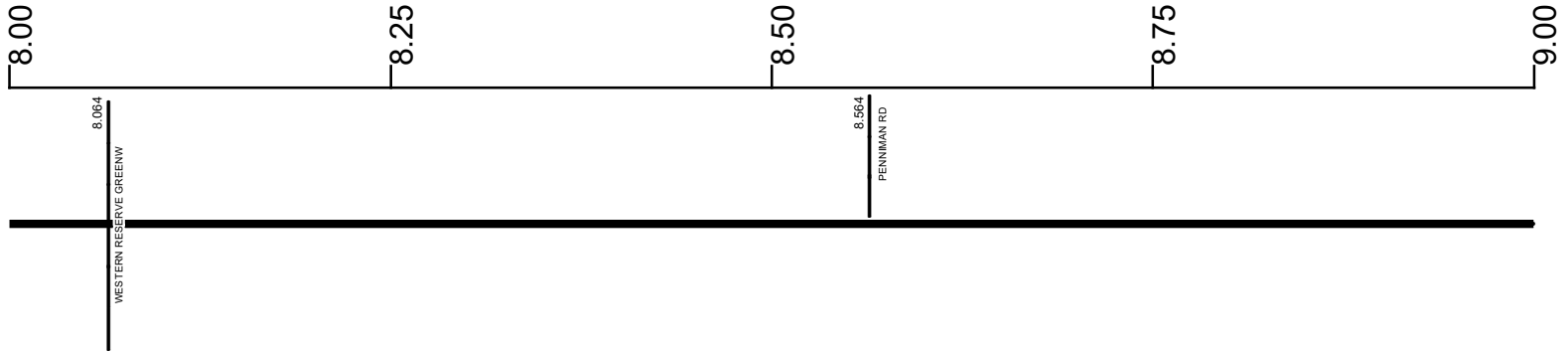

**Surface Type & Width (Left / Right)**

G (12'/10')	G 18'
7.058 - 8.125	8.125 - 15.155

**Base Type (Left / Right)**

P / K	K
7.058 - 8.125	8.125 - 15.155

**Shoulder Type & Width (Left / Right)**

2 (10'/10')	2 (3'/3')
7.058 - 8.125	8.125 - 13.381

**Through Lanes**

	2
	0 - 22.288

**Street Name**

	SR 87
	7.058 - 10.056

- |                     |                   |                      |              |
|---------------------|-------------------|----------------------|--------------|
| Non-divided Highway | Bridge (on route) | Railroad (at grade)  | Intersection |
| Divided Highway     | Underpass         | Railroad (underpass) |              |
| Secondary Segment   | Overpass          | Railroad (overpass)  |              |
| Corporation         |                   |                      |              |

Created on: 7/8/2025

transportation.ohio.gov

Prepared by  
The Ohio Department of Transportation  
Office of Technical Services  
Roadway Information

# STRUSR00087\*\*C

State True Log

47.982

County True Log

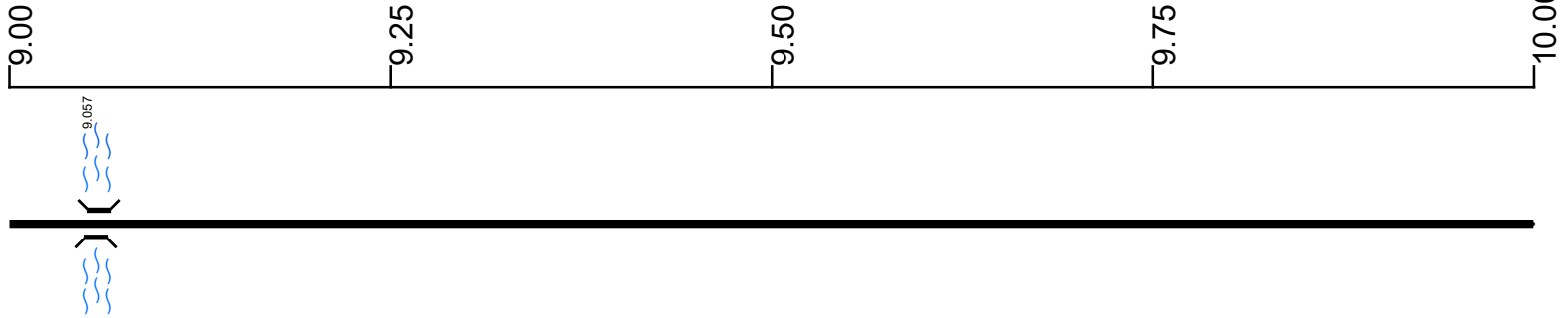

Surface Type & Width (Left / Right)

	G 18'
	8.125 - 15.155

Base Type (Left / Right)

	K
	8.125 - 15.155

Shoulder Type & Width (Left / Right)

	2 (3/3')
	8.125 - 13.381

Through Lanes

	2
	0 - 22.288

Street Name

	SR 87
	7.058 - 10.056

- |                     |                   |                      |              |
|---------------------|-------------------|----------------------|--------------|
| Non-divided Highway | Bridge (on route) | Railroad (at grade)  | Intersection |
| Divided Highway     | Underpass         | Railroad (underpass) |              |
| Secondary Segment   | Overpass          | Railroad (overpass)  |              |
| Corporation         |                   |                      |              |

Created on: 7/8/2025

# STRUSR00087\*\*C

State True Log

48.982

County True Log



Surface Type & Width (Left / Right)

	G 18'
	8.125 - 15.155

Base Type (Left / Right)

	K
	8.125 - 15.155

Shoulder Type & Width (Left / Right)

	2 (3/3')
	8.125 - 13.381

Through Lanes

	2
	0 - 22.288

Street Name

SR 87		KINSMAN RD
7.058 - 10.056		10.056 - 15.155

- |                     |                   |                      |              |
|---------------------|-------------------|----------------------|--------------|
| Non-divided Highway | Bridge (on route) | Railroad (at grade)  | Intersection |
| Divided Highway     | Underpass         | Railroad (underpass) |              |
| Secondary Segment   | Overpass          | Railroad (overpass)  |              |
| Corporation         |                   |                      |              |

Created on: 7/8/2025

transportation.ohio.gov

Prepared by  
The Ohio Department of Transportation  
Office of Technical Services  
Roadway Information

# STRUSR00087\*\*C

State True Log

49.982

County True Log

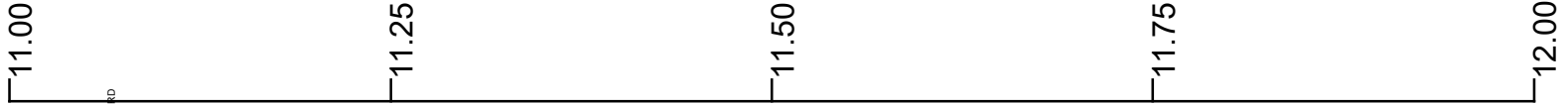

Surface Type & Width (Left / Right)

G 18'  
8.125 - 15.155

Base Type (Left / Right)

K  
8.125 - 15.155

Shoulder Type & Width (Left / Right)

2 (3/3)  
8.125 - 13.381

Through Lanes

2  
0 - 22.288

Street Name

KINSMAN RD  
10.056 - 15.155

- |                     |                   |                      |              |
|---------------------|-------------------|----------------------|--------------|
| Non-divided Highway | Bridge (on route) | Railroad (at grade)  | Intersection |
| Divided Highway     | Underpass         | Railroad (underpass) |              |
| Secondary Segment   | Overpass          | Railroad (overpass)  |              |
| Corporation         |                   |                      |              |

Created on: 7/8/2025



transportation.ohio.gov

Prepared by  
The Ohio Department of Transportation  
Office of Technical Services  
Roadway Information

# STRUSR00087\*\*C

State True Log  
County True Log

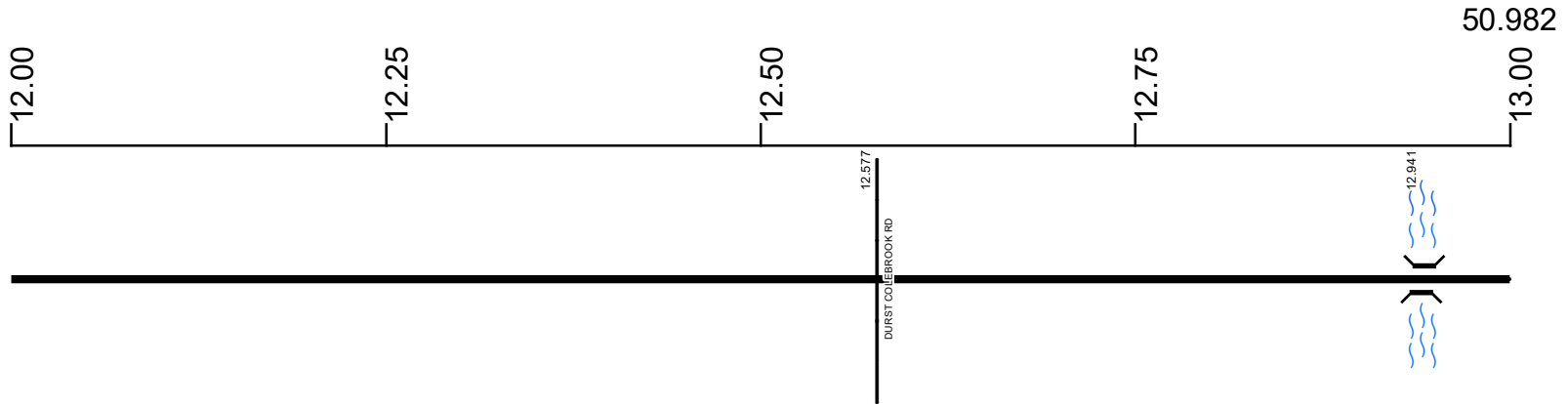

Surface Type & Width (Left / Right)

G 18'  
8.125 - 15.155

Base Type (Left / Right)

K  
8.125 - 15.155

Shoulder Type & Width (Left / Right)

2 (3/3)  
8.125 - 13.381

Through Lanes

2  
0 - 22.288

Street Name

KINSMAN RD  
10.056 - 15.155

- |                     |                   |                      |              |
|---------------------|-------------------|----------------------|--------------|
| Non-divided Highway | Bridge (on route) | Railroad (at grade)  | Intersection |
| Divided Highway     | Underpass         | Railroad (underpass) |              |
| Secondary Segment   | Overpass          | Railroad (overpass)  |              |
| Corporation         |                   |                      |              |

Created on: 7/8/2025



transportation.ohio.gov  
Prepared by  
The Ohio Department of Transportation  
Office of Technical Services  
Roadway Information

# STRUSR00087\*\*C

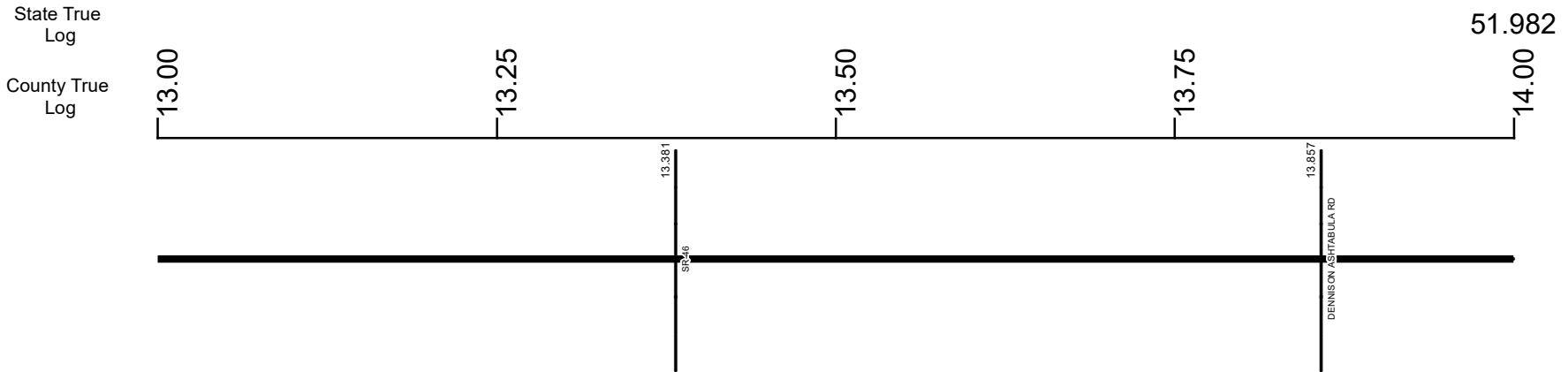

Surface Type & Width (Left / Right)	G 18'
	8.125 - 15.155
Base Type (Left / Right)	K
	8.125 - 15.155
Shoulder Type & Width (Left / Right)	
2 (3/3')	2 (2/2')
8.125 - 13.381	13.381 - 15.155
Resurface Year	2022
	13.378 - 22.288
Through Lanes	2
	0 - 22.288
Street Name	KINSMAN RD
	10.056 - 15.155

- Non-divided Highway
- Divided Highway
- Secondary Segment
- Corporation
- Bridge (on route)
- Underpass
- Overpass
- Railroad (at grade)
- Railroad (underpass)
- Railroad (overpass)
- Intersection

Created on: 7/8/2025

transportation.ohio.gov

Prepared by  
 The Ohio Department of Transportation  
 Office of Technical Services  
 Roadway Information

# STRUSR00087\*\*C

State True Log

52.982

County True Log



Surface Type & Width (Left / Right)

G 18'  
8.125 - 15.155

Base Type (Left / Right)

K  
8.125 - 15.155

Shoulder Type & Width (Left / Right)

2 (2'/2')  
13.381 - 15.155

Resurface Year

2022

Through Lanes

2  
0 - 22.288

Street Name

KINSMAN RD  
10.056 - 15.155

- |                     |                   |                      |              |
|---------------------|-------------------|----------------------|--------------|
| Non-divided Highway | Bridge (on route) | Railroad (at grade)  | Intersection |
| Divided Highway     | Underpass         | Railroad (underpass) |              |
| Secondary Segment   | Overpass          | Railroad (overpass)  |              |
| Corporation         |                   |                      |              |

Created on: 7/8/2025



transportation.ohio.gov  
 Prepared by  
 The Ohio Department of Transportation  
 Office of Technical Services  
 Roadway Information

# STRUSR00087\*\*C

State True Log

53.982

County True Log

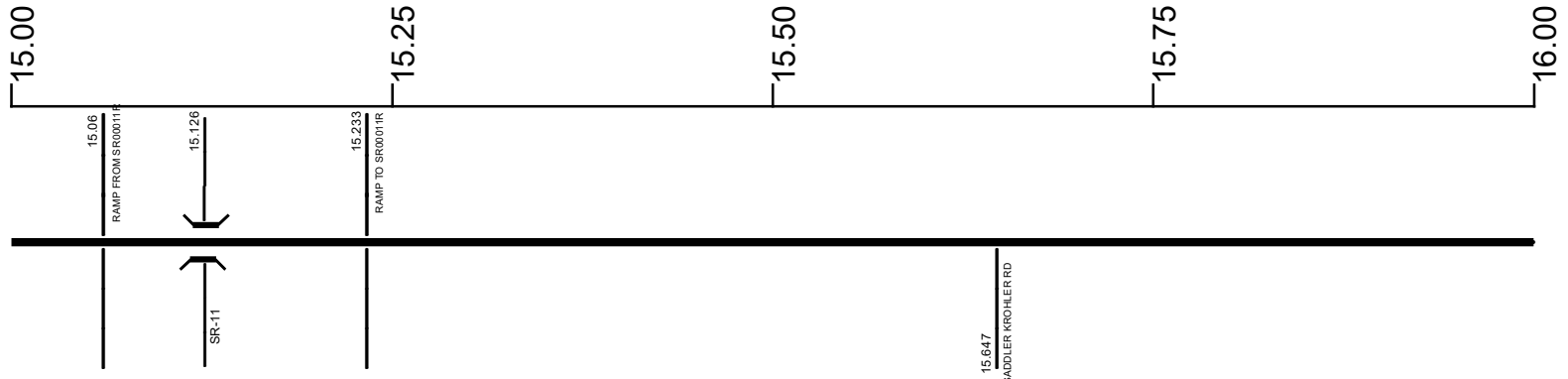

**Surface Type & Width (Left / Right)**

G 18'	G 24'	G 18'
8.125 - 15.155	15.155 - 15.313	15.313 - 19.935

**Base Type (Left / Right)**

K	L	K
8.125 - 15.155	15.155 - 15.313	15.313 - 20.638

**Shoulder Type & Width (Left / Right)**

2 (2'2")	2 (10'/10')	2 (2'2")
13.381 - 15.155	15.155 - 15.313	15.313 - 17.591

**Resurface Year**

	2022	
	13.378 - 22.288	

**Through Lanes**

	2	
	0 - 22.288	

**Street Name**

KINSMAN RD		SR 87
10.056 - 15.155		15.155 - 22.288

- Non-divided Highway
- Divided Highway
- Secondary Segment
- Corporation
- Bridge (on route)
- Underpass
- Overpass
- Railroad (at grade)
- Railroad (underpass)
- Railroad (overpass)
- Intersection

Created on: 7/8/2025

transportation.ohio.gov

Prepared by  
The Ohio Department of Transportation  
Office of Technical Services  
Roadway Information

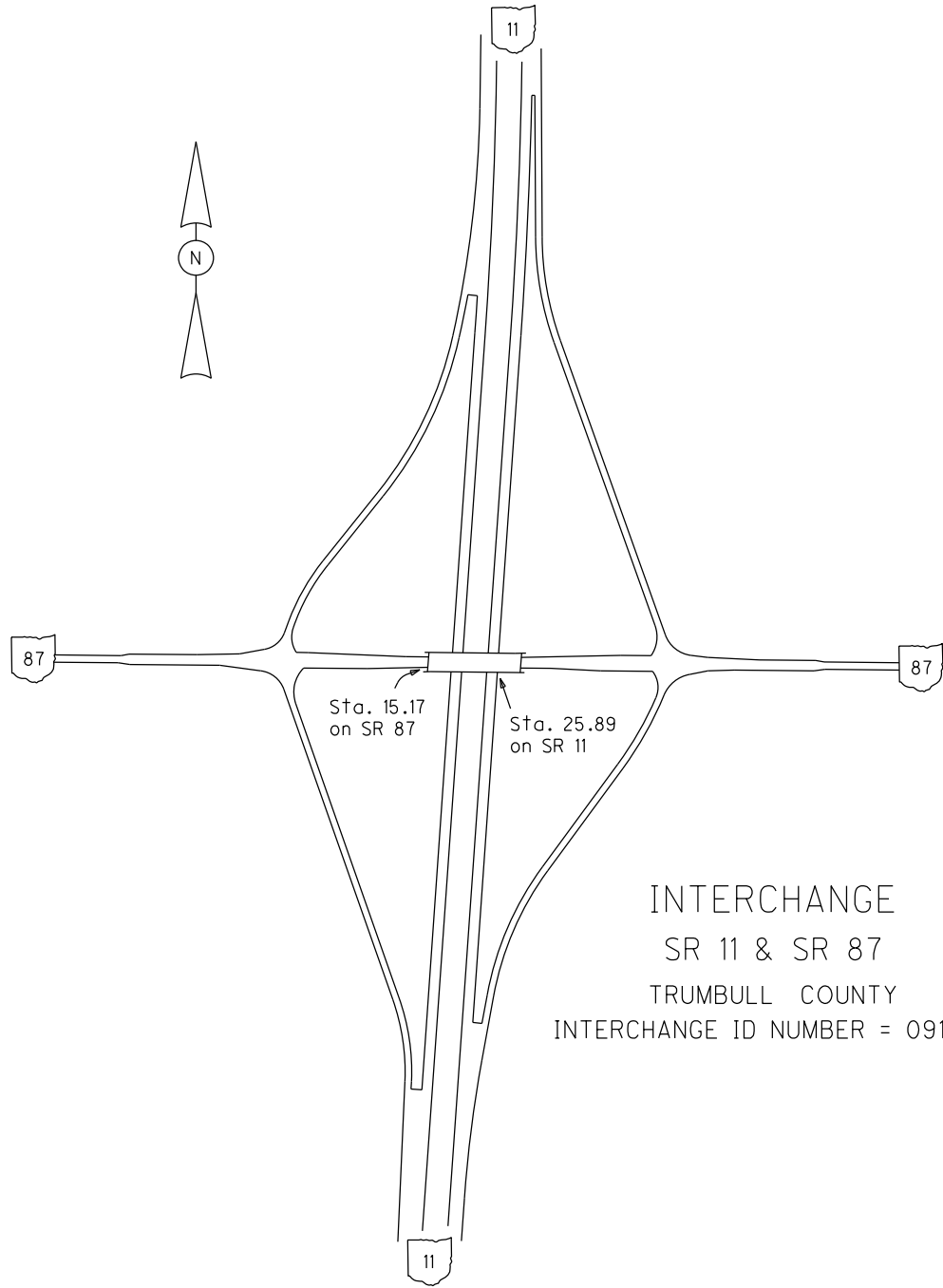

INTERCHANGE  
SR 11 & SR 87  
TRUMBULL COUNTY  
INTERCHANGE ID NUMBER = 091200

# STRUSR00087\*\*C

State True Log

54.982

County True Log

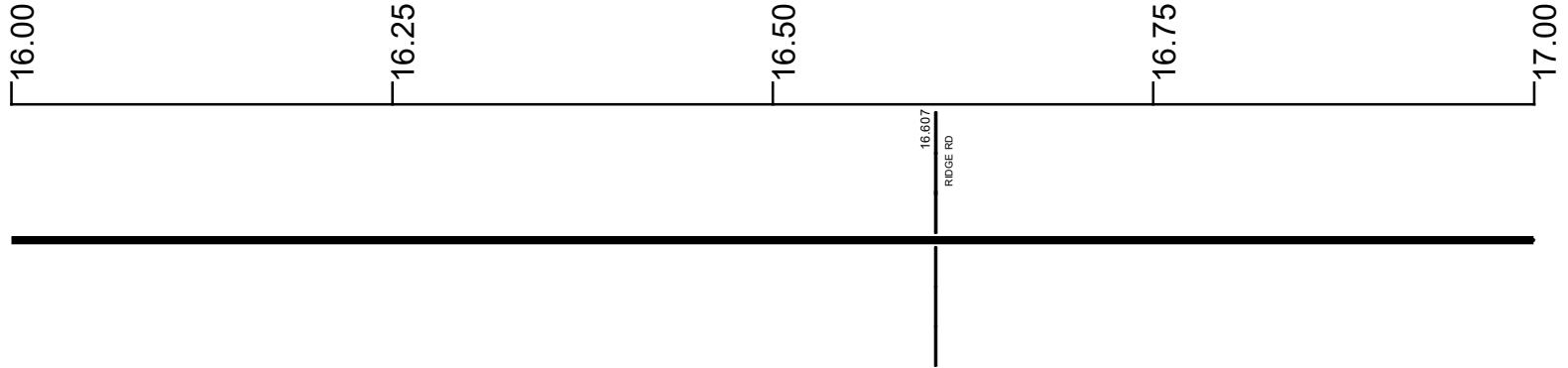

Surface Type & Width (Left / Right)

G 18'  
15.313 - 19.935

Base Type (Left / Right)

K  
15.313 - 20.638

Shoulder Type & Width (Left / Right)

2 (2'/2')  
15.313 - 17.591

Resurface Year

2022

Through Lanes

2  
0 - 22.288

Street Name

SR 87  
15.155 - 22.288

- |                     |                   |                      |              |
|---------------------|-------------------|----------------------|--------------|
| Non-divided Highway | Bridge (on route) | Railroad (at grade)  | Intersection |
| Divided Highway     | Underpass         | Railroad (underpass) |              |
| Secondary Segment   | Overpass          | Railroad (overpass)  |              |
| Corporation         |                   |                      |              |

Created on: 7/8/2025

transportation.ohio.gov

Prepared by  
The Ohio Department of Transportation  
Office of Technical Services  
Roadway Information

# STRUSR00087\*\*C

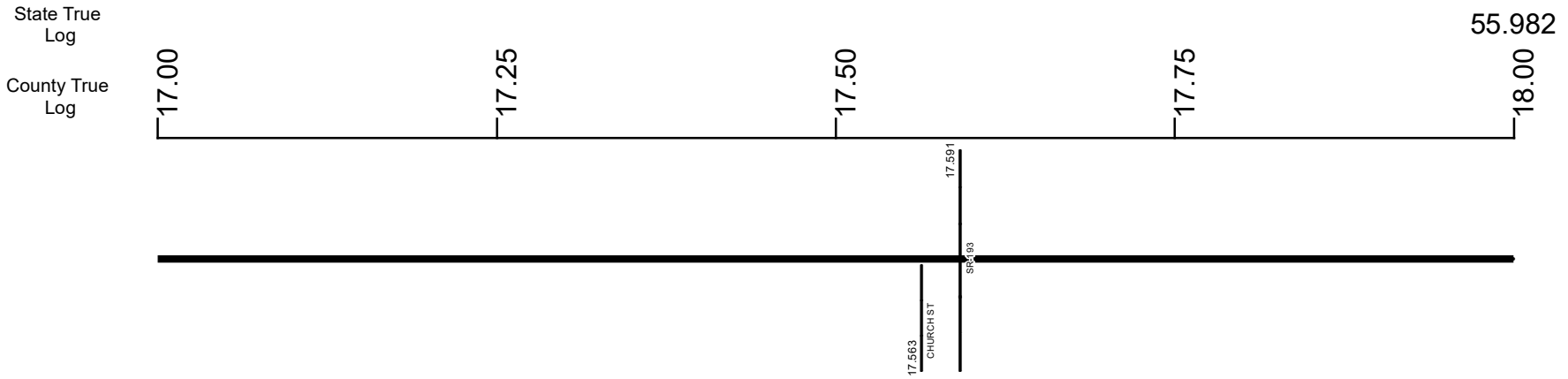

Surface Type & Width (Left / Right)	G 18'		
	15.313 - 19.935		
Base Type (Left / Right)	K		
	15.313 - 20.638		
Shoulder Type & Width (Left / Right)			
	<table style="width: 100%; border: none;"> <tr> <td style="width: 50%; border: 1px solid black; text-align: center;">2 (2'2") 15.313 - 17.591</td> <td style="width: 50%; border: 1px solid black; text-align: center;">2 (3'3") 17.591 - 19.935</td> </tr> </table>	2 (2'2") 15.313 - 17.591	2 (3'3") 17.591 - 19.935
2 (2'2") 15.313 - 17.591	2 (3'3") 17.591 - 19.935		
Resurface Year	2022		
	13.378 - 22.288		
Through Lanes	2		
	0 - 22.288		
Street Name	SR 87		
	15.155 - 22.288		

Non-divided Highway	Bridge (on route)	Railroad (at grade)	Intersection
Divided Highway	Underpass	Railroad (underpass)	
Secondary Segment	Overpass	Railroad (overpass)	
Corporation			

Created on: 7/8/2025

transportation.ohio.gov

Prepared by  
The Ohio Department of Transportation  
Office of Technical Services  
Roadway Information

# STRUSR00087\*\*C

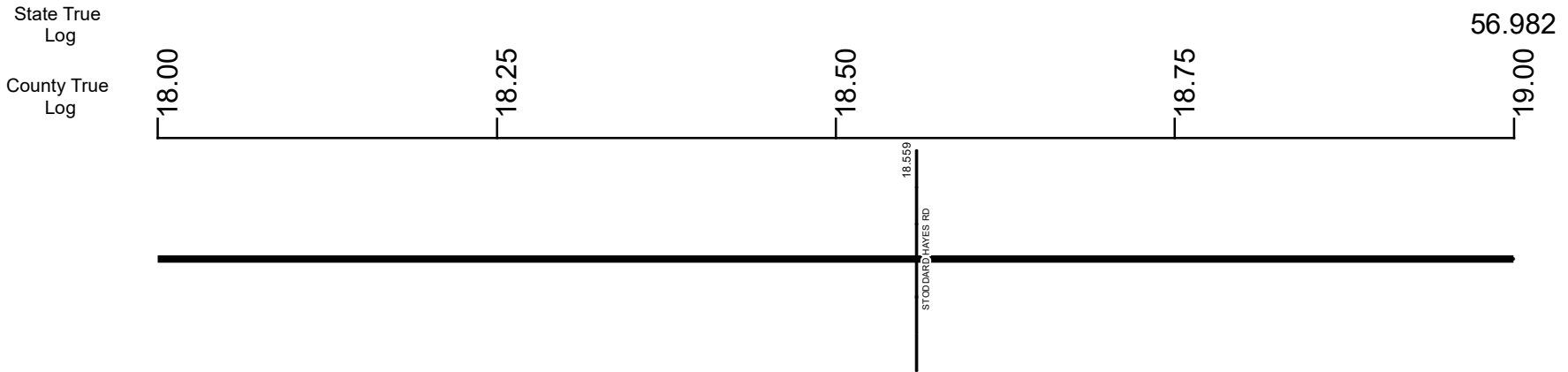

Surface Type & Width (Left / Right)	G 18'
	15.313 - 19.935
Base Type (Left / Right)	K
	15.313 - 20.638
Shoulder Type & Width (Left / Right)	2 (3/3')
	17.591 - 19.935
Resurface Year	2022
	13.378 - 22.288
Through Lanes	2
	0 - 22.288
Street Name	SR 87
	15.155 - 22.288

- Non-divided Highway
- Divided Highway
- Secondary Segment
- Corporation
- Bridge (on route)
- Underpass
- Overpass
- Railroad (at grade)
- Railroad (underpass)
- Railroad (overpass)
- Intersection

Created on: 7/8/2025



transportation.ohio.gov

Prepared by  
The Ohio Department of Transportation  
Office of Technical Services  
Roadway Information

# STRUSR00087\*\*C

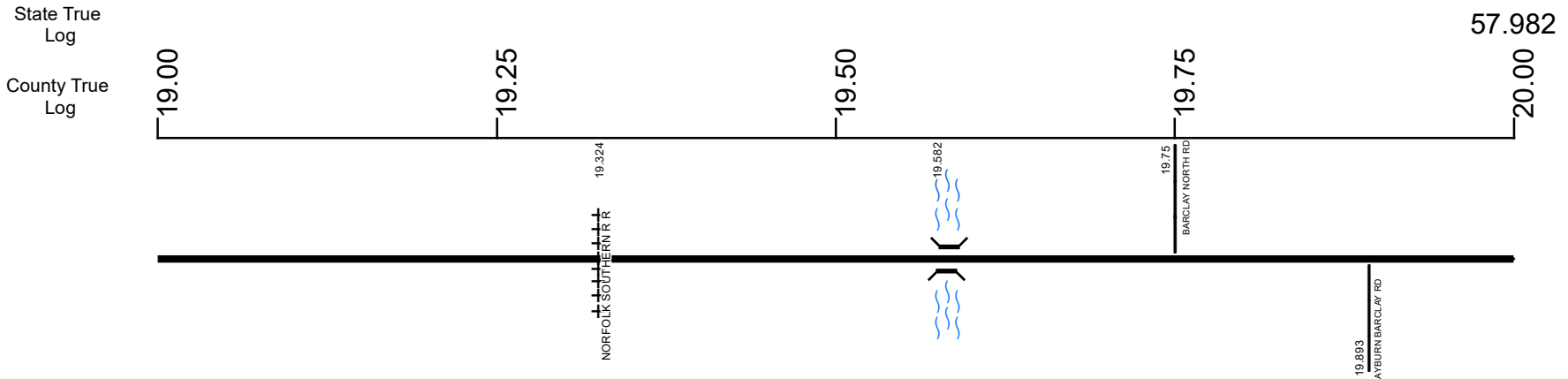

Surface Type & Width (Left / Right)	G 18' 15.313 - 19.935	G 20' 19.935 - 22.288
Base Type (Left / Right)	K 15.313 - 20.638	
Shoulder Type & Width (Left / Right)	2 (3/3') 17.591 - 19.935	2 (2/2') 19.935 - 20.638
Resurface Year	2022 13.378 - 22.288	
Through Lanes	2 0 - 22.288	
Street Name	SR 87 15.155 - 22.288	

Non-divided Highway	Bridge (on route)	Railroad (at grade)	Intersection
Divided Highway	Underpass	Railroad (underpass)	
Secondary Segment	Overpass	Railroad (overpass)	
<b>Corporation</b>			

Created on: 7/8/2025



transportation.ohio.gov

Prepared by  
The Ohio Department of Transportation  
Office of Technical Services  
Roadway Information

# STRUSR00087\*\*C

State True Log

58.982

County True Log

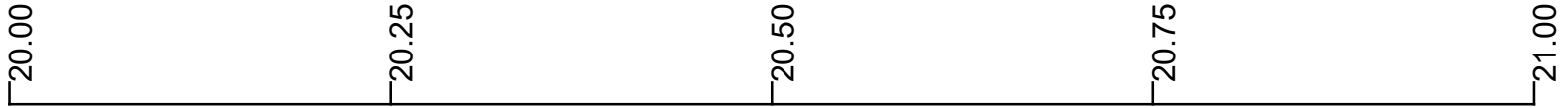

**Surface Type & Width (Left / Right)**

G 20'
19.935 - 22.288

**Base Type (Left / Right)**

K	I	K
15.313 - 20.638	20.638 - 20.769	20.769 - 22.288

**Shoulder Type & Width (Left / Right)**

2 (2'2")	2 (10'/10')	2 (2'2")
19.935 - 20.638	20.638 - 20.769	20.769 - 22.288

**Resurface Year**

2022
------

**Through Lanes**

2
0 - 22.288

**Street Name**

SR 87
15.155 - 22.288

- Non-divided Highway
- Divided Highway
- Secondary Segment
- Corporation
- Bridge (on route)
- Underpass
- Overpass
- Railroad (at grade)
- Railroad (underpass)
- Railroad (overpass)
- Intersection

Created on: 7/8/2025

transportation.ohio.gov

Prepared by  
The Ohio Department of Transportation  
Office of Technical Services  
Roadway Information

# STRUSR00087\*\*C

State True Log

59.982

County True Log

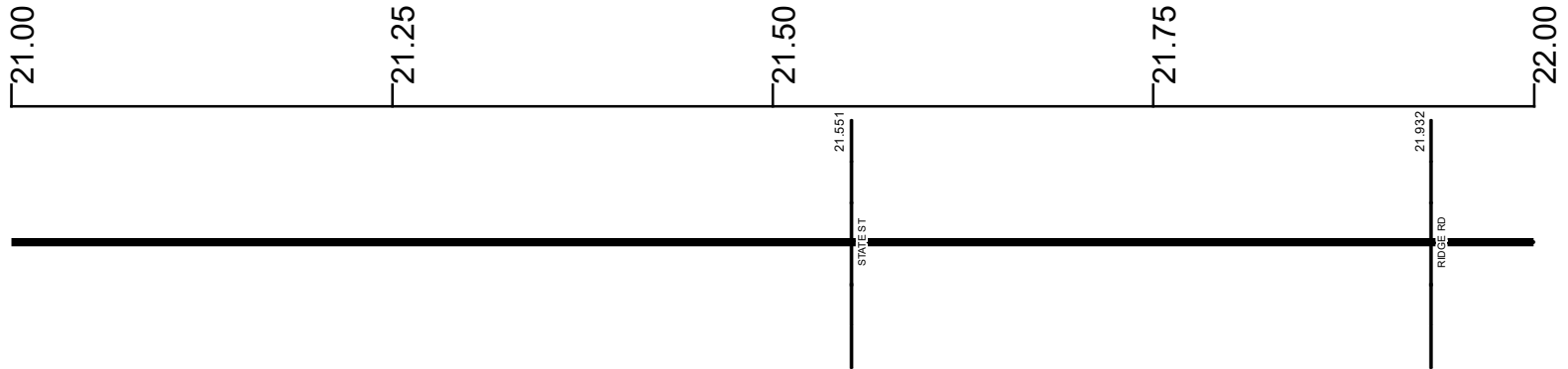

Surface Type & Width (Left / Right)

G 20'  
19.935 - 22.288

Base Type (Left / Right)

K  
20.769 - 22.288

Shoulder Type & Width (Left / Right)

2 (2'/2)  
20.769 - 22.288

Resurface Year

2022

Through Lanes

2  
0 - 22.288

Street Name

SR 87  
15.155 - 22.288

- |                     |                   |                      |              |
|---------------------|-------------------|----------------------|--------------|
| Non-divided Highway | Bridge (on route) | Railroad (at grade)  | Intersection |
| Divided Highway     | Underpass         | Railroad (underpass) |              |
| Secondary Segment   | Overpass          | Railroad (overpass)  |              |
| Corporation         |                   |                      |              |

Created on: 7/8/2025

transportation.ohio.gov

Prepared by  
The Ohio Department of Transportation  
Office of Technical Services  
Roadway Information

# STRUSR00087\*\*C

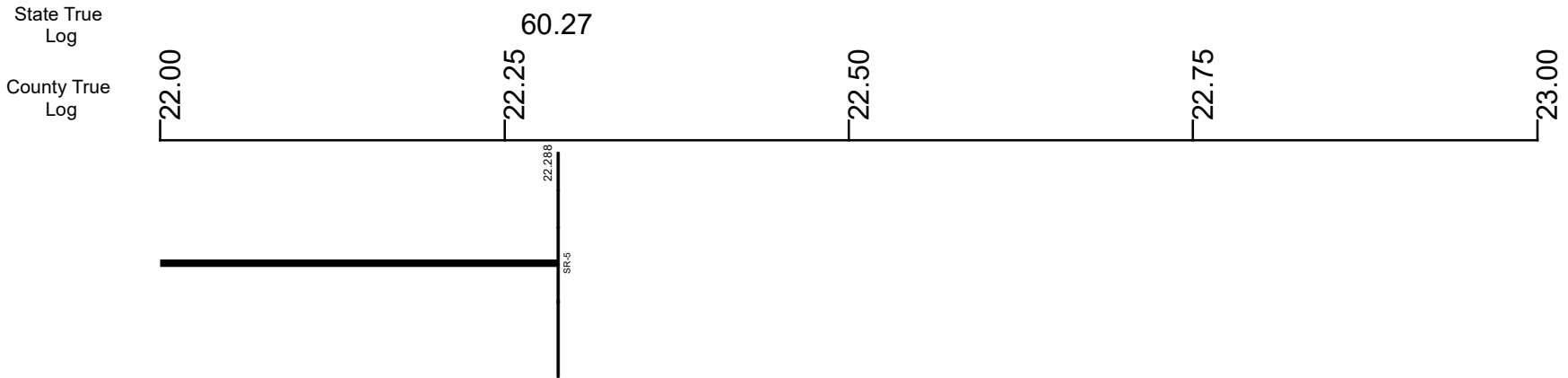

Surface Type & Width (Left / Right)	G 20'	19.935 - 22.288
Base Type (Left / Right)	K	20.769 - 22.288
Shoulder Type & Width (Left / Right)	2 (2 1/2')	20.769 - 22.288
Resurface Year	2022	13.378 - 22.288
Through Lanes	2	0 - 22.288
Street Name	SR 87	15.155 - 22.288

- Non-divided Highway
- Divided Highway
- Secondary Segment
- Corporation
- Bridge (on route)
- Underpass
- Overpass
- Railroad (at grade)
- Railroad (underpass)
- Railroad (overpass)
- Intersection

Created on: 7/8/2025



transportation.ohio.gov

Prepared by  
The Ohio Department of Transportation  
Office of Technical Services  
Roadway Information

## Historical Project List for STRUSR00087\*\*C

Begin Measure	End Measure	Project ID Number	Construction Completion Date	Treatment Category	Treatment Type
0.000	2.260	100954	10-2019	Minor Rehabilitation	38-Fine Poly AC Overlay
0.000	2.260	81581	11-2010	Minor Rehabilitation	60-AC Overlay w/Rpr
2.260	2.270	98491	7-2022	Minor Rehabilitation	38-Fine Poly AC Overlay
2.270	7.059	98491	7-2022	Minor Rehabilitation	60-AC Overlay w/Rpr
7.059	13.379	84486	10-2011	Minor Rehabilitation	60-AC Overlay w/Rpr
13.379	17.588	109580	9-2022	Preventive Maintenance	25-Chip Seal
13.379	22.288	86939	8-2015	Minor Rehabilitation	60-AC Overlay w/Rpr
13.379	22.288	24672	8-2004	Preventive Maintenance	30-Microsurfacing
17.588	22.288	109580	9-2022	Preventive Maintenance	25-Chip Seal

# Roadway Codes

## Access Control Journalized

- F - Full Access Control
- L - Limited Access Control
- N - No Access Control

## Access Control Operational

- 1 - Full Access Control
- 2 - Partial Access Control
- 3 - No Access Control

## Base Type

- F - Crack and Seat
- H - Rubblize and Roll
- I - Aggregate Base 304 or Traffic Compacted
- K - Water Bound Macadam
- L - Bituminous Concrete Mix or Penetration Macadam
- N - Plain Concrete
- P - Reinforced Concrete
- R - Brick (Flexible)
- T - Brick (Rigid)

## Direction of Travel

- B - Both (Two-way)
- F - One-way Cardinal
- T - One-way Non-cardinal

## Facility Type

- 1 - One-way Roadway
- 2 - Two-way Roadway
- 4 - Ramp
- 5 - Non-mainline
- 6 - Non-inventory Direction
- 7 - Planned / Unbuilt

## Historical Federal Aid Indicator

- N - Not a FAP Route
- Y - FAP Route

## Functional Classification

- 01 - Interstate
- 02 - Principal Arterial (Freeways)
- 03 - Principal Arterial (Other)
- 04 - Minor Arterial
- 05 - Major Collector
- 06 - Minor Collector
- 07 - Local

## Leave / Reenter Indicator

- Y - Route leaves/reenters at this point
- N - Route does not leave/reenter at this point

## Median Type

- 1 - None
- 2 - Unprotected
- 3 - Curbed
- 4 - Positive Barrier (Unspecified)
- 5 - Positive Barrier (Flexible)
- 6 - Positive Barrier (Semi-rigid)
- 7 - Positive Barrier (Rigid)

## NHS

- N - National Highway System
- H - Congressional Corridor
- 2 - Major Airport
- 3 - Major Port Facility
- 4 - Major Amtrak Station
- 5 - Major Rail / Truck Terminal
- 6 - Major Intercity Bus Terminal
- 7 - Major Public Transit / Multi-modal Passenger Terminal
- 8 - Major Pipeline Terminal
- 9 - Major Ferry Terminal

## Priority System

- G - General
- P - Priority System
- U - Urban

## Scenic Byway Code

- A - All American Road
- N - National Scenic Byway
- S - State Scenic Byway

## Shoulder Type

- 1 - None
- 2 - Surfaced shoulder exists (bituminous concrete {AC})
- 3 - Surfaced shoulder exists (Portland Cement Concrete {PCC})
- 4 - Stabilized shoulder exists (gravel or other granular material)
- 5 - Combination shoulder exists (two or more surface types)
- 6 - Earth shoulder exists
- 7 - Barrier curb exists; no shoulder in front of curb

## Surface Type

- A - Combination
- B - Brick
- C - Continuous Reinforced Concrete
- D - Reinforced Concrete
- E - Plain Concrete
- G - Bituminous Concrete
- I - Chipseal on Granular
- K - Open Graded Bituminous
- L - Chipseal or Micro
- M - Gravel
- U - Unimproved
- X - Right of Way Only