

STRUSR00193**C

State True Log 2.648

3.648

County True Log

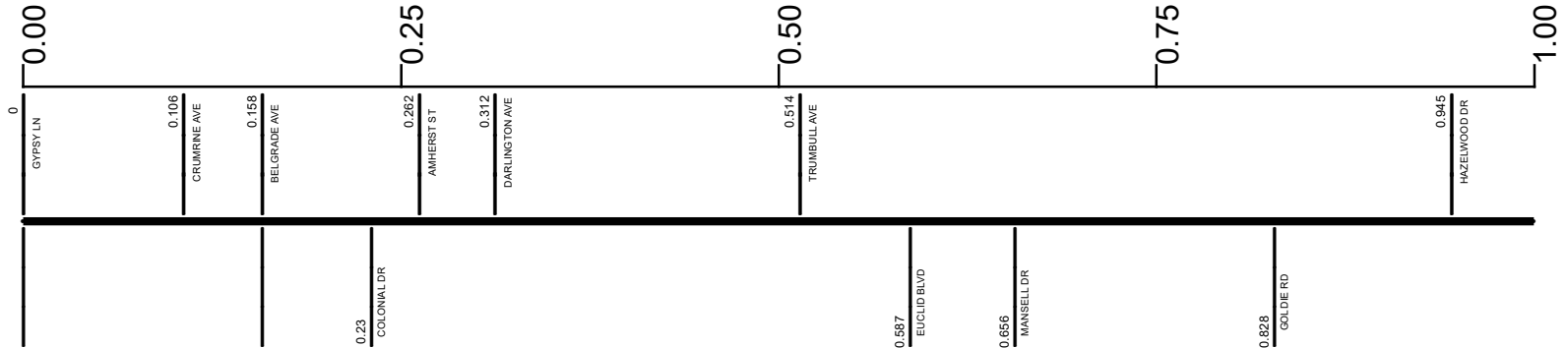

Surface Type & Width (Left / Right)

G (36'/20')
0 - 1.354

Base Type (Left / Right)

P / L
0 - 1.972

Shoulder Type & Width (Left / Right)

1 (0'/0')
0 - 1.972

Through Lanes

4
0 - 6.764

Street Name

BELMONT AVE
0 - 4.791

- | | | | |
|---------------------|-------------------|----------------------|--------------|
| Non-divided Highway | Bridge (on route) | Railroad (at grade) | Intersection |
| Divided Highway | Underpass | Railroad (underpass) | |
| Secondary Segment | Overpass | Railroad (overpass) | |
| Corporation | | | |

Created on: 7/8/2025



transportation.ohio.gov

Prepared by
The Ohio Department of Transportation
Office of Technical Services
Roadway Information

STRUSR00193**C

State True Log

4.648

County True Log

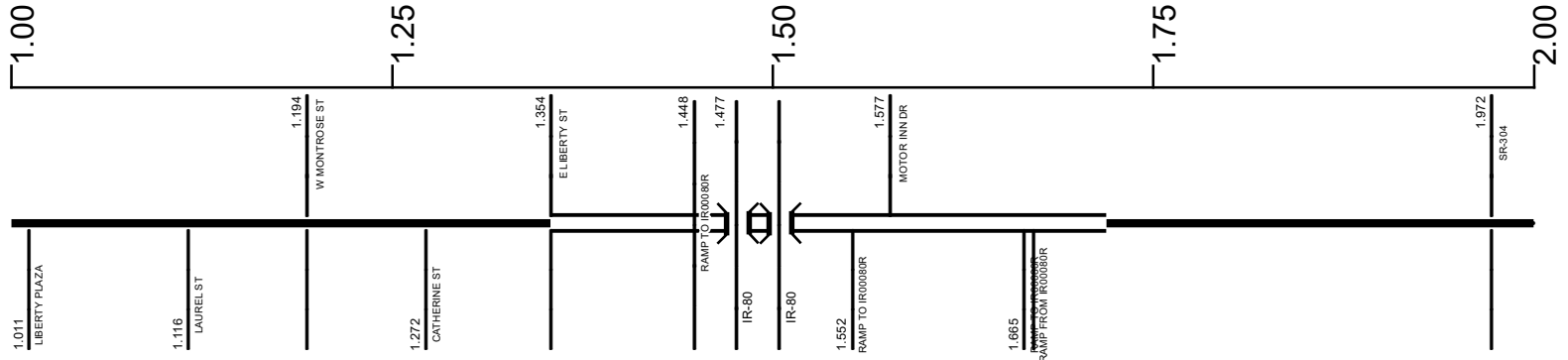

Surface Type & Width (Left / Right)

G (36'/20')	G 52'	G 56'
0 - 1.354	1.354 - 1.719	1.719 - 3.418

Base Type (Left / Right)

P / L	L
0 - 1.972	1.972 - 3.418

Shoulder Type & Width (Left / Right)

1 (0'/0')	5 (2 1/2')
0 - 1.972	1.972 - 6.574

Median Type and Width

3 (4')
1.354 - 1.719

Through Lanes

4
0 - 6.764

Street Name

BELMONT AVE
0 - 4.791

- Non-divided Highway
- Divided Highway
- Secondary Segment
- Corporation
- Bridge (on route)
- Underpass
- Overpass
- Railroad (at grade)
- Railroad (underpass)
- Railroad (overpass)
- Intersection

Created on: 7/8/2025

transportation.ohio.gov

Prepared by
The Ohio Department of Transportation
Office of Technical Services
Roadway Information

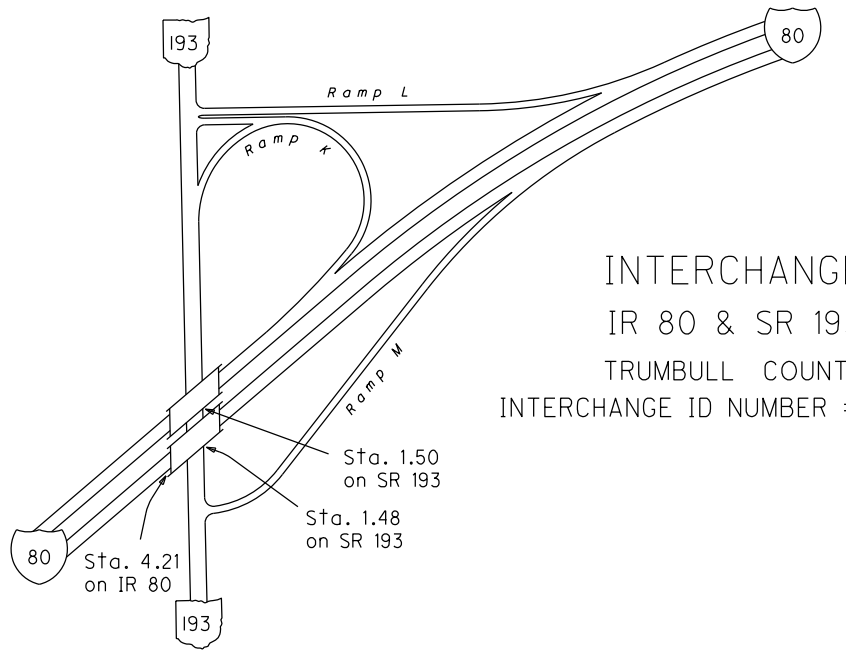

INTERCHANGE
IR 80 & SR 193
TRUMBULL COUNTY
INTERCHANGE ID NUMBER = 089900

STRUSR00193**C

State True Log

5.648

County True Log

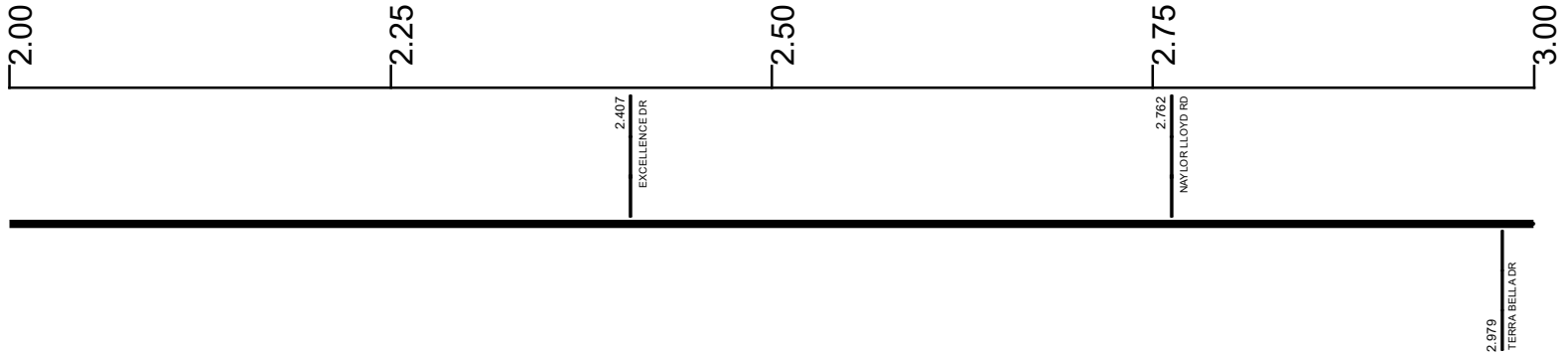

Surface Type & Width (Left / Right)

G 56'
1.719 - 3.418

Base Type (Left / Right)

L
1.972 - 3.418

Shoulder Type & Width (Left / Right)

5 (2/2)
1.972 - 6.574

Through Lanes

4
0 - 6.764

Street Name

BELMONT AVE
0 - 4.791

- | | | | |
|---------------------|-------------------|----------------------|--------------|
| Non-divided Highway | Bridge (on route) | Railroad (at grade) | Intersection |
| Divided Highway | Underpass | Railroad (underpass) | |
| Secondary Segment | Overpass | Railroad (overpass) | |
| Corporation | | | |

Created on: 7/8/2025



transportation.ohio.gov

Prepared by
The Ohio Department of Transportation
Office of Technical Services
Roadway Information

STRUSR00193**C

State True Log

6.648

County True Log

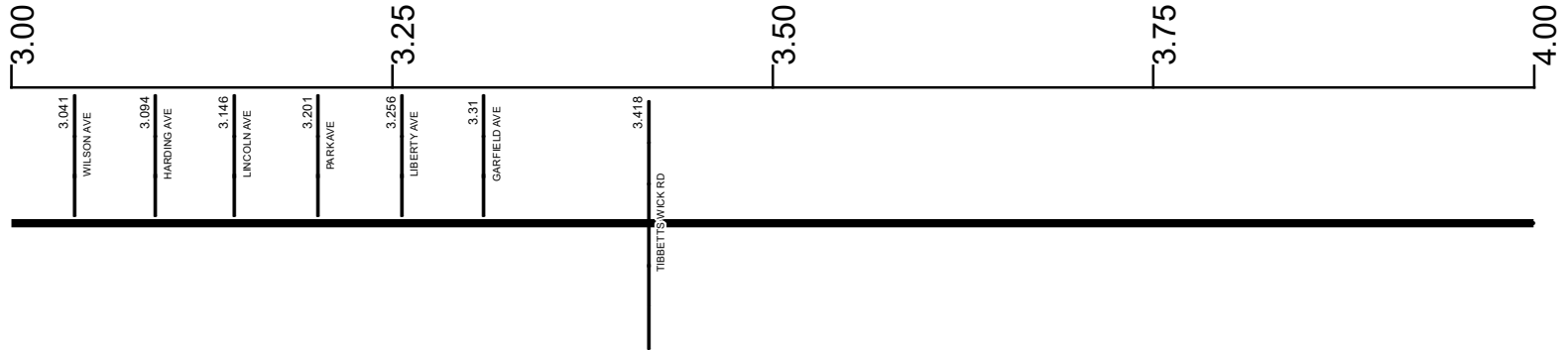

Surface Type & Width (Left / Right)

G 56'	G 48'
1.719 - 3.418	3.418 - 6.764

Base Type (Left / Right)

L	P
1.972 - 3.418	3.418 - 6.764

Shoulder Type & Width (Left / Right)

5 (2/2')
1.972 - 6.574

Through Lanes

4
0 - 6.764

Street Name

BELMONT AVE
0 - 4.791

<ul style="list-style-type: none"> Non-divided Highway Divided Highway Secondary Segment Corporation 	<ul style="list-style-type: none"> Bridge (on route) Underpass Overpass 	<ul style="list-style-type: none"> Railroad (at grade) Railroad (underpass) Railroad (overpass) 	<ul style="list-style-type: none"> Intersection
--	---	---	---

Created on: 7/8/2025

transportation.ohio.gov

Prepared by
The Ohio Department of Transportation
Office of Technical Services
Roadway Information

STRUSR00193**C

State True Log

7.648

County True Log

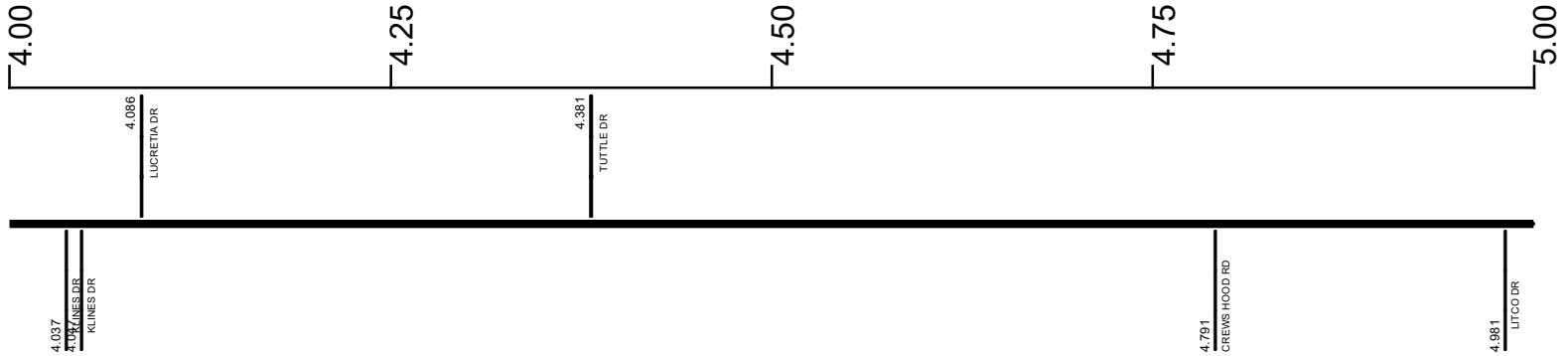

Surface Type & Width (Left / Right)

G 48'
3.418 - 6.764

Base Type (Left / Right)

P
3.418 - 6.764

Shoulder Type & Width (Left / Right)

5 (2/2)
1.972 - 6.574

Through Lanes

4
0 - 6.764

Street Name

BELMONT AVE 0 - 4.791	YOUNGSTOWN KINGSVILLE RD 4.791 - 7.181
--------------------------	---

- | | | | |
|---------------------|-------------------|----------------------|--------------|
| Non-divided Highway | Bridge (on route) | Railroad (at grade) | Intersection |
| Divided Highway | Underpass | Railroad (underpass) | |
| Secondary Segment | Overpass | Railroad (overpass) | |
| Corporation | | | |

Created on: 7/8/2025

transportation.ohio.gov

Prepared by
The Ohio Department of Transportation
Office of Technical Services
Roadway Information

STRUSR00193**C

State True Log

8.648

County True Log

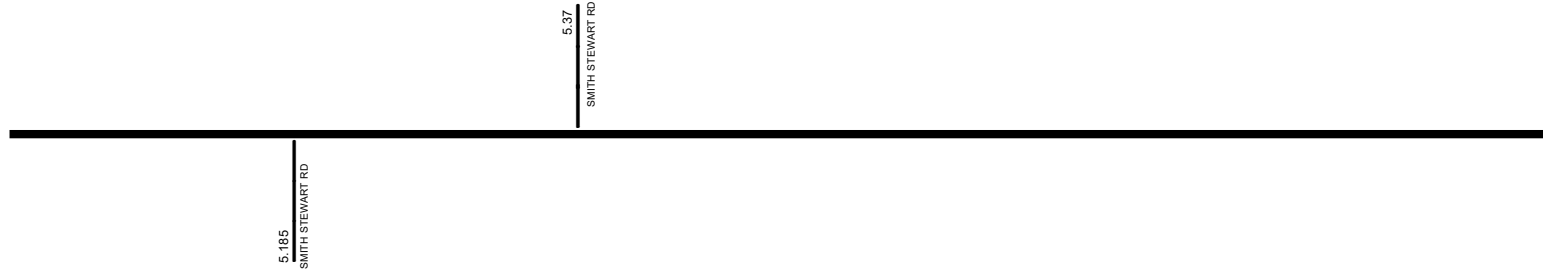

Surface Type & Width (Left / Right)

G 48'
3.418 - 6.764

Base Type (Left / Right)

P
3.418 - 6.764

Shoulder Type & Width (Left / Right)

5 (2/2)
1.972 - 6.574

Through Lanes

4
0 - 6.764

Street Name

YOUNGSTOWN KINGSVILLE RD
4.791 - 7.181

- | | | | |
|---------------------|-------------------|----------------------|--------------|
| Non-divided Highway | Bridge (on route) | Railroad (at grade) | Intersection |
| Divided Highway | Underpass | Railroad (underpass) | |
| Secondary Segment | Overpass | Railroad (overpass) | |
| Corporation | | | |

Created on: 7/8/2025

STRUSR00193**C

State True Log

9.648

County True Log

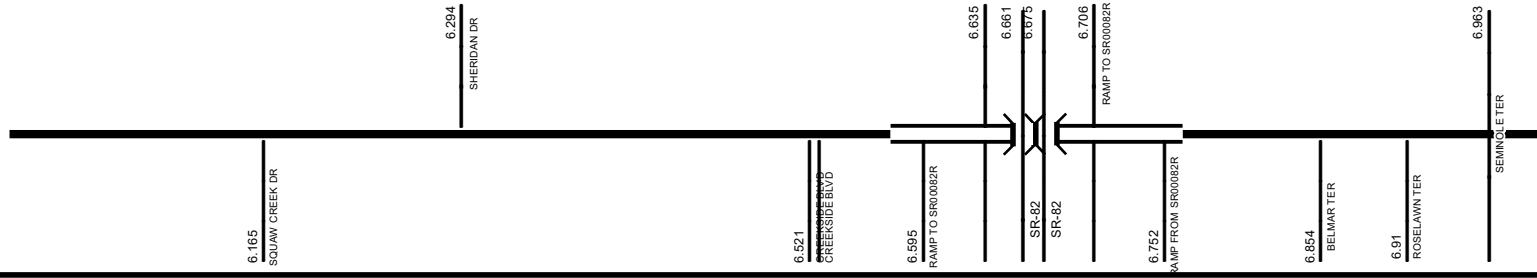

Surface Type & Width (Left / Right)		
G 48'	G (20'4')	
3.418 - 6.764	6.764 - 9.572	
Base Type (Left / Right)		
P	L / I	
3.418 - 6.764	6.764 - 7.163	
Shoulder Type & Width (Left / Right)		
5 (2'2')	1 (2'2')	5 (3'3')
1.972 - 6.574	6.574 - 6.764	6.764 - 7.181
Median Type and Width		
3 (15')		
6.574 - 6.764		
Through Lanes		
4	2	
0 - 6.764	6.764 - 25.385	
Street Name		
YOUNGSTOWN KINGSVILLE RD		
4.791 - 7.181		

<ul style="list-style-type: none"> Non-divided Highway Divided Highway Secondary Segment Corporation 	<ul style="list-style-type: none"> Bridge (on route) Underpass Overpass 	<ul style="list-style-type: none"> Railroad (at grade) Railroad (underpass) Railroad (overpass) 	<ul style="list-style-type: none"> Intersection
--	---	---	---

Created on: 7/8/2025

transportation.ohio.gov

Prepared by
The Ohio Department of Transportation
Office of Technical Services
Roadway Information

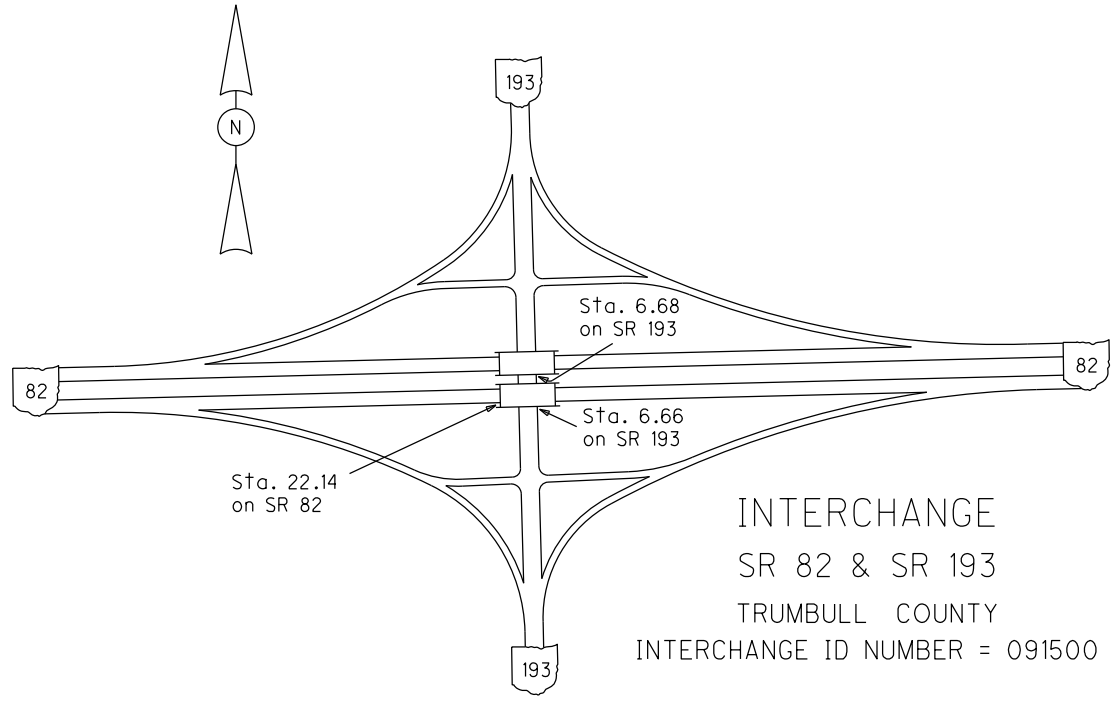

INTERCHANGE
SR 82 & SR 193
TRUMBULL COUNTY
INTERCHANGE ID NUMBER = 091500

STRUSR00193**C

State True Log

10.648

County True Log

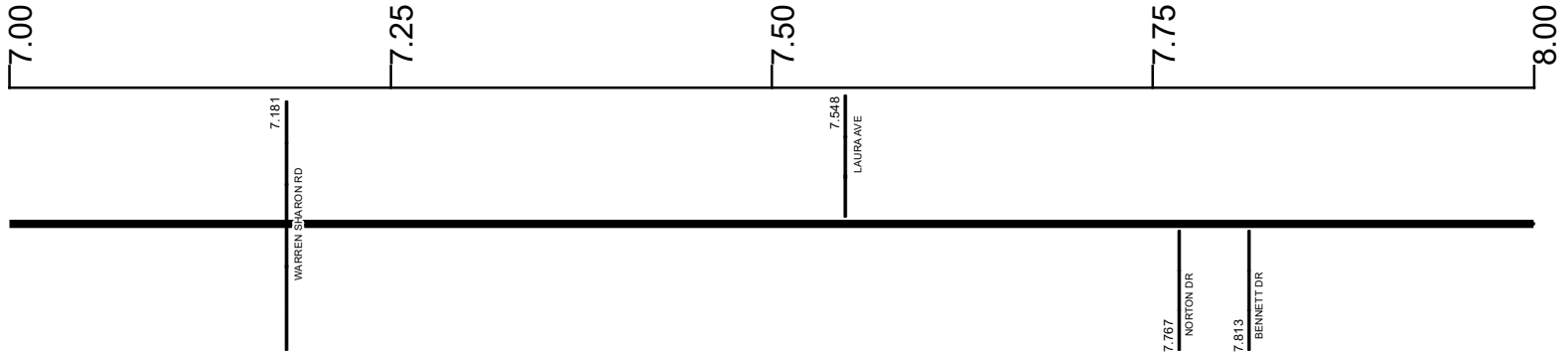

Surface Type & Width (Left / Right)

G (20'4')
6.764 - 9.572

Base Type (Left / Right)

L / I	K / I
6.764 - 7.163	7.163 - 9.572

Shoulder Type & Width (Left / Right)

5 (3'3')	5 (4'4')	5 (3'3')
6.764 - 7.181	7.181 - 7.603	7.603 - 9.572

Through Lanes

2
6.764 - 25.385

Street Name

4.791 - 7.181	YOUNGSTOWN KINGSVILLE RD	7.181 - 15.097
---------------	--------------------------	----------------

- | | | | |
|--|---|---|---|
| <ul style="list-style-type: none"> Non-divided Highway Divided Highway Secondary Segment Corporation | <ul style="list-style-type: none"> Bridge (on route) Underpass Overpass | <ul style="list-style-type: none"> Railroad (at grade) Railroad (underpass) Railroad (overpass) | <ul style="list-style-type: none"> Intersection |
|--|---|---|---|

Created on: 7/8/2025

transportation.ohio.gov

Prepared by
The Ohio Department of Transportation
Office of Technical Services
Roadway Information

STRUSR00193**C

State True Log

11.648

County True Log

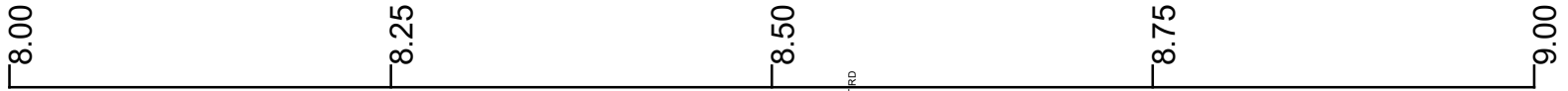

8.357
SOUTH OUTER DR

Surface Type & Width (Left / Right)

G (20'4')
6.764 - 9.572

Base Type (Left / Right)

K / I
7.163 - 9.572

Shoulder Type & Width (Left / Right)

5 (3'3')
7.603 - 9.572

Through Lanes

2
6.764 - 25.385

Street Name

YOUNGSTOWN KINGSVILLE RD
7.181 - 15.097

- | | | | |
|---------------------|-------------------|----------------------|--------------|
| Non-divided Highway | Bridge (on route) | Railroad (at grade) | Intersection |
| Divided Highway | Underpass | Railroad (underpass) | |
| Secondary Segment | Overpass | Railroad (overpass) | |
| Corporation | | | |

Created on: 7/8/2025



transportation.ohio.gov

Prepared by
The Ohio Department of Transportation
Office of Technical Services
Roadway Information

STRUSR00193**C

State True Log

12.648

County True Log

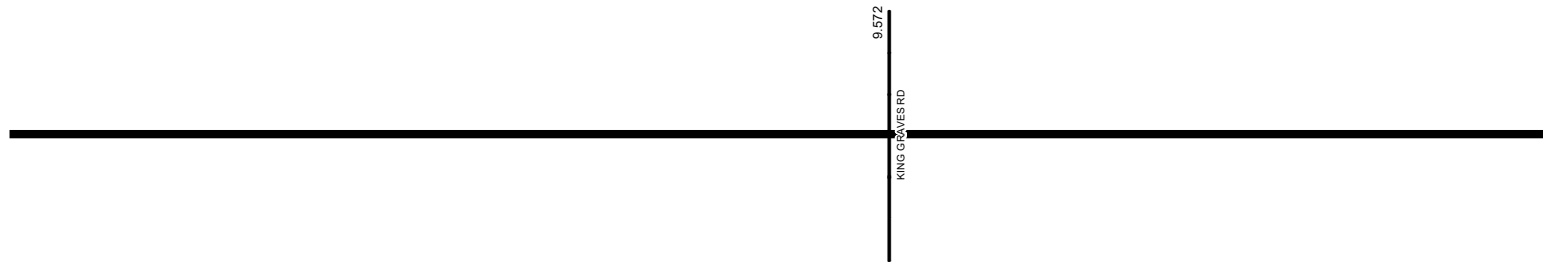
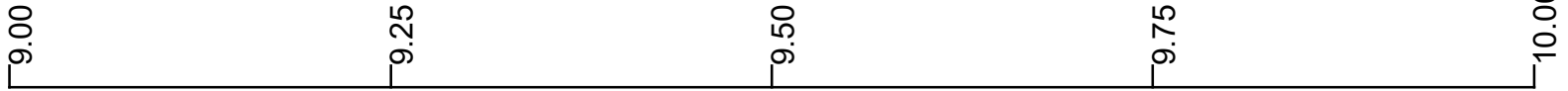

Surface Type & Width (Left / Right)

G (20'4") 6.764 - 9.572	G 20' 9.572 - 12.306
----------------------------	-------------------------

Base Type (Left / Right)

K / I 7.163 - 9.572	K 9.572 - 12.306
------------------------	---------------------

Shoulder Type & Width (Left / Right)

5 (3'3") 7.603 - 9.572	5 (2'2") 9.572 - 11.886
---------------------------	----------------------------

Through Lanes

	2 6.764 - 25.385
--	---------------------

Street Name

	YOUNGSTOWN KINGSVILLE RD 7.181 - 15.097
--	--

- Non-divided Highway
- Divided Highway
- Secondary Segment
- Corporation
- Bridge (on route)
- Underpass
- Overpass
- Railroad (at grade)
- Railroad (underpass)
- Railroad (overpass)
- Intersection

Created on: 7/8/2025

transportation.ohio.gov

Prepared by
The Ohio Department of Transportation
Office of Technical Services
Roadway Information

STRUSR00193**C

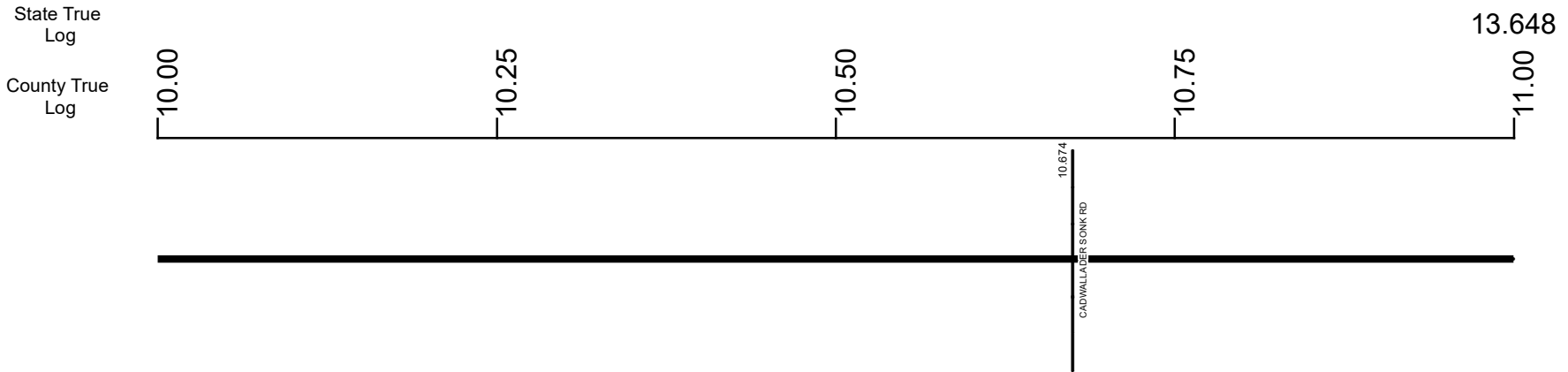

Surface Type & Width (Left / Right)	G 20'
	9.572 - 12.306
Base Type (Left / Right)	K
	9.572 - 12.306
Shoulder Type & Width (Left / Right)	5 (2/2')
	9.572 - 11.886
Through Lanes	2
	6.764 - 25.385
Street Name	YOUNGSTOWN KINGSVILLE RD
	7.181 - 15.097

<ul style="list-style-type: none"> Non-divided Highway Divided Highway Secondary Segment Corporation 	<ul style="list-style-type: none"> Bridge (on route) Underpass Overpass 	<ul style="list-style-type: none"> Railroad (at grade) Railroad (underpass) Railroad (overpass) 	<ul style="list-style-type: none"> Intersection
--	---	---	---

Created on: 7/8/2025

transportation.ohio.gov

Prepared by
The Ohio Department of Transportation
Office of Technical Services
Roadway Information

STRUSR00193**C

State True Log

14.648

County True Log

11.00

11.25

11.50

11.75

12.00



Surface Type & Width (Left / Right)

G 20'	
9.572 - 12.306	

Base Type (Left / Right)

K	
9.572 - 12.306	

Shoulder Type & Width (Left / Right)

5 (2'2')	2 (3'3')
9.572 - 11.886	11.886 - 12.306

Through Lanes

2	
6.764 - 25.385	

Street Name

YOUNGSTOWN KINGSVILLE RD	
7.181 - 15.097	

- | | | | |
|---------------------|-------------------|----------------------|--------------|
| Non-divided Highway | Bridge (on route) | Railroad (at grade) | Intersection |
| Divided Highway | Underpass | Railroad (underpass) | |
| Secondary Segment | Overpass | Railroad (overpass) | |
| Corporation | | | |

Created on: 7/8/2025

STRUSR00193**C

State True Log

15.648

County True Log

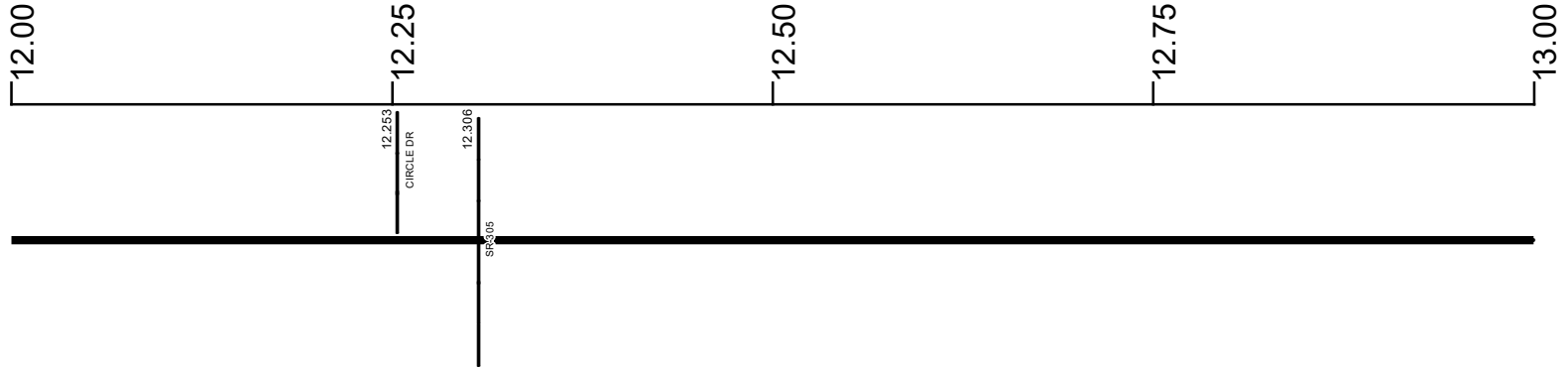

Surface Type & Width (Left / Right)

G 20'	G (20'/2')
9.572 - 12.306	12.306 - 14.91

Base Type (Left / Right)

K	K / L
9.572 - 12.306	12.306 - 14.91

Shoulder Type & Width (Left / Right)

2 (3'/3')	5 (2'/2')
11.886 - 12.306	12.306 - 14.91

Through Lanes

2
6.764 - 25.385

Street Name

YOUNGSTOWN KINGSVILLE RD
7.181 - 15.097

- | | | | |
|---------------------|-------------------|----------------------|--------------|
| Non-divided Highway | Bridge (on route) | Railroad (at grade) | Intersection |
| Divided Highway | Underpass | Railroad (underpass) | |
| Secondary Segment | Overpass | Railroad (overpass) | |
| Corporation | | | |

Created on: 7/8/2025

transportation.ohio.gov

Prepared by
The Ohio Department of Transportation
Office of Technical Services
Roadway Information

STRUSR00193**C

State True Log

16.648

County True Log

13.00

13.25

13.50

13.75

14.00



Surface Type & Width (Left / Right)

G (20'/2')
12.306 - 14.91

Base Type (Left / Right)

K / L
12.306 - 14.91

Shoulder Type & Width (Left / Right)

5 (2'/2')
12.306 - 14.91

Through Lanes

2
6.764 - 25.385

Street Name

YOUNGSTOWN KINGSVILLE RD
7.181 - 15.097

- | | | | |
|---------------------|-------------------|----------------------|--------------|
| Non-divided Highway | Bridge (on route) | Railroad (at grade) | Intersection |
| Divided Highway | Underpass | Railroad (underpass) | |
| Secondary Segment | Overpass | Railroad (overpass) | |
| Corporation | | | |

Created on: 7/8/2025

transportation.ohio.gov

Prepared by
The Ohio Department of Transportation
Office of Technical Services
Roadway Information

STRUSR00193**C

State True Log

17.648

County True Log

14.00

14.25

14.50

14.75

15.00



Surface Type & Width (Left / Right)

G (20'2")	G 24'
12.306 - 14.91	14.91 - 15.314

Base Type (Left / Right)

K / L	I
12.306 - 14.91	14.91 - 15.314

Shoulder Type & Width (Left / Right)

5 (2'2")	2 (2'2")
12.306 - 14.91	14.91 - 15.314

Through Lanes

2	
6.764 - 25.385	

Street Name

YOUNGSTOWN KINGSVILLE RD	
7.181 - 15.097	

- | | | | |
|--|---|---|---|
| <ul style="list-style-type: none"> Non-divided Highway Divided Highway Secondary Segment Corporation | <ul style="list-style-type: none"> Bridge (on route) Underpass Overpass | <ul style="list-style-type: none"> Railroad (at grade) Railroad (underpass) Railroad (overpass) | <ul style="list-style-type: none"> Intersection |
|--|---|---|---|

Created on: 7/8/2025

transportation.ohio.gov

Prepared by
The Ohio Department of Transportation
Office of Technical Services
Roadway Information

STRUSR00193**C

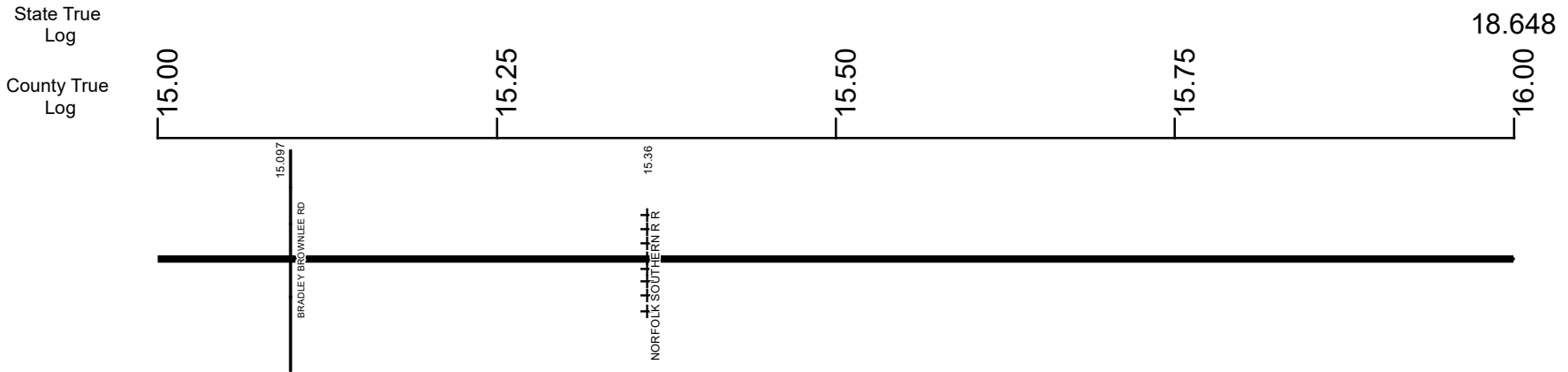

Surface Type & Width (Left / Right)

G 24' 14.91 - 15.314	G (20'2') 15.314 - 17.782
-------------------------	------------------------------

Base Type (Left / Right)

I 14.91 - 15.314	K/L 15.314 - 17.782
---------------------	------------------------

Shoulder Type & Width (Left / Right)

2 (2'2') 14.91 - 15.314	5 (2'2') 15.314 - 17.782
----------------------------	-----------------------------

Through Lanes

	2 6.764 - 25.385
--	---------------------

Street Name

YOUNGSTOWN KINGSVILLE RD 7.181 - 15.097	SR 193 15.097 - 25.385
--	---------------------------

- Non-divided Highway
 Bridge (on route)
 Railroad (at grade)
 Intersection
- Divided Highway
 Underpass
 Railroad (underpass)
- Secondary Segment
 Overpass
 Railroad (overpass)
- Corporation**

Created on: 7/8/2025

transportation.ohio.gov

Prepared by
The Ohio Department of Transportation
Office of Technical Services
Roadway Information

STRUSR00193**C

State True Log

19.648

County True Log



Surface Type & Width (Left / Right)

G (20'/2')
15.314 - 17.782

Base Type (Left / Right)

K / L
15.314 - 17.782

Shoulder Type & Width (Left / Right)

5 (2'/2')
15.314 - 17.782

Through Lanes

2
6.764 - 25.385

Street Name

SR 193
15.097 - 25.385

- | | | | |
|---------------------|-------------------|----------------------|--------------|
| Non-divided Highway | Bridge (on route) | Railroad (at grade) | Intersection |
| Divided Highway | Underpass | Railroad (underpass) | |
| Secondary Segment | Overpass | Railroad (overpass) | |
| Corporation | | | |

Created on: 7/8/2025

transportation.ohio.gov

Prepared by
The Ohio Department of Transportation
Office of Technical Services
Roadway Information

STRUSR00193**C

State True Log

20.648

County True Log

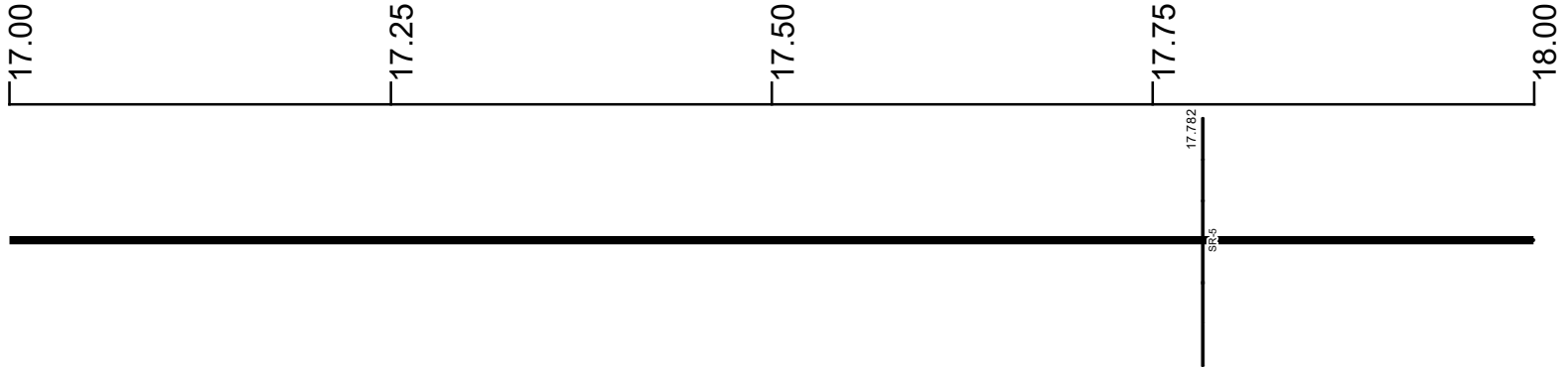

Surface Type & Width (Left / Right)

G (20'/2')	G 20'
15.314 - 17.782	17.782 - 25.385

Base Type (Left / Right)

K / L	K
15.314 - 17.782	17.782 - 22.851

Shoulder Type & Width (Left / Right)

5 (2'/2')	5 (3'/3')
15.314 - 17.782	17.782 - 22.851

Through Lanes

	2
	6.764 - 25.385

Street Name

	SR 193
	15.097 - 25.385

- Non-divided Highway
 Bridge (on route)
 Railroad (at grade)
 Intersection
- Divided Highway
 Underpass
 Railroad (underpass)
- Secondary Segment
 Overpass
 Railroad (overpass)
- Corporation**

Created on: 7/8/2025

transportation.ohio.gov

Prepared by
The Ohio Department of Transportation
Office of Technical Services
Roadway Information

STRUSR00193**C

State True Log

21.648

County True Log

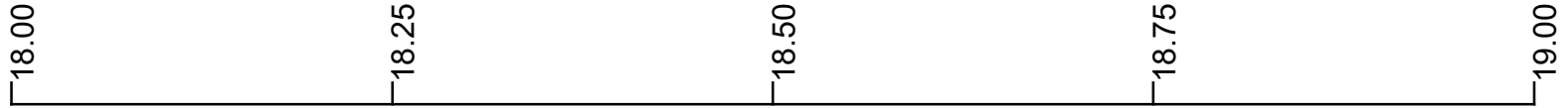

Surface Type & Width (Left / Right)

G 20'
17.782 - 25.385

Base Type (Left / Right)

K
17.782 - 22.851

Shoulder Type & Width (Left / Right)

5 (3/3)
17.782 - 22.851

Through Lanes

2
6.764 - 25.385

Street Name

SR 193
15.097 - 25.385

- | | | | |
|---------------------|-------------------|----------------------|--------------|
| Non-divided Highway | Bridge (on route) | Railroad (at grade) | Intersection |
| Divided Highway | Underpass | Railroad (underpass) | |
| Secondary Segment | Overpass | Railroad (overpass) | |
| Corporation | | | |

Created on: 7/8/2025



transportation.ohio.gov
 Prepared by
 The Ohio Department of Transportation
 Office of Technical Services
 Roadway Information

STRUSR00193**C

State True Log

22.648

County True Log

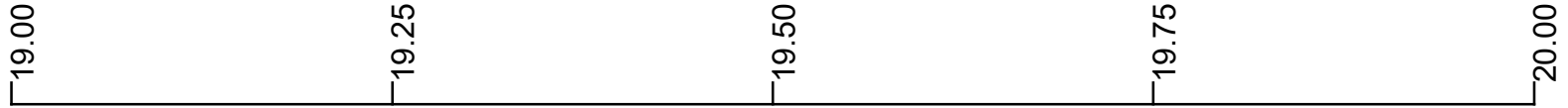

Surface Type & Width (Left / Right)

G 20'
17.782 - 25.385

Base Type (Left / Right)

K
17.782 - 22.851

Shoulder Type & Width (Left / Right)

5 (3/3)
17.782 - 22.851

Through Lanes

2
6.764 - 25.385

Street Name

SR 193
15.097 - 25.385

- | | | | |
|---------------------|-------------------|----------------------|--------------|
| Non-divided Highway | Bridge (on route) | Railroad (at grade) | Intersection |
| Divided Highway | Underpass | Railroad (underpass) | |
| Secondary Segment | Overpass | Railroad (overpass) | |
| Corporation | | | |

Created on: 7/8/2025

transportation.ohio.gov

Prepared by
The Ohio Department of Transportation
Office of Technical Services
Roadway Information

STRUSR00193**C

State True Log

23.648

County True Log

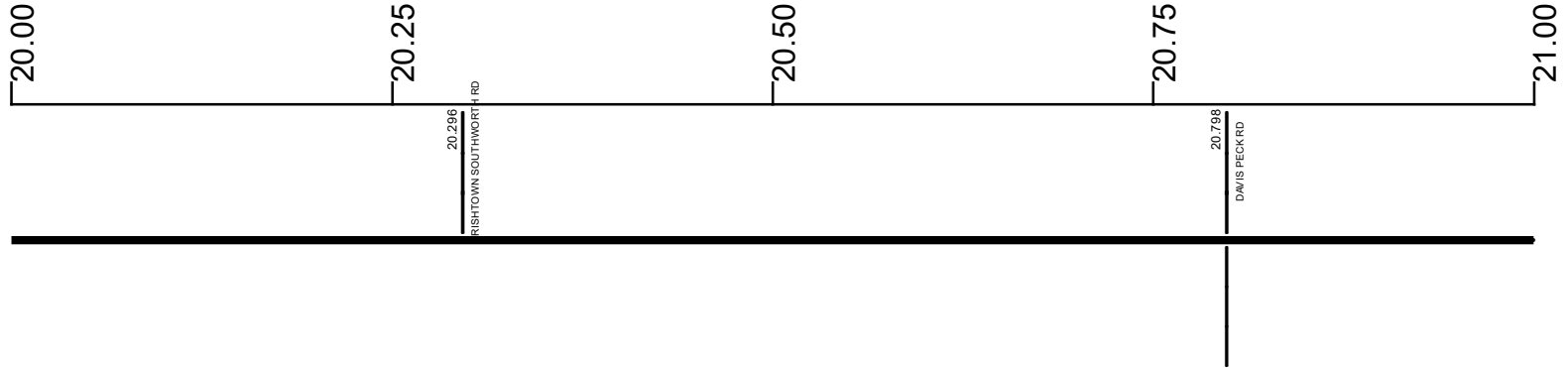

Surface Type & Width (Left / Right)

	G 20'
	17.782 - 25.385

Base Type (Left / Right)

	K
	17.782 - 22.851

Shoulder Type & Width (Left / Right)

	5 (3/3)
	17.782 - 22.851

Through Lanes

	2
	6.764 - 25.385

Street Name

	SR 193
	15.097 - 25.385

- | | | | |
|---------------------|-------------------|----------------------|--------------|
| Non-divided Highway | Bridge (on route) | Railroad (at grade) | Intersection |
| Divided Highway | Underpass | Railroad (underpass) | |
| Secondary Segment | Overpass | Railroad (overpass) | |
| Corporation | | | |

Created on: 7/8/2025

transportation.ohio.gov

Prepared by
The Ohio Department of Transportation
Office of Technical Services
Roadway Information

STRUSR00193**C

State True Log

24.648

County True Log



Surface Type & Width (Left / Right)

G 20'
17.782 - 25.385

Base Type (Left / Right)

K
17.782 - 22.851

Shoulder Type & Width (Left / Right)

5 (3/3)
17.782 - 22.851

Through Lanes

2
6.764 - 25.385

Street Name

SR 193
15.097 - 25.385

- | | | | |
|---------------------|-------------------|----------------------|--------------|
| Non-divided Highway | Bridge (on route) | Railroad (at grade) | Intersection |
| Divided Highway | Underpass | Railroad (underpass) | |
| Secondary Segment | Overpass | Railroad (overpass) | |
| Corporation | | | |

Created on: 7/8/2025

transportation.ohio.gov

Prepared by
The Ohio Department of Transportation
Office of Technical Services
Roadway Information

STRUSR00193**C

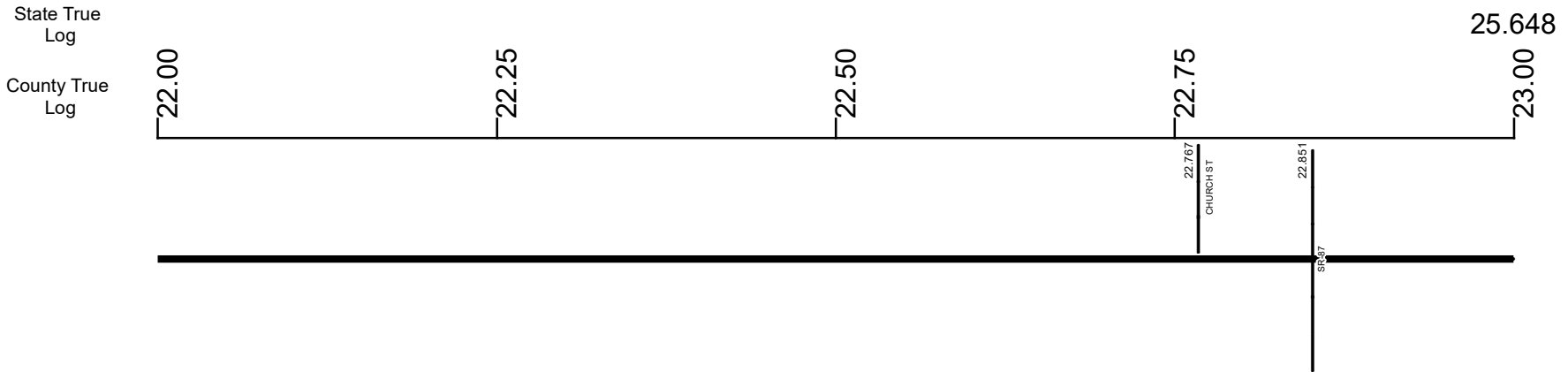

Surface Type & Width (Left / Right)	
G 20'	17.782 - 25.385
Base Type (Left / Right)	
K	P
17.782 - 22.851	22.851 - 25.385
Shoulder Type & Width (Left / Right)	
5 (3/3')	5 (2/2')
17.782 - 22.851	22.851 - 25.385
Through Lanes	
2	6.764 - 25.385
Street Name	
SR 193	15.097 - 25.385

<ul style="list-style-type: none"> Non-divided Highway Divided Highway Secondary Segment Corporation 	<ul style="list-style-type: none"> Bridge (on route) Underpass Overpass 	<ul style="list-style-type: none"> Railroad (at grade) Railroad (underpass) Railroad (overpass) 	<ul style="list-style-type: none"> Intersection
--	---	---	---

Created on: 7/8/2025

transportation.ohio.gov

Prepared by
 The Ohio Department of Transportation
 Office of Technical Services
 Roadway Information

STRUSR00193**C

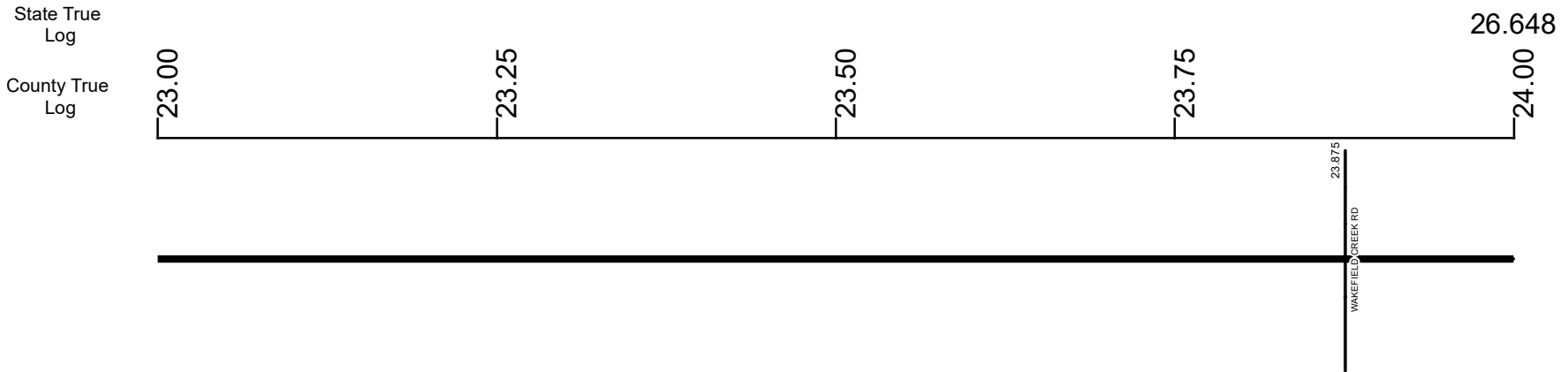

Surface Type & Width (Left / Right)	G 20'
	17.782 - 25.385
Base Type (Left / Right)	P
	22.851 - 25.385
Shoulder Type & Width (Left / Right)	5 (2/2')
	22.851 - 25.385
Through Lanes	2
	6.764 - 25.385
Street Name	SR 193
	15.097 - 25.385

Non-divided Highway	Bridge (on route)	Railroad (at grade)	Intersection
Divided Highway	Underpass	Railroad (underpass)	
Secondary Segment	Overpass	Railroad (overpass)	
Corporation			

Created on: 7/8/2025



transportation.ohio.gov
 Prepared by
 The Ohio Department of Transportation
 Office of Technical Services
 Roadway Information

STRUSR00193**C

State True Log

27.648

County True Log

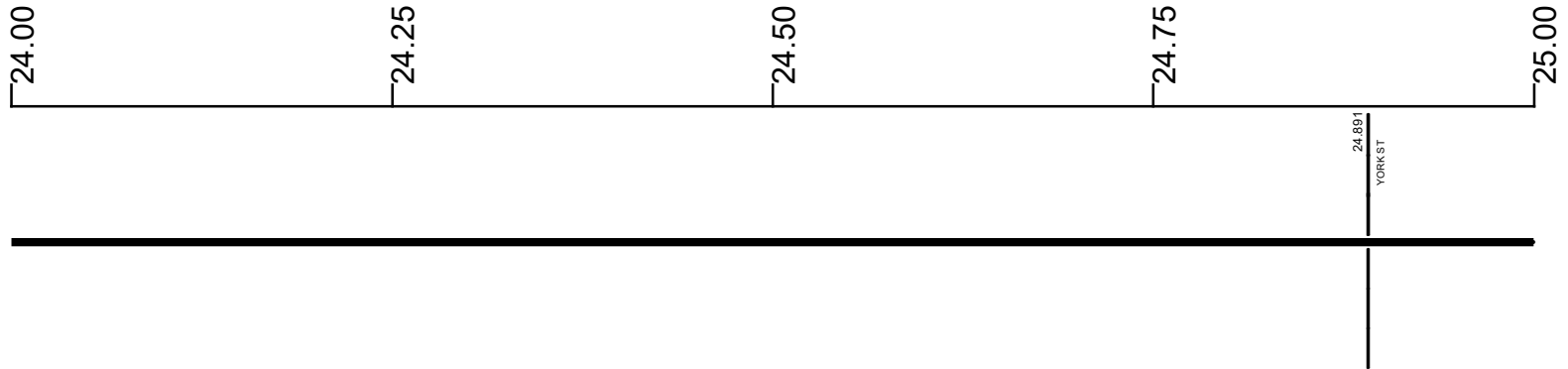

Surface Type & Width (Left / Right)

G 20'
17.782 - 25.385

Base Type (Left / Right)

P
22.851 - 25.385

Shoulder Type & Width (Left / Right)

5 (2/2)
22.851 - 25.385

Through Lanes

2
6.764 - 25.385

Street Name

SR 193
15.097 - 25.385

- | | | | |
|--|---|---|---|
| <ul style="list-style-type: none"> Non-divided Highway Divided Highway Secondary Segment Corporation | <ul style="list-style-type: none"> Bridge (on route) Underpass Overpass | <ul style="list-style-type: none"> Railroad (at grade) Railroad (underpass) Railroad (overpass) | <ul style="list-style-type: none"> Intersection |
|--|---|---|---|

Created on: 7/8/2025

transportation.ohio.gov

Prepared by
The Ohio Department of Transportation
Office of Technical Services
Roadway Information

STRUSR00193**C

State True
Log

28.033

County True
Log



Surface Type & Width (Left / Right)

G 20'
17.782 - 25.385

Base Type (Left / Right)

P
22.851 - 25.385

Shoulder Type & Width (Left / Right)

5 (2 1/2')
22.851 - 25.385

Through Lanes

2
6.764 - 25.385

Street Name

SR 193
15.097 - 25.385

- | | | | |
|---------------------|-------------------|----------------------|--------------|
| Non-divided Highway | Bridge (on route) | Railroad (at grade) | Intersection |
| Divided Highway | Underpass | Railroad (underpass) | |
| Secondary Segment | Overpass | Railroad (overpass) | |
| Corporation | | | |

Created on: 7/8/2025



transportation.ohio.gov
 Prepared by
 The Ohio Department of Transportation
 Office of Technical Services
 Roadway Information

Historical Project List for STRUSR00193**C

Begin Measure	End Measure	Project ID Number	Construction Completion Date	Treatment Category	Treatment Type
0.000	1.968	88916	6-2018	Minor Rehabilitation	60-AC Overlay w/Rpr
0.000	1.968	24569	9-2005	Minor Rehabilitation	60-AC Overlay w/Rpr
1.968	3.387	88916	6-2018	Minor Rehabilitation	38-Fine Poly AC Overlay
1.968	3.387	24569	9-2005	Minor Rehabilitation	50-AC Overlay w/o Rpr
3.387	6.780	88916	6-2018	Minor Rehabilitation	60-AC Overlay w/Rpr
3.387	6.790	24569	9-2005	Minor Rehabilitation	50-AC Overlay w/o Rpr
6.780	14.908	98505	8-2020	Minor Rehabilitation	60-AC Overlay w/Rpr
6.790	17.777	78618	8-2006	Minor Rehabilitation	38-Fine Poly AC Overlay
14.908	17.777	100237	12-2017	Preventive Maintenance	25-Chip Seal
17.777	22.846	81583	11-2012	Minor Rehabilitation	60-AC Overlay w/Rpr
22.846	25.385	84136	9-2009	Preventive Maintenance	25-Chip Seal

Roadway Codes

Access Control Journalized

- F - Full Access Control
- L - Limited Access Control
- N - No Access Control

Access Control Operational

- 1 - Full Access Control
- 2 - Partial Access Control
- 3 - No Access Control

Base Type

- F - Crack and Seat
- H - Rubblize and Roll
- I - Aggregate Base 304 or Traffic Compacted
- K - Water Bound Macadam
- L - Bituminous Concrete Mix or Penetration Macadam
- N - Plain Concrete
- P - Reinforced Concrete
- R - Brick (Flexible)
- T - Brick (Rigid)

Direction of Travel

- B - Both (Two-way)
- F - One-way Cardinal
- T - One-way Non-cardinal

Facility Type

- 1 - One-way Roadway
- 2 - Two-way Roadway
- 4 - Ramp
- 5 - Non-mainline
- 6 - Non-inventory Direction
- 7 - Planned / Unbuilt

Historical Federal Aid Indicator

- N - Not a FAP Route
- Y - FAP Route

Functional Classification

- 01 - Interstate
- 02 - Principal Arterial (Freeways)
- 03 - Principal Arterial (Other)
- 04 - Minor Arterial
- 05 - Major Collector
- 06 - Minor Collector
- 07 - Local

Leave / Reenter Indicator

- Y - Route leaves/reenters at this point
- N - Route does not leave/reenter at this point

Median Type

- 1 - None
- 2 - Unprotected
- 3 - Curbed
- 4 - Positive Barrier (Unspecified)
- 5 - Positive Barrier (Flexible)
- 6 - Positive Barrier (Semi-rigid)
- 7 - Positive Barrier (Rigid)

NHS

- N - National Highway System
- H - Congressional Corridor
- 2 - Major Airport
- 3 - Major Port Facility
- 4 - Major Amtrak Station
- 5 - Major Rail / Truck Terminal
- 6 - Major Intercity Bus Terminal
- 7 - Major Public Transit / Multi-modal Passenger Terminal
- 8 - Major Pipeline Terminal
- 9 - Major Ferry Terminal

Priority System

- G - General
- P - Priority System
- U - Urban

Scenic Byway Code

- A - All American Road
- N - National Scenic Byway
- S - State Scenic Byway

Shoulder Type

- 1 - None
- 2 - Surfaced shoulder exists (bituminous concrete {AC})
- 3 - Surfaced shoulder exists (Portland Cement Concrete {PCC})
- 4 - Stabilized shoulder exists (gravel or other granular material)
- 5 - Combination shoulder exists (two or more surface types)
- 6 - Earth shoulder exists
- 7 - Barrier curb exists; no shoulder in front of curb

Surface Type

- A - Combination
- B - Brick
- C - Continuous Reinforced Concrete
- D - Reinforced Concrete
- E - Plain Concrete
- G - Bituminous Concrete
- I - Chipseal on Granular
- K - Open Graded Bituminous
- L - Chipseal or Micro
- M - Gravel
- U - Unimproved
- X - Right of Way Only