

STRUSR00305**C

State True Log 7.36

8.36

County True Log



Surface Type & Width (Left / Right)

G (18'/4')
0 - 1.542

Base Type (Left / Right)

I / L
0 - 1.542

Shoulder Type & Width (Left / Right)

2 (1'/1')
0 - 1.542

Resurface Year

2021
0 - 1.57

Through Lanes

2
0 - 23.813

Street Name

SR 305
0 - 5.188

- | | | | |
|---------------------|-------------------|----------------------|--------------|
| Non-divided Highway | Bridge (on route) | Railroad (at grade) | Intersection |
| Divided Highway | Underpass | Railroad (underpass) | |
| Secondary Segment | Overpass | Railroad (overpass) | |
| Corporation | | | |

Created on: 7/8/2025

transportation.ohio.gov

Prepared by
The Ohio Department of Transportation
Office of Technical Services
Roadway Information

STRUSR00305**C

State True Log

9.36

County True Log

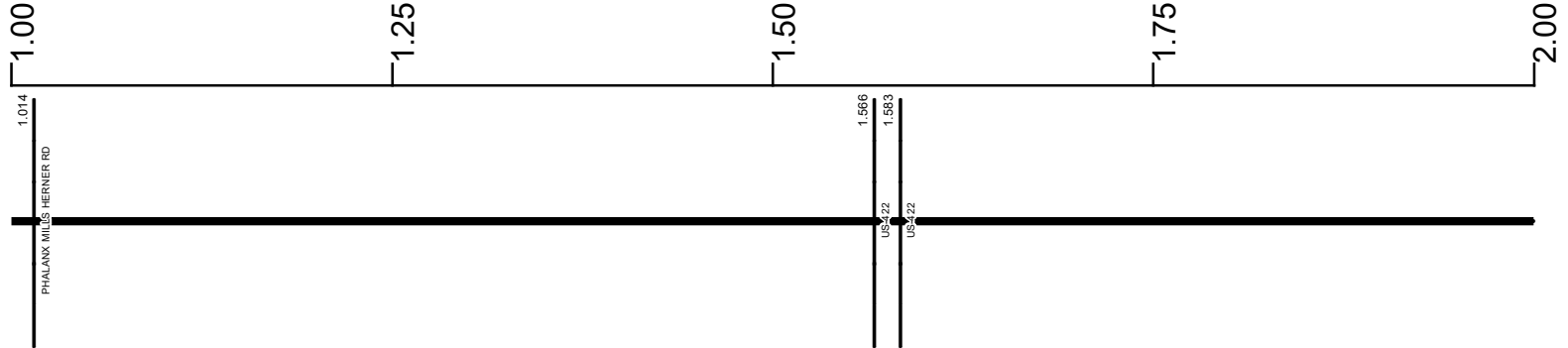

Surface Type & Width (Left / Right)

G (18'4') 0 - 1.542	G (20'4') 1.542 - 2.452
------------------------	----------------------------

Base Type (Left / Right)

I / L 0 - 1.542	K / L 1.542 - 5.722
--------------------	------------------------

Shoulder Type & Width (Left / Right)

2 (1'1") 0 - 1.542	2 (4'4") 1.542 - 5.722
-----------------------	---------------------------

Resurface Year

2021 0 - 1.57

Through Lanes

2 0 - 23.813

Street Name

SR 305 0 - 5.188

- | | | | |
|--|---|---|---|
| <ul style="list-style-type: none"> Non-divided Highway Divided Highway Secondary Segment Corporation | <ul style="list-style-type: none"> Bridge (on route) Underpass Overpass | <ul style="list-style-type: none"> Railroad (at grade) Railroad (underpass) Railroad (overpass) | <ul style="list-style-type: none"> Intersection |
|--|---|---|---|

Created on: 7/8/2025

transportation.ohio.gov

Prepared by
The Ohio Department of Transportation
Office of Technical Services
Roadway Information

STRUSR00305**C

State True Log

10.36

County True Log

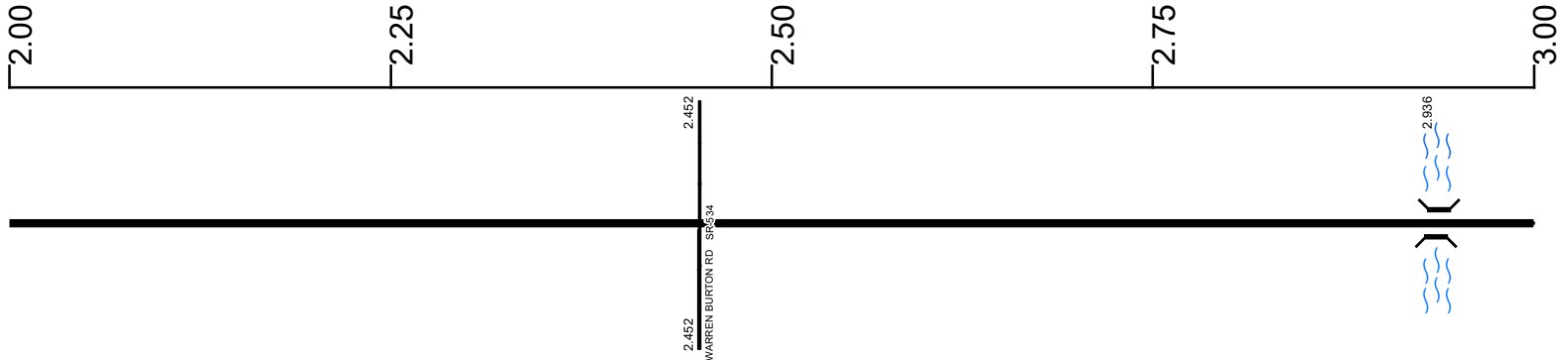

Surface Type & Width (Left / Right)

G (20'/4') 1.542 - 2.452	G (18'/6') 2.452 - 5.188
-----------------------------	-----------------------------

Base Type (Left / Right)

K / L 1.542 - 5.722	
------------------------	--

Shoulder Type & Width (Left / Right)

2 (4'/4') 1.542 - 5.722	
----------------------------	--

Through Lanes

2 0 - 23.813	
-----------------	--

Street Name

SR 305 0 - 5.188	
---------------------	--

- | | | | |
|--|---|---|---|
| <ul style="list-style-type: none"> Non-divided Highway Divided Highway Secondary Segment Corporation | <ul style="list-style-type: none"> Bridge (on route) Underpass Overpass | <ul style="list-style-type: none"> Railroad (at grade) Railroad (underpass) Railroad (overpass) | <ul style="list-style-type: none"> Intersection |
|--|---|---|---|

Created on: 7/8/2025

transportation.ohio.gov

Prepared by
The Ohio Department of Transportation
Office of Technical Services
Roadway Information

STRUSR00305**C

State True Log

11.36

County True Log

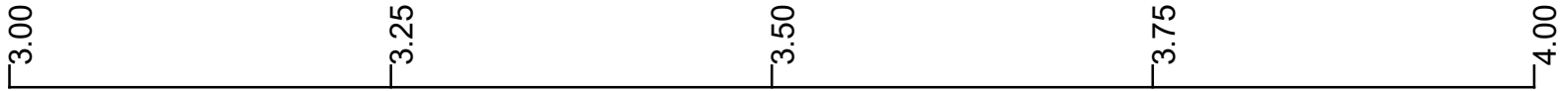

Surface Type & Width (Left / Right)

	G (18/6')
	2.452 - 5.188

Base Type (Left / Right)

	K / L
	1.542 - 5.722

Shoulder Type & Width (Left / Right)

	2 (4/4')
	1.542 - 5.722

Through Lanes

	2
	0 - 23.813

Street Name

	SR 305
	0 - 5.188

- | | | | |
|---------------------|-------------------|----------------------|--------------|
| Non-divided Highway | Bridge (on route) | Railroad (at grade) | Intersection |
| Divided Highway | Underpass | Railroad (underpass) | |
| Secondary Segment | Overpass | Railroad (overpass) | |
| Corporation | | | |

Created on: 7/8/2025

transportation.ohio.gov

Prepared by
The Ohio Department of Transportation
Office of Technical Services
Roadway Information

STRUSR00305**C

State True Log

12.36

County True Log

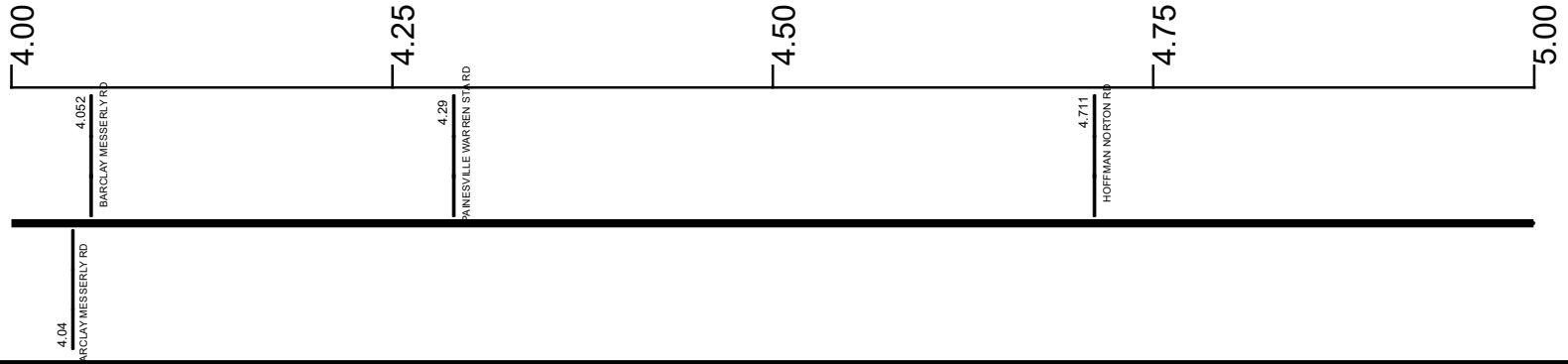

Surface Type & Width (Left / Right)

	G (18/6')
	2.452 - 5.188

Base Type (Left / Right)

	K / L
	1.542 - 5.722

Shoulder Type & Width (Left / Right)

	2 (4/4')
	1.542 - 5.722

Through Lanes

	2
	0 - 23.813

Street Name

	SR 305
	0 - 5.188

- | | | | |
|---------------------|-------------------|----------------------|--------------|
| Non-divided Highway | Bridge (on route) | Railroad (at grade) | Intersection |
| Divided Highway | Underpass | Railroad (underpass) | |
| Secondary Segment | Overpass | Railroad (overpass) | |
| Corporation | | | |

Created on: 7/8/2025

transportation.ohio.gov

Prepared by
The Ohio Department of Transportation
Office of Technical Services
Roadway Information

STRUSR00305**C

State True Log

13.36

County True Log



Surface Type & Width (Left / Right)

G (18'/6") 2.452 - 5.188	G (16'/8") 5.188 - 5.722	G 24' 5.722 - 5.966	G (18'/6") 5.966 - 6.609
-----------------------------	-----------------------------	------------------------	-----------------------------

Base Type (Left / Right)

K / L 1.542 - 5.722	I 5.722 - 5.966	I / L 5.966 - 8.881	
------------------------	--------------------	------------------------	--

Shoulder Type & Width (Left / Right)

2 (4'/4") 1.542 - 5.722	2 (2'/2") 5.722 - 5.966	2 (4'/4") 5.966 - 7.811	
----------------------------	----------------------------	----------------------------	--

Through Lanes

	2 0 - 23.813		
--	-----------------	--	--

Street Name

SR 305 0 - 5.188	STATE RD 5.188 - 5.722	OAK HILL DR 5.722 - 6.609	
---------------------	---------------------------	------------------------------	--

<p> Non-divided Highway</p> <p> Divided Highway</p> <p> Secondary Segment</p> <p> Corporation</p>	<p> Bridge (on route)</p> <p> Underpass</p> <p> Overpass</p>	<p> Railroad (at grade)</p> <p> Railroad (underpass)</p> <p> Railroad (overpass)</p>	<p> Intersection</p>
---	--	--	----------------------

Created on: 7/8/2025

transportation.ohio.gov

Prepared by

The Ohio Department of Transportation

Office of Technical Services

Roadway Information

STRUSR00305**C

State True Log

14.36

County True Log

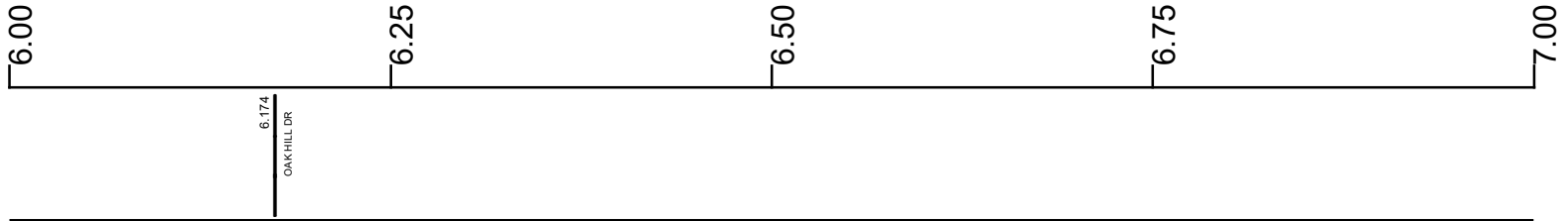

Surface Type & Width (Left / Right)

G (18'6") 5.966 - 6.609	G (19'5") 6.609 - 8.681
----------------------------	----------------------------

Base Type (Left / Right)

I / L 5.966 - 8.681	
------------------------	--

Shoulder Type & Width (Left / Right)

2 (4'4") 5.966 - 7.811	
---------------------------	--

Through Lanes

2 0 - 23.813	
-----------------	--

Street Name

OAK HILL DR 5.722 - 6.609	CENTER ST 6.609 - 8.681
------------------------------	----------------------------

- | | | | |
|--|---|---|---|
| <ul style="list-style-type: none"> Non-divided Highway Divided Highway Secondary Segment Corporation | <ul style="list-style-type: none"> Bridge (on route) Underpass Overpass | <ul style="list-style-type: none"> Railroad (at grade) Railroad (underpass) Railroad (overpass) | <ul style="list-style-type: none"> Intersection |
|--|---|---|---|

Created on: 7/8/2025

transportation.ohio.gov

Prepared by
The Ohio Department of Transportation
Office of Technical Services
Roadway Information

STRUSR00305**C

State True Log

15.36

County True Log



Surface Type & Width (Left / Right)

	G (19'5')
	6.609 - 8.681

Base Type (Left / Right)

	I / L
	5.966 - 8.681

Shoulder Type & Width (Left / Right)

2 (4'4')	5 (4'4')
5.966 - 7.811	7.811 - 8.681

Through Lanes

	2
	0 - 23.813

Street Name

	CENTER ST
	6.609 - 8.681

- | | | | |
|--|---|---|---|
| <ul style="list-style-type: none"> Non-divided Highway Divided Highway Secondary Segment Corporation | <ul style="list-style-type: none"> Bridge (on route) Underpass Overpass | <ul style="list-style-type: none"> Railroad (at grade) Railroad (underpass) Railroad (overpass) | <ul style="list-style-type: none"> Intersection |
|--|---|---|---|

Created on: 7/8/2025

transportation.ohio.gov

Prepared by
The Ohio Department of Transportation
Office of Technical Services
Roadway Information

STRUSR00305**C

State True Log

16.36

County True Log

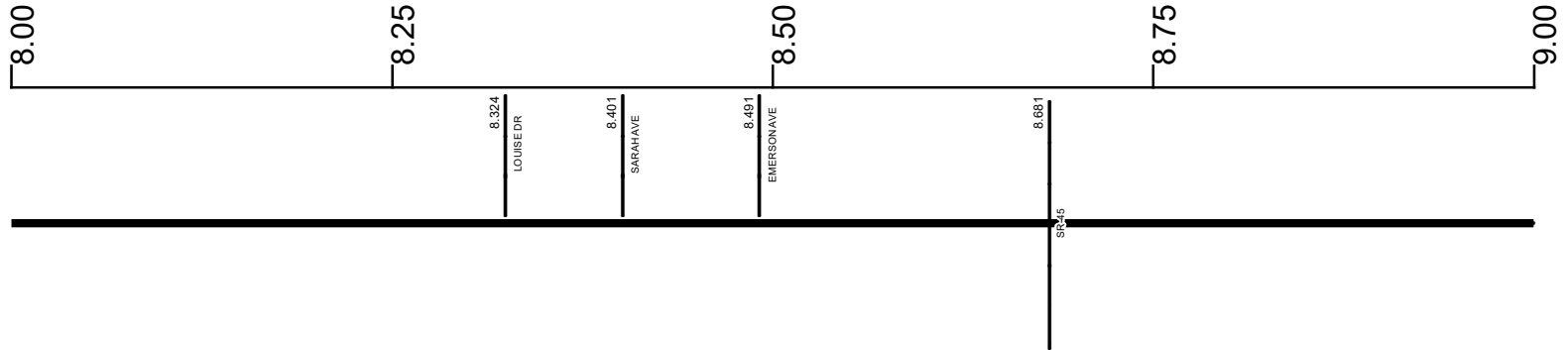

Surface Type & Width (Left / Right)

G (19'5") 6.609 - 8.681	G (18'2") 8.681 - 12.342
----------------------------	-----------------------------

Base Type (Left / Right)

I / L 5.966 - 8.681	K / L 8.681 - 9.575
------------------------	------------------------

Shoulder Type & Width (Left / Right)

5 (4'4") 7.811 - 8.681	2 (3'3") 8.681 - 12.342
---------------------------	----------------------------

Through Lanes

	2 0 - 23.813
--	-----------------

Street Name

6.609 - 8.681	CENTER ST 8.681 - 10.7
---------------	---------------------------

- | | | | |
|--|---|---|---|
| <ul style="list-style-type: none"> Non-divided Highway Divided Highway Secondary Segment Corporation | <ul style="list-style-type: none"> Bridge (on route) Underpass Overpass | <ul style="list-style-type: none"> Railroad (at grade) Railroad (underpass) Railroad (overpass) | <ul style="list-style-type: none"> Intersection |
|--|---|---|---|

Created on: 7/8/2025

transportation.ohio.gov

Prepared by
The Ohio Department of Transportation
Office of Technical Services
Roadway Information

STRUSR00305**C

State True Log

17.36

County True Log

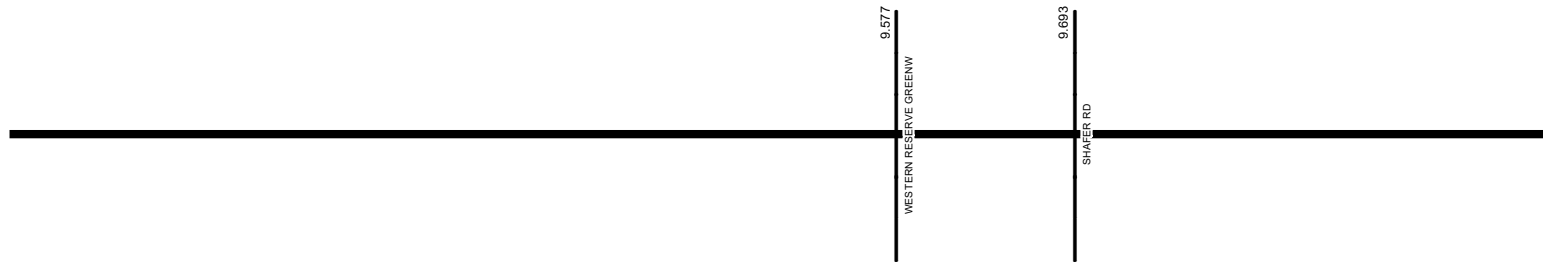

Surface Type & Width (Left / Right)

G (18/2')
8.681 - 12.342

Base Type (Left / Right)

K / L	K / I
8.681 - 9.575	9.575 - 12.342

Shoulder Type & Width (Left / Right)

2 (3/3)
8.681 - 12.342

Through Lanes

2
0 - 23.813

Street Name

CENTER ST
8.681 - 10.7

- Non-divided Highway
 Bridge (on route)
 Railroad (at grade)
 Intersection
- Divided Highway
 Underpass
 Railroad (underpass)
- Secondary Segment
 Overpass
 Railroad (overpass)
- Corporation**

Created on: 7/8/2025

transportation.ohio.gov

Prepared by

The Ohio Department of Transportation

Office of Technical Services

Roadway Information

STRUSR00305**C

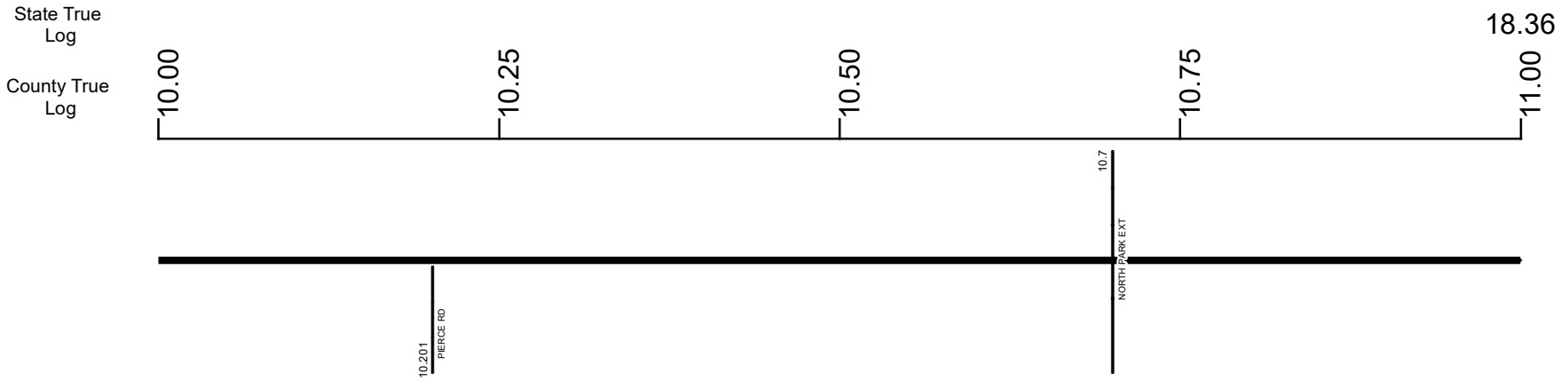

Surface Type & Width (Left / Right)	G (18/2')
	8.681 - 12.342
Base Type (Left / Right)	K / I
	9.575 - 12.342
Shoulder Type & Width (Left / Right)	2 (3/3')
	8.681 - 12.342

Through Lanes	2
	0 - 23.813

Street Name	CENTER ST	SR 305
	8.681 - 10.7	10.7 - 16.407

- Non-divided Highway
- Divided Highway
- Secondary Segment
- Corporation
- Bridge (on route)
- Underpass
- Overpass
- Railroad (at grade)
- Railroad (underpass)
- Railroad (overpass)
- Intersection

Created on: 7/8/2025



transportation.ohio.gov
 Prepared by
 The Ohio Department of Transportation
 Office of Technical Services
 Roadway Information

STRUSR00305**C

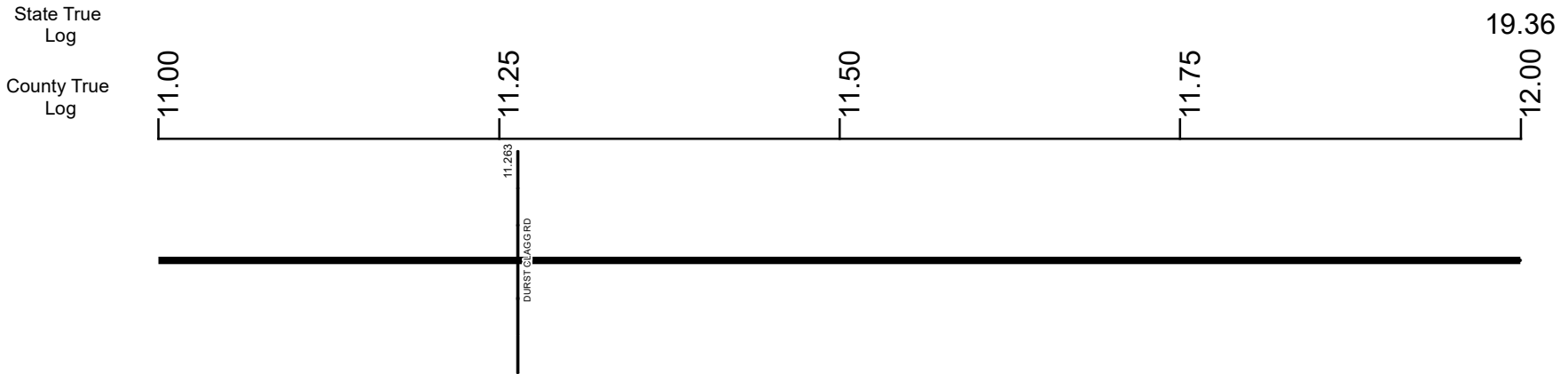

Surface Type & Width (Left / Right)

G (18'/2')
8.681 - 12.342

Base Type (Left / Right)

K / I
9.575 - 12.342

Shoulder Type & Width (Left / Right)

2 (3'/3')
8.681 - 12.342

Through Lanes

2
0 - 23.813

Street Name

SR 305
10.7 - 16.407

- Non-divided Highway
 Bridge (on route)
 Railroad (at grade)
 Intersection
- Divided Highway
 Underpass
 Railroad (underpass)
- Secondary Segment
 Overpass
 Railroad (overpass)
- Corporation**

Created on: 7/8/2025



transportation.ohio.gov
 Prepared by
 The Ohio Department of Transportation
 Office of Technical Services
 Roadway Information

STRUSR00305**C

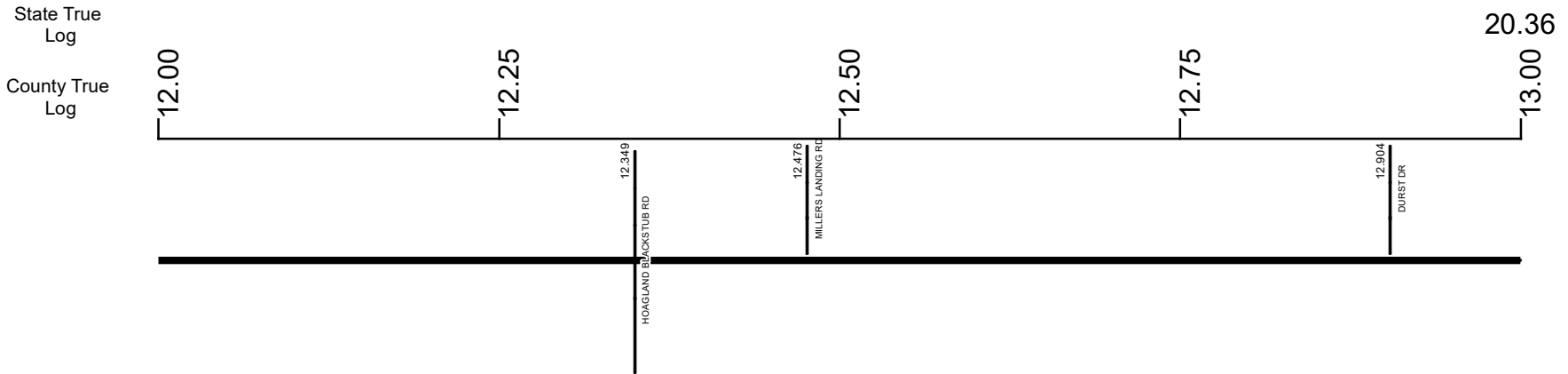

Surface Type & Width (Left / Right)

G (18'2") 8.681 - 12.342	G 20' 12.342 - 14.815
-----------------------------	--------------------------

Base Type (Left / Right)

K / I 9.575 - 12.342	K 12.342 - 14.815
-------------------------	----------------------

Shoulder Type & Width (Left / Right)

2 (3'3") 8.681 - 12.342	2 (8'8") 12.342 - 14.605
----------------------------	-----------------------------

Through Lanes

	2 0 - 23.813
--	-----------------

Street Name

	SR 305 10.7 - 16.407
--	-------------------------

- Non-divided Highway
- Divided Highway
- Secondary Segment
- Corporation
- Bridge (on route)
- Underpass
- Overpass
- Railroad (at grade)
- Railroad (underpass)
- Railroad (overpass)
- Intersection

Created on: 7/8/2025

transportation.ohio.gov

Prepared by
The Ohio Department of Transportation
Office of Technical Services
Roadway Information

STRUSR00305**C

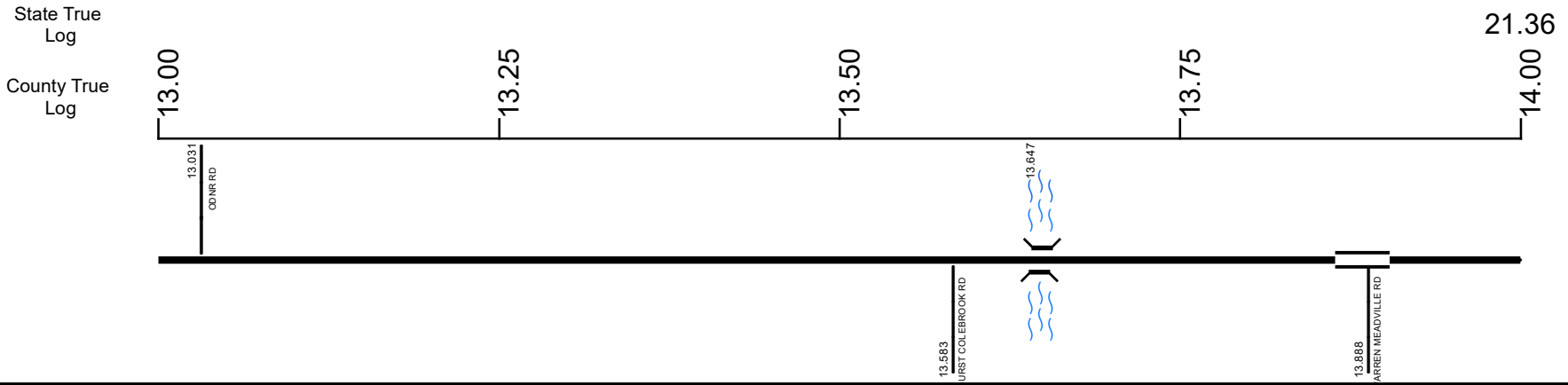

Surface Type & Width (Left / Right)	G 20'
	12.342 - 14.815
Base Type (Left / Right)	K
	12.342 - 14.815
Shoulder Type & Width (Left / Right)	2 (8/8)
	12.342 - 14.605
	Median Type and Width
	2 (10')
	13.864 - 13.904

Through Lanes	2
	0 - 23.813
Street Name	SR 305
	10.7 - 16.407

Non-divided Highway	Bridge (on route)	Railroad (at grade)	Intersection
Divided Highway	Underpass	Railroad (underpass)	
Secondary Segment	Overpass	Railroad (overpass)	
Corporation			

Created on: 7/8/2025

transportation.ohio.gov

Prepared by
The Ohio Department of Transportation
Office of Technical Services
Roadway Information

STRUSR00305**C

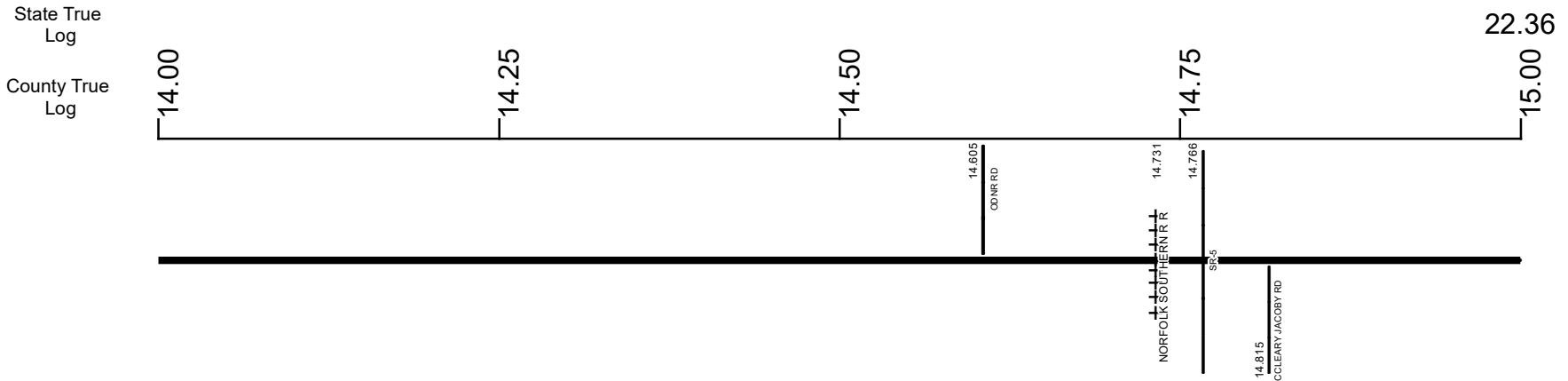

Surface Type & Width (Left / Right)	
G 20'	G (16'4')
12.342 - 14.815	14.815 - 15.188
Base Type (Left / Right)	
K	K / I
12.342 - 14.815	14.815 - 15.188
Shoulder Type & Width (Left / Right)	
2 (8/8')	5 (4/4')
12.342 - 14.605	14.605 - 15.188

Through Lanes	
2	
0 - 23.813	
Street Name	
SR 305	
10.7 - 16.407	

<ul style="list-style-type: none"> Non-divided Highway Divided Highway Secondary Segment Corporation 	<ul style="list-style-type: none"> Bridge (on route) Underpass Overpass 	<ul style="list-style-type: none"> Railroad (at grade) Railroad (underpass) Railroad (overpass) 	<ul style="list-style-type: none"> Intersection
--	---	---	---

Created on: 7/8/2025

transportation.ohio.gov

Prepared by
The Ohio Department of Transportation
Office of Technical Services
Roadway Information

STRUSR00305**C

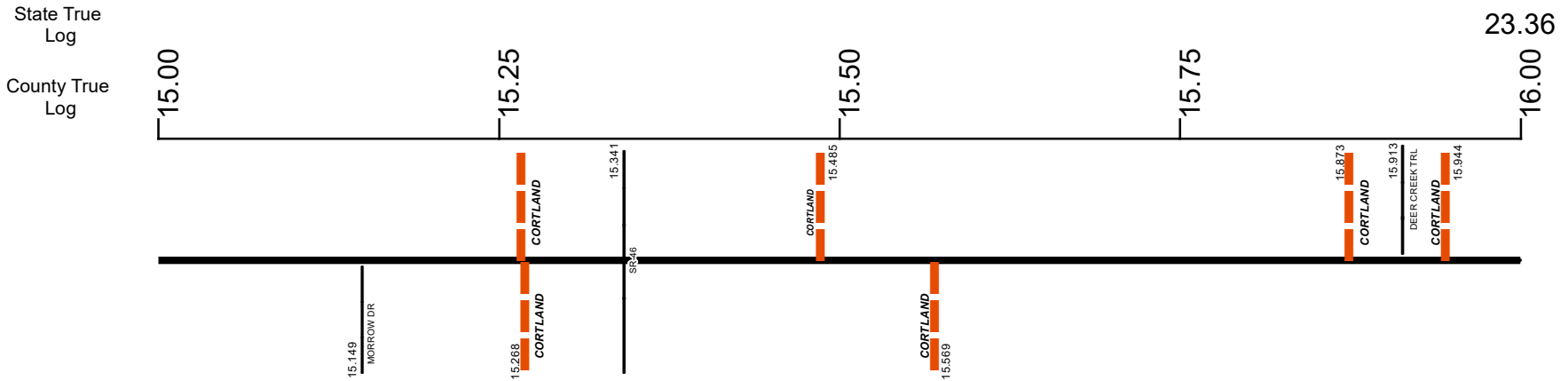

Surface Type & Width (Left / Right)

G (16'4") 14.815 - 15.188	G 36' 15.188 - 15.513	G (16'4") 15.513 - 16.645
------------------------------	--------------------------	------------------------------

Base Type (Left / Right)

K / I 14.815 - 15.188	L 15.188 - 15.513	K / I 15.513 - 16.645
--------------------------	----------------------	--------------------------

Shoulder Type & Width (Left / Right)

5 (4'4") 14.605 - 15.188	1 (0'0") 15.188 - 15.341	2 (4'4") 15.341 - 15.513	2 (2'2") 15.513 - 16.089
-----------------------------	-----------------------------	-----------------------------	-----------------------------

Through Lanes

	2
	0 - 23.813

Street Name

	SR 305
	10.7 - 16.407

- Non-divided Highway
- Divided Highway
- Secondary Segment
- Corporation
- Bridge (on route)
- Underpass
- Overpass
- Railroad (at grade)
- Railroad (underpass)
- Railroad (overpass)
- Intersection

Created on: 7/8/2025

transportation.ohio.gov

Prepared by
The Ohio Department of Transportation
Office of Technical Services
Roadway Information

STRUSR00305**C

State True Log
County True Log

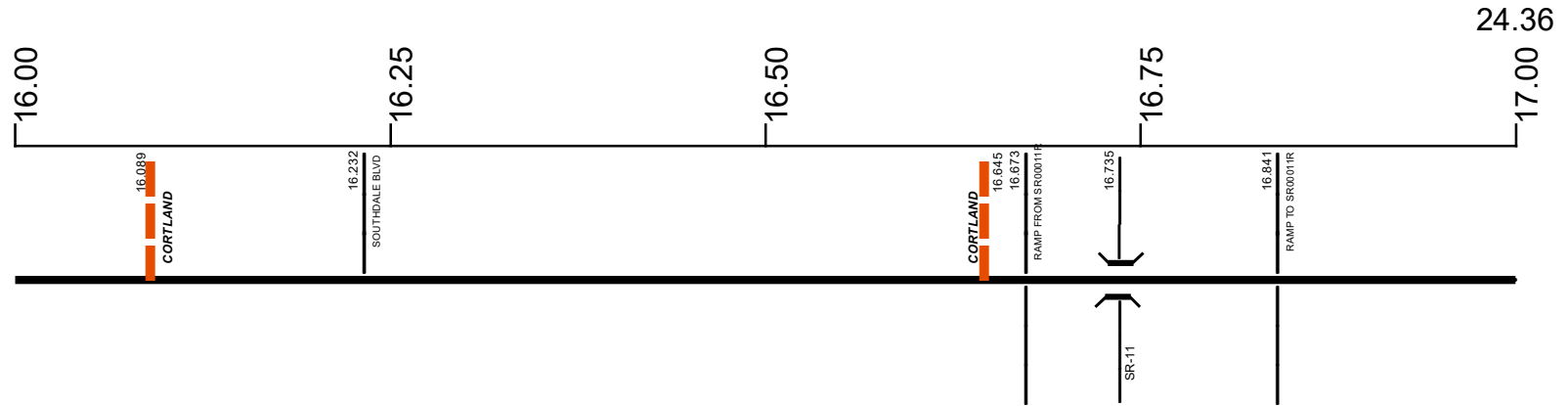

Surface Type & Width (Left / Right)

G (16'4") 15.513 - 16.645	G 24' 16.645 - 16.969	G (16'4") 16.969 - 23.93
------------------------------	--------------------------	-----------------------------

Base Type (Left / Right)

K / I 15.513 - 16.645	L 16.645 - 16.969	K / I 16.969 - 23.93
--------------------------	----------------------	-------------------------

Shoulder Type & Width (Left / Right)

2 (2'2") 15.513 - 16.089	5 (2'2") 16.089 - 16.407	2 (2'2") 16.407 - 16.645	2 (10'10") 16.645 - 16.969	2 (2'2") 16.969 - 23.93
-----------------------------	-----------------------------	-----------------------------	-------------------------------	----------------------------

Through Lanes

2 0 - 23.813

Street Name

SR 305 10.7 - 16.407	WILSON SHARPSVILLE RD 16.407 - 21.306
-------------------------	--

- Non-divided Highway
- Divided Highway
- Secondary Segment
- Corporation**
- Bridge (on route)
- Underpass
- Overpass
- Railroad (at grade)
- Railroad (underpass)
- Railroad (overpass)
- Intersection

Created on: 7/8/2025

transportation.ohio.gov

Prepared by
The Ohio Department of Transportation
Office of Technical Services
Roadway Information

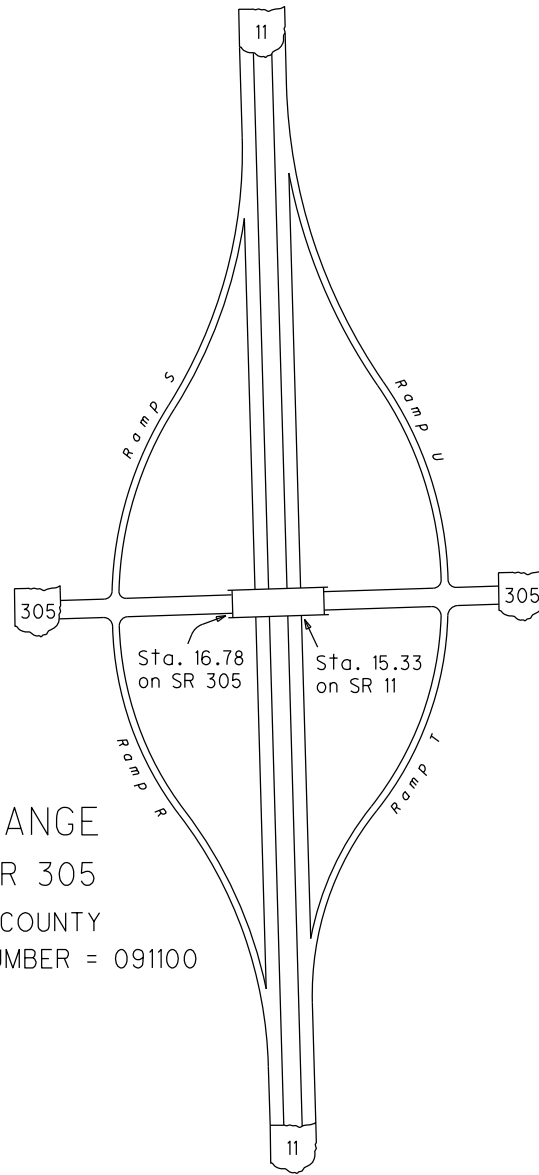

INTERCHANGE
SR 11 & SR 305
TRUMBULL COUNTY
INTERCHANGE ID NUMBER = 091100

STRUSR00305**C

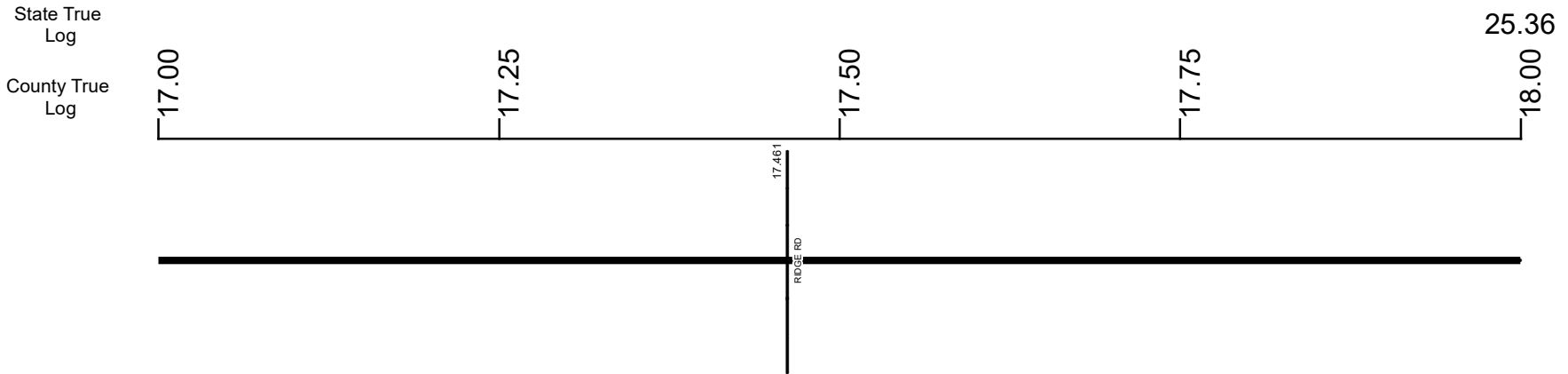

Surface Type & Width (Left / Right)

G (16'4')
16.969 - 23.93

Base Type (Left / Right)

K / I
16.969 - 23.93

Shoulder Type & Width (Left / Right)

2 (2'2')
16.969 - 23.93

Through Lanes

2
0 - 23.813

Street Name

WILSON SHARPSVILLE RD
16.407 - 21.306

- Non-divided Highway
 Bridge (on route)
 Railroad (at grade)
 Intersection
- Divided Highway
 Underpass
 Railroad (underpass)
- Secondary Segment
 Overpass
 Railroad (overpass)
- Corporation**

Created on: 7/8/2025

transportation.ohio.gov

Prepared by
The Ohio Department of Transportation
Office of Technical Services
Roadway Information

STRUSR00305**C

State True Log

26.36

County True Log

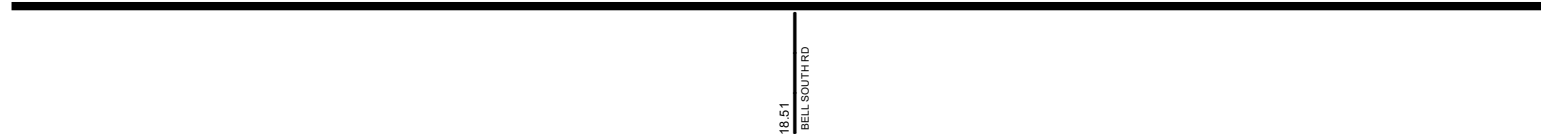
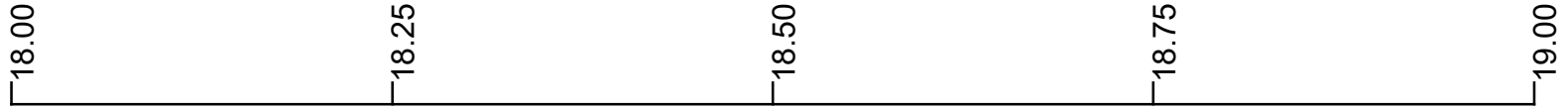

Surface Type & Width (Left / Right)

G (16'4')
16.969 - 23.93

Base Type (Left / Right)

K / I
16.969 - 23.93

Shoulder Type & Width (Left / Right)

2 (2'2')
16.969 - 23.93

Through Lanes

2
0 - 23.813

Street Name

WILSON SHARPSVILLE RD
16.407 - 21.306

- | | | | |
|---------------------|-------------------|----------------------|--------------|
| Non-divided Highway | Bridge (on route) | Railroad (at grade) | Intersection |
| Divided Highway | Underpass | Railroad (underpass) | |
| Secondary Segment | Overpass | Railroad (overpass) | |
| Corporation | | | |

Created on: 7/8/2025



transportation.ohio.gov

Prepared by
The Ohio Department of Transportation
Office of Technical Services
Roadway Information

STRUSR00305**C

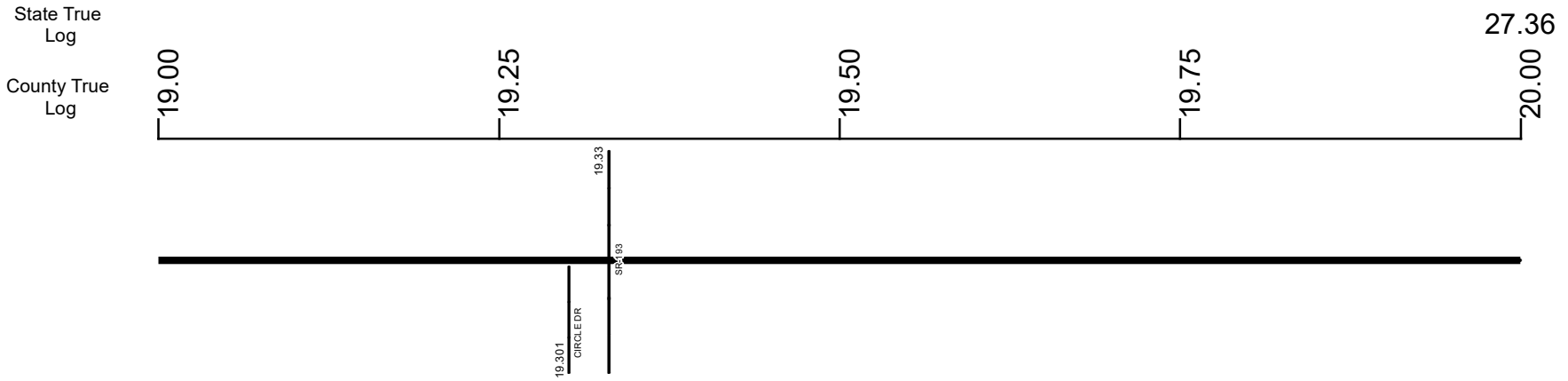

Surface Type & Width (Left / Right)	G (16'4')
	16.969 - 23.93
Base Type (Left / Right)	K / I
	16.969 - 23.93
Shoulder Type & Width (Left / Right)	2 (2'2')
	16.969 - 23.93
Through Lanes	2
	0 - 23.813
Street Name	WILSON SHARPSVILLE RD
	16.407 - 21.306

- | | | | |
|---------------------|-------------------|----------------------|--------------|
| Non-divided Highway | Bridge (on route) | Railroad (at grade) | Intersection |
| Divided Highway | Underpass | Railroad (underpass) | |
| Secondary Segment | Overpass | Railroad (overpass) | |
| Corporation | | | |

Created on: 7/8/2025

transportation.ohio.gov

Prepared by

The Ohio Department of Transportation

Office of Technical Services

Roadway Information

STRUSR00305**C

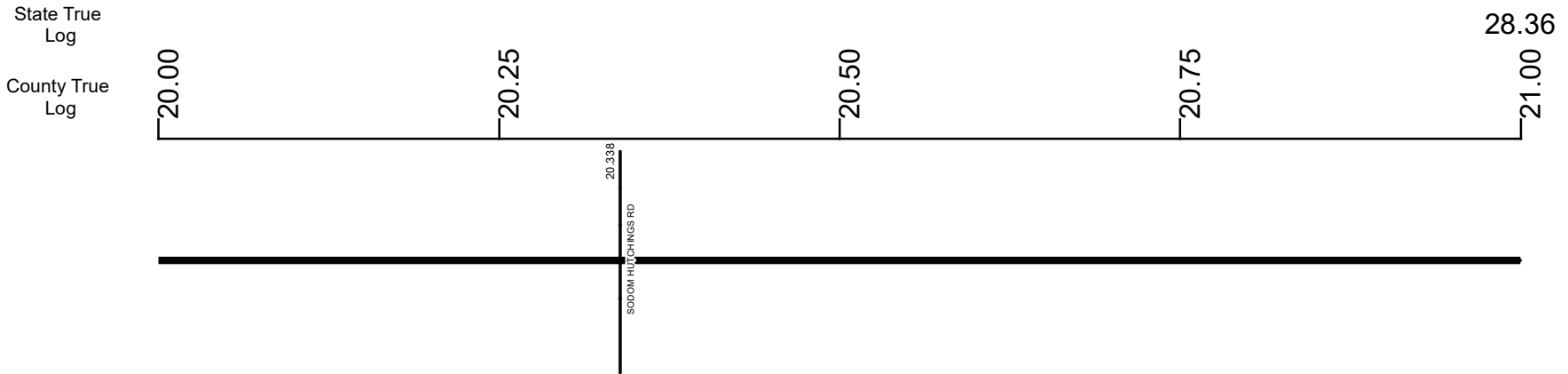

Surface Type & Width (Left / Right)

G (16'4')
16.969 - 23.93

Base Type (Left / Right)

K / I
16.969 - 23.93

Shoulder Type & Width (Left / Right)

2 (2'2')
16.969 - 23.93

Through Lanes

2
0 - 23.813

Street Name

WILSON SHARPSVILLE RD
16.407 - 21.306

- Non-divided Highway
- Divided Highway
- Secondary Segment
- Corporation
- Bridge (on route)
- Underpass
- Overpass
- Railroad (at grade)
- Railroad (underpass)
- Railroad (overpass)
- Intersection

Created on: 7/8/2025

transportation.ohio.gov
Prepared by
The Ohio Department of Transportation
Office of Technical Services
Roadway Information

STRUSR00305**C

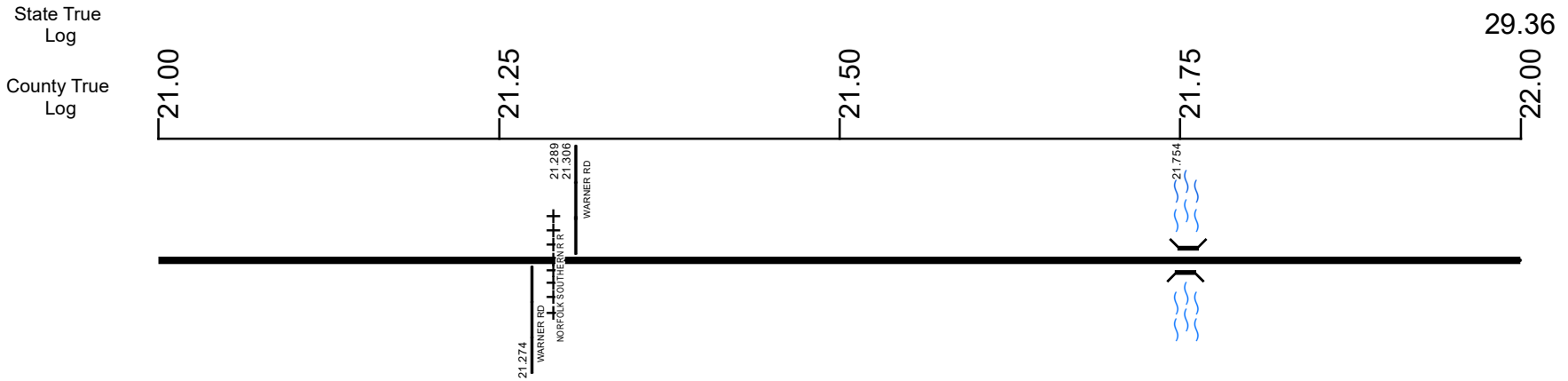

Surface Type & Width (Left / Right)	G (16'4') 16.969 - 23.93		
Base Type (Left / Right)	K / I 16.969 - 23.93		
Shoulder Type & Width (Left / Right)	2 (2'2') 16.969 - 23.93		
Through Lanes	2 0 - 23.813		
Street Name	<table border="1" style="width: 100%; border-collapse: collapse;"> <tr> <td style="width: 50%; text-align: center;">WILSON SHARPSVILLE RD 16.407 - 21.306</td> <td style="width: 50%; text-align: center;">SR 305 21.306 - 23.93</td> </tr> </table>	WILSON SHARPSVILLE RD 16.407 - 21.306	SR 305 21.306 - 23.93
WILSON SHARPSVILLE RD 16.407 - 21.306	SR 305 21.306 - 23.93		

<ul style="list-style-type: none"> Non-divided Highway Divided Highway Secondary Segment Corporation 	<ul style="list-style-type: none"> Bridge (on route) Underpass Overpass 	<ul style="list-style-type: none"> Railroad (at grade) Railroad (underpass) Railroad (overpass) 	<ul style="list-style-type: none"> Intersection
--	---	---	---

Created on: 7/8/2025

transportation.ohio.gov

Prepared by
The Ohio Department of Transportation
Office of Technical Services
Roadway Information

STRUSR00305**C

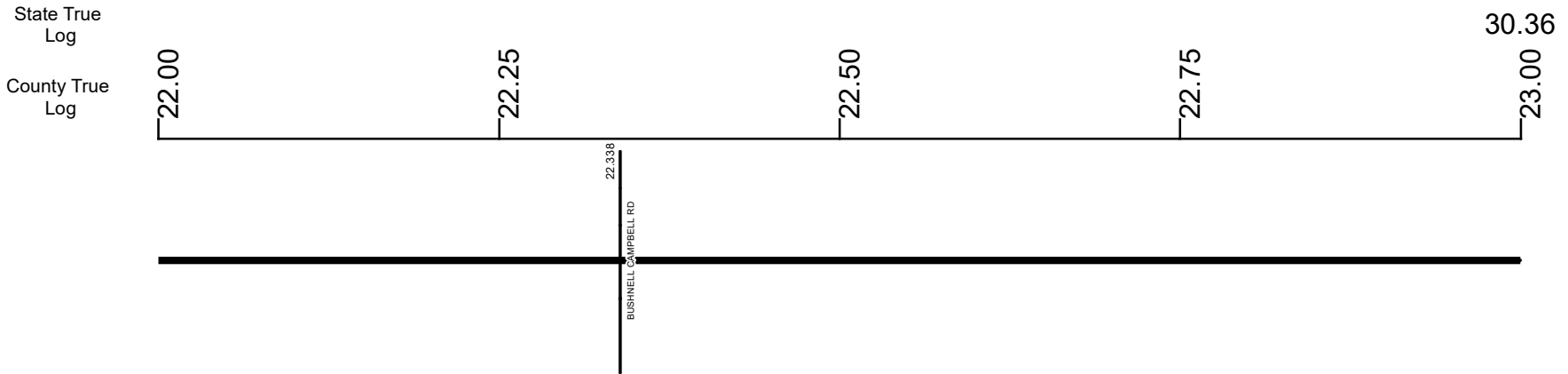

Surface Type & Width (Left / Right)

G (16'4')
16.969 - 23.93

Base Type (Left / Right)

K / I
16.969 - 23.93

Shoulder Type & Width (Left / Right)

2 (2'2')
16.969 - 23.93

Through Lanes

2
0 - 23.813

Street Name

SR 305
21.306 - 23.93

- Non-divided Highway
- Divided Highway
- Secondary Segment
- Corporation
- Bridge (on route)
- Underpass
- Overpass
- Railroad (at grade)
- Railroad (underpass)
- Railroad (overpass)
- Intersection

Created on: 7/8/2025



transportation.ohio.gov
 Prepared by
 The Ohio Department of Transportation
 Office of Technical Services
 Roadway Information

STRUSR00305**C

State True Log
County True Log

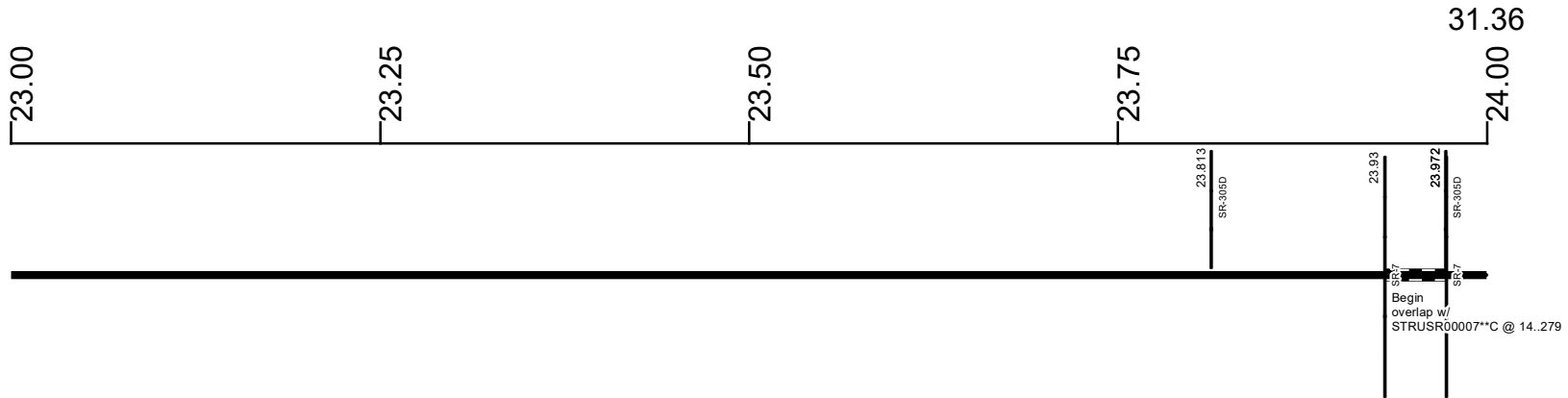

Surface Type & Width (Left / Right)

G (16'4")	G 20'
16.969 - 23.93	

Base Type (Left / Right)

K / I	K
16.969 - 23.93	23.972 - 26.538

Shoulder Type & Width (Left / Right)

2 (2'2")	2 (2'2")
16.969 - 23.93	23.972 - 26.538

Through Lanes

2	1	2
0 - 23.813	23.813 - 23.93	23.972 - 26.538

Street Name

SR 305	SR 305
21.306 - 23.93	23.972 - 26.538

- | | | | |
|---------------------|-------------------|----------------------|--------------|
| Non-divided Highway | Bridge (on route) | Railroad (at grade) | Intersection |
| Divided Highway | Underpass | Railroad (underpass) | |
| Secondary Segment | Overpass | Railroad (overpass) | |
| Corporation | | | |

Created on: 7/8/2025

transportation.ohio.gov

Prepared by
The Ohio Department of Transportation
Office of Technical Services
Roadway Information

STRUSR00305**C

State True Log

32.36

County True Log

24.00

24.25

24.50

24.75

25.00



Surface Type & Width (Left / Right)

G 20'
23.972 - 26.538

Base Type (Left / Right)

K
23.972 - 26.538

Shoulder Type & Width (Left / Right)

2 (2'/2)
23.972 - 26.538

Through Lanes

2
23.972 - 26.538

Street Name

SR 305
23.972 - 26.538

- Non-divided Highway
 Bridge (on route)
 Railroad (at grade)
 Intersection
- Divided Highway
 Underpass
 Railroad (underpass)
- Secondary Segment
 Overpass
 Railroad (overpass)
- Corporation**

Created on: 7/8/2025

transportation.ohio.gov
Prepared by
The Ohio Department of Transportation
Office of Technical Services
Roadway Information

STRUSR00305**C

State True Log

33.36

County True Log



Surface Type & Width (Left / Right)

G 20'
23.972 - 26.538

Base Type (Left / Right)

K
23.972 - 26.538

Shoulder Type & Width (Left / Right)

2 (2'/2)
23.972 - 26.538

Through Lanes

2
23.972 - 26.538

Street Name

SR 305
23.972 - 26.538

- | | | | |
|---------------------|-------------------|----------------------|--------------|
| Non-divided Highway | Bridge (on route) | Railroad (at grade) | Intersection |
| Divided Highway | Underpass | Railroad (underpass) | |
| Secondary Segment | Overpass | Railroad (overpass) | |
| Corporation | | | |

Created on: 7/8/2025

transportation.ohio.gov

Prepared by
The Ohio Department of Transportation
Office of Technical Services
Roadway Information

STRUSR00305**C

State True Log

County True Log

33.898

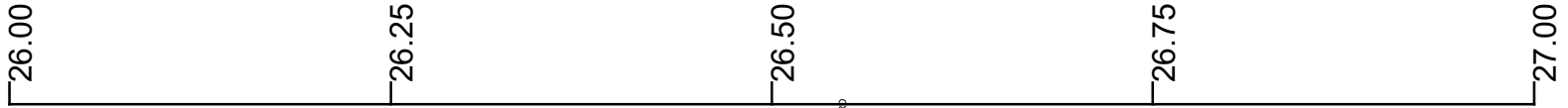

26.538
BROCKWAY SHARON RD

Surface Type & Width (Left / Right)

G 20'
23.972 - 26.538

Base Type (Left / Right)

K
23.972 - 26.538

Shoulder Type & Width (Left / Right)

2 (2 1/2')
23.972 - 26.538

Through Lanes

2
23.972 - 26.538

Street Name

SR 305
23.972 - 26.538

- | | | | |
|---------------------|-------------------|----------------------|--------------|
| Non-divided Highway | Bridge (on route) | Railroad (at grade) | Intersection |
| Divided Highway | Underpass | Railroad (underpass) | |
| Secondary Segment | Overpass | Railroad (overpass) | |
| Corporation | | | |

Created on: 7/8/2025



transportation.ohio.gov

Prepared by

The Ohio Department of Transportation
Office of Technical Services
Roadway Information

Historical Project List for STRUSR00305**C

Begin Measure	End Measure	Project ID Number	Construction Completion Date	Treatment Category	Treatment Type
0.000	1.570	110676	10-2021	Minor Rehabilitation	38-Fine Poly AC Overlay
0.000	1.570	100237	12-2017	Preventive Maintenance	25-Chip Seal
0.000	1.570	77835	9-2009	Minor Rehabilitation	60-AC Overlay w/Rpr
1.570	2.450	88912	7-2017	Minor Rehabilitation	60-AC Overlay w/Rpr
1.570	2.450	19787	5-2003	Minor Rehabilitation	60-AC Overlay w/Rpr
2.450	23.930	96568	10-2020	Minor Rehabilitation	60-AC Overlay w/Rpr
23.972	26.538	94118	11-2019	Minor Rehabilitation	60-AC Overlay w/Rpr

Roadway Codes

Access Control Journalized

- F - Full Access Control
- L - Limited Access Control
- N - No Access Control

Access Control Operational

- 1 - Full Access Control
- 2 - Partial Access Control
- 3 - No Access Control

Base Type

- F - Crack and Seat
- H - Rubblize and Roll
- I - Aggregate Base 304 or Traffic Compacted
- K - Water Bound Macadam
- L - Bituminous Concrete Mix or Penetration Macadam
- N - Plain Concrete
- P - Reinforced Concrete
- R - Brick (Flexible)
- T - Brick (Rigid)

Direction of Travel

- B - Both (Two-way)
- F - One-way Cardinal
- T - One-way Non-cardinal

Facility Type

- 1 - One-way Roadway
- 2 - Two-way Roadway
- 4 - Ramp
- 5 - Non-mainline
- 6 - Non-inventory Direction
- 7 - Planned / Unbuilt

Historical Federal Aid Indicator

- N - Not a FAP Route
- Y - FAP Route

Functional Classification

- 01 - Interstate
- 02 - Principal Arterial (Freeways)
- 03 - Principal Arterial (Other)
- 04 - Minor Arterial
- 05 - Major Collector
- 06 - Minor Collector
- 07 - Local

Leave / Reenter Indicator

- Y - Route leaves/reenters at this point
- N - Route does not leave/reenter at this point

Median Type

- 1 - None
- 2 - Unprotected
- 3 - Curbed
- 4 - Positive Barrier (Unspecified)
- 5 - Positive Barrier (Flexible)
- 6 - Positive Barrier (Semi-rigid)
- 7 - Positive Barrier (Rigid)

NHS

- N - National Highway System
- H - Congressional Corridor
- 2 - Major Airport
- 3 - Major Port Facility
- 4 - Major Amtrak Station
- 5 - Major Rail / Truck Terminal
- 6 - Major Intercity Bus Terminal
- 7 - Major Public Transit / Multi-modal Passenger Terminal
- 8 - Major Pipeline Terminal
- 9 - Major Ferry Terminal

Priority System

- G - General
- P - Priority System
- U - Urban

Scenic Byway Code

- A - All American Road
- N - National Scenic Byway
- S - State Scenic Byway

Shoulder Type

- 1 - None
- 2 - Surfaced shoulder exists (bituminous concrete {AC})
- 3 - Surfaced shoulder exists (Portland Cement Concrete {PCC})
- 4 - Stabilized shoulder exists (gravel or other granular material)
- 5 - Combination shoulder exists (two or more surface types)
- 6 - Earth shoulder exists
- 7 - Barrier curb exists; no shoulder in front of curb

Surface Type

- A - Combination
- B - Brick
- C - Continuous Reinforced Concrete
- D - Reinforced Concrete
- E - Plain Concrete
- G - Bituminous Concrete
- I - Chipseal on Granular
- K - Open Graded Bituminous
- L - Chipseal or Micro
- M - Gravel
- U - Unimproved
- X - Right of Way Only