

STRUSR00534**C

State True Log

18.258

County True Log

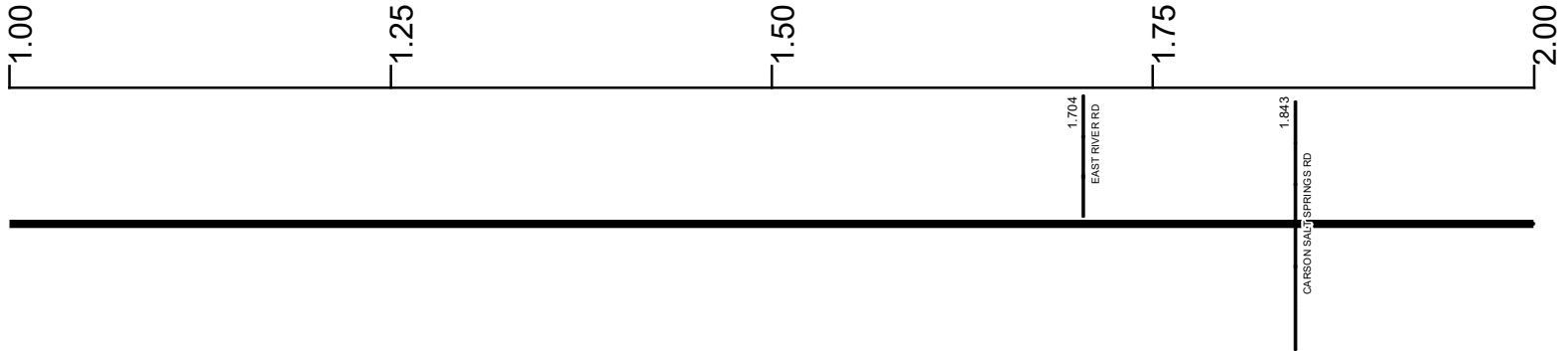

Surface Type & Width (Left / Right)

G 24'	G (17'7")	G 24'
0 - 1.167	1.167 - 1.615	1.615 - 3.678

Base Type (Left / Right)

L	K / L	L
0.75 - 1.167	1.167 - 1.615	1.615 - 3.678

Shoulder Type & Width (Left / Right)

5 (3/3)
0 - 4.155

Through Lanes

2
0 - 23.808

Street Name

SR 534
0 - 2.746

- | | | | |
|---------------------|-------------------|----------------------|--------------|
| Non-divided Highway | Bridge (on route) | Railroad (at grade) | Intersection |
| Divided Highway | Underpass | Railroad (underpass) | |
| Secondary Segment | Overpass | Railroad (overpass) | |
| Corporation | | | |

Created on: 7/8/2025

transportation.ohio.gov

Prepared by
The Ohio Department of Transportation
Office of Technical Services
Roadway Information

STRUSR00534**C

State True Log

19.258

County True Log

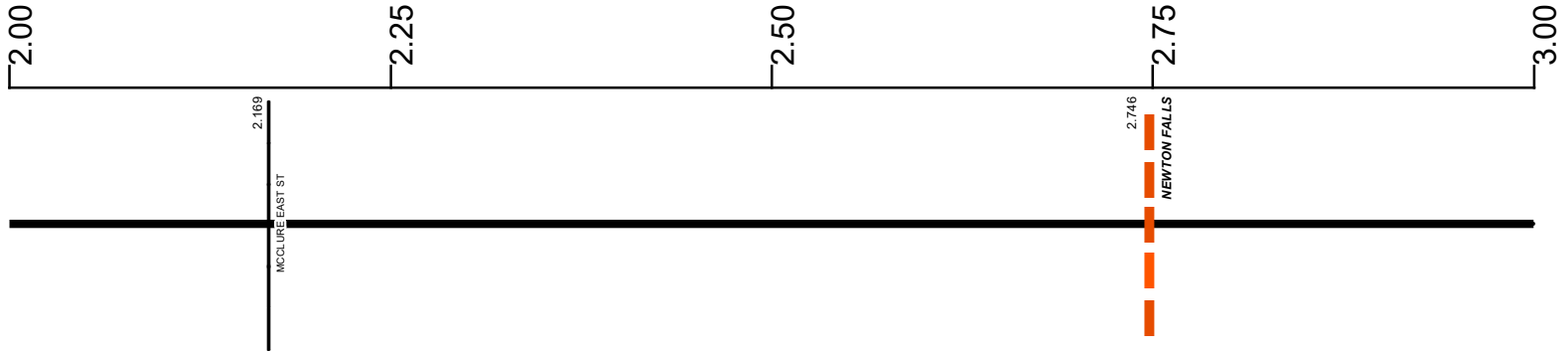

Surface Type & Width (Left / Right)

G 24'
1.615 - 3.678

Base Type (Left / Right)

L
1.615 - 3.678

Shoulder Type & Width (Left / Right)

5 (3/3)
0 - 4.155

Through Lanes

2
0 - 23.808

Street Name

SR 534 0 - 2.746	MILTON BLVD 2.746 - 3.405
---------------------	------------------------------

- | | | | |
|---------------------|-------------------|----------------------|--------------|
| Non-divided Highway | Bridge (on route) | Railroad (at grade) | Intersection |
| Divided Highway | Underpass | Railroad (underpass) | |
| Secondary Segment | Overpass | Railroad (overpass) | |
| Corporation | | | |

Created on: 7/8/2025

transportation.ohio.gov

Prepared by
The Ohio Department of Transportation
Office of Technical Services
Roadway Information

STRUSR00534**C

State True Log

20.258

County True Log

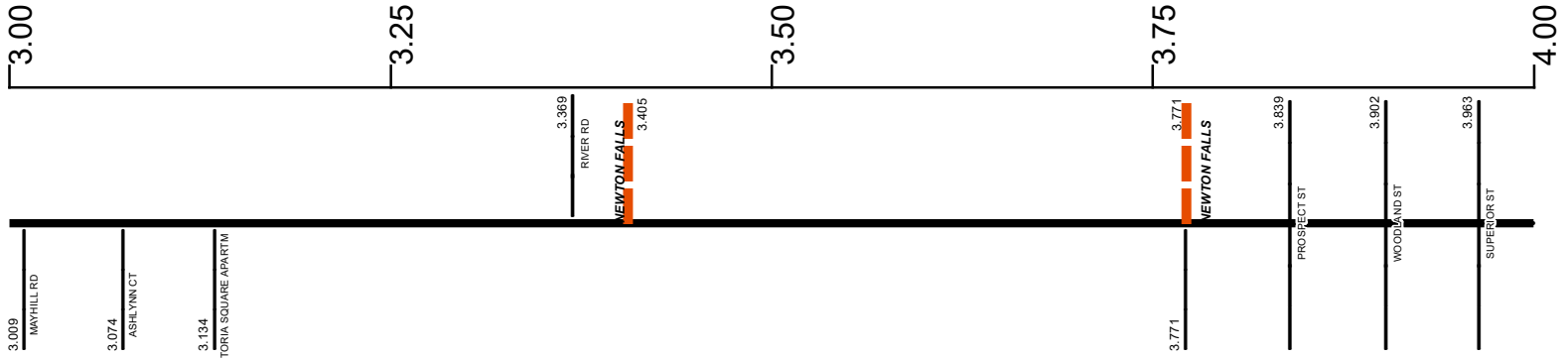

Surface Type & Width (Left / Right)

G 24'	G (17'7")	G (20'4")
1.615 - 3.678	3.678 - 3.771	3.771 - 4.021

Base Type (Left / Right)

L	K / L	R / L
1.615 - 3.678	3.678 - 3.771	3.771 - 4.021

Shoulder Type & Width (Left / Right)

	5 (3/3)	
	0 - 4.155	

Resurface Year

2021
3.75 - 4.02

Through Lanes

	2	
	0 - 23.808	

Street Name

MILTON BLVD	SR 534	MILTON BLVD
2.746 - 3.405	3.405 - 3.771	3.771 - 4.021

- Non-divided Highway
- Divided Highway
- Secondary Segment
- Corporation
- Bridge (on route)
- Underpass
- Overpass
- Railroad (at grade)
- Railroad (underpass)
- Railroad (overpass)
- Intersection

Created on: 7/8/2025

transportation.ohio.gov

Prepared by
The Ohio Department of Transportation
Office of Technical Services
Roadway Information

STRUSR00534**C

State True Log

21.258

County True Log

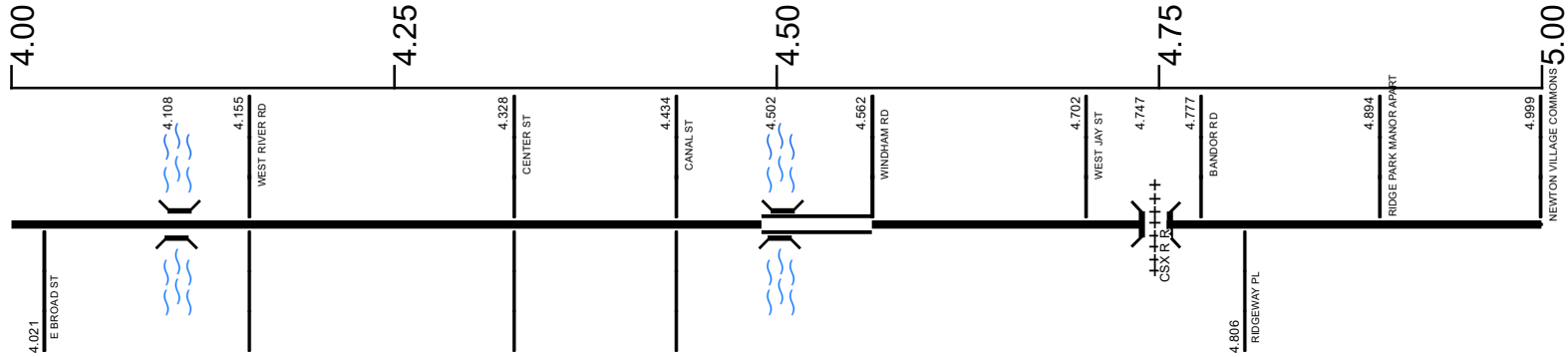

Surface Type & Width (Left / Right)

G (20'4')	G 24'	G (24'/16')	G (32'/33')	D (33'/32')	G (16'/12')	G 28'	G (18'/6')
3.771 - 4.021	4.021 - 4.155	4.155 - 4.328	4.328 - 4.49	4.499 - 4.562	4.564 - 4.646	4.646 - 4.824	4.824 - 5.507

Base Type (Left / Right)

R / L	N	T / L	T	K / I	I	P / I
3.771 - 4.021	4.021 - 4.155	4.155 - 4.328	4.328 - 4.499	4.564 - 4.646	4.646 - 4.824	4.824 - 5.507

Shoulder Type & Width (Left / Right)

5 (3'/3')	1 (0'/0')	5 (2'/2')
0 - 4.155	4.155 - 4.824	4.824 - 5.187

Median Type and Width

3 (3')
4.49 - 4.562

Resurface Year

2021

3.75 - 4.02

Through Lanes

2
0 - 23.808

Street Name

MILTON BLVD	E BROAD ST	W BROAD ST	RIDGE RD
3.771 - 4.021	4.021 - 4.328	4.328 - 4.562	4.562 - 5.187

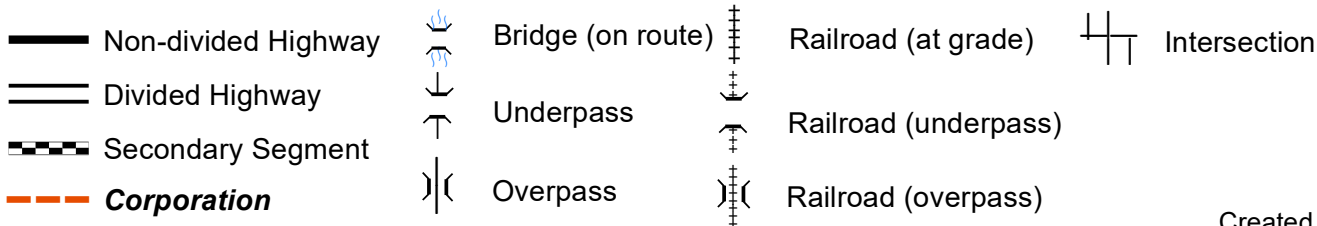

Created on: 7/8/2025

transportation.ohio.gov

Prepared by
The Ohio Department of Transportation
Office of Technical Services
Roadway Information

STRUSR00534**C

State True Log

22.258

County True Log

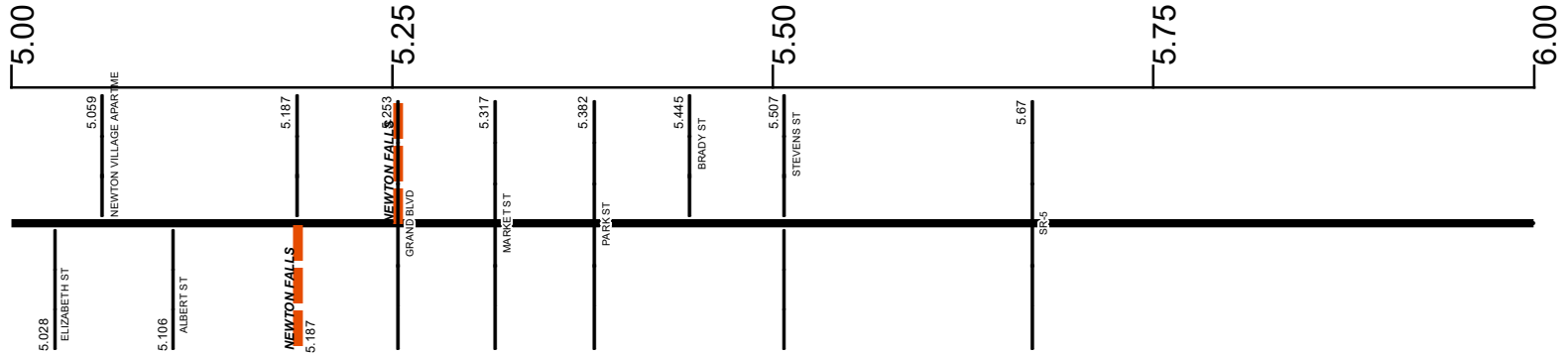

Surface Type & Width (Left / Right)

G (18'6") 4.824 - 5.507	G (20'4") 5.507 - 5.67	G (20'2") 5.67 - 7.941
----------------------------	---------------------------	---------------------------

Base Type (Left / Right)

P / I 4.824 - 5.507	K / I 5.507 - 5.67	K / L 5.67 - 7.941
------------------------	-----------------------	-----------------------

Shoulder Type & Width (Left / Right)

5 (2'2") 4.824 - 5.187	5 (3'3") 5.187 - 5.67	5 (2'2") 5.67 - 9.721
---------------------------	--------------------------	--------------------------

Resurface Year

2021 5.52 - 7.941

Through Lanes

2 0 - 23.808

Street Name

RIDGE RD 4.562 - 5.187	SR 534 5.187 - 7.721
---------------------------	-------------------------

- Non-divided Highway
- Divided Highway
- Secondary Segment
- Corporation
- Bridge (on route)
- Underpass
- Overpass
- Railroad (at grade)
- Railroad (underpass)
- Railroad (overpass)
- Intersection

Created on: 7/8/2025

transportation.ohio.gov

Prepared by
The Ohio Department of Transportation
Office of Technical Services
Roadway Information

STRUSR00534**C

State True Log

23.258

County True Log



Surface Type & Width (Left / Right)	G (20'/2')
	5.67 - 7.941
Base Type (Left / Right)	K / L
	5.67 - 7.941
Shoulder Type & Width (Left / Right)	5 (2'/2')
	5.67 - 9.721
Resurface Year	2021
	5.52 - 7.941
Through Lanes	2
	0 - 23.808
Street Name	SR 534
	5.187 - 7.721

Non-divided Highway	Bridge (on route)	Railroad (at grade)	Intersection
Divided Highway	Underpass	Railroad (underpass)	
Secondary Segment	Overpass	Railroad (overpass)	
Corporation			

Created on: 7/8/2025

transportation.ohio.gov

Prepared by
The Ohio Department of Transportation
Office of Technical Services
Roadway Information

STRUSR00534**C

State True Log

24.258

County True Log

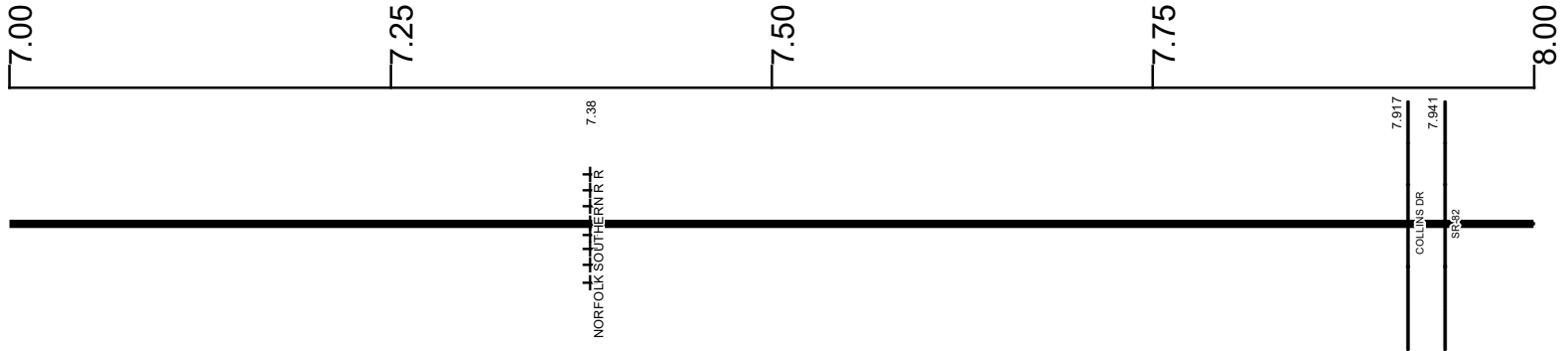

Surface Type & Width (Left / Right)

G (20'2")	G (18'2")
5.67 - 7.941	7.941 - 9.061

Base Type (Left / Right)

K / L	K / I
5.67 - 7.941	7.941 - 9.061

Shoulder Type & Width (Left / Right)

5 (2'2")
5.67 - 9.721

Resurface Year

2021	2022
5.52 - 7.941	7.941 - 9.877

Through Lanes

2
0 - 23.808

Street Name

	SR 534	
5.187 - 7.721		7.721 - 21.561

- | | | | |
|--|---|---|---|
| <ul style="list-style-type: none"> Non-divided Highway Divided Highway Secondary Segment Corporation | <ul style="list-style-type: none"> Bridge (on route) Underpass Overpass | <ul style="list-style-type: none"> Railroad (at grade) Railroad (underpass) Railroad (overpass) | <ul style="list-style-type: none"> Intersection |
|--|---|---|---|

Created on: 7/8/2025

transportation.ohio.gov

Prepared by
The Ohio Department of Transportation
Office of Technical Services
Roadway Information

STRUSR00534**C

State True Log

25.258

County True Log

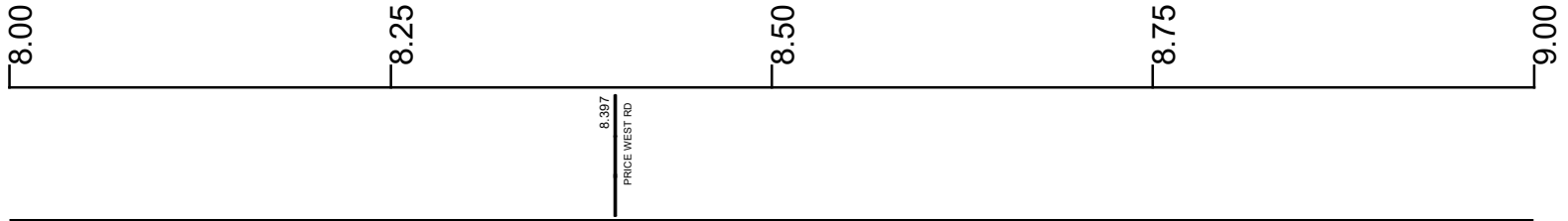

Surface Type & Width (Left / Right)

G (18/2')
7.941 - 9.061

Base Type (Left / Right)

K / I
7.941 - 9.061

Shoulder Type & Width (Left / Right)

5 (2/2')
5.67 - 9.721

Resurface Year

2022
7.941 - 9.877

Through Lanes

2
0 - 23.808

Street Name

SR 534
7.721 - 21.561

- | | | | |
|---------------------|-------------------|----------------------|--------------|
| Non-divided Highway | Bridge (on route) | Railroad (at grade) | Intersection |
| Divided Highway | Underpass | Railroad (underpass) | |
| Secondary Segment | Overpass | Railroad (overpass) | |
| Corporation | | | |

Created on: 7/8/2025

transportation.ohio.gov

Prepared by
The Ohio Department of Transportation
Office of Technical Services
Roadway Information

STRUSR00534**C

State True Log

26.258

County True Log

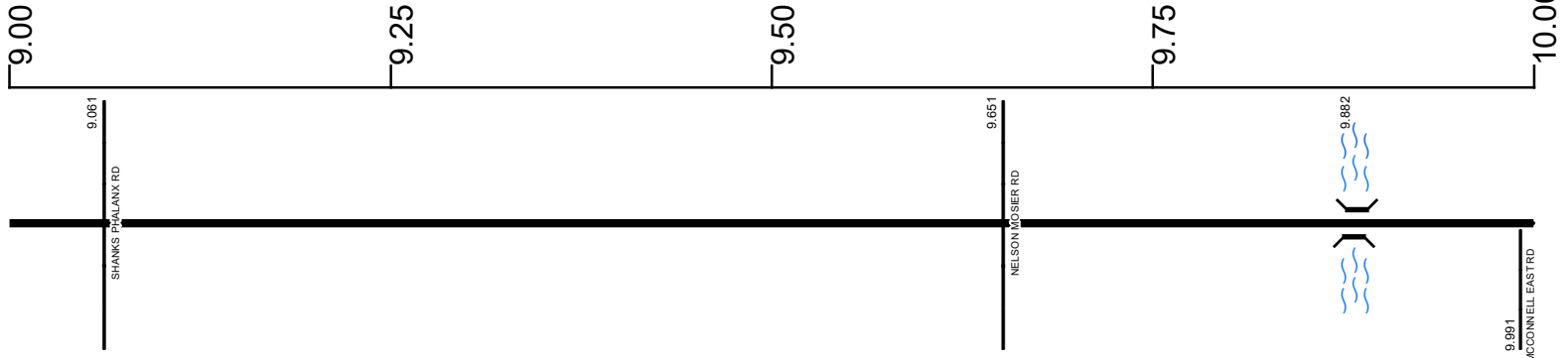

Surface Type & Width (Left / Right)

G (18/2')	G 20'	G 24'
7.941 - 9.061	9.061 - 9.721	9.721 - 10.372

Base Type (Left / Right)

K / I	I	
7.941 - 9.061	9.061 - 13.246	

Shoulder Type & Width (Left / Right)

5 (2/2')	5 (3/3')
5.67 - 9.721	9.721 - 10.372

Resurface Year

2022		
7.941 - 9.877		

Resurface Year

2022
9.92 - 10.41

Through Lanes

2
0 - 23.808

Street Name

SR 534
7.721 - 21.561

- Non-divided Highway
- Divided Highway
- Secondary Segment
- Corporation
- Bridge (on route)
- Underpass
- Overpass
- Railroad (at grade)
- Railroad (underpass)
- Railroad (overpass)
- Intersection

Created on: 7/8/2025

transportation.ohio.gov

Prepared by
The Ohio Department of Transportation
Office of Technical Services
Roadway Information

STRUSR00534**C

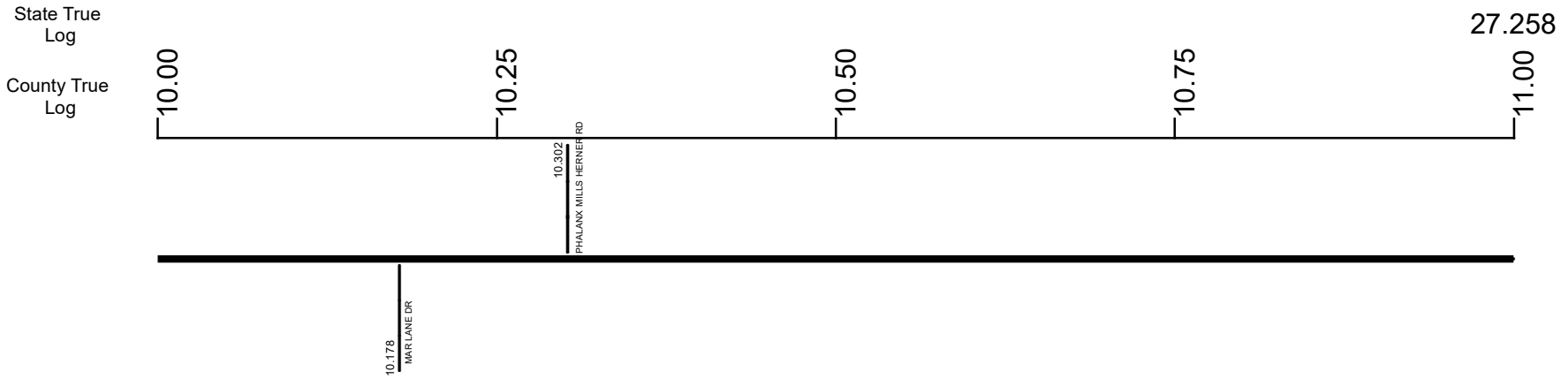

Surface Type & Width (Left / Right)	
G 24' 9.721 - 10.372	G 20' 10.372 - 13.246
Base Type (Left / Right)	
I 9.061 - 13.246	
Shoulder Type & Width (Left / Right)	
5 (3/3') 9.721 - 10.372	5 (2/2') 10.372 - 24.173
Resurface Year	
2022 9.92 - 10.41	2021 10.41 - 12.48
Through Lanes	
2 0 - 23.808	
Street Name	
SR 534 7.721 - 21.561	

Non-divided Highway	Bridge (on route)	Railroad (at grade)	Intersection
Divided Highway	Underpass	Railroad (underpass)	
Secondary Segment	Overpass	Railroad (overpass)	
Corporation			

Created on: 7/8/2025

transportation.ohio.gov

Prepared by
The Ohio Department of Transportation
Office of Technical Services
Roadway Information

STRUSR00534**C

State True Log

28.258

County True Log

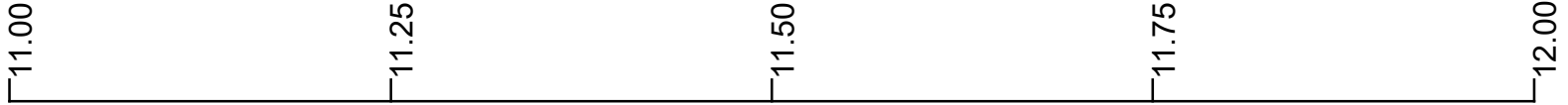

Surface Type & Width (Left / Right)	G 20'
	10.372 - 13.246
Base Type (Left / Right)	I
	9.061 - 13.246
Shoulder Type & Width (Left / Right)	5 (2/2')
	10.372 - 24.173
Resurface Year	2021
	10.41 - 12.48
Through Lanes	2
	0 - 23.808
Street Name	SR 534
	7.721 - 21.561

<ul style="list-style-type: none"> Non-divided Highway Divided Highway Secondary Segment Corporation 	<ul style="list-style-type: none"> Bridge (on route) Underpass Overpass 	<ul style="list-style-type: none"> Railroad (at grade) Railroad (underpass) Railroad (overpass) 	<ul style="list-style-type: none"> Intersection
--	---	---	---

Created on: 7/8/2025

transportation.ohio.gov

Prepared by
The Ohio Department of Transportation
Office of Technical Services
Roadway Information

STRUSR00534**C

State True Log

29.258

County True Log

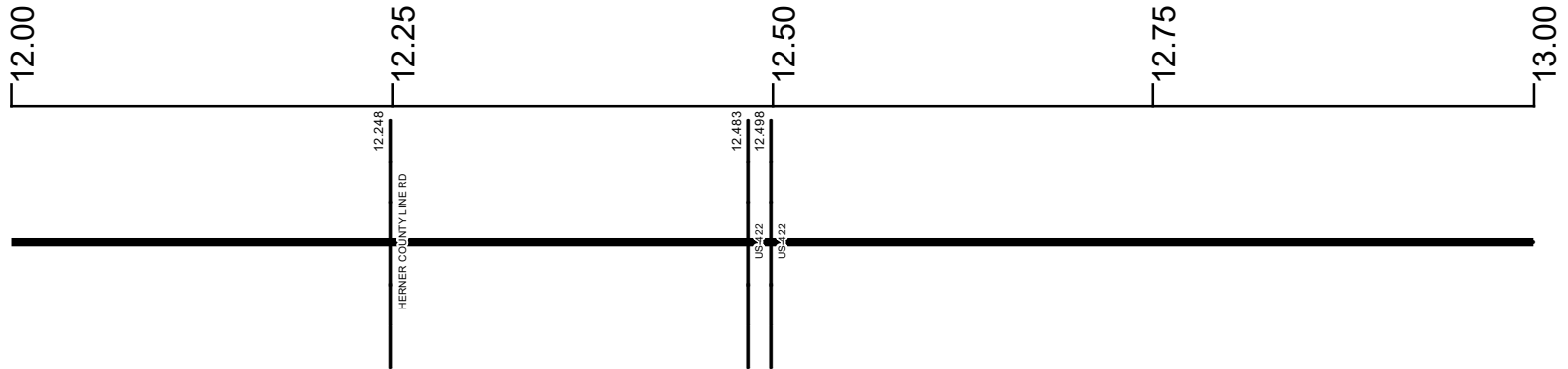

Surface Type & Width (Left / Right)

G 20'
10.372 - 13.246

Base Type (Left / Right)

I
9.061 - 13.246

Shoulder Type & Width (Left / Right)

5 (2/2)
10.372 - 24.173

Resurface Year

2021

10.41 - 12.48

Resurface Year

2022

12.498 - 13.264

Through Lanes

2
0 - 23.808

Street Name

SR 534
7.721 - 21.561

- | | | | |
|---------------------|-------------------|----------------------|--------------|
| Non-divided Highway | Bridge (on route) | Railroad (at grade) | Intersection |
| Divided Highway | Underpass | Railroad (underpass) | |
| Secondary Segment | Overpass | Railroad (overpass) | |
| Corporation | | | |

Created on: 7/8/2025

transportation.ohio.gov

Prepared by
The Ohio Department of Transportation
Office of Technical Services
Roadway Information

STRUSR00534**C

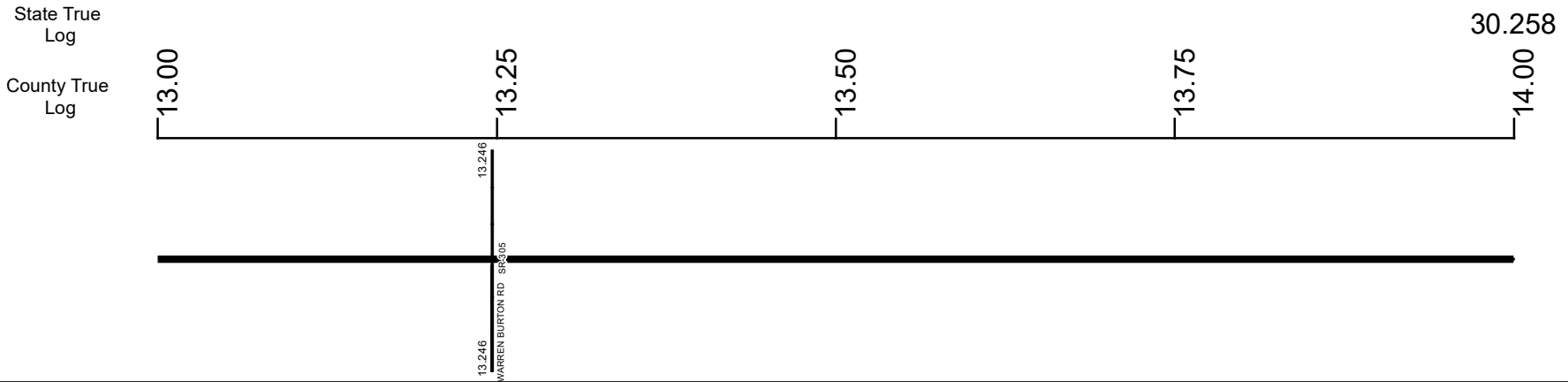

Surface Type & Width (Left / Right)	
G 20' 10.372 - 13.246	G (17'3') 13.246 - 14.804
Base Type (Left / Right)	
I 9.061 - 13.246	K / I 13.246 - 14.804
Shoulder Type & Width (Left / Right)	
5 (2'2") 10.372 - 24.173	
 Resurface Year	
2022 12.498 - 13.264	
Through Lanes	
2 0 - 23.808	
Street Name	
SR 534 7.721 - 21.561	

<ul style="list-style-type: none"> Non-divided Highway Divided Highway Secondary Segment Corporation 	<ul style="list-style-type: none"> Bridge (on route) Underpass Overpass 	<ul style="list-style-type: none"> Railroad (at grade) Railroad (underpass) Railroad (overpass) 	<ul style="list-style-type: none"> Intersection
--	---	---	---

Created on: 7/8/2025

transportation.ohio.gov

Prepared by
The Ohio Department of Transportation
Office of Technical Services
Roadway Information

STRUSR00534**C

State True Log
County True Log

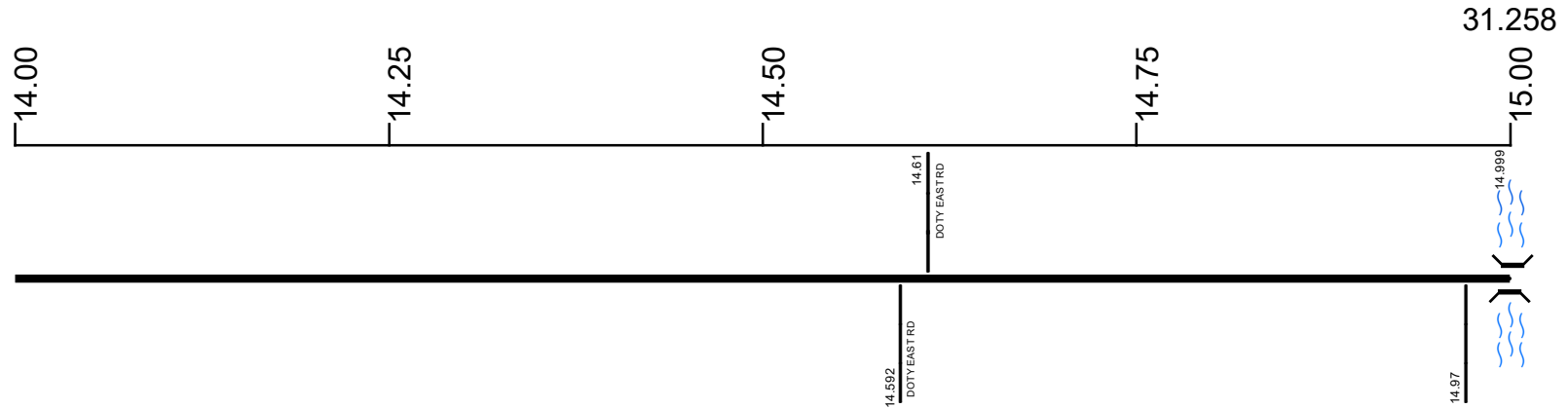

Surface Type & Width (Left / Right)

G (17'3")	G 24'
13.246 - 14.804	14.804 - 15.215

Base Type (Left / Right)

K / I	L
13.246 - 14.804	14.804 - 15.215

Shoulder Type & Width (Left / Right)

5 (2'2")	
10.372 - 24.173	

Through Lanes

	2
	0 - 23.808

Street Name

	SR 534
	7.721 - 21.561

- Non-divided Highway
- Divided Highway
- Secondary Segment
- Corporation
- Bridge (on route)
- Underpass
- Overpass
- Railroad (at grade)
- Railroad (underpass)
- Railroad (overpass)
- Intersection

Created on: 7/8/2025

transportation.ohio.gov

Prepared by
The Ohio Department of Transportation
Office of Technical Services
Roadway Information

STRUSR00534**C

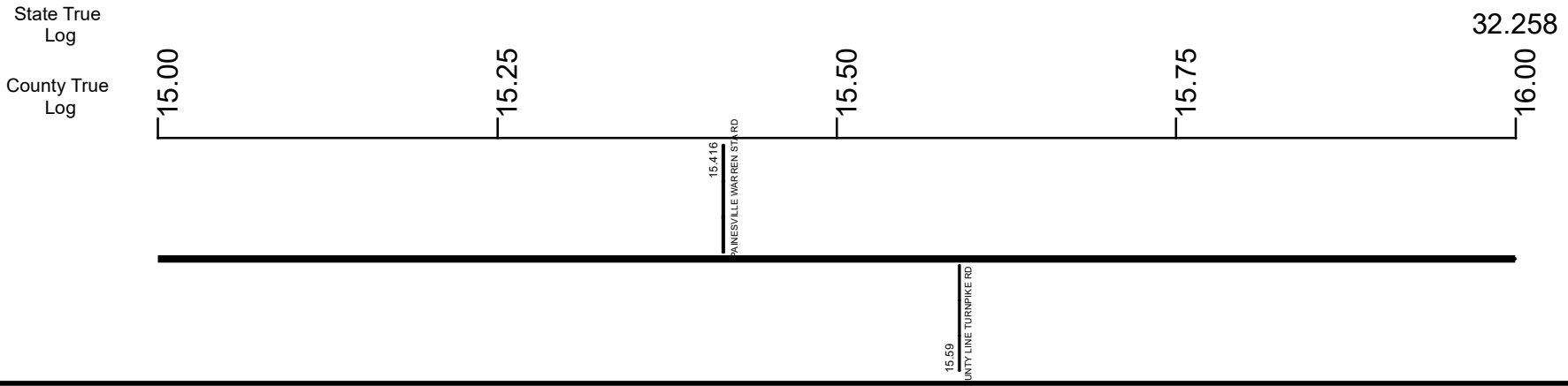

Surface Type & Width (Left / Right)	
G 24' 14.804 - 15.215	G (17'3') 15.215 - 19.121
Base Type (Left / Right)	
L 14.804 - 15.215	K / I 15.215 - 20.221
Shoulder Type & Width (Left / Right)	
5 (2'2") 10.372 - 24.173	

Through Lanes	2 0 - 23.808
Street Name	SR 534 7.721 - 21.561

Non-divided Highway	Bridge (on route)	Railroad (at grade)	Intersection
Divided Highway	Underpass	Railroad (underpass)	
Secondary Segment	Overpass	Railroad (overpass)	
Corporation			

Created on: 7/8/2025



transportation.ohio.gov

Prepared by
The Ohio Department of Transportation
Office of Technical Services
Roadway Information

STRUSR00534**C

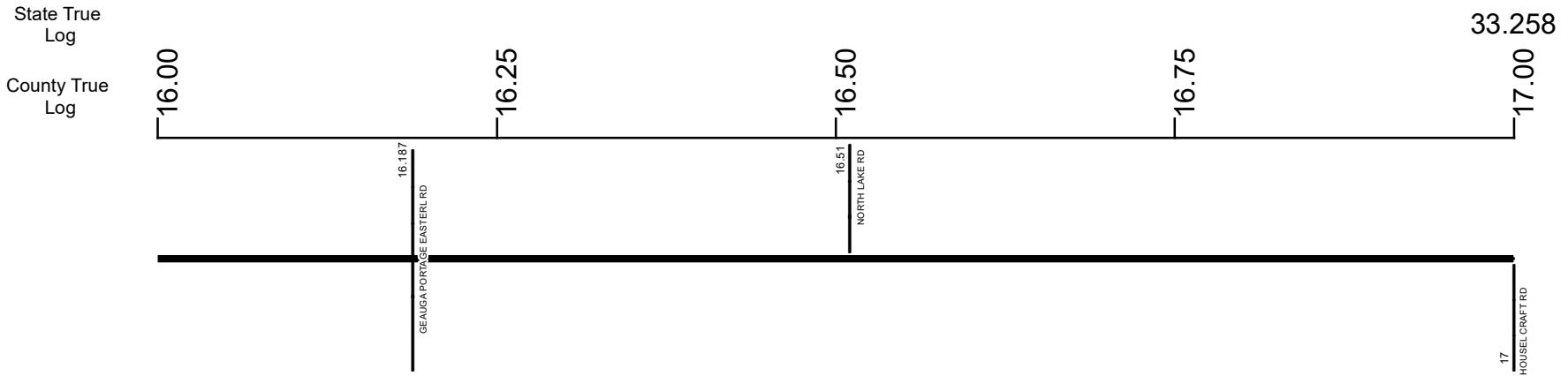

Surface Type & Width (Left / Right)	G (17/3')
	15.215 - 19.121
Base Type (Left / Right)	K / I
	15.215 - 20.221
Shoulder Type & Width (Left / Right)	5 (2/2')
	10.372 - 24.173
Through Lanes	2
	0 - 23.808
Street Name	SR 534
	7.721 - 21.561

	Non-divided Highway		Bridge (on route)		Railroad (at grade)		Intersection
	Divided Highway		Underpass		Railroad (underpass)		
	Secondary Segment		Overpass		Railroad (overpass)		
	Corporation						

Created on: 7/8/2025

transportation.ohio.gov

Prepared by
The Ohio Department of Transportation
Office of Technical Services
Roadway Information

STRUSR00534**C

State True Log

34.258

County True Log



Surface Type & Width (Left / Right)

G (17/3')
15.215 - 19.121

Base Type (Left / Right)

K / I
15.215 - 20.221

Shoulder Type & Width (Left / Right)

5 (2/2')
10.372 - 24.173

Through Lanes

2
0 - 23.808

Street Name

SR 534
7.721 - 21.561

- | | | | |
|---------------------|-------------------|----------------------|--------------|
| Non-divided Highway | Bridge (on route) | Railroad (at grade) | Intersection |
| Divided Highway | Underpass | Railroad (underpass) | |
| Secondary Segment | Overpass | Railroad (overpass) | |
| Corporation | | | |

Created on: 7/8/2025



transportation.ohio.gov

Prepared by
The Ohio Department of Transportation
Office of Technical Services
Roadway Information

STRUSR00534**C

State True Log

County True Log

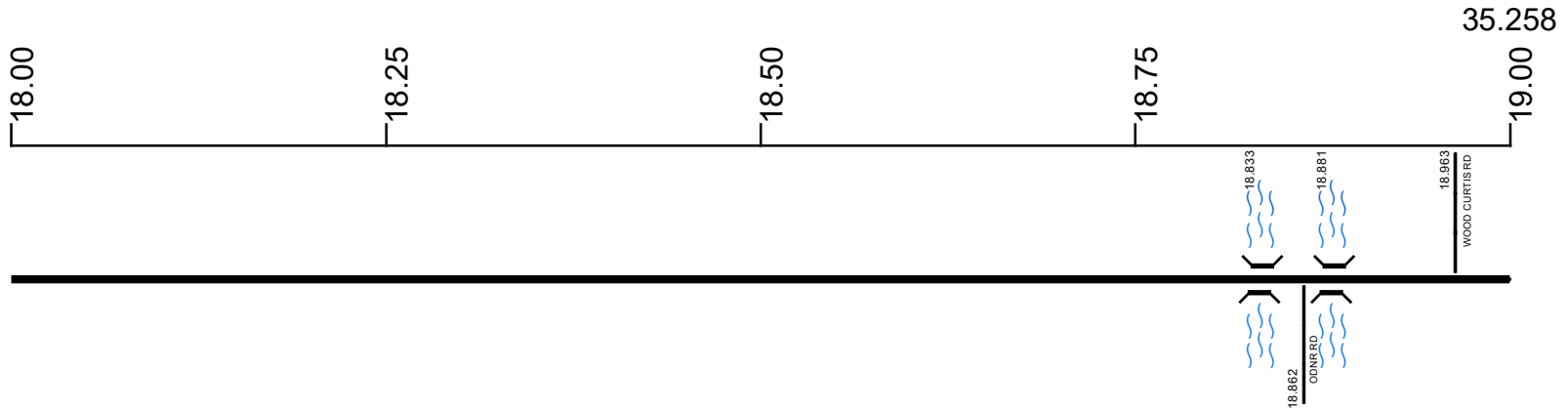

Surface Type & Width (Left / Right)

	G (17/3')
	15.215 - 19.121

Base Type (Left / Right)

	K / I
	15.215 - 20.221

Shoulder Type & Width (Left / Right)

	5 (2/2')
	10.372 - 24.173

Through Lanes

	2
	0 - 23.808

Street Name

	SR 534
	7.721 - 21.561

- | | | | |
|---------------------|-------------------|----------------------|--------------|
| Non-divided Highway | Bridge (on route) | Railroad (at grade) | Intersection |
| Divided Highway | Underpass | Railroad (underpass) | |
| Secondary Segment | Overpass | Railroad (overpass) | |
| Corporation | | | |

Created on: 7/8/2025

transportation.ohio.gov

Prepared by
The Ohio Department of Transportation
Office of Technical Services
Roadway Information

STRUSR00534**C

State True Log

36.258

County True Log

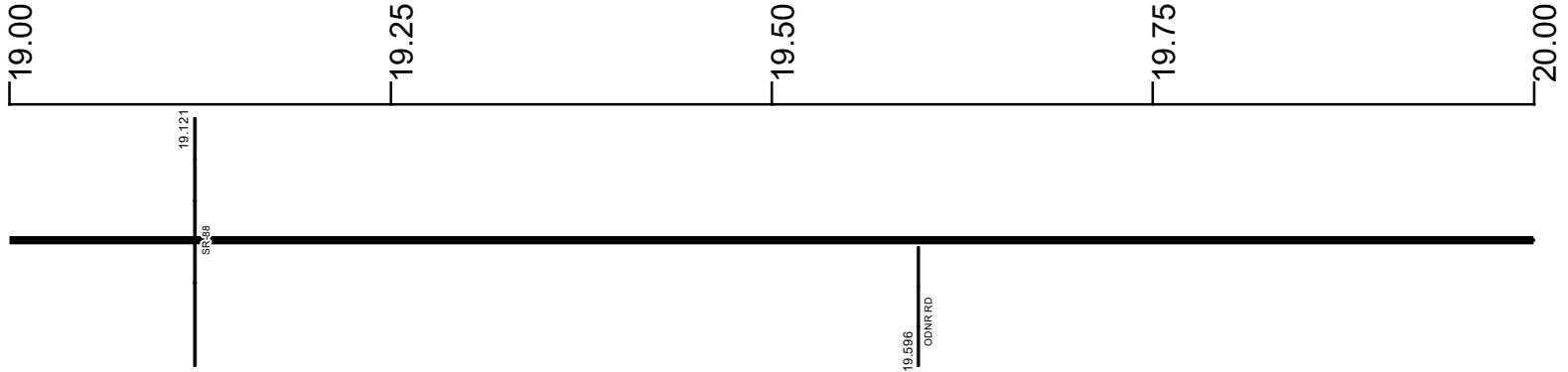

Surface Type & Width (Left / Right)

G (17'3')	G (10'12')
15.215 - 19.121	19.121 - 20.221

Base Type (Left / Right)

	K / I
	15.215 - 20.221

Shoulder Type & Width (Left / Right)

	5 (2'2')
	10.372 - 24.173

Resurface Year

	2024
	19.121 - 23.808

Through Lanes

	2
	0 - 23.808

Street Name

	SR 534
	7.721 - 21.561

- Non-divided Highway
- Divided Highway
- Secondary Segment
- Corporation
- Bridge (on route)
- Underpass
- Overpass
- Railroad (at grade)
- Railroad (underpass)
- Railroad (overpass)
- Intersection

Created on: 7/8/2025



Prepared by
The Ohio Department of Transportation
Office of Technical Services
Roadway Information

STRUSR00534**C

State True Log

37.258

County True Log

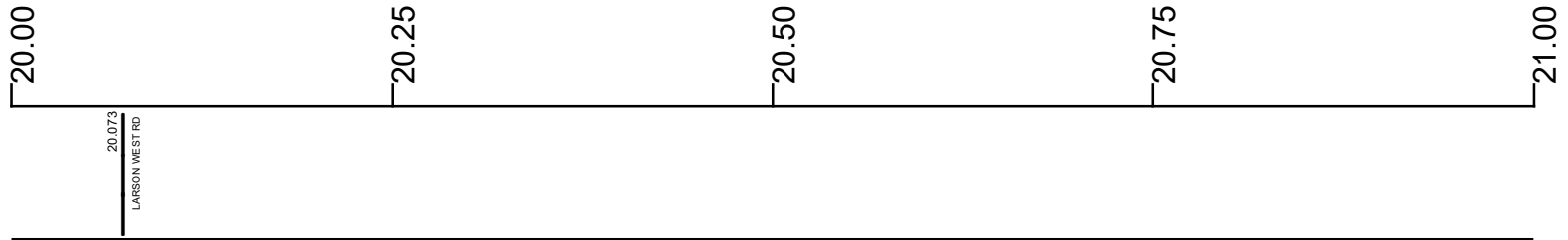

Surface Type & Width (Left / Right)

G (10'/12')	G (20'/2')	G (10'/12')
19.121 - 20.221	20.221 - 20.641	20.641 - 23.095

Base Type (Left / Right)

K / I	I / L	K / I
15.215 - 20.221	20.221 - 20.641	20.641 - 23.095

Shoulder Type & Width (Left / Right)

5 (2'/2')
10.372 - 24.173

Resurface Year

2024

Through Lanes

2

Street Name

SR 534
7.721 - 21.561

- Non-divided Highway
- Divided Highway
- Secondary Segment
- Corporation
- Bridge (on route)
- Underpass
- Overpass
- Railroad (at grade)
- Railroad (underpass)
- Railroad (overpass)
- Intersection

Created on: 7/8/2025

transportation.ohio.gov

Prepared by
The Ohio Department of Transportation
Office of Technical Services
Roadway Information

STRUSR00534**C

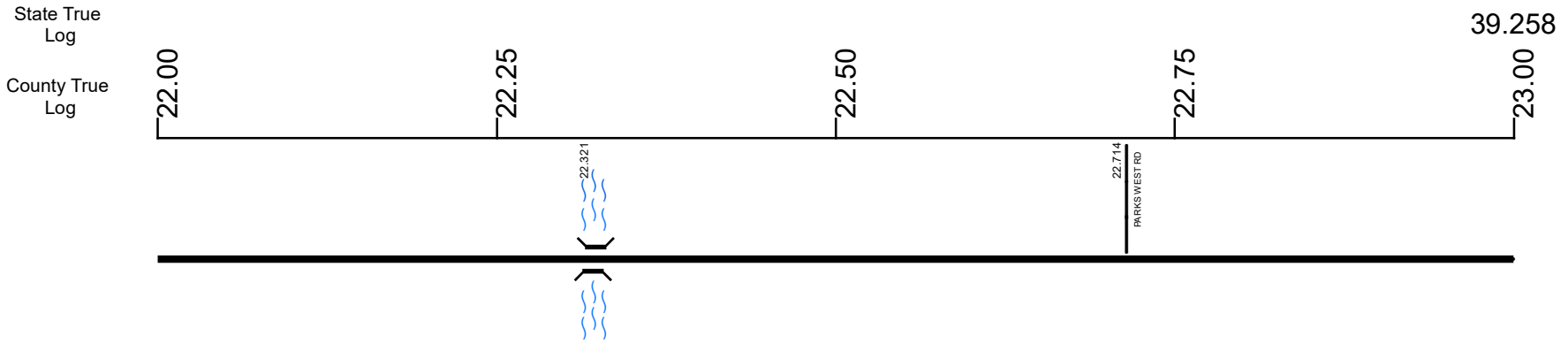

Surface Type & Width (Left / Right)	G (10'/12')
	20.641 - 23.095
Base Type (Left / Right)	K / I
	20.641 - 23.095
Shoulder Type & Width (Left / Right)	5 (2'/2')
	10.372 - 24.173
Resurface Year	2024
	19.121 - 23.808
Through Lanes	2
	0 - 23.808
Street Name	SR 534
	21.561 - 23.808

Non-divided Highway	Bridge (on route)	Railroad (at grade)	Intersection
Divided Highway	Underpass	Railroad (underpass)	
Secondary Segment	Overpass	Railroad (overpass)	
Corporation			

Created on: 7/8/2025



transportation.ohio.gov
 Prepared by
 The Ohio Department of Transportation
 Office of Technical Services
 Roadway Information

STRUSR00534**C

State True Log

40.258

County True Log

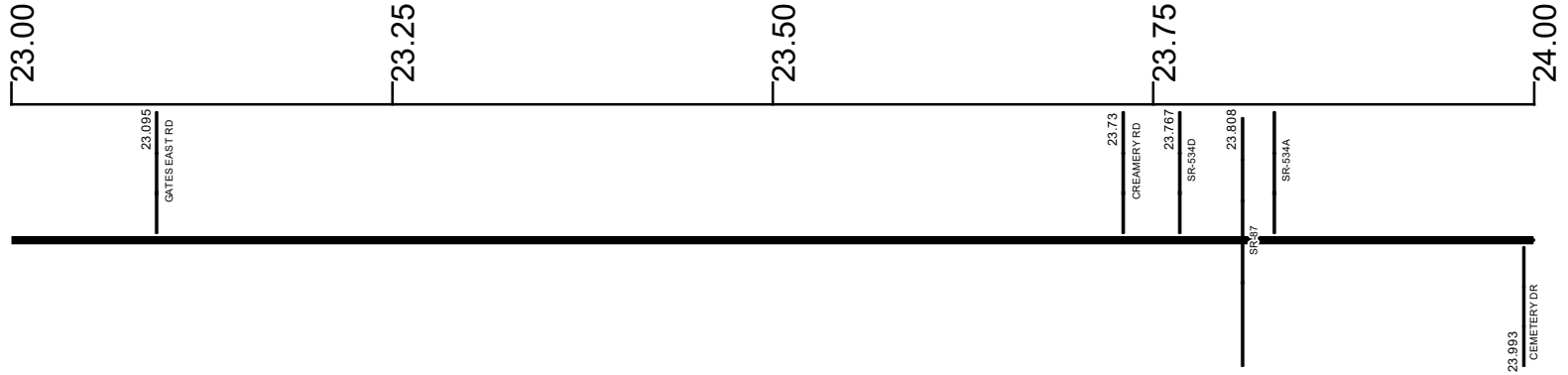

Surface Type & Width (Left / Right)

G (10'/12')	G (20'/2')	G 18'
20.641 - 23.095	23.095 - 23.808	23.808 - 24.173

Base Type (Left / Right)

K / I	I / L	P
20.641 - 23.095	23.095 - 23.808	23.808 - 26.851

Shoulder Type & Width (Left / Right)

	5 (2'/2')	
	10.372 - 24.173	

Resurface Year

	2024	2022
	19.121 - 23.808	23.808 - 25.048

Through Lanes

	2	1
	0 - 23.808	23.808 - 24.165

Street Name

	SR 534	
	21.561 - 23.808	23.808 - 26.851

- Non-divided Highway
- Divided Highway
- Secondary Segment
- Corporation
- Bridge (on route)
- Underpass
- Overpass
- Railroad (at grade)
- Railroad (underpass)
- Railroad (overpass)
- Intersection

Created on: 7/8/2025

transportation.ohio.gov

Prepared by
The Ohio Department of Transportation
Office of Technical Services
Roadway Information

STRUSR00534**C

State True Log

41.258

County True Log

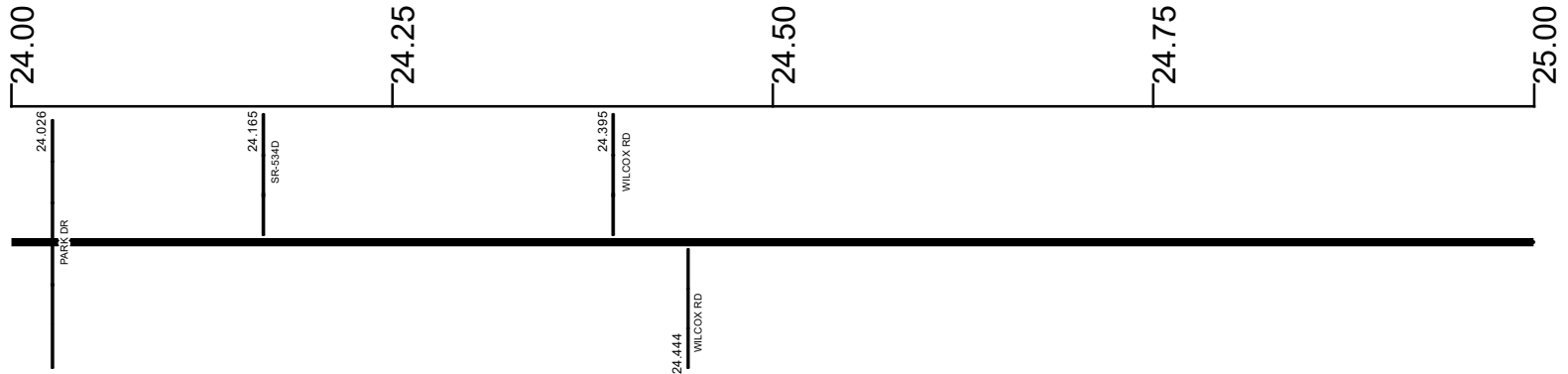

Surface Type & Width (Left / Right)

G 18' 23.808 - 24.173	G 34' 24.173 - 25.368
--------------------------	--------------------------

Base Type (Left / Right)

P 23.808 - 26.851	
----------------------	--

Shoulder Type & Width (Left / Right)

5 (2 1/2') 10.372 - 24.173	2 (2 1/2') 24.173 - 25.368
-------------------------------	-------------------------------

Resurface Year

2022 23.808 - 25.048

Through Lanes

1 23.808 - 24.165	2 24.165 - 26.851
----------------------	----------------------

Street Name

SR 534 23.808 - 26.851

- | | | | |
|--|---|---|---|
| <ul style="list-style-type: none"> Non-divided Highway Divided Highway Secondary Segment Corporation | <ul style="list-style-type: none"> Bridge (on route) Underpass Overpass | <ul style="list-style-type: none"> Railroad (at grade) Railroad (underpass) Railroad (overpass) | <ul style="list-style-type: none"> Intersection |
|--|---|---|---|

Created on: 7/8/2025

transportation.ohio.gov

Prepared by
The Ohio Department of Transportation
Office of Technical Services
Roadway Information

STRUSR00534**C

State True Log
County True Log

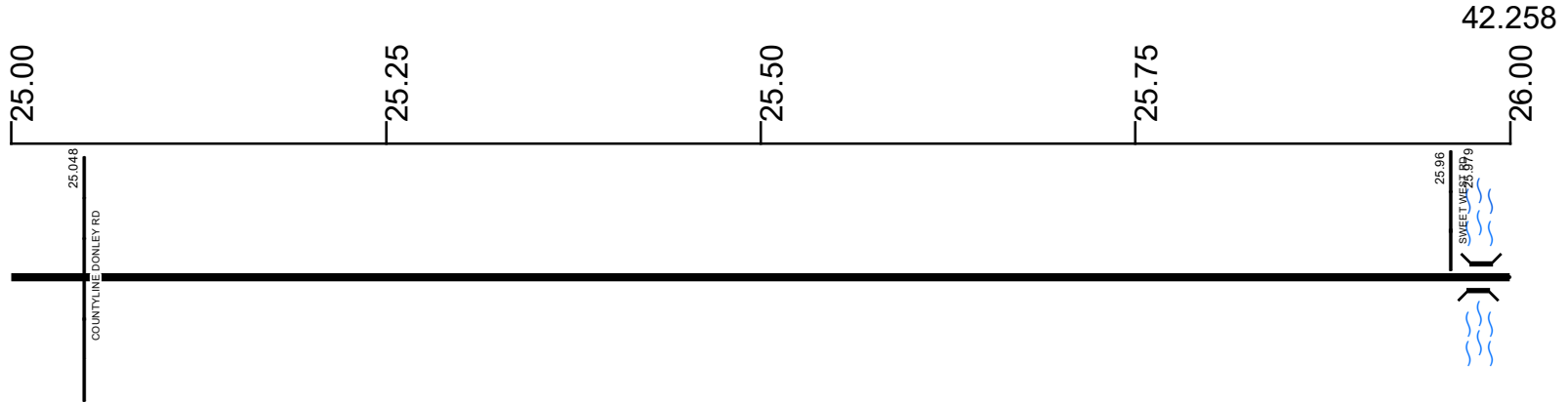

Surface Type & Width (Left / Right)

G 34'	G 18'
24.173 - 25.368	25.368 - 26.851

Base Type (Left / Right)

P
23.808 - 26.851

Shoulder Type & Width (Left / Right)

2 (2'1/2')	5 (2'1/2')
24.173 - 25.368	25.368 - 26.851

Resurface Year

2022

23.808 - 25.048

Through Lanes

2
24.165 - 26.851

Street Name

SR 534
23.808 - 26.851

- Non-divided Highway
- Divided Highway
- Secondary Segment
- Corporation
- Bridge (on route)
- Underpass
- Overpass
- Railroad (at grade)
- Railroad (underpass)
- Railroad (overpass)
- Intersection

Created on: 7/8/2025

transportation.ohio.gov

Prepared by
The Ohio Department of Transportation
Office of Technical Services
Roadway Information

STRUSR00534**C

State True Log

43.109

County True Log



Surface Type & Width (Left / Right)

G 18'
25.368 - 26.851

Base Type (Left / Right)

P
23.808 - 26.851

Shoulder Type & Width (Left / Right)

5 (2 1/2')
25.368 - 26.851

Through Lanes

2
24.165 - 26.851

Street Name

SR 534
23.808 - 26.851

- | | | | |
|---------------------|-------------------|----------------------|--------------|
| Non-divided Highway | Bridge (on route) | Railroad (at grade) | Intersection |
| Divided Highway | Underpass | Railroad (underpass) | |
| Secondary Segment | Overpass | Railroad (overpass) | |
| Corporation | | | |

Created on: 7/8/2025

transportation.ohio.gov

Prepared by
The Ohio Department of Transportation
Office of Technical Services
Roadway Information

Historical Project List for STRUSR00534**C

Begin Measure	End Measure	Project ID Number	Construction Completion Date	Treatment Category	Treatment Type
0.000	0.750	101951	10-2022	Minor Rehabilitation	38-Fine Poly AC Overlay
0.000	0.750	84601	10-2014	Minor Rehabilitation	60-AC Overlay w/Rpr
0.750	2.734	82918	8-2012	Minor Rehabilitation	60-AC Overlay w/Rpr
2.734	3.384	82918	8-2012	Minor Rehabilitation	60-AC Overlay w/Rpr
3.384	4.024	82918	8-2012	Minor Rehabilitation	60-AC Overlay w/Rpr
3.754	4.024	96560	12-2021	Preventive Maintenance	30-Microsurfacing
3.754	5.233	24568	4-2005	Minor Rehabilitation	60-AC Overlay w/Rpr
4.024	5.233	93485	12-2019	Minor Rehabilitation	38-Fine Poly AC Overlay
5.233	7.943	82918	8-2012	Minor Rehabilitation	60-AC Overlay w/Rpr
5.523	7.943	96560	12-2021	Preventive Maintenance	30-Microsurfacing
7.943	10.413	101951	10-2022	Minor Rehabilitation	60-AC Overlay w/Rpr
10.413	12.482	110676	10-2021	Minor Rehabilitation	60-AC Overlay w/Rpr
12.482	13.252	101951	10-2022	Minor Rehabilitation	60-AC Overlay w/Rpr
13.252	19.118	94114	10-2018	Minor Rehabilitation	60-AC Overlay w/Rpr
19.118	24.165	81581	11-2010	Minor Rehabilitation	60-AC Overlay w/Rpr
23.805	26.851	101951	10-2022	Minor Rehabilitation	60-AC Overlay w/Rpr
24.165	25.453	23967	7-2014	Minor Rehabilitation	60-AC Overlay w/Rpr
25.453	26.851	81581	11-2010	Minor Rehabilitation	60-AC Overlay w/Rpr

Roadway Codes

Access Control Journalized

- F - Full Access Control
- L - Limited Access Control
- N - No Access Control

Access Control Operational

- 1 - Full Access Control
- 2 - Partial Access Control
- 3 - No Access Control

Base Type

- F - Crack and Seat
- H - Rubblize and Roll
- I - Aggregate Base 304 or Traffic Compacted
- K - Water Bound Macadam
- L - Bituminous Concrete Mix or Penetration Macadam
- N - Plain Concrete
- P - Reinforced Concrete
- R - Brick (Flexible)
- T - Brick (Rigid)

Direction of Travel

- B - Both (Two-way)
- F - One-way Cardinal
- T - One-way Non-cardinal

Facility Type

- 1 - One-way Roadway
- 2 - Two-way Roadway
- 4 - Ramp
- 5 - Non-mainline
- 6 - Non-inventory Direction
- 7 - Planned / Unbuilt

Historical Federal Aid Indicator

- N - Not a FAP Route
- Y - FAP Route

Functional Classification

- 01 - Interstate
- 02 - Principal Arterial (Freeways)
- 03 - Principal Arterial (Other)
- 04 - Minor Arterial
- 05 - Major Collector
- 06 - Minor Collector
- 07 - Local

Leave / Reenter Indicator

- Y - Route leaves/reenters at this point
- N - Route does not leave/reenter at this point

Median Type

- 1 - None
- 2 - Unprotected
- 3 - Curbed
- 4 - Positive Barrier (Unspecified)
- 5 - Positive Barrier (Flexible)
- 6 - Positive Barrier (Semi-rigid)
- 7 - Positive Barrier (Rigid)

NHS

- N - National Highway System
- H - Congressional Corridor
- 2 - Major Airport
- 3 - Major Port Facility
- 4 - Major Amtrak Station
- 5 - Major Rail / Truck Terminal
- 6 - Major Intercity Bus Terminal
- 7 - Major Public Transit / Multi-modal Passenger Terminal
- 8 - Major Pipeline Terminal
- 9 - Major Ferry Terminal

Priority System

- G - General
- P - Priority System
- U - Urban

Scenic Byway Code

- A - All American Road
- N - National Scenic Byway
- S - State Scenic Byway

Shoulder Type

- 1 - None
- 2 - Surfaced shoulder exists (bituminous concrete {AC})
- 3 - Surfaced shoulder exists (Portland Cement Concrete {PCC})
- 4 - Stabilized shoulder exists (gravel or other granular material)
- 5 - Combination shoulder exists (two or more surface types)
- 6 - Earth shoulder exists
- 7 - Barrier curb exists; no shoulder in front of curb

Surface Type

- A - Combination
- B - Brick
- C - Continuous Reinforced Concrete
- D - Reinforced Concrete
- E - Plain Concrete
- G - Bituminous Concrete
- I - Chipseal on Granular
- K - Open Graded Bituminous
- L - Chipseal or Micro
- M - Gravel
- U - Unimproved
- X - Right of Way Only