

SUNISR00161**C

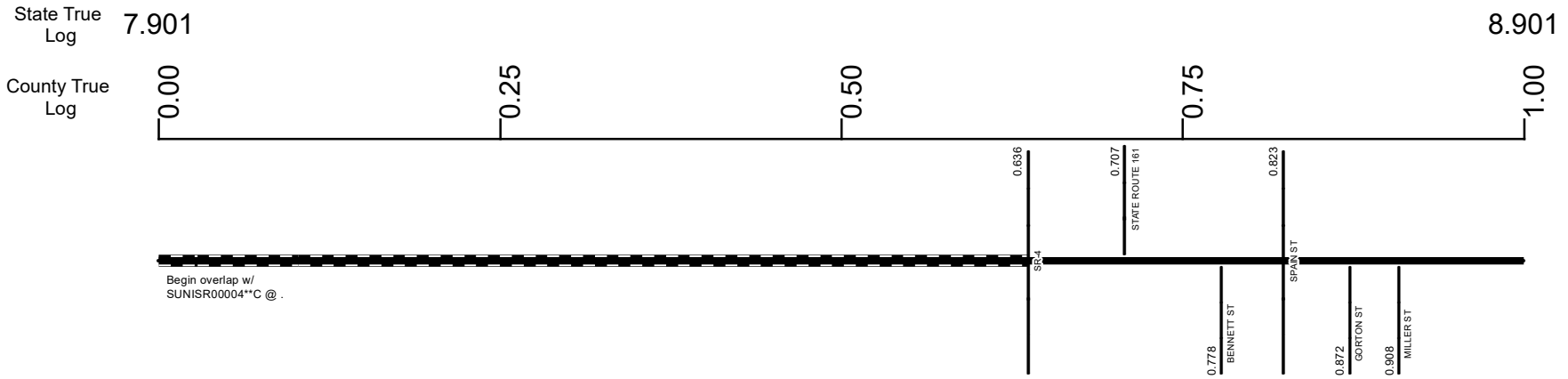

Surface Type & Width (Left / Right)	G (19/5')
	0.636 - 2.587
Base Type (Left / Right)	I / L
	0.636 - 2.587
Shoulder Type & Width (Left / Right)	5 (1/1')
	0.636 - 2.587
Resurface Year	2024
	0.636 - 0.915
Through Lanes	2
	0.636 - 6.116
Street Name	SR 161
	0.636 - 6.116

Non-divided Highway	Bridge (on route)	Railroad (at grade)	Intersection
Divided Highway	Underpass	Railroad (underpass)	
Secondary Segment	Overpass	Railroad (overpass)	
Corporation			

Created on: 7/9/2025



transportation.ohio.gov
 Prepared by
 The Ohio Department of Transportation
 Office of Technical Services
 Roadway Information

SUNISR00161**C

State True Log

9.901

County True Log

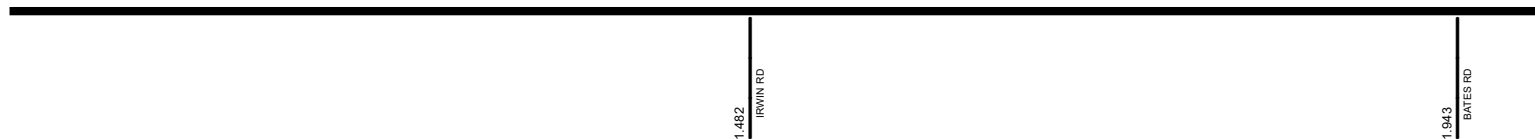

Surface Type & Width (Left / Right)

	G (19/5')
	0.636 - 2.587

Base Type (Left / Right)

	I / L
	0.636 - 2.587

Shoulder Type & Width (Left / Right)

	5 (1/1')
	0.636 - 2.587

Through Lanes

	2
	0.636 - 6.116

Street Name

	SR 161
	0.636 - 6.116

- | | | | |
|---------------------|-------------------|----------------------|--------------|
| Non-divided Highway | Bridge (on route) | Railroad (at grade) | Intersection |
| Divided Highway | Underpass | Railroad (underpass) | |
| Secondary Segment | Overpass | Railroad (overpass) | |
| Corporation | | | |

Created on: 7/9/2025

transportation.ohio.gov

Prepared by
The Ohio Department of Transportation
Office of Technical Services
Roadway Information

SUNISR00161**C

State True Log

10.901

County True Log

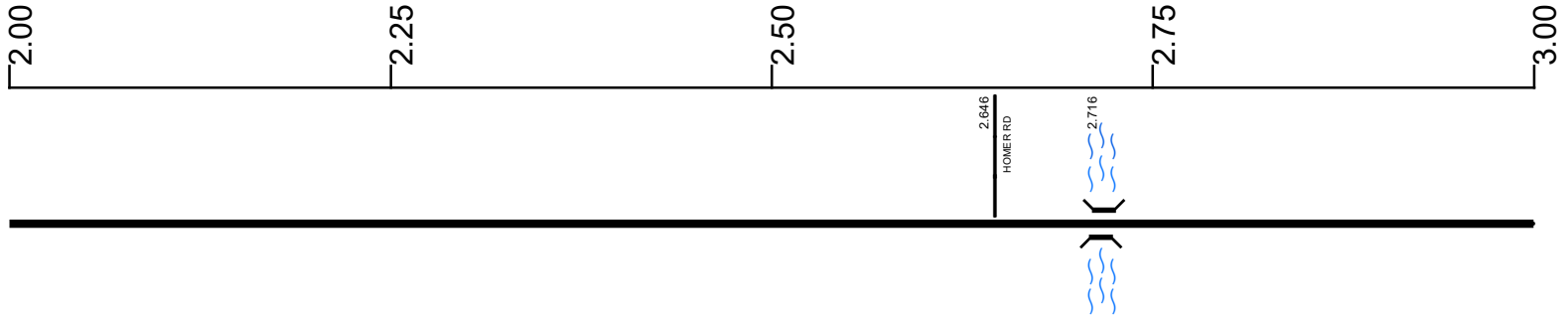

Surface Type & Width (Left / Right)

G (19'5") 0.636 - 2.587	G 24' 2.587 - 3.178
----------------------------	------------------------

Base Type (Left / Right)

I / L 0.636 - 2.587	I 2.587 - 3.178
------------------------	--------------------

Shoulder Type & Width (Left / Right)

5 (1'1") 0.636 - 2.587	5 (2'2") 2.587 - 6.116
---------------------------	---------------------------

Through Lanes

	2 0.636 - 6.116
--	--------------------

Street Name

	SR 161 0.636 - 6.116
--	-------------------------

Non-divided Highway	Bridge (on route)	Railroad (at grade)	Intersection
Divided Highway	Underpass	Railroad (underpass)	
Secondary Segment	Overpass	Railroad (overpass)	
Corporation			

Created on: 7/9/2025

transportation.ohio.gov

Prepared by
The Ohio Department of Transportation
Office of Technical Services
Roadway Information

SUNISR00161**C

State True
Log

11.901

County True
Log

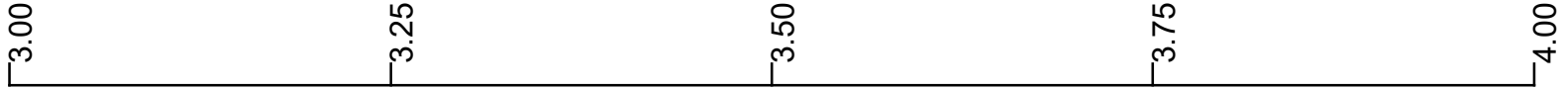

Surface Type & Width (Left / Right)

G 24' 2.587 - 3.178	G (19/5) 3.178 - 6.116
------------------------	---------------------------

Base Type (Left / Right)

I 2.587 - 3.178	I / L 3.178 - 6.116
--------------------	------------------------

Shoulder Type & Width (Left / Right)

5 (2/2) 2.587 - 6.116

Through Lanes

2 0.636 - 6.116

Street Name

SR 161 0.636 - 6.116

- | | | | |
|--|---|---|---|
| <ul style="list-style-type: none"> Non-divided Highway Divided Highway Secondary Segment Corporation | <ul style="list-style-type: none"> Bridge (on route) Underpass Overpass | <ul style="list-style-type: none"> Railroad (at grade) Railroad (underpass) Railroad (overpass) | <ul style="list-style-type: none"> Intersection |
|--|---|---|---|

Created on: 7/9/2025

transportation.ohio.gov

Prepared by
The Ohio Department of Transportation
Office of Technical Services
Roadway Information

SUNISR00161**C

State True Log

12.901

County True Log



Surface Type & Width (Left / Right)

G (19/5')
3.178 - 6.116

Base Type (Left / Right)

I / L
3.178 - 6.116

Shoulder Type & Width (Left / Right)

5 (2/2)
2.587 - 6.116

Through Lanes

2
0.636 - 6.116

Street Name

SR 161
0.636 - 6.116

- | | | | |
|---------------------|-------------------|----------------------|--------------|
| Non-divided Highway | Bridge (on route) | Railroad (at grade) | Intersection |
| Divided Highway | Underpass | Railroad (underpass) | |
| Secondary Segment | Overpass | Railroad (overpass) | |
| Corporation | | | |

Created on: 7/9/2025



transportation.ohio.gov

Prepared by
The Ohio Department of Transportation
Office of Technical Services
Roadway Information

SUNISR00161**C

State True Log

13.901

County True Log



Surface Type & Width (Left / Right)

G (19/5')
3.178 - 6.116

Base Type (Left / Right)

I / L
3.178 - 6.116

Shoulder Type & Width (Left / Right)

5 (2/2)
2.587 - 6.116

Through Lanes

2
0.636 - 6.116

Street Name

SR 161
0.636 - 6.116

- | | | | |
|---------------------|-------------------|----------------------|--------------|
| Non-divided Highway | Bridge (on route) | Railroad (at grade) | Intersection |
| Divided Highway | Underpass | Railroad (underpass) | |
| Secondary Segment | Overpass | Railroad (overpass) | |
| Corporation | | | |

Created on: 7/9/2025



transportation.ohio.gov

Prepared by
The Ohio Department of Transportation
Office of Technical Services
Roadway Information

SUNISR00161**C

State True Log

14.901

County True Log

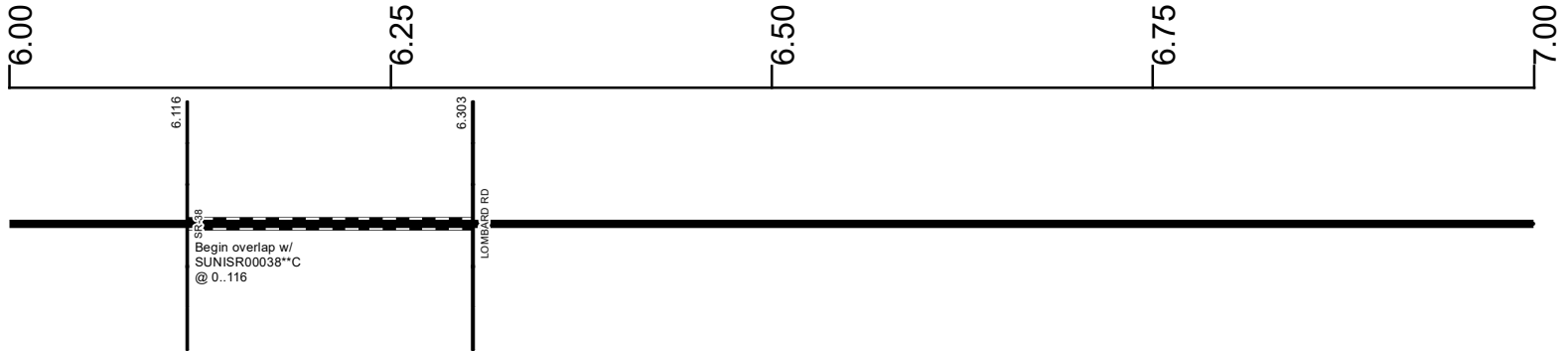

Surface Type & Width (Left / Right)

G (19/5)
3.178 - 6.116

Base Type (Left / Right)

I / L
3.178 - 6.116

Shoulder Type & Width (Left / Right)

5 (2/2)
2.587 - 6.116

Surface Type & Width (Left / Right)

G 24' 6.303 - 6.522	G (18/6') 6.522 - 11.201
------------------------	-----------------------------

Base Type (Left / Right)

I 6.303 - 6.522	I / L 6.522 - 11.201
--------------------	-------------------------

Shoulder Type & Width (Left / Right)

	5 (1/1) 6.303 - 11.201
--	---------------------------

Through Lanes

2
0.636 - 6.116

SR 161
0.636 - 6.116

Through Lanes

2
6.303 - 12.975

Street Name

SR 161
6.303 - 12.197

- | | | | |
|--|---|---|---|
| <ul style="list-style-type: none"> Non-divided Highway Divided Highway Secondary Segment Corporation | <ul style="list-style-type: none"> Bridge (on route) Underpass Overpass | <ul style="list-style-type: none"> Railroad (at grade) Railroad (underpass) Railroad (overpass) | <ul style="list-style-type: none"> Intersection |
|--|---|---|---|

Created on: 7/9/2025

transportation.ohio.gov

Prepared by
The Ohio Department of Transportation
Office of Technical Services
Roadway Information

SUNISR00161**C

State True Log

15.901

County True Log

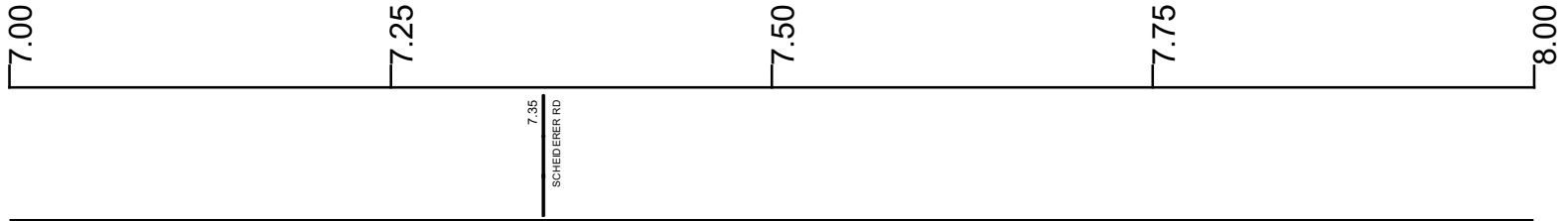

Surface Type & Width (Left / Right)

G (18'/6')
6.522 - 11.201

Base Type (Left / Right)

I / L
6.522 - 11.201

Shoulder Type & Width (Left / Right)

5 (1'/1')
6.303 - 11.201

Through Lanes

2
6.303 - 12.975

Street Name

SR 161
6.303 - 12.197

- | | | | |
|---------------------|-------------------|----------------------|--------------|
| Non-divided Highway | Bridge (on route) | Railroad (at grade) | Intersection |
| Divided Highway | Underpass | Railroad (underpass) | |
| Secondary Segment | Overpass | Railroad (overpass) | |
| Corporation | | | |

Created on: 7/9/2025

transportation.ohio.gov

Prepared by
The Ohio Department of Transportation
Office of Technical Services
Roadway Information

SUNISR00161**C

State True Log

16.901

County True Log



Surface Type & Width (Left / Right)

	G (18'/6')
	6.522 - 11.201

Base Type (Left / Right)

	I / L
	6.522 - 11.201

Shoulder Type & Width (Left / Right)

	5 (1'/1')
	6.303 - 11.201

Through Lanes

	2
	6.303 - 12.975

Street Name

	SR 161
	6.303 - 12.197

- | | | | |
|---------------------|-------------------|----------------------|--------------|
| Non-divided Highway | Bridge (on route) | Railroad (at grade) | Intersection |
| Divided Highway | Underpass | Railroad (underpass) | |
| Secondary Segment | Overpass | Railroad (overpass) | |
| Corporation | | | |

Created on: 7/9/2025

transportation.ohio.gov

Prepared by
The Ohio Department of Transportation
Office of Technical Services
Roadway Information

SUNISR00161**C

State True Log

17.901

County True Log



Surface Type & Width (Left / Right)

	G (18'/6')
	6.522 - 11.201

Base Type (Left / Right)

	I / L
	6.522 - 11.201

Shoulder Type & Width (Left / Right)

	5 (1'/1')
	6.303 - 11.201

Through Lanes

	2
	6.303 - 12.975

Street Name

	SR 161
	6.303 - 12.197

- | | | | |
|---------------------|-------------------|----------------------|--------------|
| Non-divided Highway | Bridge (on route) | Railroad (at grade) | Intersection |
| Divided Highway | Underpass | Railroad (underpass) | |
| Secondary Segment | Overpass | Railroad (overpass) | |
| Corporation | | | |

Created on: 7/9/2025

transportation.ohio.gov

Prepared by
The Ohio Department of Transportation
Office of Technical Services
Roadway Information

SUNISR00161**C

State True Log

18.901

County True Log



Surface Type & Width (Left / Right)

G (18/6')
6.522 - 11.201

Base Type (Left / Right)

I / L
6.522 - 11.201

Shoulder Type & Width (Left / Right)

5 (1/1')
6.303 - 11.201

Through Lanes

2
6.303 - 12.975

Street Name

SR 161
6.303 - 12.197

- | | | | |
|---------------------|-------------------|----------------------|--------------|
| Non-divided Highway | Bridge (on route) | Railroad (at grade) | Intersection |
| Divided Highway | Underpass | Railroad (underpass) | |
| Secondary Segment | Overpass | Railroad (overpass) | |
| Corporation | | | |

Created on: 7/9/2025



transportation.ohio.gov
 Prepared by
 The Ohio Department of Transportation
 Office of Technical Services
 Roadway Information

SUNISR00161**C

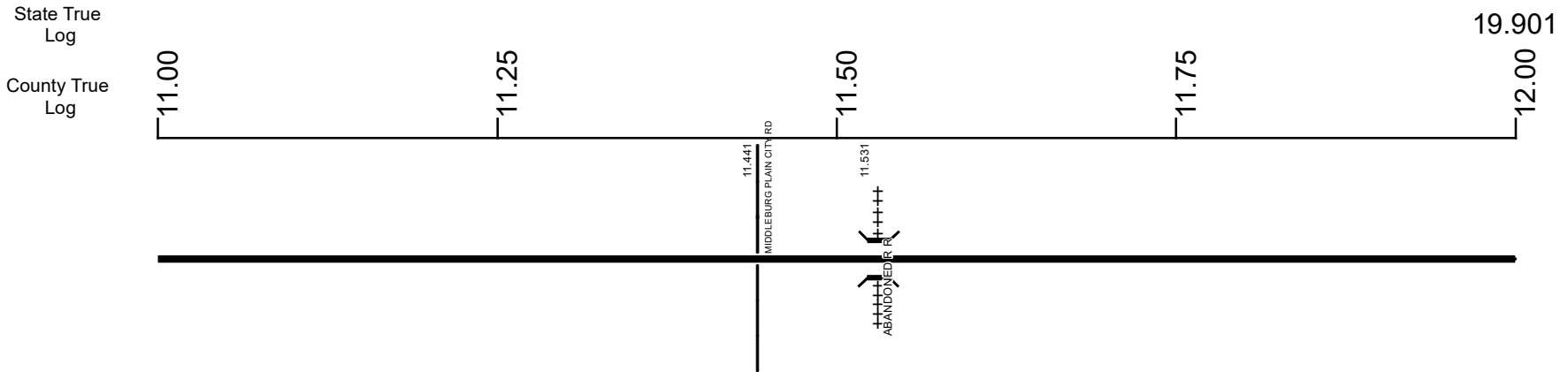

Surface Type & Width (Left / Right)

G (18'/6') 6.522 - 11.201	G 24' 11.201 - 12.209
------------------------------	--------------------------

Base Type (Left / Right)

I / L 6.522 - 11.201	L 11.201 - 12.209
-------------------------	----------------------

Shoulder Type & Width (Left / Right)

5 (1'1') 6.303 - 11.201	5 (4'4') 11.201 - 12.209
----------------------------	-----------------------------

Through Lanes

	2 6.303 - 12.975
--	---------------------

Street Name

	SR 161 6.303 - 12.197
--	--------------------------

- | | | | |
|---------------------|-------------------|----------------------|--------------|
| Non-divided Highway | Bridge (on route) | Railroad (at grade) | Intersection |
| Divided Highway | Underpass | Railroad (underpass) | |
| Secondary Segment | Overpass | Railroad (overpass) | |
| Corporation | | | |

Created on: 7/9/2025

transportation.ohio.gov

Prepared by
The Ohio Department of Transportation
Office of Technical Services
Roadway Information

SUNISR00161**C

State True Log
County True Log

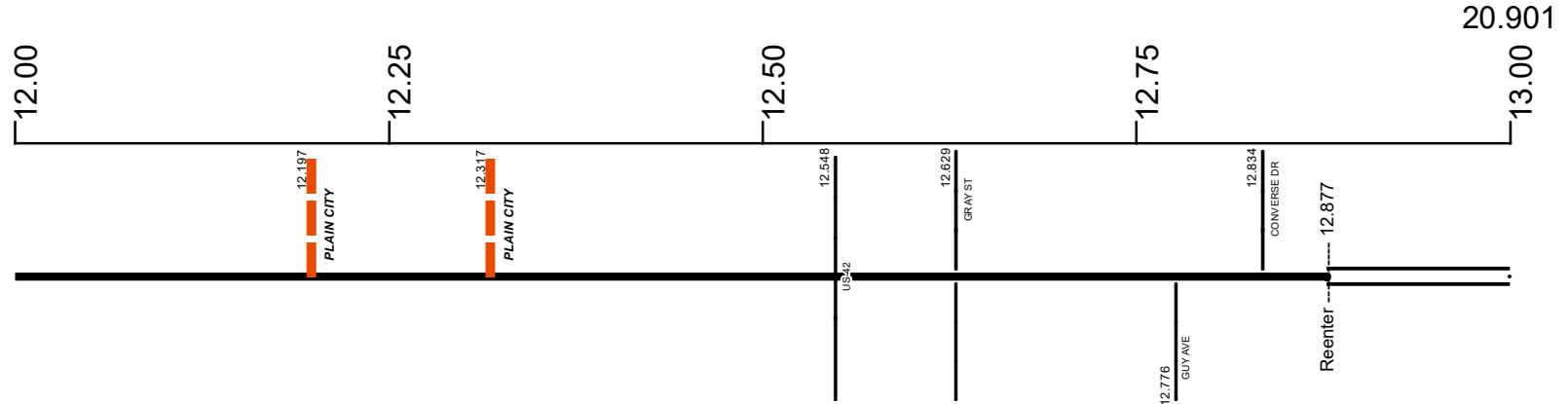

Surface Type & Width (Left / Right)

G 24'	G 22'	G 24'	G 36'	G 48'
11.201 - 12.209	12.209 - 12.398	12.398 - 12.548	12.548 - 12.947	12.947 - 13.095

Base Type (Left / Right)

L	I	L	R	L
11.201 - 12.209	12.209 - 12.548	12.548 - 12.698	12.698 - 12.877	12.947 - 13.672

Shoulder Type & Width (Left / Right)

5 (4/4')	5 (1/1')	1 (0/0')	5 (0/0')	1 (0/0')
11.201 - 12.209	12.209 - 12.398	12.398 - 12.877	12.877 - 12.947	12.947 - 13.354

Median Type and Width

3 (10')
12.877 - 13.095

Through Lanes

2	4
6.303 - 12.975	12.975 - 13.095

Street Name

SR 161	W MAIN ST	SR 161
6.303 - 12.197	12.197 - 12.947	12.947 - 13.672

- Non-divided Highway
- Divided Highway
- Secondary Segment
- Corporation
- Bridge (on route)
- Underpass
- Overpass
- Railroad (at grade)
- Railroad (underpass)
- Railroad (overpass)
- Intersection

Created on: 7/9/2025



Prepared by
The Ohio Department of Transportation
Office of Technical Services
Roadway Information

SUNISR00161**C

State True Log

26.055

County True Log

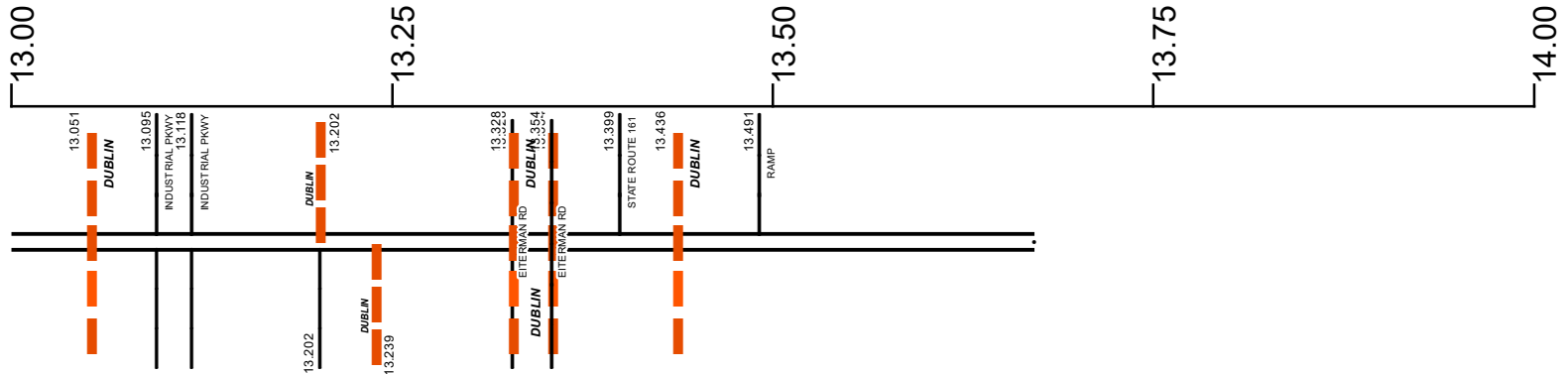

Surface Type & Width (Left / Right)

G 48'	G 60'	G (36'/24')	G 72'	G 60'	G (36'/24')	G 32'
12.947 - 13.095		13.118 - 13.218	13.218 - 13.328	13.354 - 13.399		13.399 - 13.672

Base Type (Left / Right)

L
12.947 - 13.672

Shoulder Type & Width (Left / Right)

1 (0'/0')	1 (4'/20')	5 (6'/6')
12.947 - 13.354	13.354 - 13.399	13.399 - 13.672

Median Type and Width

3 (10')	3 (140')	3 (10')	3 (140')	3 (10')	2 (9999')
12.877 - 13.095	13.095 - 13.118	13.118 - 13.328	13.354 - 13.399	13.399 - 13.672	

Through Lanes

4	2	4	2
12.975 - 13.095	13.095 - 13.118	13.118 - 13.27	13.27 - 13.672

Street Name

SR 161
12.947 - 13.672

- Non-divided Highway
- Divided Highway
- Secondary Segment
- Corporation
- Bridge (on route)
- Underpass
- Overpass
- Railroad (at grade)
- Railroad (underpass)
- Railroad (overpass)
- Intersection

Created on: 7/9/2025

transportation.ohio.gov

Prepared by
The Ohio Department of Transportation
Office of Technical Services
Roadway Information

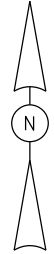
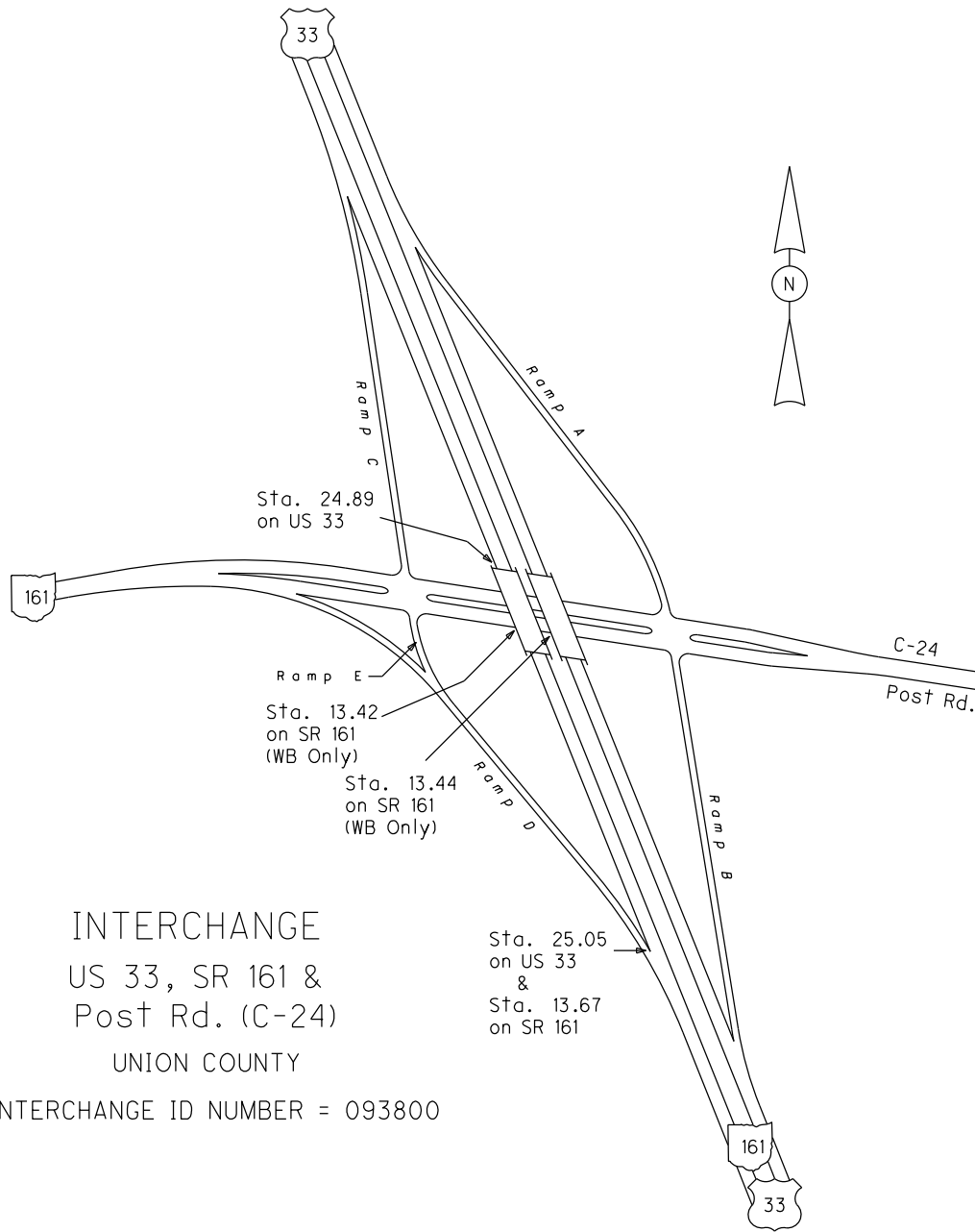

INTERCHANGE
 US 33, SR 161 &
 Post Rd. (C-24)
 UNION COUNTY
 INTERCHANGE ID NUMBER = 093800

US33 SHEET 5 OF 6
 US33 SHEET 6 OF 6
 SR161 SHEET 3 OF 3

Historical Project List for SUNISR00161**C

Begin Measure	End Measure	Project ID Number	Construction Completion Date	Treatment Category	Treatment Type
0.636	6.116	78307	9-2010	Minor Rehabilitation	60-AC Overlay w/Rpr
1.037	6.116	105512	10-2019	Preventive Maintenance	25-Chip Seal
6.303	12.418	78307	9-2010	Minor Rehabilitation	60-AC Overlay w/Rpr
12.398	12.548	105512	10-2019	Minor Rehabilitation	60-AC Overlay w/Rpr
12.548	12.698	105512	10-2019	Minor Rehabilitation	38-Fine Poly AC Overlay
12.548	12.877	25802	7-2008	Minor Rehabilitation	60-AC Overlay w/Rpr
12.698	12.877	105512	10-2019	Minor Rehabilitation	38-Fine Poly AC Overlay
13.008	13.502	86464	7-2011	Minor Rehabilitation	60-AC Overlay w/Rpr

Roadway Codes

Access Control Journalized

- F - Full Access Control
- L - Limited Access Control
- N - No Access Control

Access Control Operational

- 1 - Full Access Control
- 2 - Partial Access Control
- 3 - No Access Control

Base Type

- F - Crack and Seat
- H - Rubblize and Roll
- I - Aggregate Base 304 or Traffic Compacted
- K - Water Bound Macadam
- L - Bituminous Concrete Mix or Penetration Macadam
- N - Plain Concrete
- P - Reinforced Concrete
- R - Brick (Flexible)
- T - Brick (Rigid)

Direction of Travel

- B - Both (Two-way)
- F - One-way Cardinal
- T - One-way Non-cardinal

Facility Type

- 1 - One-way Roadway
- 2 - Two-way Roadway
- 4 - Ramp
- 5 - Non-mainline
- 6 - Non-inventory Direction
- 7 - Planned / Unbuilt

Historical Federal Aid Indicator

- N - Not a FAP Route
- Y - FAP Route

Functional Classification

- 01 - Interstate
- 02 - Principal Arterial (Freeways)
- 03 - Principal Arterial (Other)
- 04 - Minor Arterial
- 05 - Major Collector
- 06 - Minor Collector
- 07 - Local

Leave / Reenter Indicator

- Y - Route leaves/reenters at this point
- N - Route does not leave/reenter at this point

Median Type

- 1 - None
- 2 - Unprotected
- 3 - Curbed
- 4 - Positive Barrier (Unspecified)
- 5 - Positive Barrier (Flexible)
- 6 - Positive Barrier (Semi-rigid)
- 7 - Positive Barrier (Rigid)

NHS

- N - National Highway System
- H - Congressional Corridor
- 2 - Major Airport
- 3 - Major Port Facility
- 4 - Major Amtrak Station
- 5 - Major Rail / Truck Terminal
- 6 - Major Intercity Bus Terminal
- 7 - Major Public Transit / Multi-modal Passenger Terminal
- 8 - Major Pipeline Terminal
- 9 - Major Ferry Terminal

Priority System

- G - General
- P - Priority System
- U - Urban

Scenic Byway Code

- A - All American Road
- N - National Scenic Byway
- S - State Scenic Byway

Shoulder Type

- 1 - None
- 2 - Surfaced shoulder exists (bituminous concrete {AC})
- 3 - Surfaced shoulder exists (Portland Cement Concrete {PCC})
- 4 - Stabilized shoulder exists (gravel or other granular material)
- 5 - Combination shoulder exists (two or more surface types)
- 6 - Earth shoulder exists
- 7 - Barrier curb exists; no shoulder in front of curb

Surface Type

- A - Combination
- B - Brick
- C - Continuous Reinforced Concrete
- D - Reinforced Concrete
- E - Plain Concrete
- G - Bituminous Concrete
- I - Chipseal on Granular
- K - Open Graded Bituminous
- L - Chipseal or Micro
- M - Gravel
- U - Unimproved
- X - Right of Way Only