

SWILSR00107**C

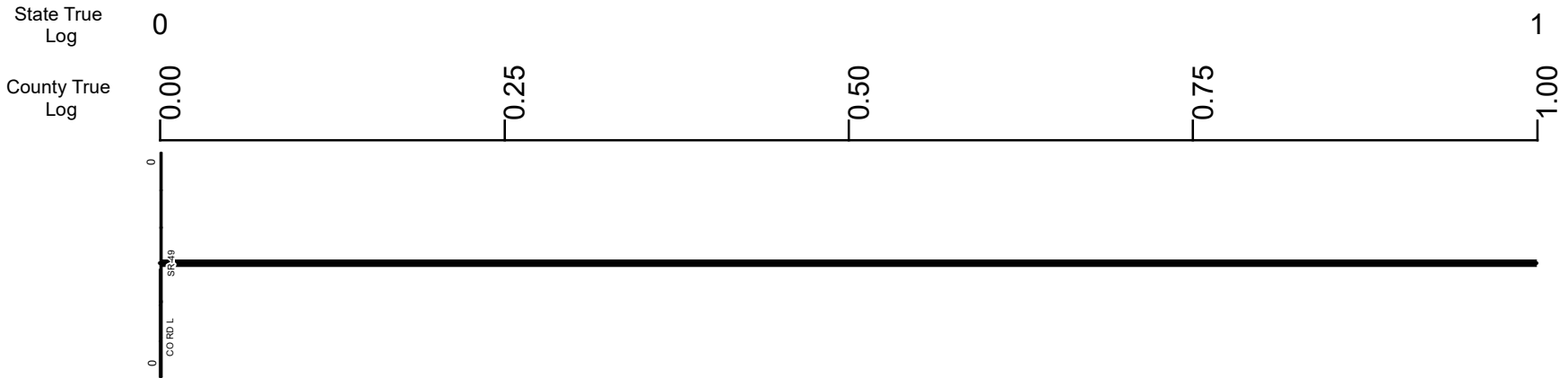

Surface Type & Width (Left / Right)	G (16'4') 0 - 8.017
Base Type (Left / Right)	K / I 0 - 7.67
Shoulder Type & Width (Left / Right)	2 (4'4') 0 - 8.017
Through Lanes	2 0 - 8.139
Street Name	SR 107 0 - 8.035

- Non-divided Highway
- Divided Highway
- Secondary Segment
- Corporation
- Bridge (on route)
- Underpass
- Overpass
- Railroad (at grade)
- Railroad (underpass)
- Railroad (overpass)
- Intersection

Created on: 7/9/2025



transportation.ohio.gov
 Prepared by
 The Ohio Department of Transportation
 Office of Technical Services
 Roadway Information

SWILSR00107**C

State True Log

County True Log

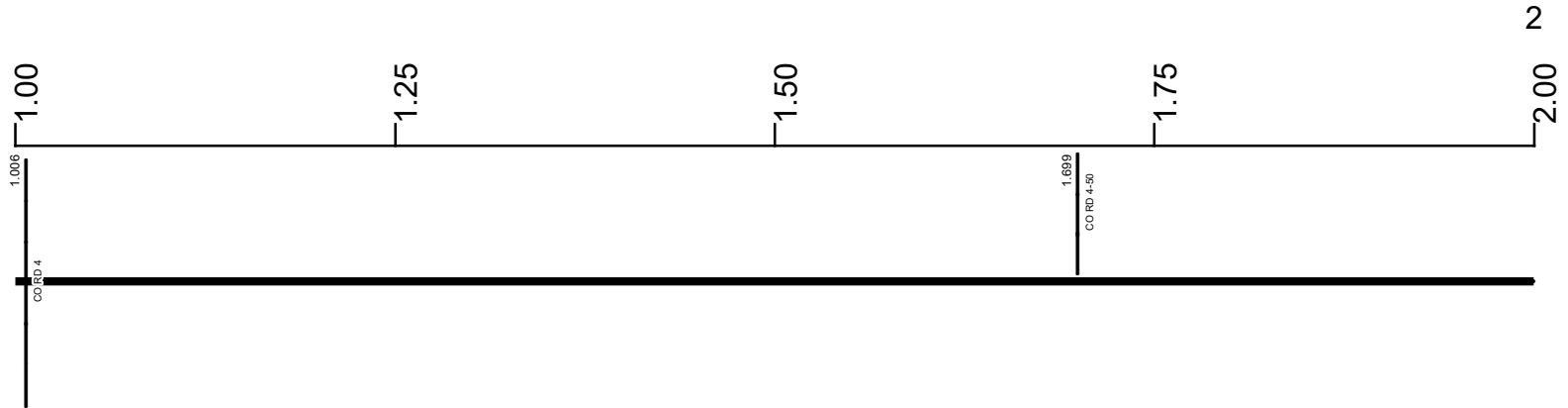

Surface Type & Width (Left / Right)

G (16'4')
0 - 8.017

Base Type (Left / Right)

K / I
0 - 7.67

Shoulder Type & Width (Left / Right)

2 (4'4')
0 - 8.017

Through Lanes

2
0 - 8.139

Street Name

SR 107
0 - 8.035

- Non-divided Highway
 Bridge (on route)
 Railroad (at grade)
 Intersection
- Divided Highway
 Underpass
 Railroad (underpass)
- Secondary Segment
 Overpass
 Railroad (overpass)
- Corporation**

Created on: 7/9/2025



transportation.ohio.gov

Prepared by
The Ohio Department of Transportation
Office of Technical Services
Roadway Information

SWILSR00107**C

State True Log

3

County True Log



Surface Type & Width (Left / Right)

	G (16'4')
	0 - 8.017

Base Type (Left / Right)

	K / I
	0 - 7.67

Shoulder Type & Width (Left / Right)

	2 (4'4')
	0 - 8.017

Through Lanes

	2
	0 - 8.139

Street Name

	SR 107
	0 - 8.035

- | | | | |
|---------------------|-------------------|----------------------|--------------|
| Non-divided Highway | Bridge (on route) | Railroad (at grade) | Intersection |
| Divided Highway | Underpass | Railroad (underpass) | |
| Secondary Segment | Overpass | Railroad (overpass) | |
| Corporation | | | |

Created on: 7/9/2025

transportation.ohio.gov

Prepared by
The Ohio Department of Transportation
Office of Technical Services
Roadway Information

SWILSR00107**C

State True Log

4

County True Log

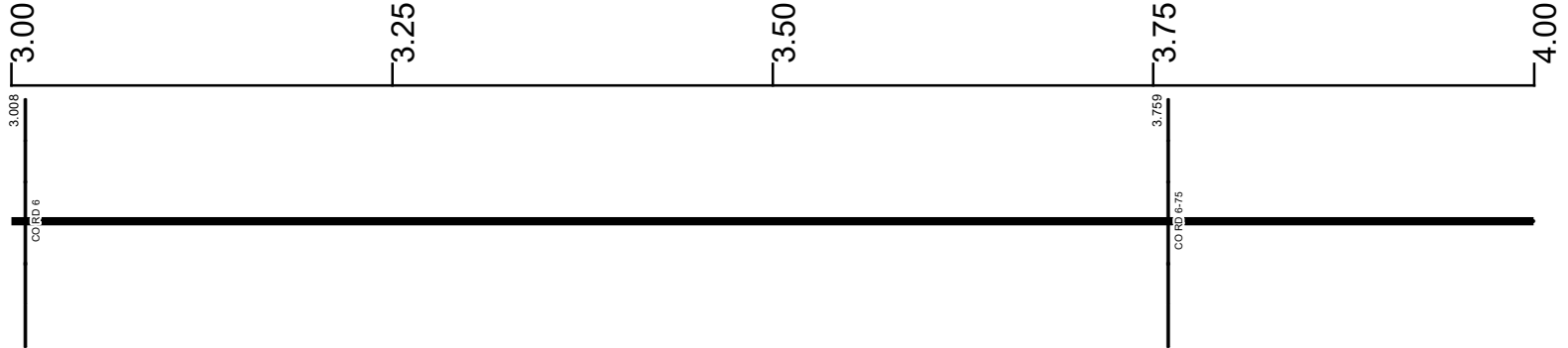

Surface Type & Width (Left / Right)

G (16'4')
0 - 8.017

Base Type (Left / Right)

K / I
0 - 7.67

Shoulder Type & Width (Left / Right)

2 (4'4')
0 - 8.017

Through Lanes

2
0 - 8.139

Street Name

SR 107
0 - 8.035

- Non-divided Highway
- Divided Highway
- Secondary Segment
- Corporation
- Bridge (on route)
- Underpass
- Overpass
- Railroad (at grade)
- Railroad (underpass)
- Railroad (overpass)
- Intersection

Created on: 7/9/2025

transportation.ohio.gov
Prepared by
The Ohio Department of Transportation
Office of Technical Services
Roadway Information

SWILSR00107**C

State True Log

5

County True Log

4.00

4.25

4.50

4.75

5.00



Surface Type & Width (Left / Right)

G (16'4')
0 - 8.017

Base Type (Left / Right)

K / I
0 - 7.67

Shoulder Type & Width (Left / Right)

2 (4'4')
0 - 8.017

Through Lanes

2
0 - 8.139

Street Name

SR 107
0 - 8.035

- Non-divided Highway
 Bridge (on route)
 Railroad (at grade)
 Intersection
- Divided Highway
 Underpass
 Railroad (underpass)
- Secondary Segment
 Overpass
 Railroad (overpass)
- Corporation**

Created on: 7/9/2025



transportation.ohio.gov

Prepared by
The Ohio Department of Transportation
Office of Technical Services
Roadway Information

SWILSR00107**C

State True Log

County True Log

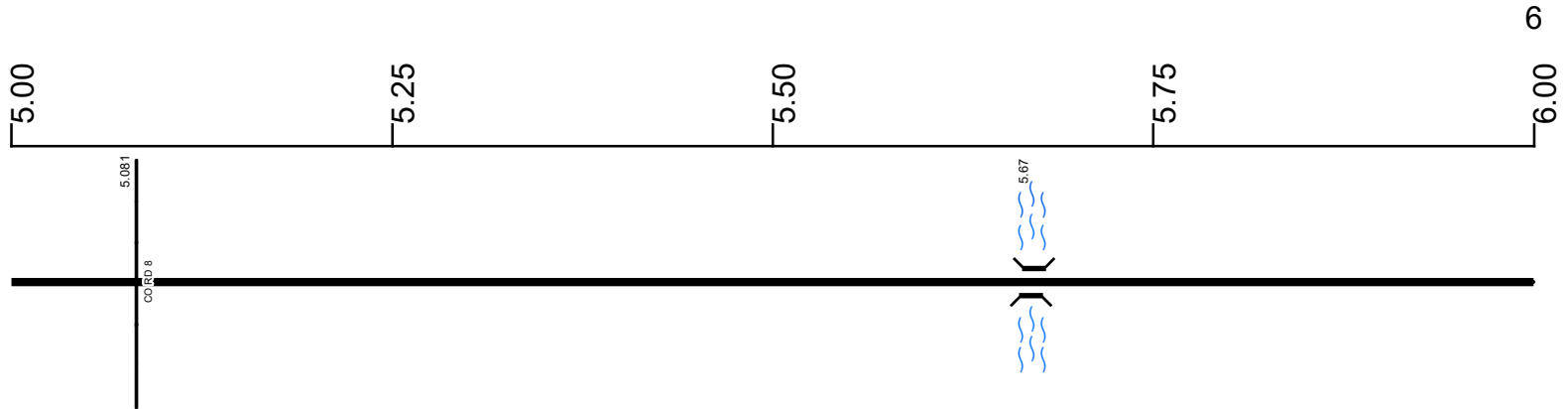

Surface Type & Width (Left / Right)

G (16'4')
0 - 8.017

Base Type (Left / Right)

K / I
0 - 7.67

Shoulder Type & Width (Left / Right)

2 (4'4')
0 - 8.017

Through Lanes

2
0 - 8.139

Street Name

SR 107
0 - 8.035

- Non-divided Highway
- Divided Highway
- Secondary Segment
- Corporation
- Bridge (on route)
- Underpass
- Overpass
- Railroad (at grade)
- Railroad (underpass)
- Railroad (overpass)
- Intersection

Created on: 7/9/2025

transportation.ohio.gov
Prepared by
The Ohio Department of Transportation
Office of Technical Services
Roadway Information

SWILSR00107**C

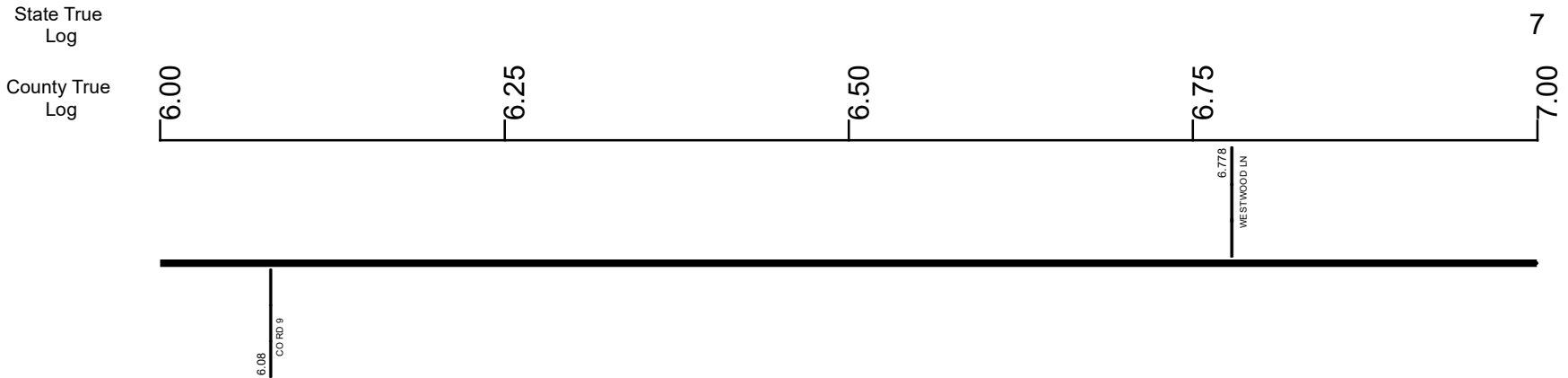

Surface Type & Width (Left / Right)	G (16'4')
	0 - 8.017
Base Type (Left / Right)	K / I
	0 - 7.67
Shoulder Type & Width (Left / Right)	2 (4'4')
	0 - 8.017
Through Lanes	2
	0 - 8.139
Street Name	SR 107
	0 - 8.035

- Non-divided Highway
- Divided Highway
- Secondary Segment
- Corporation
- Bridge (on route)
- Underpass
- Overpass
- Railroad (at grade)
- Railroad (underpass)
- Railroad (overpass)
- Intersection

Created on: 7/9/2025

transportation.ohio.gov

Prepared by
The Ohio Department of Transportation
Office of Technical Services
Roadway Information

SWILSR00107**C

State True Log

County True Log

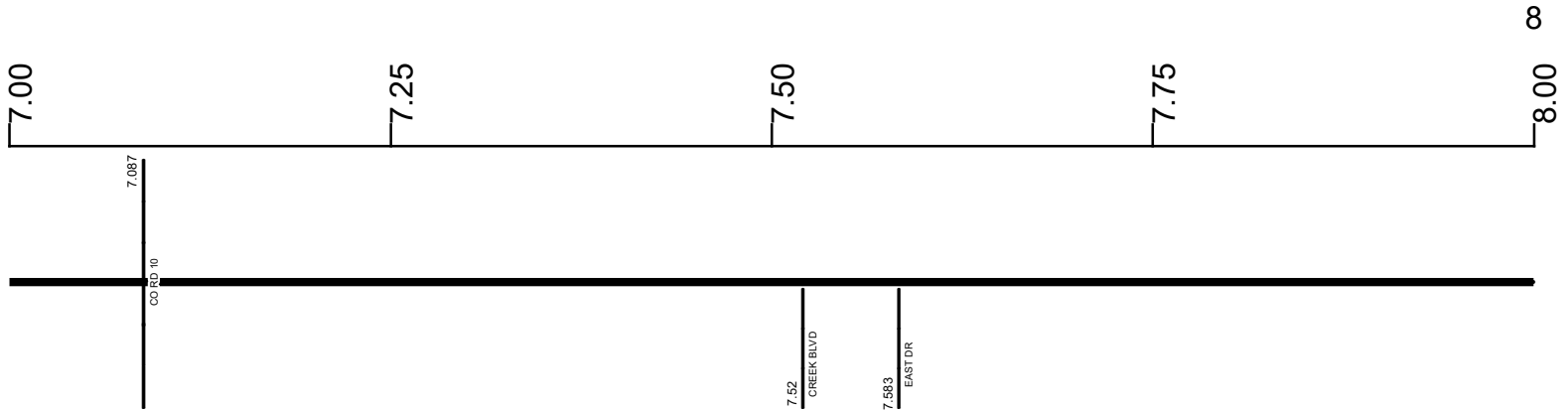

Surface Type & Width (Left / Right)

	G (16'4')
	0 - 8.017

Base Type (Left / Right)

K / I	N / I
0 - 7.67	7.67 - 8.017

Shoulder Type & Width (Left / Right)

	2 (4'4')
	0 - 8.017

Through Lanes

	2
	0 - 8.139

Street Name

	SR 107
	0 - 8.035

- | | | | |
|--|---|---|---|
| <ul style="list-style-type: none"> Non-divided Highway Divided Highway Secondary Segment Corporation | <ul style="list-style-type: none"> Bridge (on route) Underpass Overpass | <ul style="list-style-type: none"> Railroad (at grade) Railroad (underpass) Railroad (overpass) | <ul style="list-style-type: none"> Intersection |
|--|---|---|---|

Created on: 7/9/2025

transportation.ohio.gov

Prepared by
The Ohio Department of Transportation
Office of Technical Services
Roadway Information

SWILSR00107**C

State True Log

County True Log

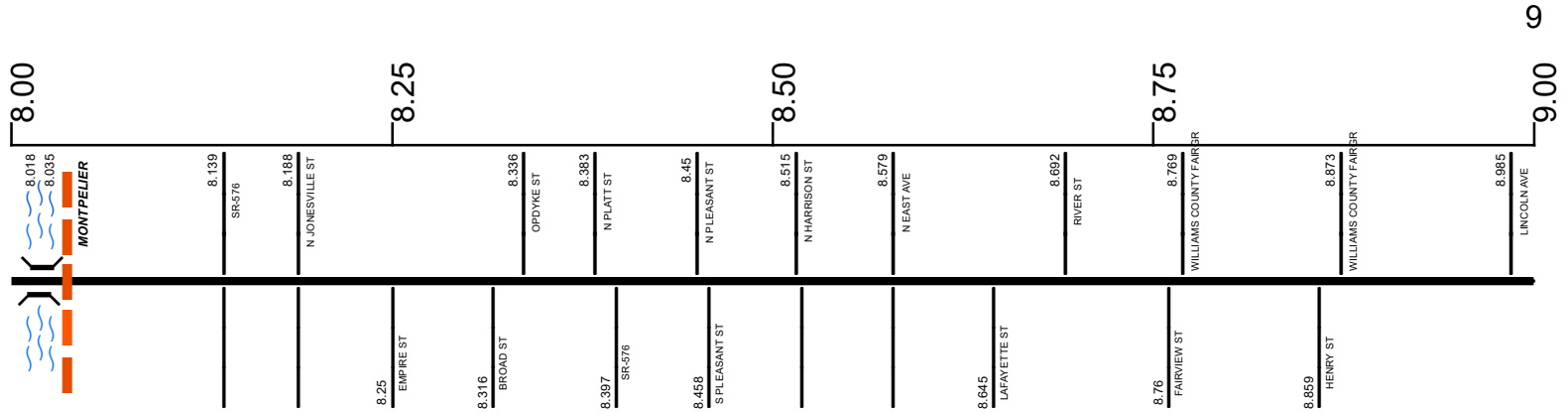

Surface Type & Width (Left / Right)

G (16'4") G 28'	G 36'	G (42'7")	G 30'	G (30'20")
8.017 - 8.057	8.057 - 8.139	8.139 - 8.397	8.397 - 8.888	8.888 - 9.168

Base Type (Left / Right)

N / I	N	T / I	T	K / L
7.67 - 8.017	8.017 - 8.139	8.139 - 8.397	8.397 - 8.888	8.888 - 9.168

Shoulder Type & Width (Left / Right)

2 (4'4")	1 (0'0")
0 - 8.017	8.017 - 10.099

Through Lanes

2	4	2	4
0 - 8.139	8.139 - 8.397	8.397 - 8.888	8.888 - 10.099

Street Name

SR 107	W MAIN ST	E MAIN ST
0 - 8.035	8.035 - 8.397	8.397 - 10.099

- Non-divided Highway
- Divided Highway
- Secondary Segment
- Corporation
- Bridge (on route)
- Underpass
- Overpass
- Railroad (at grade)
- Railroad (underpass)
- Railroad (overpass)
- Intersection

Created on: 7/9/2025



transportation.ohio.gov
Prepared by
The Ohio Department of Transportation
Office of Technical Services
Roadway Information

SWILSR00107**C

State True Log
County True Log

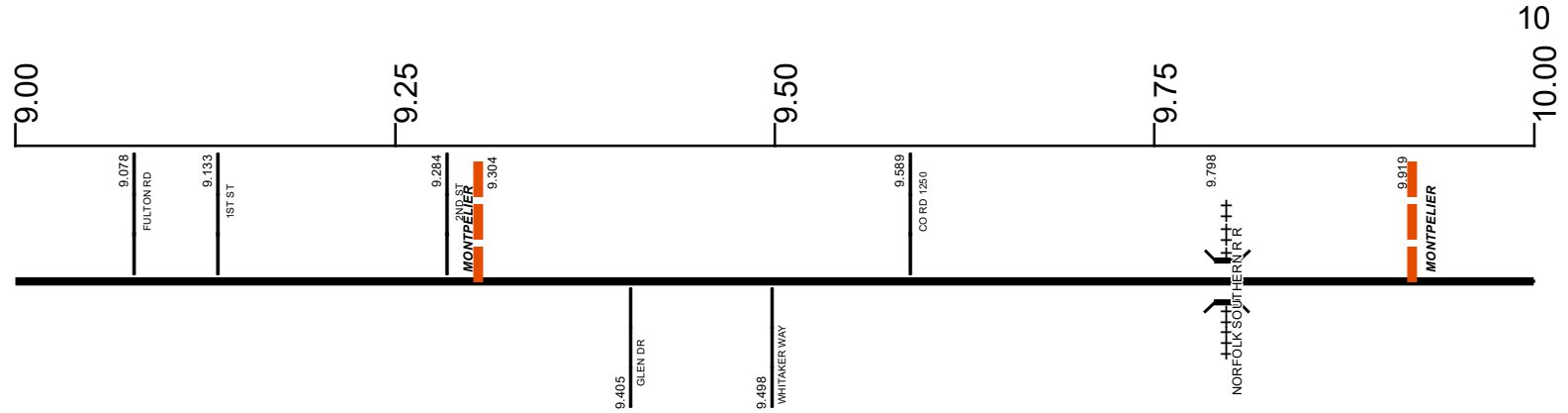

Surface Type & Width (Left / Right)

G (30'/20')	G 50'
8.888 - 9.168	9.168 - 10.099

Base Type (Left / Right)

K / L	L
8.888 - 9.168	9.168 - 10.099

Shoulder Type & Width (Left / Right)

1 (0'/0')
8.017 - 10.099

Through Lanes

4
8.888 - 10.099

Street Name

E MAIN ST
8.397 - 10.099

- Non-divided Highway
- Divided Highway
- Secondary Segment
- Corporation
- Bridge (on route)
- Underpass
- Overpass
- Railroad (at grade)
- Railroad (underpass)
- Railroad (overpass)
- Intersection

Created on: 7/9/2025

transportation.ohio.gov
Prepared by
The Ohio Department of Transportation
Office of Technical Services
Roadway Information

SWILSR00107**C

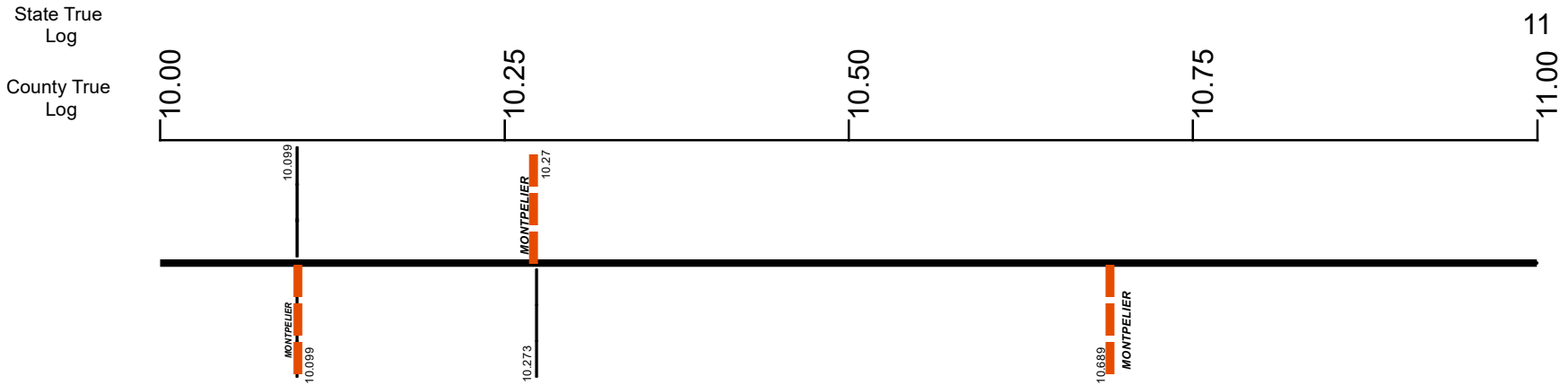

Surface Type & Width (Left / Right)

G 50'	G 22'	G (22'/14')
9.168 - 10.099	10.099 - 10.853	10.853 - 11.054

Base Type (Left / Right)

L	K	K / I
9.168 - 10.099	10.099 - 10.853	10.853 - 11.054

Shoulder Type & Width (Left / Right)

1 (0'/0')	2 (6'/6')
8.017 - 10.099	10.099 - 11.054

Through Lanes

4	2
8.888 - 10.099	10.099 - 11.054

Street Name

E MAIN ST	MAIN ST	MAIN	SR 107
8.397 - 10.099	10.099 - 10.27	10.27 - 10.314	10.314 - 11.054

- Non-divided Highway
- Divided Highway
- Secondary Segment
- Corporation
- Bridge (on route)
- Underpass
- Overpass
- Railroad (at grade)
- Railroad (underpass)
- Railroad (overpass)
- Intersection

Created on: 7/9/2025

transportation.ohio.gov

Prepared by
The Ohio Department of Transportation
Office of Technical Services
Roadway Information

SWILSR00107**C

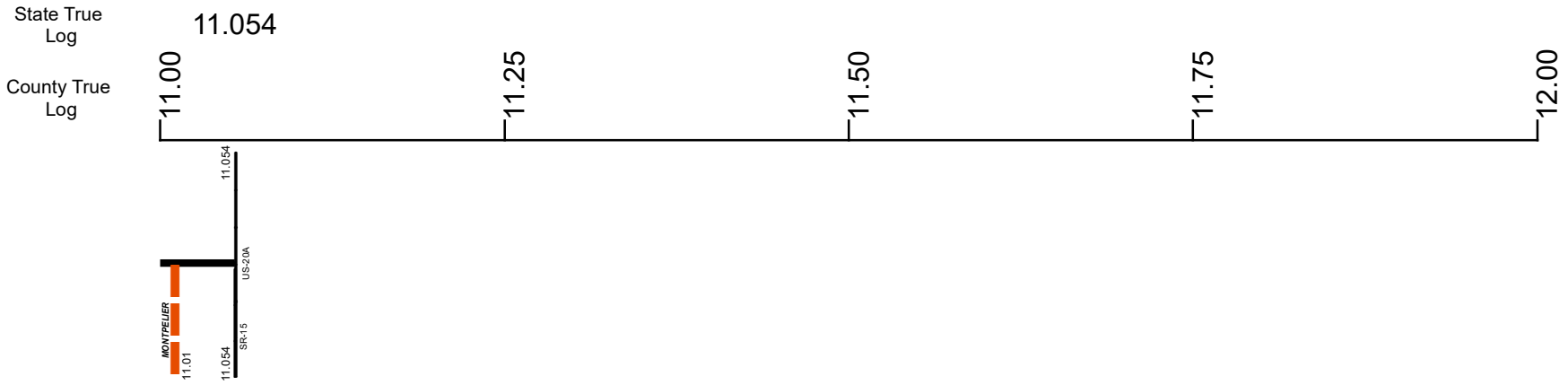

- Surface Type & Width (Left / Right)
G (22'/14')
- 10.853 - 11.054
- Base Type (Left / Right)
K / I
- 10.853 - 11.054
- Shoulder Type & Width (Left / Right)
2 (6'/6')
- 10.099 - 11.054
- Through Lanes
2
- 10.099 - 11.054
- Street Name
SR 107
- 10.314 - 11.054

Non-divided Highway	Bridge (on route)	Railroad (at grade)	Intersection
Divided Highway	Underpass	Railroad (underpass)	
Secondary Segment	Overpass	Railroad (overpass)	
Corporation			

Created on: 7/9/2025

transportation.ohio.gov

Prepared by
The Ohio Department of Transportation
Office of Technical Services
Roadway Information

Historical Project List for SWILSR00107**C

Begin Measure	End Measure	Project ID Number	Construction Completion Date	Treatment Category	Treatment Type
0.000	7.079	105474	10-2019	Minor Rehabilitation	38-Fine Poly AC Overlay
0.000	7.069	95788	9-2014	Preventive Maintenance	25-Chip Seal
9.480	11.054	101346	8-2020	Minor Rehabilitation	60-AC Overlay w/Rpr

Roadway Codes

Access Control Journalized

- F - Full Access Control
- L - Limited Access Control
- N - No Access Control

Access Control Operational

- 1 - Full Access Control
- 2 - Partial Access Control
- 3 - No Access Control

Base Type

- F - Crack and Seat
- H - Rubblize and Roll
- I - Aggregate Base 304 or Traffic Compacted
- K - Water Bound Macadam
- L - Bituminous Concrete Mix or Penetration Macadam
- N - Plain Concrete
- P - Reinforced Concrete
- R - Brick (Flexible)
- T - Brick (Rigid)

Direction of Travel

- B - Both (Two-way)
- F - One-way Cardinal
- T - One-way Non-cardinal

Facility Type

- 1 - One-way Roadway
- 2 - Two-way Roadway
- 4 - Ramp
- 5 - Non-mainline
- 6 - Non-inventory Direction
- 7 - Planned / Unbuilt

Historical Federal Aid Indicator

- N - Not a FAP Route
- Y - FAP Route

Functional Classification

- 01 - Interstate
- 02 - Principal Arterial (Freeways)
- 03 - Principal Arterial (Other)
- 04 - Minor Arterial
- 05 - Major Collector
- 06 - Minor Collector
- 07 - Local

Leave / Reenter Indicator

- Y - Route leaves/reenters at this point
- N - Route does not leave/reenter at this point

Median Type

- 1 - None
- 2 - Unprotected
- 3 - Curbed
- 4 - Positive Barrier (Unspecified)
- 5 - Positive Barrier (Flexible)
- 6 - Positive Barrier (Semi-rigid)
- 7 - Positive Barrier (Rigid)

NHS

- N - National Highway System
- H - Congressional Corridor
- 2 - Major Airport
- 3 - Major Port Facility
- 4 - Major Amtrak Station
- 5 - Major Rail / Truck Terminal
- 6 - Major Intercity Bus Terminal
- 7 - Major Public Transit / Multi-modal Passenger Terminal
- 8 - Major Pipeline Terminal
- 9 - Major Ferry Terminal

Priority System

- G - General
- P - Priority System
- U - Urban

Scenic Byway Code

- A - All American Road
- N - National Scenic Byway
- S - State Scenic Byway

Shoulder Type

- 1 - None
- 2 - Surfaced shoulder exists (bituminous concrete {AC})
- 3 - Surfaced shoulder exists (Portland Cement Concrete {PCC})
- 4 - Stabilized shoulder exists (gravel or other granular material)
- 5 - Combination shoulder exists (two or more surface types)
- 6 - Earth shoulder exists
- 7 - Barrier curb exists; no shoulder in front of curb

Surface Type

- A - Combination
- B - Brick
- C - Continuous Reinforced Concrete
- D - Reinforced Concrete
- E - Plain Concrete
- G - Bituminous Concrete
- I - Chipseal on Granular
- K - Open Graded Bituminous
- L - Chipseal or Micro
- M - Gravel
- U - Unimproved
- X - Right of Way Only