

ODOT Dist 4 - Ashtabula County - FINAL
No Passing Zone Log (ATB)

Route: 0307R (SATBSR00307**C)

From: 0.000 LEAVE LAK CO

Length: 20.670 Direction: East

To: 20.670 S0193R

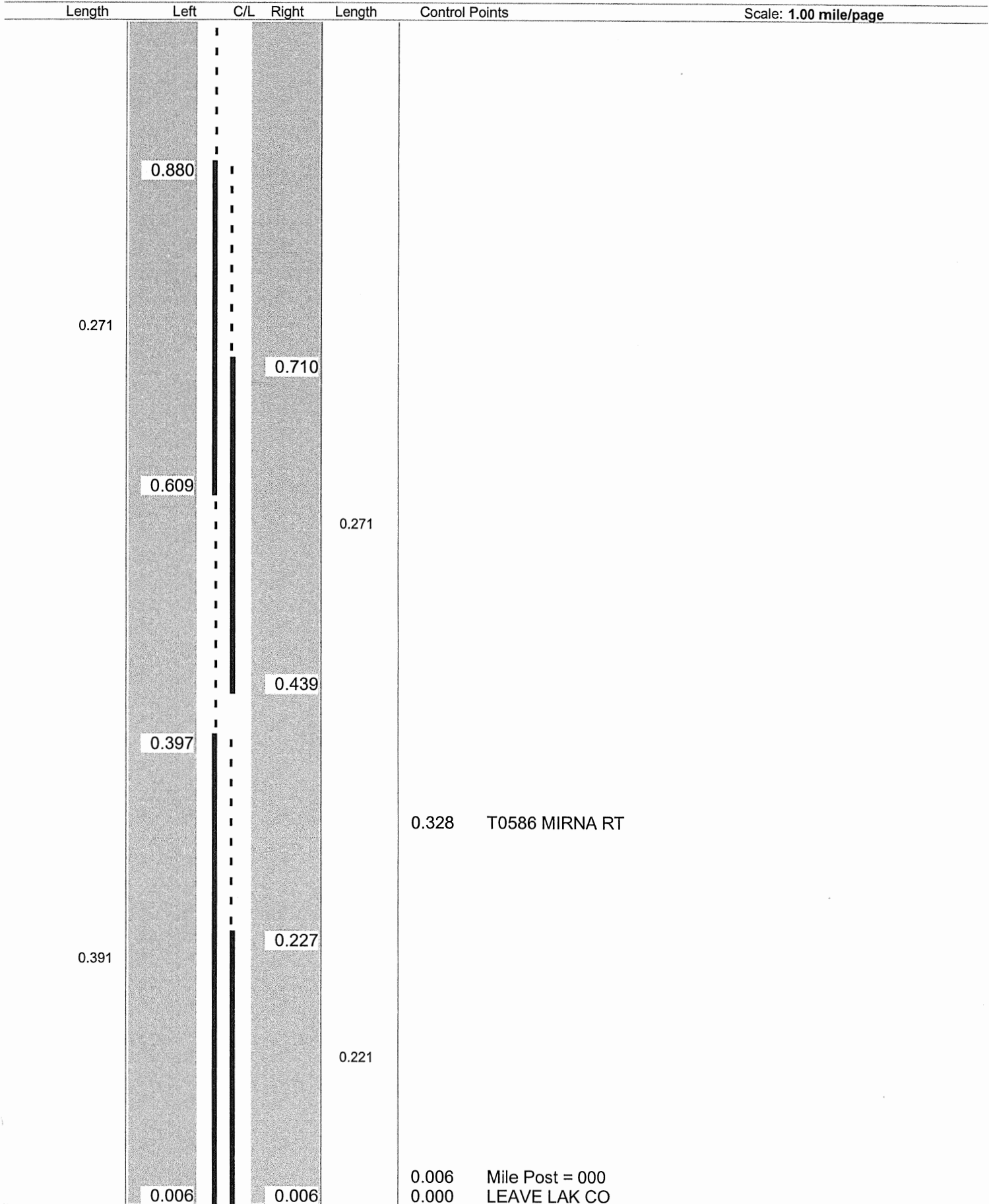

Sheet total equivalent length of solid line: 1.324

Accum. total: 1.324

ODOT Dist 4 - Ashtabula County - FINAL
No Passing Zone Log (ATB)

Route: 0307R (SATBSR00307**C)
 Length: 20.670 Direction: East

From: 0.000 LEAVE LAK CO
 To: 20.670 S0193R

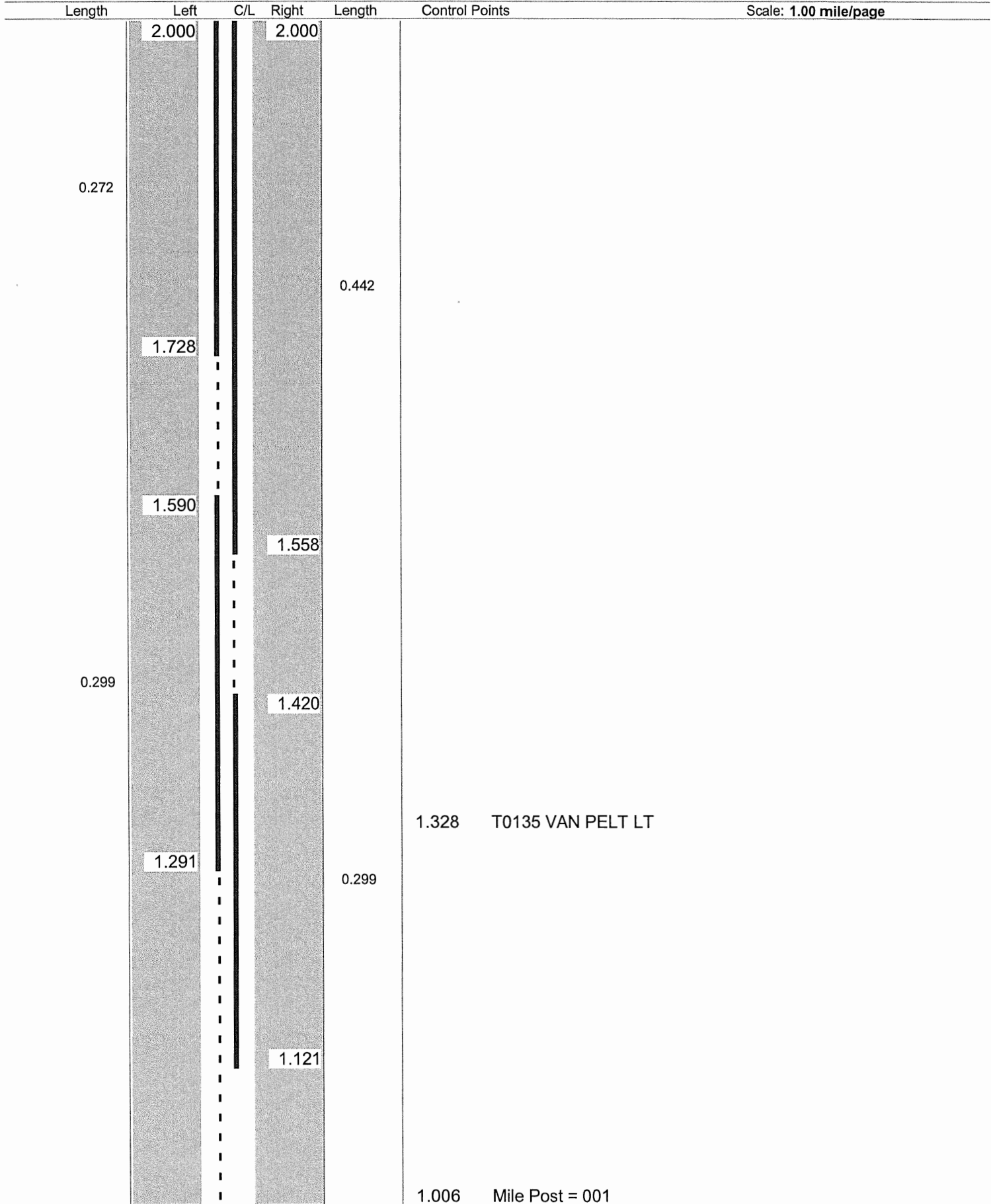

ODOT Dist 4 - Ashtabula County - FINAL
No Passing Zone Log (ATB)

Route: 0307R (SATBSR00307**C)
 Length: 20.670 Direction: East

From: 0.000 LEAVE LAK CO
 To: 20.670 S0193R

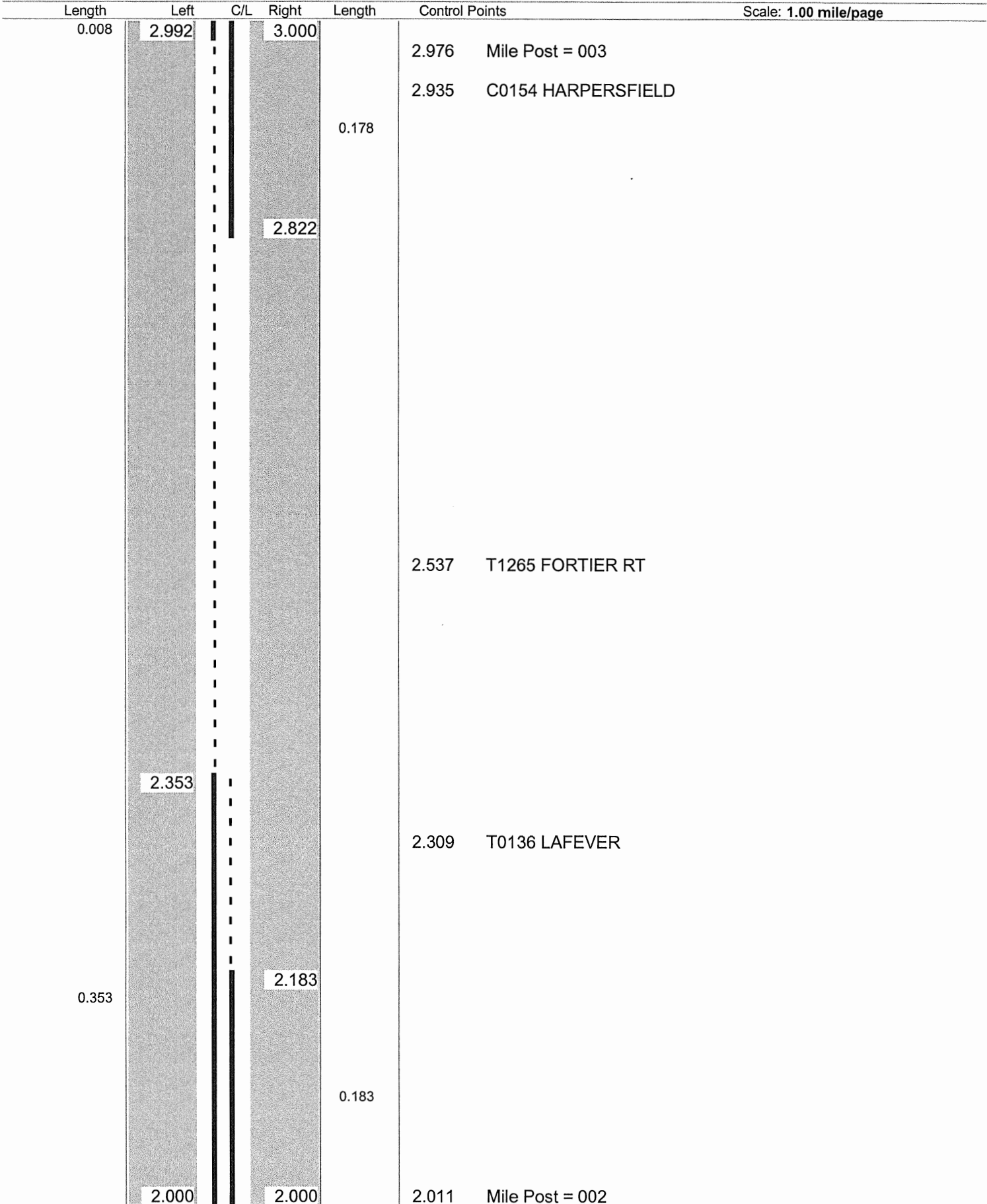

ODOT Dist 4 - Ashtabula County - FINAL

No Passing Zone Log (ATB)

Route: 0307R (SATBSR00307**C)

From: 0.000 LEAVE LAK CO

Length: 20.670 Direction: East

To: 20.670 S0193R

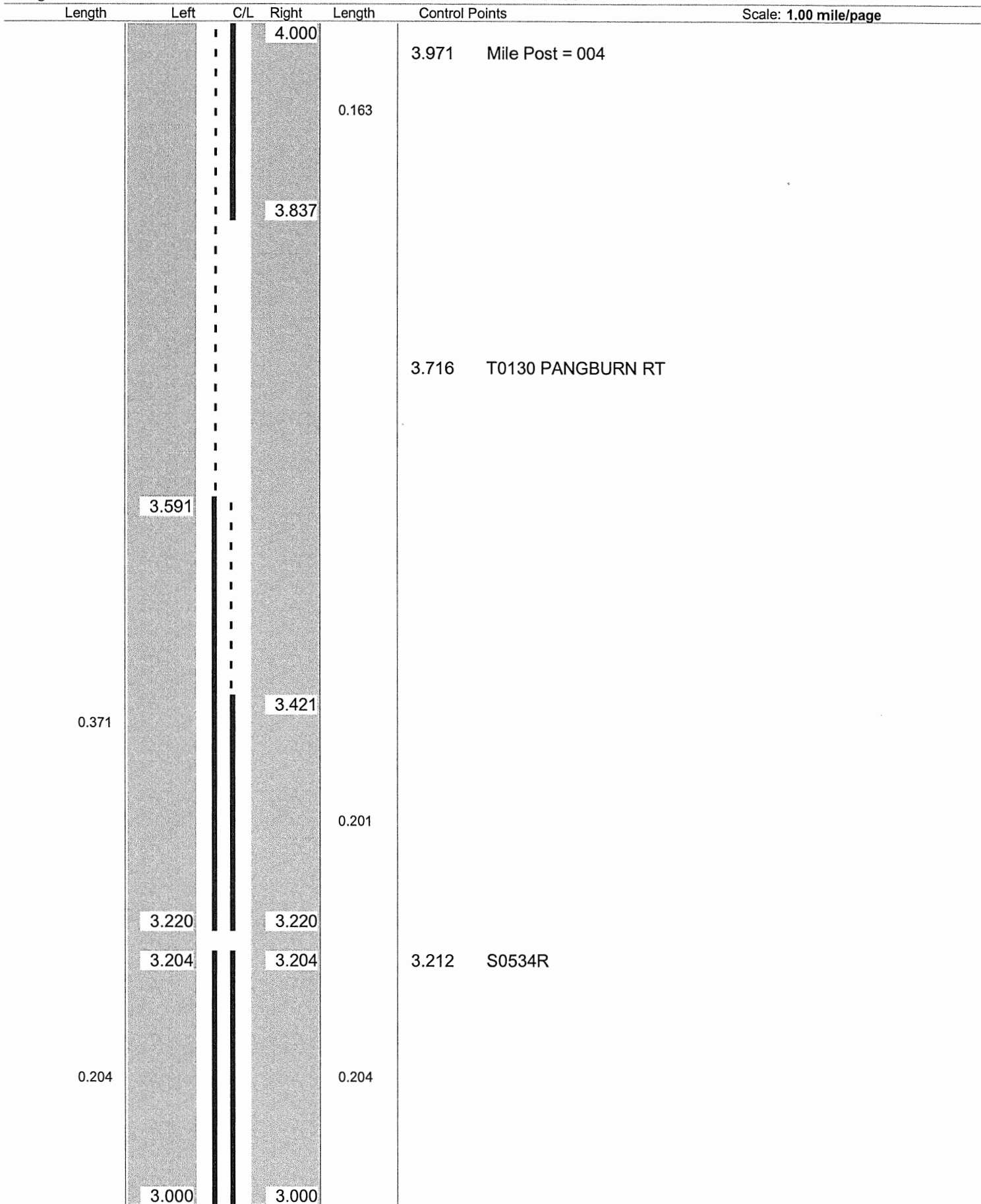

ODOT Dist 4 - Ashtabula County - FINAL
No Passing Zone Log (ATB)

Route: 0307R (SATBSR00307**C)

From: 0.000 LEAVE LAK CO

Length: 20.670 Direction: East

To: 20.670 S0193R

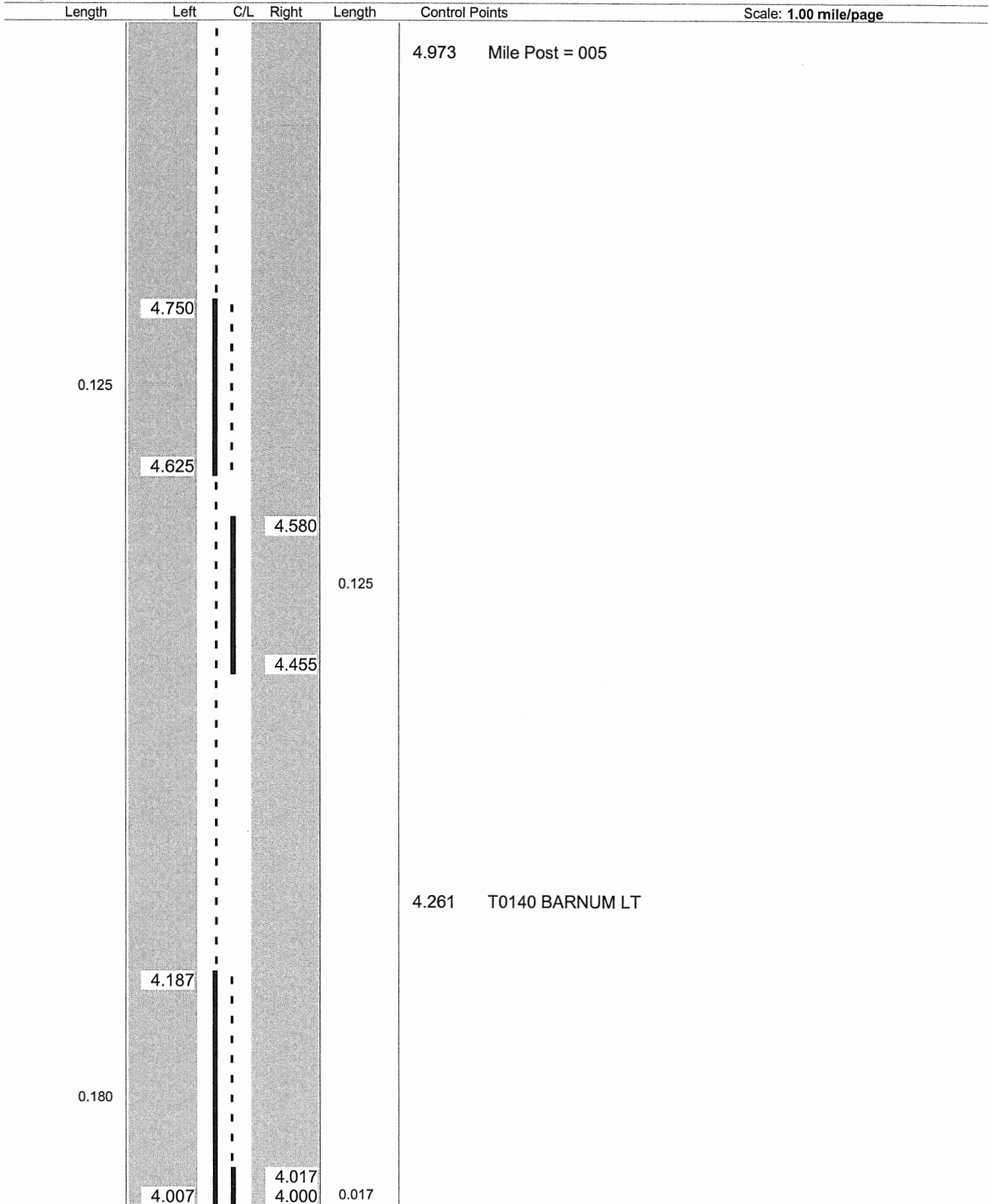

ODOT Dist 4 - Ashtabula County - FINAL
No Passing Zone Log (ATB)

Route: 0307R (SATBSR00307**C)

From: 0.000 LEAVE LAK CO

Length: 20.670 Direction: East

To: 20.670 S0193R

Length	Left	C/L	Right	Length	Control Points
					5.974 Mile Post = 006
					5.726 T1257 RAVINEWOOD RT
0.495					5.423 C0009 WINDSOR MECHANICSBURG
				0.495	

ODOT Dist 4 - Ashtabula County - FINAL
No Passing Zone Log (ATB)

Route: 0307R (SATBSR00307**C)

From: 0.000 LEAVE LAK CO

Length: 20.670 Direction: East

To: 20.670 S0193R

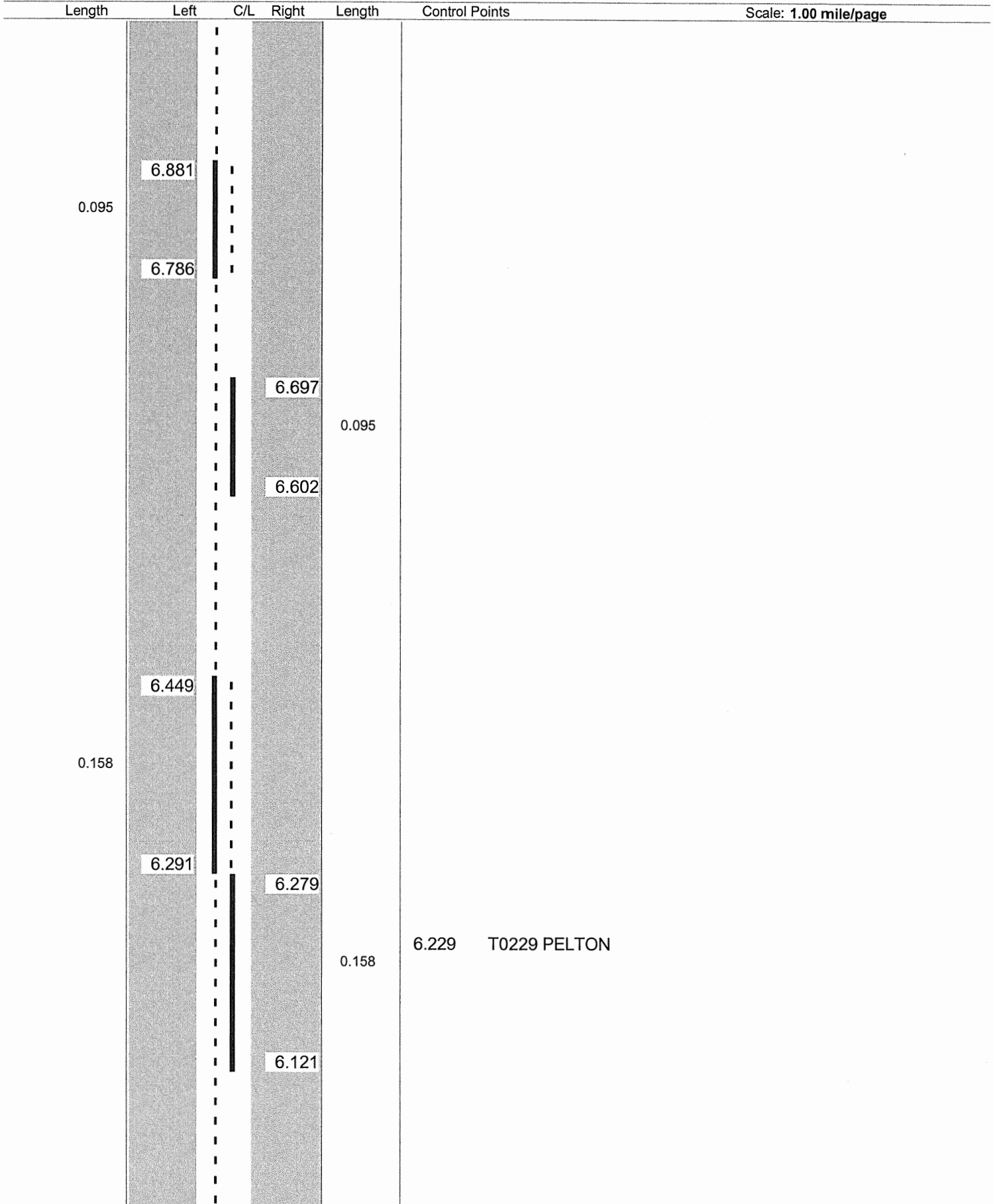

Sheet total equivalent length of solid line: 0.756

Accum. total: 7.600

ODOT Dist 4 - Ashtabula County - FINAL
No Passing Zone Log (ATB)

Route: 0307R (SATBSR00307**C)
 Length: 20.670 Direction: East

From: 0.000 LEAVE LAK CO
 To: 20.670 S0193R

Length	Left	C/L	Right	Length	Control Points	Scale: 1.00 mile/page
	8.000				7.978 Mile Post = 008	
0.181			7.906		7.910 T1015 CHESTNUT	
	7.819		7.819	0.087		
	7.794		7.794		7.807 S0045R	
					7.720 T1017 MAPLE RT	
					7.627 BRIDGE	
					7.560 T1014 CAMPUS LT	
0.616				0.786		
	7.178				7.216	↑ 40mph
					7.182 T0131 COLLEGE LT	
			7.008		7.001 Mile Post = 007	

**ODOT District 4
No Passing Zone Log (ATB)**

Route: **0307R (SATBSR00307**C)**
Length: **0.990** Direction: **East**

From: **8.000 LEAVE LAK CO**
To: **8.990 S0193R**

Scale: **1.00 mile/page**

Length	Left	C/L	Right	Length	Control Points
0.079	8.990		8.990		8.973 Mile Post = 009
	8.921				8.915 T0078 FOREMAN
				0.243	
				8.757	
	8.685				
0.285					8.555
				8.484	
	8.400				
					0.280
				8.204	
	8.085				
0.085					
	8.000				

ODOT District 4 No Passing Zone Log (ATB)

Route: 0307R (SATBSR00307**C)
Length: 1.000 Direction: East

From: 9.000 LEAVE LAK CO
To: 10.000 S0193R

Scale: 1.00 mile/page

Length	Left	C/L	Right	Length	Control Points
0.056	9.998				
	9.942		9.942		9.964 Mile Post = 010
			9.886	0.056	9.942 T0200 DADEVILLE LT
	9.602				
0.095					
	9.507				
			9.424		
				0.095	
			9.329		
	9.275				
0.095					
	9.180				
			9.098		
	9.033				
0.033					
	9.000		9.000	0.098	9.003 BRIDGE

Sheet total equivalent length of solid line: 0.770

Accum. total: 0.770

ODOT Dist 4 - Ashtabula County - FINAL
No Passing Zone Log (ATB)

Route: **0307R (SATBSR00307**C)**
 Length: **20.670** Direction: **East**

From: **0.000 LEAVE LAK CO**
 To: **20.670 S0193R**

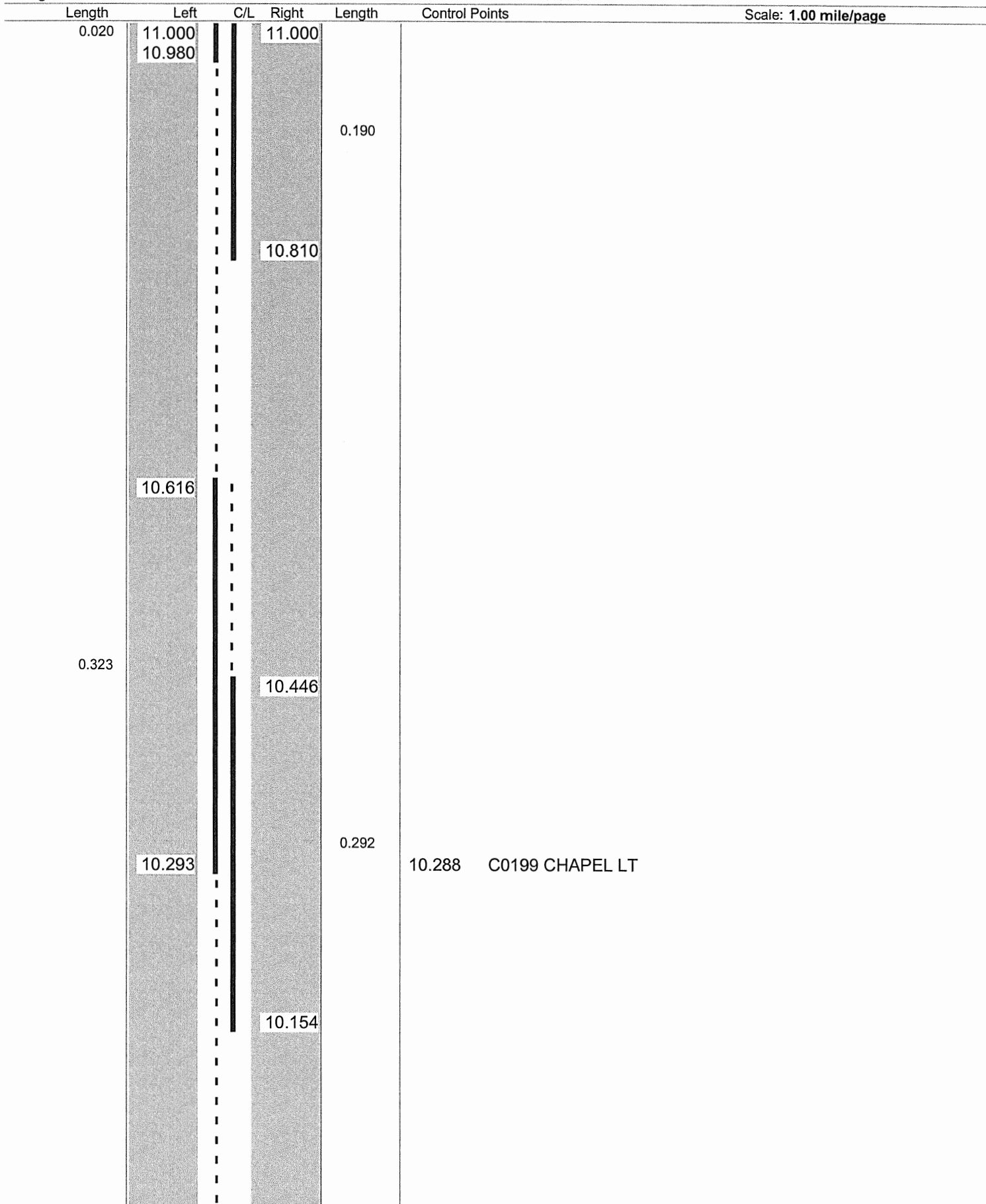

**ODOT District 4
No Passing Zone Log (ATB)**

Route: 0307R (SATBSR00307**C)
Length: 0.990 Direction: East

From: 11.000 LEAVE LAK CO
To: 11.990 S0193R

Scale: 1.00 mile/page

Length	Left	C/L	Right	Length	Control Points
0.031	11.990 11.969		11.990		11.972 Mile Post = 012
				0.164	
			11.836		
	11.798				
			11.650		11.659 11.655 T0278 DOYLE LT
0.475					↑ 45mph
	11.323			0.650	
	11.195				
0.195					11.099 T0286 HICKOK RT
	11.000		11.000		11.008 BRIDGE

ODOT Dist 4 - Ashtabula County - FINAL
No Passing Zone Log (ATB)

Route: 0307R (SATBSR00307**C)
 Length: 20.670 Direction: East

From: 0.000 LEAVE LAK CO
 To: 20.670 S0193R

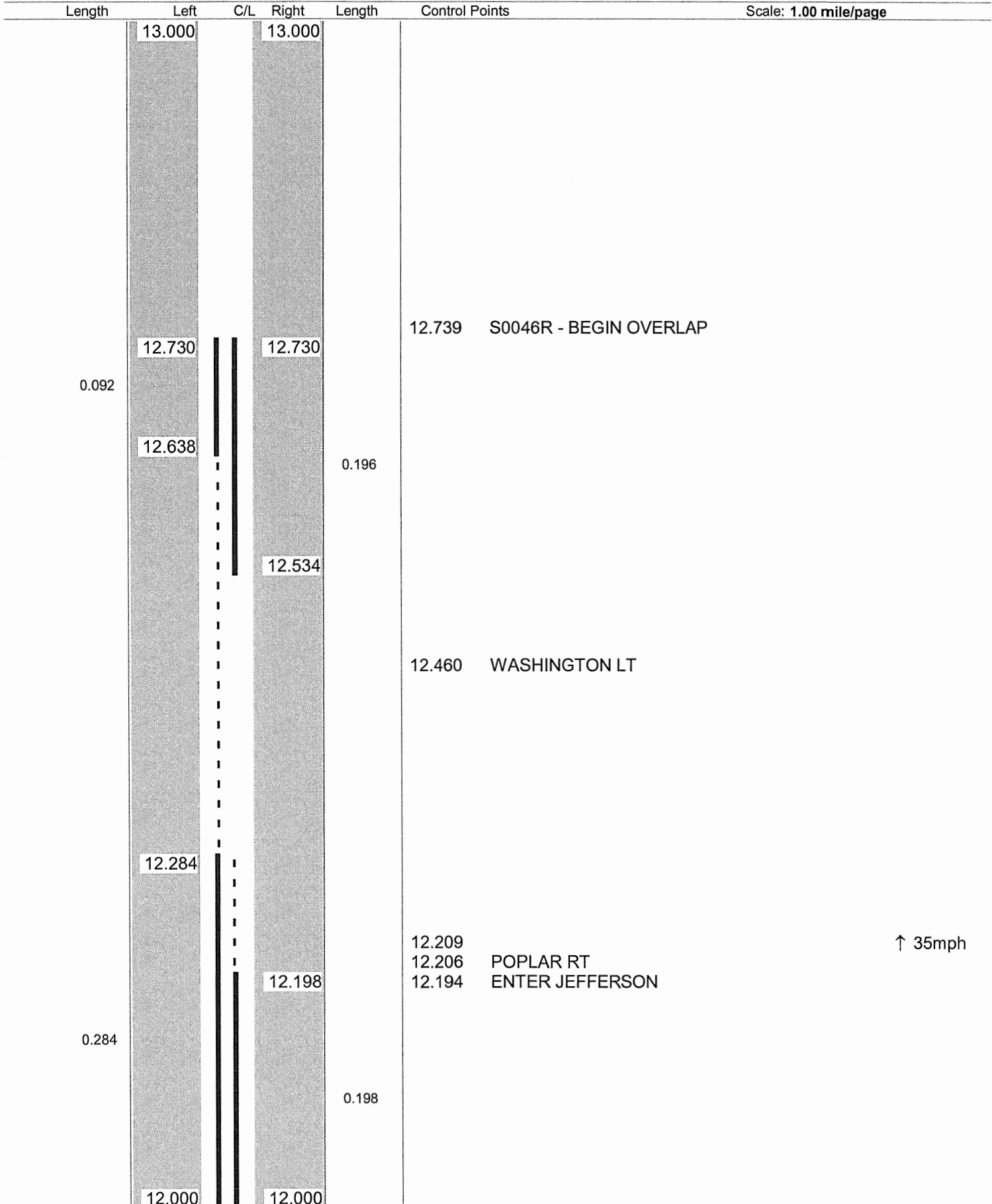

ODOT Dist 4 - Ashtabula County - FINAL
No Passing Zone Log (ATB)

Route: 0307R (SATBSR00307**C)
 Length: 20.670 Direction: East

From: 0.000 LEAVE LAK CO
 To: 20.670 S0193R

Length	Left	C/L	Right	Length	Control Points	Scale: 1.00 mile/page
	14.000			13.997	Mile Post = 014	
0.104						
	13.896			13.903		
				13.890	S0046R - END OVERLAP	↑ 35mph

ODOT Dist 4 - Ashtabula County - FINAL
No Passing Zone Log (ATB)

Route: 0307R (SATBSR00307**C)
 Length: 20.670 Direction: East

From: 0.000 LEAVE LAK CO
 To: 20.670 S0193R

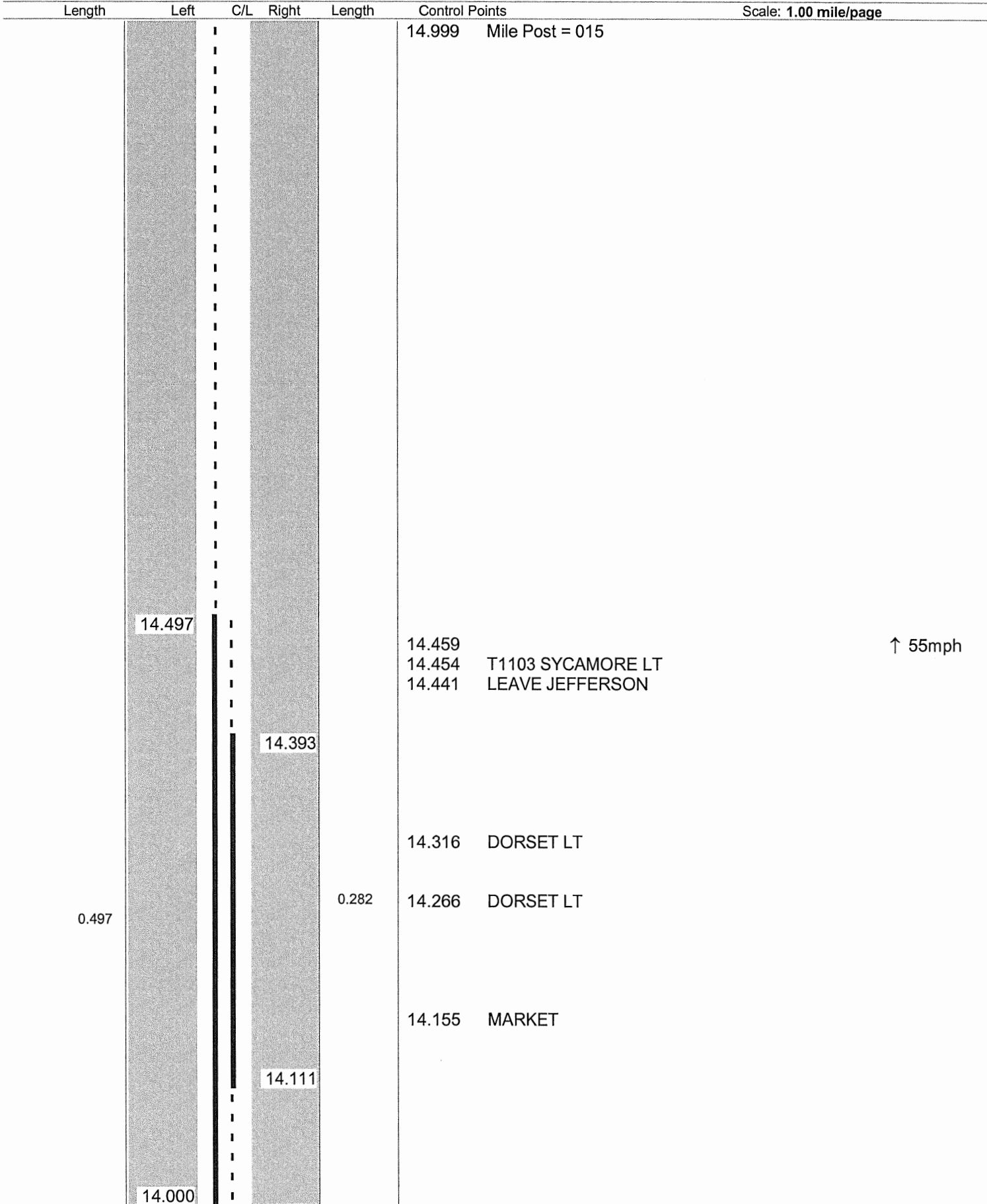

ODOT Dist 4 - Ashtabula County - FINAL
No Passing Zone Log (ATB)

Route: 0307R (SATBSR00307**C)

From: 0.000 LEAVE LAK CO

Length: 20.670 Direction: East

To: 20.670 S0193R

Length	Left	C/L	Right	Length	Control Points	Scale: 1.00 mile/page
					15.581 T0186 BLACK SEA	
0.066	15.192					
	15.126				15.122 T0303 SPRUCE LT	
			15.110	0.062		
			15.048			

ODOT Dist 4 - Ashtabula County - FINAL
No Passing Zone Log (ATB)

Route: 0307R (SATBSR00307**C)

From: 0.000 LEAVE LAK CO

Length: 20.670 Direction: East

To: 20.670 S0193R

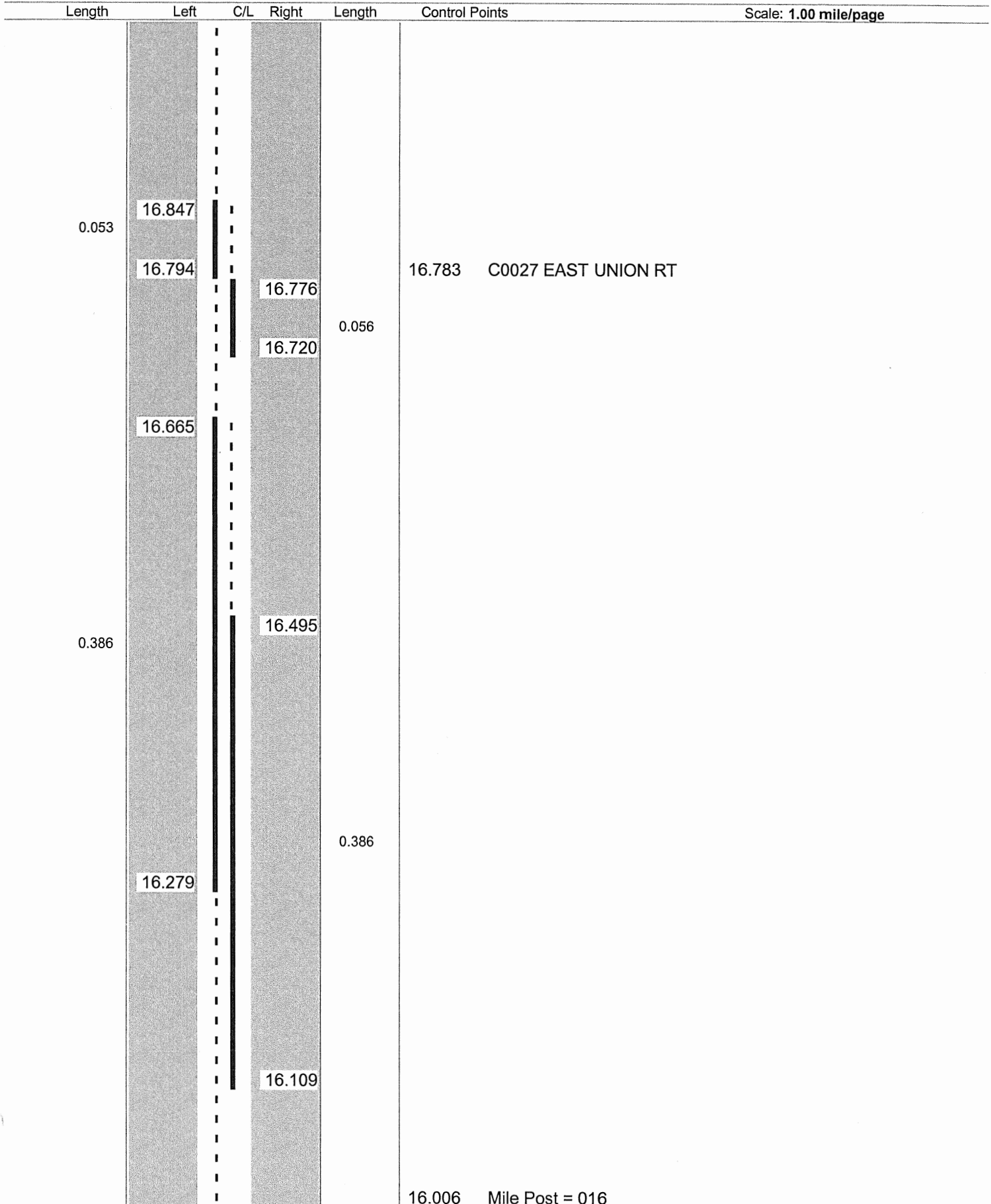

**ODOT District 4
No Passing Zone Log (ATB)**

Route: **0307R (SATBSR00307**C)**
Length: **0.500** Direction: **East**

From: **17.000 LEAVE LAK CO**
To: **17.500 S0193R**

Scale: **0.50 mile/page**

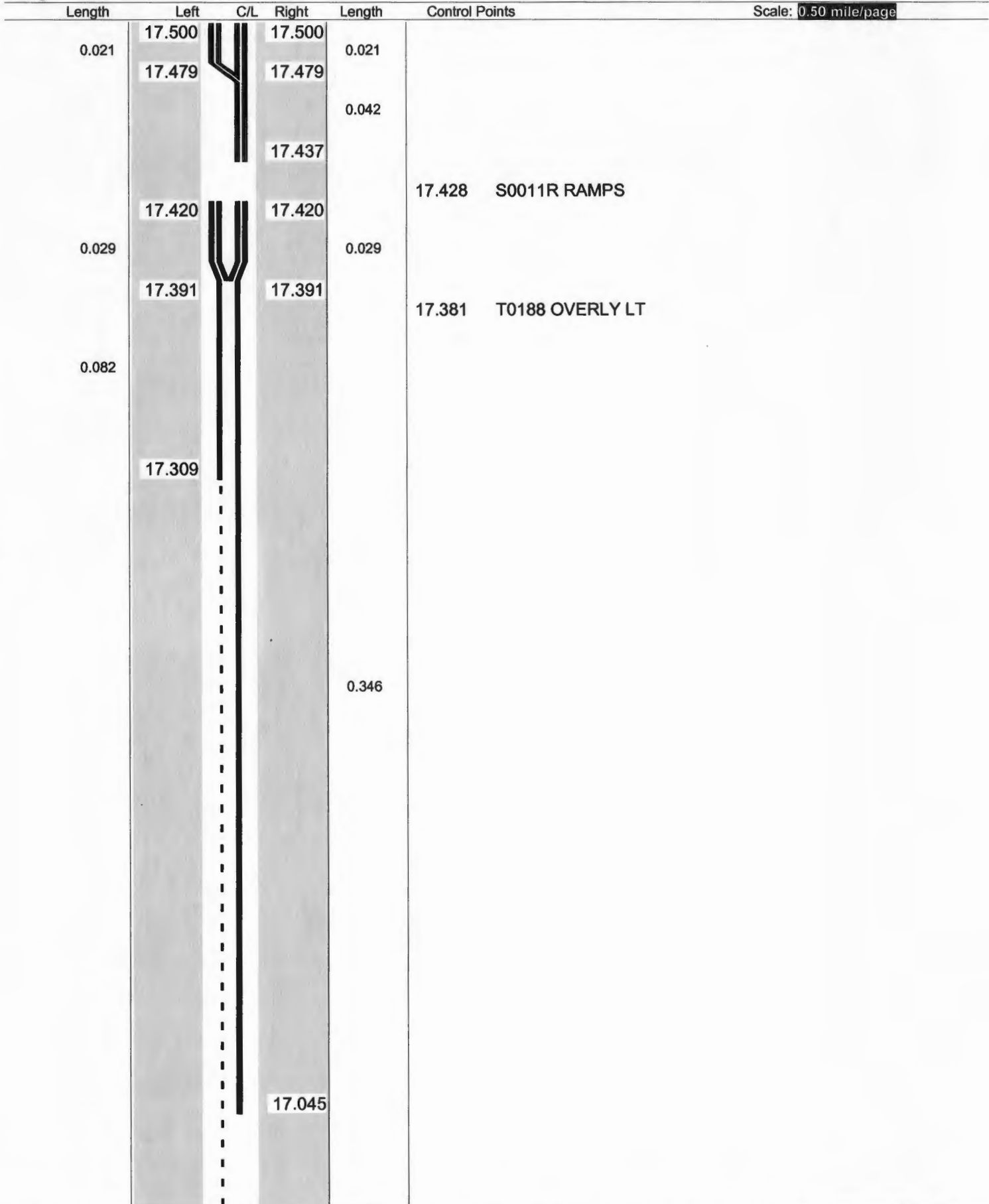

**ODOT District 4
No Passing Zone Log (ATB)**

Route: **0307R (SATBSR00307**C)**
Length: **0.490** Direction: **East**

From: **17.500 LEAVE LAK CO**
To: **17.990 S0193R**

Length	Left	C/L	Right	Length	Control Points	Scale: 0.50 mile/page
			17.984			
0.318				0.302		
0.030	17.682		17.682	0.030		
	17.652		17.652			
					17.645 S0011R RAMPS	
0.028	17.638					
	17.610		17.610			
0.033				0.033		
	17.577		17.577			
0.063				0.063		
0.014	17.514		17.514	0.014	17.516 S0011R Bridge (hwy Over Hwy)	
	17.500		17.500			

ODOT Dist 4 - Ashtabula County - FINAL
No Passing Zone Log (ATB)

Route: 0307R (SATBSR00307**C)
 Length: 20.670 Direction: East

From: 0.000 LEAVE LAK CO
 To: 20.670 S0193R

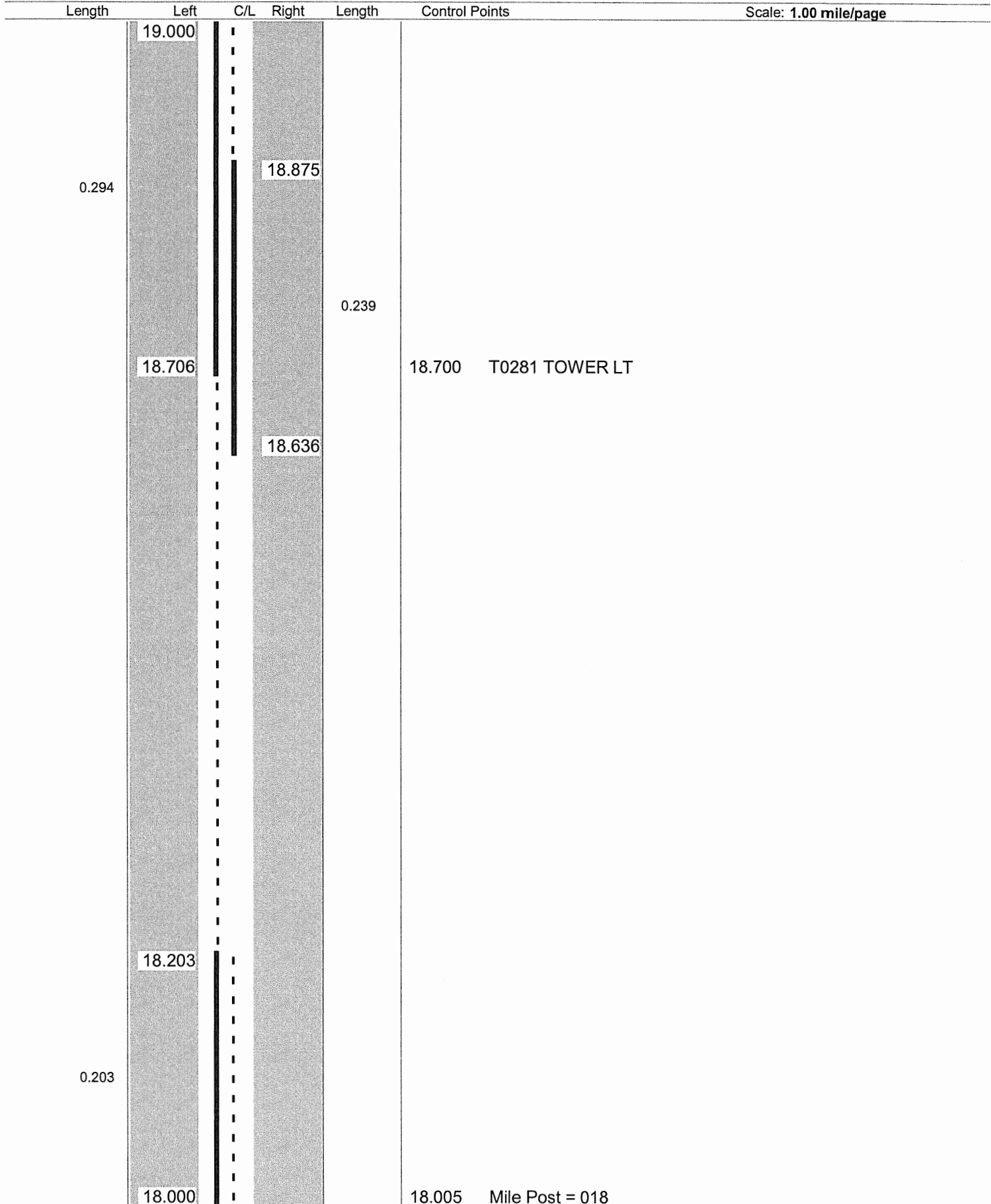

**ODOT District 4
No Passing Zone Log (ATB)**

Route: **0307R (SATBSR00307**C)**
Length: **0.990** Direction: **East**

From: **19.000 LEAVE LAK CO**
To: **19.990 S0193R**

Length	Left	C/L	Right	Length	Control Points	Scale: 1.00 mile/page
	19.990		19.972		19.981 C0012 FOOTVILLE RICHMOND LT	
					19.850 BRIDGE	
					19.823 T0176 RUSSELL RT	
				0.387		
					19.672 C0012 FOOTVILLE RICHMOND RT	
0.722			19.585			
			19.378			
	19.278					
				0.270		
			19.108			
	19.045					
0.045	19.000				19.005 Mile Post = 019	

ODOT Dist 4 - Ashtabula County - FINAL
No Passing Zone Log (ATB)

Route: 0307R (SATBSR00307**C)
 Length: 20.670 Direction: East

From: 0.000 LEAVE LAK CO
 To: 20.670 S0193R

Length	Left	C/L	Right	Length	Control Points
--------	------	-----	-------	--------	----------------

Scale: 1.00 mile/page

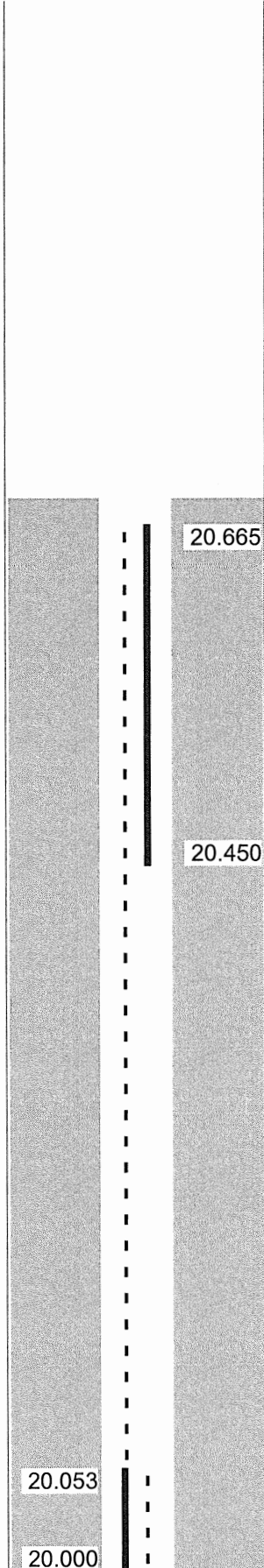

20.670 S0193R

0.215

0.053

20.013 Mile Post = 020