

**ODOT Dist 4 - Ashtabula County - FINAL**  
**No Passing Zone Log (ATB)**

Route: 0046R (SATBSR00046\*\*C)

From: 0.000 LEAVE TRU CO

Length: 21.977 Direction: North

To: 21.977 START OF C00025 STATE

Length      Left      C/L      Right      Length      Control Points      Scale: 1.00 mile/page

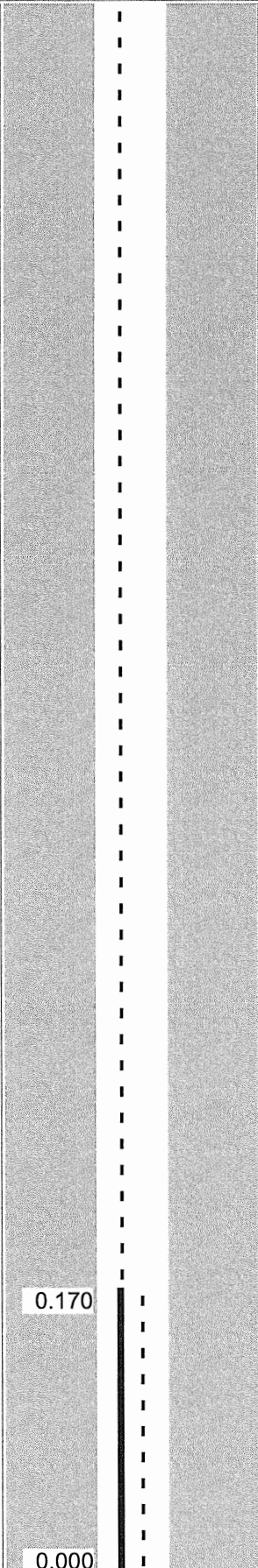

0.000 Mile Post = 000  
 0.000 LEAVE TRU CO



**ODOT Dist 4 - Ashtabula County - FINAL**  
**No Passing Zone Log (ATB)**

Route: **0046R (SATBSR00046\*\*C)**

From: **0.000 LEAVE TRU CO**

Length: **21.977** Direction: **North**

To: **21.977 START OF C00025 STATE**

Length	Left	C/L	Right	Length	Control Points	Scale: 1.00 mile/page
0.211	2.781					
	2.570		2.557	0.212	2.564 U0322R	
			2.345			
					2.031 Mile Post = 002	



ODOT District 4  
No Passing Zone Log (ATB)

Route: 0046R (SATBSR00046\*\*C)  
Length: 0.990 Direction: North

From: 4.000 LEAVE TRU CO  
To: 4.990 START OF C00025 STATE

Scale: 1.00 mile/page

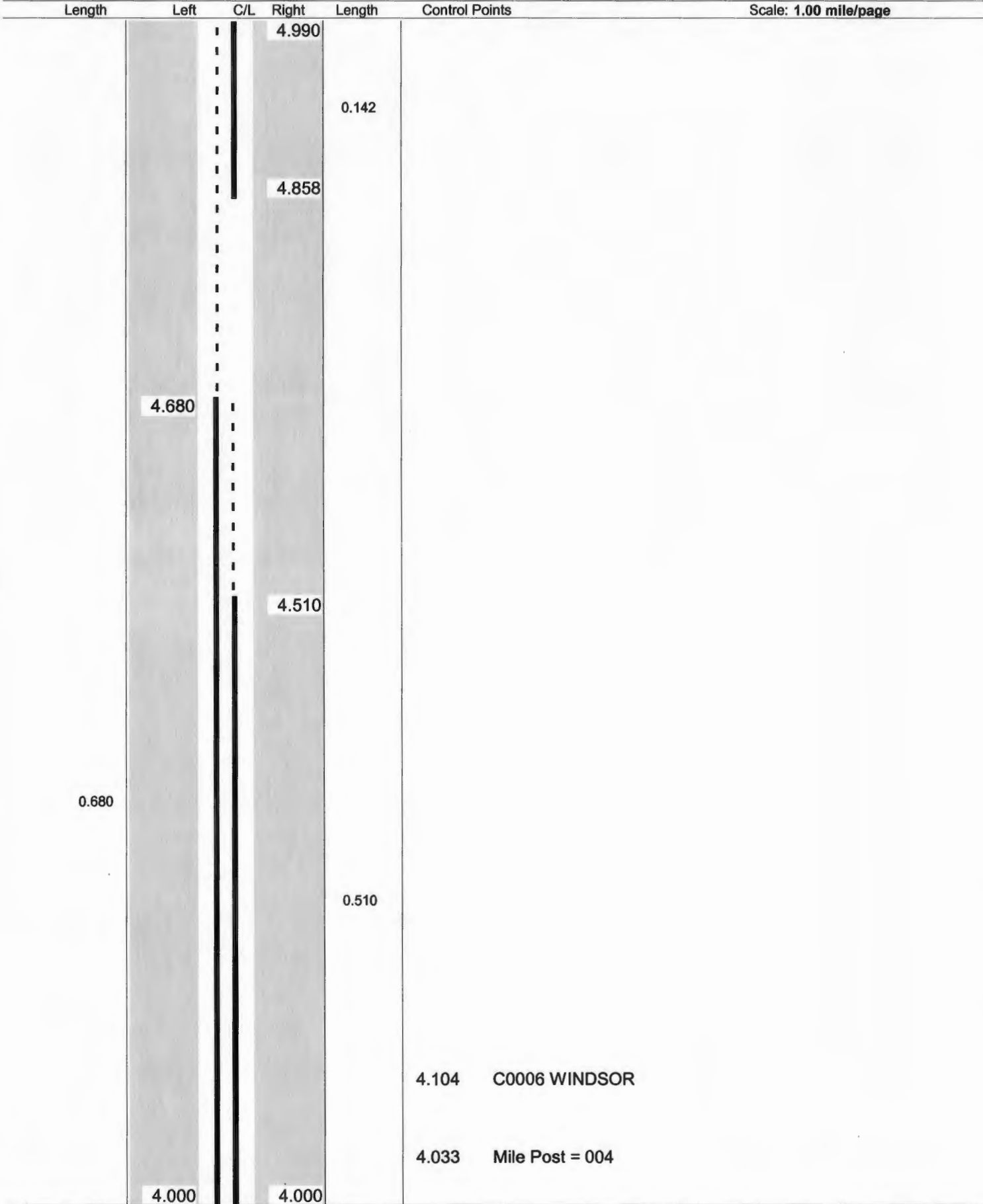

**ODOT Dist 4 - Ashtabula County - FINAL**  
**No Passing Zone Log (ATB)**

Route: 0046R (SATBSR00046\*\*C)  
 Length: 21.977

Direction: North

From: 0.000 LEAVE TRU CO  
 To: 21.977 START OF C00025 STATE

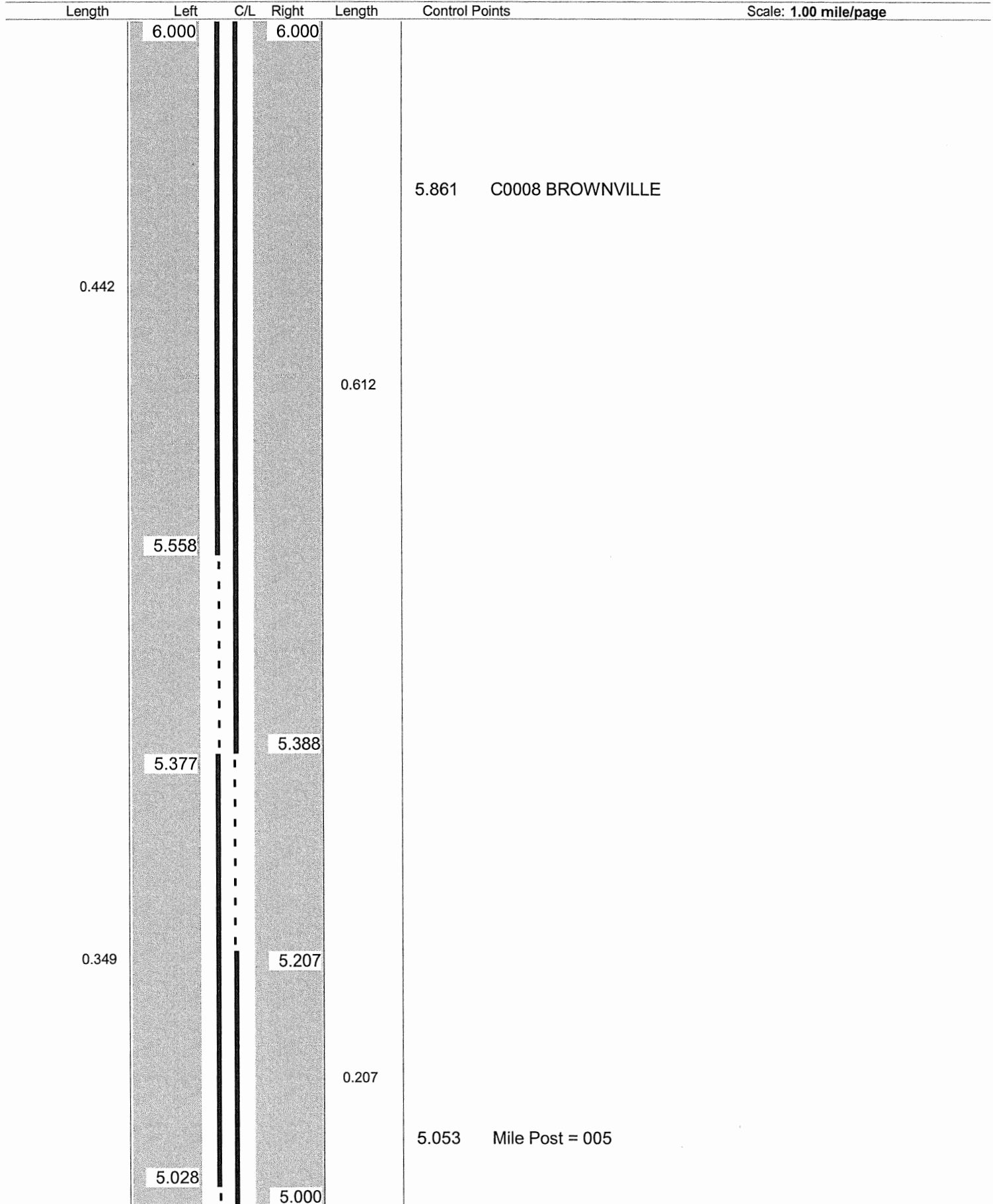

**ODOT District 4  
No Passing Zone Log (ATB)**

Route: **0046R (SATBSR00046\*\*C)**  
Length: **0.990**      Direction: **North**

From: **6.000 LEAVE TRU CO**  
To: **6.990 START OF C00025 STATE**

Scale: 1.00 mile/page

Length	Left	C/L	Right	Length	Control Points
			6.990		
				0.134	
			6.866		
				6.828	T0092 WAY LT
	6.695				
0.193					
	6.502		6.525		
				0.193	
			6.332		
	6.242				
0.242			6.137		6.145 C0580 DODGEVILLE
				0.137	
					6.062 Mile Post = 006
	6.000		6.000		

**ODOT District 4  
No Passing Zone Log (ATB)**

Route: **0046R (SATBSR00046\*\*C)**  
Length: **0.990** Direction: **North**

From: **7.000 LEAVE TRU CO**  
To: **7.990 START OF C00025 STATE**

Length	Left	C/L	Right	Length	Control Points	Scale: 1.00 mile/page
0.016	7.984		7.990			
				0.186		
			7.814			
	7.650					
0.161						
	7.489					
	7.480		7.480		7.484 U0006R	
0.269						
	7.211			0.480		
					7.074 Mile Post = 007	
			7.000			

**ODOT Dist 4 - Ashtabula County - FINAL**  
**No Passing Zone Log (ATB)**

Route: 0046R (SATBSR00046\*\*C)  
 Length: 21.977 Direction: North

From: 0.000 LEAVE TRU CO  
 To: 21.977 START OF C00025 STATE

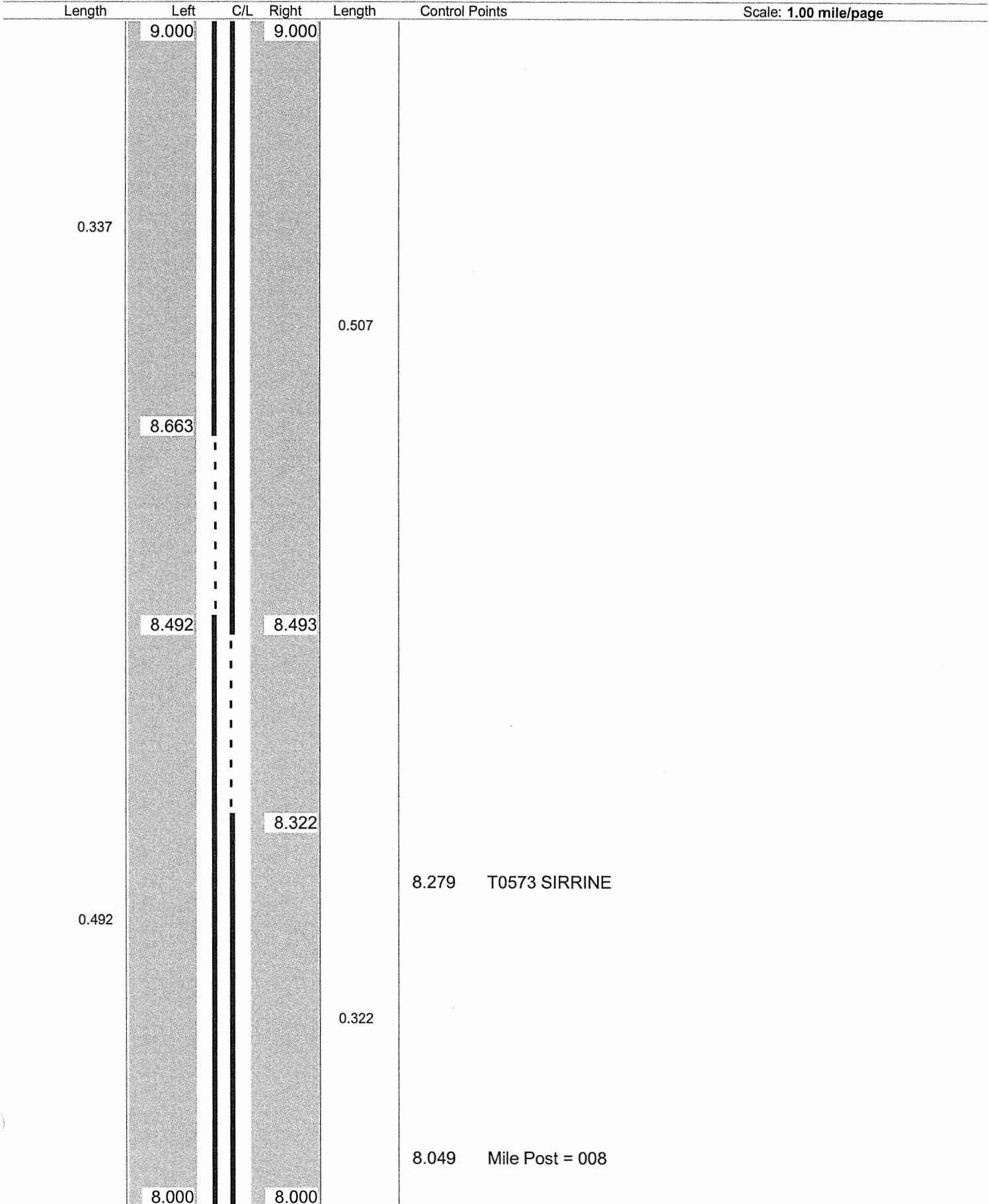

**ODOT Dist 4 - Ashtabula County - FINAL**  
**No Passing Zone Log (ATB)**

Route: **0046R (SATBSR00046\*\*C)**

From: **0.000 LEAVE TRU CO**

Length: **21.977** Direction: **North**

To: **21.977 START OF C00025 STATE**

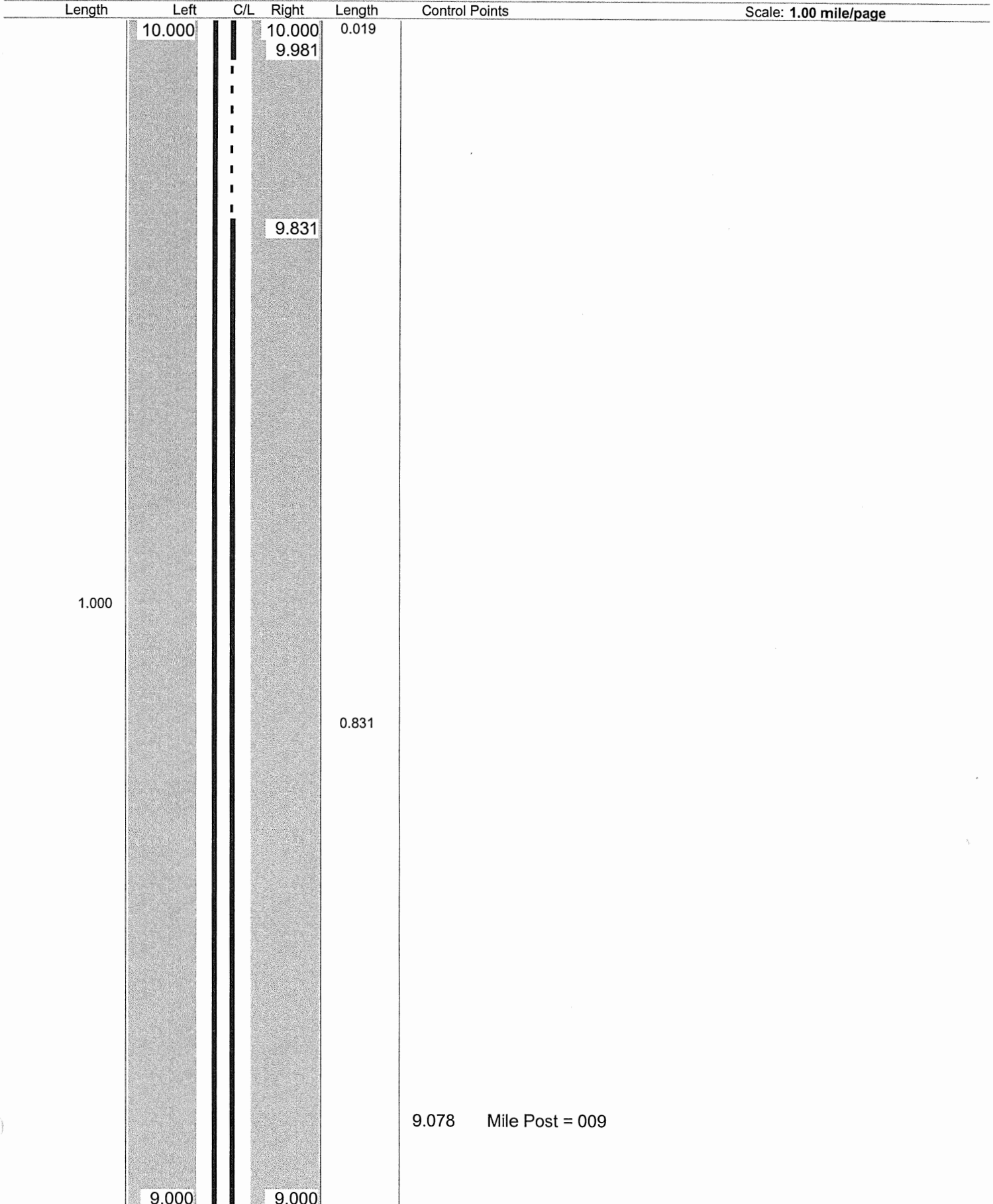

ODOT Dist 4 - Ashtabula County - FINAL  
 No Passing Zone Log (ATB)

Route: 0046R (SATBSR00046\*\*C)

Length: 21.977

Direction: North

From: 0.000 LEAVE TRU CO

To: 21.977 START OF C00025 STATE

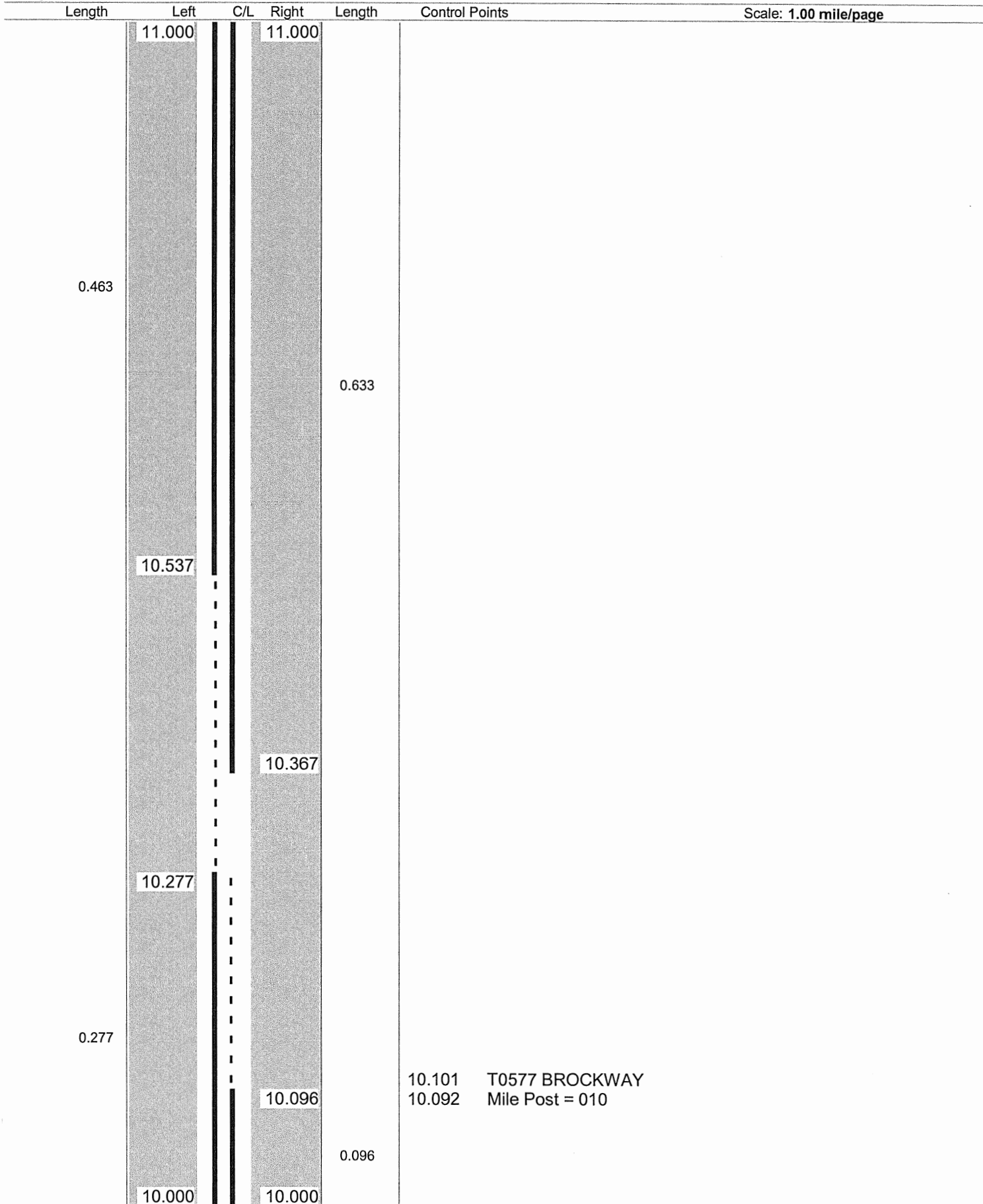

**ODOT Dist 4 - Ashtabula County - FINAL**  
**No Passing Zone Log (ATB)**

Route: 0046R (SATBSR00046\*\*C)

From: 0.000 LEAVE TRU CO

Length: 21.977 Direction: North

To: 21.977 START OF C00025 STATE

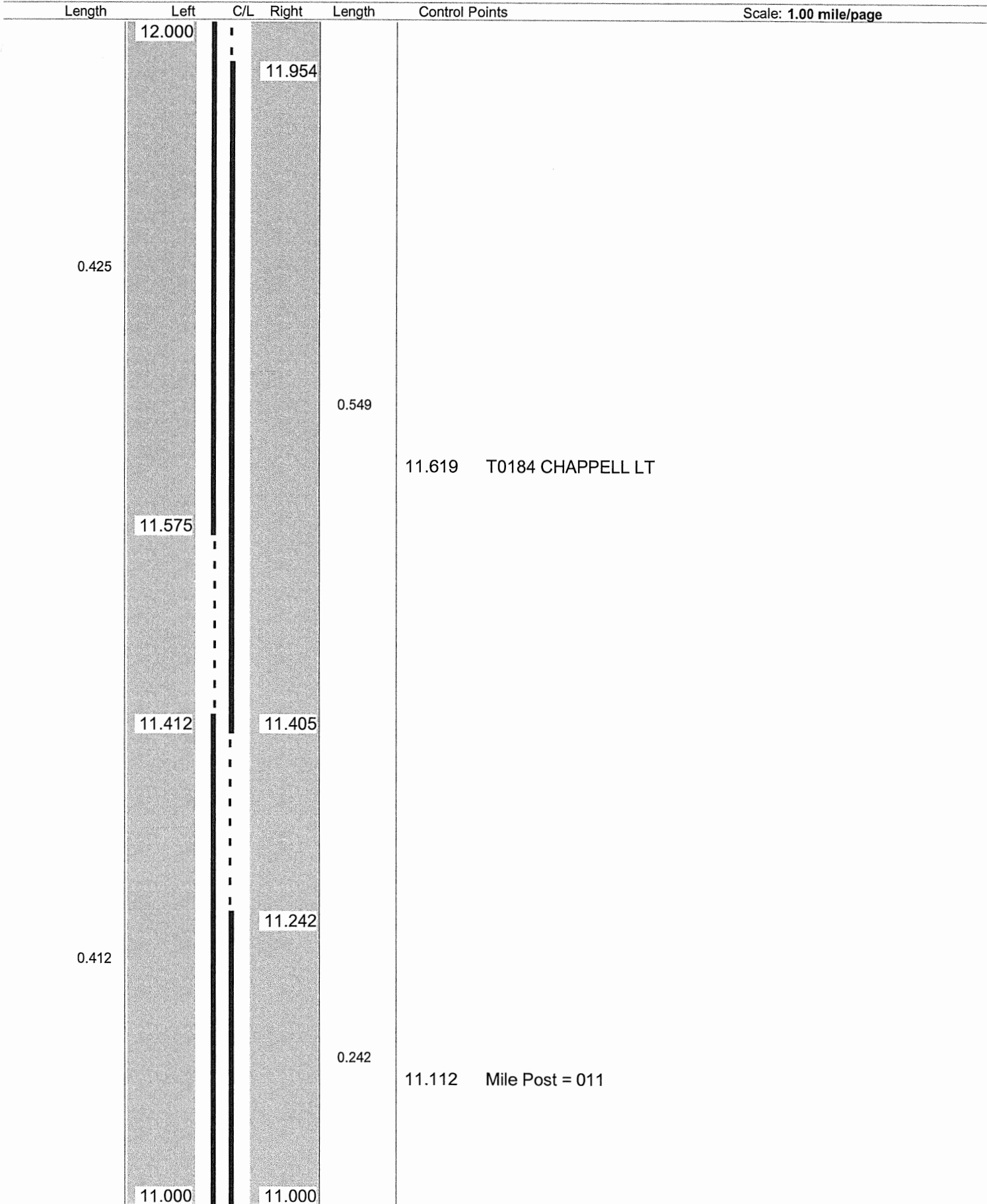

**ODOT District 4  
No Passing Zone Log (ATB)**

Route: **0046R (SATBSR00046\*\*C)**  
Length: **0.990**      Direction: **North**

From: **12.000 LEAVE TRU CO**  
To: **12.990 START OF C00025 STATE**

Length	Left	C/L	Right	Length	Control Points	Scale: 1.00 mile/page
			12.990			
	12.962					
0.128					12.893    C0012 FOOTVILLE RICHMOND	
	12.834			0.336		
			12.664			
	12.643					
0.294			12.473		12.448    T0116 TISCH LT	
	12.349			0.294		
			12.179			
	12.124				12.124    Mile Post = 012	
0.124						
	12.000					

**ODOT District 4  
No Passing Zone Log (ATB)**

Route: **0046R (SATBSR00046\*\*C)**  
Length: **0.990**      Direction: **North**

From: **13.000 LEAVE TRU CO**  
To: **13.990 START OF C00025 STATE**

Length	Left	C/L	Right	Length	Control Points	Scale: 1.00 mile/page
			13.990	0.033		
			13.967			
	13.900					
			13.730			
0.689					13.649 T0187 WEBSTER RT	
				0.730		
	13.211					
			13.000		13.140 Mile Post = 013	

**ODOT Dist 4 - Ashtabula County - FINAL**  
**No Passing Zone Log (ATB)**

Route: 0046R (SATBSR00046\*\*C)

From: 0.000 LEAVE TRU CO

Length: 21.977 Direction: North

To: 21.977 START OF C00025 STATE

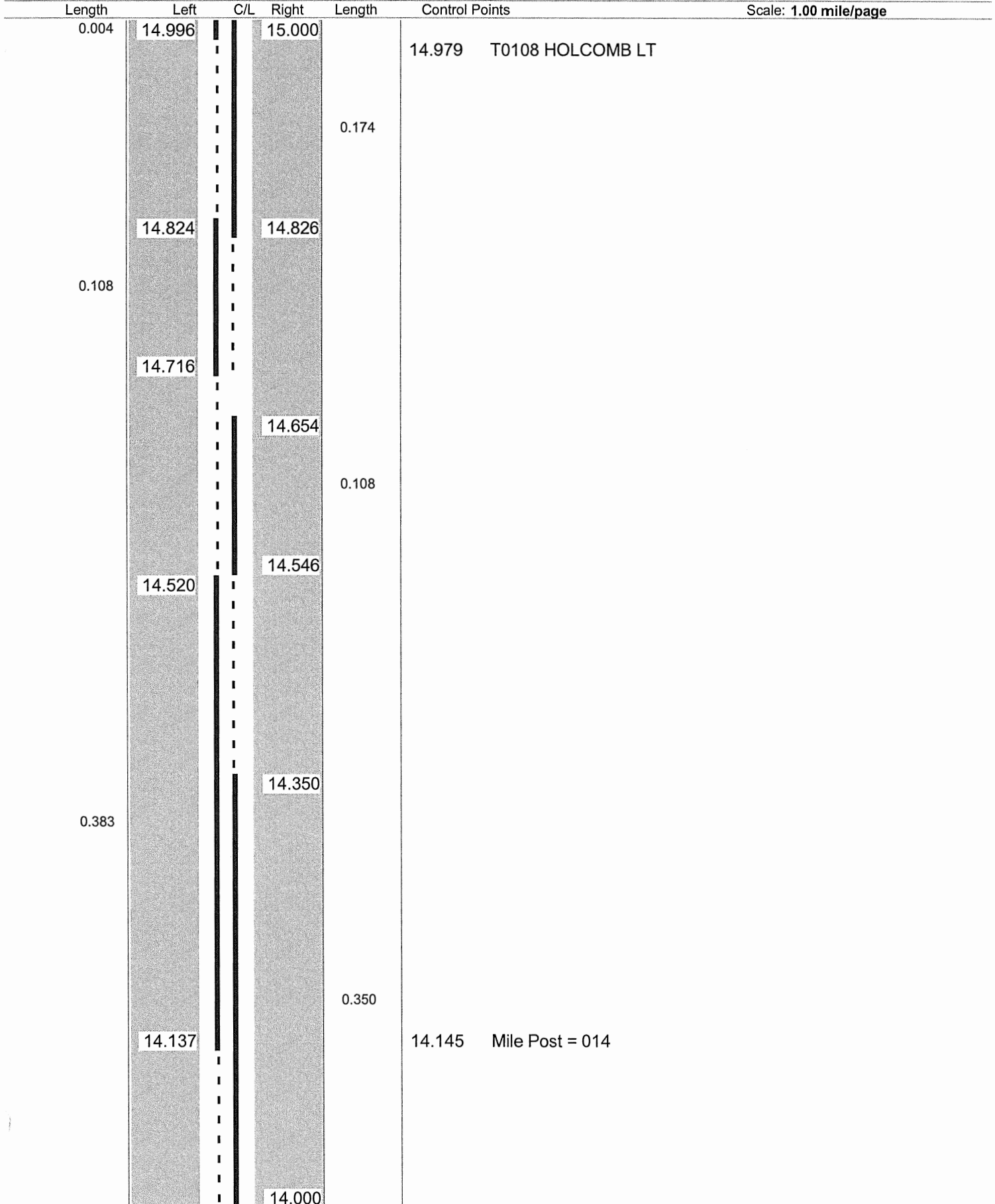

**ODOT Dist 4 - Ashtabula County - FINAL**  
**No Passing Zone Log (ATB)**

Route: **0046R (SATBSR00046\*\*C)**

From: **0.000 LEAVE TRU CO**

Length: **21.977** Direction: **North**

To: **21.977 START OF C00025 STATE**

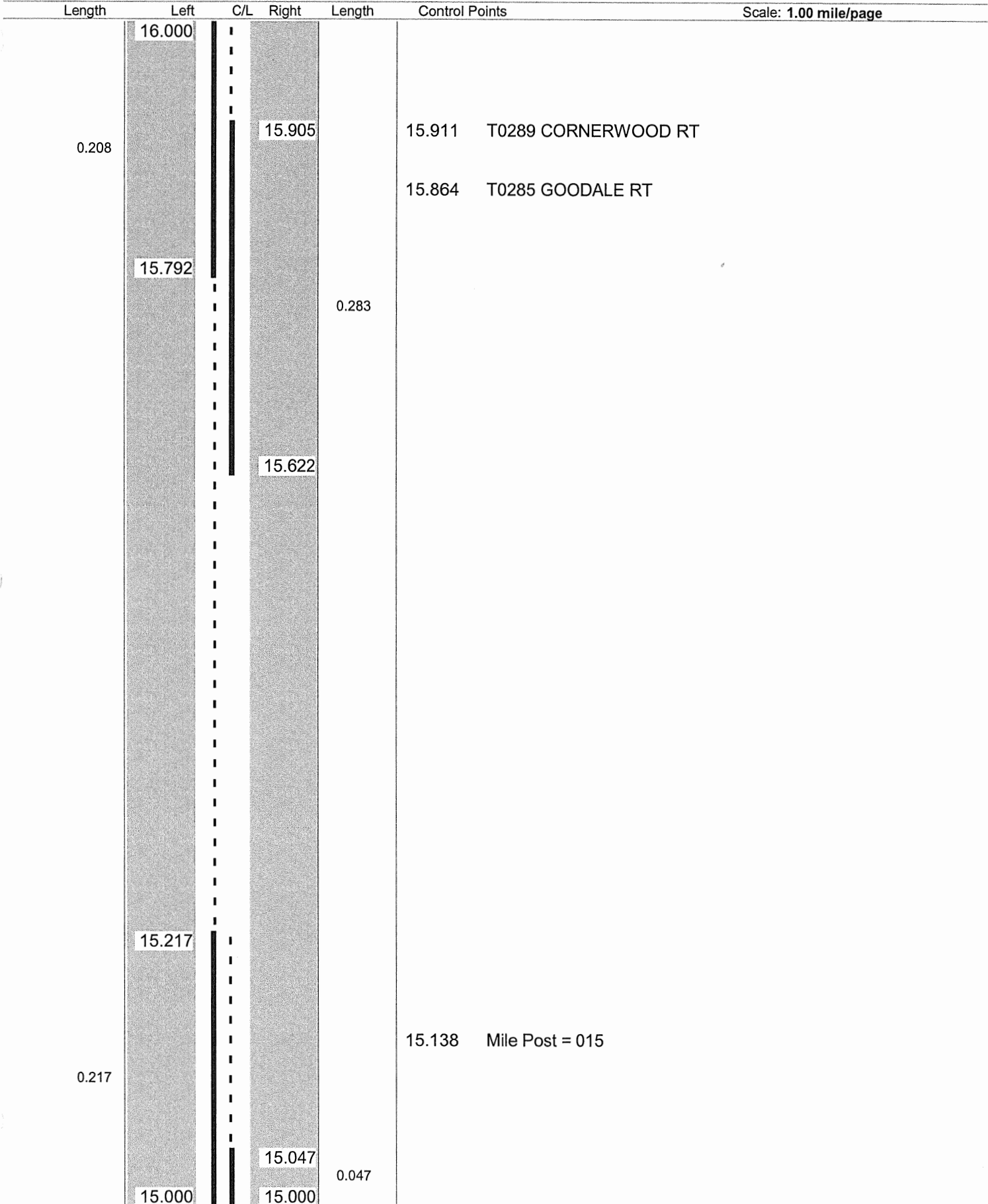

**ODOT Dist 4 - Ashtabula County - FINAL**  
**No Passing Zone Log (ATB)**

Route: 0046R (SATBSR00046\*\*C)  
 Length: 21.977

Direction: North

From: 0.000 LEAVE TRU CO  
 To: 21.977 START OF C00025 STATE

Length	Left	C/L	Right	Length	Control Points	Scale: 0.50 mile/page
	16.500		16.500			
0.152					16.481 CEDAR RT	
				0.247	16.390 LINDA LT	
	16.348				16.341 ENTER JEFFERSON 16.341 S0307R	
			16.253			
					16.171 Mile Post = 016	
	16.046					
0.046						
	16.000					

**ODOT Dist 4 - Ashtabula County - FINAL**  
**No Passing Zone Log (ATB)**

Route: 0046R (SATBSR00046\*\*C)  
 Length: 21.977

Direction: North

From: 0.000 LEAVE TRU CO  
 To: 21.977 START OF C00025 STATE

Length	Left	C/L	Right	Length	Control Points	Scale: 0.50 mile/page
	17.000		17.000			
0.087				0.087	16.972 WALL RT	
	16.913		16.913			
	16.886				16.899 JEFFERSON	
0.024	16.862		16.862			
					16.759 SATIN	
0.362				0.362		
					16.620 ERIE	
	16.500		16.500			

**ODOT Dist 4 - Ashtabula County - FINAL**  
**No Passing Zone Log (ATB)**

Route: **0046R (SATBSR00046\*\*C)**  
 Length: **21.977**

Direction: **North**

From: **0.000 LEAVE TRU CO**  
 To: **21.977 START OF C00025 STATE**

Length	Left	C/L	Right	Length	Control Points	Scale: 0.50 mile/page
0.006	17.494		17.494	0.005		
			17.467	0.027		
	17.450				17.459 S0307R / S0167R	
0.026						
	17.424		17.424			
0.021				0.021		
	17.403		17.403			
					17.319 PINE	
0.403				0.403		
					17.180 ASHTABULA	
					17.156 Mile Post = 017	
					17.041 WALNUT	
	17.000		17.000			

**ODOT Dist 4 - Ashtabula County - FINAL**  
**No Passing Zone Log (ATB)**

Route: **0046R (SATBSR00046\*\*C)**

From: **0.000 LEAVE TRU CO**

Length: **21.977** Direction: **North**

To: **21.977 START OF C00025 STATE**

Length	Left	C/L	Right	Length	Control Points	Scale: 0.50 mile/page
0.014	18.000 17.986		17.976		17.982 T0523 LAWYER RT	
			17.916	0.060		
	17.810				17.866	↑ 55mph
			17.677			
0.310					17.630 17.627 T1023 OAK LT	↑ 45mph
				0.177		
					17.562 T1022 LINDEN LT	
					17.531 LEAVE JEFFERSON	
	17.500		17.500			

**ODOT Dist 4 - Ashtabula County - FINAL**  
**No Passing Zone Log (ATB)**

Route: **0046R (SATBSR00046\*\*C)**

From: **0.000 LEAVE TRU CO**

Length: **21.977** Direction: **North**

To: **21.977 START OF C00025 STATE**

Length	Left	C/L	Right	Length	Control Points
	18.985				
0.064	18.921		18.910		18.915 T0296 PERRY RT
			18.841	0.069	
	18.699				
0.315			18.529		18.524 C0288 MARKET RT
	18.384			0.315	
			18.214		18.180 Mile Post = 018
0.042	18.042				
	18.000				

Scale: 1.00 mile/page



**ODOT District 4  
No Passing Zone Log (ATB)**

Route: **0046R (SATBSR00046\*\*C)**  
Length: **0.990**      Direction: **North**

From: **20.000 LEAVE TRU CO**  
To: **20.990 START OF C00025 STATE**

Length	Left	C/L	Right	Length	Control Points	Scale: 1.00 mile/page
0.313	20.990		20.936	0.061	20.945 T0319 MORGAN	
			20.875			
0.245	20.687		20.648	0.131		
			20.517			
	20.248		20.166			
	20.003		20.000	0.166	20.201 Mile Post = 020	
					20.176 C0016 GRIGGS RT	

**ODOT Dist 4 - Ashtabula County - FINAL**  
**No Passing Zone Log (ATB)**

Route: **0046R (SATBSR00046\*\*C)**

Length: **21.977** Direction: **North**

From: **0.000 LEAVE TRU CO**

To: **21.977 START OF C00025 STATE**

Length	Left	C/L	Right	Length	Control Points
	21.977		21.977		21.977 START OF C00025 STATE
0.129					21.963 S0011R RAMP RT
					21.926 S0011R RAMP LT
	21.848			0.299	21.844 S0011R Bridge (Hwy Over Hwy)
					21.807 S0011R RAMPS
					21.765 S0011R RAMP LT
			21.678		
	21.610				
0.309					
			21.440		
	21.301			0.309	21.339 C0150 JEFFERSON LT
					21.305 C0150 JEFFERSON - EXIT ONLY LT
					21.230 Mile Post = 021
			21.131		
0.007	21.007				