

ODOT District 10 - Athens County - 6/7/12
No Passing Zone Log (ATH)

Route: **0682R**
 Length: **7.750**

Direction: **North**

From: **0.000 US 33**
 To: **7.750 S0013**

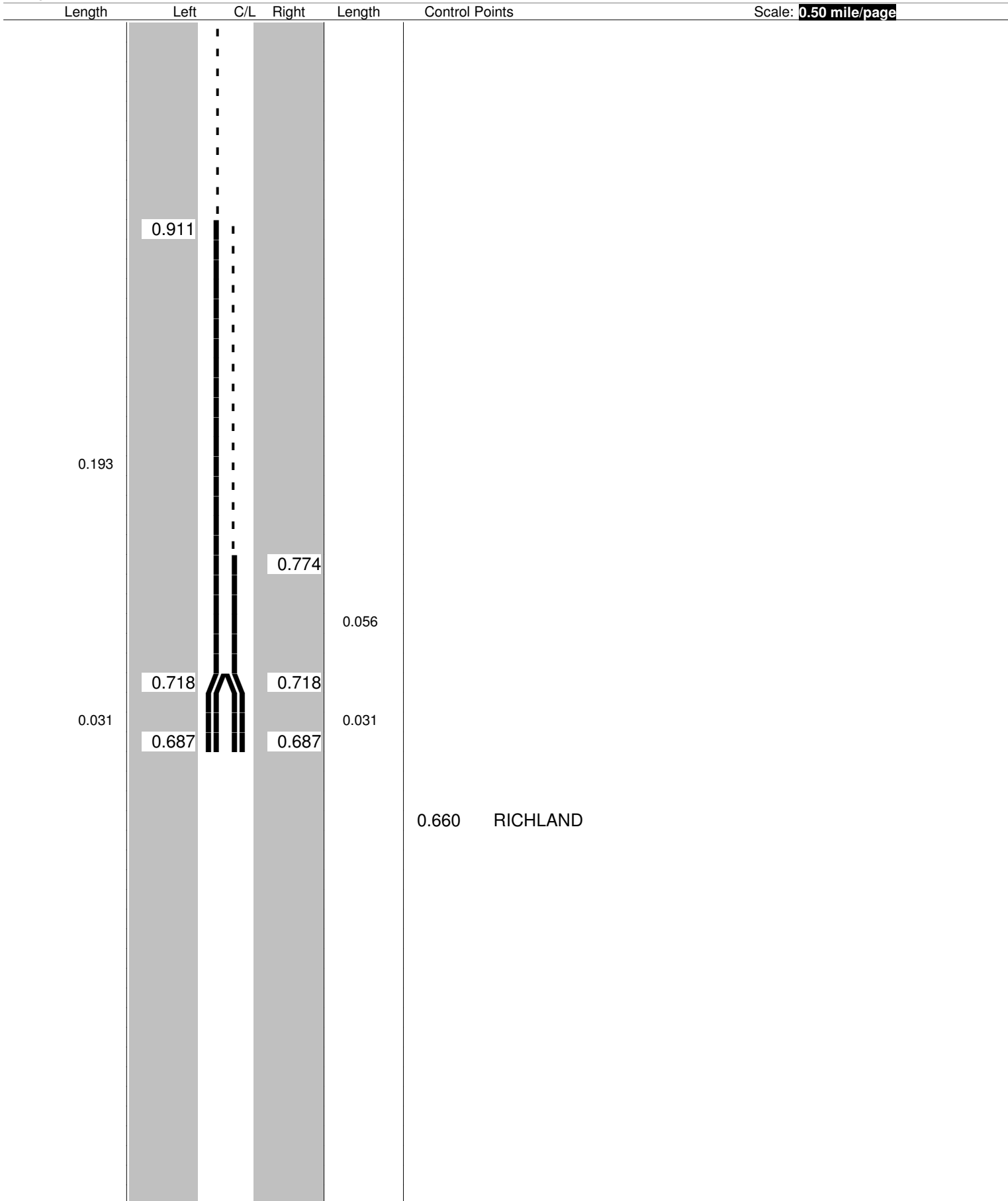

ODOT District 10 - Athens County - 6/7/12
 No Passing Zone Log (ATH)

Route: **0682R**
 Length: **7.750**

Direction: **North**

From: **0.000 US 33**
 To: **7.750 S0013**

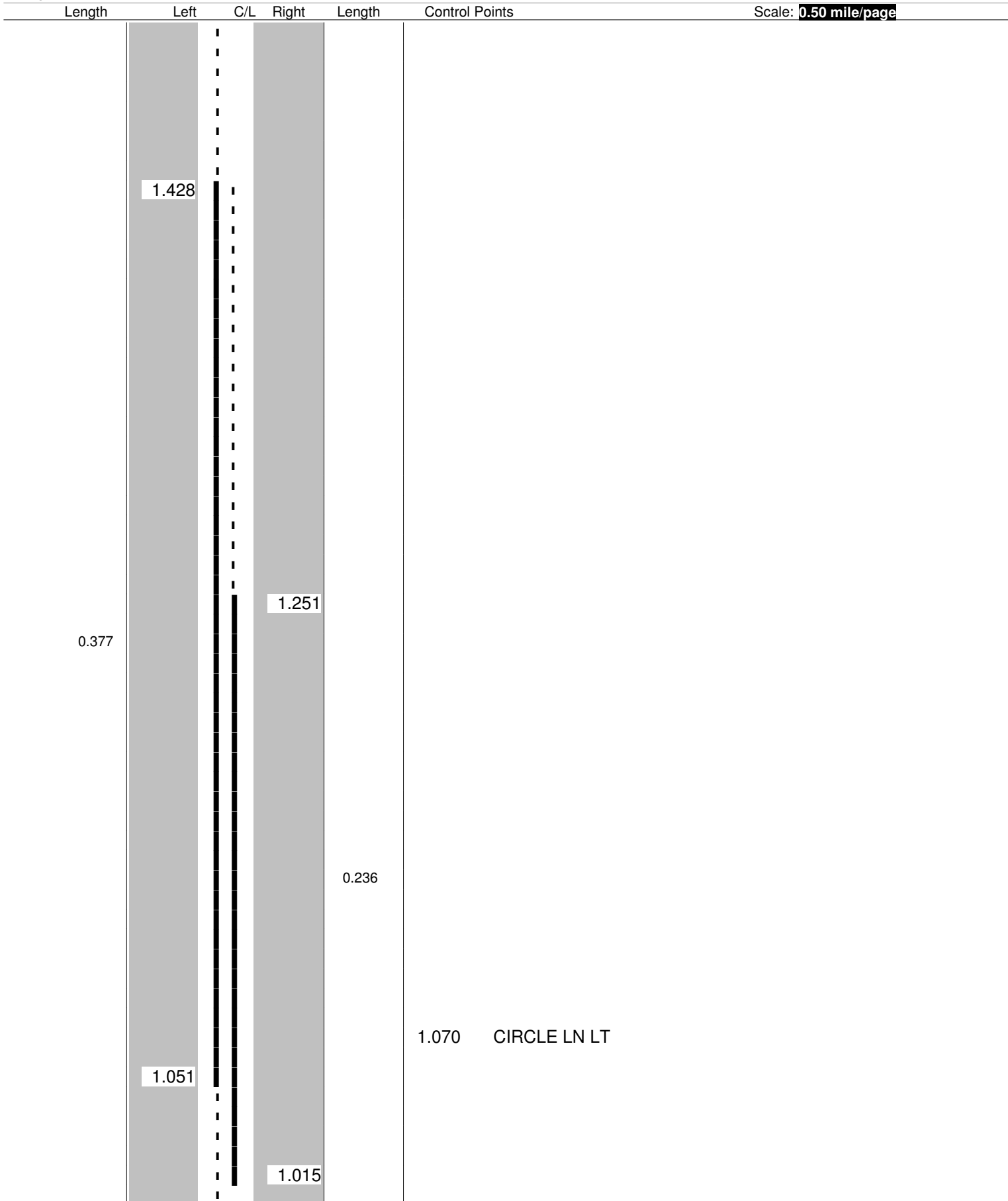

Sheet total equivalent length of solid line: 0.688

Accum. total: 1.140

ODOT District 10 - Athens County - 6/7/12
No Passing Zone Log (ATH)

Route: **0682R**
 Length: **7.750**

Direction: **North**

From: **0.000 US 33**
 To: **7.750 S0013**

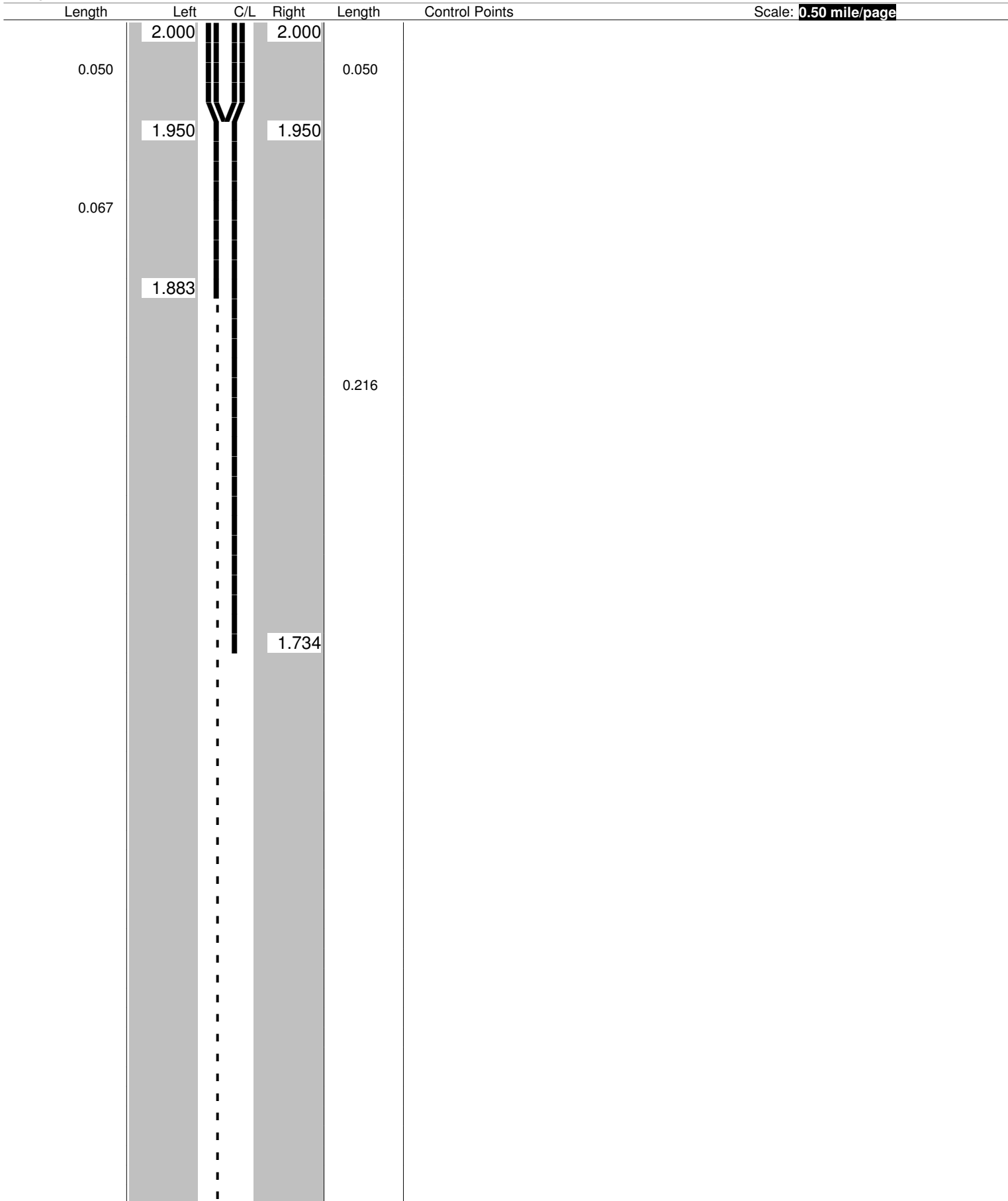

Scale: **0.50 mile/page**

ODOT District 10 - Athens County - 6/7/12
 No Passing Zone Log (ATH)

Route: **0682R**
 Length: **7.750**

Direction: **North**

From: **0.000 US 33**
 To: **7.750 S0013**

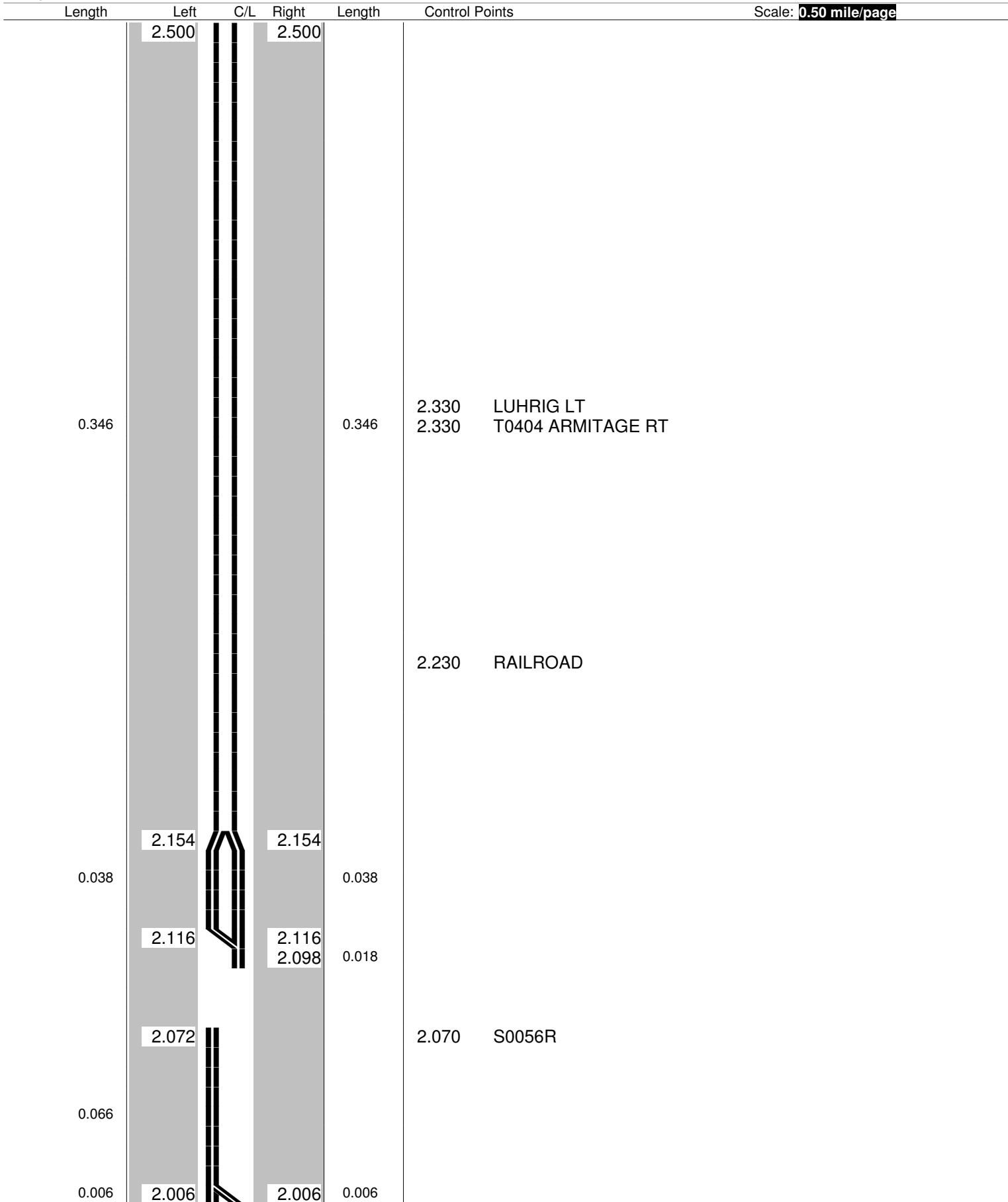

Sheet total equivalent length of solid line: 1.036

Accum. total: 2.813

ODOT District 10 - Athens County - 6/7/12
No Passing Zone Log (ATH)

Route: **0682R**
 Length: **7.750**

Direction: **North**

From: **0.000 US 33**
 To: **7.750 S0013**

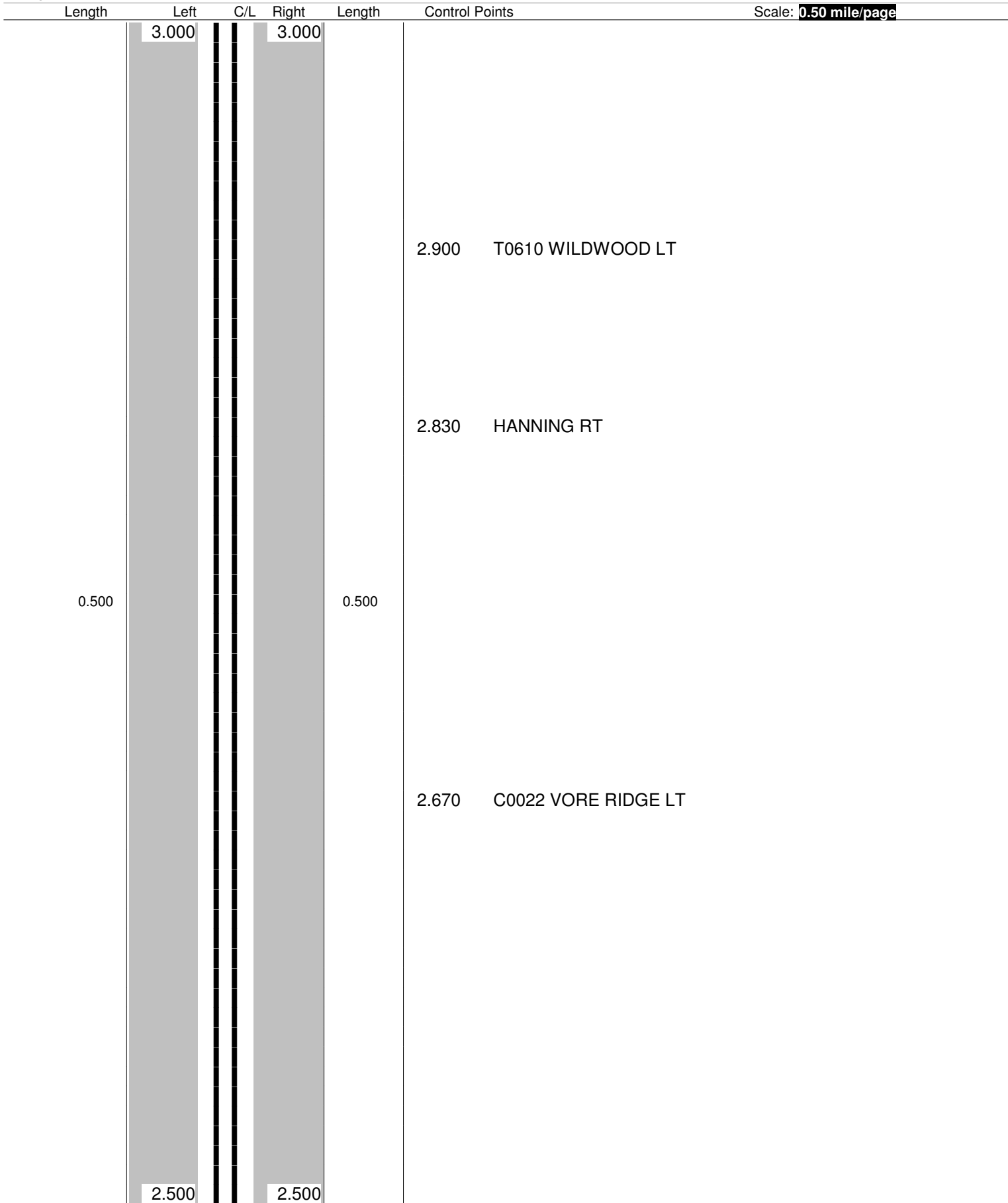

Sheet total equivalent length of solid line: 1.000

Accum. total: 3.813

ODOT District 10 - Athens County - 6/7/12
No Passing Zone Log (ATH)

Route: **0682R**
 Length: **7.750**

Direction: **North**

From: **0.000 US 33**
 To: **7.750 S0013**

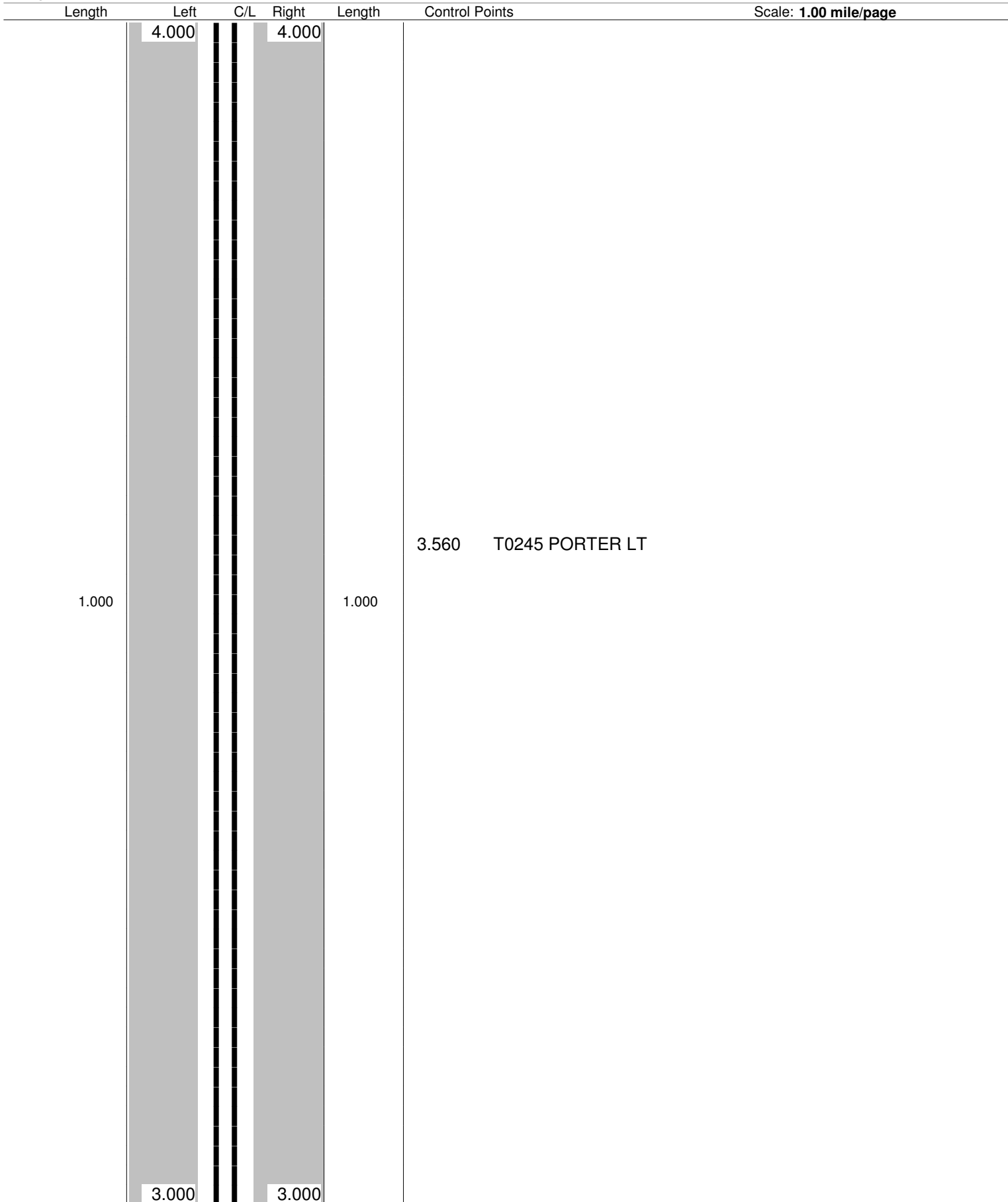

Sheet total equivalent length of solid line: 2.000

Accum. total: 5.813

ODOT District 10 - Athens County - 6/7/12
No Passing Zone Log (ATH)

Route: **0682R**
 Length: **7.750**

Direction: **North**

From: **0.000 US 33**
 To: **7.750 S0013**

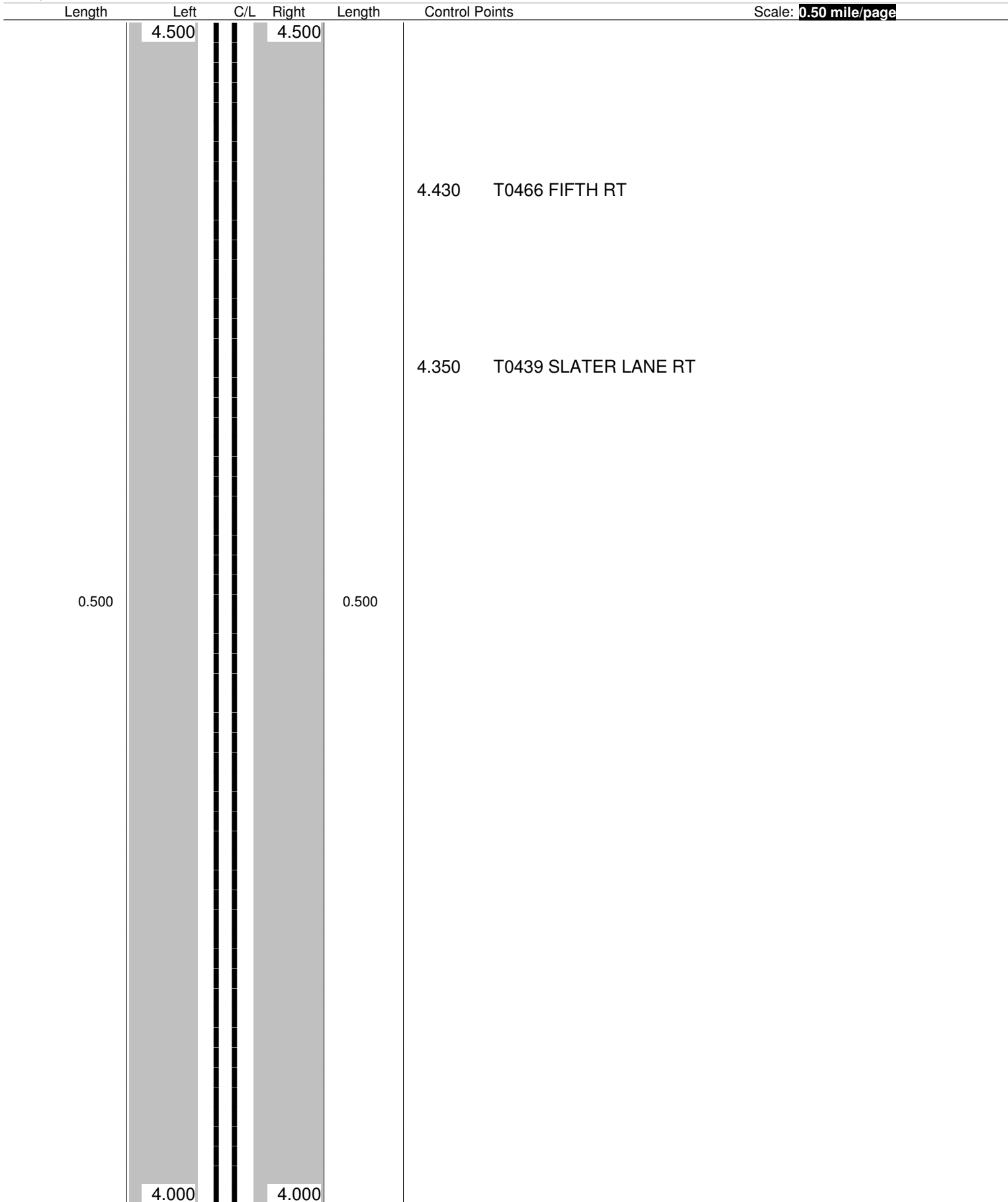

ODOT District 10 - Athens County - 6/7/12
No Passing Zone Log (ATH)

Route: **0682R**
 Length: **7.750**

Direction: **North**

From: **0.000 US 33**
 To: **7.750 S0013**

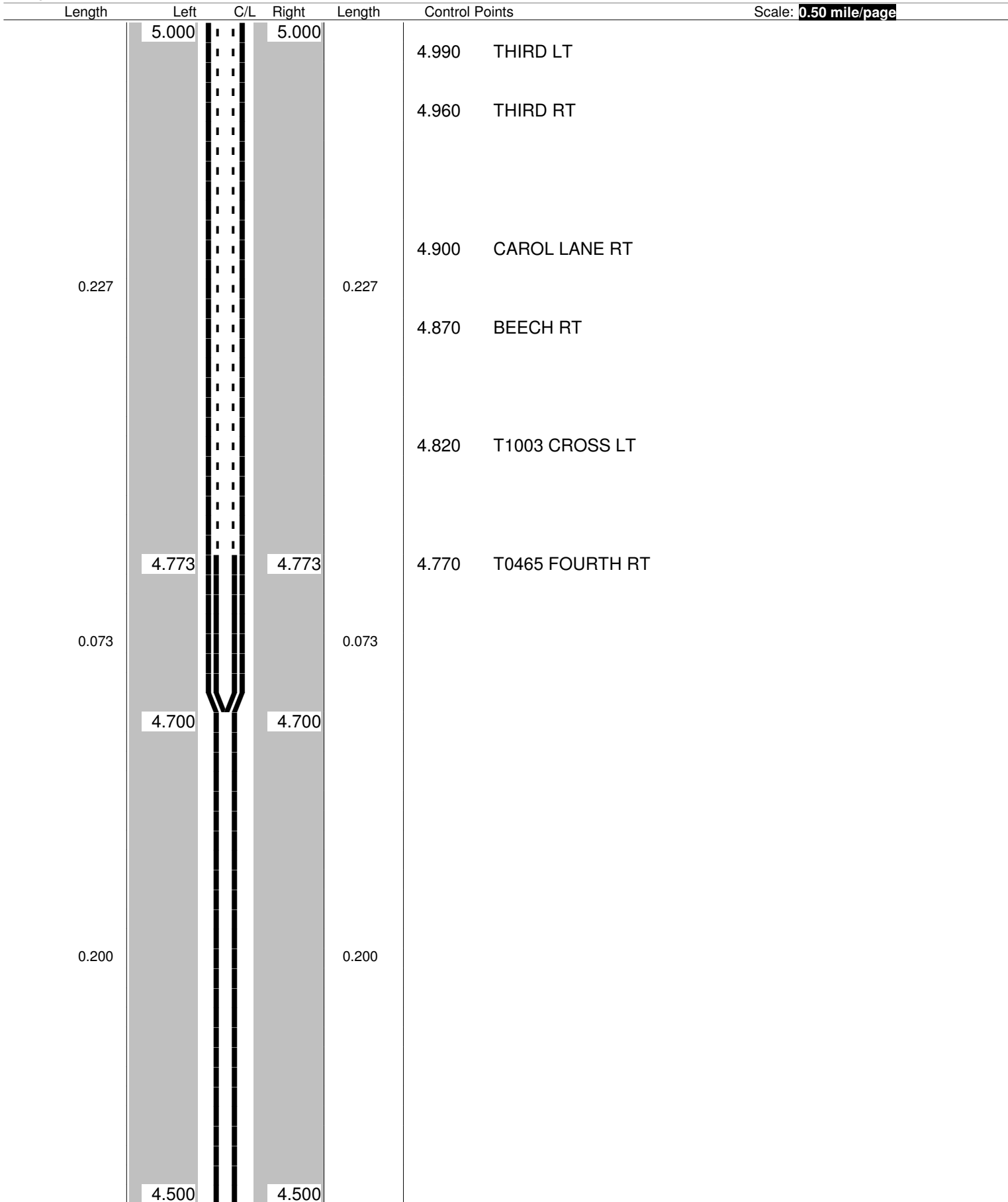

Sheet total equivalent length of solid line: 1.260

Accum. total: 8.073

ODOT District 10 - Athens County - 6/7/12

No Passing Zone Log (ATH)

Route: **0682R**
 Length: **7.750**

Direction: **North**

From: **0.000 US 33**
 To: **7.750 S0013**

Length	Left	C/L	Right	Length	Control Points	Scale: 0.50 mile/page
	5.500		5.500			
0.278				0.278	5.460 ELM RT	
					5.390 MAIN LT	
					5.340 CAMPBELL LT	
					5.330 OAK RT	
0.009	5.222 5.213		5.222 5.213	0.009		
			5.189	0.024		
0.032	5.165				5.170 T0256 CONNETT LT	
					5.170 C0007 JOHNSON RT	
0.022	5.133		5.133	0.022		
	5.111		5.111		5.110 FIRST LT	
					5.100 FIRST RT	
0.111				0.111	5.050 SECOND LT	
					5.030 SECOND RT	
	5.000		5.000			

ODOT District 10 - Athens County - 6/7/12

No Passing Zone Log (ATH)

Route: **0682R**
 Length: **7.750**

Direction: **North**

From: **0.000 US 33**
 To: **7.750 S0013**

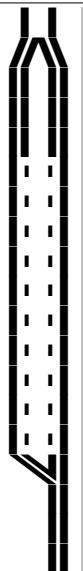
Length	Left	C/L	Right	Length	Control Points	Scale: 0.50 mile/page
0.014	6.000 5.986		6.000 5.986	0.014		
0.033	5.953		5.953	0.033		
0.087	5.866		5.866	0.087		
			5.834	0.032	5.890 T1014 RALLEN RT 5.870 T0661 MOUND LT	
0.025	5.813			0.025	5.820 C0110 POSTON STATION LT 5.800 T1021 WALNUT RT	
0.008	5.788 5.780		5.788 5.780	0.008	5.760 HARTMAN LT	
0.280	5.500		5.500	0.280	5.620 PINE RT	

ODOT District 10 - Athens County - 6/7/12
No Passing Zone Log (ATH)

Route: **0682R**
 Length: **7.750**

Direction: **North**

From: **0.000 US 33**
 To: **7.750 S0013**

Length	Left	C/L	Right	Length	Control Points	Scale: 1.00 mile/page
	7.000		7.000			
					6.810	OLD US 33 LT
					6.570	T0246 LEMASTER LT
					6.570	T0251 RIVER RT
1.000				1.000		
					6.190	33 RAMP LT
					6.190	T0662 WHISPERING PINES RT
					6.180	US 33 RAMP RT
					6.040	US 33 RAMP LT
					6.020	US 33 RAMP RT
					6.020	T1220 SUNSET LT
	6.000		6.000			

