

ODOT Dist 8 - BUT Co - FINAL
No Passing Zone Log (BUT)

Route: **0732R**
 Length: **13.750**

Direction: **North**

From: **0.000 S0129R**
 To: **13.750 ENTER PRE CO**

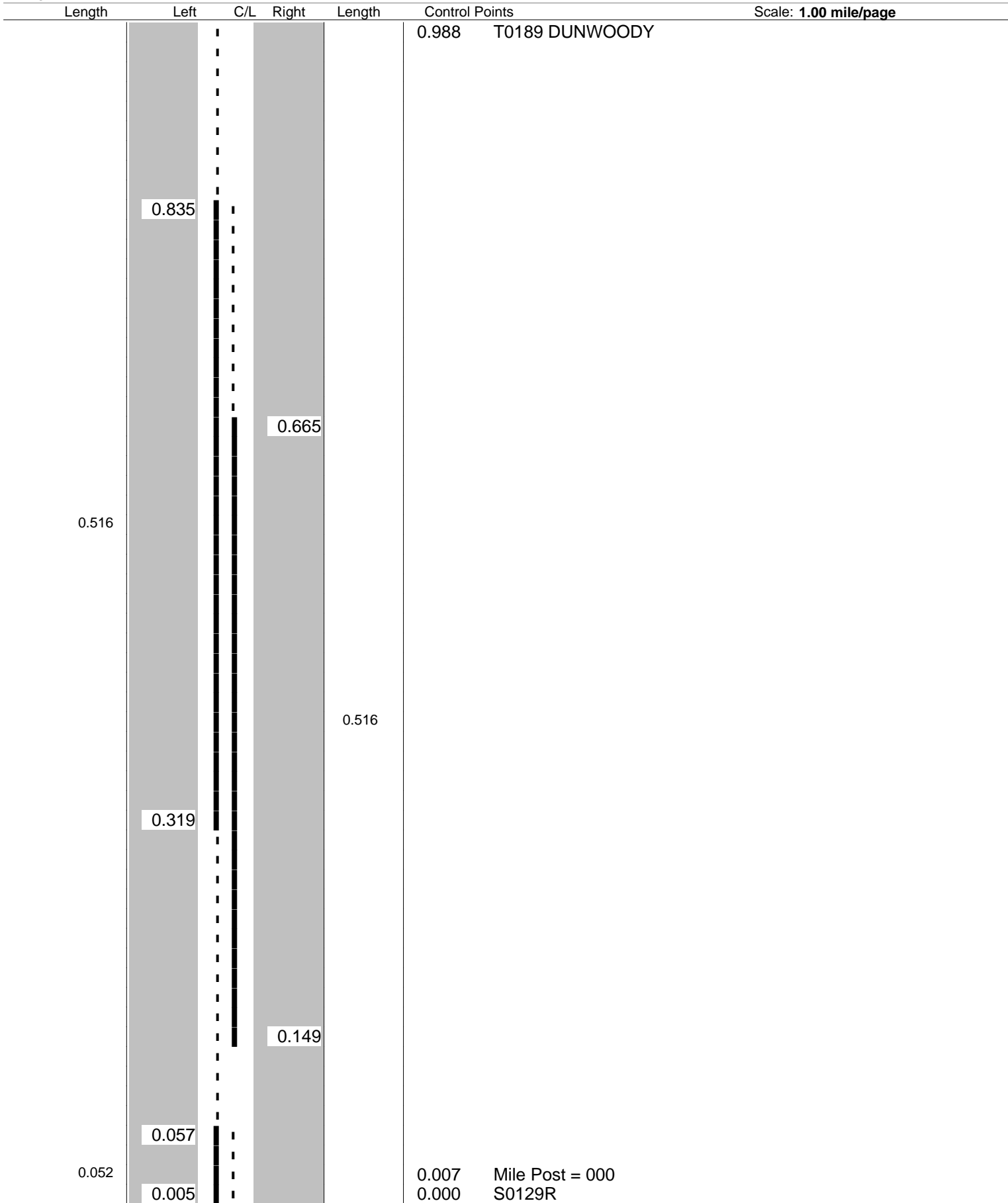

Sheet total equivalent length of solid line: 1.248

Accum. total: 1.248

ODOT Dist 8 - BUT Co - FINAL
No Passing Zone Log (BUT)

Route: **0732R**
 Length: **13.750**

Direction: **North**

From: **0.000 S0129R**
 To: **13.750 ENTER PRE CO**

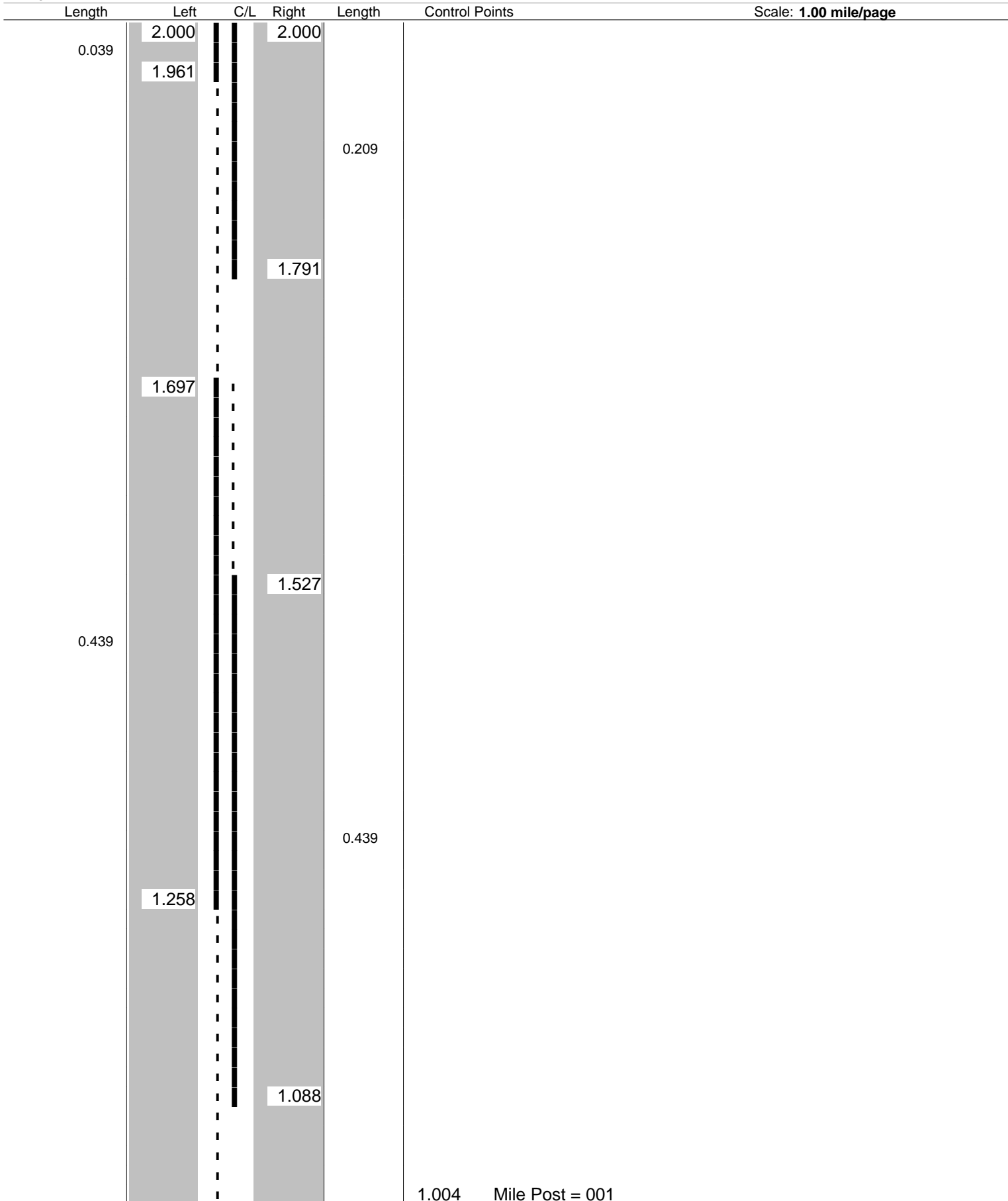

Sheet total equivalent length of solid line: 1.299

Accum. total: 2.547

ODOT Dist 8 - BUT Co - FINAL
No Passing Zone Log (BUT)

Route: **0732R**
 Length: **13.750**

Direction: **North**

From: **0.000 S0129R**
 To: **13.750 ENTER PRE CO**

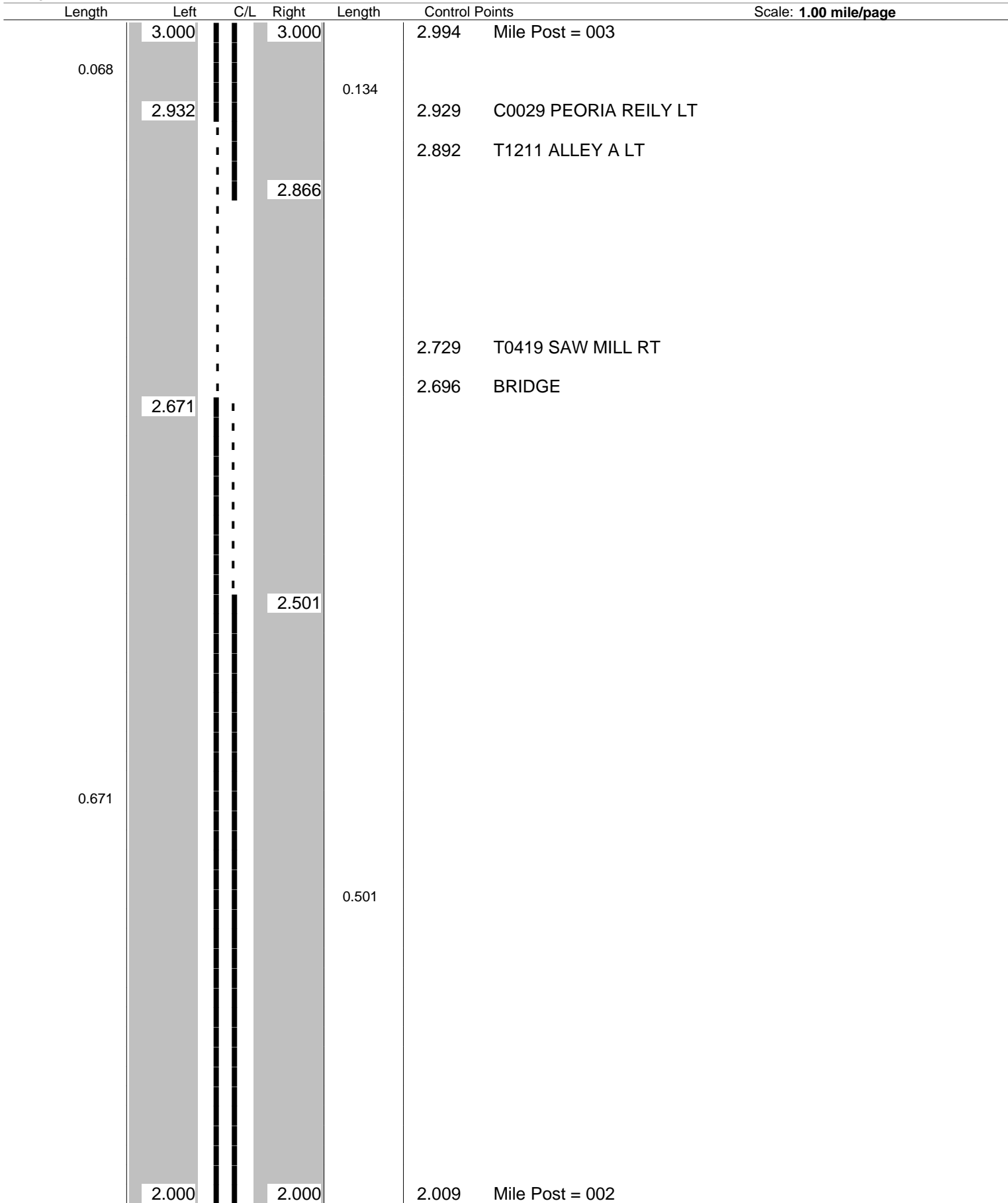

Sheet total equivalent length of solid line: 1.482

Accum. total: 4.029

ODOT Dist 8 - BUT Co - FINAL
No Passing Zone Log (BUT)

Route: **0732R**
 Length: **13.750**

Direction: **North**

From: **0.000 S0129R**
 To: **13.750 ENTER PRE CO**

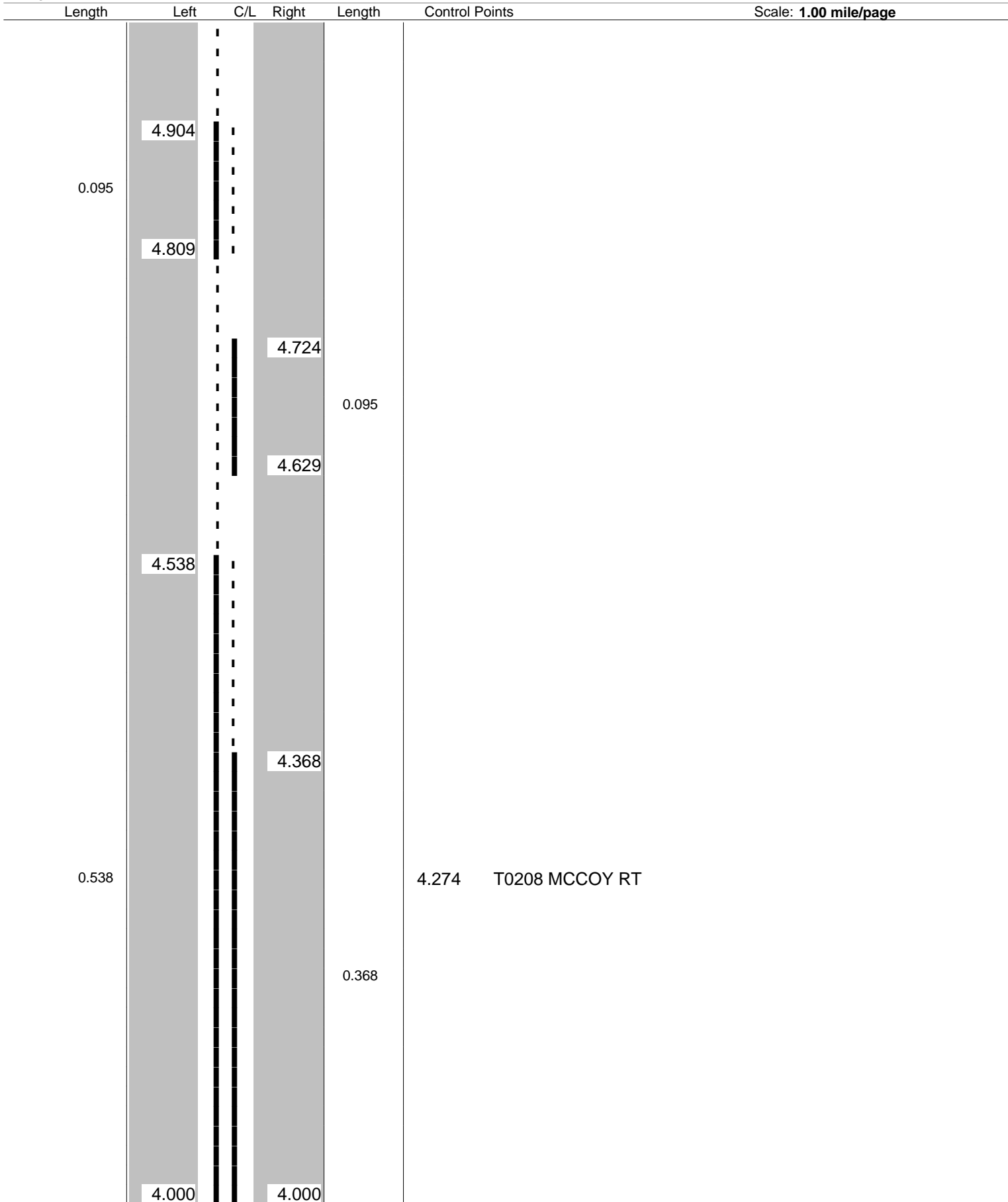

ODOT Dist 8 - BUT Co - FINAL
No Passing Zone Log (BUT)

Route: **0732R**
 Length: **13.750**

Direction: **North**

From: **0.000 S0129R**
 To: **13.750 ENTER PRE CO**

Length	Left	C/L	Right	Length	Control Points	Scale: 1.00 mile/page
	7.000		7.000			
0.107	6.860				6.821 ENTER OXFORD	
	6.753					
			6.696	0.113		
			6.583			
0.143	6.493					
	6.350				6.341 C0038 STILLWELL BECKETT	
			6.323	0.143		
			6.180			
					6.024 Mile Post = 006	

ODOT Dist 8 - BUT Co - FINAL
No Passing Zone Log (BUT)

Route: **0732R**
 Length: **13.750**

Direction: **North**

From: **0.000 S0129R**
 To: **13.750 ENTER PRE CO**

Length	Left	C/L	Right	Length	Control Points	Scale: 1.00 mile/page
	10.000		10.000		9.981 KELLY LT	
					9.978 Mile Post = 010	
0.150				0.150		
	9.850		9.850		9.850 LEAVE OXFORD	

ODOT Dist 8 - BUT Co - FINAL
No Passing Zone Log (BUT)

Route: **0732R**
 Length: **13.750**

Direction: **North**

From: **0.000 S0129R**
 To: **13.750 ENTER PRE CO**

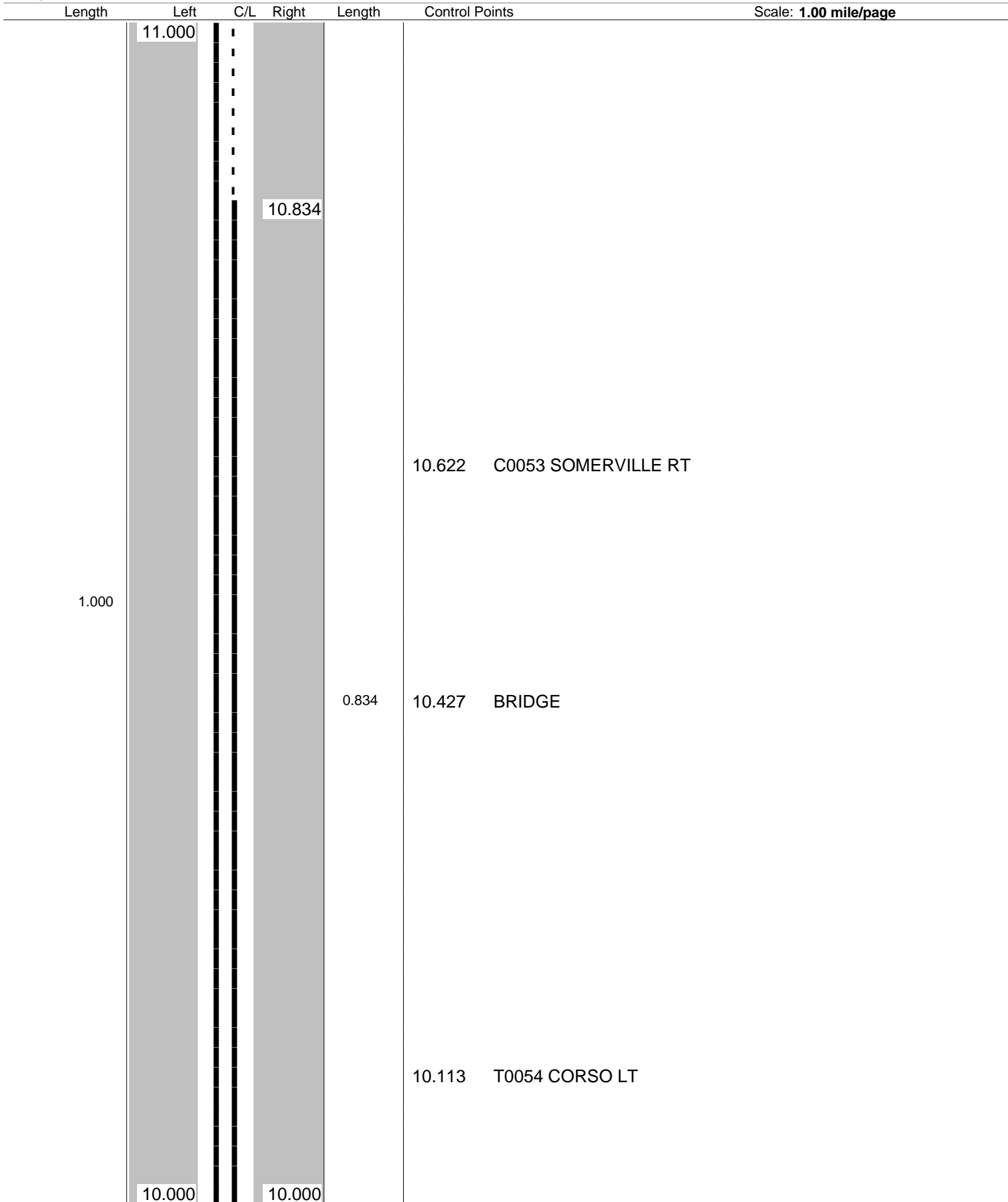

ODOT Dist 8 - BUT Co - FINAL
No Passing Zone Log (BUT)

Route: **0732R**
 Length: **13.750**

Direction: **North**

From: **0.000 S0129R**
 To: **13.750 ENTER PRE CO**

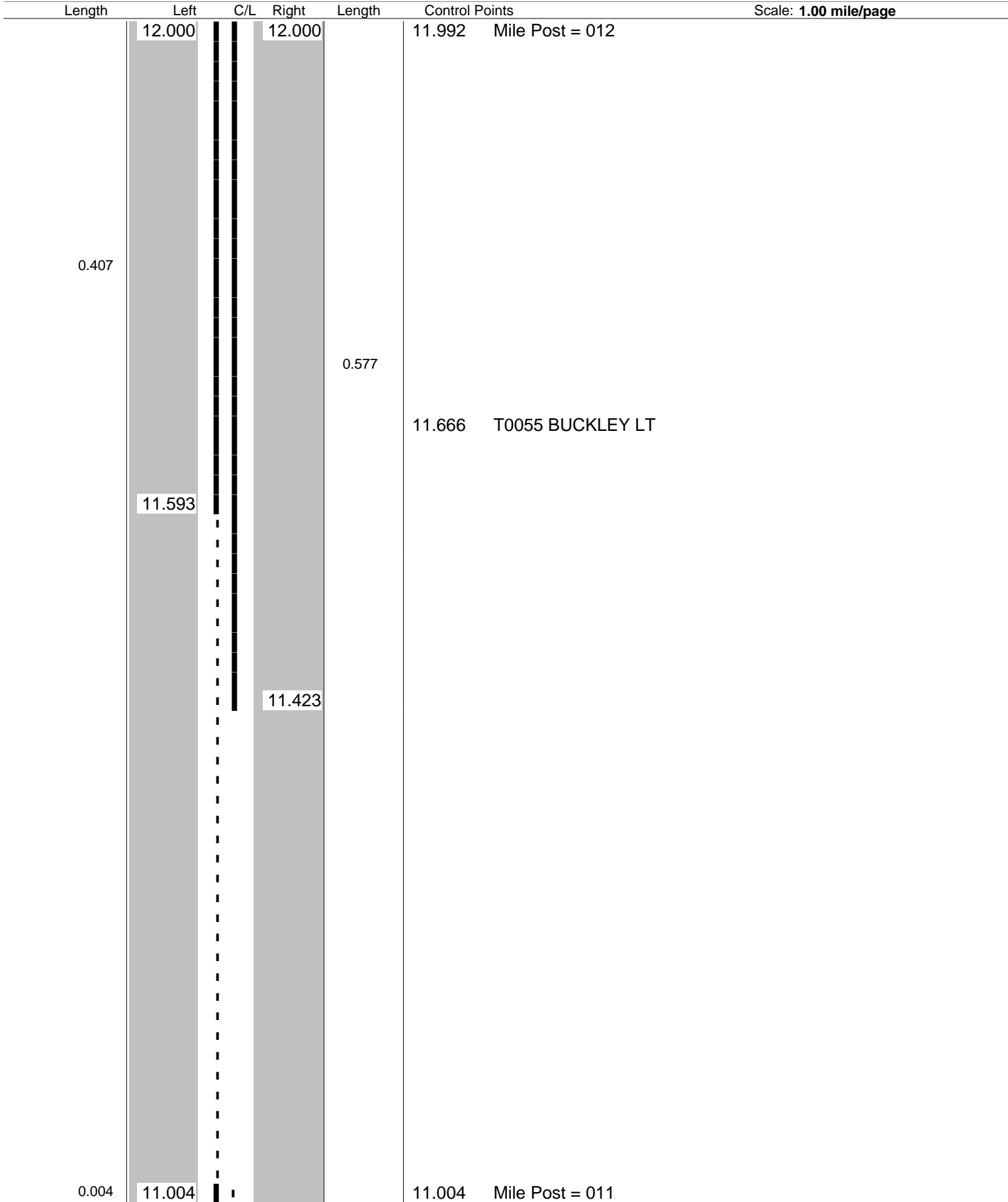

Sheet total equivalent length of solid line: 1.136

Accum. total: 11.790

ODOT Dist 8 - BUT Co - FINAL
No Passing Zone Log (BUT)

Route: **0732R**
 Length: **13.750**

Direction: **North**

From: **0.000 S0129R**
 To: **13.750 ENTER PRE CO**

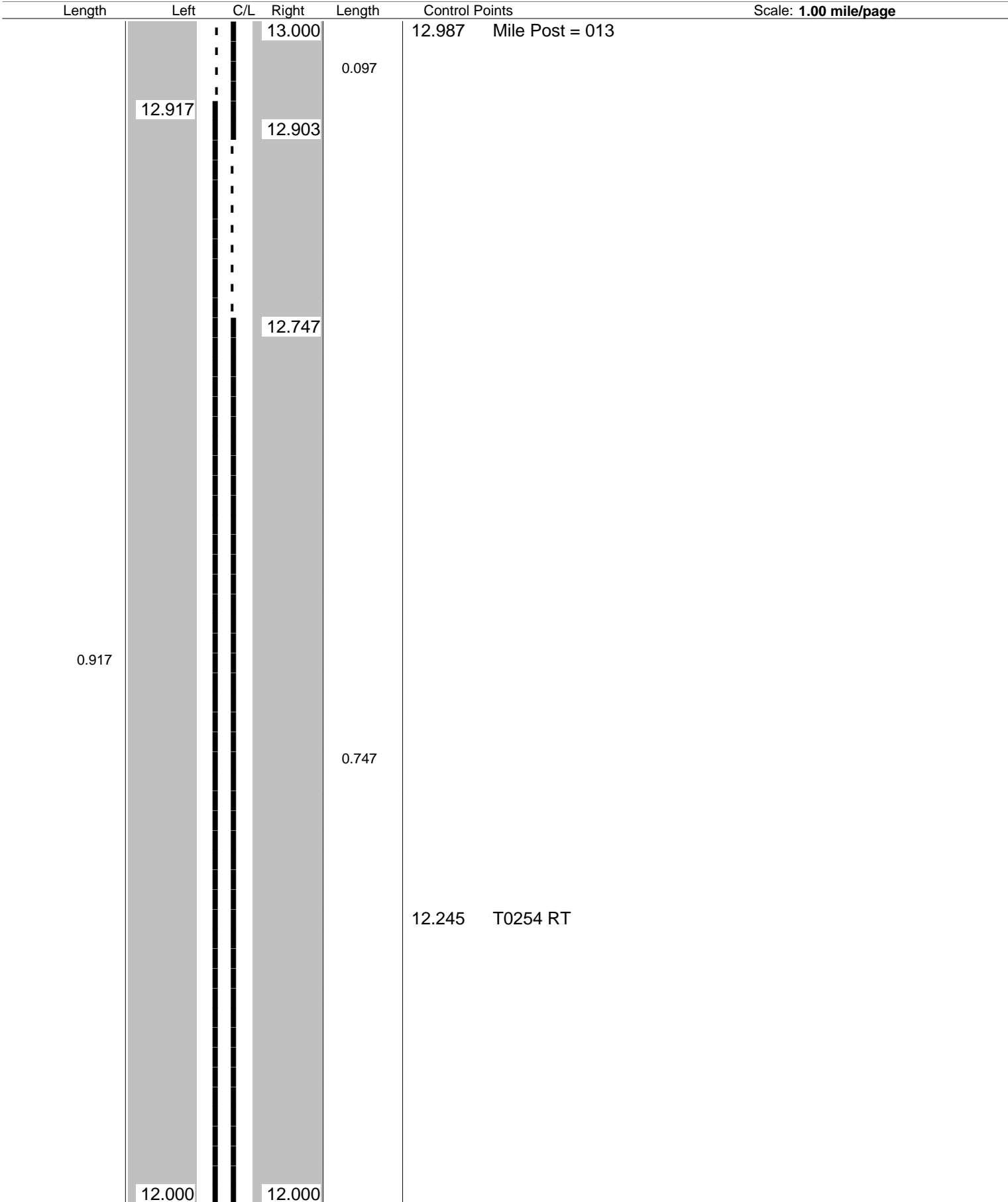

ODOT Dist 8 - BUT Co - FINAL
No Passing Zone Log (BUT)

Route: **0732R**
 Length: **13.750**

Direction: **North**

From: **0.000 S0129R**
 To: **13.750 ENTER PRE CO**

