

ODOT Dist 4 - Mahoning County - FINAL
No Passing Zone Log (MAH)

Route: **0625R (SMAHSR00625**C)**
 Length: **3.045** Direction: **North**

From: **0.000 U0224R**
 To: **3.045 ENTER YOUNGSTOWN**

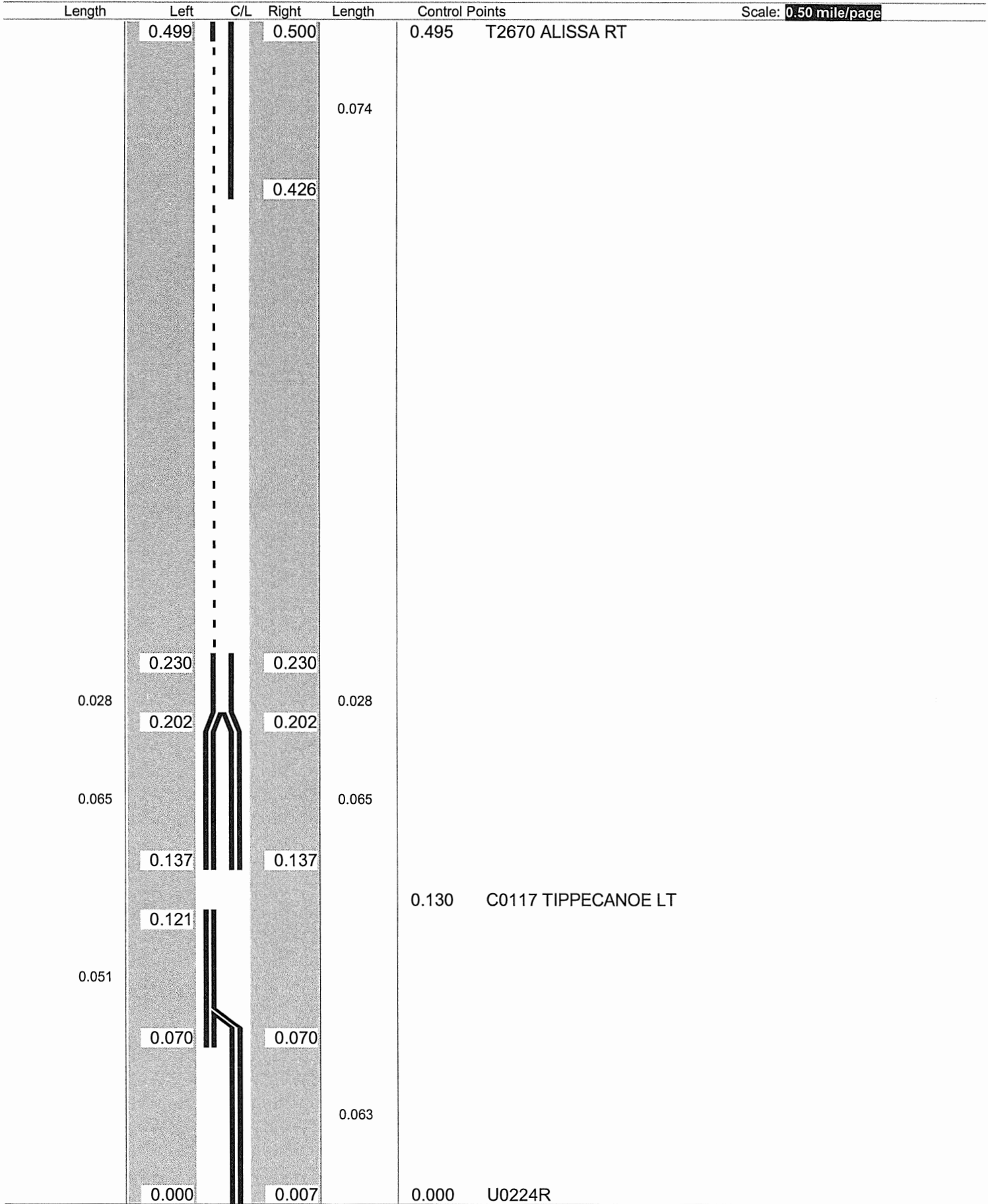

ODOT Dist 4 - Mahoning County - FINAL

No Passing Zone Log (MAH)

Route: **0625R (SMAHSR00625**C)**

From: **0.000 U0224R**

Length: **3.045** Direction: **North**

To: **3.045 ENTER YOUNGSTOWN**

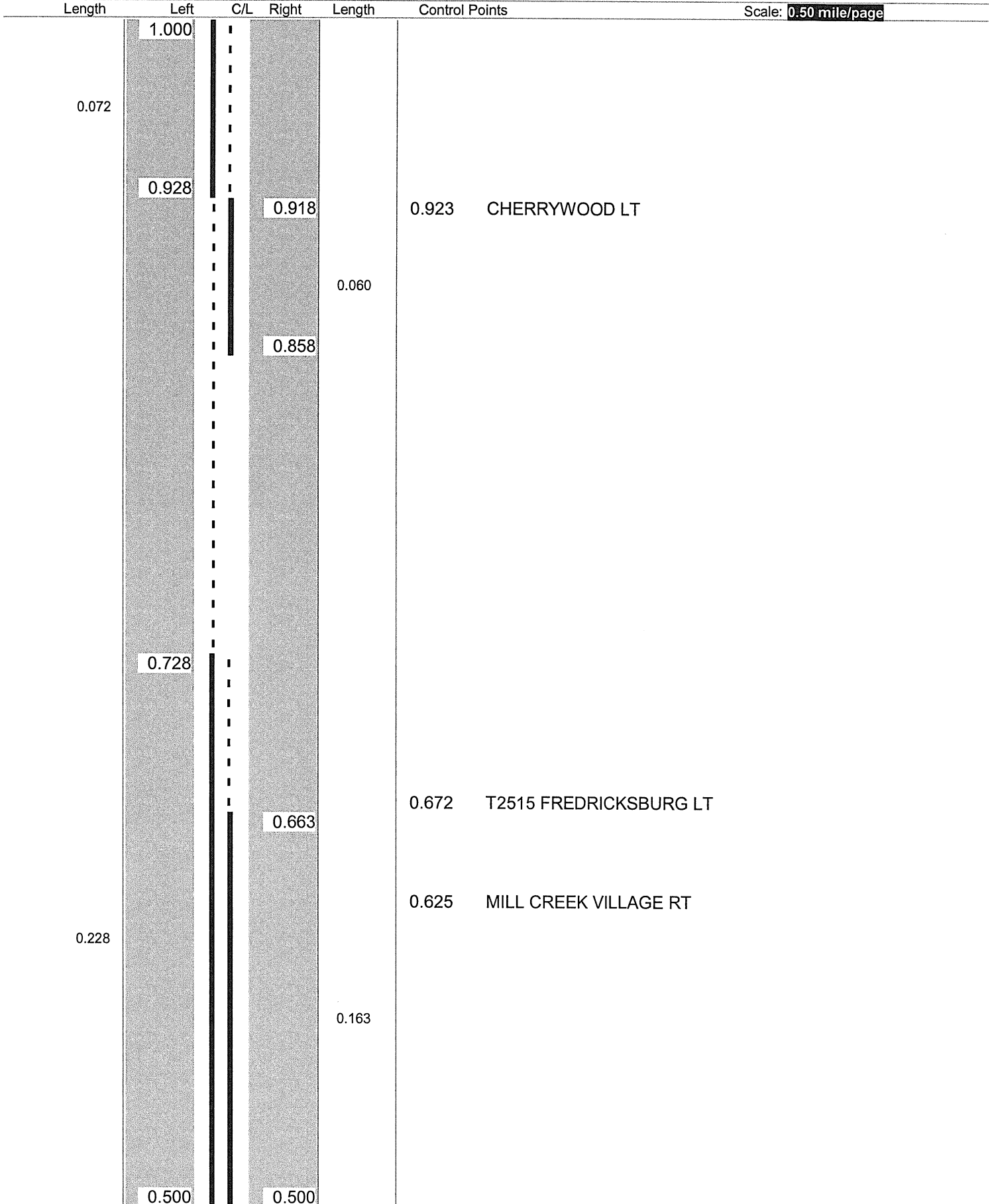

Sheet total equivalent length of solid line: 0.642

Accum. total: 1.330

**ODOT District 4
No Passing Zone Log (MAH)**

Route: **0625R (SMAHSR00625**C)**
 Length: **0.999** Direction: **North**

From: **1.000 U0224R**
 To: **1.999 ENTER YOUNGSTOWN**

Length	Left	C/L	Right	Length	Control Points	Scale: 1.00 mile/page
					1.965 Mile Post = 002	
	1.915					
0.223					1.788	↑ 45mph
			1.754			
	1.692		1.692	0.062		
	1.664		1.664		1.677 C0100 SHIELDS	
0.165				0.228		
	1.499				1.495 T2577 VALLEYVIEW LT	
			1.436			
	1.358					
0.140						
	1.218		1.226		1.232 T2575 SHADELAND LT	
				0.178		
			1.048			
0.005	1.005					

ODOT Dist 4 - Mahoning County - FINAL
No Passing Zone Log (MAH)

Route: **0625R (SMAHSR00625**C)**

From: **0.000 U0224R**

Length: **3.045** Direction: **North**

To: **3.045 ENTER YOUNGSTOWN**

Length	Left	C/L	Right	Length	Control Points	Scale: 1.00 mile/page
			3.000		2.981 Mile Post = 003	
				0.141		
			2.859			
	2.763					
			2.693		2.698 T1612 RIVERSIDE	
0.340					2.593 C0267 LOCKWOOD RT	
				0.354	2.519 T2059 LAKESHORE RT	
	2.423				2.419 T2060 MILLTRACE	
			2.339			
	2.165					
0.058	2.107					
			2.086		2.096 C0200 TRUESDALE	
			2.019	0.067		

ODOT Dist 4 - Mahoning County - FINAL
No Passing Zone Log (MAH)

Route: 0625R (SMAHSR00625**C)

From: 0.000 U0224R

Length: 3.045

Direction: North

To: 3.045 ENTER YOUNGSTOWN

Length Left C/L Right Length Control Points Scale: 1.00 mile/page

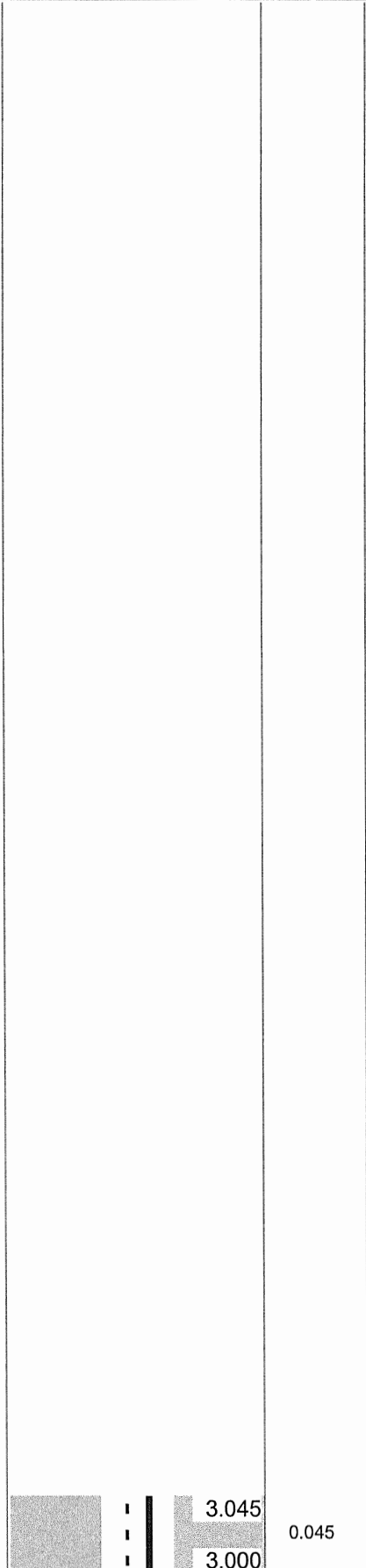

3.045 ENTER YOUNGSTOWN
 3.045 MIDLOTHIAN

0.045