

ODOT Dist 4 - Stark County - FINAL

No Passing Zone Log (STA)

Route: **0043R (SSTASR00043**C)**
 Length: **27.176** Direction: **North**

From: **0.000 LEAVE CAR CO**
 To: **27.176 ENTER POR CO**

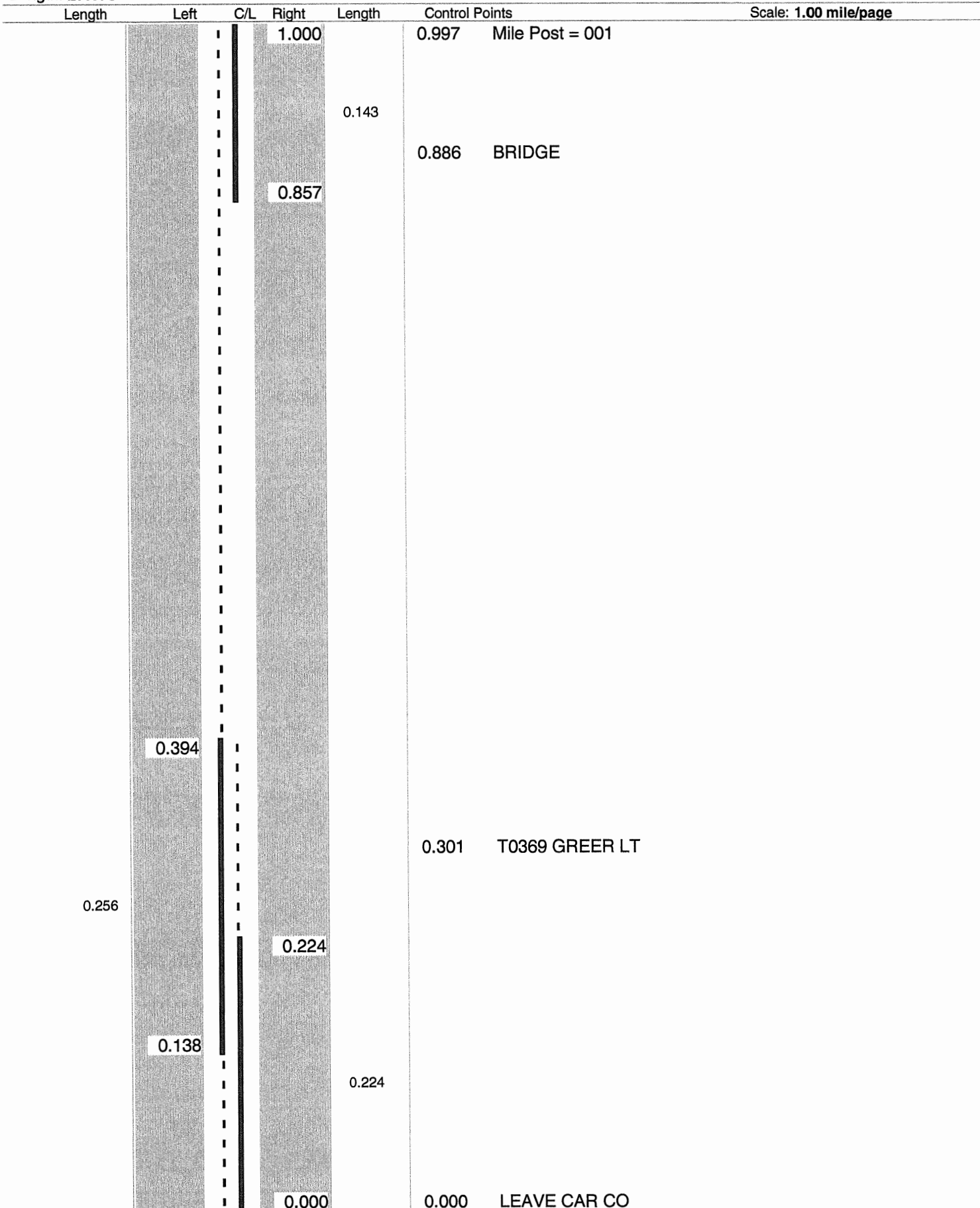

ODOT Dist 4 - Stark County - FINAL
No Passing Zone Log (STA)

Route: **0043R (SSTASR00043**C)**

Length: **27.176**

Direction: **North**

From: **0.000 LEAVE CAR CO**

To: **27.176 ENTER POR CO**

Length	Left	C/L	Right	Length	Control Points	Scale: 1.00 mile/page
	2.000		2.000			
0.290					1.927 T0153 ELSON	
				0.360	1.846 T1971 HALTON RT	
					1.780 T1972 WELKER RT	
	1.710				1.707 T1973 ELAND RT	
			1.640			
					1.574	↑ 40mph
	1.532					
			1.381		1.399 T0163 WYANDOT LT	
0.390					1.389 S0044R RT	
					1.330 S0044R RT	
				0.239		
					1.209 T0163A GOODLAND LT	
	1.142		1.142			
	1.132		1.132		1.137 S0183R LT	
0.105						
				0.132		
	1.027					
			1.000			

Sheet total equivalent length of solid line: 1.605

Accum. total: 2.457

ODOT Dist 4 - Stark County - FINAL
No Passing Zone Log (STA)

Route: **0043R (SSTASR00043**C)**

From: **0.000 LEAVE CAR CO**

Length: **27.176** Direction: **North**

To: **27.176 ENTER POR CO**

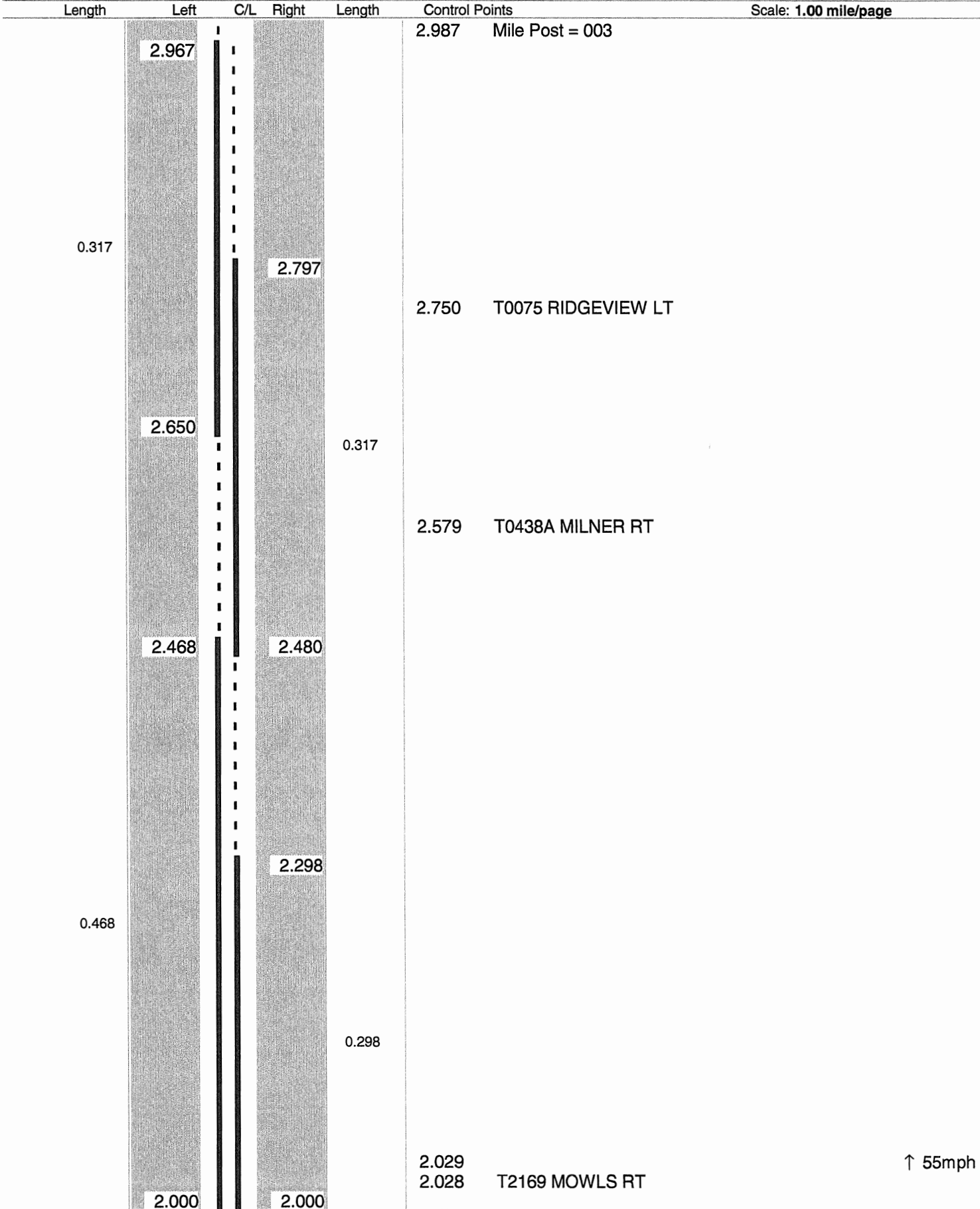

Sheet total equivalent length of solid line: 1.539

Accum. total: 3.996

ODOT Dist 4 - Stark County - FINAL
No Passing Zone Log (STA)

Route: **0043R (SSTASR00043**C)**
 Length: **27.176** Direction: **North**

From: **0.000 LEAVE CAR CO**
 To: **27.176 ENTER POR CO**

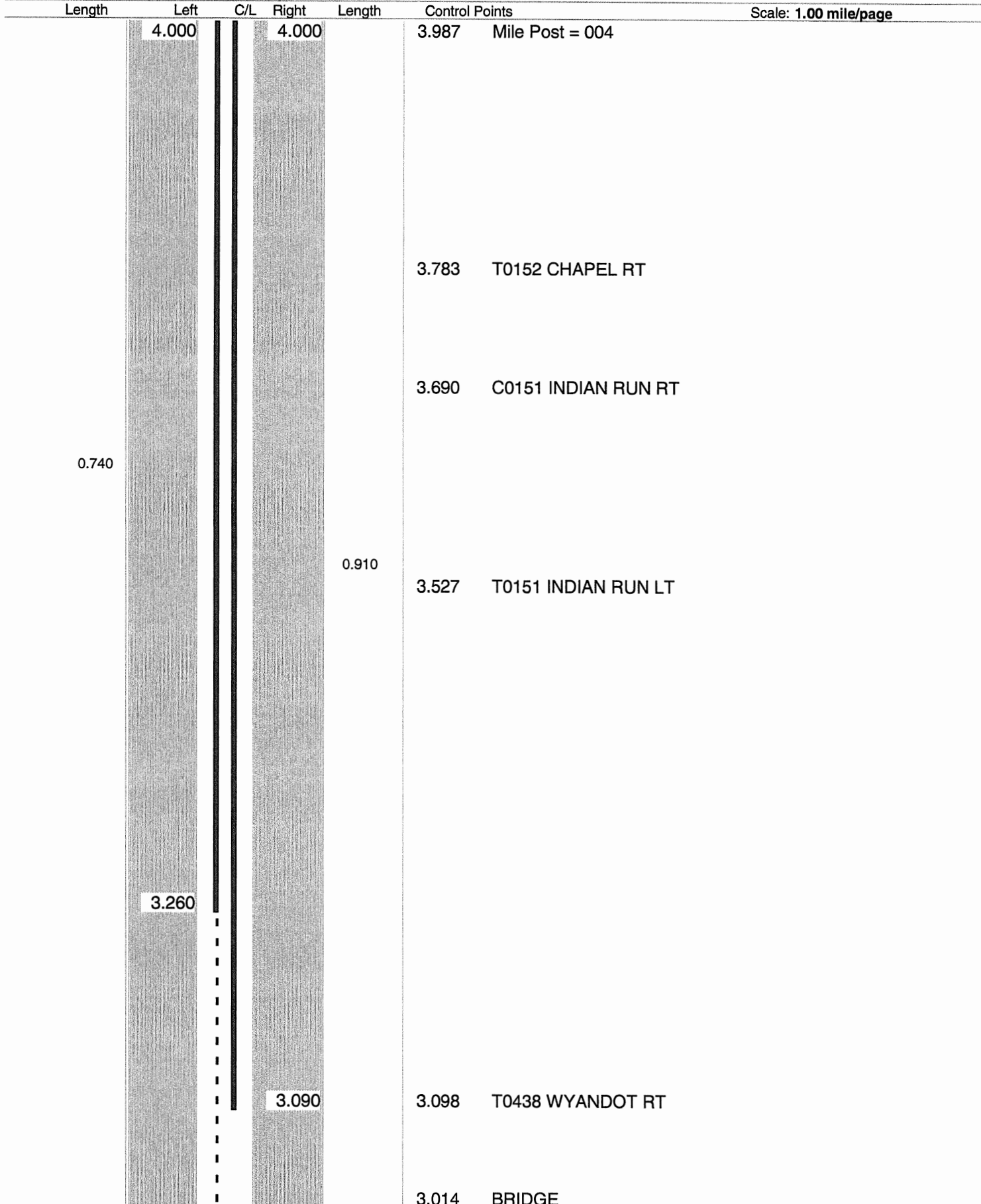

Sheet total equivalent length of solid line: 1.715

Accum. total: 5.711

ODOT Dist 4 - Stark County - FINAL
No Passing Zone Log (STA)

Route: **0043R (SSTASR00043**C)**
 Length: **27.176** Direction: **North**

From: **0.000 LEAVE CAR CO**
 To: **27.176 ENTER POR CO**

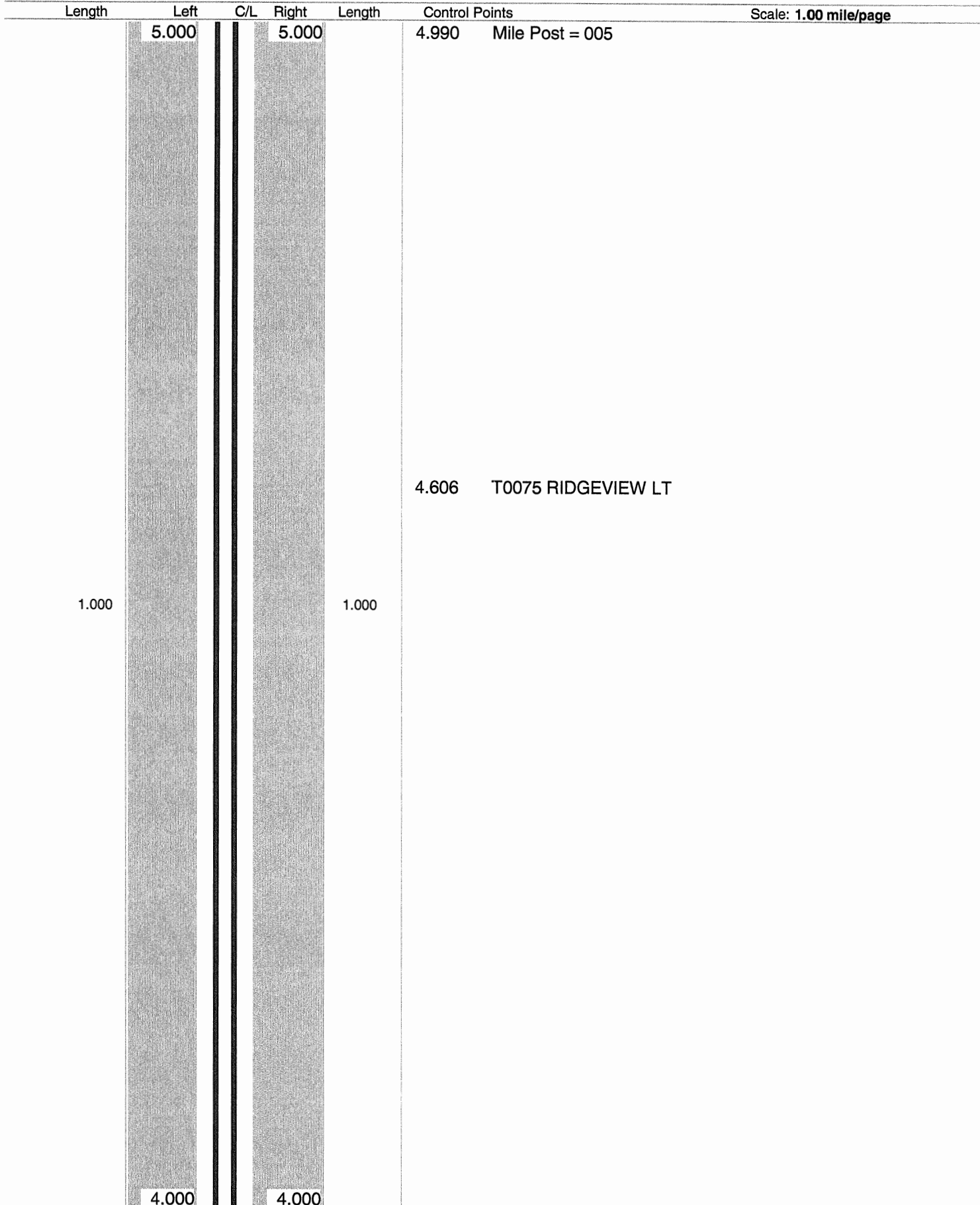

Sheet total equivalent length of solid line: 2.000

Accum. total: 7.711

ODOT Dist 4 - Stark County - FINAL
No Passing Zone Log (STA)

Route: **0043R (SSTASR00043**C)**
 Length: **27.176** Direction: **North**

From: **0.000 LEAVE CAR CO**
 To: **27.176 ENTER POR CO**

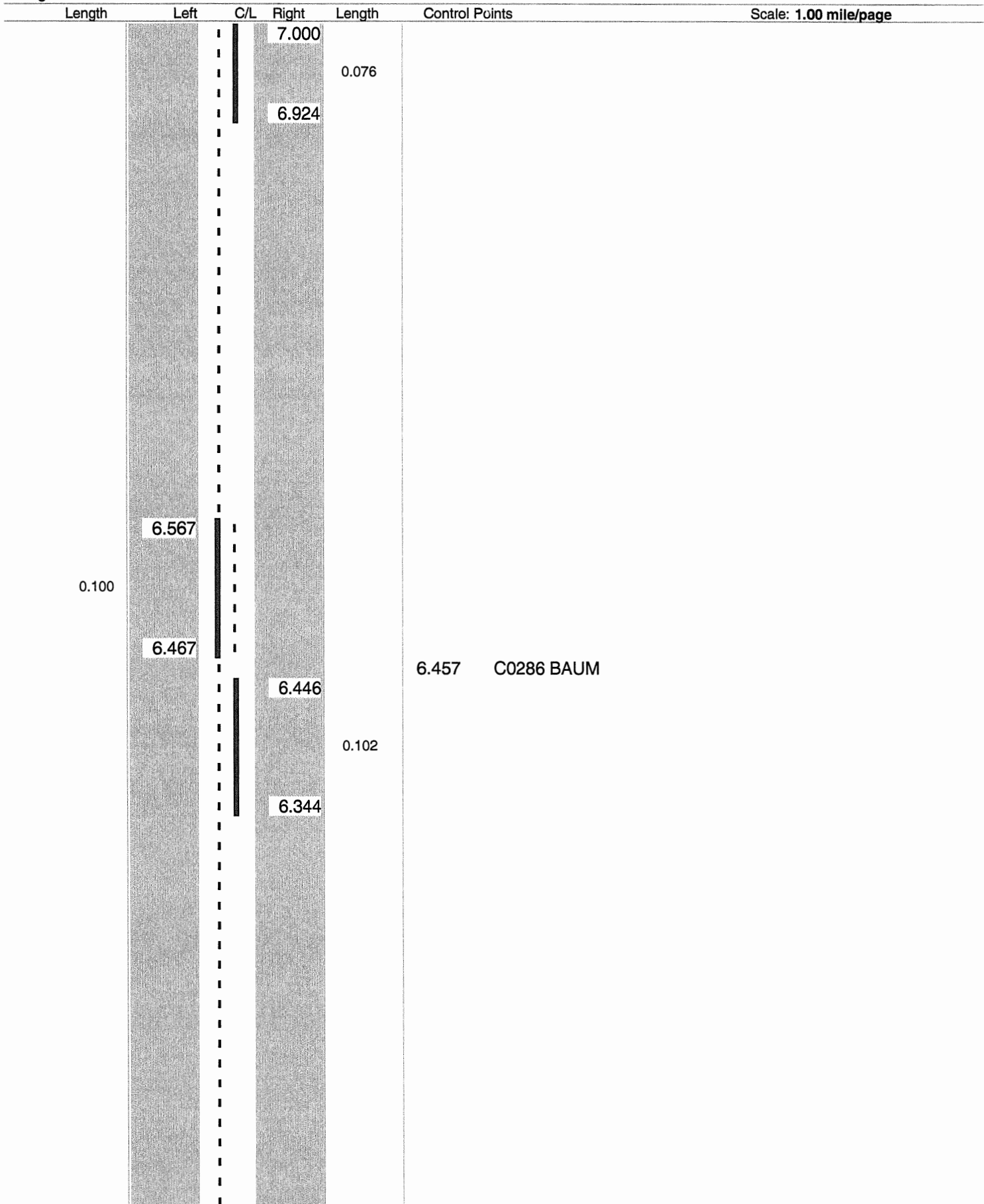

ODOT Dist 4 - Stark County - FINAL
No Passing Zone Log (STA)

Route: **0043R (SSTASR00043**C)**
 Length: **27.176** Direction: **North**

From: **0.000 LEAVE CAR CO**
 To: **27.176 ENTER POR CO**

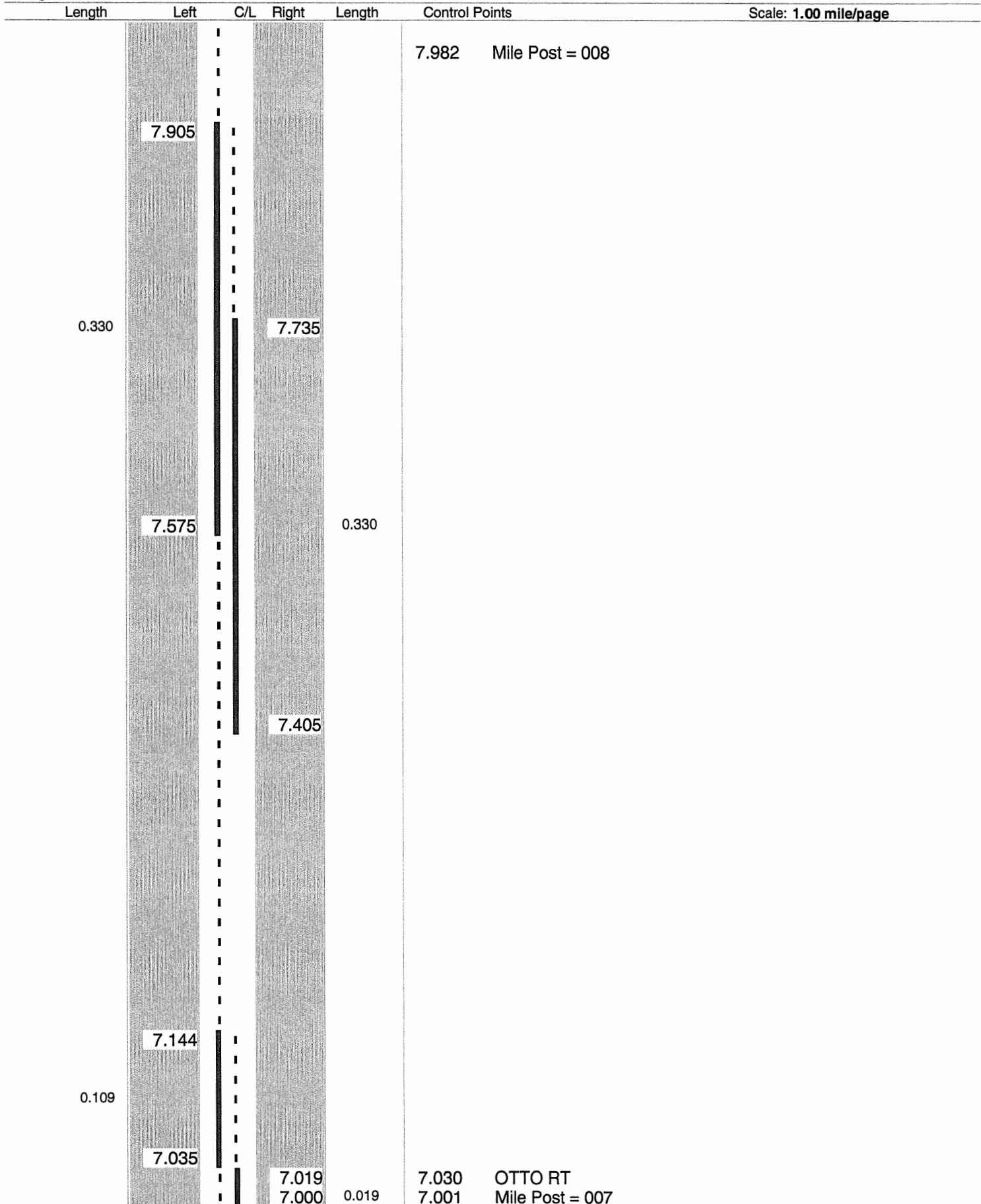

Sheet total equivalent length of solid line: 0.998

Accum. total: 10.166

ODOT Dist 4 - Stark County - FINAL
No Passing Zone Log (STA)

Route: **0043R (SSTASR00043**C)**
 Length: **27.176** Direction: **North**

From: **0.000 LEAVE CAR CO**
 To: **27.176 ENTER POR CO**

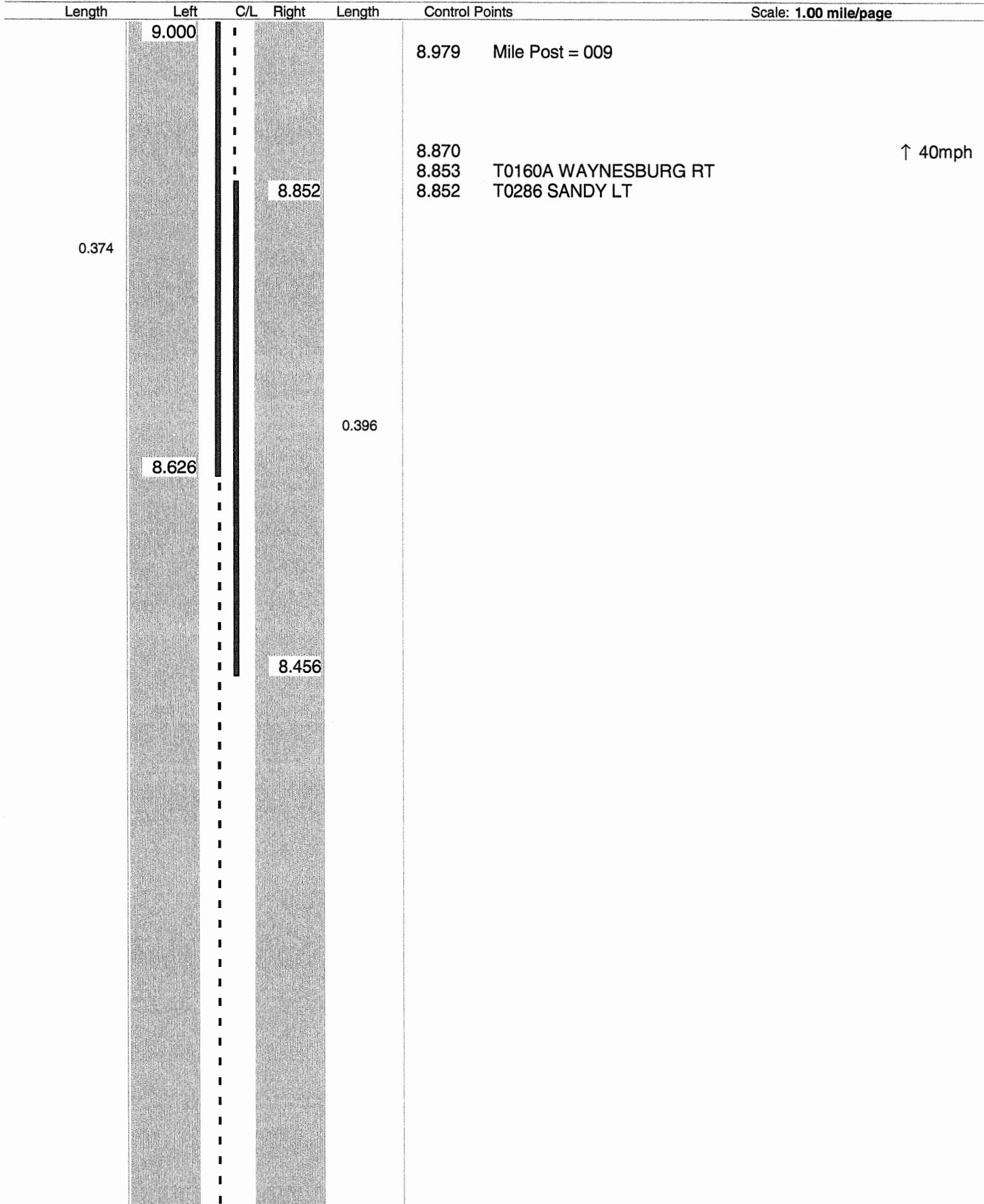

**ODOT District 4
No Passing Zone Log (STA)**

Route: 0043R (SSTASR00043**C)
Length: 0.999 Direction: North

From: 9.000 LEAVE CAR CO
To: 9.999 ENTER POR CO

Length	Left	C/L	Right	Length	Control Points	Scale: 1.00 mile/page
	9.999		9.999		9.998 Mile Post = 010 9.982 BRIDGE	
0.844					9.644 T0291 MILLERTON LT	
				0.911	9.543 T0295 SHERR LT 9.491 24TH RT	
					9.351 25TH	
					9.252 26TH	
	9.156		9.089		9.151 T0164 AMFORD RT	
0.022	9.022 9.000					

ODOT Dist 4 - Stark County - FINAL
No Passing Zone Log (STA)

Route: **0043R (SSTASR00043**C)**

From: **0.000 LEAVE CAR CO**

Length: **27.176** Direction: **North**

To: **27.176 ENTER POR CO**

Length	Left	C/L	Right	Length	Control Points	Scale: 0.50 mile/page
	10.500		10.500			
				10.456	T1009 BERDEL LT	
				10.412	T1009 BERDEL RT	
0.500				10.231	C0150 ORCHARD VIEW	
				10.151	18TH RT	
				10.093	19TH RT	
	10.000		10.000			

ODOT Dist 4 - Stark County - FINAL

No Passing Zone Log (STA)

Route: **0043R (SSTASR00043**C)**
 Length: **27.176** Direction: **North**

From: **0.000 LEAVE CAR CO**
 To: **27.176 ENTER POR CO**

Length	Left	C/L	Right	Length	Control Points	Scale: 0.50 mile/page
	11.000		11.000			
0.039	10.701		10.701	0.039	10.711 ENTER CANTON 10.711 U0030 RAMP LT	
	10.662		10.662	0.010	10.646 14TH RT	
0.134	10.634		10.634	0.134	10.532 RAILROAD	
	10.500		10.500			

ODOT Dist 4 - Stark County - FINAL
No Passing Zone Log (STA)

Route: **0043R (SSTASR00043**C)**
 Length: **27.176** Direction: **North**

From: **0.000 LEAVE CAR CO**
 To: **27.176 ENTER POR CO**

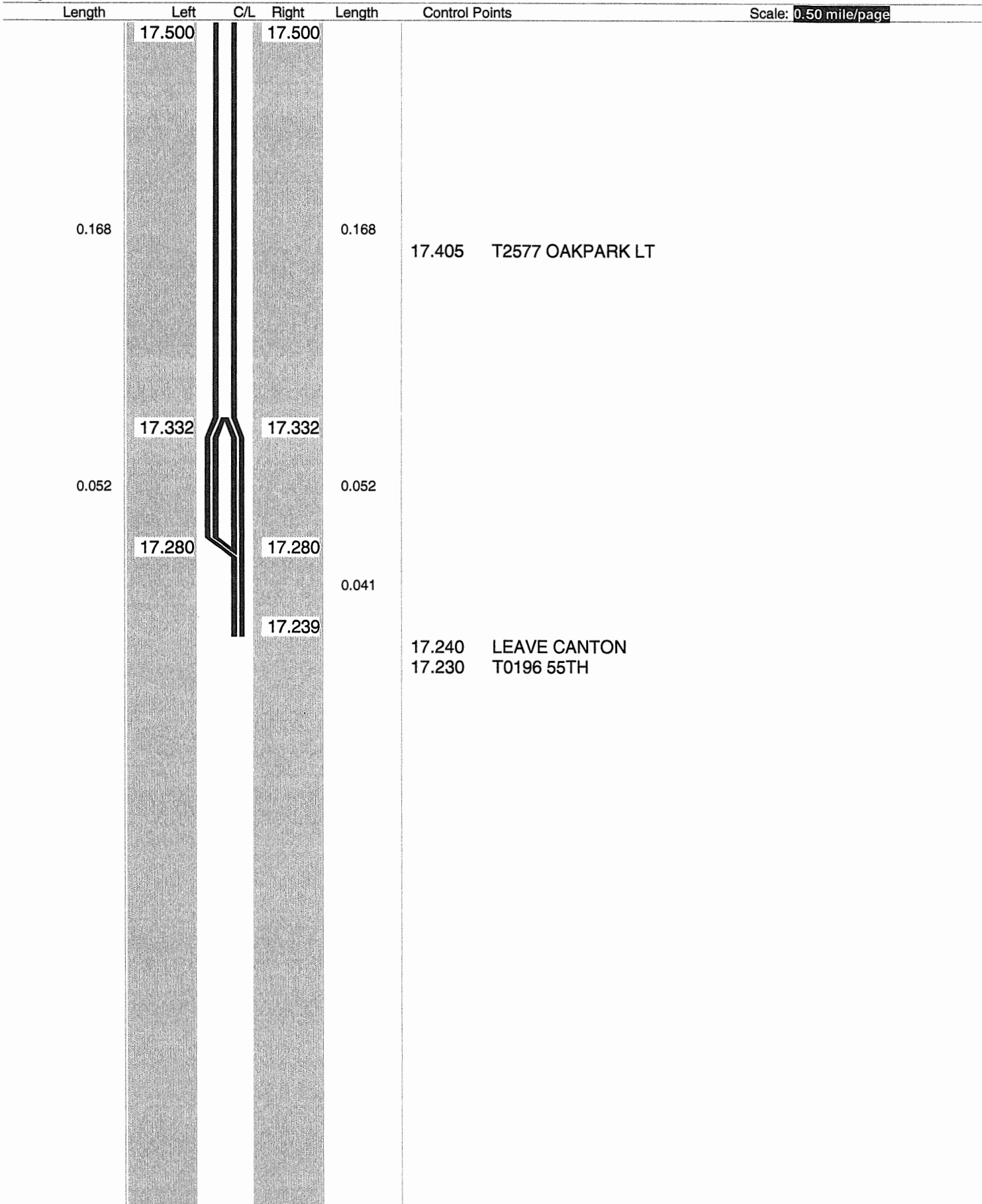

ODOT Dist 4 - Stark County - FINAL
No Passing Zone Log (STA)

Route: **0043R (SSTASR00043**C)**
 Length: **27.176** Direction: **North**

From: **0.000 LEAVE CAR CO**
 To: **27.176 ENTER POR CO**

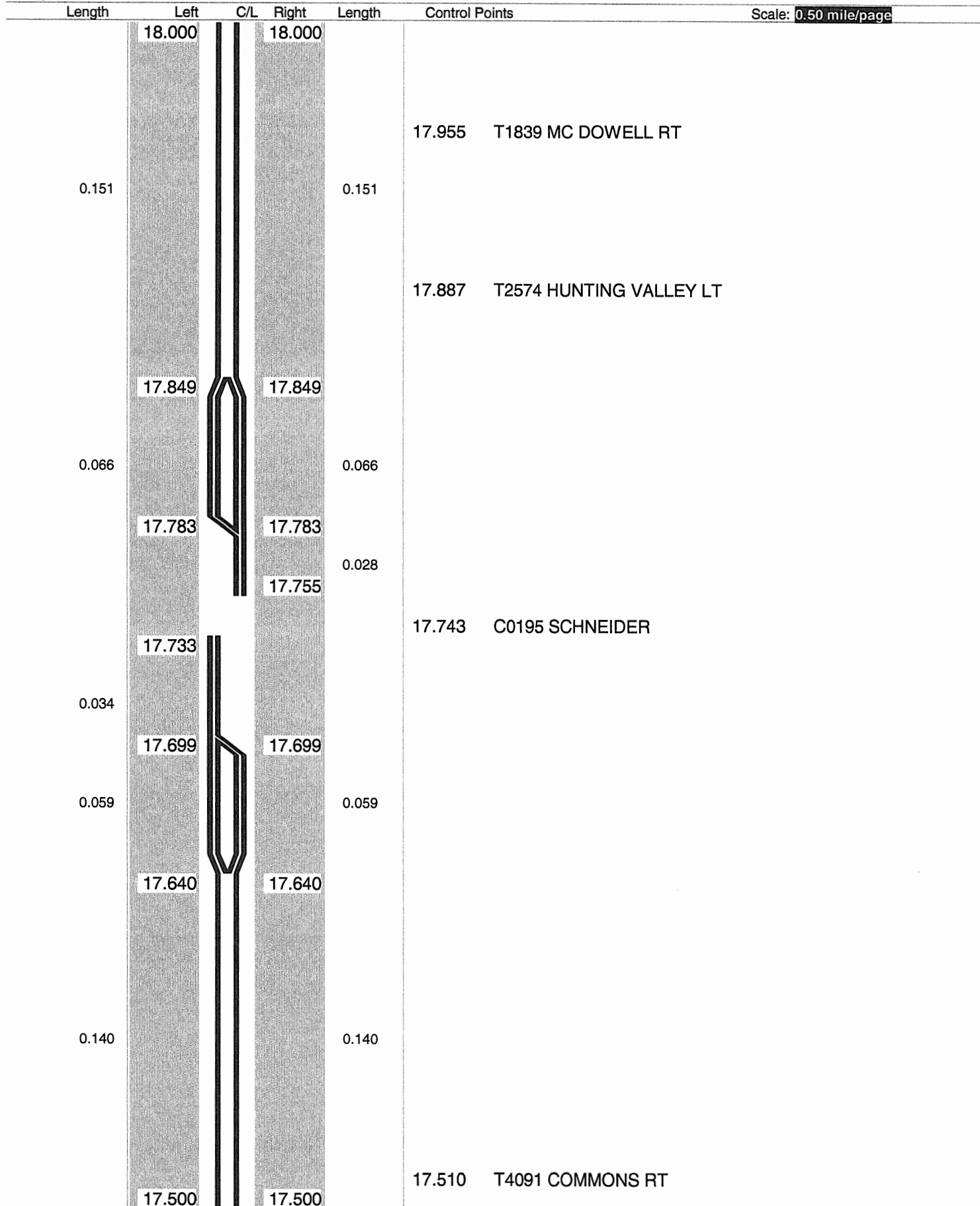

ODOT Dist 4 - Stark County - FINAL

No Passing Zone Log (STA)

Route: **0043R (SSTASR00043**C)**

From: **0.000 LEAVE CAR CO**

Length: **27.176** Direction: **North**

To: **27.176 ENTER POR CO**

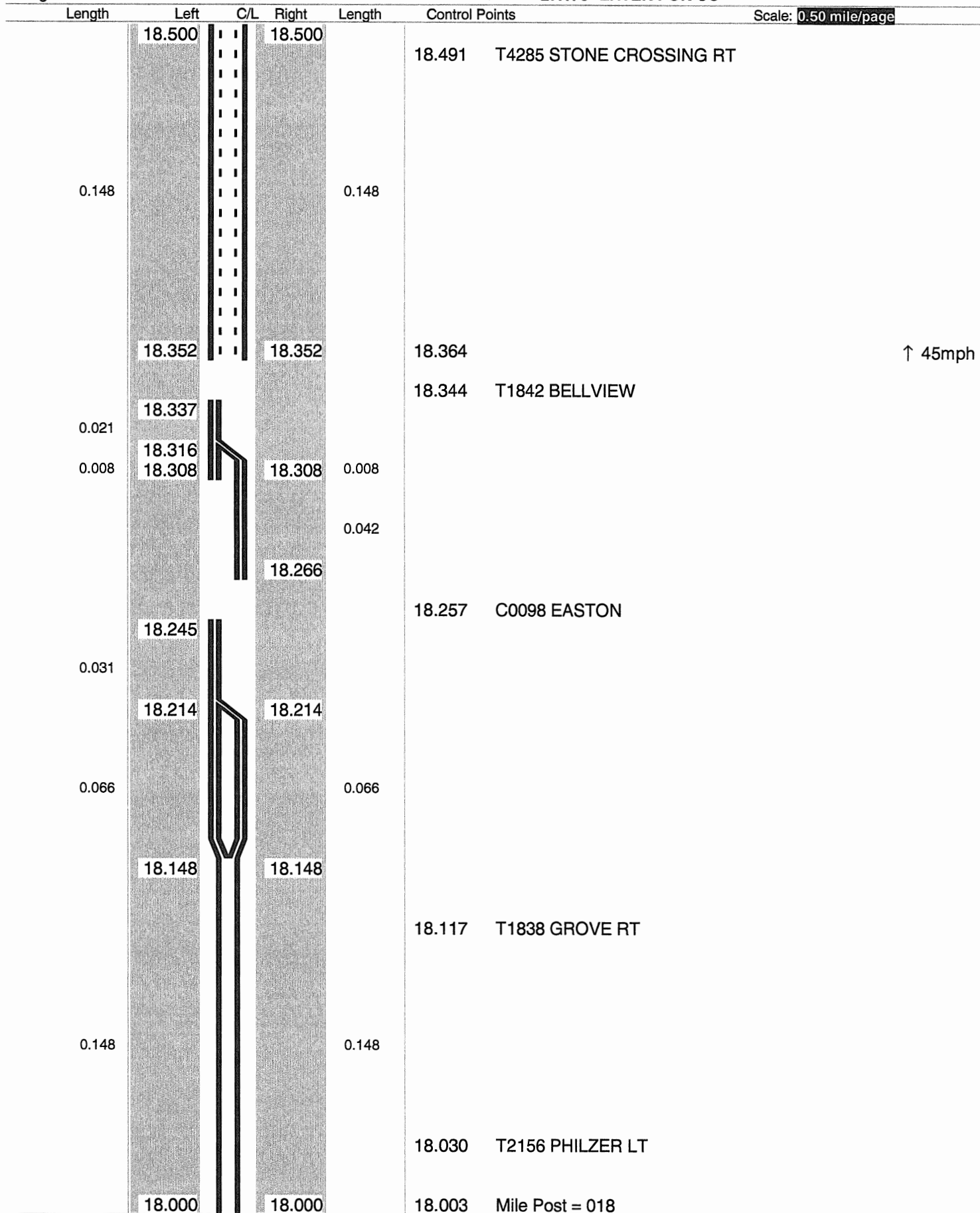

Sheet total equivalent length of solid line: 1.150

Accum. total: 17.337

ODOT Dist 4 - Stark County - FINAL
No Passing Zone Log (STA)

Route: **0043R (SSTASR00043**C)**

From: **0.000 LEAVE CAR CO**

Length: **27.176** Direction: **North**

To: **27.176 ENTER POR CO**

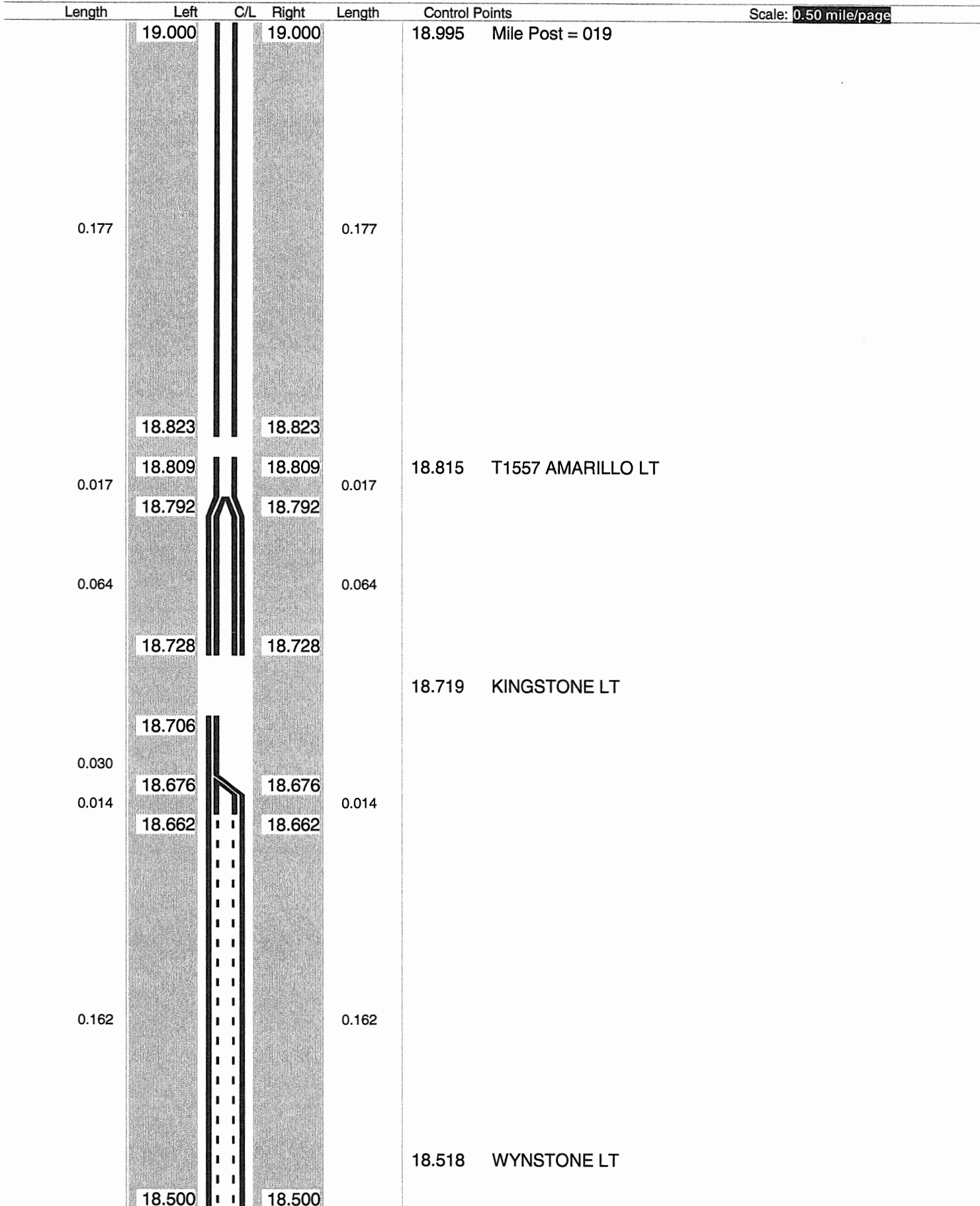

ODOT Dist 4 - Stark County - FINAL
No Passing Zone Log (STA)

Route: **0043R (SSTASR00043**C)**
 Length: **27.176** Direction: **North**

From: **0.000 LEAVE CAR CO**
 To: **27.176 ENTER POR CO**

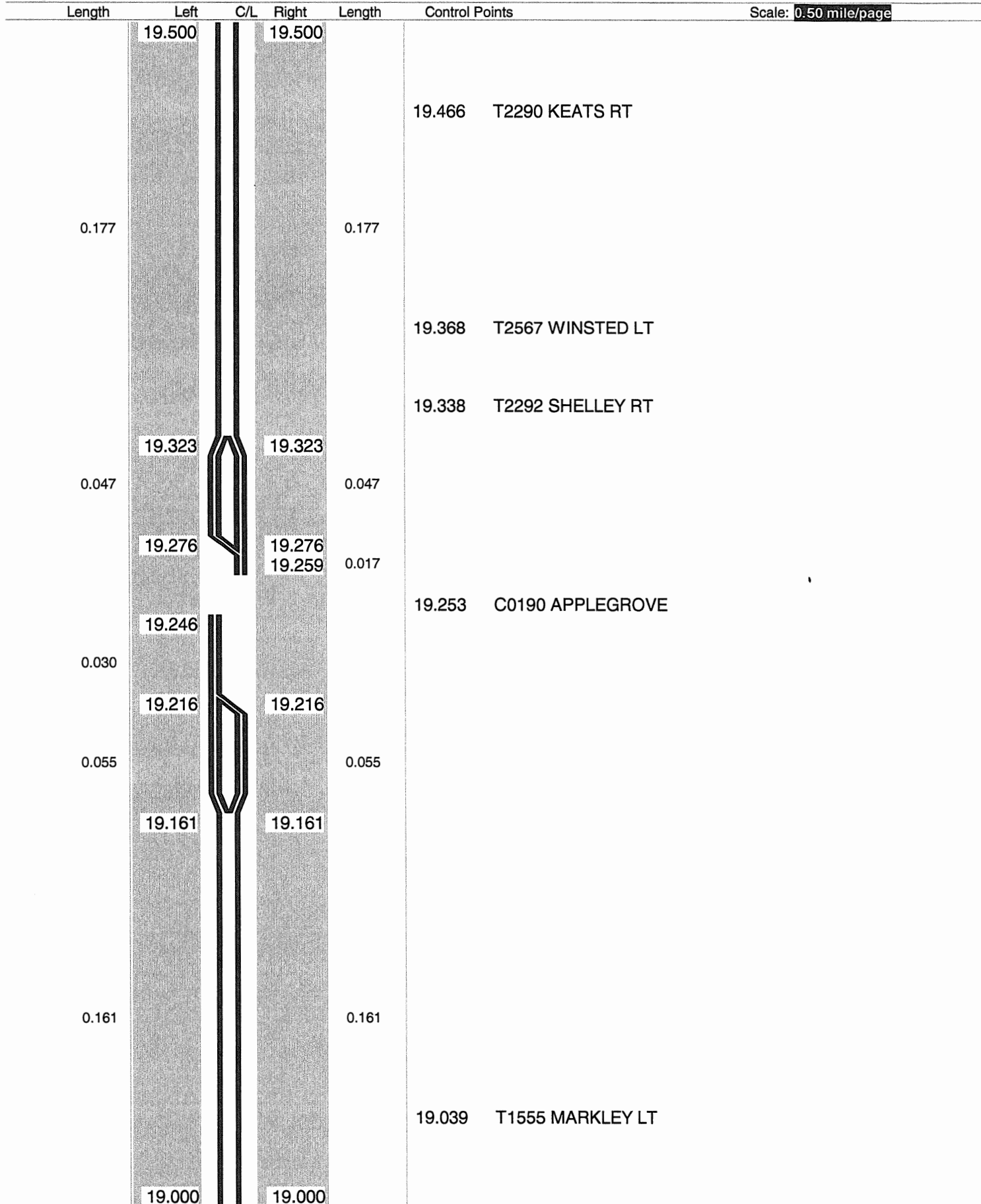

ODOT Dist 4 - Stark County - FINAL
No Passing Zone Log (STA)

Route: **0043R (SSTASR00043**C)**

Length: **27.176**

Direction: **North**

From: **0.000 LEAVE CAR CO**

To: **27.176 ENTER POR CO**

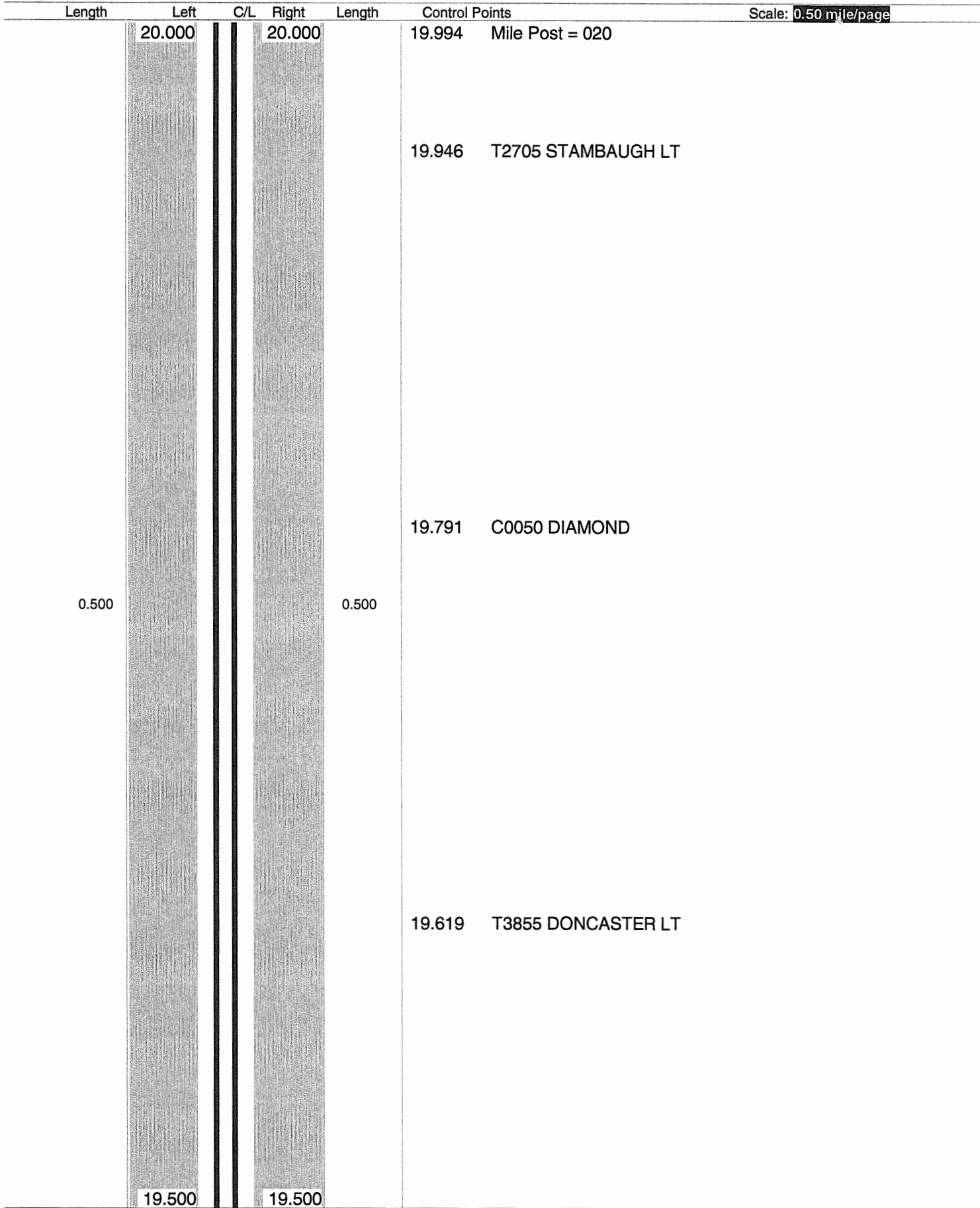

Sheet total equivalent length of solid line: 1.000

Accum. total: 20.680

ODOT Dist 4 - Stark County - FINAL
No Passing Zone Log (STA)

Route: **0043R (SSTASR00043**C)**

Length: **27.176**

Direction: **North**

From: **0.000 LEAVE CAR CO**

To: **27.176 ENTER POR CO**

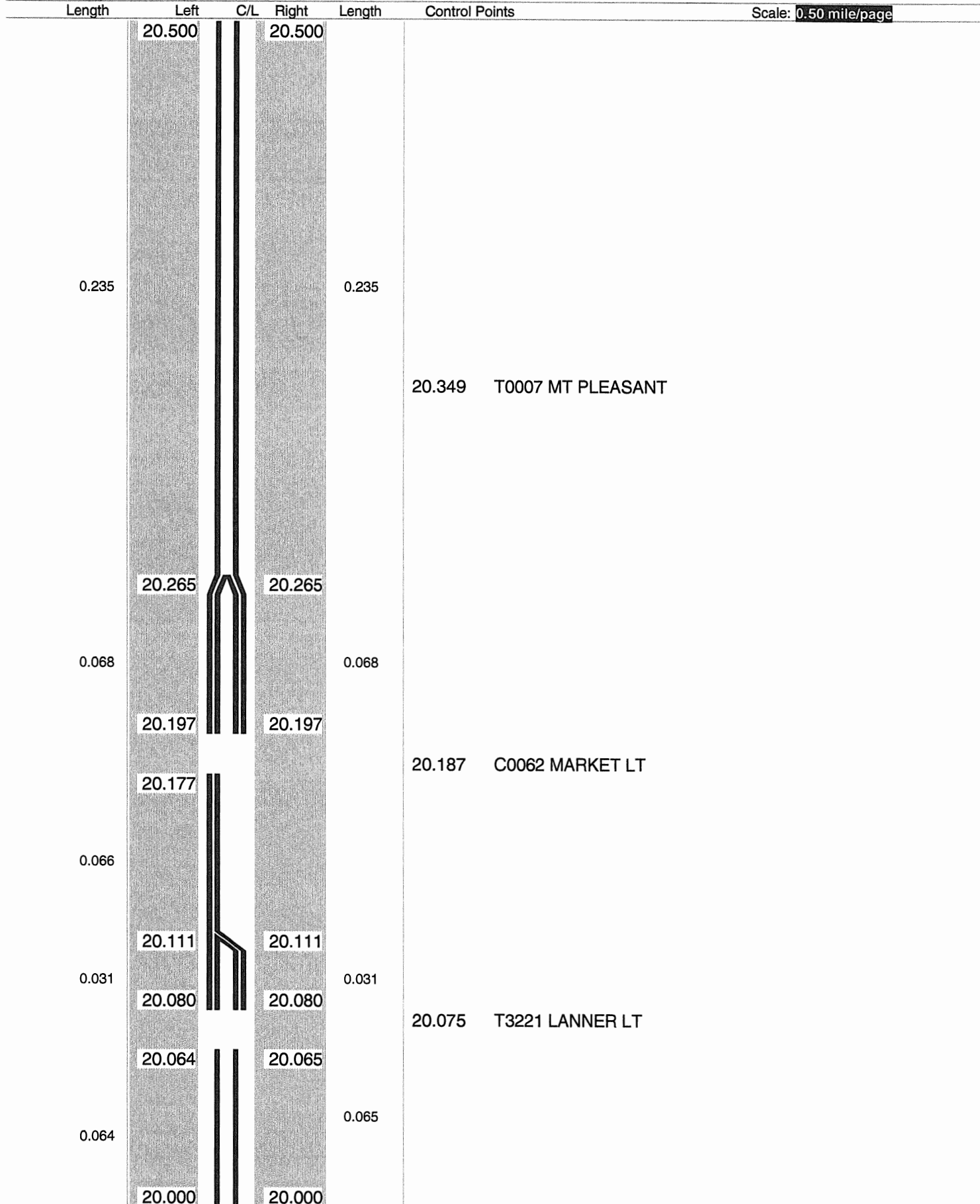

ODOT Dist 4 - Stark County - FINAL
No Passing Zone Log (STA)

Route: **0043R (SSTASR00043**C)**
 Length: **27.176** Direction: **North**

From: **0.000 LEAVE CAR CO**
 To: **27.176 ENTER POR CO**

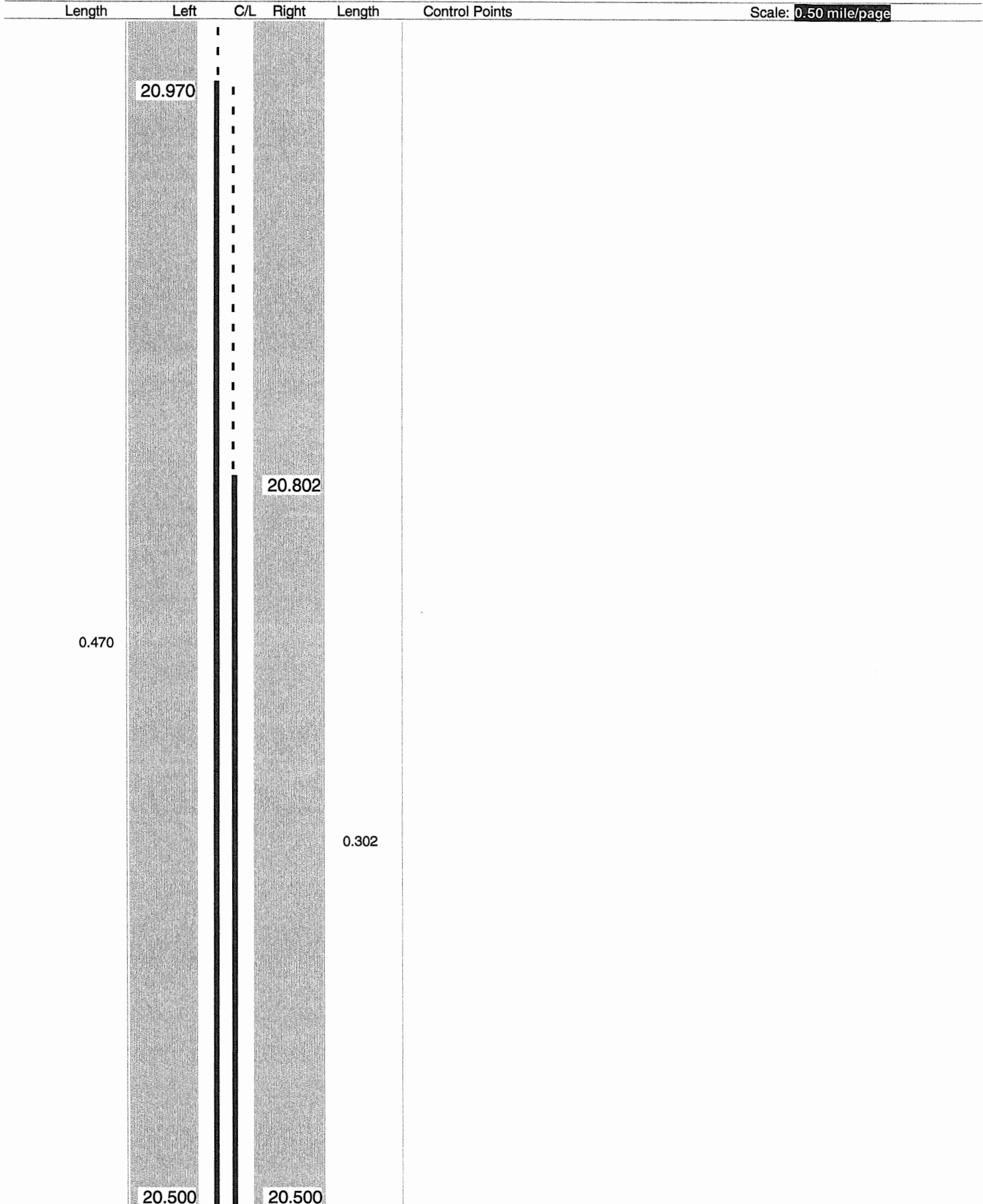

Sheet total equivalent length of solid line: 0.829

Accum. total: 22.636

ODOT Dist 4 - Stark County - FINAL

No Passing Zone Log (STA)

Route: **0043R (SSTASR00043**C)**
 Length: **27.176** Direction: **North**

From: **0.000 LEAVE CAR CO**
 To: **27.176 ENTER POR CO**

Length	Left	C/L	Right	Length	Control Points	Scale: 1.00 mile/page
	22.000		21.983	0.017	21.989 Mile Post = 022	
0.145						
	21.855		21.836			
				0.151		
			21.685			
	21.472					
			21.391		21.401 C0031 STATE	
0.281						
	21.191			0.363		
					21.174	↑ 55mph
			21.028		21.039 T0082 LOVERS LANE RT	
					21.002 Mile Post = 021	

ODOT District 4
No Passing Zone Log (STA)

Route: **0043R (SSTASR00043**C)**
 Length: **0.999** Direction: **North**

From: **22.000 LEAVE CAR CO**
 To: **22.999 ENTER POR CO**

Length	Left	C/L	Right	Length	Control Points	Scale: 1.00 mile/page
	22.999		22.999		22.987 Mile Post = 023	
					22.954 T2464 ELOISE LT	
					22.925 T2465 GARYDALE LT	
					22.861 T2464 ELOISE LT	
0.548					22.696 T0429 ROYER RT	
				0.718		
	22.452					
	22.276		22.282			
0.276					22.134 T0048 NIMISHILLEN CHURCH	
			22.125			
				0.125		
	22.000		22.000			

ODOT Dist 4 - Stark County - FINAL
No Passing Zone Log (STA)

Route: **0043R (SSTASR00043**C)**

From: **0.000 LEAVE CAR CO**

Length: **27.176** Direction: **North**

To: **27.176 ENTER POR CO**

Length	Left	C/L	Right	Length	Control Points	Scale: 1.00 mile/page
	24.000		24.000		23.979 Mile Post = 024	
					23.888 WYANDOT LT	
					23.791 T2463 HAZEL LT	
					23.787	↑ 35mph
					23.782 ENTRE HARTVILLE	
					23.655 T2694 HOWARD LT	
1.000				1.000		
					23.227 C0057 SMITH KRAMER	
					23.102 C0192 MIDDLEBRANCH RT	
	23.000		23.000			

ODOT Dist 4 - Stark County - FINAL
No Passing Zone Log (STA)

Route: **0043R (SSTASR00043**C)**
 Length: **27.176**

Direction: **North**

From: **0.000 LEAVE CAR CO**
 To: **27.176 ENTER POR CO**

Length	Left	C/L	Right	Length	Control Points	Scale: 1.00 mile/page
	24.985		24.985		24.995 S0619R	
					24.903 SUNNY SIDE LT	
					24.856 MILL RT	
					24.769 LINCOLN	
					24.668 WASHINGTON LT	
					24.663 WASHINGTON RT	
					24.590 JEFFERSON	
0.985				0.985		
					24.461 WOODLAND	
					24.365 WOODSIDE LT	
					24.284 SENECA LT	
					24.098 TONAWANDA LT	
	24.000		24.000			

ODOT Dist 4 - Stark County - FINAL
No Passing Zone Log (STA)

Route: **0043R (SSTASR00043**C)**
 Length: **27.176**

Direction: **North**

From: **0.000 LEAVE CAR CO**
 To: **27.176 ENTER POR CO**

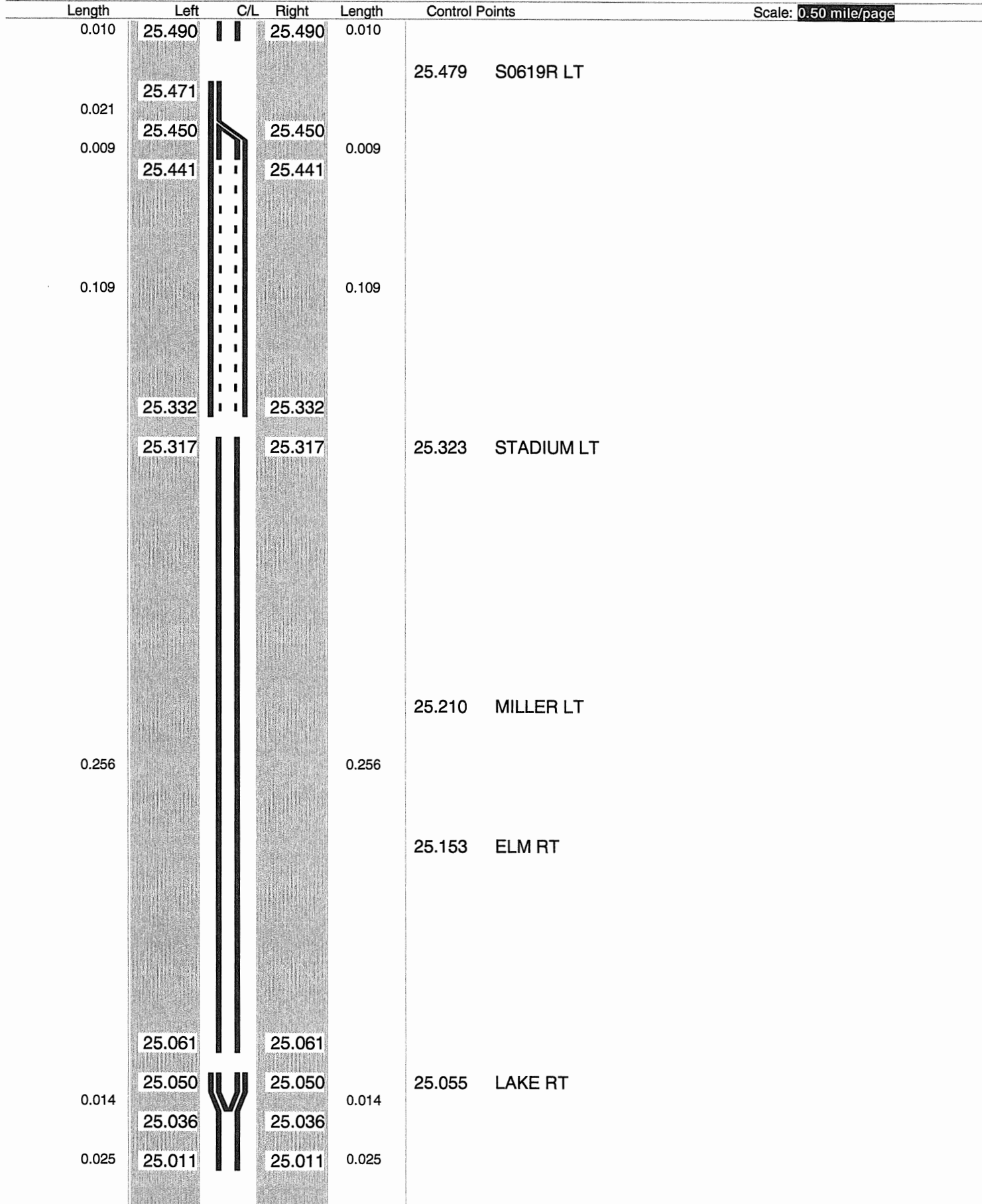

ODOT Dist 4 - Stark County - FINAL
No Passing Zone Log (STA)

Route: **0043R (SSTASR00043**C)**
 Length: **27.176** Direction: **North**

From: **0.000 LEAVE CAR CO**
 To: **27.176 ENTER POR CO**

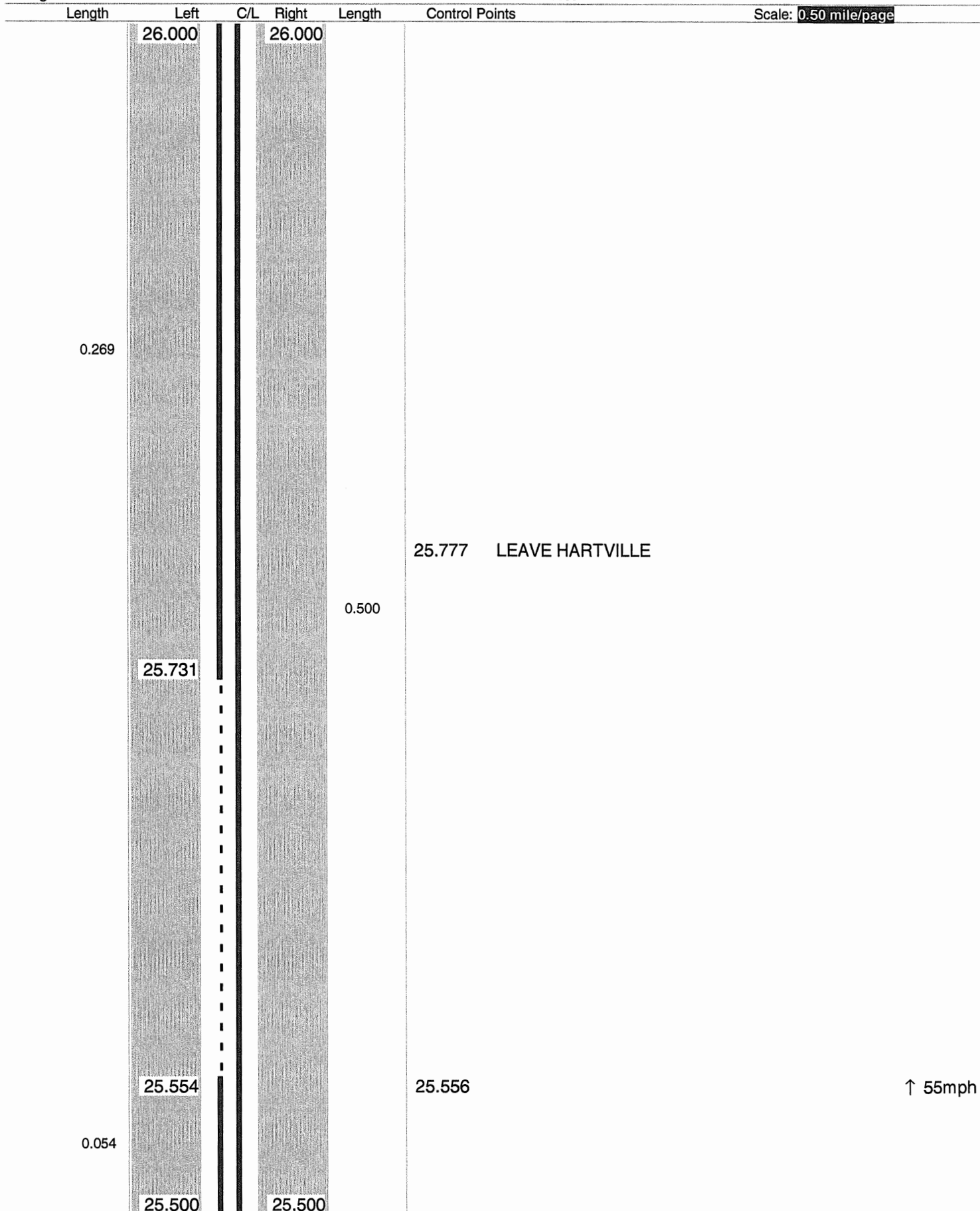

ODOT Dist 4 - Stark County - FINAL
No Passing Zone Log (STA)

Route: **0043R (SSTASR00043**C)**
 Length: **27.176** Direction: **North**

From: **0.000 LEAVE CAR CO**
 To: **27.176 ENTER POR CO**

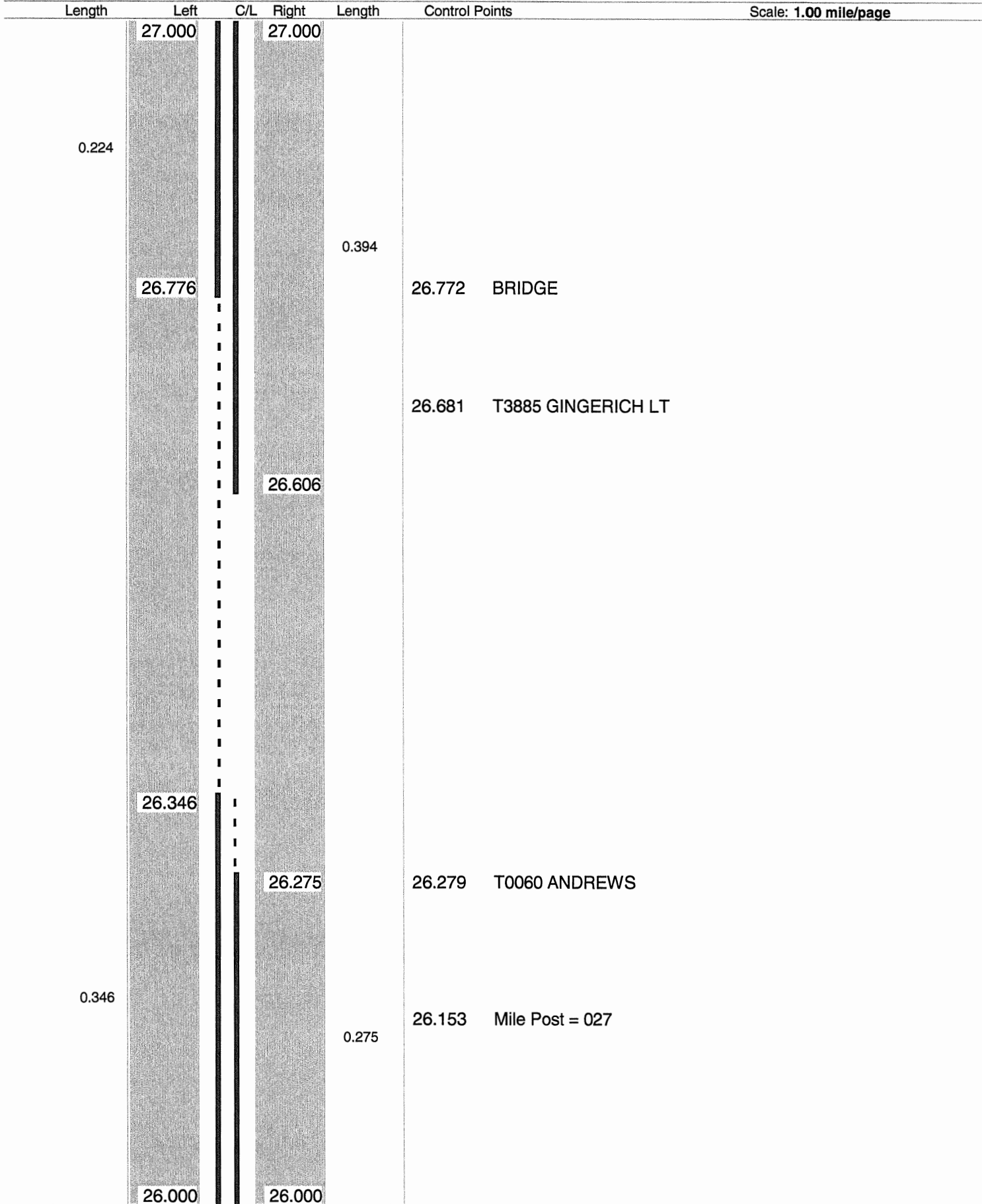

**ODOT Dist 4 - Stark County - FINAL
No Passing Zone Log (STA)**

Route: 0043R (SSTASR00043**C)

From: 0.000 LEAVE CAR CO

Length: 27.176 Direction: North

To: 27.176 ENTER POR CO

Length	Left	C/L	Right	Length	Control Points	Scale: 1.00 mile/page
0.176				0.176		
	27.176		27.176		27.176 ENTER POR CO	
	27.000		27.000			